

DETTAGLIO RECINZIONE
SCALA 1:25

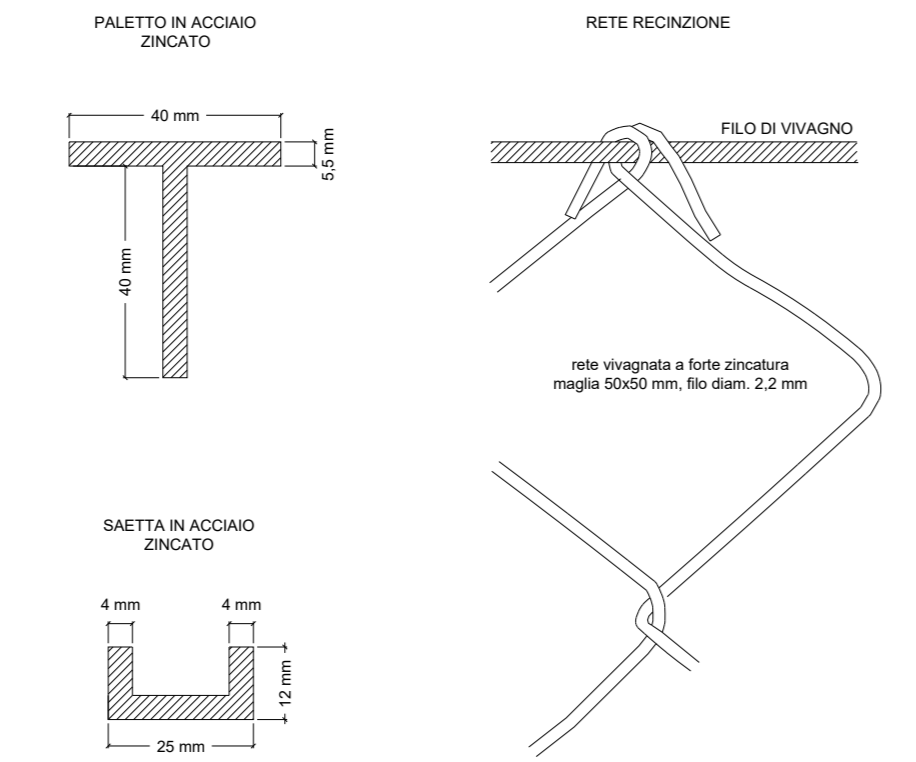

SEZIONI TIPO STRADE COLLEGAMENTO AI CAMPI

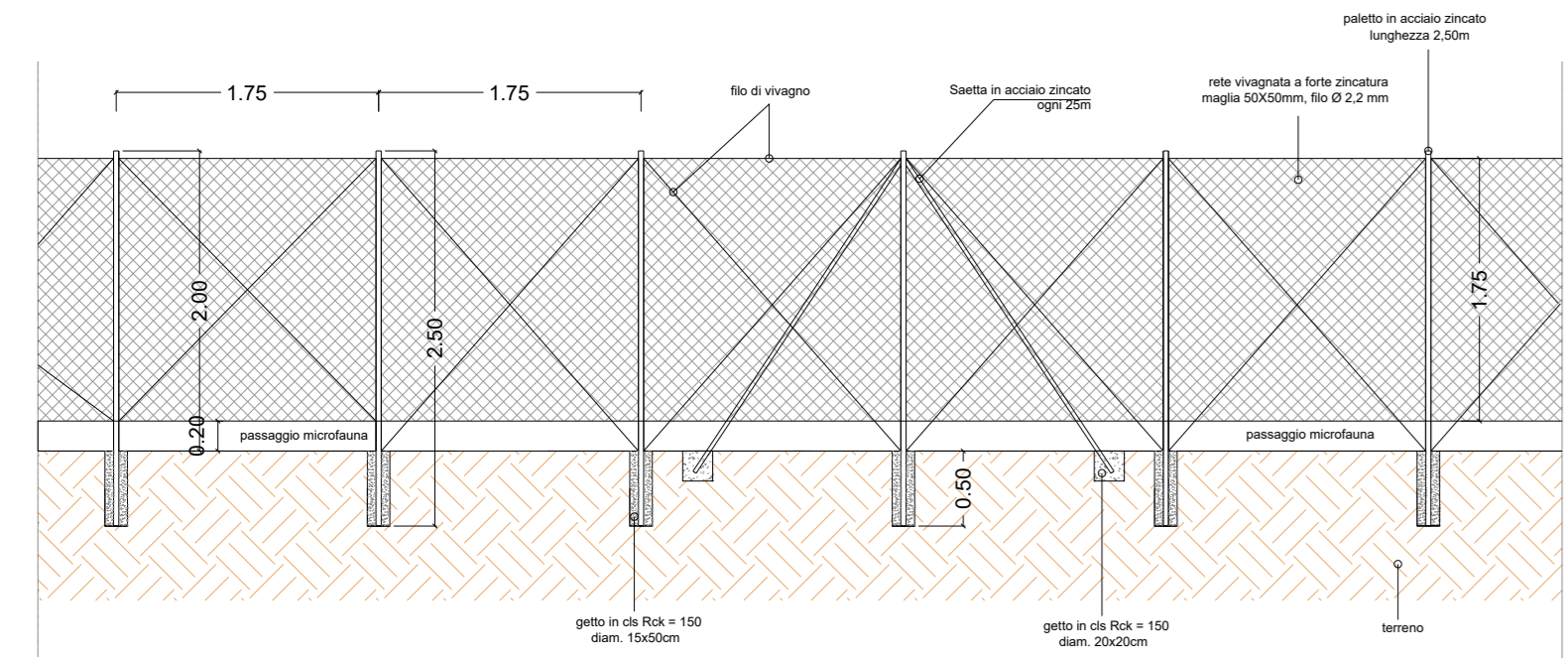
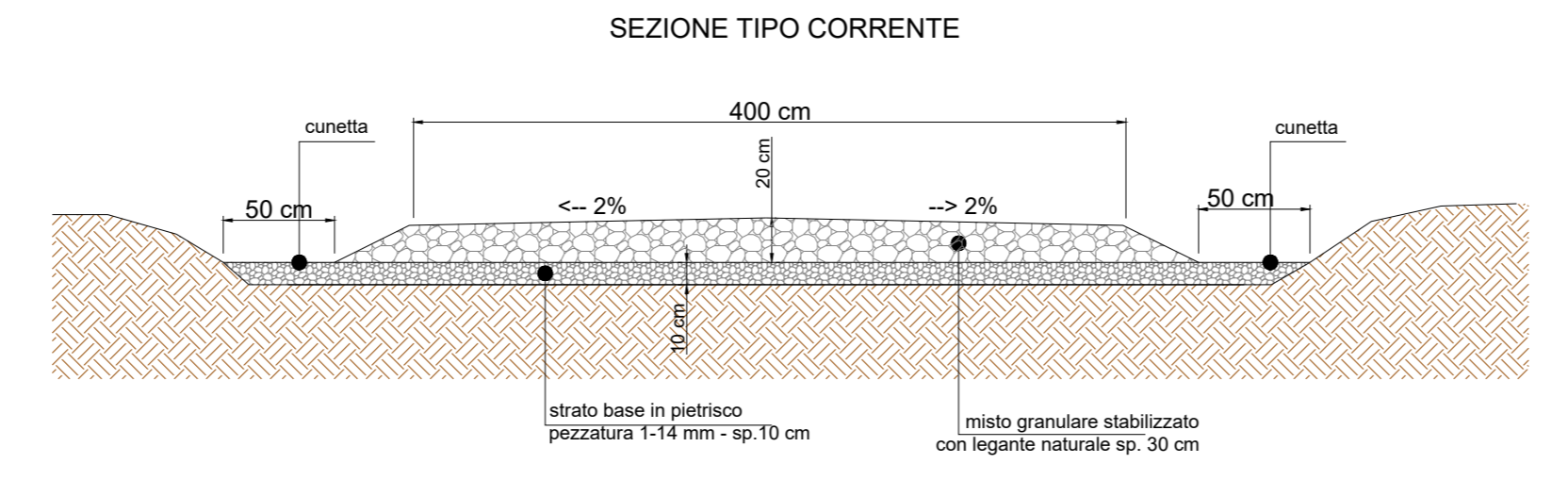

SEZIONI TIPO VIABILITA' DI SERVIZIO INTERNA AI CAMPI

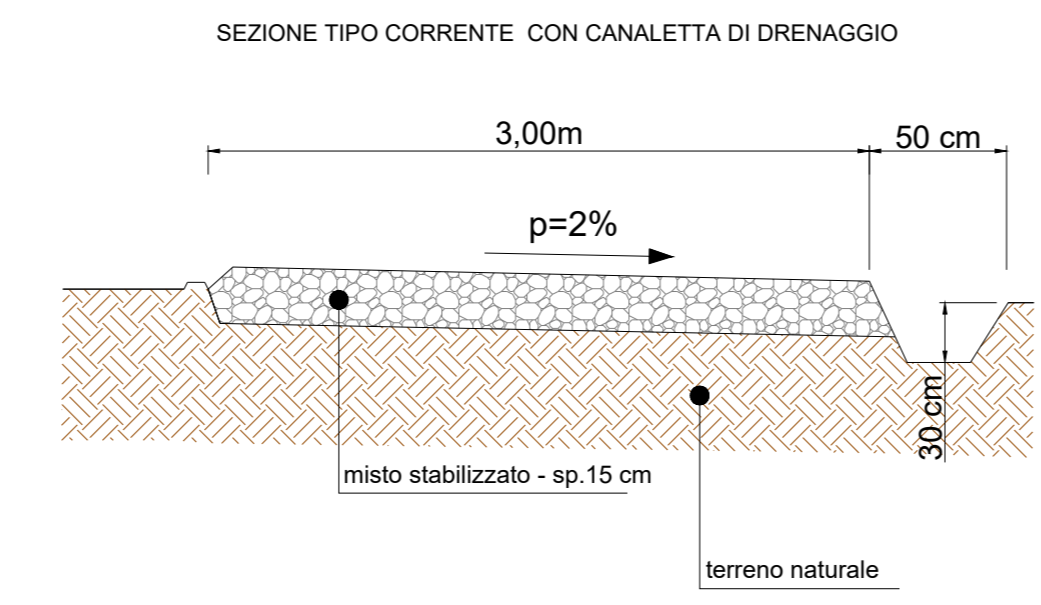
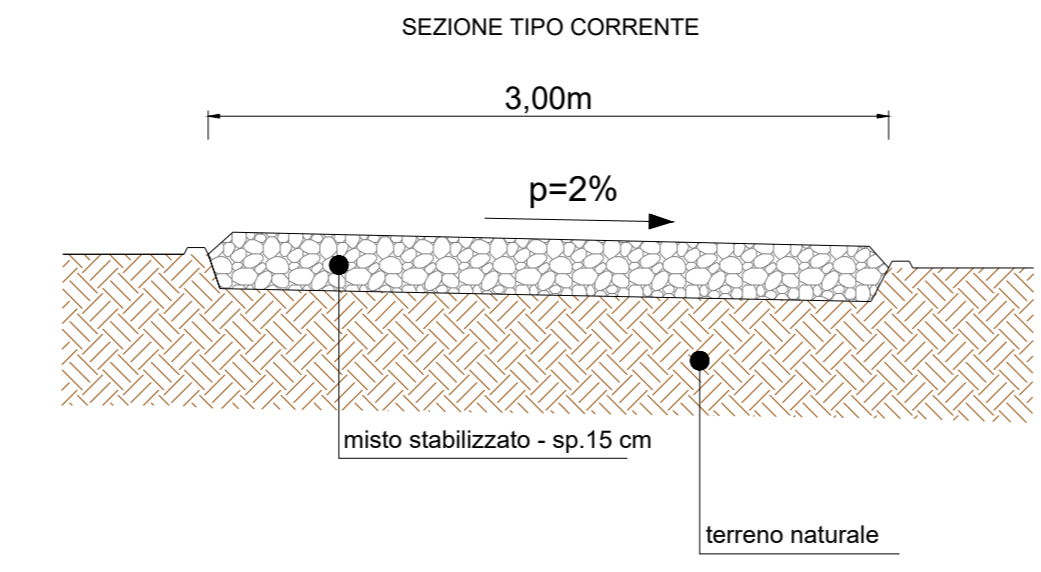

SEZIONE TIPO STRADA PERIMETRALE CON RECINZIONE

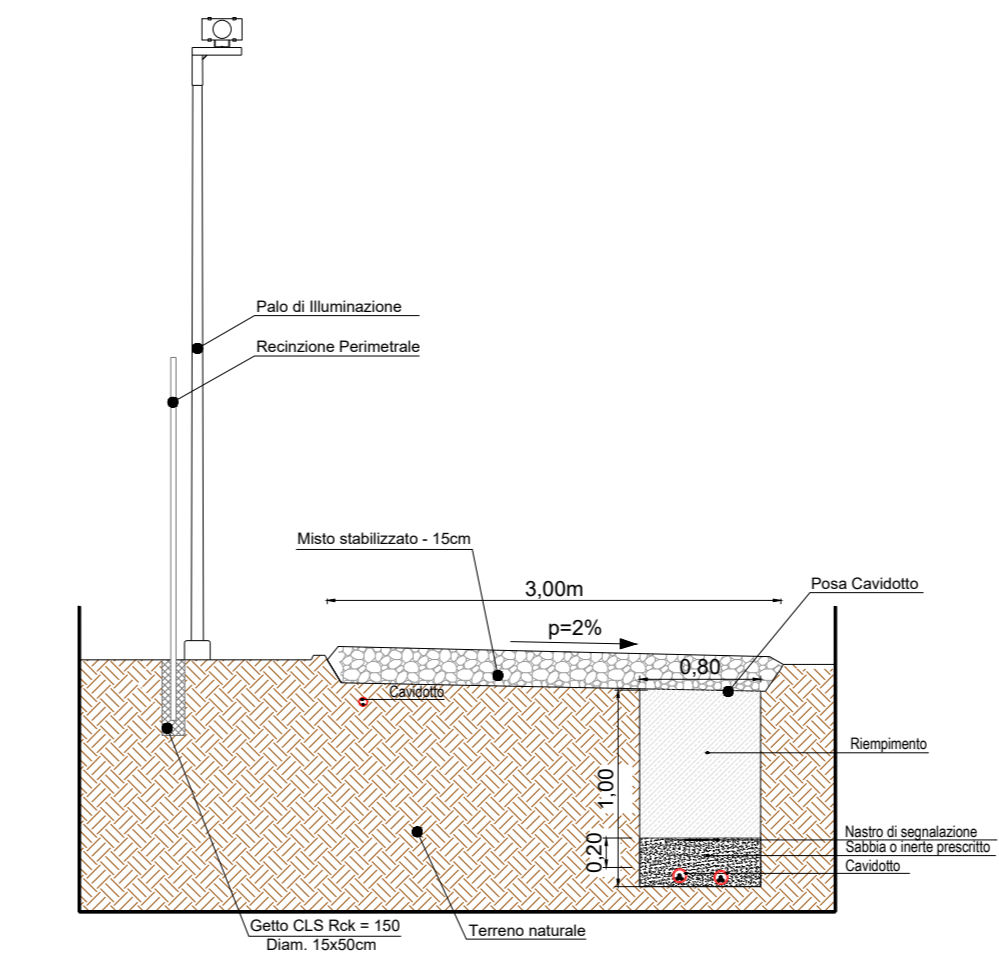

PALO DI ILLUMINAZIONE E VIDEOSORVEGLIANZA
SCALA 1:50

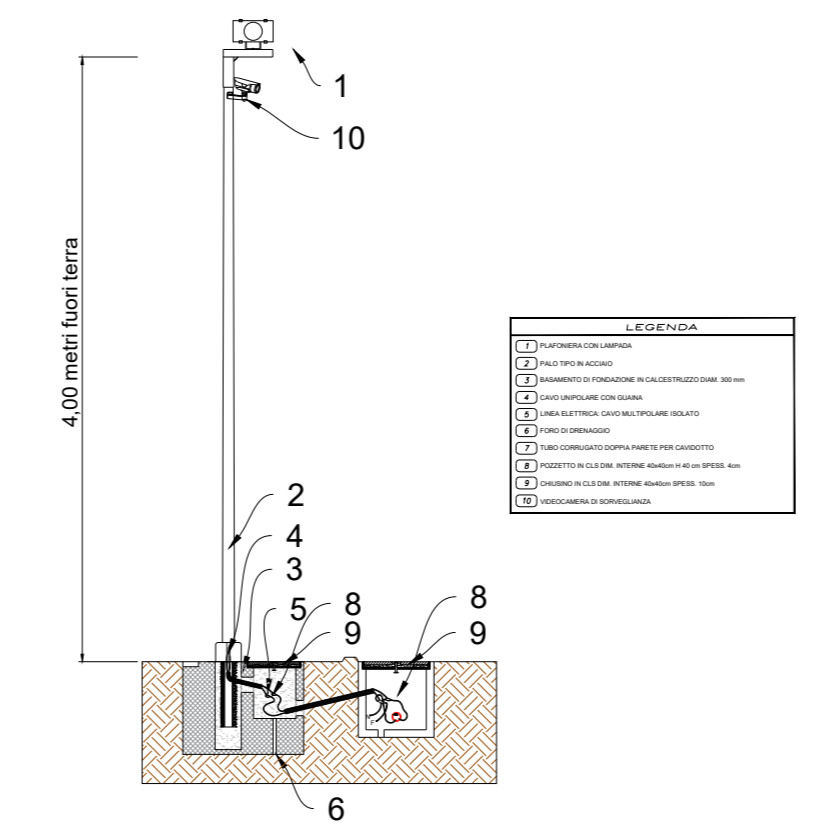

SEZIONE TIPO STRADA PERIMETRALE CON PARTICOLARE POZZETTO

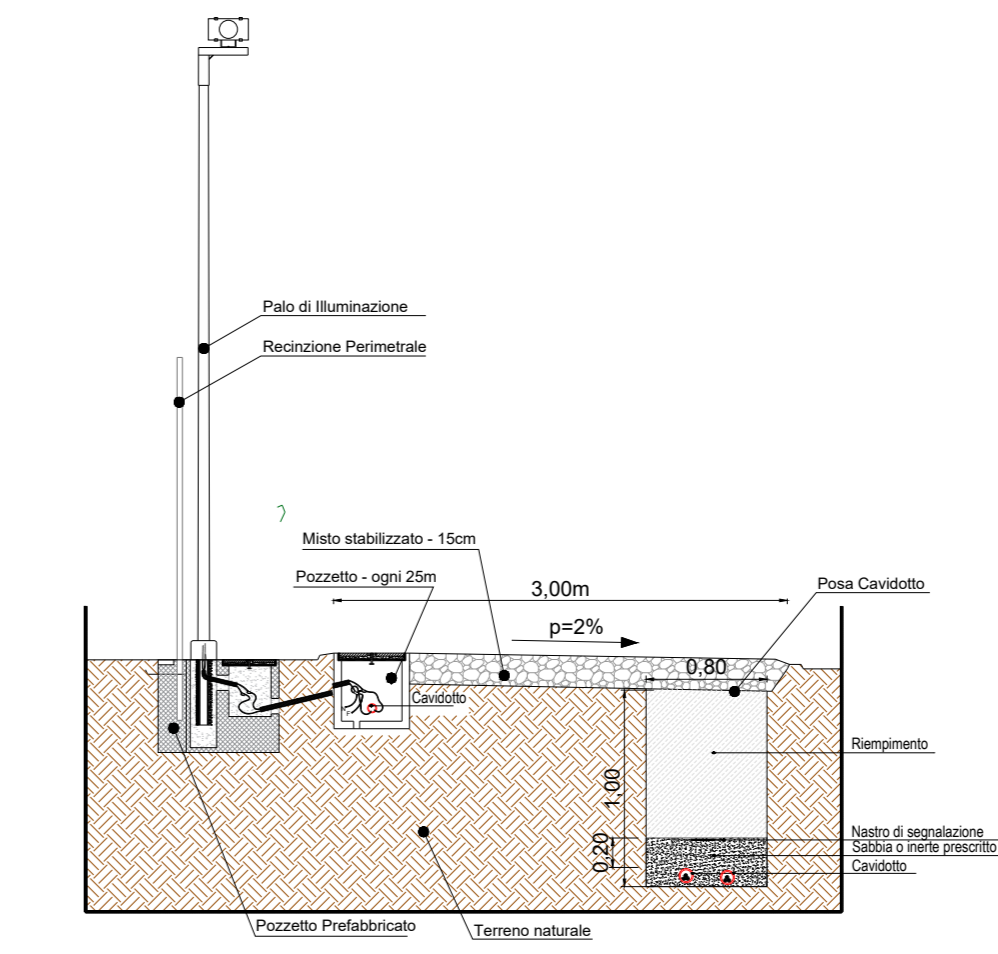

PALO DI ILLUMINAZIONE
SCALA 1:50

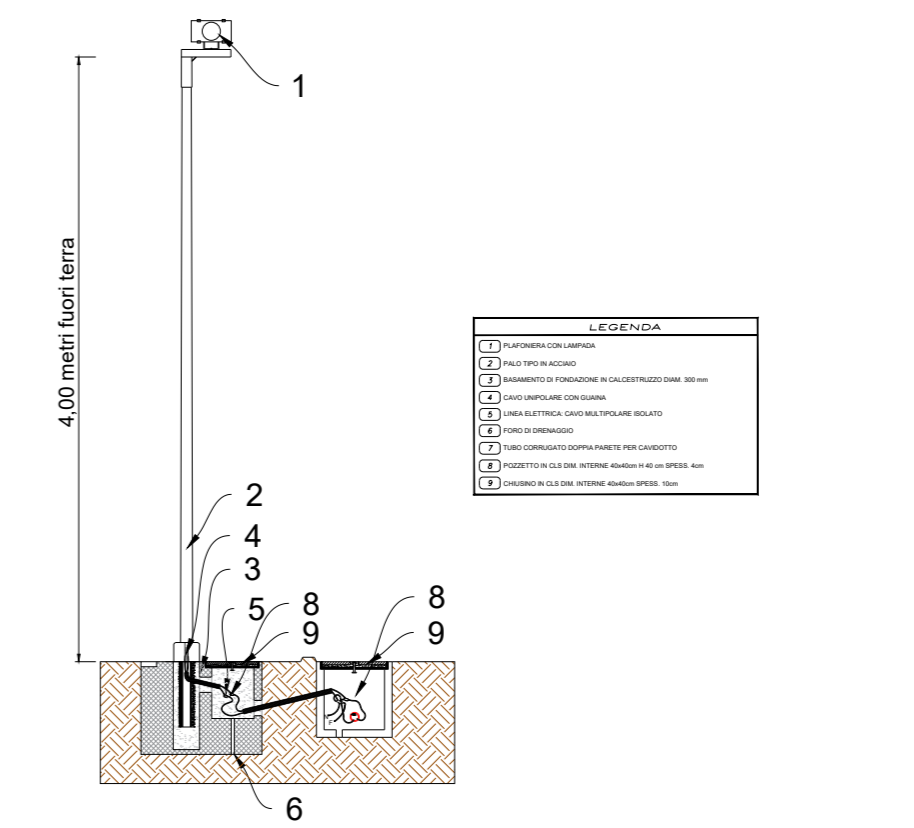

DETTAGLIO CANCELLO DI INGRESSO

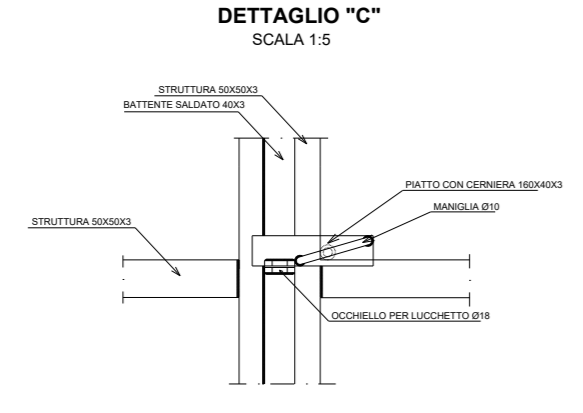
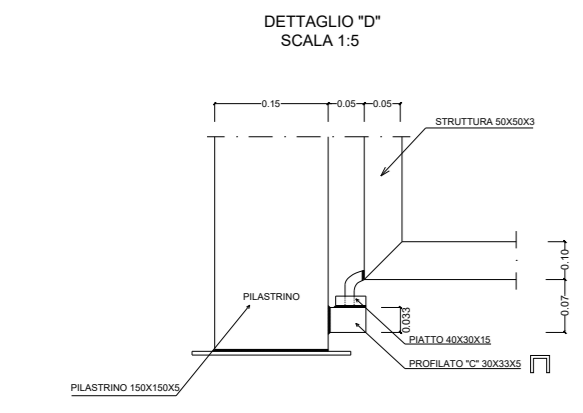
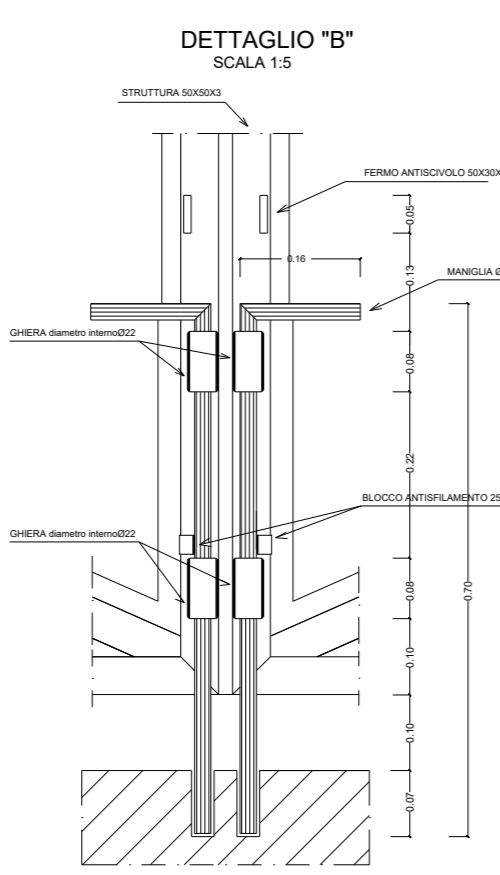
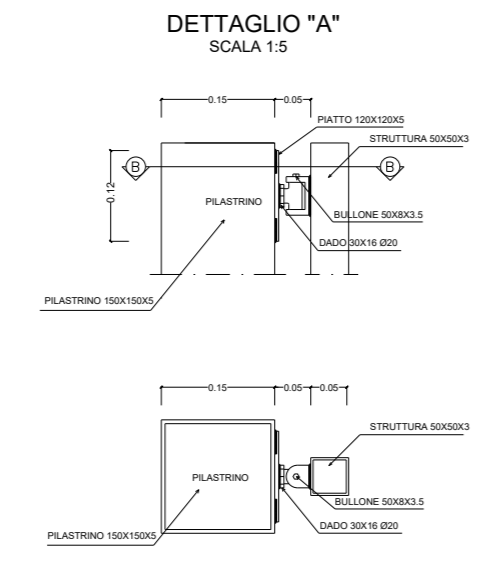
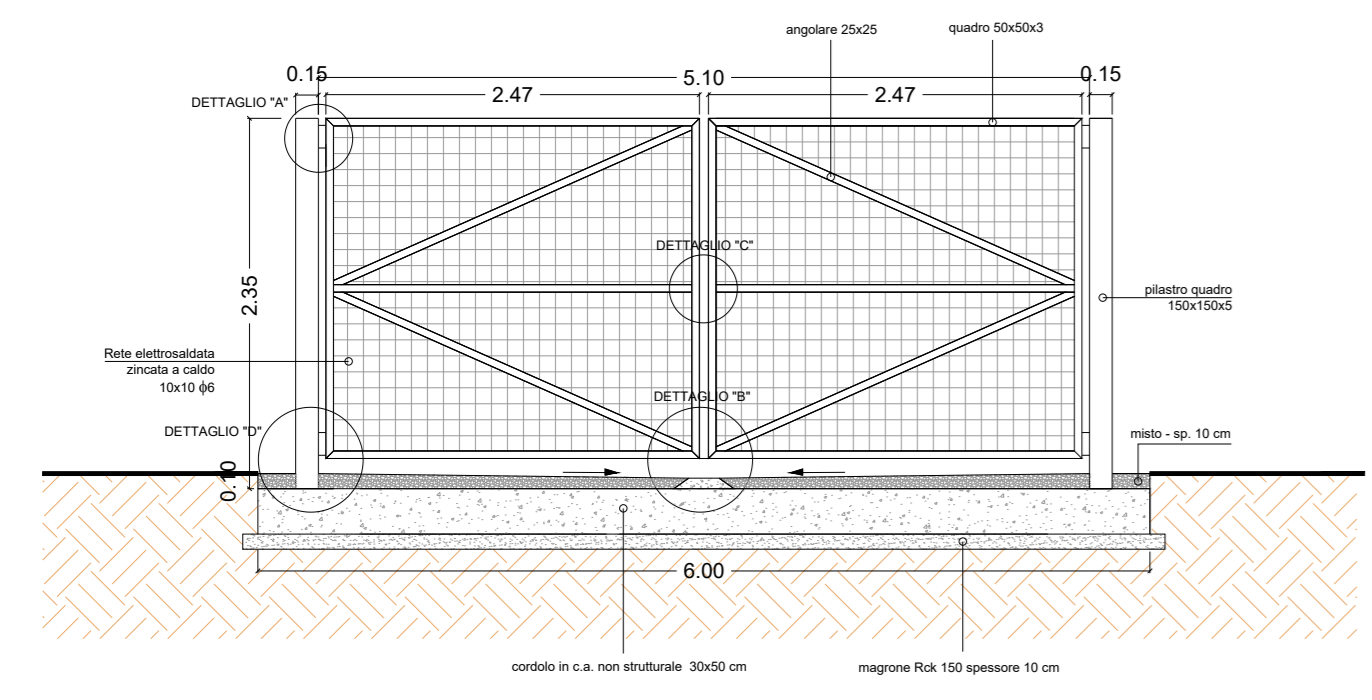

ENE 002a - Grosseto
Comuni: Grosseto
Provincia: Grosseto
Regione: Toscana

Proponente:
GRÖSSETO GREEN POWER S.R.L.
Via Dante, 7
20123 Milano (MI)
P.Iva: 1266000964
PEC: grossetogreenpower@pec.it

Consulenza ambientale e progettazione:
ARCADIS Italia S.r.l.
Via Monte Rosa, 93 | 20149 | Milano (MI)
T. +39 02 00 62 46 65 | F. +39 02 80 42 13
P.Iva: 01521770212
info@arcadis.it | www.arcadis.com

Rev.	Data	Descrizione	Dis.	Confr.	App.
0	Dic.23	Progetto Definitivo - Prima Emissione	CR	MA	SDA

Nome Progetto:
ENE 002a - Grosseto - Progetto di un impianto agrivoltico sito nel comune di Grosseto in località "Braccagni" di potenza nominale pari a 38.47 MWp in DC

Nome Documento:
Campo FV - Particolari Strade Interne, recinzioni e cancelli

Codice documento:
PRO_TAV_15

Scala:
VARIE