

LIVELLETTTE

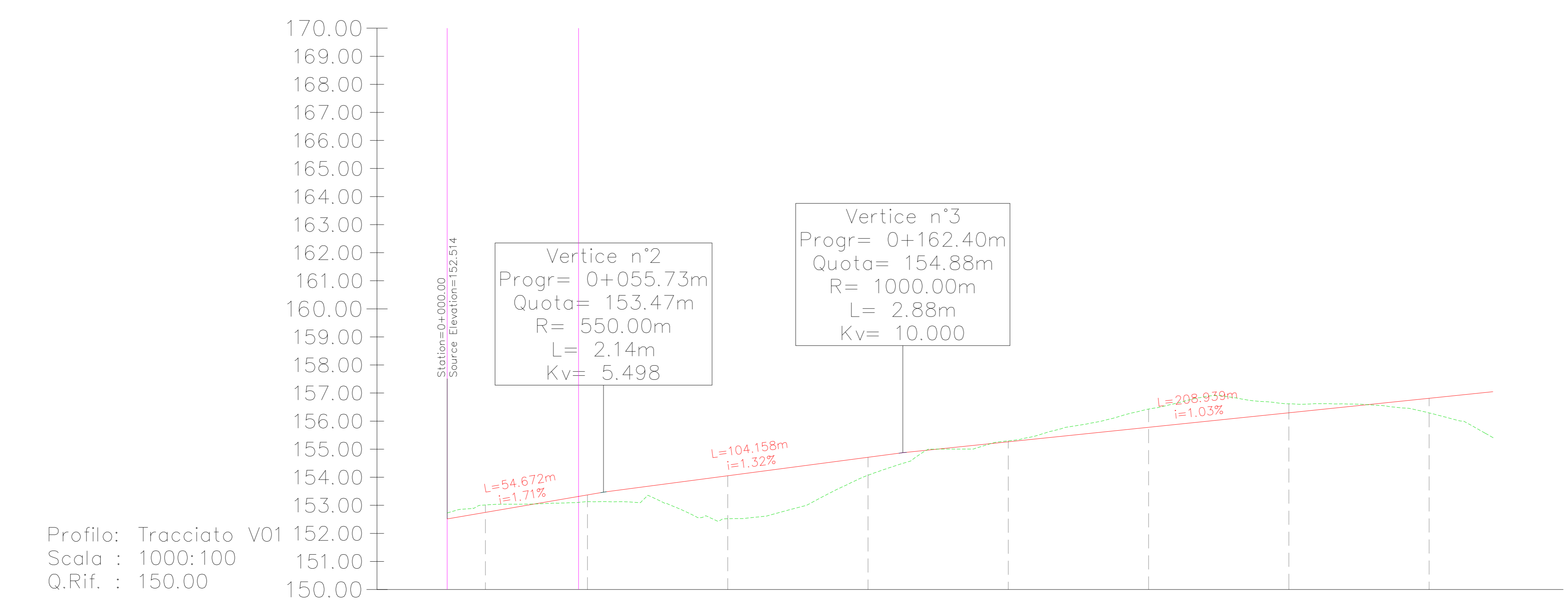
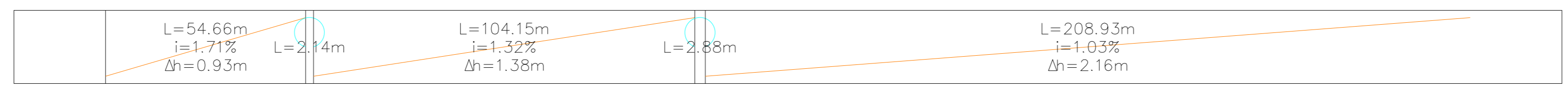

NUMERO SEZIONE	1	2	3	4	5	6	7	8
DISTANZE PROGRESSIVE	0+000.00	0+055.73	0+100.00	0+150.00	0+200.00	0+250.00	0+300.00	0+350.00
DISTANZE PARZIALI		55.73	44.27	50.00	50.00	50.00	50.00	50.00
QUOTE PROGETTO	152.25	153.17	154.05	154.71	155.36	155.78	156.40	156.51
QUOTE TERRENO	153.00	153.11	153.52	154.07	155.39	156.41	156.62	156.21
DIFFERENZA QUOTE	-0.75	0.06	0.53	0.64	-0.03	-0.63	-0.22	0.30
ETTOMETRICHE	00	01	02	03	04	05	06	07
ANDAMENTO PLANIMETRICO								

01	19/02/2024	Seconda Emissione	A. Olsson	G. Altiro	P. Polini
00	10/05/2022	Prima Emissione	A. Filippi	G. Altiro	P. Polini
REV.	DATE	DESCRIPTION	PREPARED	CHECKED	APPROVED

PROJECT: IMPIANTO EOLICO SANLURI-SARDARA

FILE NAME: GRE.EEC.D.25.IT.W.17279.00.003.01 - Profili longitudinali stradali

CLASSIFICATION:	FORMAT:	SCALE:	PLLOT SCALE:	SHEET:
PUBLIC	A0	1:1000	1:1	1 di 16

UTILIZATION SCOPE: BASIC DESIGN

TITLE: Profili longitudinali stradali

EGP VALIDATION

VALIDATED BY:	GROUP:	FUNCTION:	TYPE:	COUNTRY:	PLANT:	SYSTEM:	PROGRESSIVE:	REVISION:
	GRE.EEC	D25	ITW17279	00008301				

LIVELLETTA

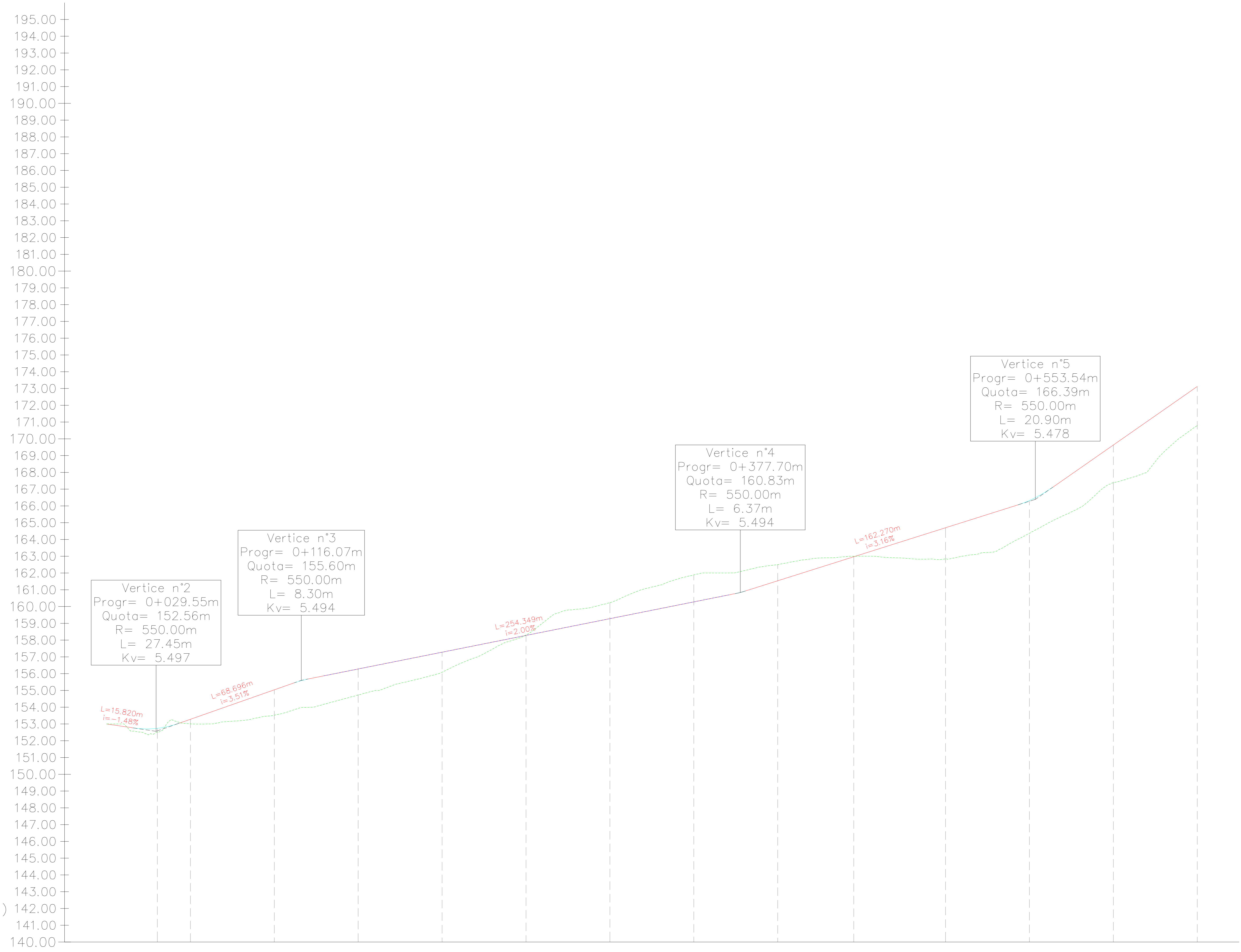
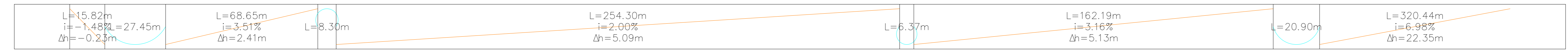

Profilo: Tracciato V02-V04 (1)
Scala : 1000:100
Q.Rif. : 140.00

NUMERO SEZIONE
DISTANZE PROGRESSIVE
DISTANZE PARZIALI
QUOTE PROGETTO
QUOTE TERRENO
DIFFERENZA QUOTE
ETOMETRICHE
ANDAMENTO PLANIMETRICO

	1	2	3	4	5	6	7	8	9	10	11	12	13	14
DISTANZE PROGRESSIVE	0+000.00	0+029.55	0+116.07	0+124.37	0+200.82	0+254.39	0+260.76	0+327.13	0+333.50	0+400.00	0+420.90	0+441.80	0+462.70	0+483.60
DISTANZE PARZIALI		19,68	50,00	50,00	50,00	50,00	50,00	50,00	50,00	45,34	54,66	50,00	50,00	50,00
QUOTE PROGETTO	152,74	152,98	155,60	155,84	156,08	156,32	156,56	156,80	157,04	157,28	157,52	157,76	158,00	158,24
QUOTE TERRENO	152,74	152,98	153,22	153,46	153,70	153,94	154,18	154,42	154,66	154,90	155,14	155,38	155,62	155,86
DIFFERENZA QUOTE	0,00	0,00	0,38	0,38	0,38	0,38	0,38	0,38	0,38	0,38	0,38	0,38	0,38	0,38
ETOMETRICHE	0,00	0,00	0,00	0,00	0,00	0,00	0,00	0,00	0,00	0,00	0,00	0,00	0,00	0,00
ANDAMENTO PLANIMETRICO														

01	19/02/2024	Seconda Emissione	A. Olsson	G. Altaro	P. Polini
00	10/06/2022	Prima Emissione	A. Filippi	G. Altaro	P. Polini
REV.	DATE	DESCRIPTION	PREPARED	CHECKED	APPROVED
IMPIANTO EOLICO SANLURI-SARDARA					
FILE NAME: GRE.ECC.D.25.IT.W.17279.00.003.01 - Profili longitudinali stradali					
CLASSIFICATION: PUBLIC		FORMAT: A0	SCALE: 1:1000	PLOT SCALE: 1:1	SHEET: 2 di 16
UTILIZATION SCOPE: BASIC DESIGN					
TITLE: Profili longitudinali stradali					
EGP VALIDATION					
VALIDATED BY:	GROUP:	FUNCTION:	TYPE:	COUNTRY:	EGP CODE:
VERIFIED BY:	GRE.ECC	D.25	ITW17279	00008301	24

LIVELLETTA

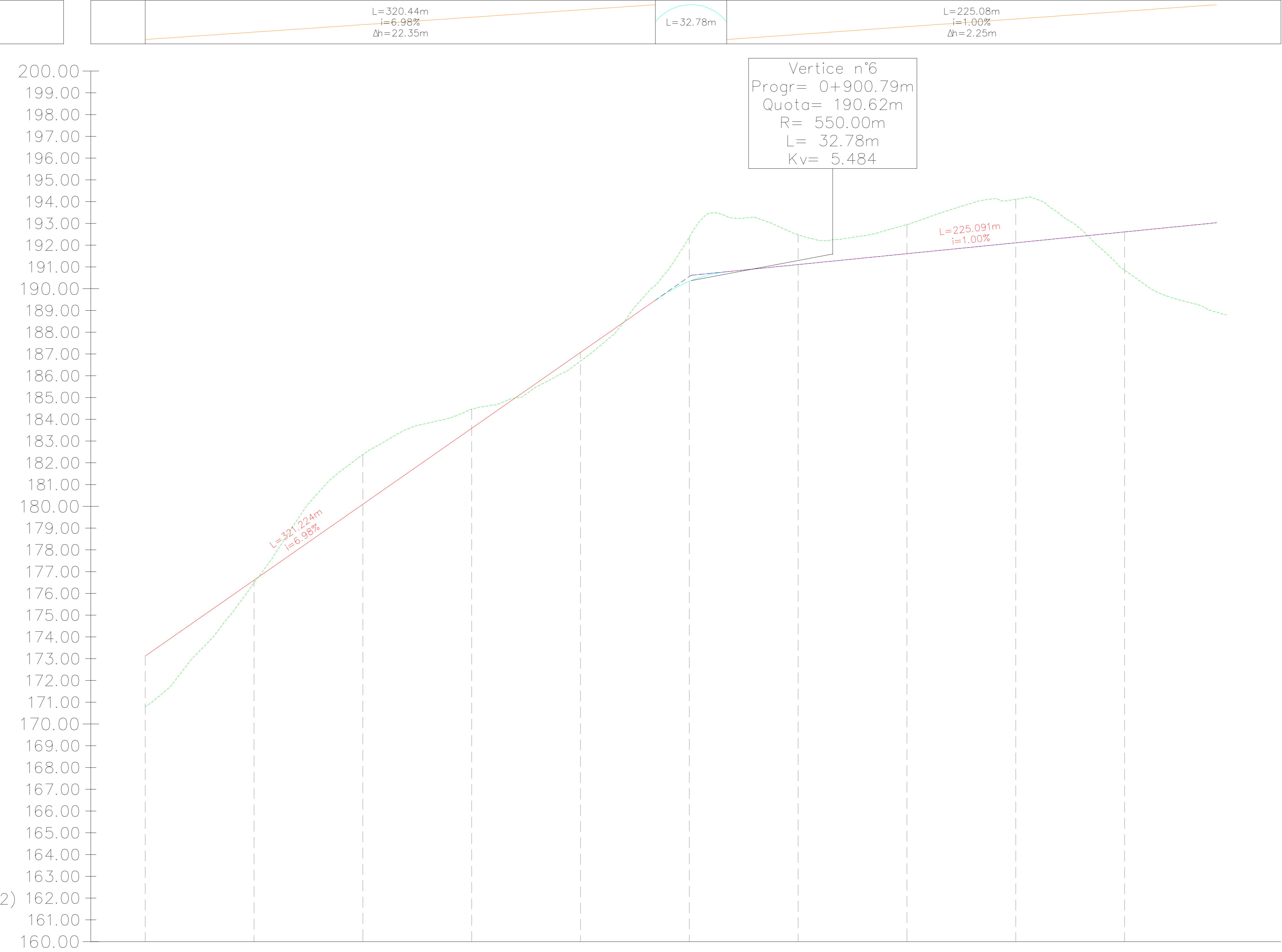

Profilo: Tracciato V02-V04 (2)
 Scala : 1000:100
 Q.Rif. : 160.00

NUMERO SEZIONE
DISTANZE PROGRESSIVE
DISTANZE PARZIALI
QUOTE PROGETTO
QUOTE TERRENO
DIFFERENZA QUOTE
ETTOMETRICHE
ANDAMENTO PLANIMETRICO

14	15	16	17	18	19	20	21	22	23
0+650.00	0+700.00	0+750.00	0+800.00	0+850.00	0+900.00	0+950.00	1+000.00	1+050.00	1+100.00
50,00	50,00	50,00	50,00	50,00	50,00	50,00	50,00	50,00	50,00
173,12	178,61	182,10	182,59	182,07	182,54	181,11	181,61	182,11	182,61
173,79	178,49	182,39	184,46	186,67	188,17	189,48	190,59	191,11	191,66
2,20	0,12	-2,29	-1,89	0,40	-2,00	-1,37	-1,24	-0,80	1,16
06	07	08	09	10	11	12	13	14	15
L=37,37m R=100,00m		L=185,57m			L=36,22m R=100,00m		L=260,42m		

01	19/02/2024	Seconda Emissione	A. Olsson	G. Altaro	P. Poloni
00	10/06/2022	Prima Emissione	A. Filippi	G. Altaro	P. Poloni
REV.	DATE	DESCRIPTION	PREPARED	CHECKED	APPROVED
PROJECT: IMPIANTO EOLICO SANLURI-SARDARA			FILE NAME: GRE.EEGC.D.25.IT.W.17279.00.003.01 - Profili longitudinali stradali		
CLASSIFICATION: PUBLIC		FORMAT: A0	SCALE: 1:1000	PLLOT SCALE: 1:1	SHEET: 3 di 16
UTILIZATION SCOPE: BASIC DESIGN		TITLE: Profili longitudinali stradali			
EGP VALIDATION					
EGP CODE					
GROUP FUNCTION TYPE OWNER COUNTRY TIC PLANT SYSTEM PROGRESSIVE REVISION					
GRE.EEGC.D.25.IT.W.17279.00.003.01					

LIVELLETTE

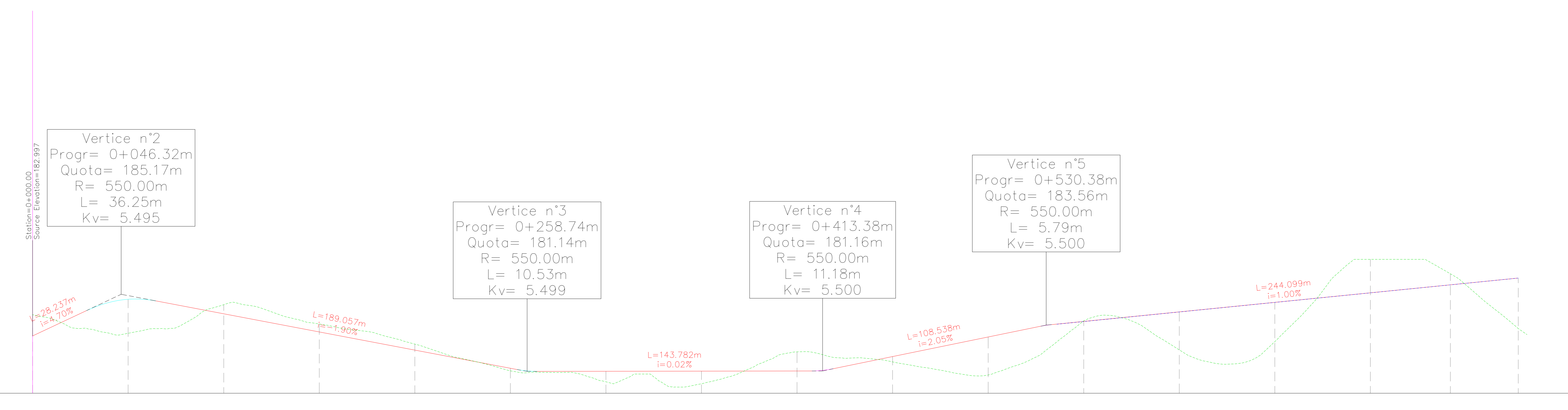
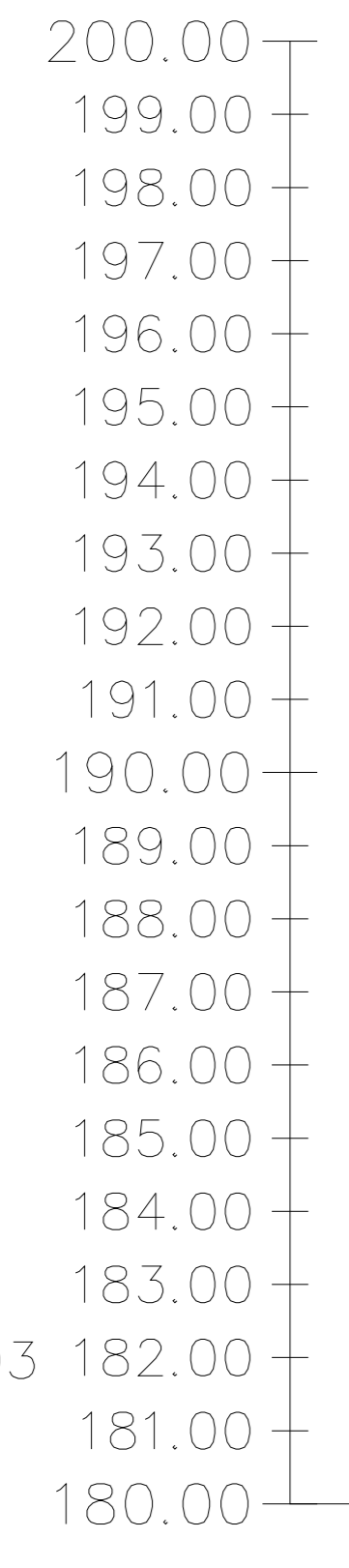
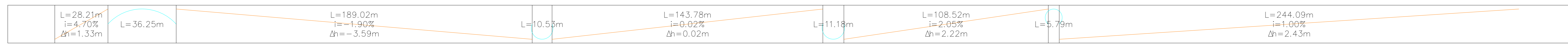

Profilo: Tracciato V03
Scala : 1000:100
Q.Rif. : 180.00

NUMERO SEZIONE
DISTANZE PROGRESSIVE
DISTANZE PARZIALI
QUOTE PROGETTO
QUOTE TERRENO
DIFFERENZA QUOTE
ETTOMETRICHE
ANDAMENTO PLANIMETRICO

1	2	3	4	5	6	7	8	9	10	11	12	13	14	15	16	17
0+000.00	0+050.00	0+100.00	0+150.00	0+200.00	0+250.00	0+300.00	0+350.00	0+400.00	0+450.00	0+500.00	0+550.00	0+600.00	0+650.00	0+700.00	0+750.00	0+777.00
	50,00	50,00	50,00	50,00	50,00	50,00	50,00	50,00	50,00	50,00	50,00	50,00	50,00	50,00	41,86	35,54
182,00	184,51	186,15	187,20	187,6	187,7	187,15	187,15	187,16	187,32	187,34	187,9	188,16	188,15	188,25	188,67	188,68
184,17	185,14	186,61	187,62	187,57	187,17	186,60	186,69	186,16	186,64	186,96	187,9	188,17	188,19	188,10	188,25	188,18
-1,17	-1,37	-0,46	-0,42	-0,37	0,04	0,55	0,66	-1,00	0,69	1,99	-0,01	1,99	-2,05	-1,75	-0,59	
00		01		02		03		04		05		06		07		07
Lr=275,18m			L=204,17m R=120,00m					Lr=302,66m								

01	19/02/2024	Seconda Emissione	A. Osborn	G. Altaro	P. Polidò
00	10/06/2022	Prima Emissione	A. Filippi	G. Altaro	P. Polidò
REV.	DATE	DESCRIPTION	PREPARED	CHECKED	APPROVED
IMPIANTO EOLICO SANLURI-SARDARA					
FILE NAME: GRE.EEC.D.25.IT.W.17279.00.003.01 - Profili longitudinali stradali					
CLASSIFICATION:	PUBLIC	FORMAT:	A0	SCALE:	1:1000
UTILIZATION SCOPE:	BASIC DESIGN	TITLE:	Profili longitudinali stradali		
Engineering & Construction					
EGP VALIDATION					
VALIDATED BY:	EGP CODE				
VERIFIED BY:	GROUP	FUNCTION	TYPE	COUNTRY	PLANT
COORDINATORS:	GRE.EEC	D.25	ITW172790008301		

LIVELLETTA

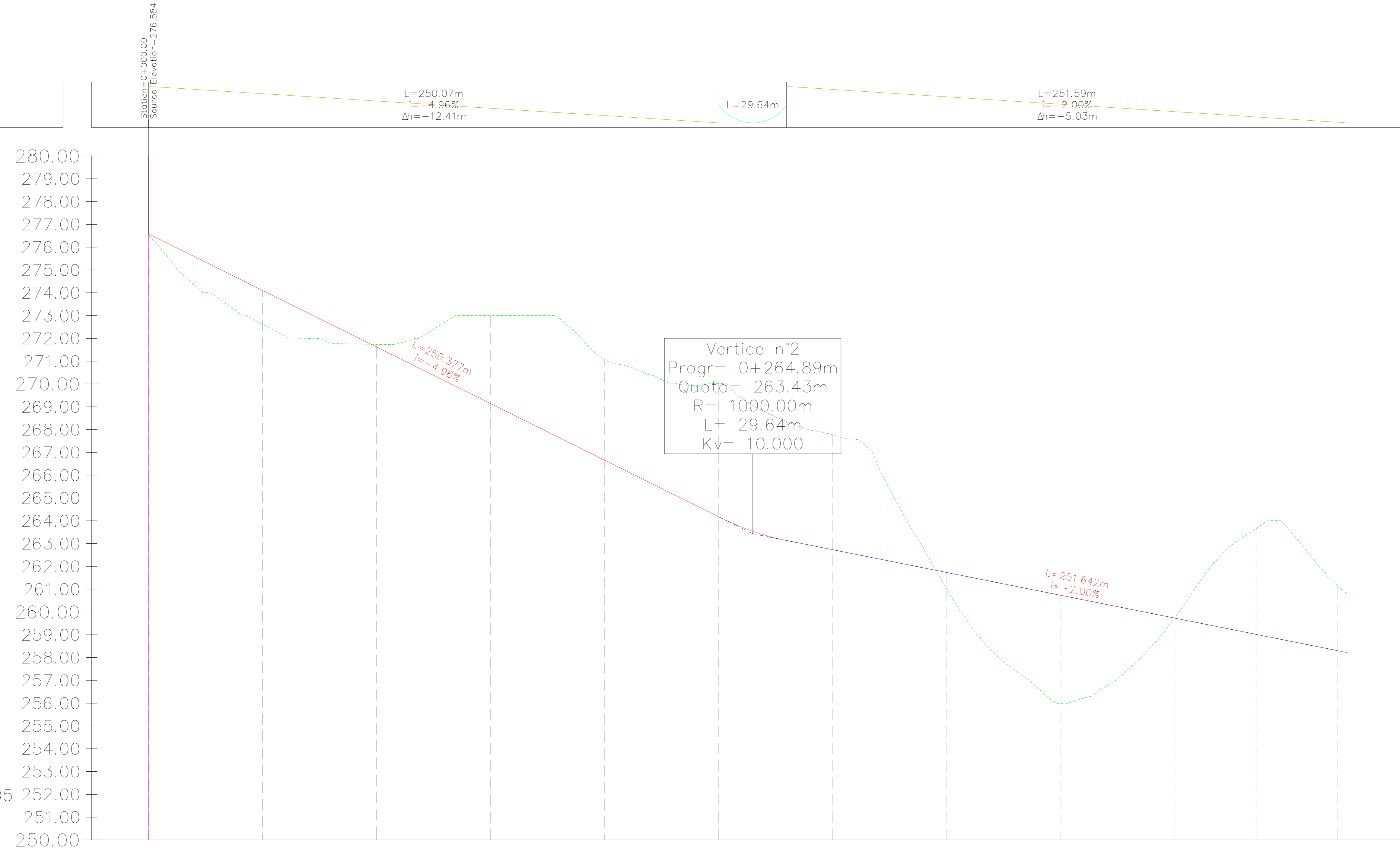

Profilo: Tracciato V05
 Scala : 1000:100
 Q.Rif. : 250.00

NUMERO SEZIONE	1	2	3	4	5	6	7	8	9	10	11	12
DISTANZE PROGRESSIVE	0+000,00	0+050,00	0+100,00	0+150,00	0+200,00	0+250,00	0+300,00	0+350,00	0+400,00	0+450,00	0+485,55	0+521,08
DISTANZE PARZIALI		50,00	50,00	50,00	50,00	50,00	50,00	50,00	50,00	50,00	35,55	35,53
QUOTE PROGETTO	276,59	274,10	271,62	269,14	266,65	264,17	261,68	259,19	256,71	254,22	251,73	249,24
QUOTE TERRENO	276,57	276,10	271,74	271,08	271,06	270,09	267,77	267,09	265,89	259,76	261,06	261,16
DIFFERENZA QUOTE	0,02	-1,99	-0,12	-1,94	-4,41	-5,92	-5,89	0,74	4,74	-0,07	-4,64	-0,05
ETTOMETRICHE	00		01		02		03		04		05	05
ANDAMENTO PLANIMETRICO												

01	19/02/2024	Seconda Emissione	A. Olsson	G. Altaro	P. Polisti
00	10/05/2022	Prima Emissione	A. Filippi	G. Altaro	P. Polisti
REV.	DATE	DESCRIPTION	PREPARED	CHECKED	APPROVED

PROJECT: **IMPIANTO EOLICO SANLURI-SARDARA**

FILE NAME: GRE.EEC.D.25.IT.W.17279.00.003.01 - Profili longitudinali stradali

CLASSIFICATION:	FORMAT:	SCALE:	PLLOT SCALE:	SHEET:
PUBLIC	A0	1:1000	1:1	2 di 16

UTILIZATION SCOPE: **BASIC DESIGN** TITLE: **Profili longitudinali stradali**

EGP VALIDATION

VALIDATED BY:	GROUP:	FUNCTION:	TYPE:	COUNTRY:	TCC:	PLANT:	SYSTEM:	PROGRESSIVE:	REVISION:
	GRE.EEC	D.25	ITW	17279	00	003	01		

EGP CODE: **08301**

LIVELLETTA

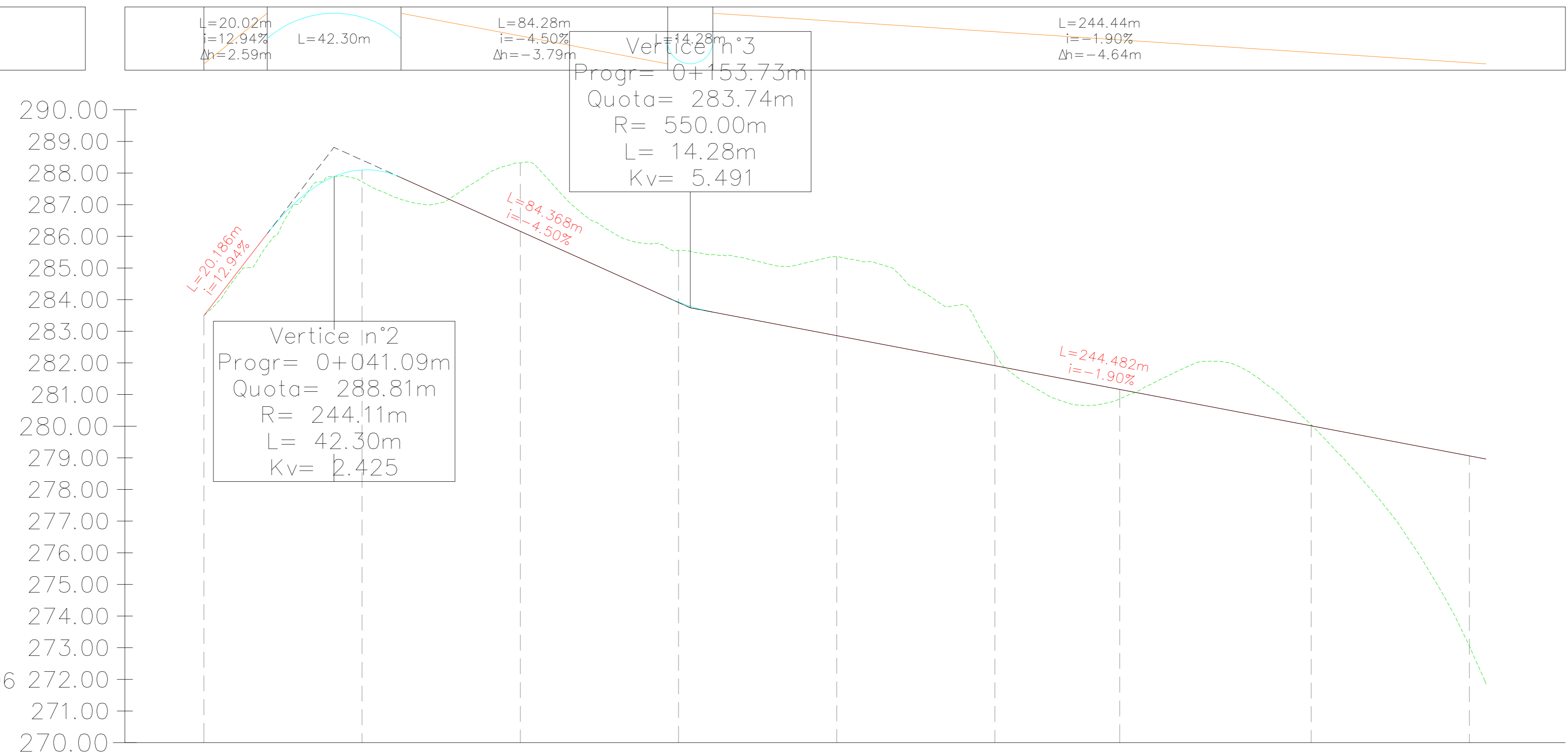

Profilo: Tracciato - V06
 Scala : 1000:100
 Q.Rif. : 270.00

NUMERO SEZIONE	1	2	3	4	5	6	7	8	9
DISTANZE PROGRESSIVE	0+000,00	0+050,00	0+100,00	0+150,00	0+200,00	0+250,00	0+300,00	0+350,00	0+400,00
DISTANZE PARZIALI		50,00	50,00	50,00	50,00	50,00	50,00	50,00	50,00
QUOTE PROGETTO	283,49	288,10	286,16	283,92	282,86	281,91	281,16	280,01	279,06
QUOTE TERRENO	283,49	287,12	286,17	285,16	285,36	282,11	280,86	280,04	272,16
DIFFERENZA QUOTE	0,00	0,98	-0,01	-1,24	-2,50	-4,19	-0,28	-0,03	6,89
ETTOMETRICHE	00	01	02	03	04	05	06	07	08
ANDAMENTO PLANIMETRICO	<p>L=18,26m R=50,00m Lr=17,80m</p> <p>L=104,52m R=80,00m Lr=16,03m</p> <p>Lr=248,05m</p>								

01	19/02/2024	Seconda Emissione	A. Olsson	G. Altaro	P. Poloni
00	10/06/2022	Prima Emissione	A. Filippi	G. Altaro	P. Poloni
REV.	DATE	DESCRIPTION	PREPARED	CHECKED	APPROVED

PROJECT: IMPIANTO EOLICO SANLURI-SARDARA

FILE NAME: GRE.EEC.D.25.IT.W.17279.00.003.01 - Profili longitudinali stradali

CLASSIFICATION: PUBLIC

FORMAT: A0

SCALE: 1:1000

FLUT SCALE: 1:1

SHEET: 6 di 16

UTILIZATION SCOPE: BASIC DESIGN

TITLE: Profili longitudinali stradali

EGP VALIDATION

GROUP: GRE.EEC

FUNCTION: D25

TYPE: ITW172790008301

EGP CODE

PLANT

SYSTEM

PROGRESSIVE

REVISION

LIVELLETTE

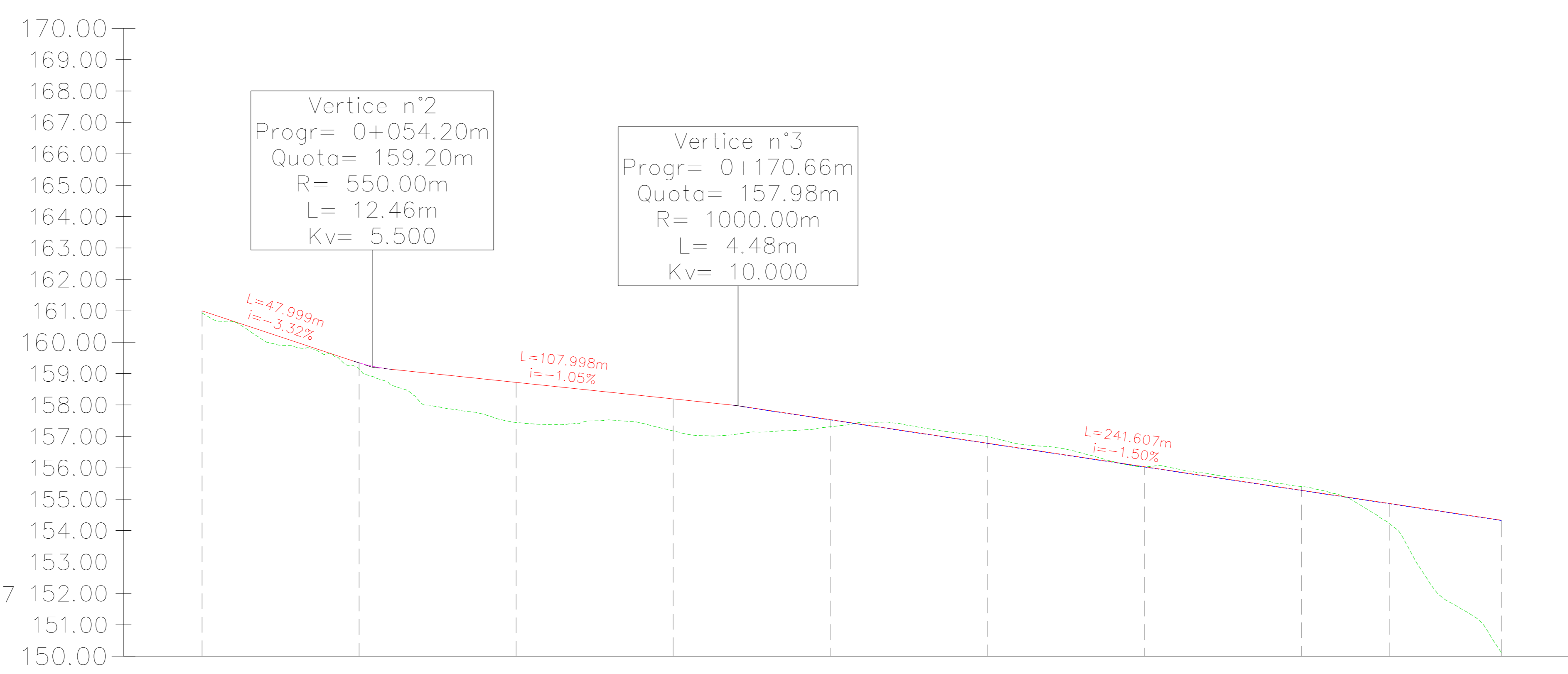
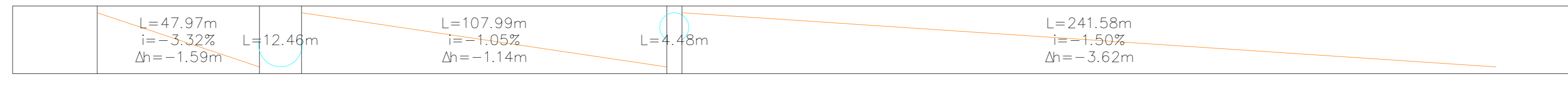

Profilo: Tracciato V07
 Scala : 1000:100
 Q.Rif. : 150.00

NUMERO SEZIONE
DISTANZE PROGRESSIVE
DISTANZE PARZIALI
QUOTE PROGETTO
QUOTE TERRENO
DIFFERENZA QUOTE
ETTOMETRICHE

1	2	3	4	5	6	7	8	9	10
0+000,00	0+050,00	0+100,00	0+150,00	0+200,00	0+250,00	0+300,00	0+350,00	0+398,54	0+411,98
50,00	50,00	50,00	50,00	50,00	50,00	50,00	50,00	28,15	35,54
161,00	158,20	157,15	156,10	155,05	154,00	152,95	151,90	150,85	149,80
160,97	158,18	157,13	156,08	155,03	153,98	152,93	151,88	150,83	149,78
0,03	0,02	0,02	0,02	0,02	0,02	0,02	0,02	0,02	0,02
0,00	0,00	0,00	0,00	0,00	0,00	0,00	0,00	0,00	0,00

ANDAMENTO PLANIMETRICO

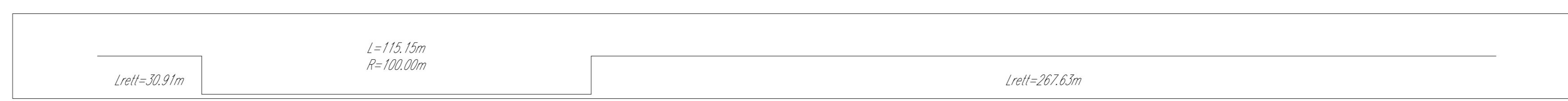

01	19/02/2024	Seconda Emissione	A. Olsson	G. Altaro	P. Poloni
00	10/06/2022	Prima Emissione	A. Filippi	G. Altaro	P. Poloni

Stantec
enel
 Green Power
 Engineering & Construction
EGP VALIDATION

PROJECT: **IMPIANTO EOLICO SANLURI-SARDARA**
 FILE NAME: GRE.EEC.D.25.IT.W.17279.00.003.01 - Profili longitudinali stradali
 CLASSIFICATION: **PUBLIC** FORMAT: **A0** SCALE: **1:1000** PLOT SCALE: **1:1** SHEET: **7** di **16**
 UTILIZATION SCOPE: **BASIC DESIGN** TITLE: **Profili longitudinali stradali**
 VALIDATED BY: []
 VERIFIED BY: []
 COLLABORATORS: GRE.EEC.D.25.IT.W.17279.00.003.01

LIVELLETTA

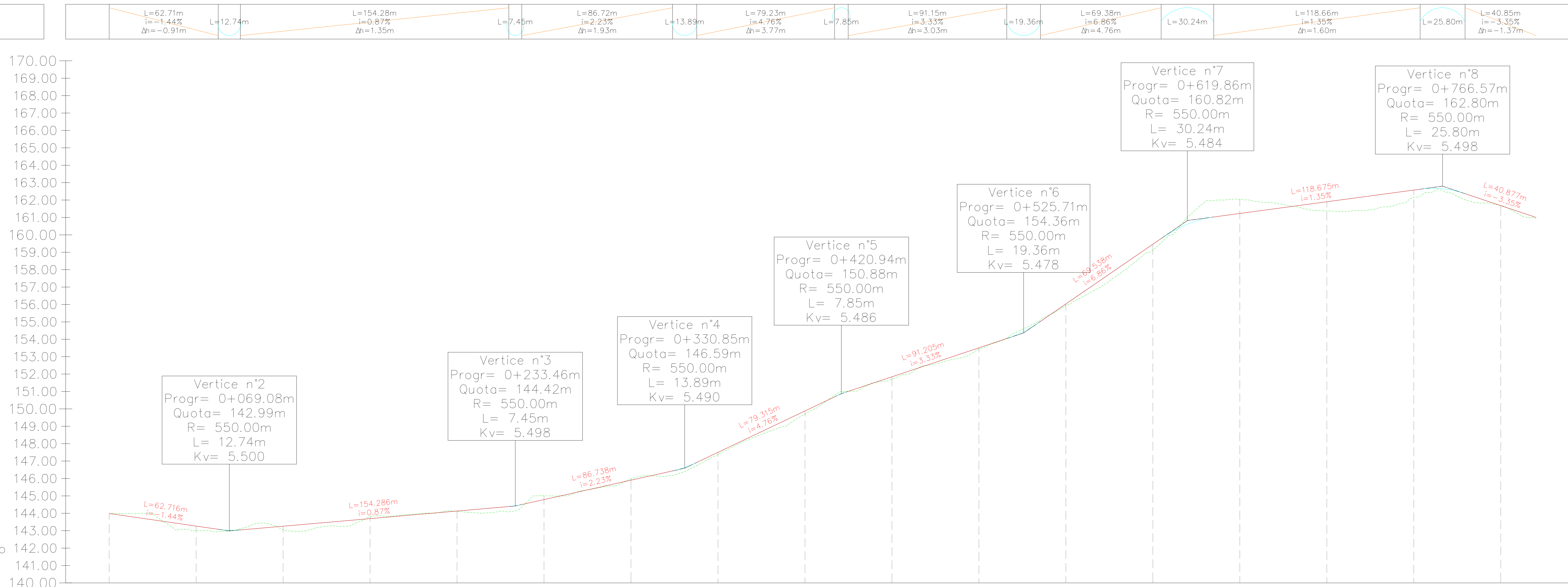

NUMERO SEZIONE
DISTANZE PROGRESSIVE
DISTANZE PARZIALI
QUOTE PROGETTO
QUOTE TERRENO
DIFFERENZA QUOTE
ETTOMETRICHE

1	2	3	4	5	6	7	8	9	10	11	12	13	14	15	16	17
0+000.00	0+050.00	0+100.00	0+150.00	0+200.00	0+250.00	0+300.00	0+350.00	0+400.00	0+450.00	0+500.00	0+550.00	0+600.00	0+650.00	0+700.00	0+750.00	0+800.00
50,00	50,00	50,00	50,00	50,00	50,00	50,00	50,00	50,00	50,00	50,00	50,00	50,00	50,00	50,00	50,00	50,00
142,99	142,99	142,99	142,99	144,51	144,79	145,90	145,90	146,88	151,84	151,51	156,01	158,16	161,51	161,80	162,80	161,80
142,99	142,99	142,99	142,99	144,42	145,01	145,99	145,99	146,71	151,71	151,44	155,96	158,12	162,84	161,86	162,15	161,80
0,00	0,00	0,00	0,00	0,00	0,00	0,00	0,00	0,00	0,00	0,00	0,00	0,00	0,00	0,00	0,00	0,00
00	01	02	03	04	05	06	07	08	09	10	11	12	13	14	15	16

ANDAMENTO PLANIMETRICO

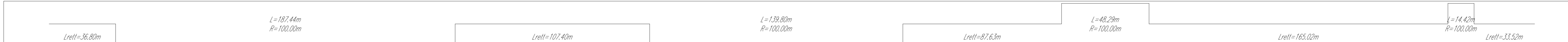

01	19/02/2024	Seconda Emissione	A. Osborn	G. Altaro	P. Polidò
00	10/06/2022	Prima Emissione	A. Filippi	G. Altaro	P. Polidò
REV.	DATE	DESCRIPTION	DRAWN	CHECKED	APPROVED

PROJECT: IMPIANTO EOLICO SANLURI-SARDARA

FILE NAME: GRE.EEC.D.25.IT.W.17279.00.003.01 - Profili longitudinali stradali

CLASSIFICATION:	PUBLIC	FORMAT:	A0	SCALE:	1:1000	PLLOT SCALE:	1:1	SHEET:	8 di 16
UTILIZATION SCOPE:	BASIC DESIGN	TITLE:	Profili longitudinali stradali						

EGP VALIDATION

VALIDATED BY:	GROUP:	FUNCTION:	TYPE:	COUNTRY:	TCC:	PLANT:	SYSTEM:	PROGRESSIVE:	REVISION:
VERIFIED BY:	GRE.EEC	D.25	ITW	17279	00	003	01		

EGP CODE: GRE.EEC.D.25.IT.W.17279.00.003.01

LIVELLETTA

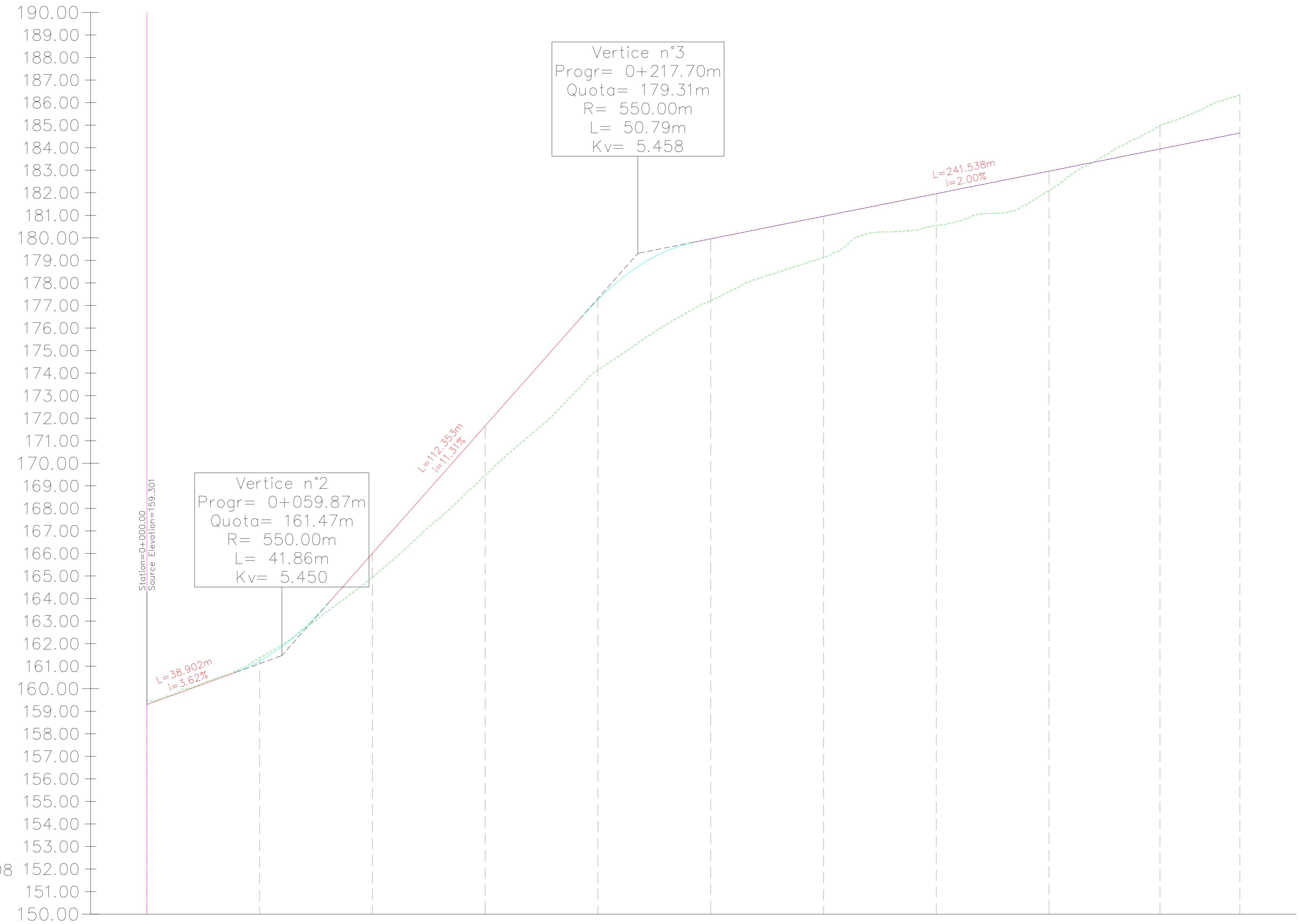
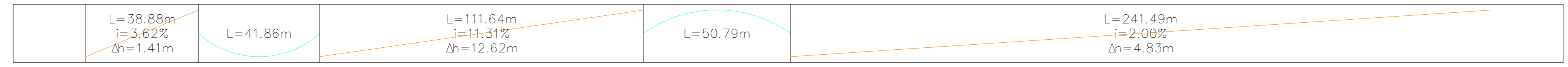

NUMERO SEZIONE
DISTANZE PROGRESSIVE
DISTANZE PARZIALI
QUOTE PROGETTO
QUOTE TERRENO
DIFFERENZA QUOTE
ETTOMETRICHE
ANDAMENTO PLANIMETRICO

	1	2	3	4	5	6	7	8	9	10	11
DISTANZE PROGRESSIVE	0+000.00	0+059.87	0+101.73	0+163.37	0+217.70	0+268.49	0+319.28	0+370.07	0+420.86	0+471.65	0+484.44
DISTANZE PARZIALI		50,00	50,00	50,00	50,00	50,00	50,00	50,00	50,00	49,21	35,43
QUOTE PROGETTO	159,30	161,47	166,01	171,06	172,76	178,96	180,96	181,96	182,96	183,94	184,05
QUOTE TERRENO	159,30	161,47	164,86	168,47	174,14	172,21	178,11	182,54	182,10	184,09	186,17
DIFFERENZA QUOTE	0,00	-0,04	1,15	2,59	2,62	2,75	2,85	1,42	0,86	0,04	-1,08
ETTOMETRICHE	00		01		02		03		04		04
ANDAMENTO PLANIMETRICO	L=86,06m R=100,00m		L=192,84m								

01	19/02/2024	Seconda Emissione	A. Olsson	G. Altaro	P. Poloni
00	10/06/2022	Prima Emissione	A. Filippi	G. Altaro	P. Poloni

REV.	DATE	DESCRIPTION	PREPARED	CHECKED	APPROVED

PROJECT: IMPIANTO EOLICO SANLURI-SARDARA

FILE NAME: GRE.ECC.D.25.IT.W.17279.00.003.01 - Profili longitudinali stradali

CLASSIFICATION:	FORMAT:	SCALE:	PLANT SCALE:	SHEET:
PUBLIC	A0	1:1000	1:1	9 di 16

UTILIZATION SCOPE: BASIC DESIGN

TITLE: Profili longitudinali stradali

EGP VALIDATION

VALIDATED BY:	GROUP:	FUNCTION:	TYPE:	COUNTRY:	TIC:	PLANT:	SYSTEM:	PROGRESSIVE:	REVISION:
	GRE.ECC.	D25	ITW1727900008301						

LIVELLETTA

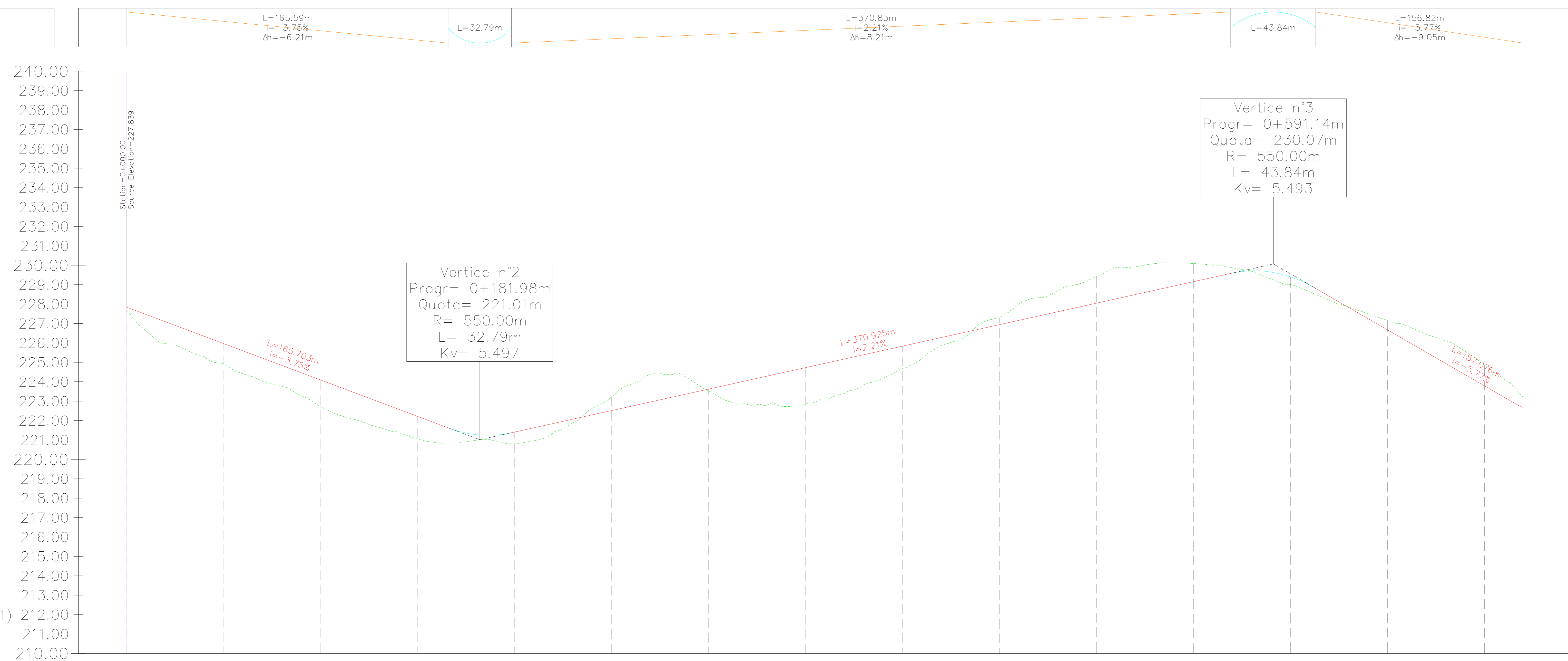

Profilo: Tracciato - V09 (1)
 Scala : 1000:100
 Q.Rif. : 210.00

NUMERO SEZIONE	1	2	3	4	5	6	7	8	9	10	11	12	13	14	15
DISTANZE PROGRESSIVE	0+000.00	0+050.00	0+100.00	0+150.00	0+200.00	0+250.00	0+300.00	0+350.00	0+400.00	0+450.00	0+500.00	0+550.00	0+600.00	0+650.00	0+700.00
DISTANZE PARZIALI		50,00	50,00	50,00	50,00	50,00	50,00	50,00	50,00	50,00	50,00	50,00	50,00	50,00	50,00
QUOTE PROGETTO	227,84	228,96	229,09	229,21	229,41	229,52	229,62	229,71	229,84	229,94	229,95	229,96	229,97	229,97	229,97
QUOTE TERRENO	227,88	228,91	229,71	229,86	229,79	229,51	229,59	229,65	229,68	229,78	229,41	229,09	229,01	228,76	228,65
DIFFERENZA QUOTE	0,04	0,05	0,38	0,35	0,62	0,01	0,03	0,06	0,16	0,16	0,54	0,87	0,96	0,21	0,32
ETTOMETRICHE	00		01		02		03		04		05		06		07
ANDAMENTO PLANIMETRICO															

01	19/02/2024	Seconda Emissione	A. Osborn	G. Altaro	P. Polidori
00	10/06/2022	Prima Emissione	A. Filippi	G. Altaro	P. Polidori
REV.	DATE	DESCRIZIONE	PREPARED	CHECKED	APPROVED

PROJECT: **IMPIANTO EOLICO SANLURI-SARDARA**

FILE NAME: GRE.EEC.D.25.IT.W.17279.00.003.01 - Profili longitudinali stradali

CLASSIFICATION: **PUBLIC** | FORMAT: **A0** | SCALE: **1:1000** | PLOT SCALE: **1:1** | SHEET: **10 di 16**

UTILIZATION SCOPE: **BASIC DESIGN** | TITLE: **Profili longitudinali stradali**

EGP VALIDATION

VALIDATED BY	GROUP	FUNCTION	TYPE	COUNTRY	TIC	PLANT	SYSTEM	PROGRESSIVE	REVISION
VERIFIED BY	GRE.EEC	D.25	ITW172790008301						

LIVELLETTA

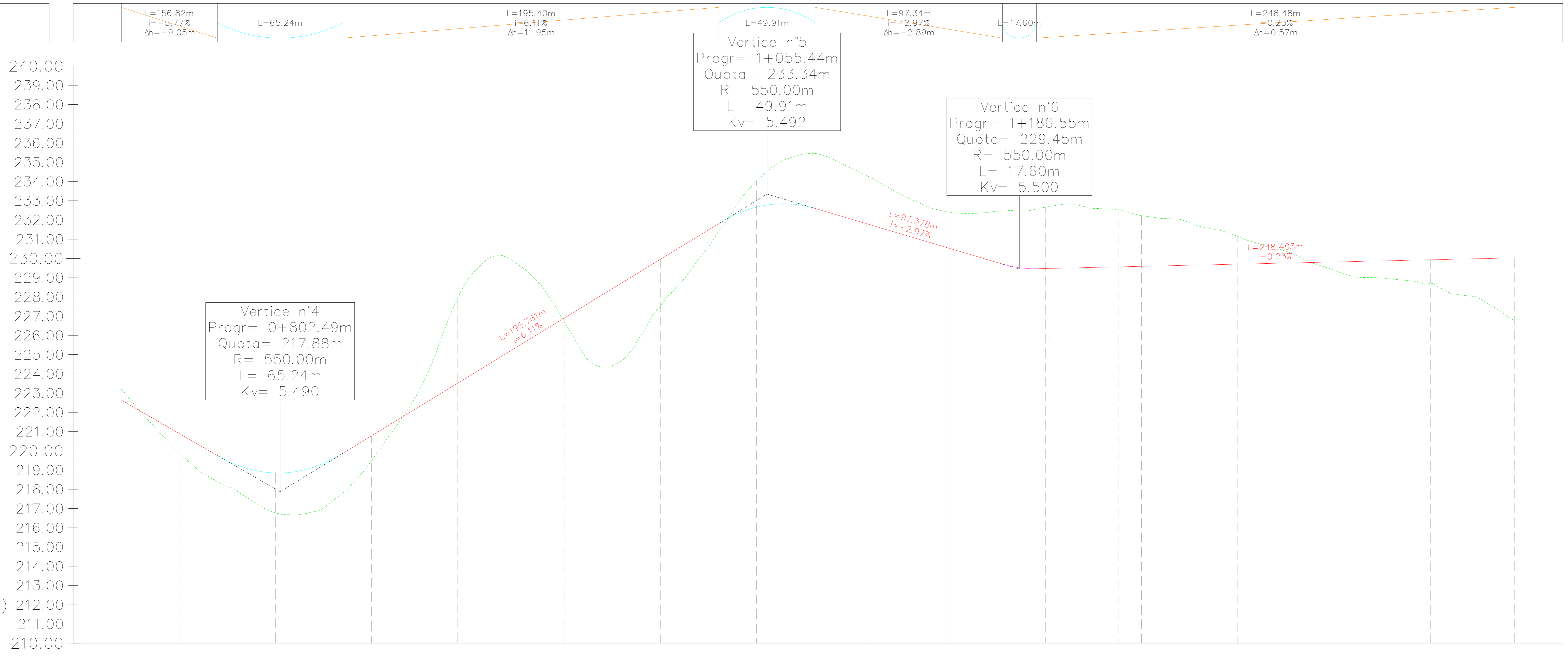

Profilo: Tracciato - V09 (2)
Scala : 1000:100
Q.Rif. : 210.00

NUMERO SEZIONE
DISTANZE PROGRESSIVE
DISTANZE PARZIALI
QUOTE PROGETTO
QUOTE TERRENO
DIFFERENZA QUOTE
ETTOMETRICHE
ANDAMENTO PLANIMETRICO

	16	17	18	19	20	21	22	23	24	25	26	27	28	29	30	31
DISTANZE PROGRESSIVE	0+800.00	0+850.00	0+900.00	0+949.49	0+1000.00	1+000.00	1+050.00	1+100.00	1+150.00	1+200.00	1+231.81	1+243.98	1+300.00	1+350.00	1+400.00	1+448.81
DISTANZE PARZIALI		50.00	50.00	44.49	55.51	50.00	50.00	60.00	40.00	50.00	31.81	12.17	50.00	50.00	50.00	48.81
QUOTE PROGETTO	219.80	219.85	220.78	221.50	226.80	229.85	232.66	231.72	230.57	229.40	229.56	229.59	229.70	229.87	229.81	229.07
QUOTE TERRENO	219.80	218.78	219.49	217.87	226.72	227.52	234.04	234.16	232.41	232.06	232.54	232.23	231.14	229.39	228.70	226.74
DIFFERENZA QUOTE	0.00	0.07	1.29	4.63	0.08	2.33	-1.37	-2.44	-1.88	-2.59	-2.97	-2.64	-1.44	0.48	1.11	3.33
ETTOMETRICHE	07	08	09	09	10	10	11	11	12	12	13	13	14	14	14	14
ANDAMENTO PLANIMETRICO	L=67.64m R=100.00m		L=98.41m		L=22.87m R=50.00m		L=122.80m R=106.10m		L=242.88m		L=242.88m		L=242.88m		L=242.88m	

01	19/02/2024	Seconda Emissione	A. Olsson	G. Altaro	P. Poloni
00	10/05/2022	Prima Emissione	A. Filippi	G. Altaro	P. Poloni
REV.	DATE	DESCRIPTION	PREPARED	CHECKED	APPROVED
PROJECT: IMPIANTO EOLICO SANLURI-SARDARA			EGP CODE		
FILE NAME: GRE.EEC.D.25.IT.W.17279.00.003.01 - Profili longitudinali stradali			EGP CODE		
CLASSIFICATION: PUBLIC	FORMAT: A0	SCALE: 1:1000	PLANT SCALE: 1:1	SHEET: 11 di 16	
UTILIZATION SCOPE: BASIC DESIGN			TITLE: Profili longitudinali stradali		
EGP VALIDATION			EGP CODE		
VALIDATED BY:	GROUP:	FUNCTION:	TYPE:	COUNTRY:	PLANT:
VERIFIED BY:	GROUP:	FUNCTION:	TYPE:	COUNTRY:	PLANT:
COORDINATORS:	GROUP:	FUNCTION:	TYPE:	COUNTRY:	PLANT:
GRE.EEC.D.25.IT.W.17279.00.003.01					

LIVELLETTA

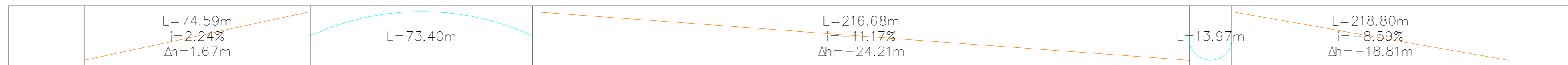

290.00
289.00
288.00
287.00
286.00
285.00
284.00
283.00
282.00
281.00
280.00
279.00
278.00
277.00
276.00
275.00
274.00
273.00
272.00
271.00
270.00
269.00
268.00
267.00
266.00
265.00
264.00
263.00
262.00
261.00
260.00
259.00
258.00
257.00
256.00
255.00
254.00
253.00
252.00
251.00
249.00
248.00
247.00
246.00
245.00
244.00
243.00
242.00
241.00
240.00
239.00
238.00

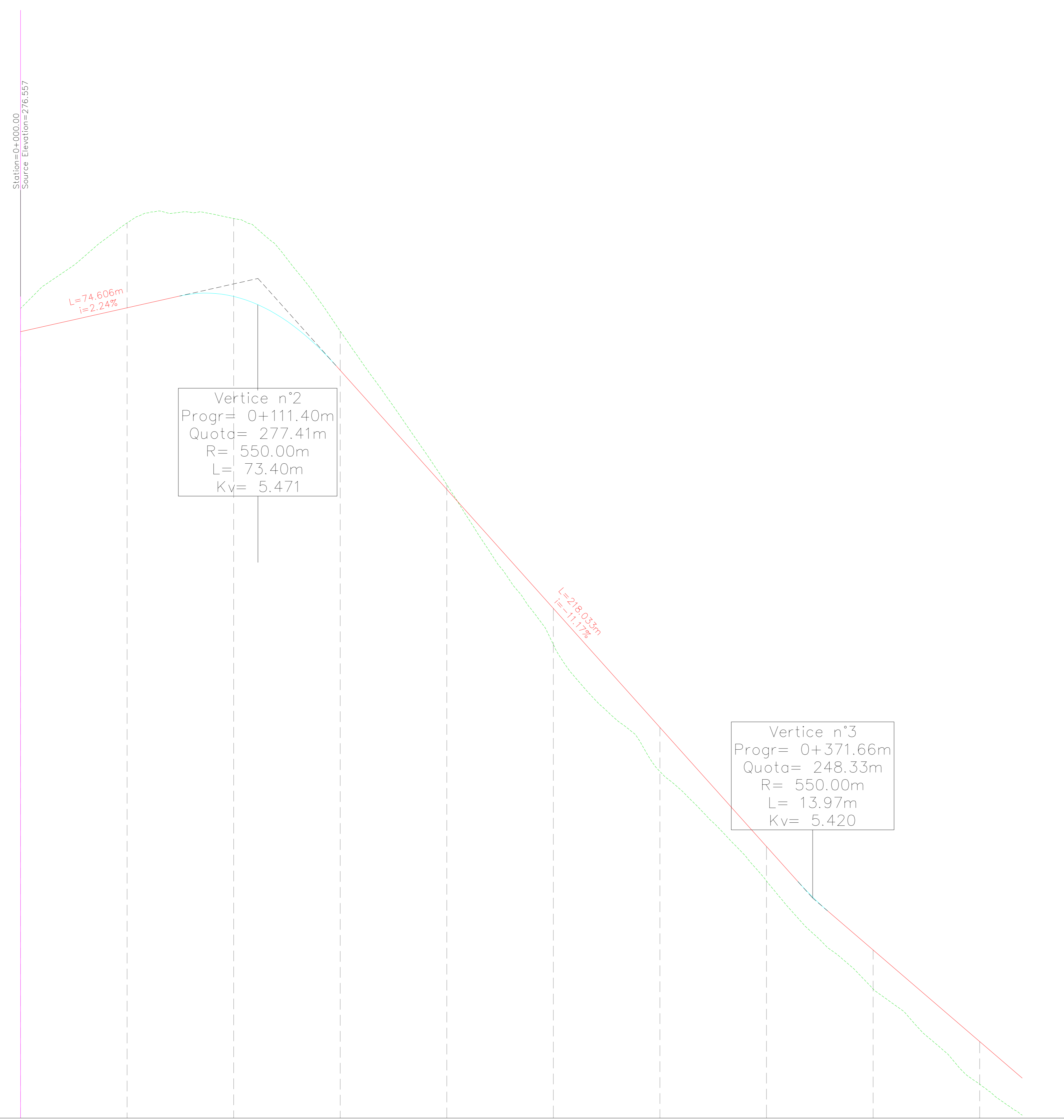

Profilo: Tracciato V10240.00
Scala : 1000:100
Q.Rif. : 238.00

NUMERO SEZIONE
DISTANZE PROGRESSIVE
DISTANZE PARZIALI
QUOTE PROGETTO
QUOTE TERRENO
DIFFERENZA QUOTE
ETTOMETRICHE
ANDAMENTO PLANIMETRICO

1	2	3	4	5	6	7	8	9	10
0+000.00	0+050.00	0+100.00	0+150.00	0+200.00	0+250.00	0+300.00	0+350.00	0+400.00	0+450.00
50,00	50,00	50,00	50,00	50,00	50,00	50,00	50,00	50,00	50,00
276,55	276,55	276,56	272,59	268,51	264,30	260,01	255,75	251,59	247,59
276,55	276,55	276,55	274,51	272,51	268,27	264,01	259,75	255,59	251,59
-0,00	-0,00	-0,00	-1,94	-4,02	-6,10	-8,17	-10,25	-12,33	-14,41
0,00	0,00	0,00	0,00	0,00	0,00	0,00	0,00	0,00	0,00
L=51,62m R=100,00m		L=22,20m R=90,00m		L=198,94m		L=22,20m R=90,00m		L=328,71m	

01	19/02/2024	Seconda Emissione	A. Olsson	G. Altaro	P. Poloni
00	10/05/2022	Prima Emissione	A. Filippi	G. Altaro	P. Poloni
REV.	DATE	DESCRIPTION	PREPARED	CHECKED	APPROVED
PROJECT: IMPIANTO EOLICO SANLURI-SARDARA					
FILE NAME: GRE.EEC.D.25.IT.W.17279.00.003.01 - Profili longitudinali stradali					
CLASSIFICATION: PUBLIC		FORMAT: A0	SCALE: 1:1000	PLLOT SCALE: 1:1	SHEET: 12 di 16
UTILIZATION SCOPE: BASIC DESIGN		TITLE: Profili longitudinali stradali			
EGP VALIDATION					
EGP CODE					
GROUP FUNCTION TYPE USER COUNTRY TIC PLANT SYSTEM PROGRESSIVE REVISION					
GRE.EEC.D.25.IT.W.17279.00.003.01					

LIVELLETTA

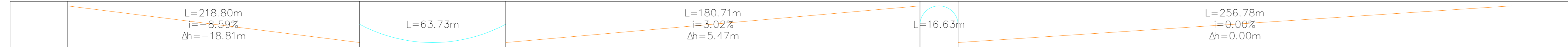

271.00
270.00
269.00
268.00
267.00
266.00
265.00
264.00
263.00
262.00
261.00
260.00
259.00
258.00
257.00
256.00
255.00
254.00
253.00
252.00
251.00
250.00
249.00
248.00
247.00
246.00
245.00
244.00
243.00
242.00
241.00
240.00
239.00
238.00
237.00
236.00
235.00
234.00
233.00
232.00
231.00
229.00
228.00
227.00
226.00
225.00
224.00
223.00
222.00
221.00
220.00

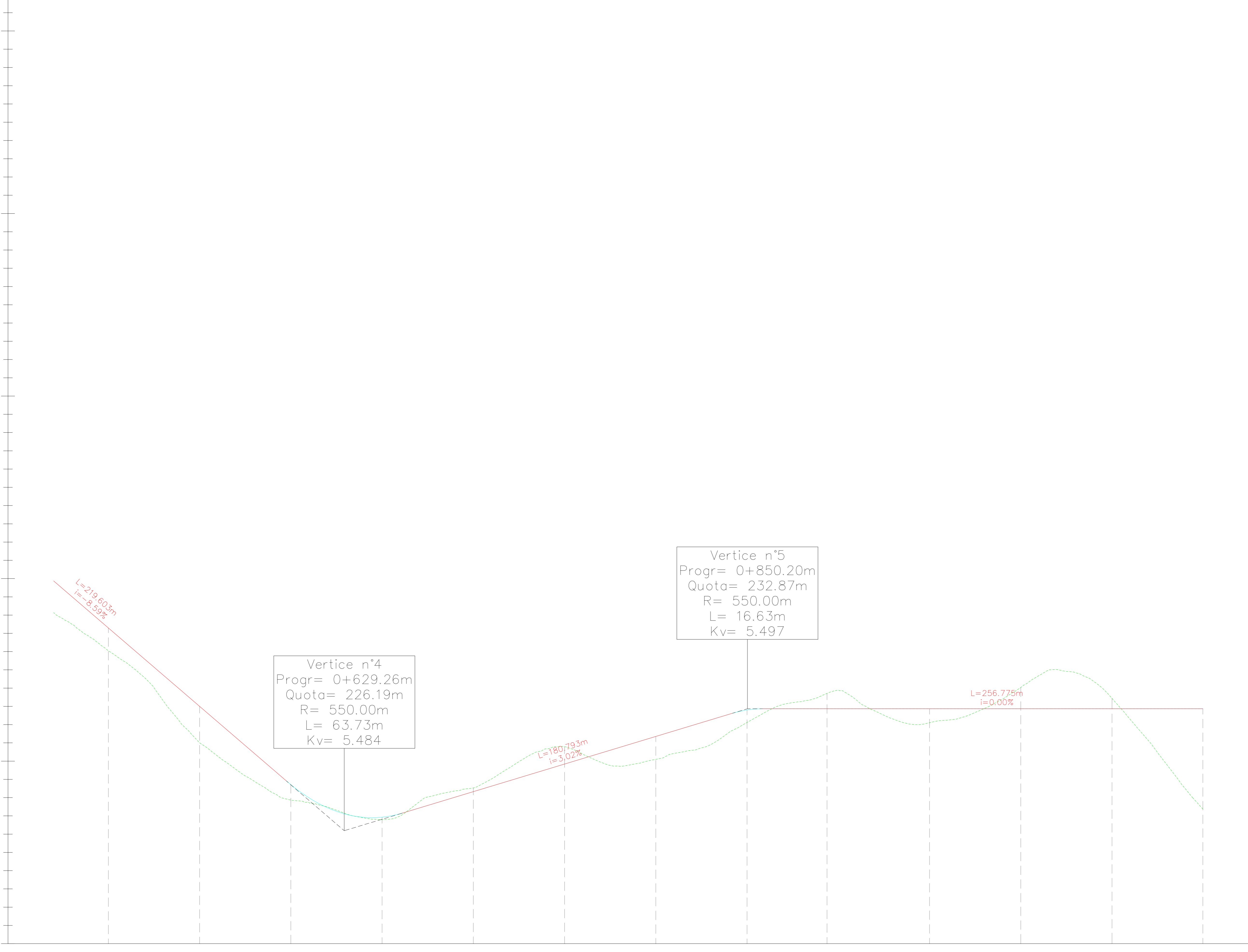

Profilo: Tracciato V10 (1)
Scala : 1000:100
Q.Rif. : 220.00

NUMERO SEZIONE
DISTANZE PROGRESSIVE
DISTANZE PARZIALI
QUOTE PROGETTO
QUOTE TERRENO
DIFFERENZA QUOTE
ETTOMETRICHE
ANDAMENTO PLANIMETRICO

11	12	13	14	15	16	17	18	19	20	21	22	23
0+000.00	0+050.00	0+100.00	0+150.00	0+200.00	0+250.00	0+300.00	0+350.00	0+400.00	0+450.00	0+500.00	0+550.00	0+600.00
50.00	50.00	50.00	50.00	50.00	50.00	50.00	50.00	43.80	56.20	50.00	50.00	49.79
212.50	211.00	208.71	206.87	204.57	202.64	200.10	197.82	195.77	193.90	192.20	190.64	189.17
236.05	231.00	227.97	226.80	225.57	224.29	222.97	221.62	220.21	218.75	217.24	215.68	214.17
1.25	2.00	0.84	0.17	-0.20	-0.55	-0.85	-1.26	-1.69	-2.04	-2.37	-2.66	-2.91
04	05	06	07	08	09	10	11	12	13	14	15	16
L=328.71m			L=153.69m			L=12.46m R=100.00m			L=239.53m			

01	19/02/2024	Seconda Emissione	A. Olsson	G. Altaro	P. Polini
00	10/05/2022	Prima Emissione	A. Filippi	G. Altaro	P. Polini
REV.	DATE	DESCRIPTION	PREPARED	CHECKED	APPROVED
PROJECT: IMPIANTO EOLICO SANLURI-SARDARA			EGP CODE		
FILE NAME: GRE.EEC.D.25.IT.W.17279.00.003.01 - Profili longitudinali stradali			SHEET: 13 di 16		
CLASSIFICATION: PUBLIC			FORMAT: A0	SCALE: 1:1000	PLLOT SCALE: 1:1
UTILIZATION SCOPE: BASIC DESIGN			TITLE: Profili longitudinali stradali		
EGP VALIDATION			EGP CODE		
VALIDATED BY:	GROUP:	FUNCTION:	TYPE:	COUNTRY:	PLANT:
VERIFIED BY:	GROUP:	FUNCTION:	TYPE:	COUNTRY:	PLANT:
COLLABORATORS:	GROUP:	FUNCTION:	TYPE:	COUNTRY:	PLANT:
GRE.EEC.D.25.IT.W.17279.00.003.01					

LIVELLETTA

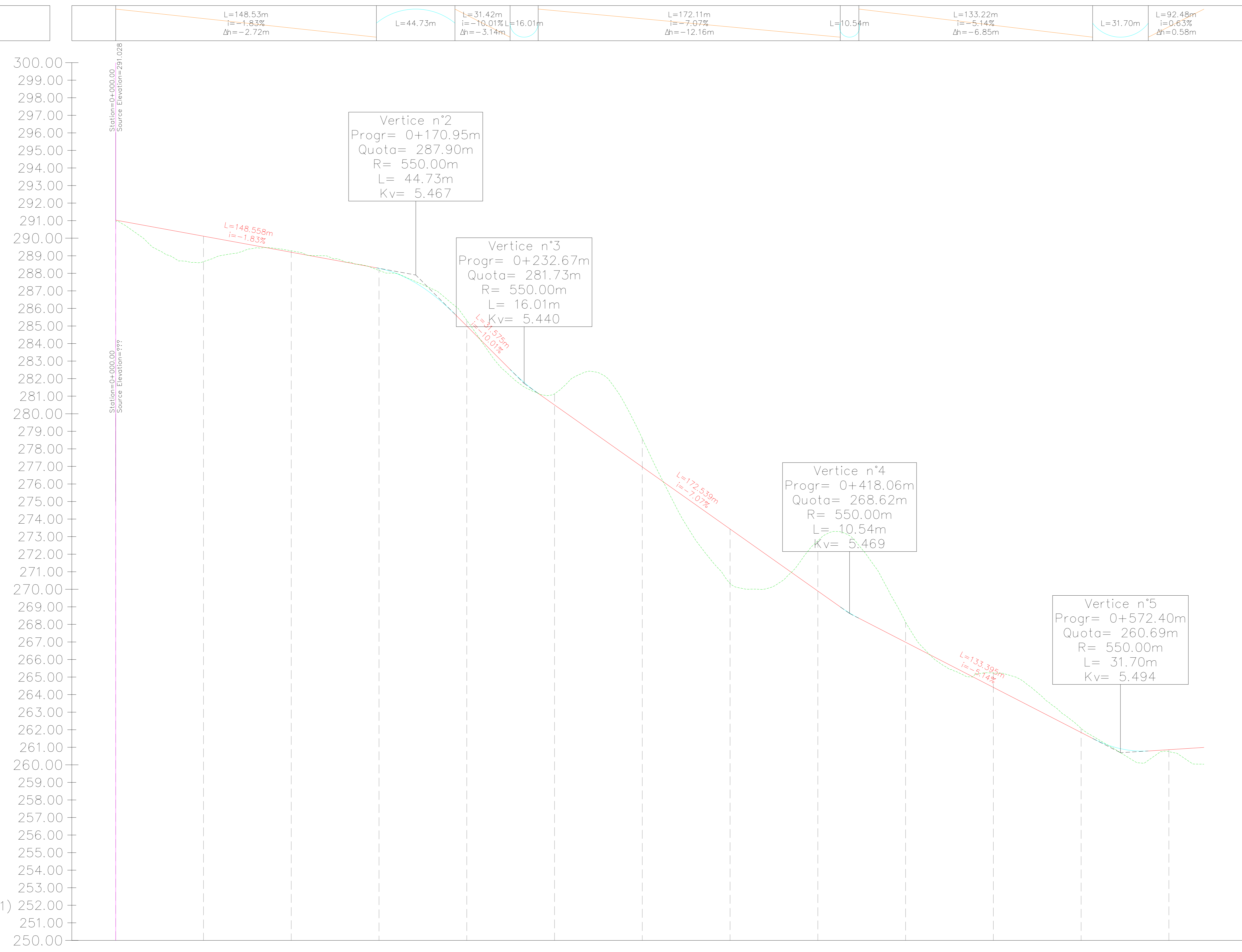

NUMERO SEZIONE
DISTANZE PROGRESSIVE
DISTANZE PARZIALI
QUOTE PROGETTO
QUOTE TERRENO
DIFFERENZA QUOTE
ETTOMETRICHE
ANDAMENTO PLANIMETRICO

1	2	3	4	5	6	7	8	9	10	11	12	13
0+00.00	0+50.00	0+100.00	0+150.00	0+200.00	0+250.00	0+300.00	0+350.00	0+400.00	0+450.00	0+500.00	0+550.00	0+600.00
50,00	50,00	50,00	50,00	50,00	50,00	50,00	50,00	50,00	50,00	50,00	50,00	50,00
291,07	288,11	289,37	288,38	288,00	288,50	276,97	275,61	269,87	268,88	264,41	261,24	260,67
288,07	288,16	288,28	288,16	288,47	281,11	278,09	278,01	272,28	268,11	263,21	262,08	260,18
0,00	1,05	0,00	0,12	0,37	0,61	1,62	2,00	7,59	1,15	0,60	0,64	0,69
00	01	02	03	04	05	06	07	08	09	10	11	12
L=203,37m		L=42,28m R=93,49m		L=23,12m R=69,32m		L=94,52m		L=25,52m R=69,32m		L=93,25m		L=158,42m

01	19/02/2024	Seconda Emissione	A. Olsson	G. Altaro	P. Polidò
00	10/05/2022	Prima Emissione	A. Filippi	G. Altaro	P. Polidò
REV.	DATE	DESCRIPTION	PREPARED	CHECKED	APPROVED
IMPIANTO EOLICO SANLURI-SARDARA					
FILE NAME: GRE.EEC.D.25.IT.W.17279.00.003.01 - Profili longitudinali stradali					
CLASSIFICATION: PUBLIC		FORMAT: A0	SCALE: 1:1000	PLOT SCALE: 1:1	SHEET: 14 di 16
UTILIZATION SCOPE: BASIC DESIGN					
TITLE: Profili longitudinali stradali					
EGP VALIDATION					
VALIDATED BY: _____					
VERIFIED BY: _____					
COLLABORATORS: GRE.EEC.D.25.IT.W.17279.00.003.01					

LIVELLETTA

300.00
299.00
298.00
297.00
296.00
295.00
294.00
293.00
292.00
291.00
290.00
289.00
288.00
287.00
286.00
285.00
284.00
283.00
282.00
281.00
280.00
279.00
278.00
277.00
276.00
275.00
274.00
273.00
272.00
271.00
270.00
269.00
268.00
267.00
266.00
265.00
264.00
263.00
262.00
261.00
260.00
259.00
258.00
257.00
256.00
255.00
254.00
253.00
252.00
251.00
250.00

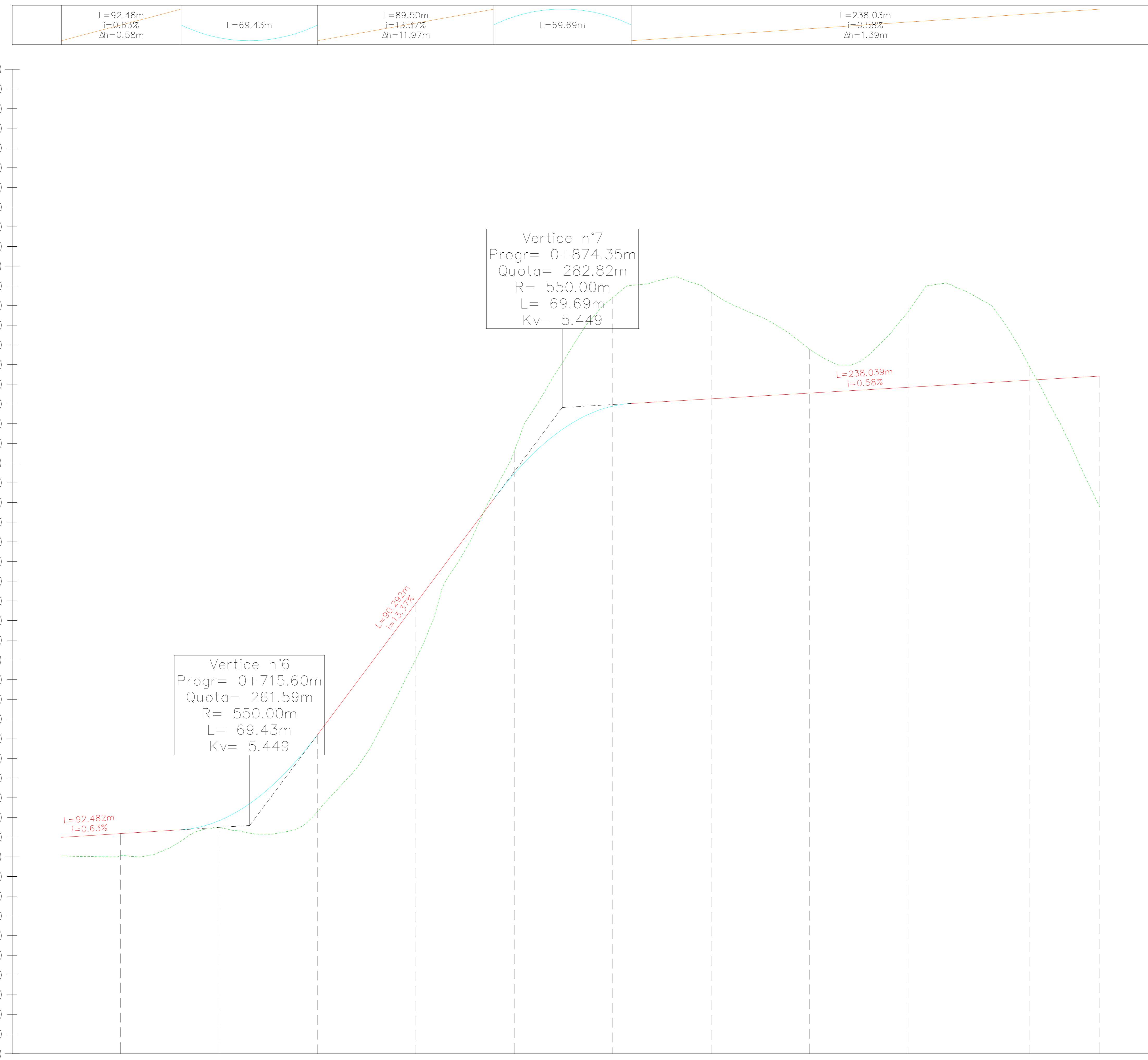

Profilo: Tracciato - V11 (2)
Scala : 1000:100
Q.Rif. : 250.00

NUMERO SEZIONE
DISTANZE PROGRESSIVE
DISTANZE PARZIALI
QUOTE PROGETTO
QUOTE TERRENO
DIFFERENZA QUOTE
ETTOMETRICHE
ANDAMENTO PLANIMETRICO

	14	15	16	17	18	19	20	21	22	23	24	
DISTANZE PROGRESSIVE	0+000.00	0+100.00	0+200.00	0+300.00	0+400.00	0+500.00	0+600.00	0+700.00	0+800.00	0+900.00	0+1000.00	
DISTANZE PARZIALI		50,00	50,00	50,00	50,00	50,00	50,00	50,00	50,00	61,88	35,49	
QUOTE PROGETTO		261,18	261,00	262,19	272,88	279,47	282,89	281,28	282,25	282,65	284,21	284,41
QUOTE TERRENO		260,08	261,01	262,29	270,04	280,00	283,41	280,67	282,28	282,67	284,08	277,71
DIFFERENZA QUOTE		1,10	-0,01	-0,10	2,84	-1,14	-0,52	0,61	-0,03	-0,02	0,13	6,70
ETTOMETRICHE	06	07	08	09	10	11	11	11	11	11	11	
ANDAMENTO PLANIMETRICO	L=4,58m R=49,32m Lr=138,42m			L=48,16m R=69,32m			Lr=241,88m					

01	19/02/2024	Seconda Emissione	A. Olsson	G. Altaro	P. Polidori
00	10/06/2022	Prima Emissione	A. Filiberti	G. Altaro	P. Polidori
REV.	DATE	DESCRIPTION	PREPARED	CHECKED	APPROVED
IMPIANTO EOLICO SANLURI-SARDARA					
FILE NAME: GRE.EEC.D.25.IT.W.17279.00.003.01 - Profili longitudinali stradali					
CLASSIFICATION:	PUBLIC	FORMAT:	A0	SCALE:	1:1000
UTILIZATION SCOPE:	BASIC DESIGN	PLANT:	1:1	FLUT SCALE:	1:1
TITLE: Profili longitudinali stradali					
SHEET: 15 di 16					
EGP VALIDATION					
VERIFIED BY: []					
COLLABORATORS: GRE.EEC.D.25.IT.W.17279.00.003.01					

LIVELLETTA

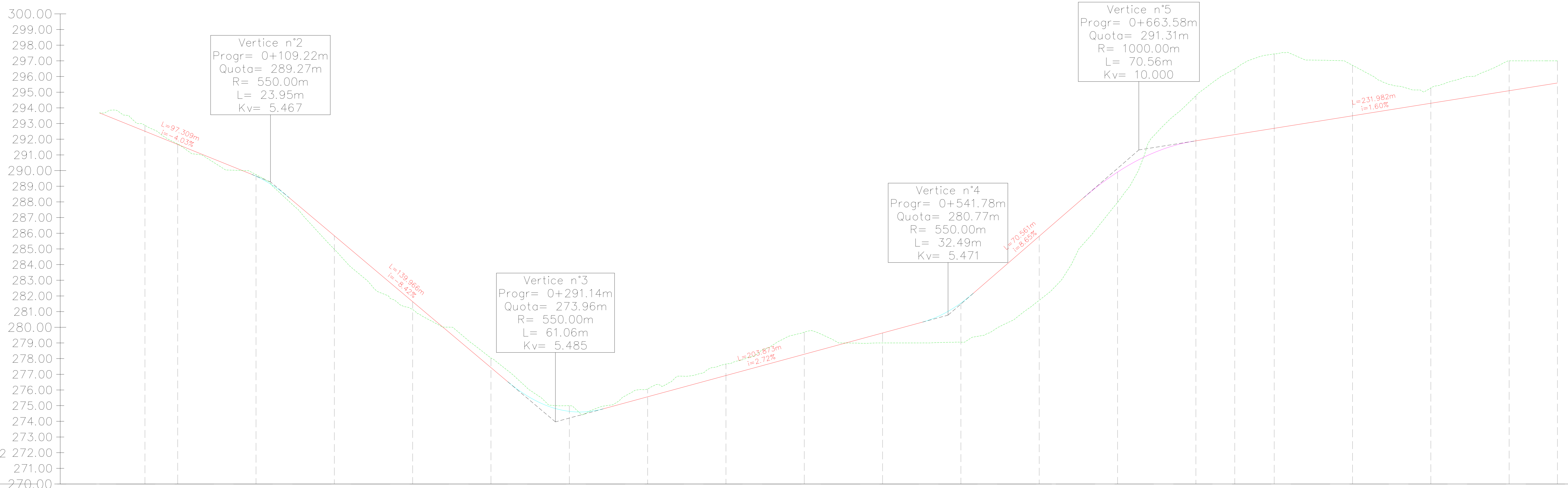
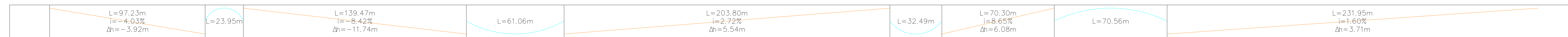

Profilo: Tracciato V12
Scala : 1000:100
Q.Rif. : 270,00

NUMERO SEZIONE	1	2	3	4	5	6	7	8	9	10	11	12	13	14	15	16	17	18	19	20	21
DISTANZE PROGRESSIVE	0+000,00	0+020,00	0+050,00	0+100,00	0+150,00	0+200,00	0+260,00	0+320,00	0+380,00	0+440,00	0+500,00	0+530,00	0+600,00	0+670,00	0+740,00	0+810,00	0+880,00	0+950,00	0+1020,00	0+1090,00	0+1160,00
DISTANZE PARZIALI		20,92	50,00	50,00	50,00	50,00	50,00	50,00	50,00	50,00	50,00	50,00	50,00	50,00	50,00	24,83	25,17	50,00	50,00	50,00	50,81
QUOTE PROGETTO	282,51	281,66	280,64	280,64	281,65	277,65	276,65	278,66	278,66	278,66	279,64	281,64	285,61	289,60	291,60	292,79	292,79	291,50	290,29	288,69	286,59
QUOTE TERRENO	282,89	281,79	280,74	280,88	281,15	278,04	278,09	278,07	277,66	278,69	279,00	278,06	281,72	287,07	294,07	296,69	297,14	296,72	296,07	294,00	291,00
DIFFERENZA QUOTE	-0,38	-0,14	-0,10	-0,24	-0,50	-0,40	-0,36	-0,39	-0,72	-1,01	-0,64	-0,49	-0,09	-0,14	-0,98	-0,49	-0,45	-0,22	-0,98	-1,31	-1,41
ETTOMETRICHE	00		01		02		03		04		05		06		07		08		09		09

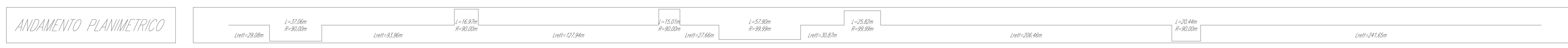

01	19/02/2024	Seconda Emissione	A. Olsson	G. Altaro	P. Polidò
00	10/06/2022	Prima Emissione	A. Filippi	G. Altaro	P. Polidò
REV.	DATE	DESCRIPTION	PREPARED	CHECKED	APPROVED

PROJECT: **IMPIANTO EOLICO SANLURI-SARDARA**

FILE NAME: GRE.EEC.D.25.IT.W.17279.00.003.01 - Profili longitudinali stradali

CLASSIFICATION: **PUBLIC** | FORMAT: **A0** | SCALE: **1:1000** | PLOT SCALE: **1:1** | SHEET: **16 di 16**

UTILIZATION SCOPE: **BASIC DESIGN** | TITLE: **Profili longitudinali stradali**

EGP VALIDATION

VALIDATED BY	GROUP	FUNCTION	TYPE	COUNTRY	PLANT	SYSTEM	PROGRESSIVE	REVISION
VERIFIED BY	GRE.EEC	D.25	ITW172790008301					