

Concio 19  
1 : 50

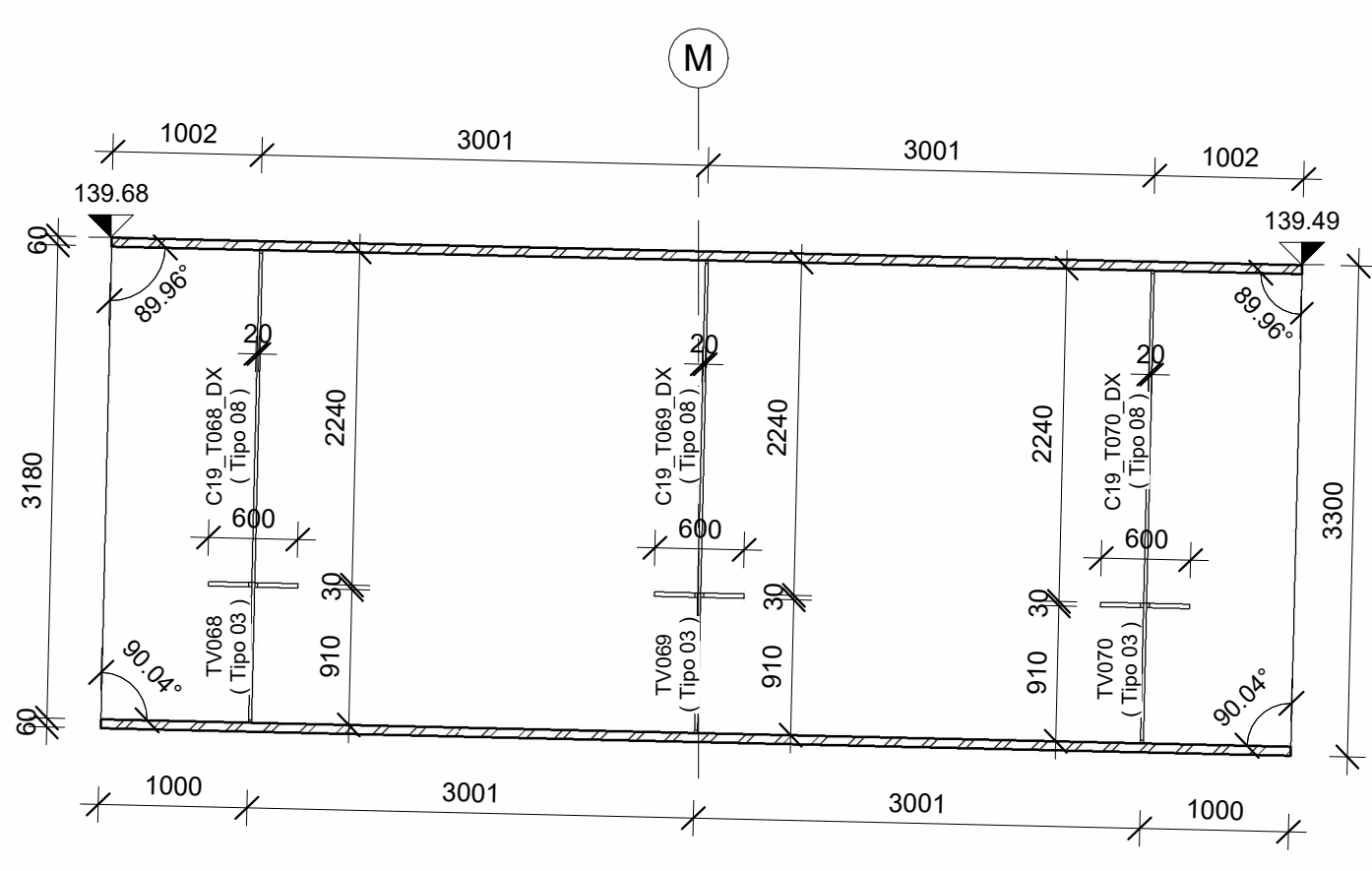

Concio 20  
1 : 50

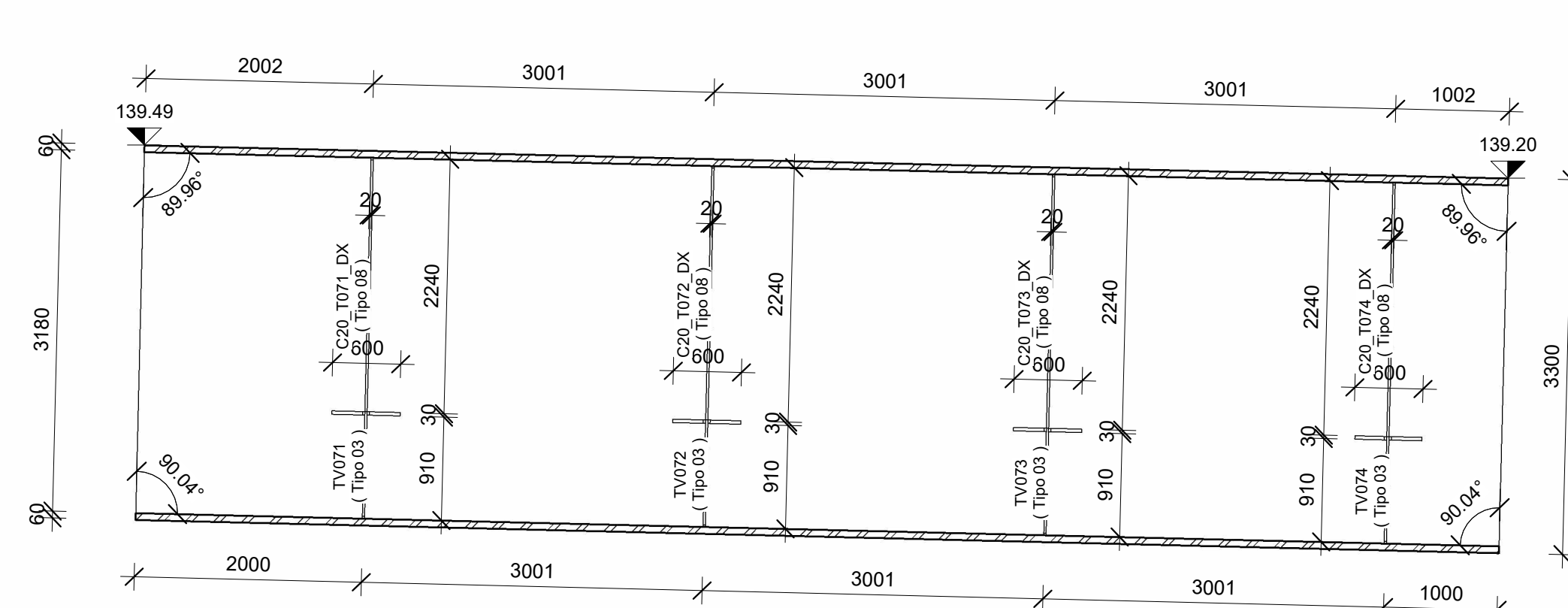

Concio 21  
1 : 50

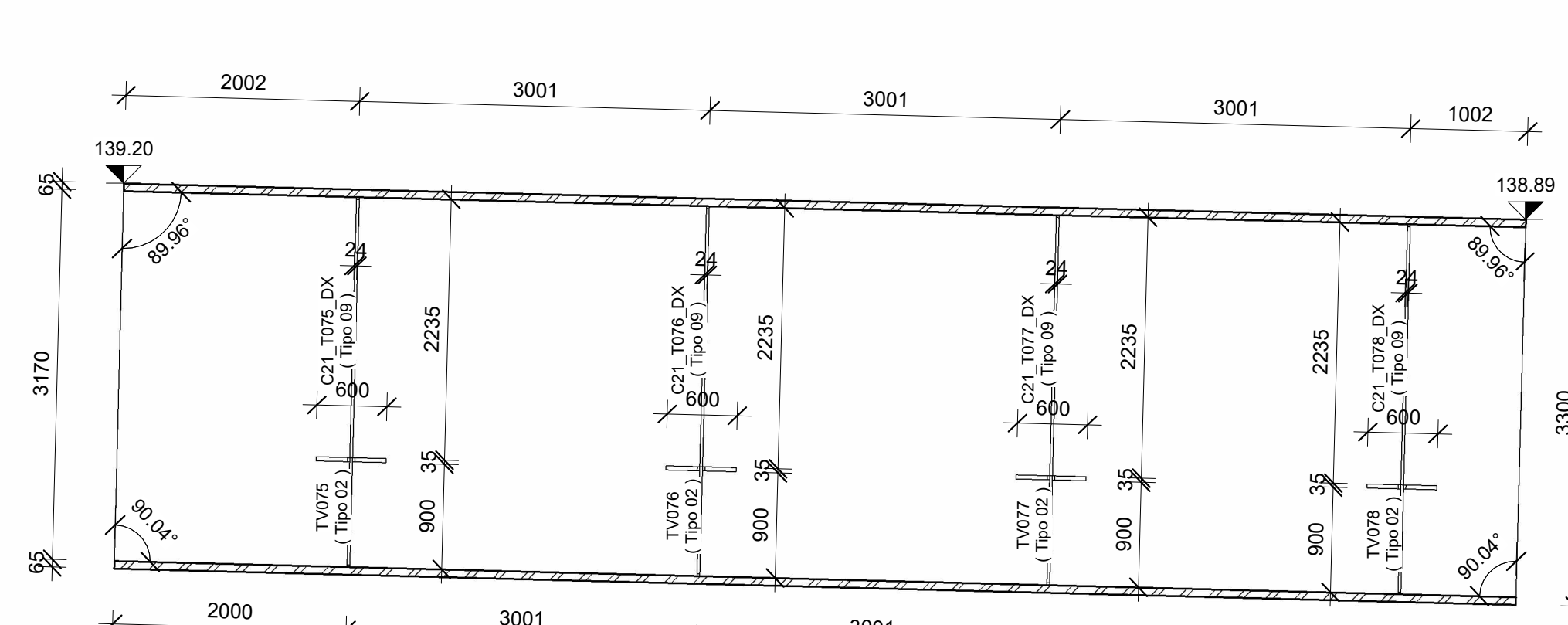

Concio 22  
1 : 50

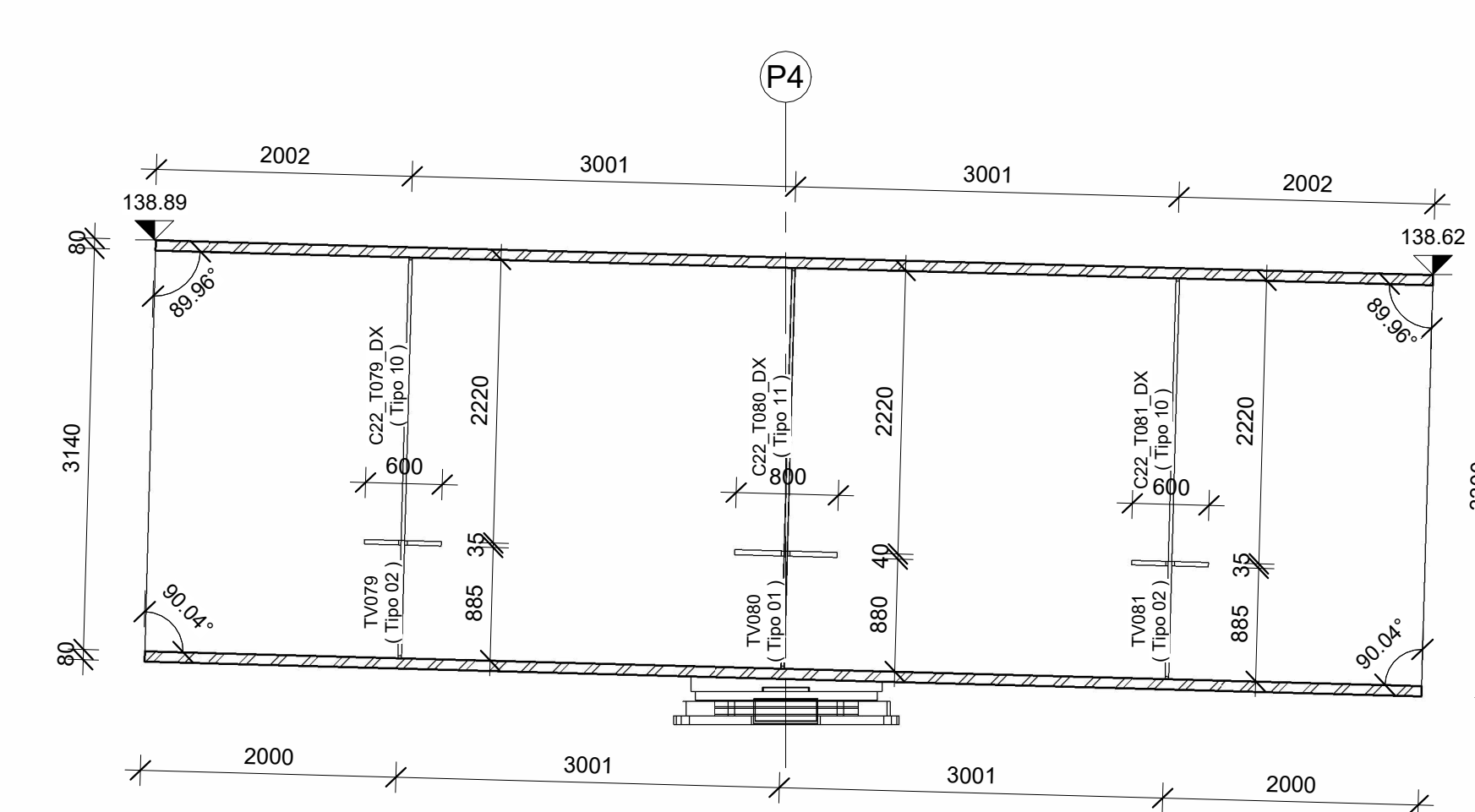

Concio 23  
1 : 50

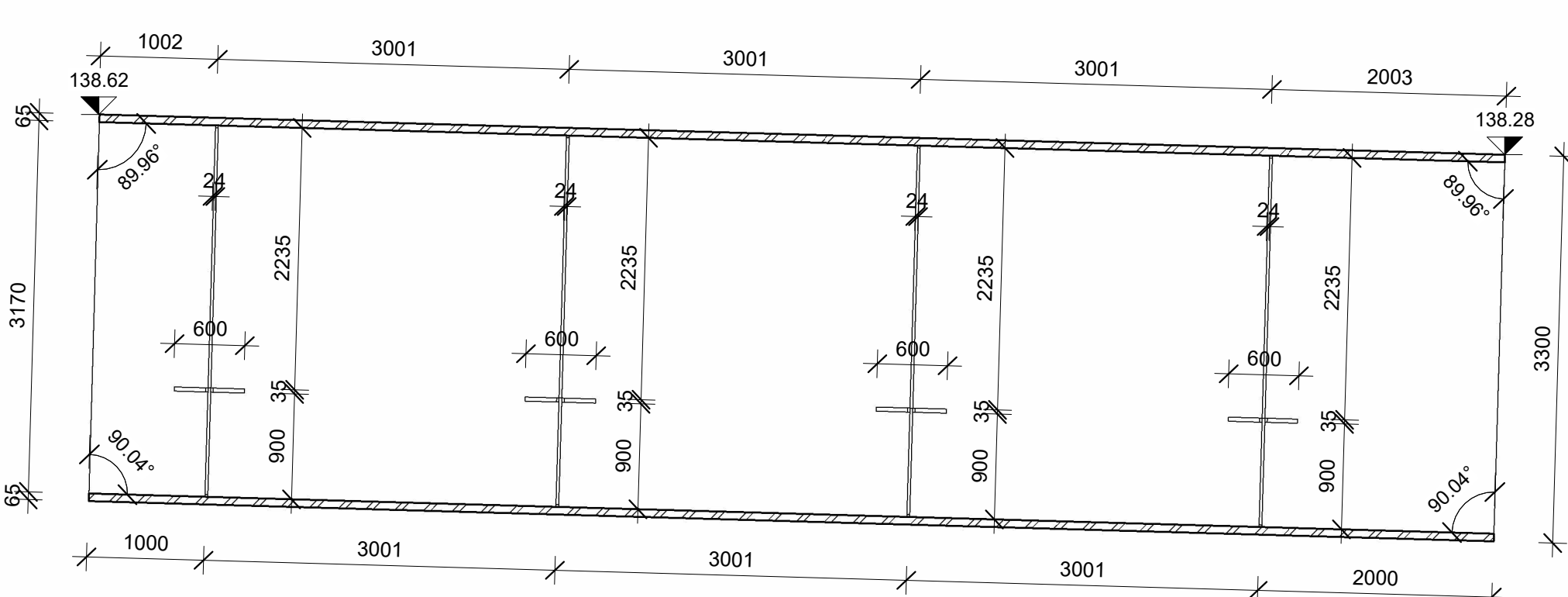

Concio 24  
1 : 50

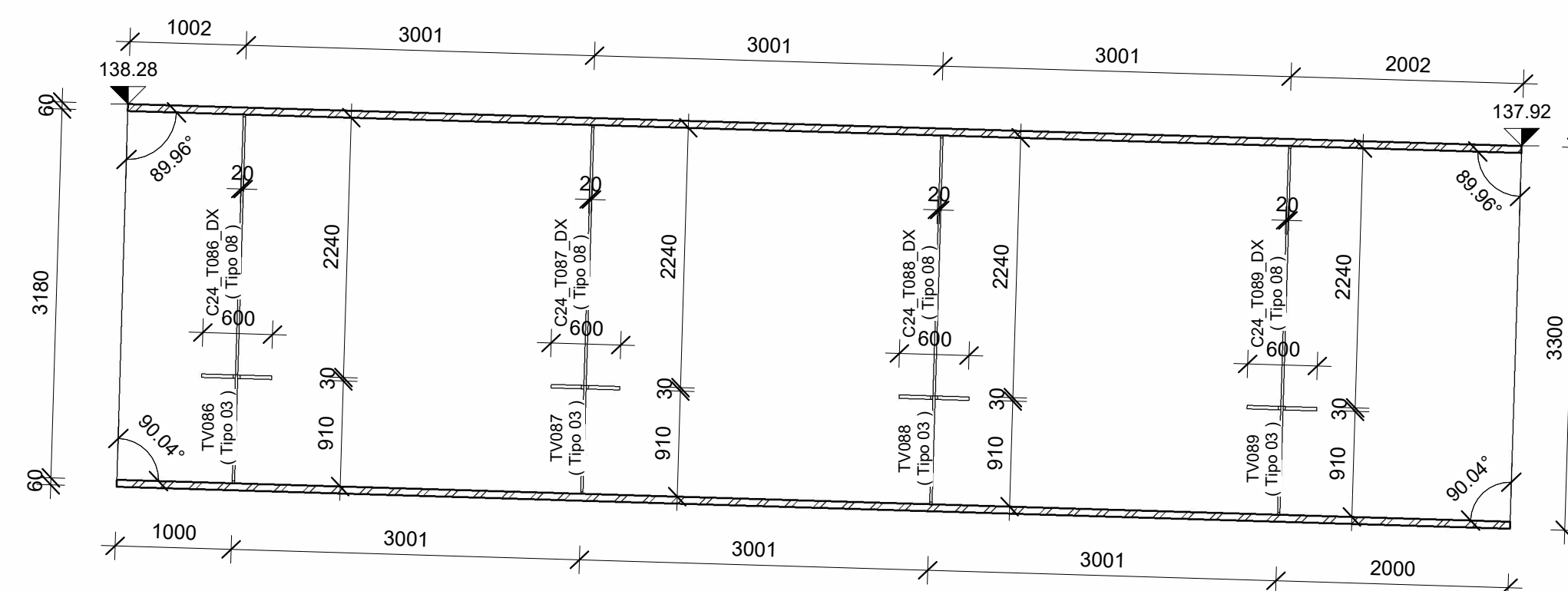

Concio 25  
1 : 50

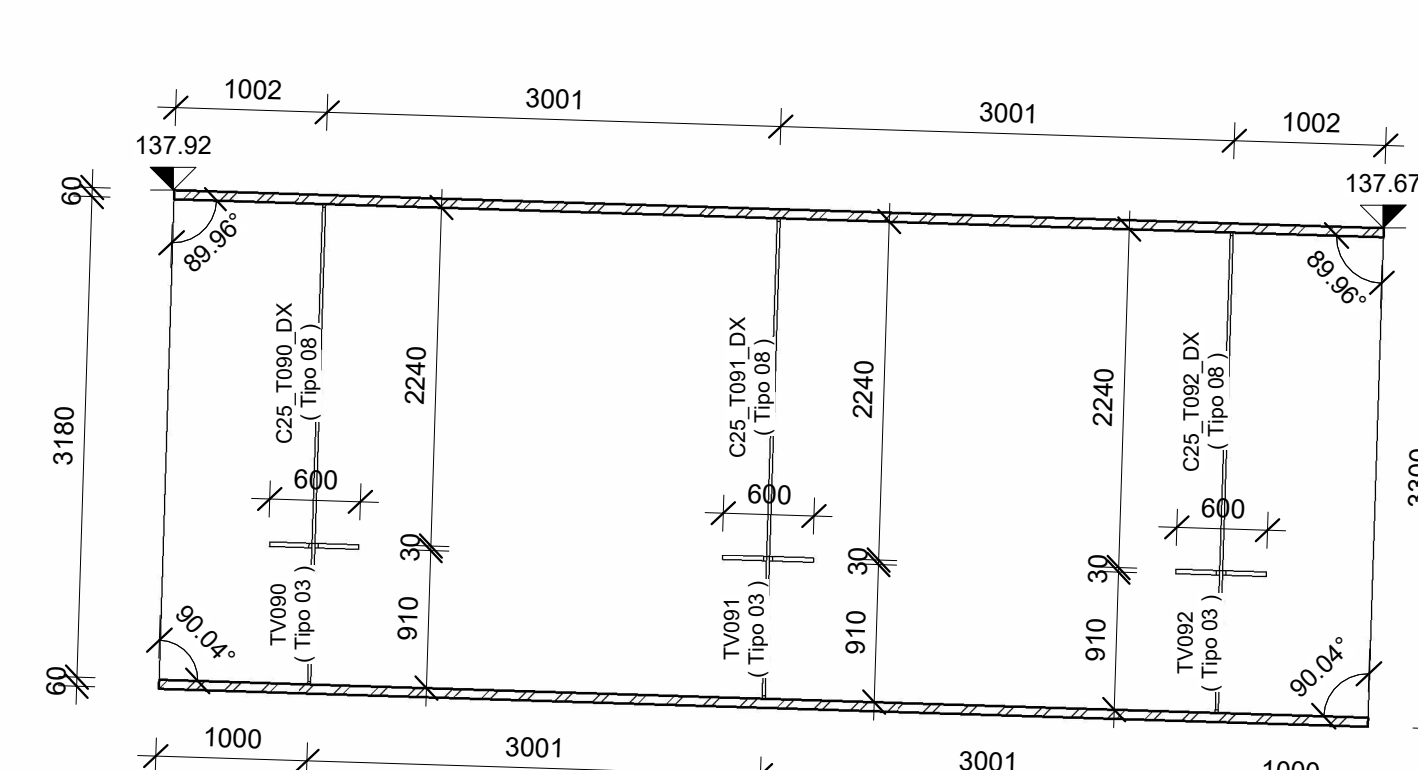

Concio 26  
1 : 50

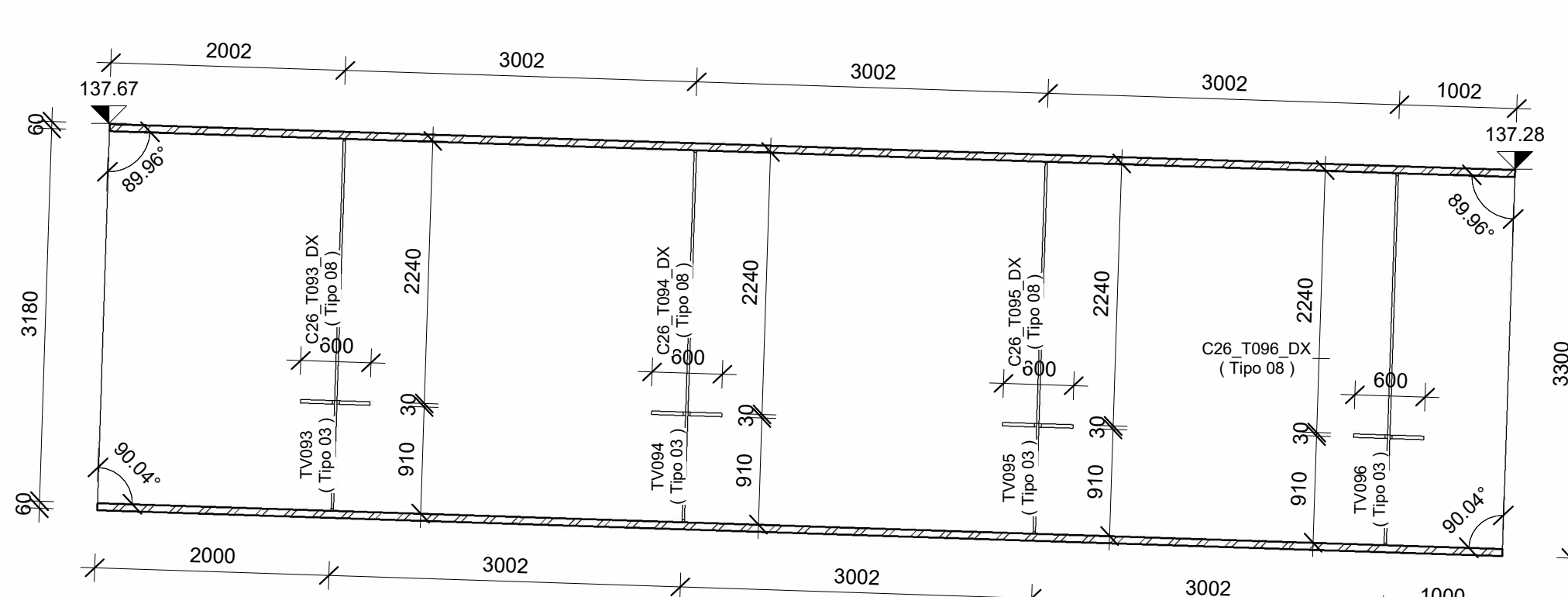

Concio 27  
1 : 50

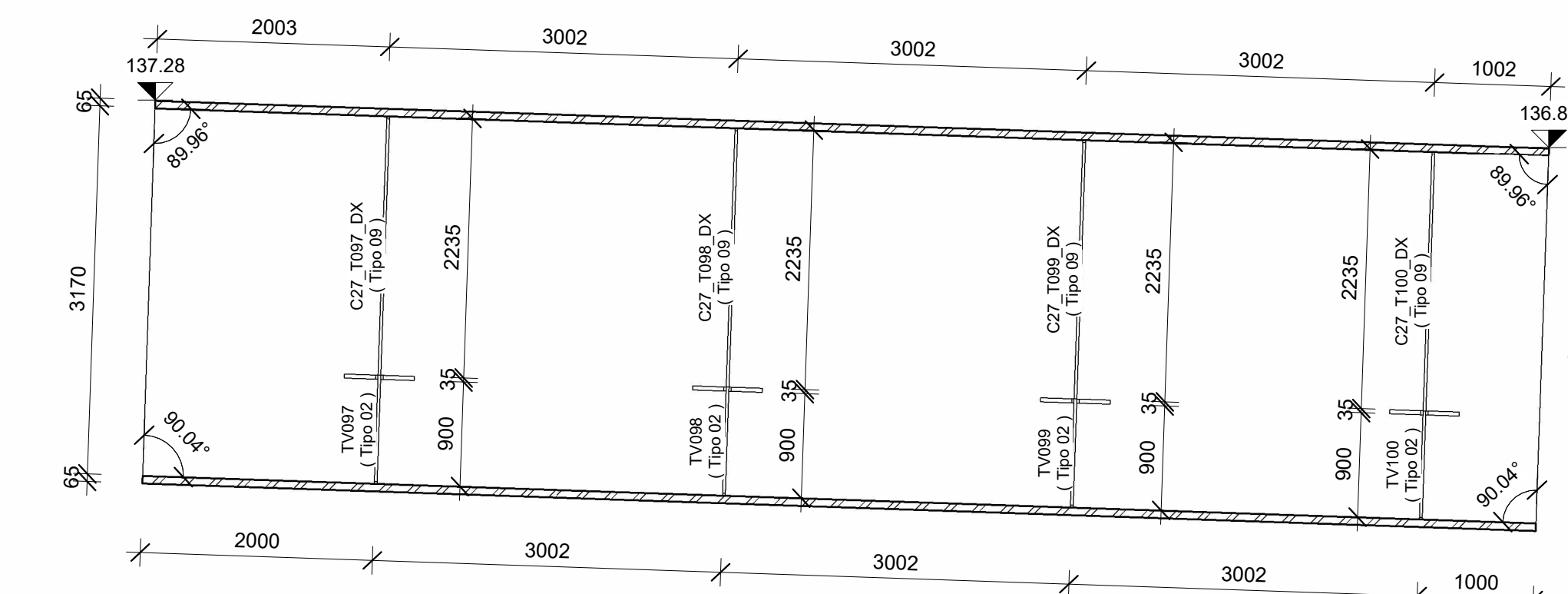

Concio 28  
1 : 50

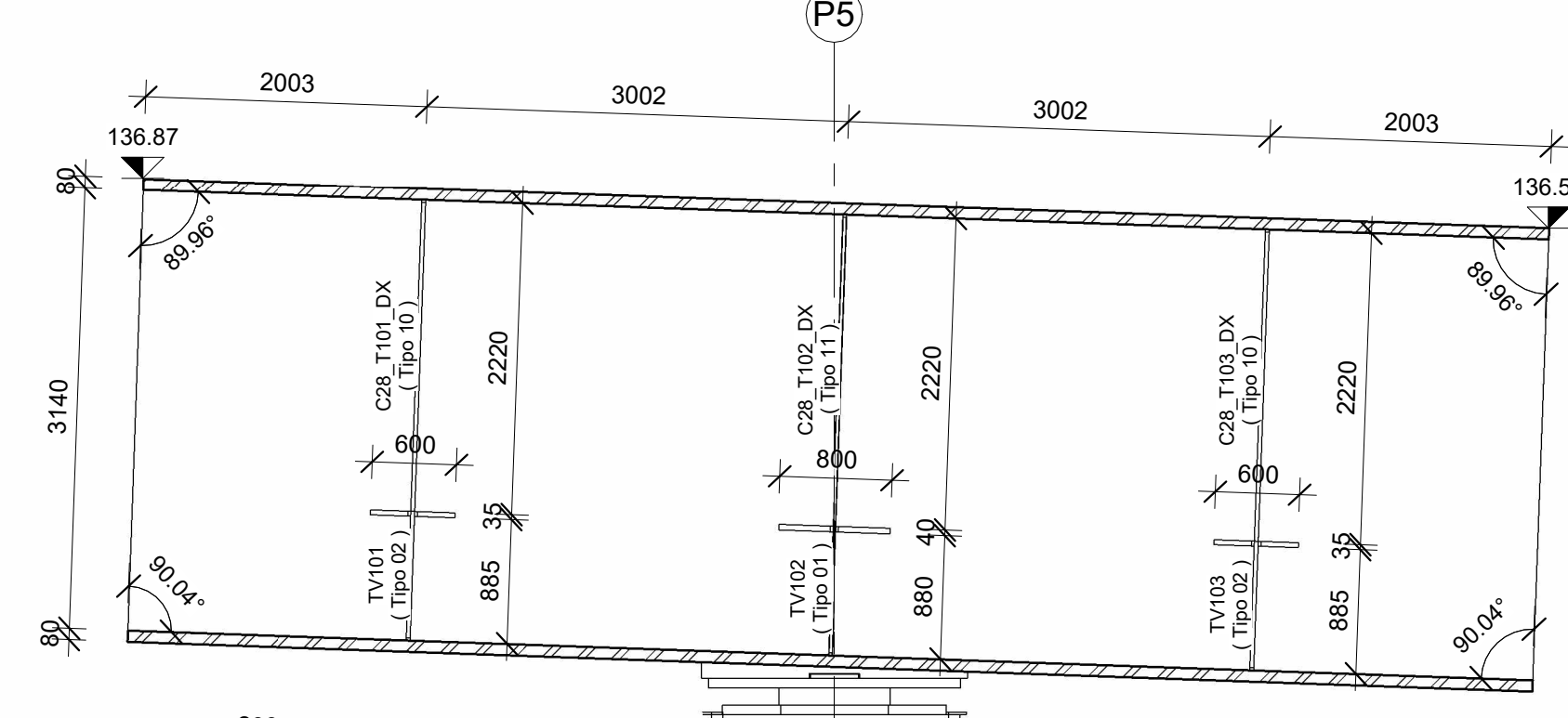

Concio 29  
1 : 50

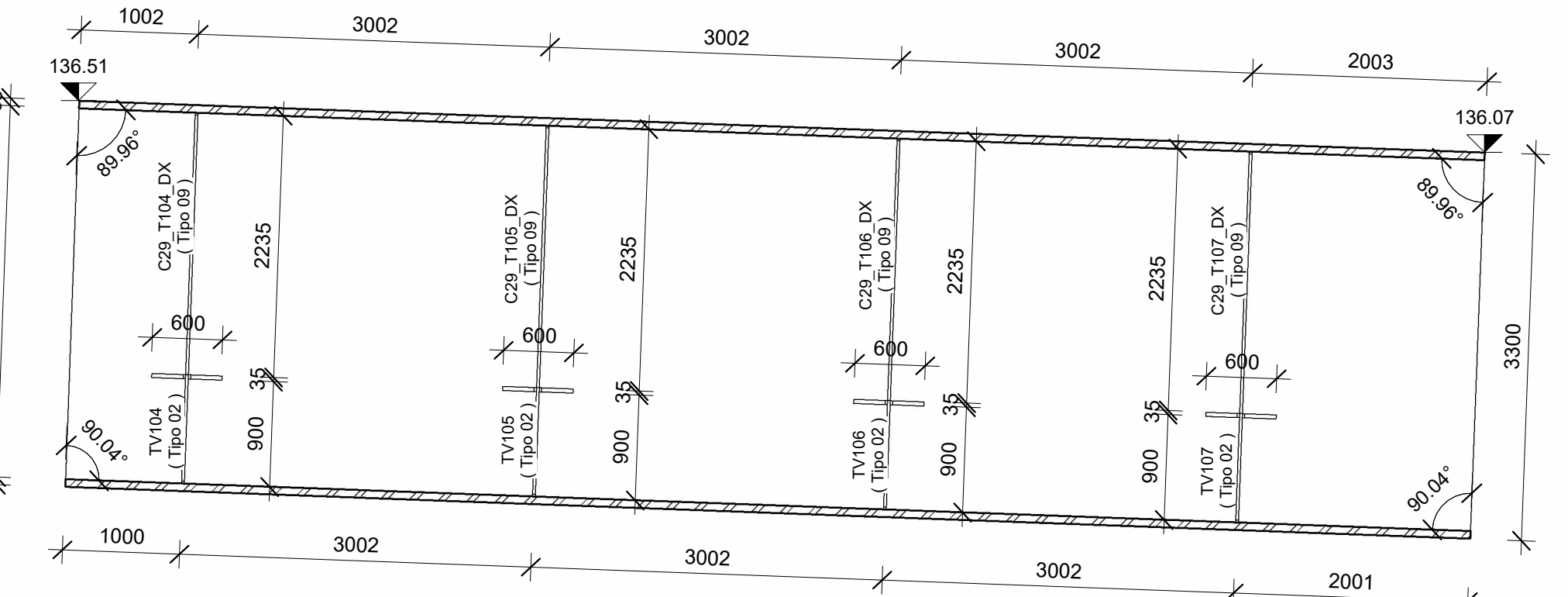

Concio 30  
1 : 50

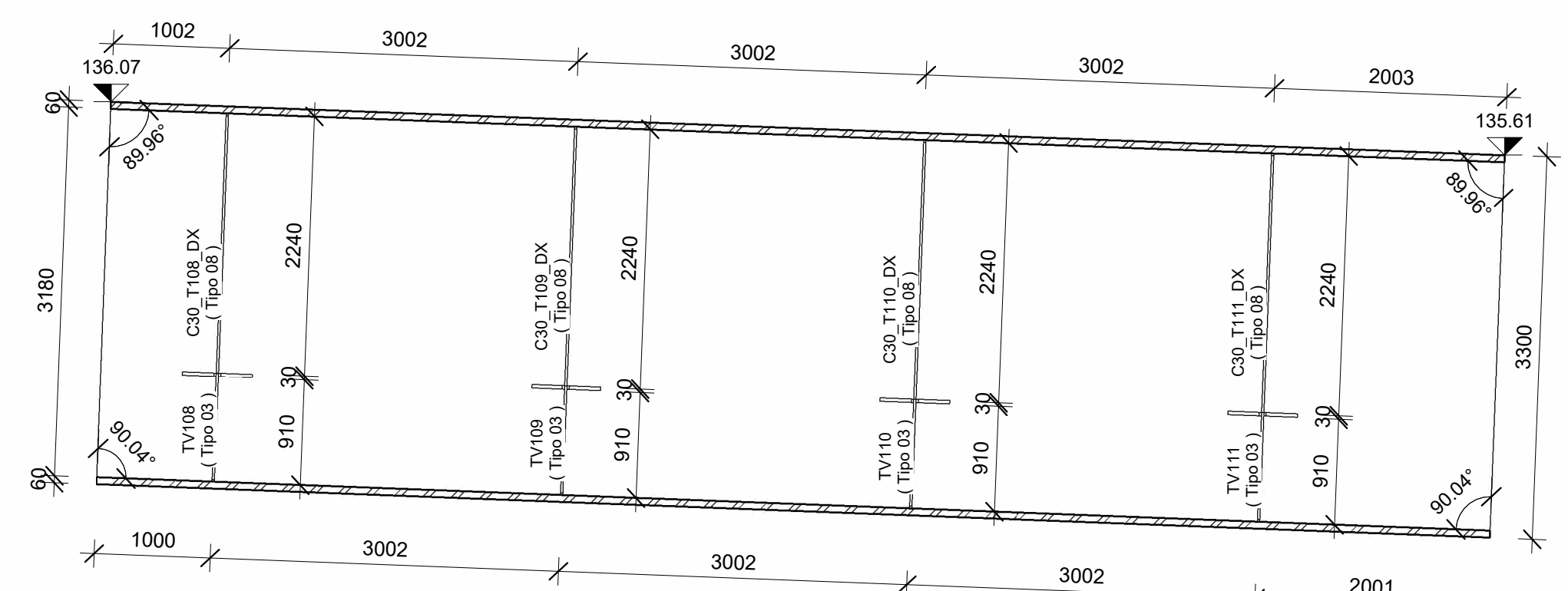

Concio 31  
1 : 50

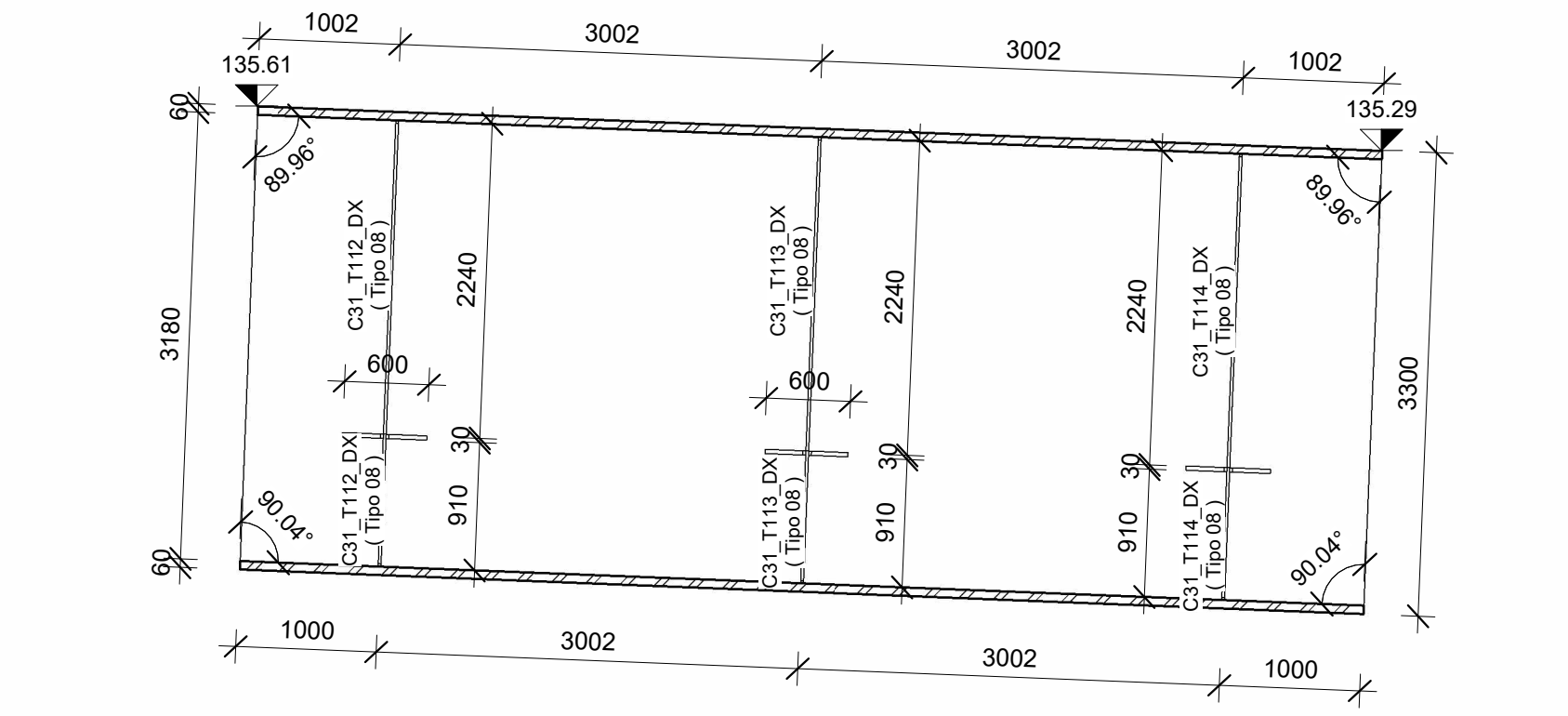

Concio 32  
1 : 50

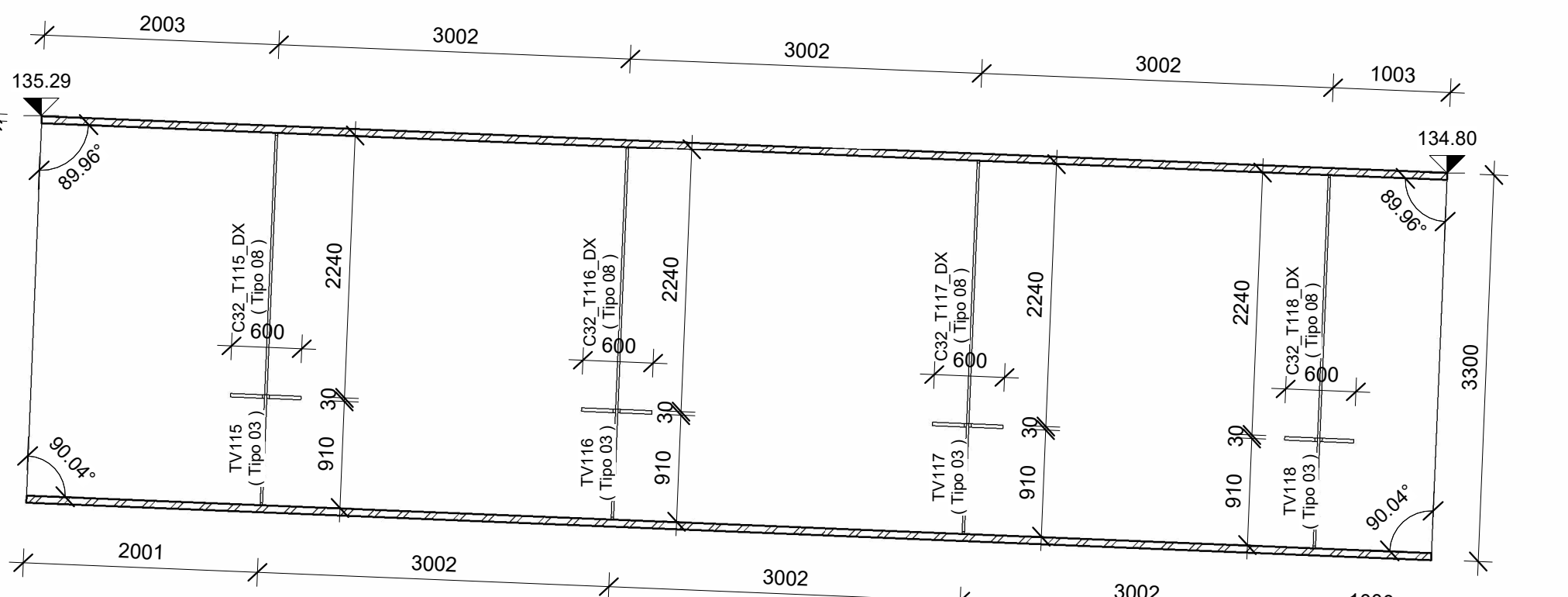

Concio 33  
1 : 50

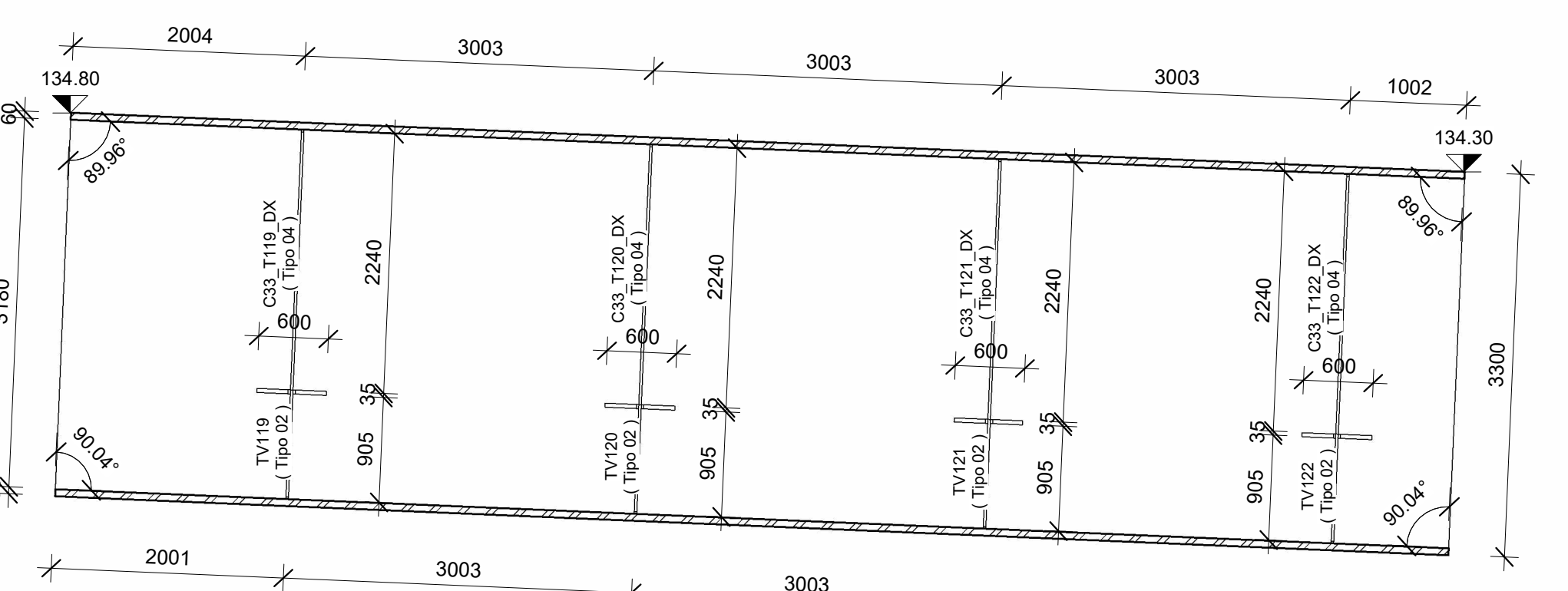

Concio 34  
1 : 50

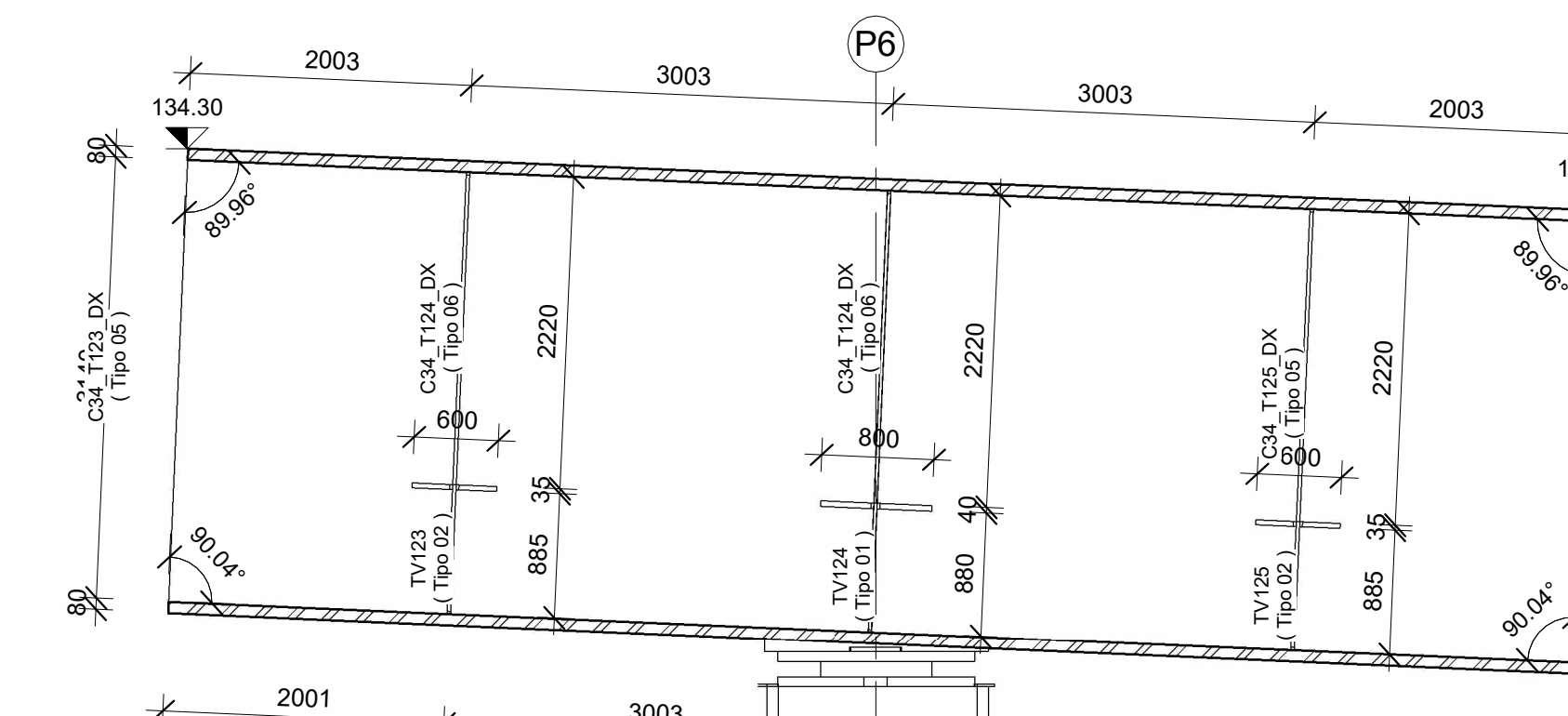

Concio 35  
1 : 50

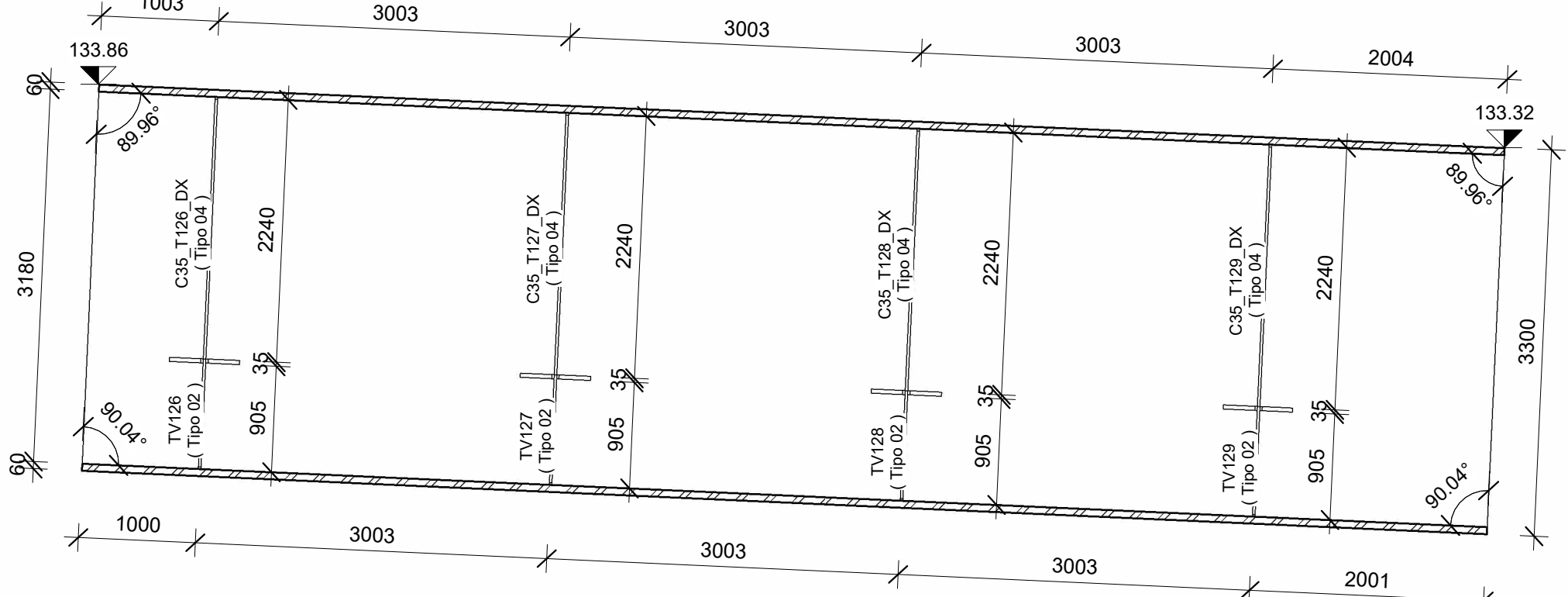

Concio 36  
1 : 50

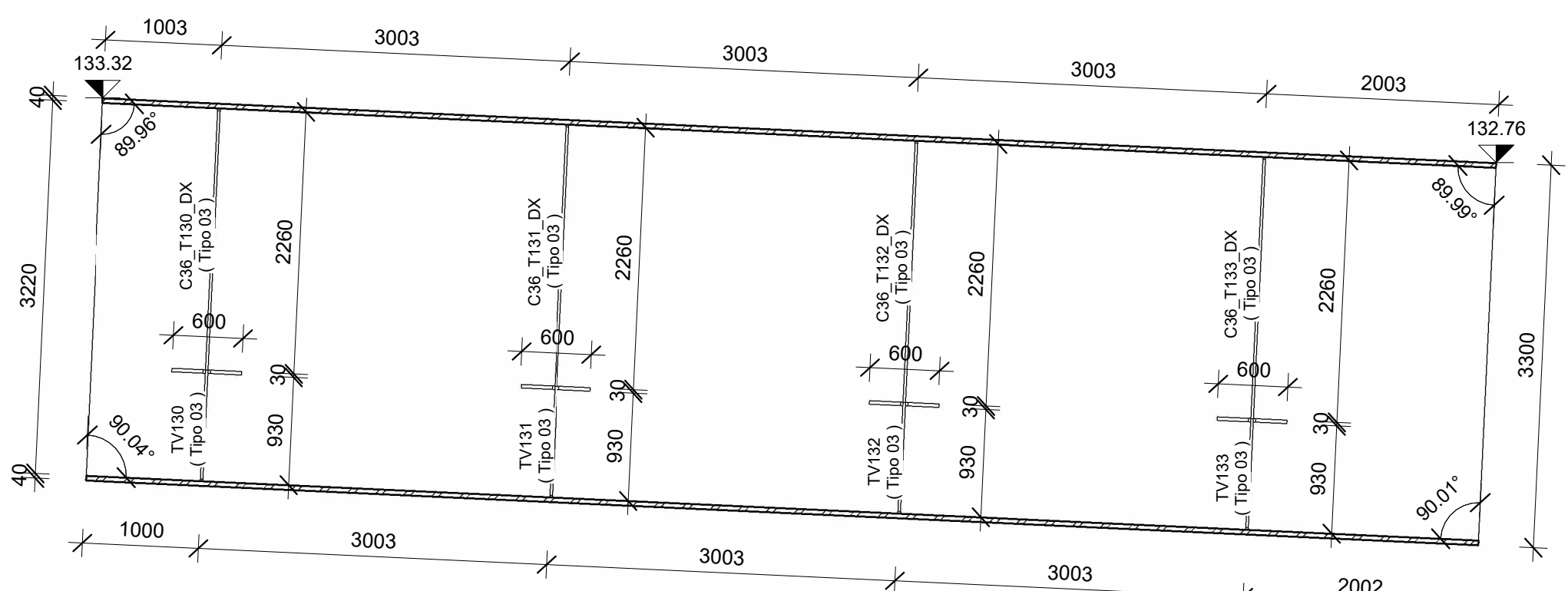

Concio 37  
1 : 50

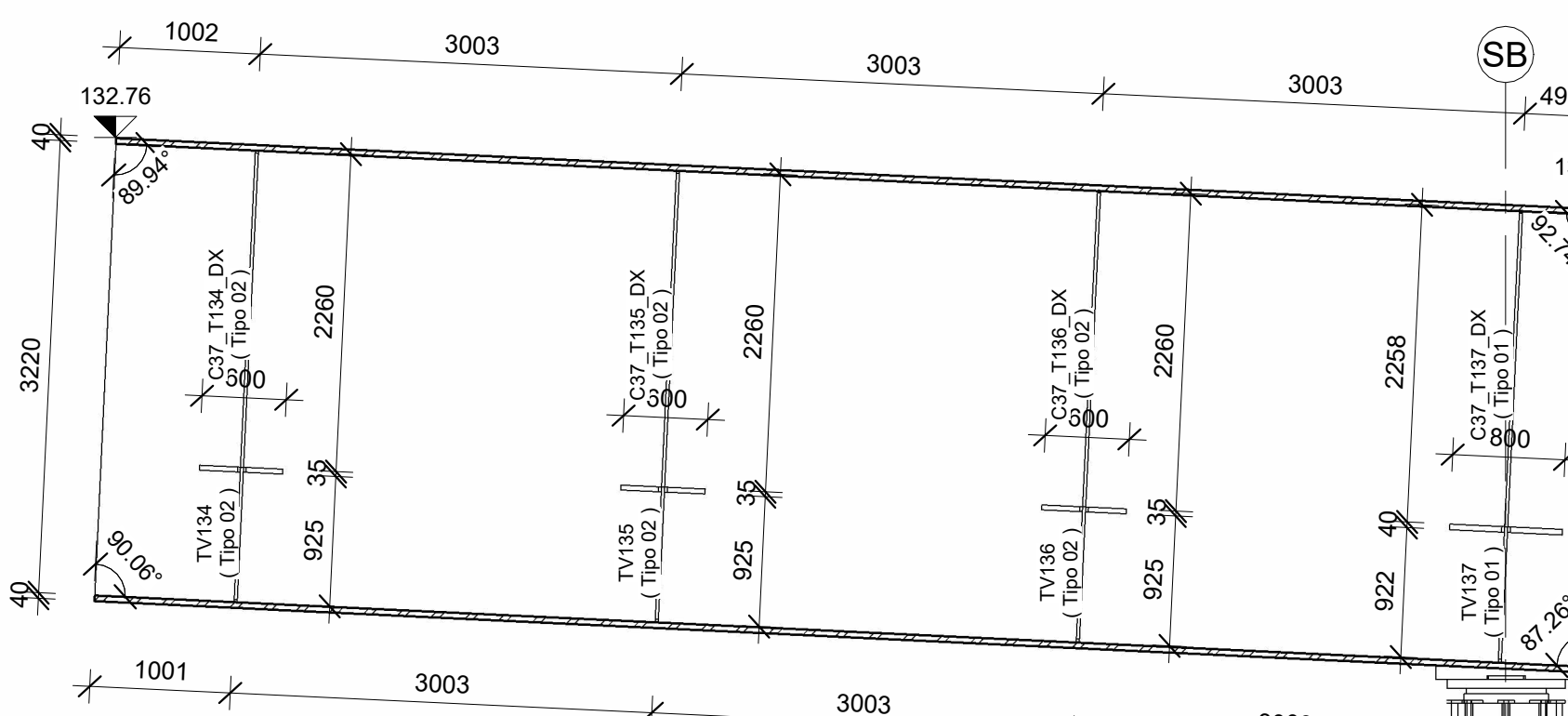

**anas**  
GRUPPO FS ITALIANE  
Direzione Progettazione e Realizzazione Lavori

S.S. 67 "Tosco Romagnola"  
Lavori di adeguamento della S.S. 67 nel tratto tra la località S. Francesco in Comune di Pelago e l'abitato di Dicomano.  
Variante di Rufina (FI) - LOTTI 2A e 2B

**PROGETTO DEFINITIVO** COD. FI462

PROGETTAZIONE: MANDATARIA: MANDANTE:  
RAGGRUPPAMENTO: **PRO ITER**  
TECNICO: **PRO ITER**  
PROGETTISTI: **PRO ITER**

IL RESPONSABILE DELL'INTEGRAZIONE DELLE PRESTAZIONI SPECIALISTICHE:  
**PRO ITER**

IL GEOLOGO:  
**PRO ITER**

IL COORDINATORE PER LA SICUREZZA IN FASE DI PROGETTAZIONE:  
**PRO ITER**

VISTO IL RESP. DEL PROCEDIMENTO:  
**PRO ITER**

PROTOCOLLO: DATA:

**ASSE PRINCIPALE**  
VIADOTTI  
VIADOTTO SIEVE 2  
Impalcato metallico - Conci 19-37

PROGETTO	IN PROG.	ANNO	NOME FILE	REVISIONE	SCALA
ACN00113	D	20	P01-VI03-STR-CP10-A.pdf	A	1:50
D					
C					
B					
A	EMISSIONE	10/2023	Tasconi	Regondi	Fornichi
REV.	DESCRIZIONE	DATA	REDATTO	VERIFICATO	APPROVATO