

PLAN VIEW & BATHYMETRY

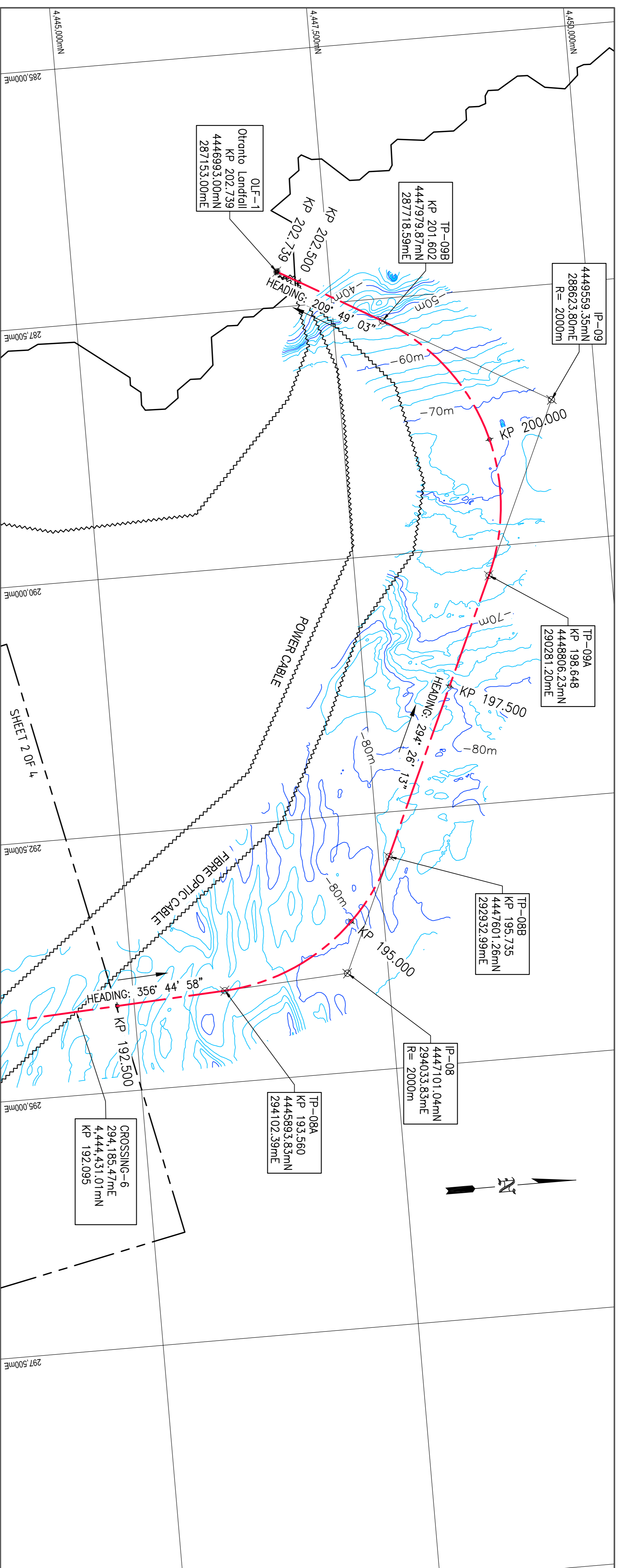

LONGITUDINAL PROFILE ALONG ROUTE CENTER LINE

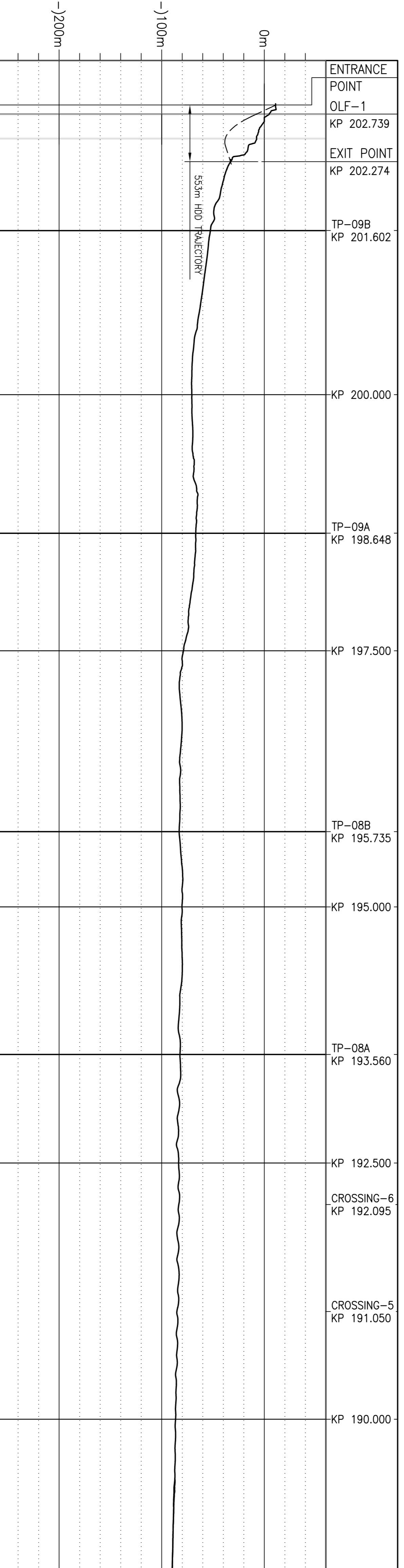

PIPELINE DESIGN SUMMARY

ENTRANCE POINT KP 202.827	KP 202.739 OLF-1	EXIT POINT KP 202.274	TP-09B KP 201.602	KP 200.000	TP-09A KP 198.648	KP 197.500	TP-08B KP 195.735	KP 195.000	TP-08A KP 193.560	KP 192.500	CROSSING-6 KP 192.095	CROSSING-5 KP 191.050	KP 190.000
<p>OUTSIDE DIAMETER (INCH) 32</p> <p>WALL THICKNESS (mm) 20.6</p> <p>MATERIAL GRADE X-70</p> <p>ANTI-CORROSION COATING 4.5mm 3-LAYER POLYPROPYLENE</p> <p>CONCRETE COATING 80</p>													

NOTES

- BATHYMETRY FROM IGI RECONNAISSANCE MARINE SURVEY 2007.
- GEOGRAPHIC COASTLINE DATA OBTAINED FROM NATIONAL GEOGRAPHIC DATA CENTER'S COASTLINE EXTRACTOR. WORLD VECTOR SHORELINE DATA (DESIGNED FOR 1 : 250,000)
- CABLE ALIGNMENTS FROM:
  - ITALIAN HYDROGRAPHIC CHART No. 920
  - ITALY - GREECE SUBMARINE HYDRO INTERCONNECTOR - GENERAL OVERVIEW & KEY MAP
  - SUBMARINE FIBRE-OPTIC LINK (ITALY) - FIBELIA (GREEK MARINE SURVEY)
- PIPELINE DESIGN SUMMARY FROM DESIGN REVIEW & CAPEX ESTIMATE REPORT 31040901-001-TRP-005\_REV.0
- KP % ARE RELATIVE TO POSSIBLE LANDFALL POINT ONZ (KP 0.000)
- FOR CABLE CROSSINGS NEAR OLF-1 LOCATION, REFER TO DRAWING No. 31040905-001-DRW-00-005 "HDD TRAJECTORY - LONGITUDINAL PROFILE"

ROUTE DEFINITION

POINT	NORTHING	EASTING	LATITUDE	LONGITUDE	RADIUS
OM2	4,352,679.55m	439,205.70m	39° 19' 17" N	20° 17' 41" E	N/A
IP-01	4,350,798.22m	428,998.03m	39° 18' 13" N	20° 10' 55" E	3,500m
IP-02	4,351,089.98m	413,227.32m	39° 18' 17" N	19° 59' 37" E	5,000m
IP-03	4,343,811.23m	398,109.65m	39° 14' 15" N	19° 49' 10" E	10,000m
IP-04	4,380,174.81m	348,192.09m	39° 33' 28" N	19° 13' 59" E	10,000m
IP-05	4,403,220.00m	319,867.00m	39° 45' 56" N	18° 53' 50" E	10,000m
IP-06	4,418,307.00m	299,056.00m	39° 23' 28" N	18° 39' 01" E	5,000m
IP-07	4,440,408.18m	294,413.99m	40° 05' 20" N	18° 35' 19" E	3,500m
IP-08	4,447,101.04m	294,033.89m	40° 08' 56" N	18° 34' 55" E	2,000m
IP-09	4,449,559.35m	288,623.80m	40° 10' 11" N	18° 31' 04" E	2,000m
OLF-1	4,446,993.00m	287,153.00m	40° 08' 47" N	18° 30' 05" E	N/A

LEGEND

- PIPELINE ROUTE CENTER LINE
- MAJOR DEPTH CONTOUR (C.L. = 10m)
- MINOR DEPTH CONTOUR (C.L. = 2m)
- SUBMARINE CABLE
- APPROX. TERRITORIAL BOUNDARY (12 NAUTICAL MILES ZONE)

PROJECTION PARAMETERS

HOR. COORDINATE SYSTEM : WGS 84 / UTM ZONE 34  
 PROJECTION : UNIVERSAL TRANSVERSE MERCATOR (UTM)  
 Central Meridian (CM) : 21° 00' 00" East  
 Latitude of Origin : 00° 00' 00" North  
 False Easting : 500,000 m  
 False Northing : 0 m  
 Scale factor at CM : 0.999600

SCALE

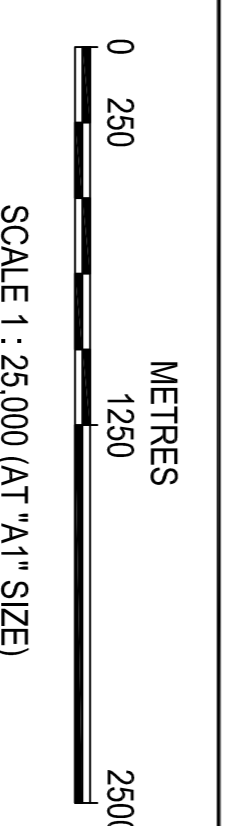

**IGI Poseidon**

**WorleyParsons Group**

ITALIAN ROUTE SECTION ALIGNED ON CHAKI 1 OF 4

IGI INTERCONNECTOR GREECE - ITALY ITALIAN AUTHORITIES APPROVAL SUPPORT

Client Representative Κωδικός Αναφοράς: Πύλη 1 Client Reference Αριθμός Έργου: 31040905	Client Name Επιχειρησιακή Ονομασία: ΤΕΑ Company Name: ΤΕΑ	Contract Unit Number Κωδικός Έργου: 0101-DRW-00-002	Sheet No. Σελίδα: 1 of 4
Author Κωδικός Υποψηφίου: 31040905	Project Director Όνομα: Δ. ΜΑΡΤΙΝΙΔΗΣ	Design No. Κωδικός Έργου: 0101-DRW-00-002	Scale Μέγεθος: B
Engineer Όνομα: ΜΑΡΤΙΝΙΔΗΣ	Checked Όνομα: ΜΑΡΤΙΝΙΔΗΣ	Approved Όνομα: ΜΑΡΤΙΝΙΔΗΣ	Scale Μέγεθος: B
Project Manager Όνομα: ΜΑΡΤΙΝΙΔΗΣ	Checked Όνομα: ΜΑΡΤΙΝΙΔΗΣ	Approved Όνομα: ΜΑΡΤΙΝΙΔΗΣ	Scale Μέγεθος: B
Document Operator Όνομα: ΜΑΡΤΙΝΙΔΗΣ	Checked Όνομα: ΜΑΡΤΙΝΙΔΗΣ	Approved Όνομα: ΜΑΡΤΙΝΙΔΗΣ	Scale Μέγεθος: B