

PLAN VIEW & BATHYMETRY

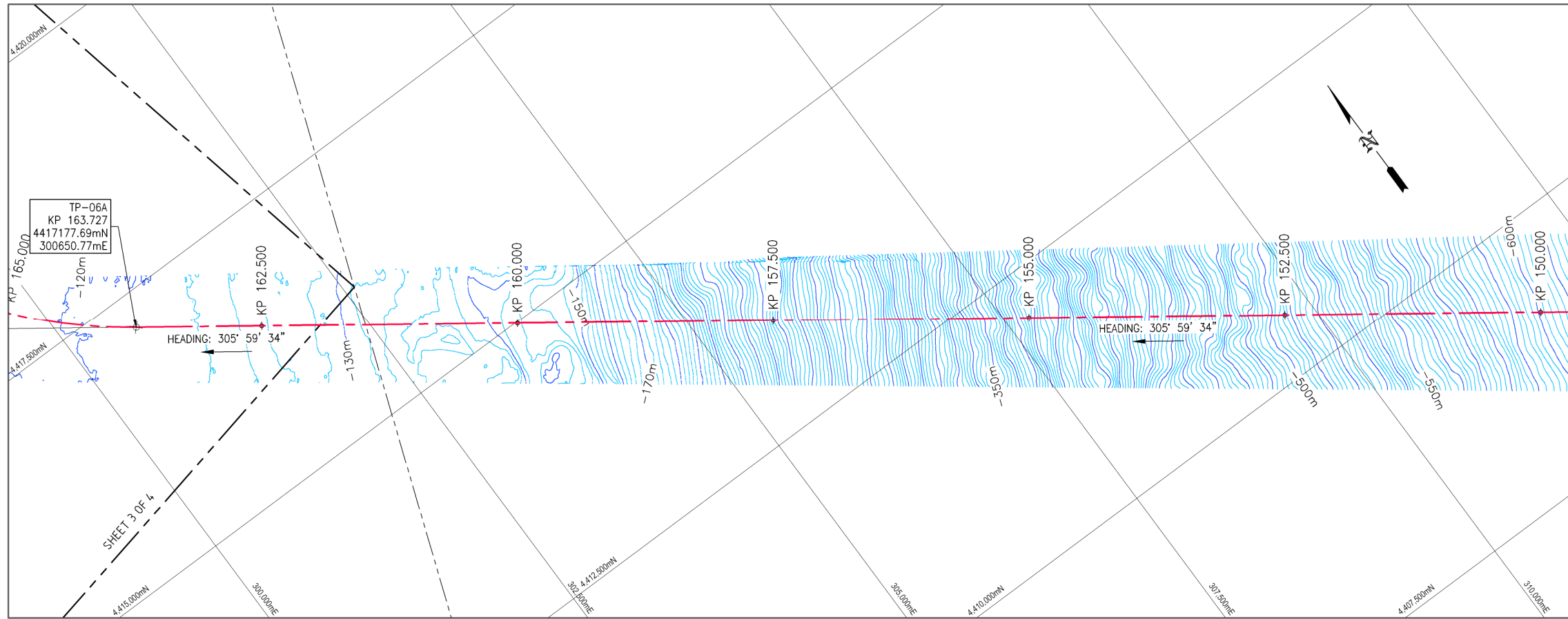

NOTES

- BATHYMETRY FROM IGI RECONNAISSANCE MARINE SURVEY 2007.
- GEOGRAPHIC COASTLINE DATA OBTAINED FROM NATIONAL GEOGRAPHIC DATA CENTER'S COASTLINE EXTRACTOR. WORLD VECTOR SHORELINE DATA (DESIGNED FOR 1 : 250,000)
- CABLE ALIGNMENTS FROM:
 - ITALIAN HYDROGRAPHIC CHART No. 920
 - ITALY-GREECE SUBMARINE HVDC INTERCONNECTOR - GENERAL OVERVIEW & KEY MAP.
 - SUBMARINE FIBRE-OPTIC LINK OTRANTO (ITALY) - FTILIA (GREECE) MARINE SURVEY.
- PIPELINE DESIGN SUMMARY FROM DESIGN REVIEW & CAPEX ESTIMATE REPORT 31040901-001-TRP-005, REV. 0.
- KP's ARE RELATIVE TO POSSIBLE LANDFALL POINT OM2 (KP 0.000)

ROUTE DEFINITION

POINT	NORTHING	EASTING	LATITUDE	LONGITUDE	RADIUS
OM2	4,352,679.55m	439,205.70m	39° 19' 17" N	20° 17' 41" E	N/A
IP-01	4,350,798.22m	428,998.03m	39° 18' 13" N	20° 10' 35" E	3,500m
IP-02	4,351,089.98m	413,227.32m	39° 18' 17" N	19° 59' 37" E	5,000m
IP-03	4,343,811.23m	398,109.65m	39° 14' 15" N	19° 49' 10" E	10,000m
IP-04	4,380,174.81m	348,192.09m	39° 33' 28" N	19° 13' 59" E	10,000m
IP-05	4,403,220.00m	319,867.00m	39° 45' 36" N	18° 53' 50" E	10,000m
IP-06	4,418,307.00m	299,096.00m	39° 23' 28" N	18° 39' 01" E	5,000m
IP-07	4,440,408.18m	294,413.93m	40° 05' 20" N	18° 35' 19" E	3,500m
IP-08	4,447,101.04m	294,033.83m	40° 08' 56" N	18° 34' 55" E	2,000m
IP-09	4,449,559.35m	288,623.80m	40° 10' 11" N	18° 31' 04" E	2,000m
OLF-1	4,446,993.00m	287,153.00m	40° 08' 47" N	18° 30' 05" E	N/A

LEGEND

- PIPELINE ROUTE CENTER LINE
- MAJOR DEPTH CONTOUR (C.I.= 10m)
- MINOR DEPTH CONTOUR (C.I.= 2m)
- SUBMARINE CABLE
- APPROX. TERRITORIAL BOUNDARY (12 NAUTICAL MILES ZONE)

LONGITUDINAL PROFILE ALONG ROUTE CENTER LINE

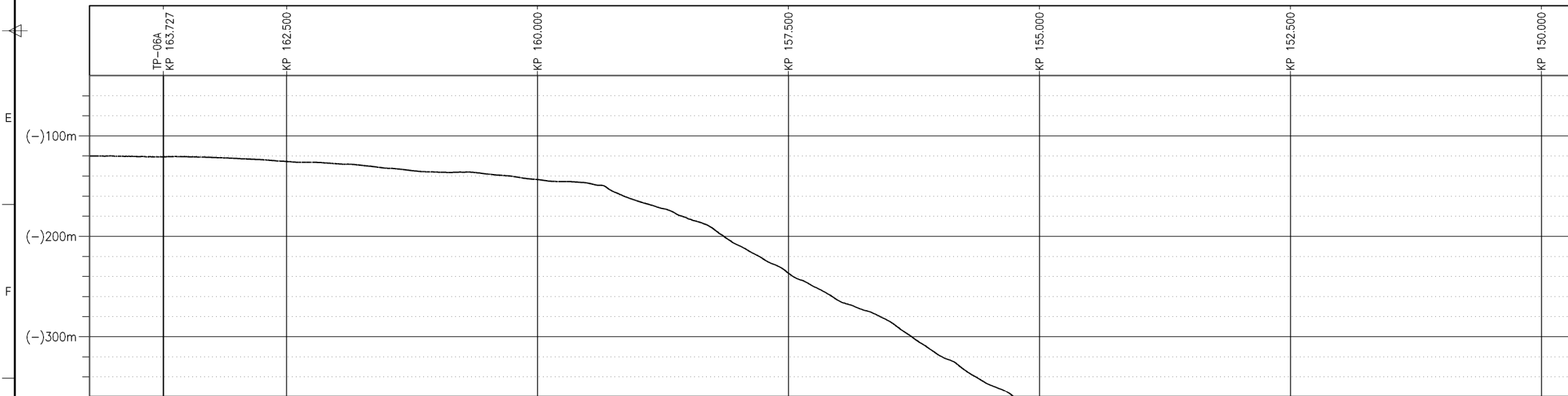

PROJECTION PARAMETERS

HOR. COORDINATE SYSTEM : WGS 84 / UTM ZONE 34
 PROJECTION : UNIVERSAL TRANSVERSE MERCATOR (UTM)
 Central Meridian (CM) : 21° 00' 00" East
 Latitude of Origin : 00° 00' 00" North
 False Easting : 500,000 m
 False Northing : 0 m
 Scale factor at CM : 0.999600

SCALE

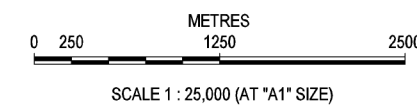

PIPELINE DESIGN SUMMARY

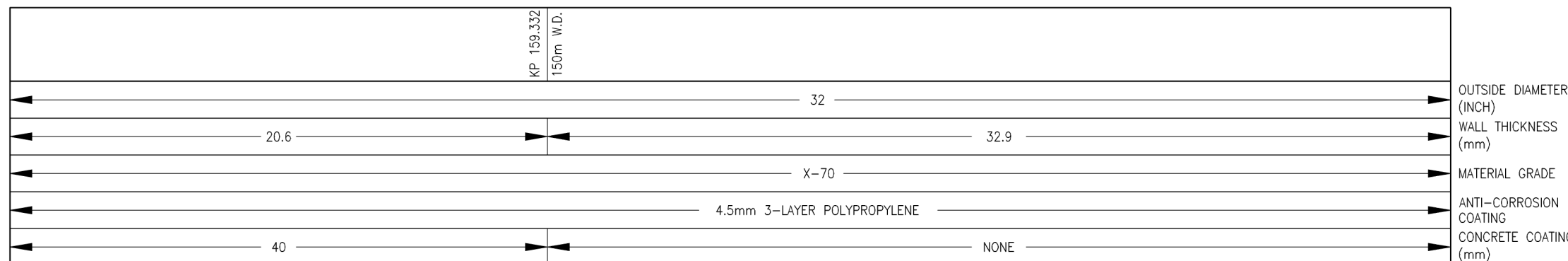

		IGI INTERCONNECTOR GREECE - ITALY ITALIAN AUTHORITIES APPROVAL SUPPORT	
		Τίτλος / Title ITALIAN ROUTE SECTION ALIGNMENT CHART 4 OF 4	
Αντιπρόσωπος Πελάτη Client Representative Ελεο Ράγκεν Elio Ruggeri	Κλίμακα Scale 1:25,000	Κωδικός Περιοχής Area Code 31040905	Φύλλο Sheet 4 of 4
Κωδικός Αναφοράς Πελάτη Client Reference Σύμβαση No Contract No. T.B.A.	Κωδικός Προγράμματος Project Identification 31040905	Σχέδιο-No Drawing-No. 0101-DRW-00-002	Αναθ. Rev. B
Αντιπρόσωπος Μηχανικού Engineer Representative Martijn van Diehl	Παραγωγή Αρχείου Document Originator Frank van Kalk	Contract Number Unit Number Identification	Size Sec No