

VIABILITÀ IN76 / SOTTOVIA SL05

Table with 2 columns: VIABILITÀ IN76/SL05, VERTICE IN76/SL05.1. Rows include X, Y, Azim coordinates.

Table with 2 columns: VIABILITÀ IN76/SL05, VERTICE IN76/SL05.2. Rows include X, Y, T1, T2, Afa, Az, Az2, DeltaR1, Tau1, C, X, Y, R, Afac, Tarco, Sv coordinates and parameters.

Table with 2 columns: VIABILITÀ IN76/SL05, VERTICE IN76/SL05.3. Rows include X, Y, T1, T2, Afa, Az, Az2, DeltaR1, Tau1, C, X, Y, R, Afac, Tarco, Sv coordinates and parameters.

Table with 2 columns: VIABILITÀ IN76/SL05, VERTICE IN76/SL05.4. Rows include X, Y, T1, T2, Afa, Az, Az2, DeltaR1, Tau1, C, X, Y, R, Afac, Tarco, Sv coordinates and parameters.

Table with 2 columns: VIABILITÀ IN76/SL05, VERTICE IN76/SL05.5. Rows include X, Y, Azim coordinates.



SCHEMA DATI DI TRACCIAMENTO

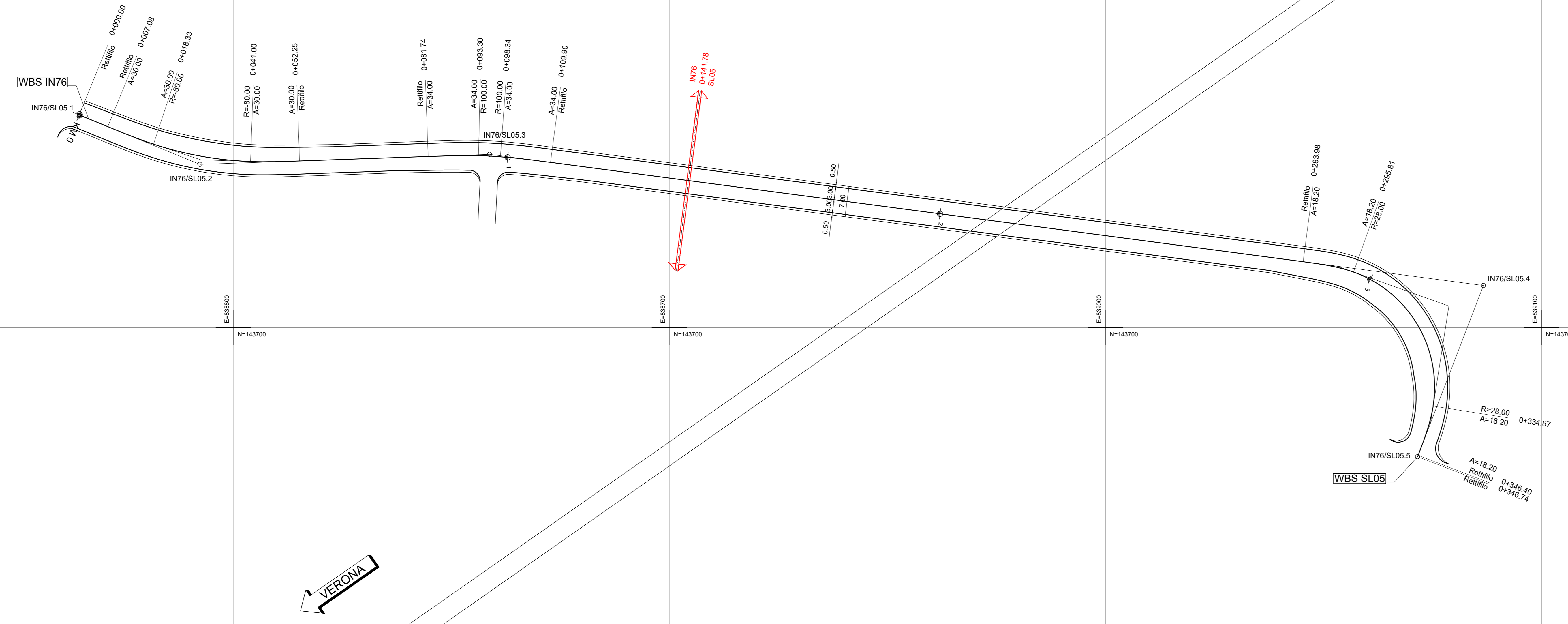
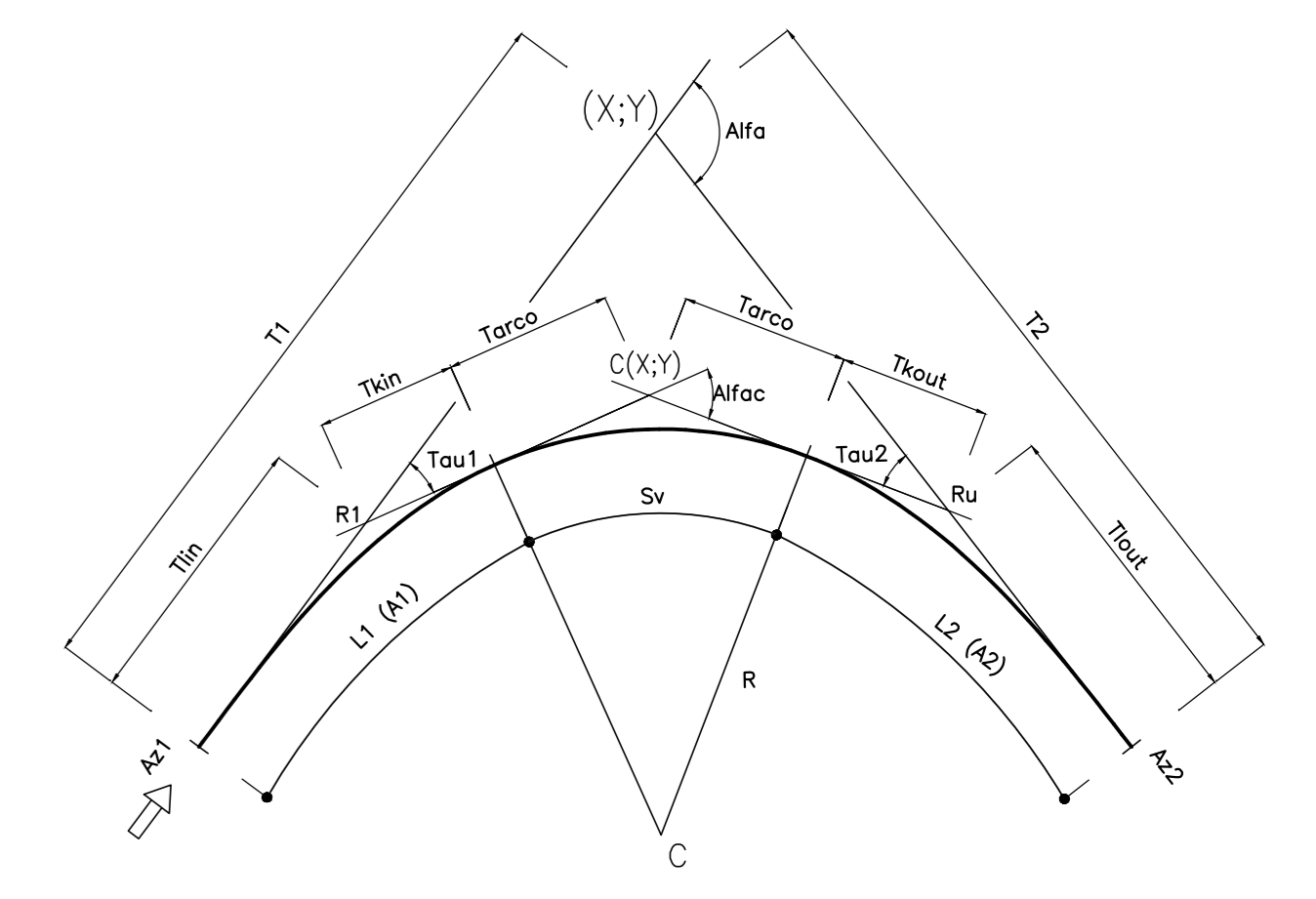

Administrative and technical information block containing: COMMITENTE (RFI), ALTA SORVEGLIANZA (ITALFERR), GENERAL CONTRACTOR (Consorzio Irico-IV Due), project title (INFRASTRUTTURE FERROVIARIE STRATEGICHE...), project phase (PROGETTO ESECUTIVO), and a detailed revision table with columns for Rev., Descrizione, Eredita, Data, Verificate, Data, Approvato, Data, and the Project Designer's name.