

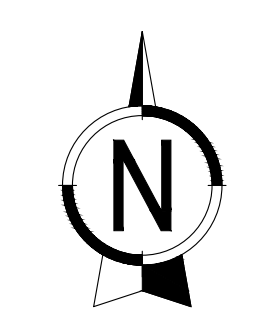

SCHEMA DATI DI TRACCIAMENTO

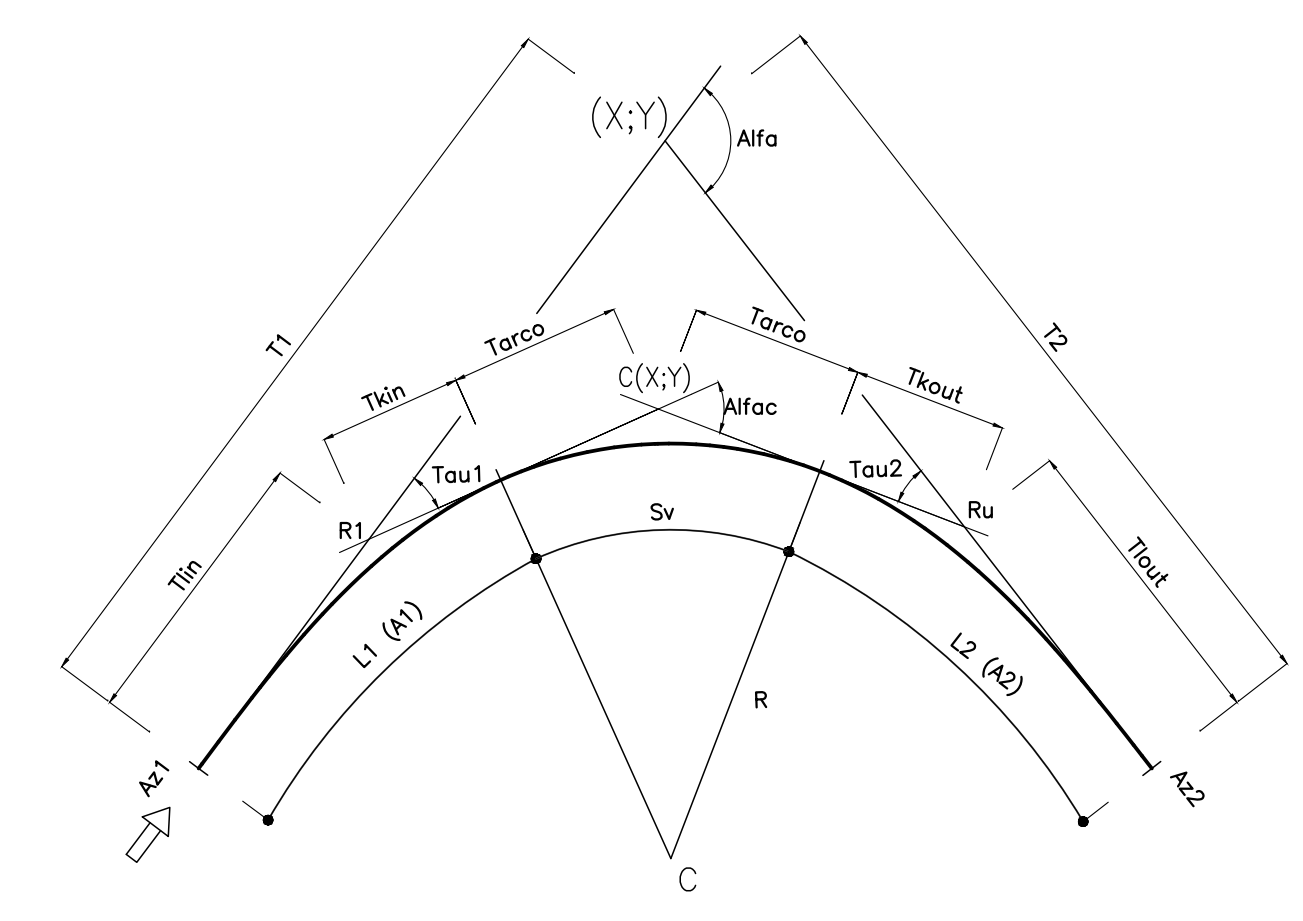

VIABILITÀ  
CAVALCAFERROVIA IV10

Table with 5 columns: IV10 VERTICE IV10.1, CAVALCAFERROVIA IV10 VERTICE IV10.2, CAVALCAFERROVIA IV10 VERTICE IV10.3, CAVALCAFERROVIA IV10 VERTICE IV10.4, IV10 VERTICE IV10.5. Each column contains technical data for a specific vertex, including coordinates (X, Y), tangents (T1, T2), offsets (Az1, Az2), and other geometric parameters.

VIABILITÀ  
DI ACCESSO

Table with 4 columns: Accesso Casa VERTICE AcCasa.1, Accesso Casa VERTICE AcCasa.2, Accesso Casa VERTICE AcCasa.3, Accesso Casa VERTICE AcCasa.4. Each column contains technical data for an access point, including coordinates (X, Y), radii (R), tangents (T), and offsets (Az1, Az2).

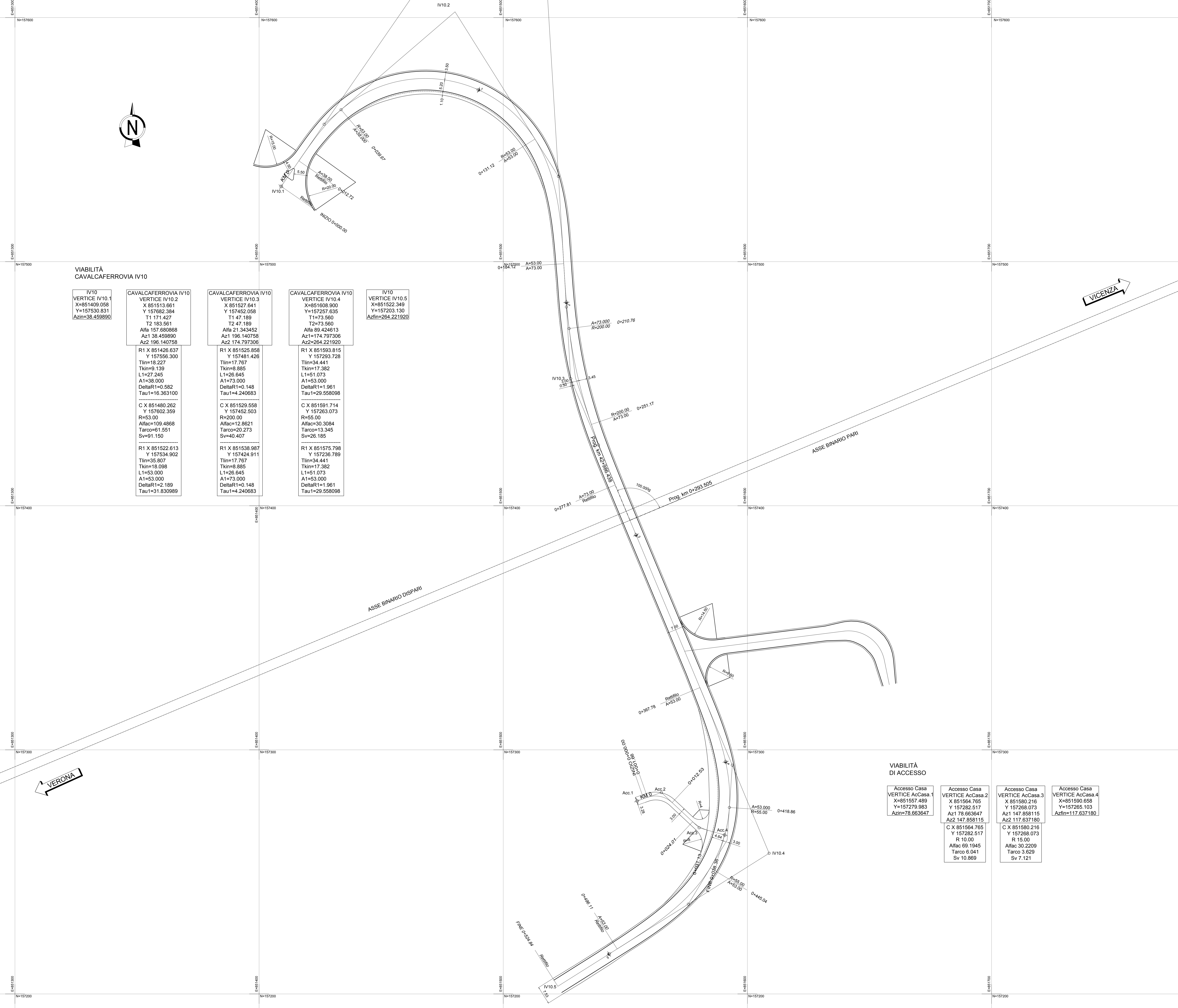

COMMITTENTE: RFI  
RETE FERROVIARIA ITALIANA  
GRUPPO FERROVIE DELLO STATO

ALTA Sorveglianza: ITALFERR  
GRUPPO FERROVIE DELLO STATO

GENERAL CONTRACTOR: Consorzio IricAV Due

**INFRASTRUTTURE FERROVIARIE STRATEGICHE DEFINITE DALLA  
LEGGE OBIETTIVO N. 443/01**  
**LINEA A.V. /A.C. TORINO-VENEZIA Tratta VERONA-PADOVA**  
**Lotto funzionale Verona-Bivio Vicenza**  
**PROGETTO ESECUTIVO**  
IV - CAVALCAFERROVIA  
IV10 - CAVALCAFERROVIA AL Km 42+986.44  
GENERALE

Approval and project information section. Includes a table for 'GENERAL CONTRACTOR' with fields for project name, date, and signature. Below it is a 'VISTO CONSORZIO IRICAV DUE' section with a signature and date. A table shows the project's revision history (Rev. A, B, C) with columns for description, budget, verification, and approval. At the bottom, there are fields for project code (CUP: J11E1000000009) and file name.