

PROGRESSIVA 0+000.000

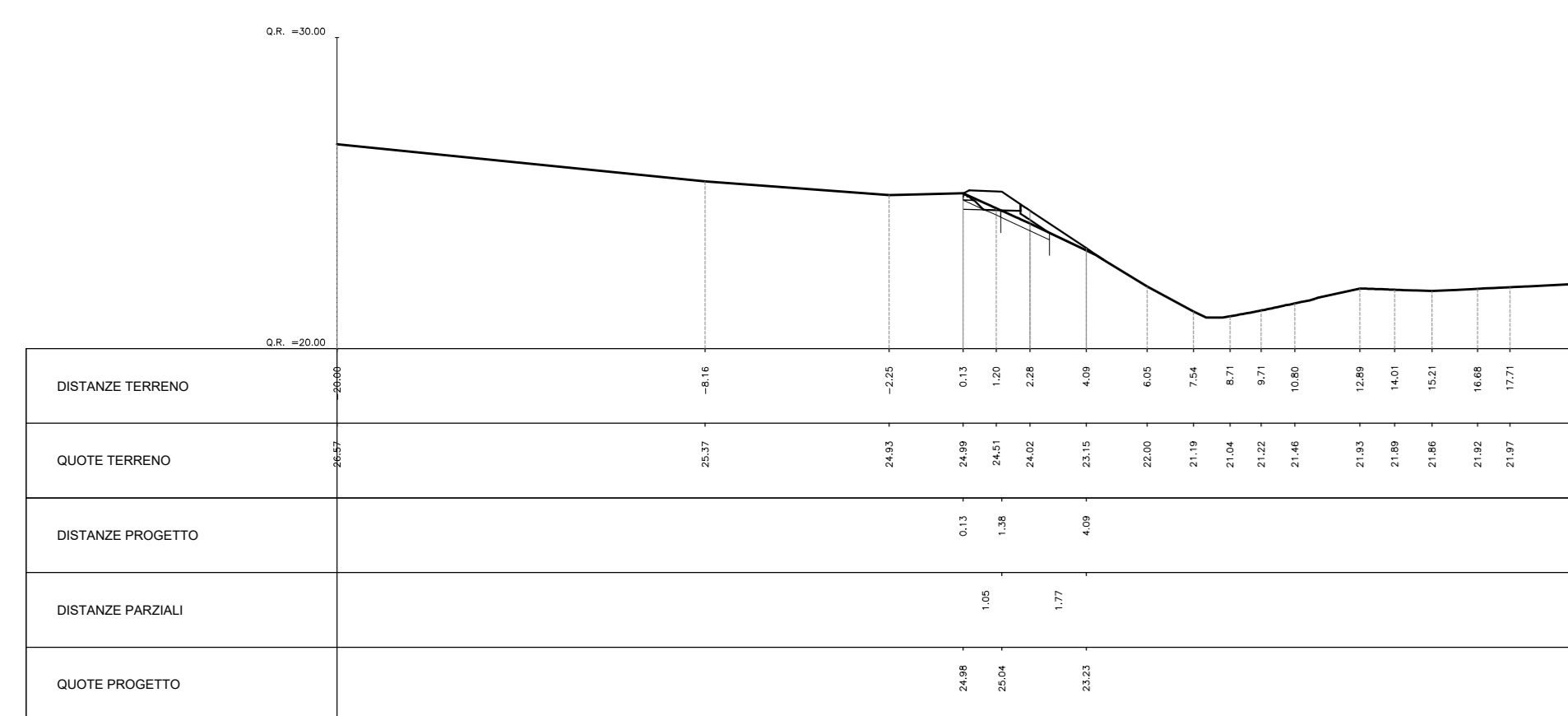

PROGRESSIVA 0+040.000

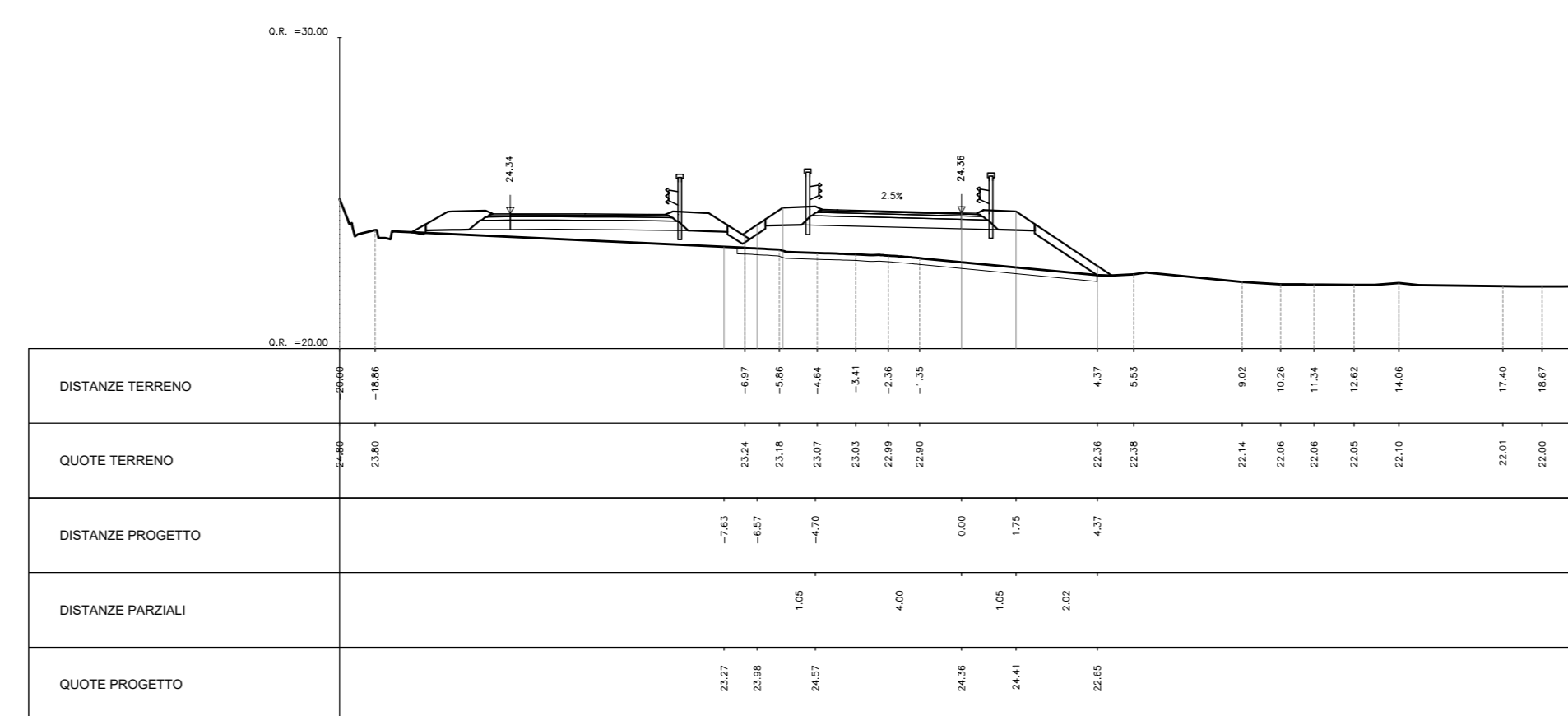

PROGRESSIVA 0+010.000

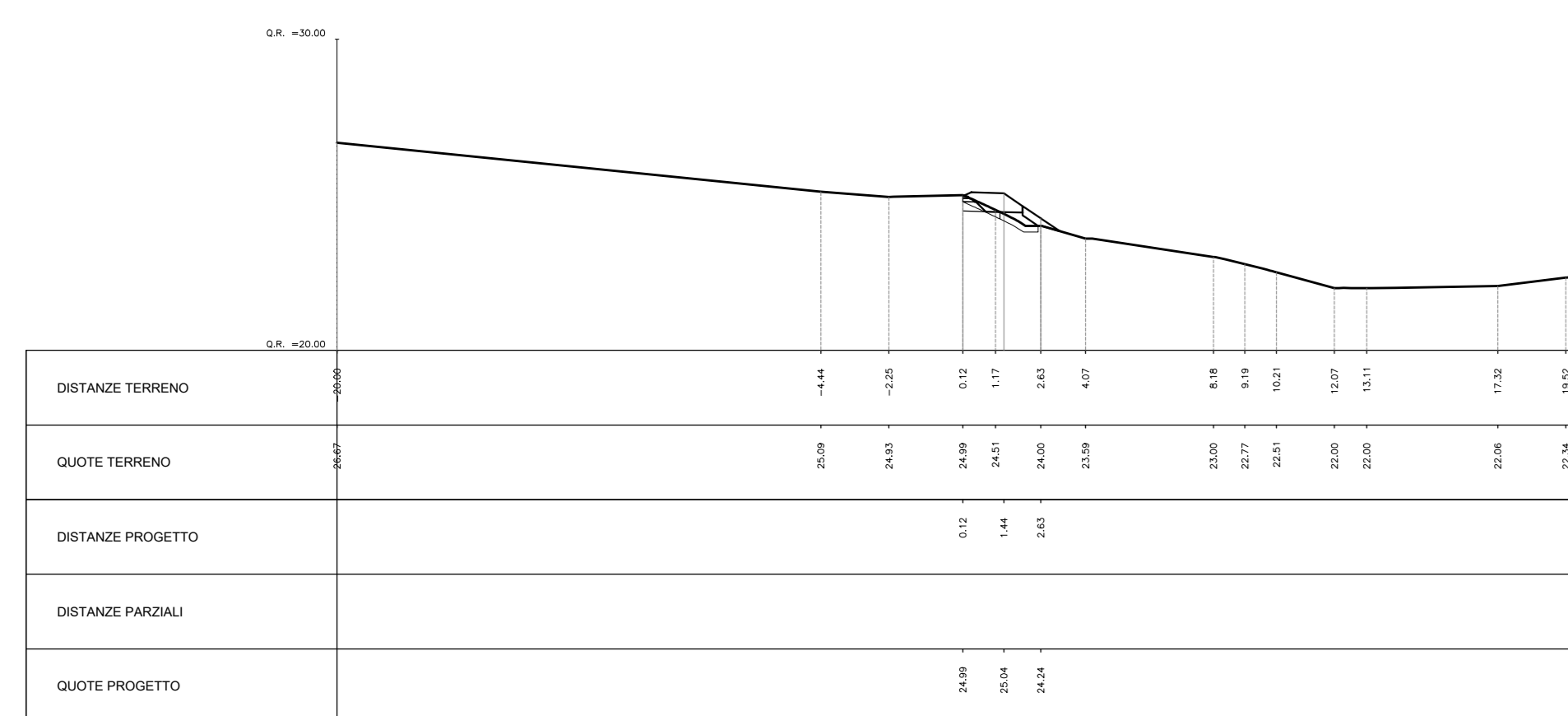

PROGRESSIVA 0+044.000

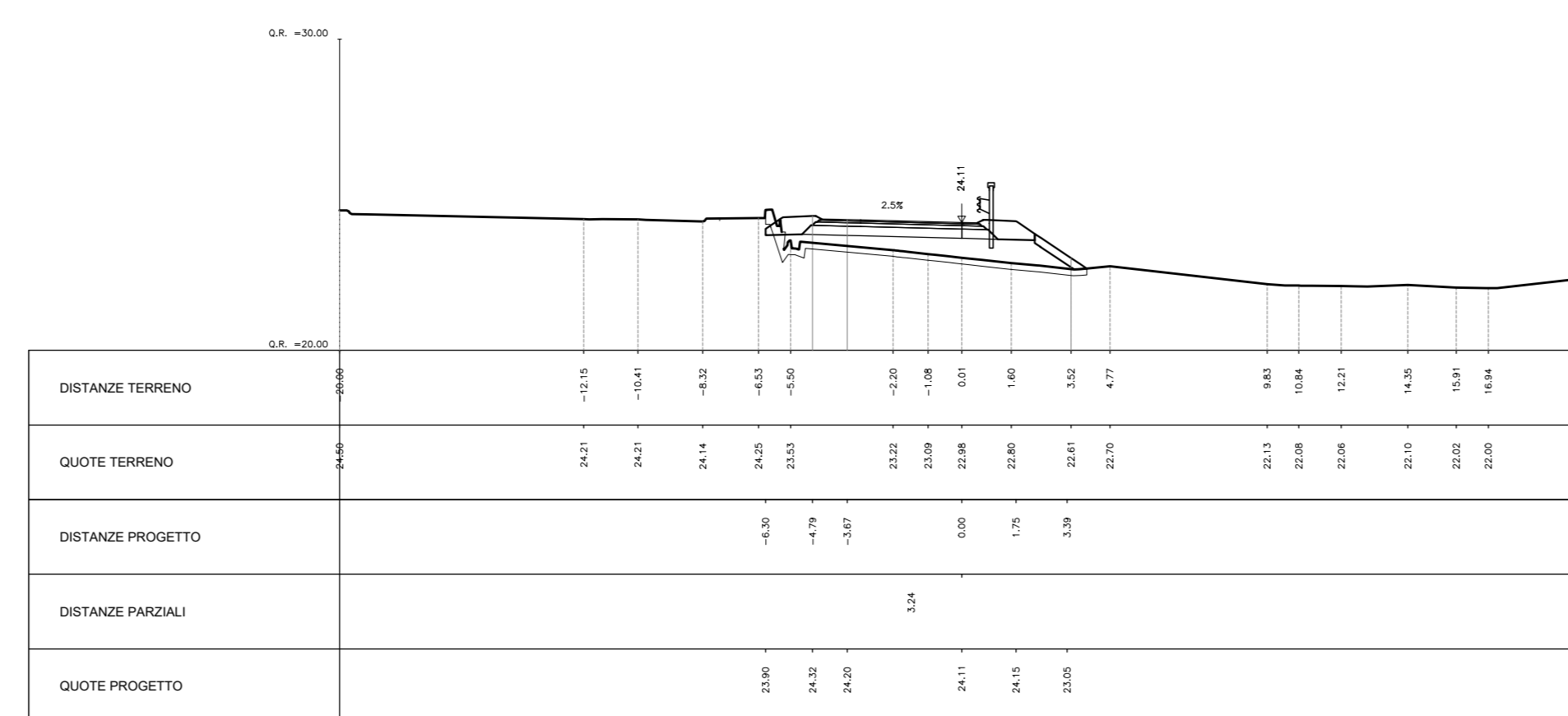

PROGRESSIVA 0+020.000

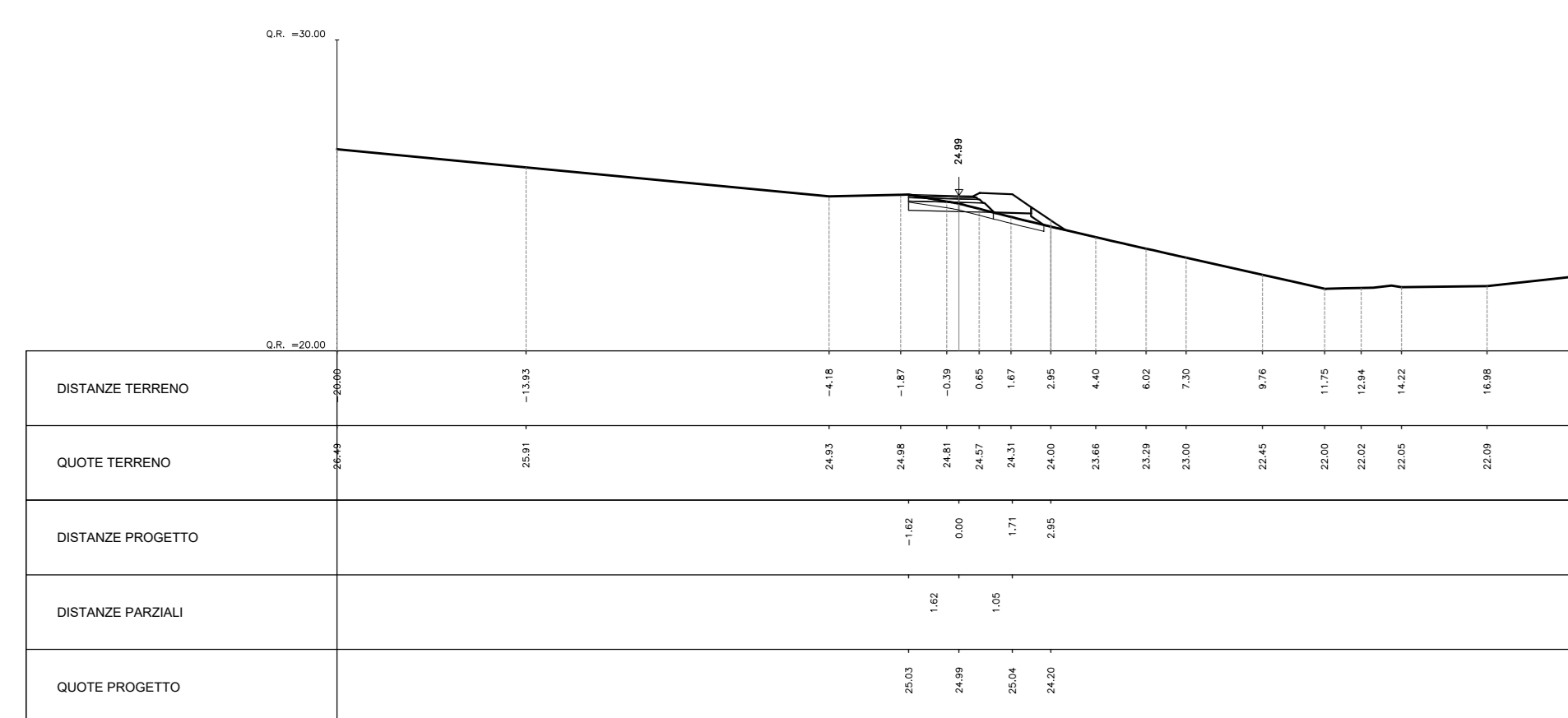

PROGRESSIVA 0+052.700

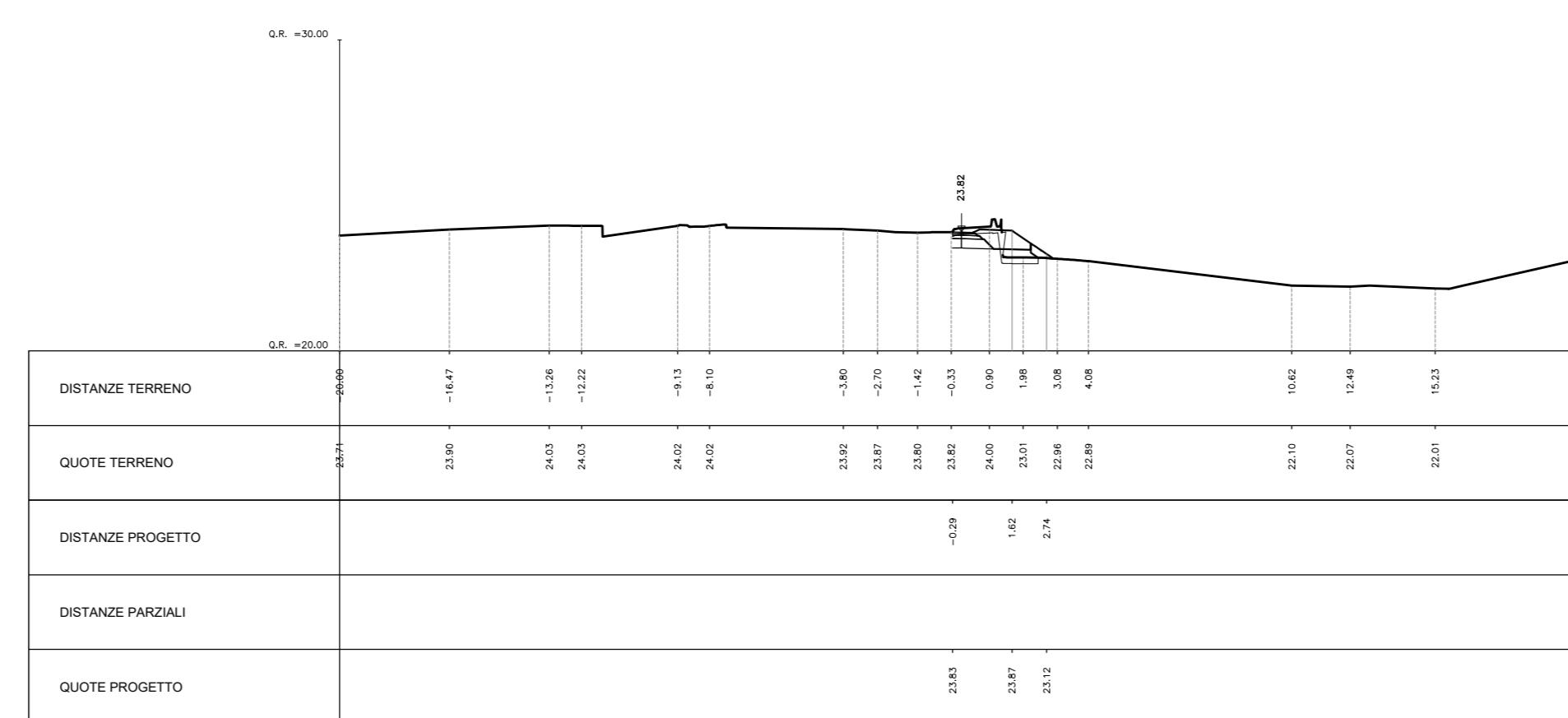

PROGRESSIVA 0+030.000

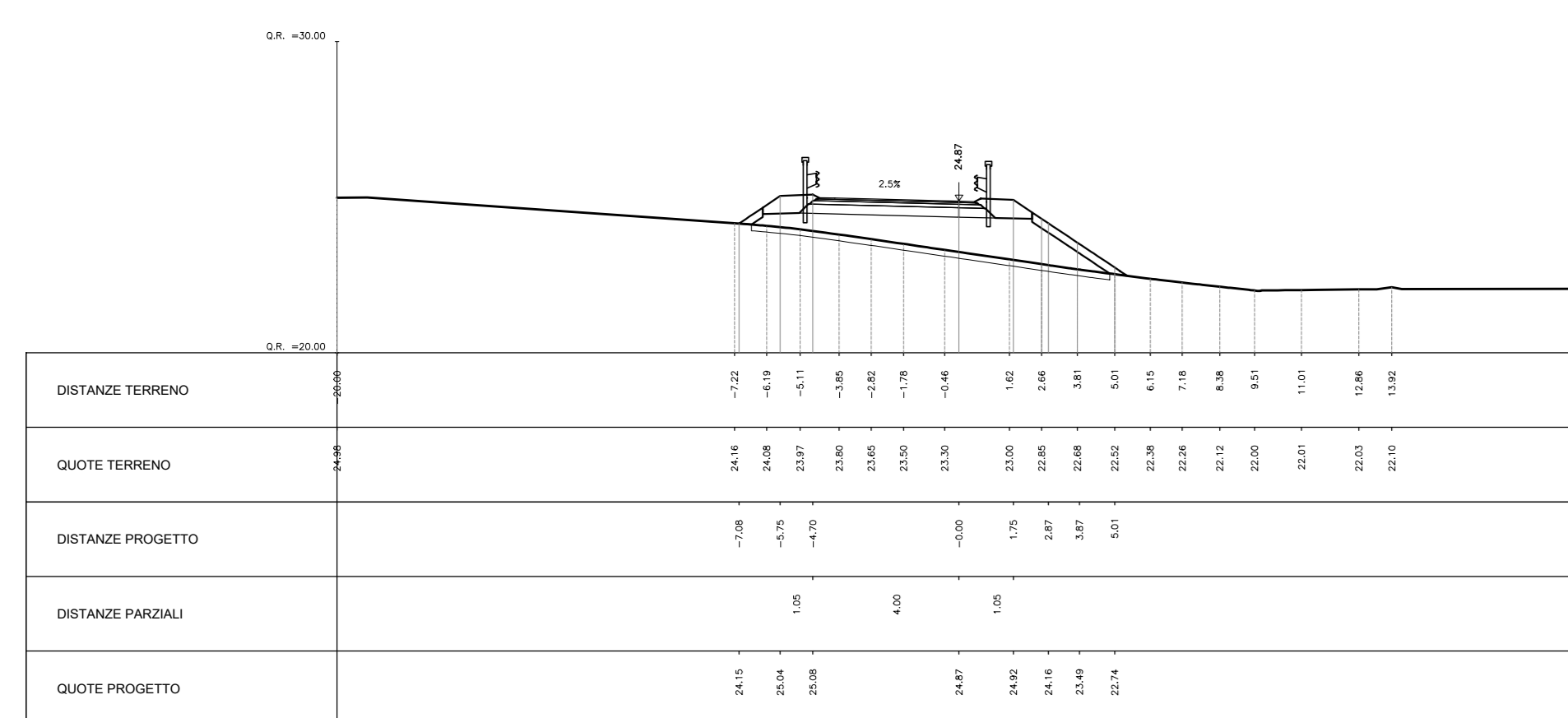

APPALTATORE:
CONSORZIO MESSINA CATANIA LOTTO NORD

 PROGETTAZIONE: RTI - Rocksoil SpA, Proger SpA, Pini Swiss Engineers srl
 PROGETTO ESECUTIVO

SVINCOLO TEMPORANEO DI ACCESSO ALL'AUTOSTRADA A18
 (km 18+300) - COMUNE DI NIZZA
 PROGETTO STRADALE
 Sezioni Trasversali - Tav. 8

APPALTATORE Il Direttore Tecnico Ing. P.M. Gianvecchio		PROGETTISTI Ing. F. Calabrese		SCALA: 1:200			
COMMESSA	LOTTO	FASE	ENTE	TIPO DOC.	OPERA/DISCIPLINA	PROGR.	REV.
RS50	02	E	ZZ	W9	N14100	008	A
Rev.	Descrizione	Redatto	Data	Verificato	Data	Approvato	Data
A	Emissione	R. Maggione	Gen. 2024	F. Calabrese	Gen. 2024	C. Latorre	Gen. 2024
B							
C							
D							
File: RSO02ZZV9N4100008A.dwg							n. Elib.: