



Collegamento autostradale Asti – Cuneo – Tronco Il Lotto 6 Roddi – Diga Enel
VERIFICA DI ASSOGGETTABILITA' EX ART. 20 D.LGS. 152/06
RUMORE - Analisi ambientale opere in variante

ALLEGATO 3

**LIVELLI DI PRESSIONE SONORA COMPLESSIVA - MAPPA H=4
M PERIODO DIURNO/NOTTURNO - FASE 1**

LEGENDA

Codifica ricettore

XX001 — n° progressivo
comune

RO=Roddi GU=Guarene AL=Alba

CH=Cherasco MO=La Morra VE=Verduno

Ambito di studio cantieri (m)

500 ————— ambito di indagine
500 —————

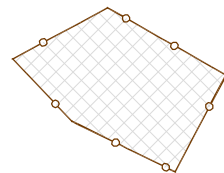

aree di cantiere

Livelli di rumore (dBA)

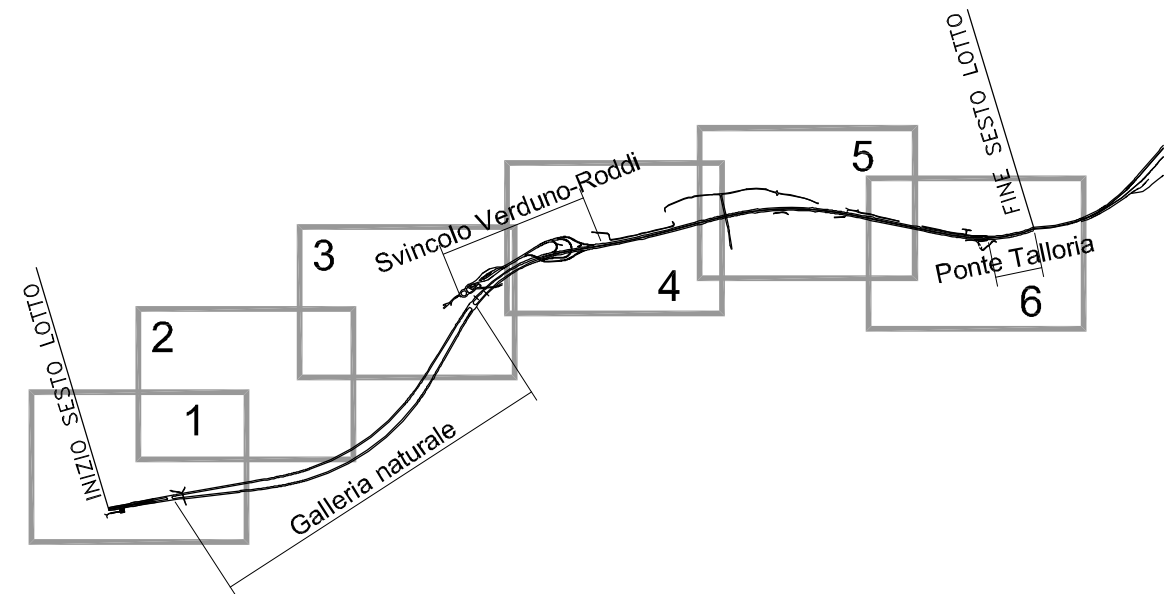
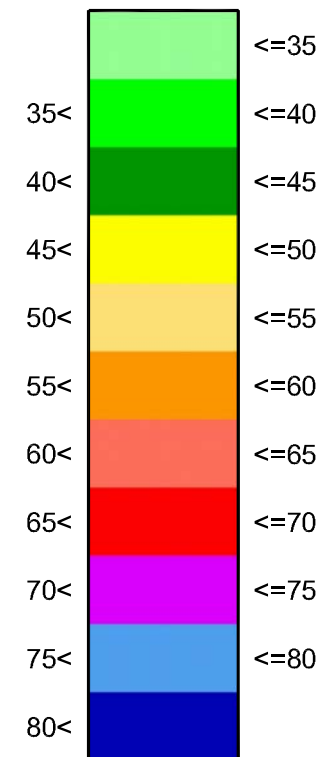

QUADRO D'UNIONE



SCALA 1:5000

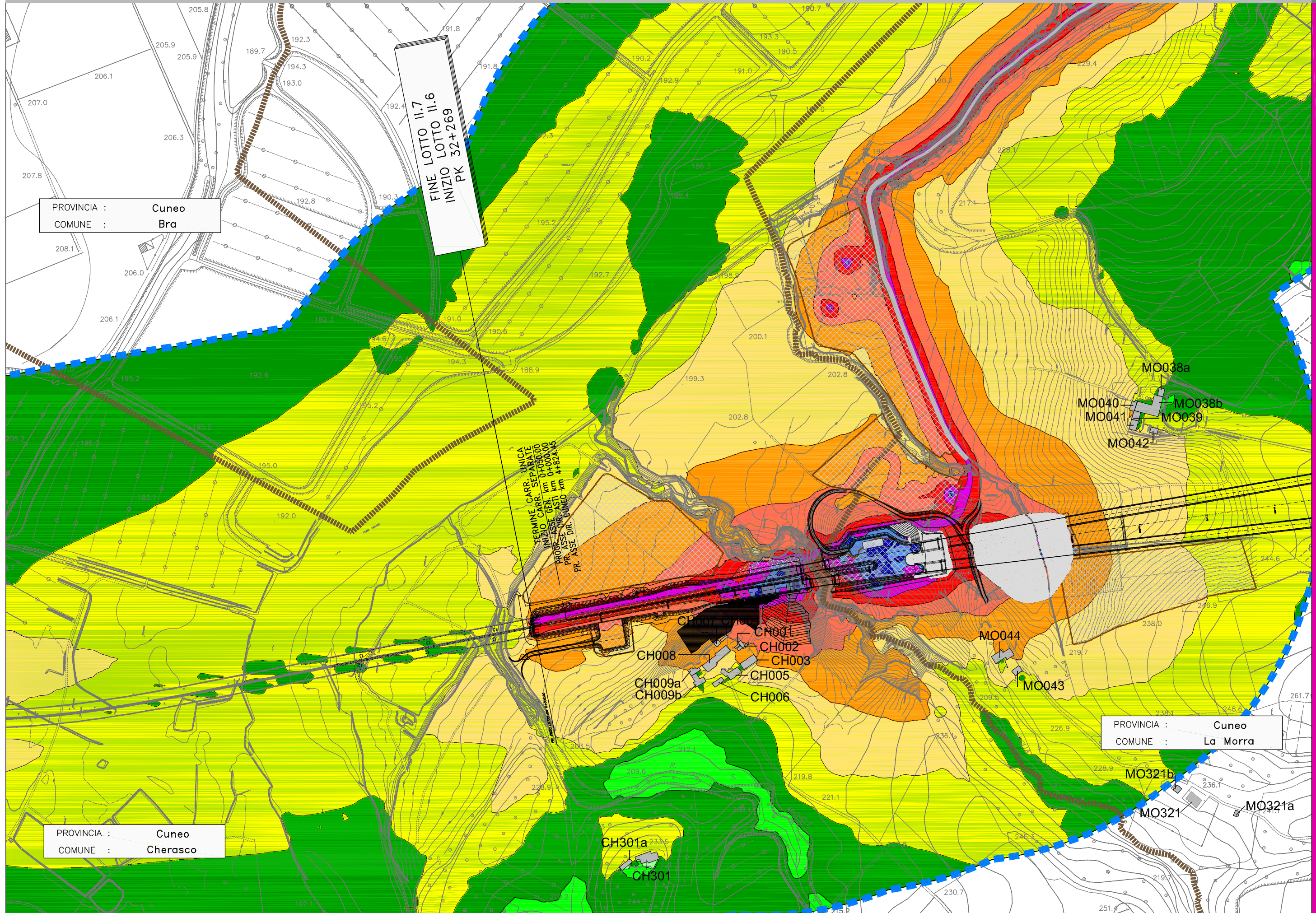

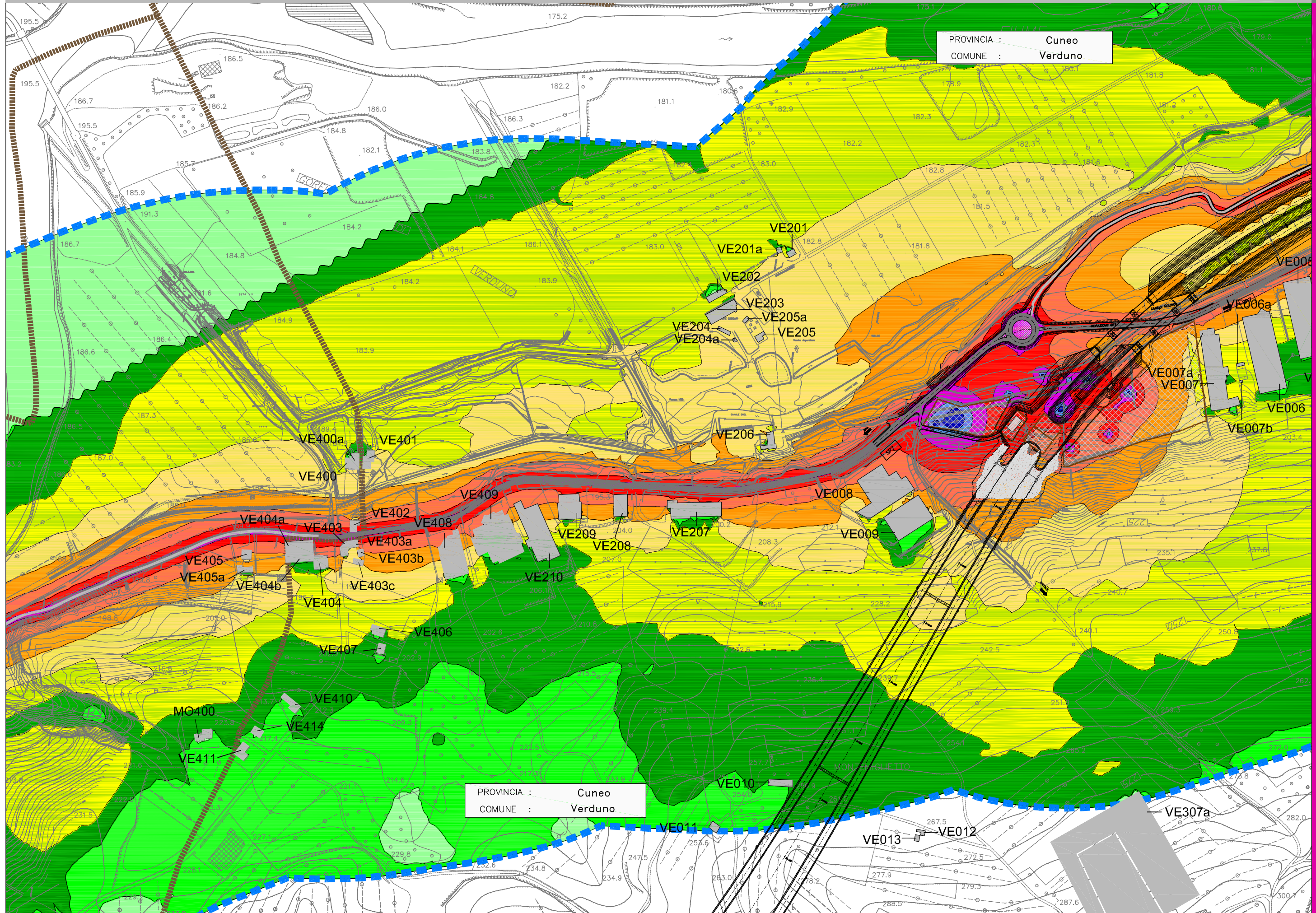

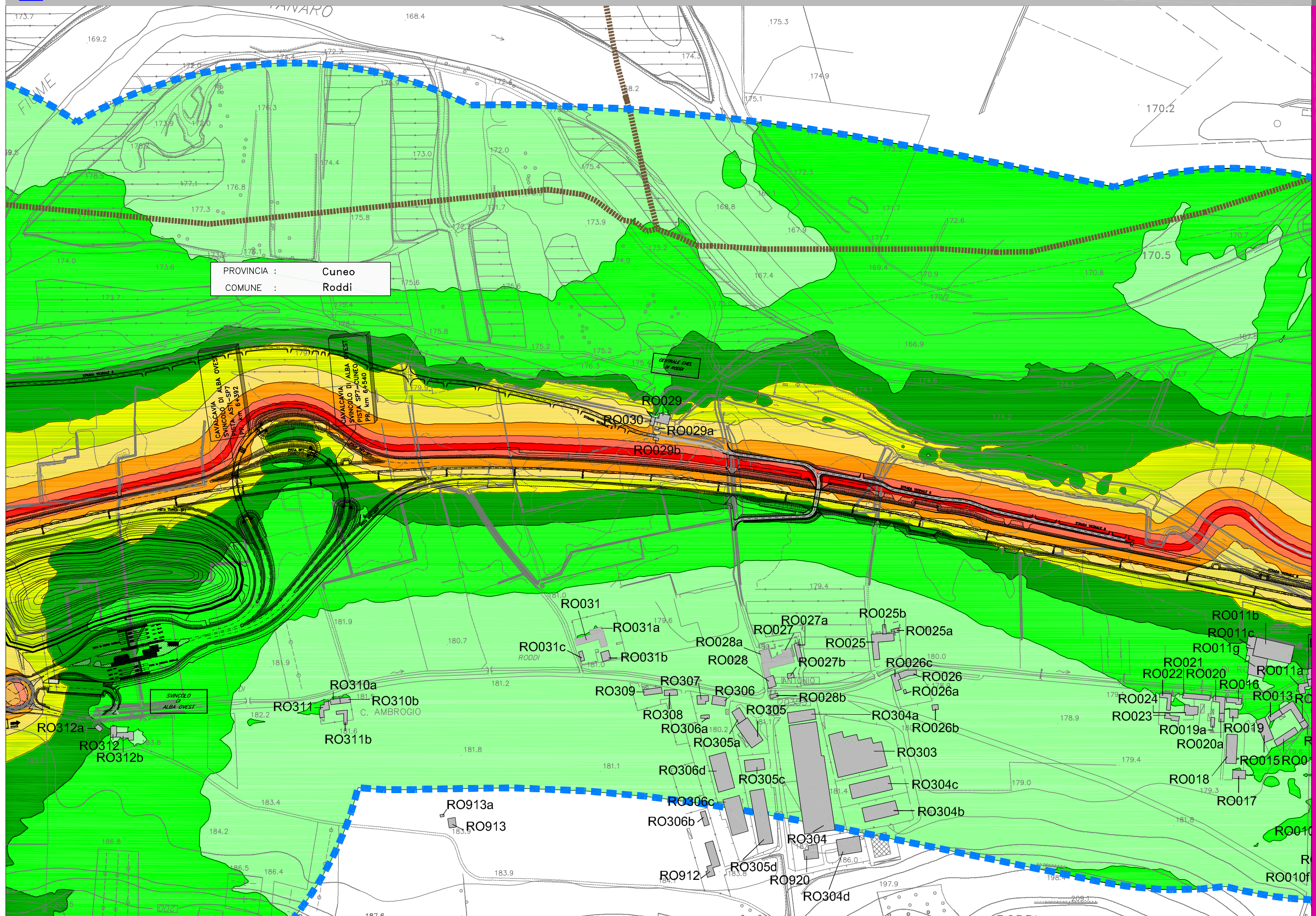

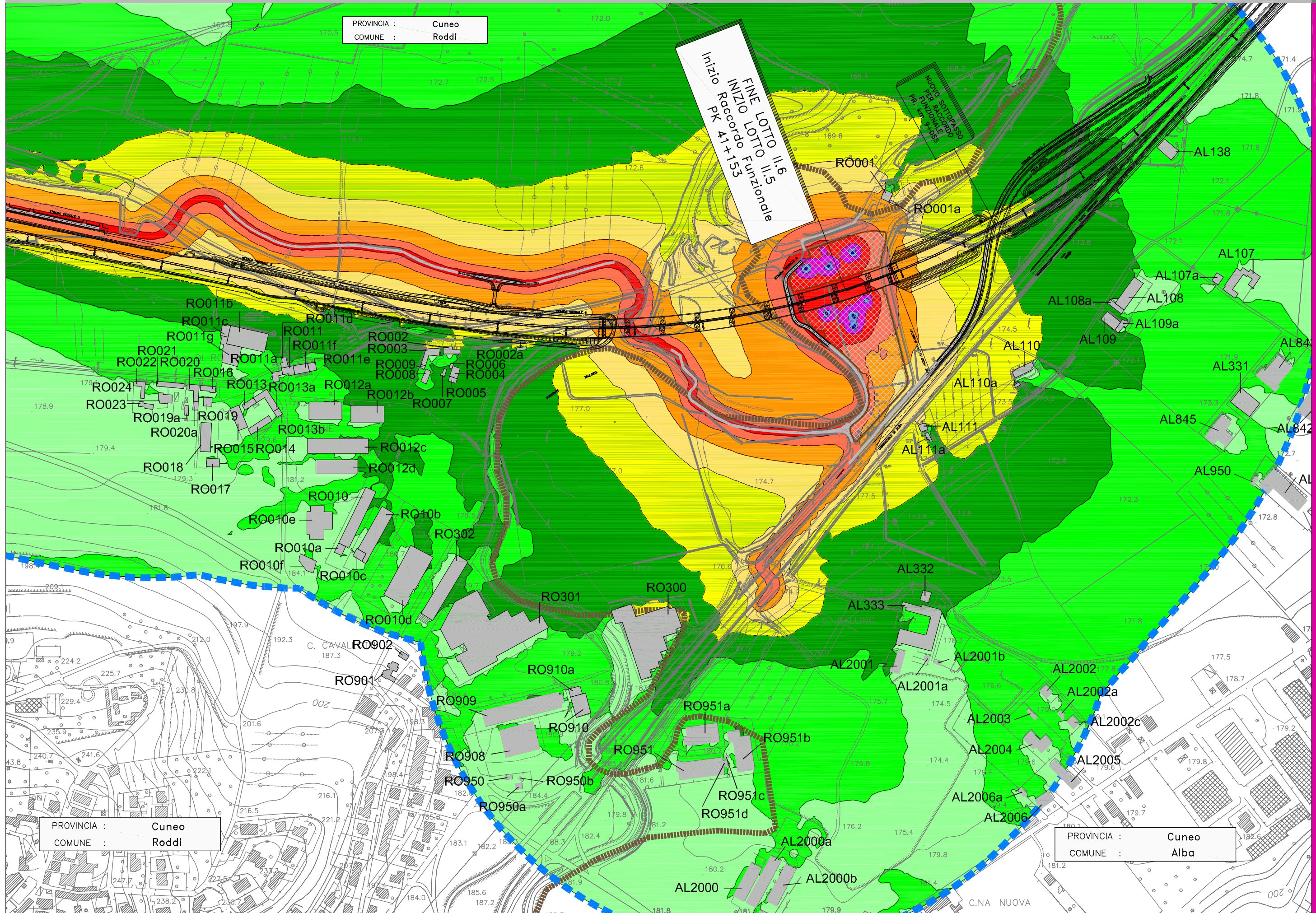

LEGENDA

Codifica ricettore

XX001 — n° progressivo
comune

RO=Roddi GU=Guarene AL=Alba

CH=Cherasco MO=La Morra VE=Verduno

Ambito di studio cantieri (m)

500 ————— ambito di indagine
500 —————

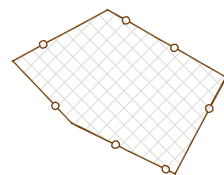

aree di cantiere

Livelli di rumore (dBA)

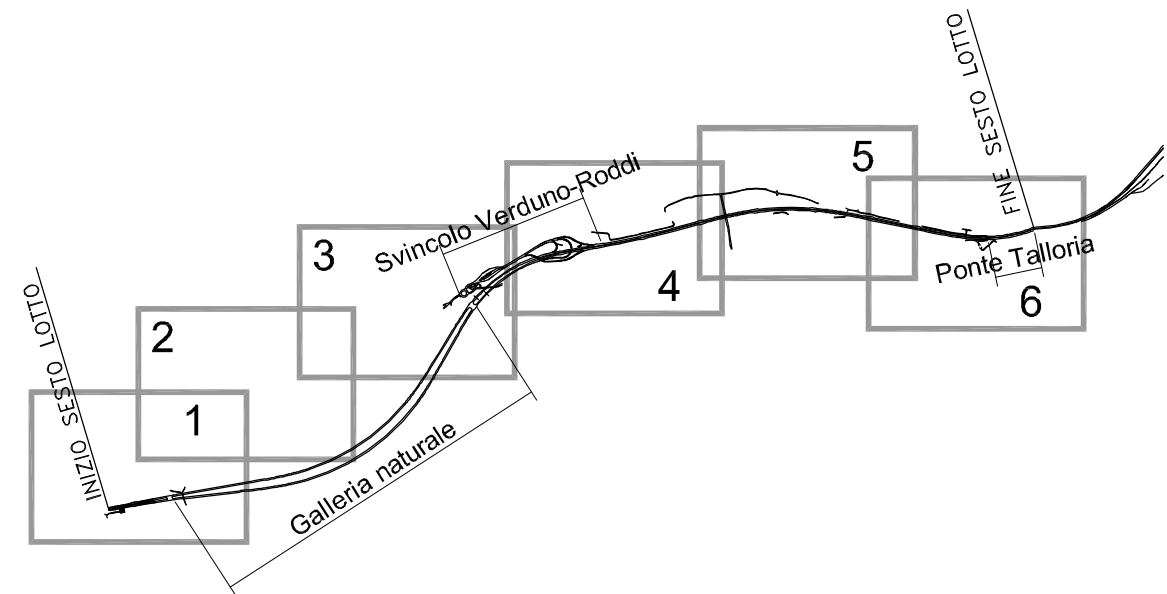
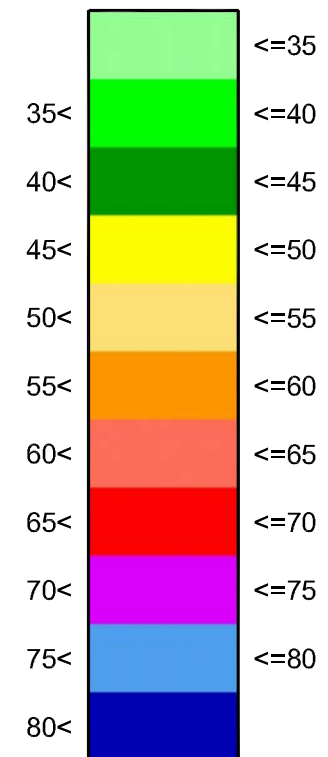

QUADRO D'UNIONE



SCALA 1:5000

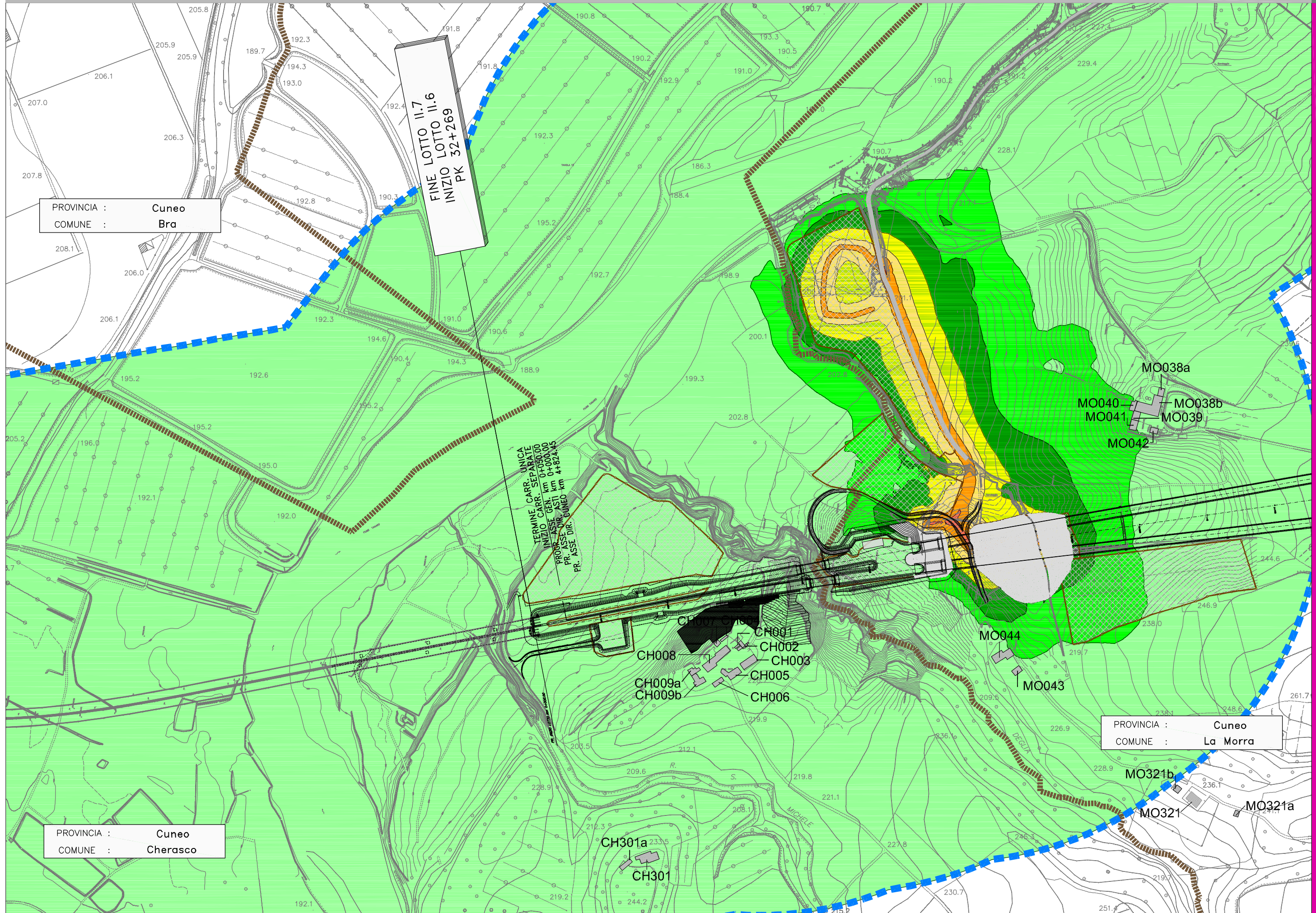

PROVINCIA : Cuneo
COMUNE : Bra

FINE LOTTO 11.7
LOTTO 11.6
INIZIO LOTTO 11.6
PK 32+269

TERMINI CARR. UNICA
INIZIO CARR. SEPARATE
PROV. ASSE GEN. km 0+000,00
PR. ASSE DIR. ASTI km 0+000,45
PR. ASSE DIR. CUNEO km 4+824,45

PROVINCIA : Cuneo
COMUNE : La Morra

PROVINCIA : Cuneo
COMUNE : Cherasco

LIVELLI DI PRESSIONE SONORA COMPLESSIVA Leq(22-6) Fase 1

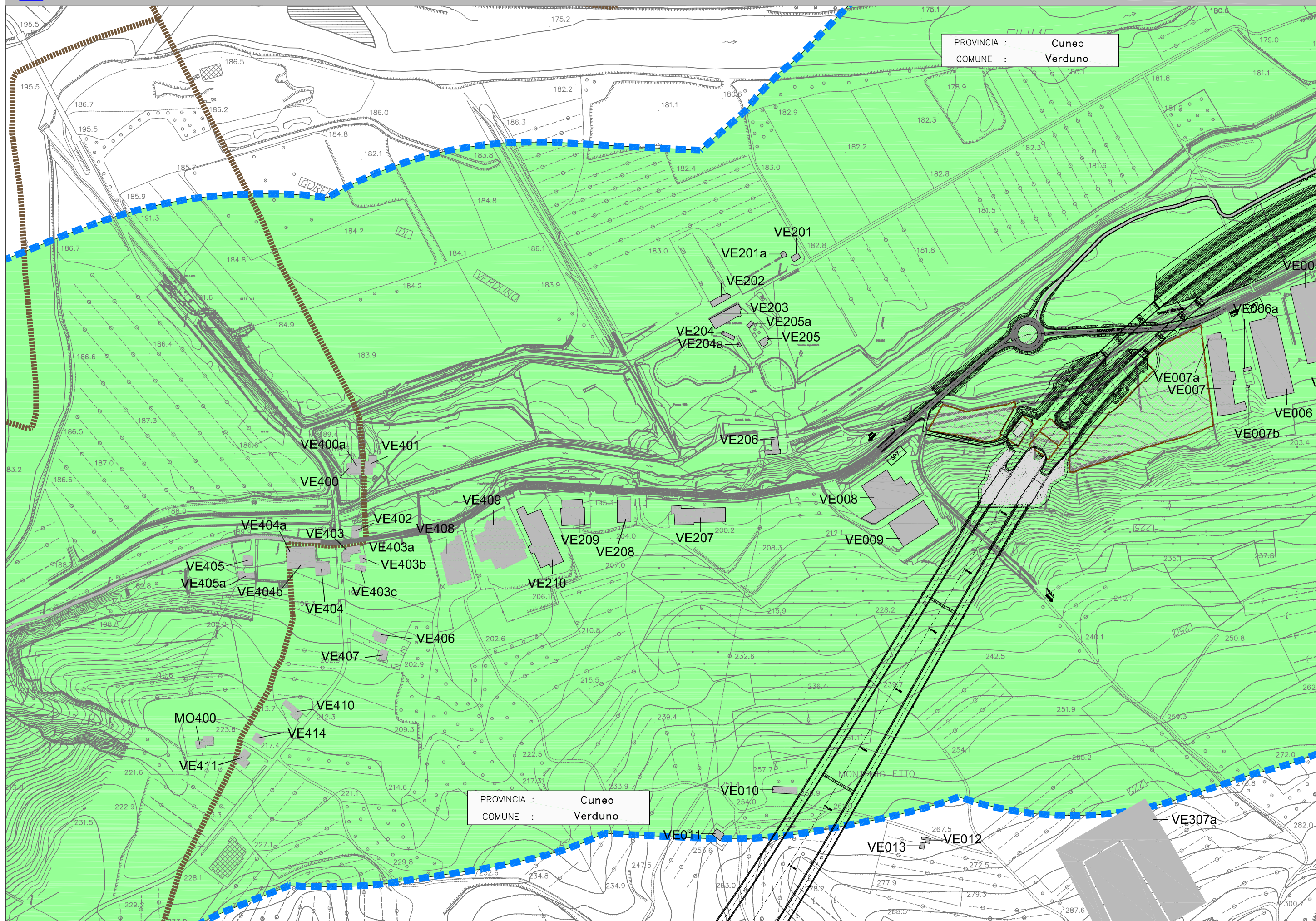

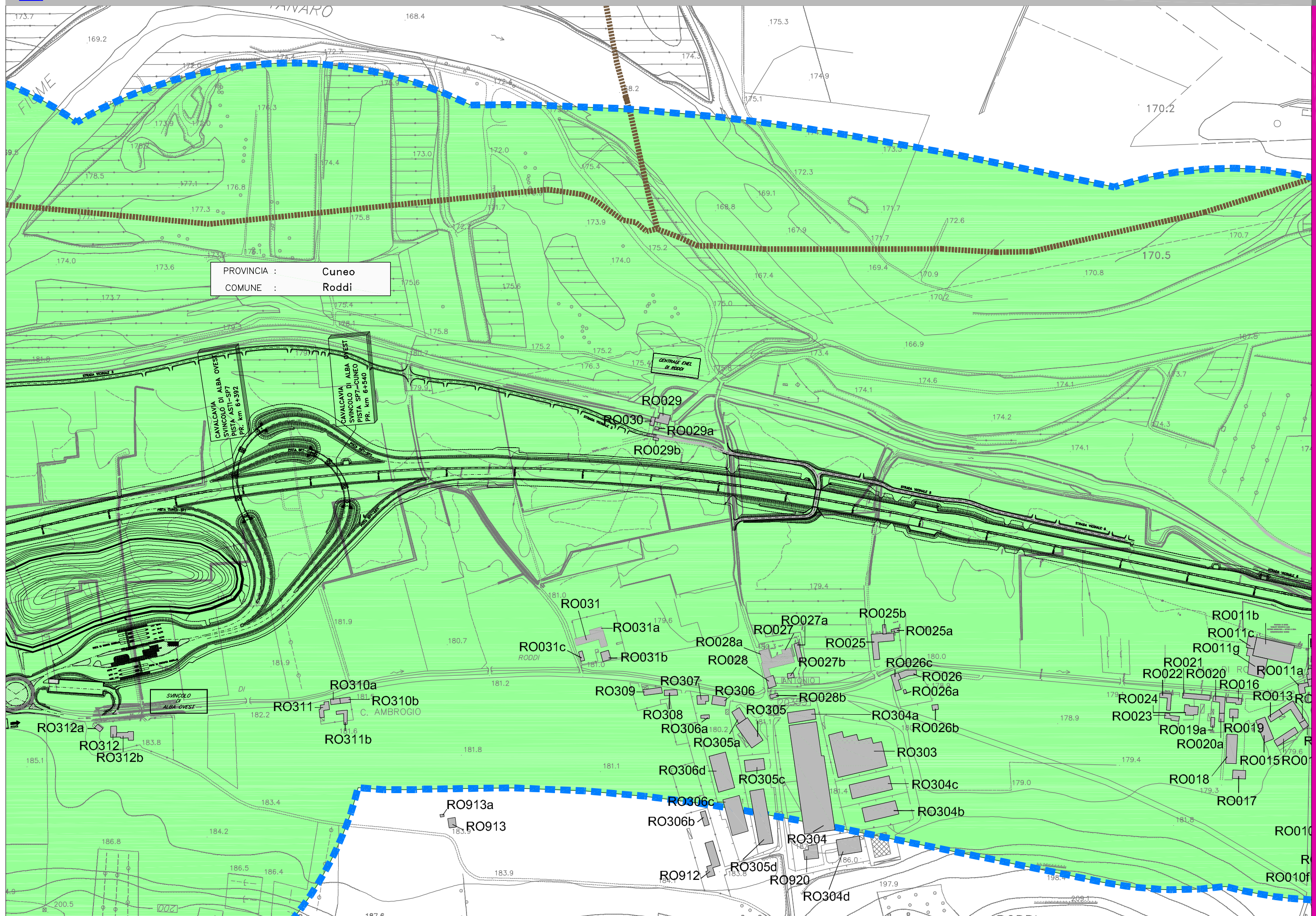

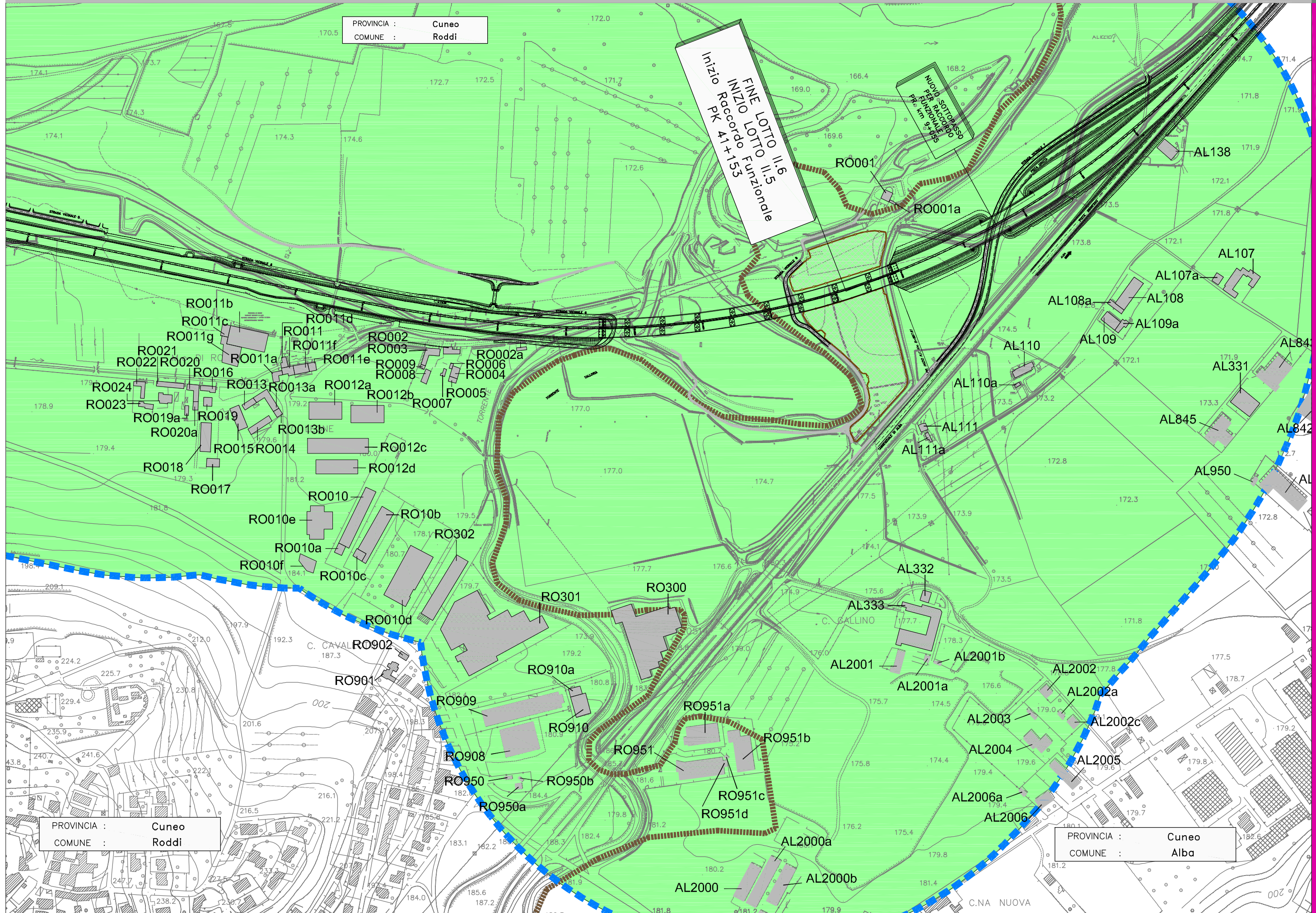

PROVINCIA : Cuneo
COMUNE : Roddi

FINE LOTTO II.6
INIZIO LOTTO II.5
Inizio Raccordo Funzionale
PK 41+153

NUOVO SOTTOPASSO
PER RACCORDO
FUNZIONALE
PR. Km 9+495

PROVINCIA : Cuneo
COMUNE : Roddi

PROVINCIA : Cuneo
COMUNE : Alba