

PROFILO LONGITUDINALE MURO OS34

SCALA 1:200

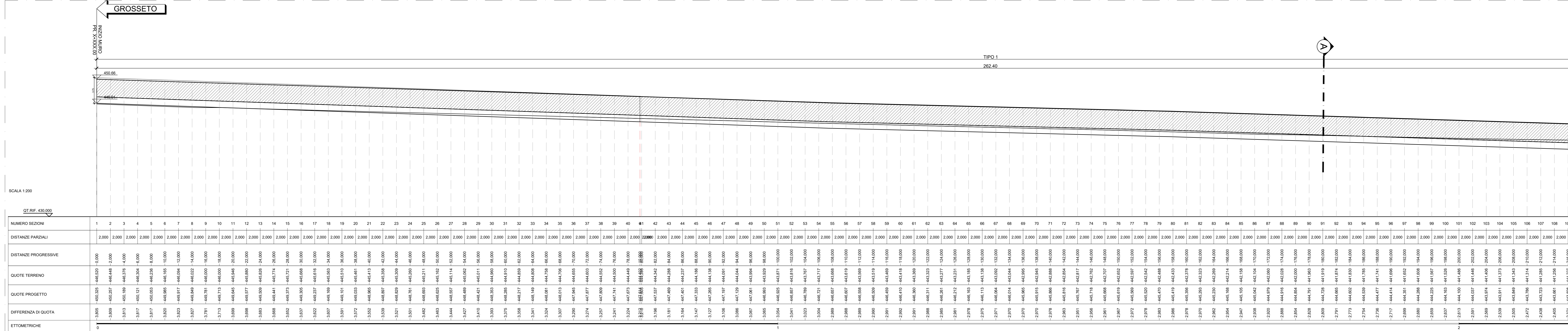

SCALA 1:200

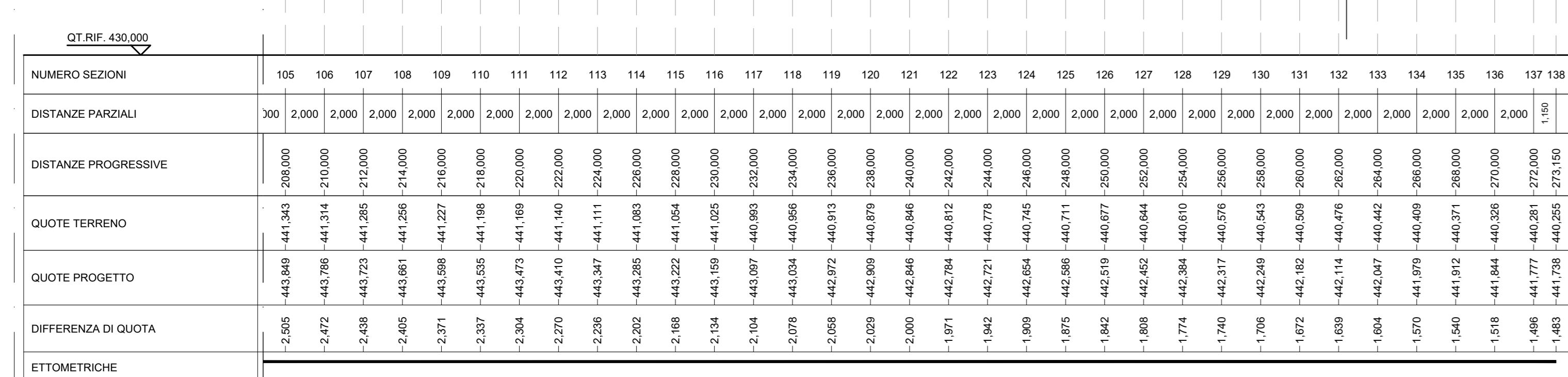

SEZIONE A-A TIPO 1

SCALA 1:100

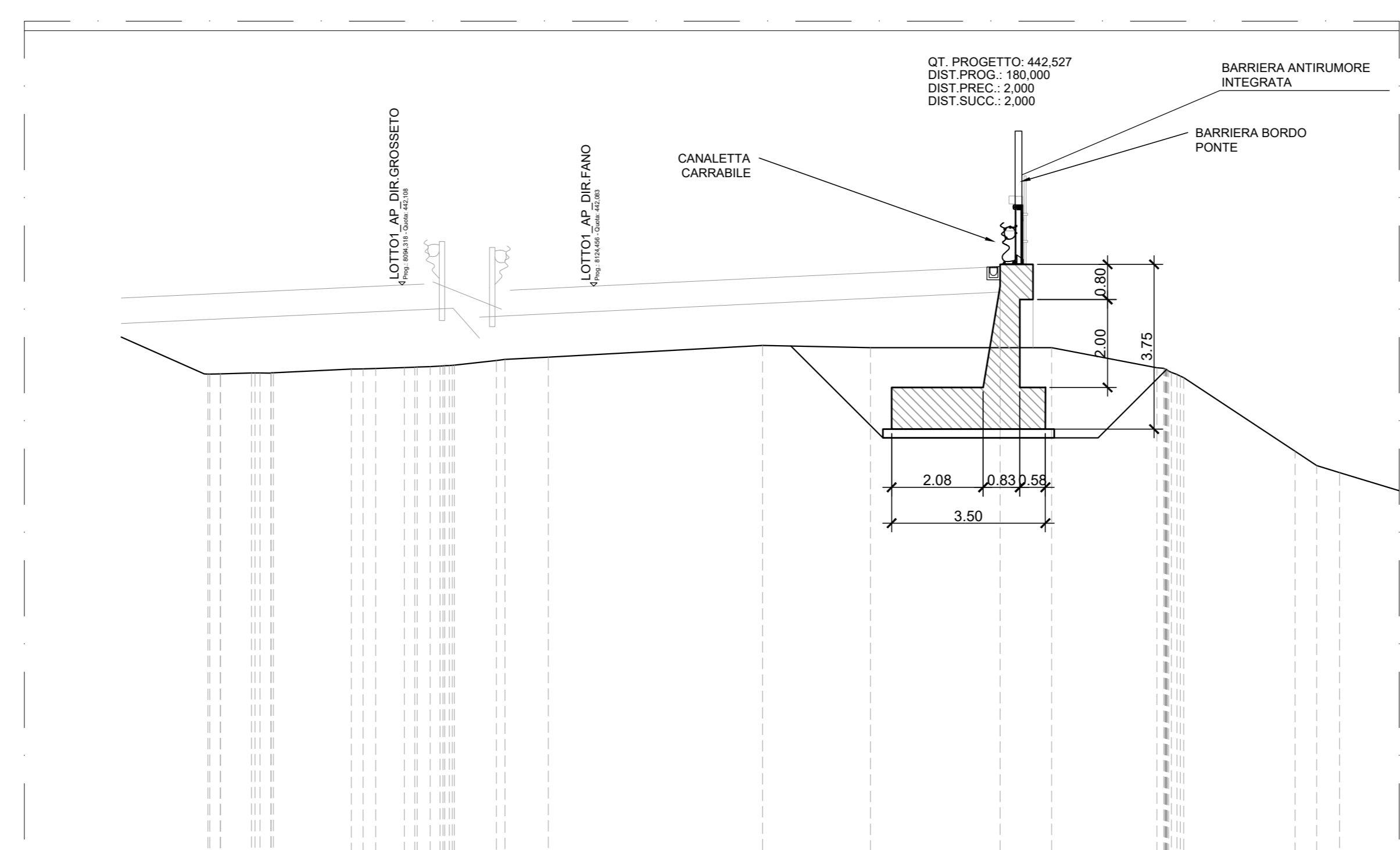

SCALA 1:100

Table with 7 columns: QUOTE TERRENO, DIST PARZIALI TERRENO, ASSI ESTERNI, DIST PARZIALI PROGETTO, QUOTE USURA, and DIST PARZIALI USURA. It provides numerical data for each section of the wall.

Table titled 'INCIDENZA ARMATURA TIPO 1'. It specifies the reinforcement requirements: Elemento (Fondazione) is 80 kg/mc, and Elemento (Elevazione) is 271 kg/mc.

GIUNTO DILATAZIONE

SCALA 1:10



TABELLA MATERIALI

Technical specifications for materials and construction. It details requirements for concrete (C12/15, C32/40), reinforcement (S4, S5), and other materials. It also lists general specifications for the concrete used in the wall.

TIPOLOGICO FASI COSTRUTTIVE MURO IN SCAVO

SCALA 1:100

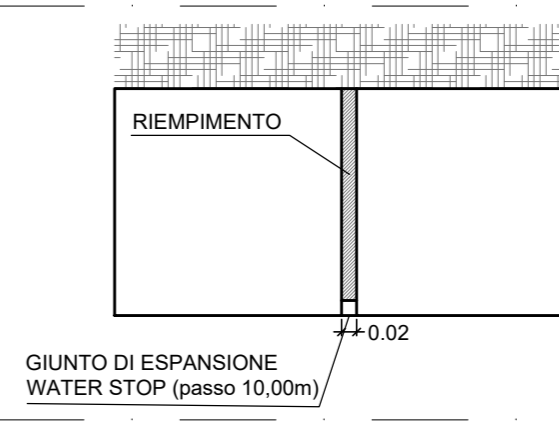
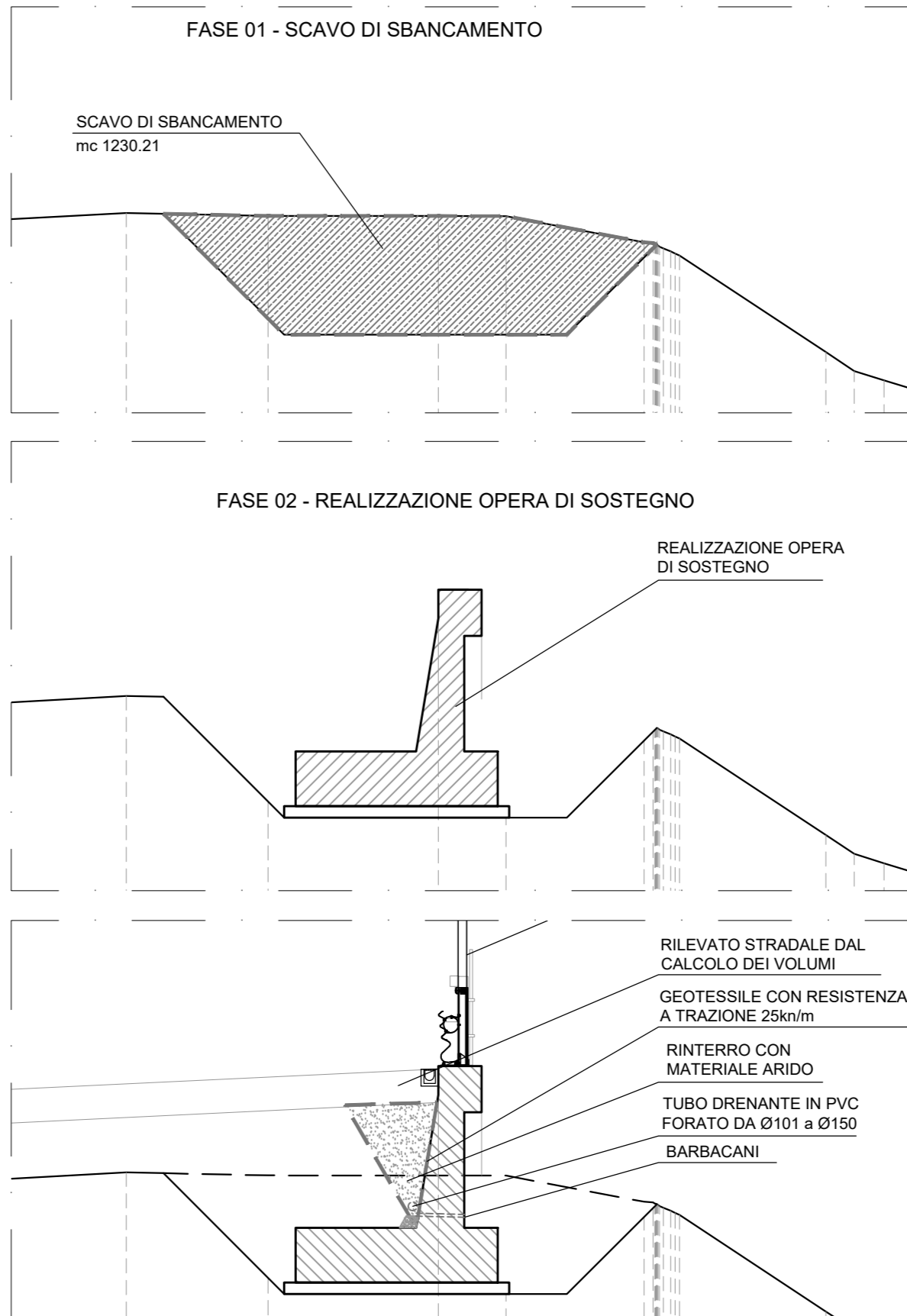

Direzione Progettazione e Realizzazione Lavori

E78 GROSSETO - FANO
Tratto Nodo di Arezzo - Selci - Lama (E45)
Adeguamento a quattro corsie del tratto
San Zeno - Arezzo - Palazzo del Pero, 1° lotto

PROGETTO DEFINITIVO FI 508

ANAS - DIREZIONE PROGETTAZIONE E REALIZZAZIONE LAVORI

Table with project details including the geologist (Dott. Geol. Roberto Selvi), project manager (Ing. Ambrogio Signorini), and other technical staff. It also lists the design and construction firms: GPI INGENGNERIA and engeko.

OPERE D'ARTE MINORI

OPERE DI SOSTEGNO - MURI -
PIANTA PROSPETTO E PARTICOLARI COSTRUTTIVI
OS34 1-2

Table with project identification: CODICE PROGETTO (DPI1508 D 23), NOME FILE (P010S34STRDIO1_B), and REVISIONE (B).

Table with revision details: REVISIONE (B), DATA (Genno '24), REDATTO (Guidobaldi), and APPROVATO (Guiducci).