

PIANTA FONDAZIONI - Scala 1:50

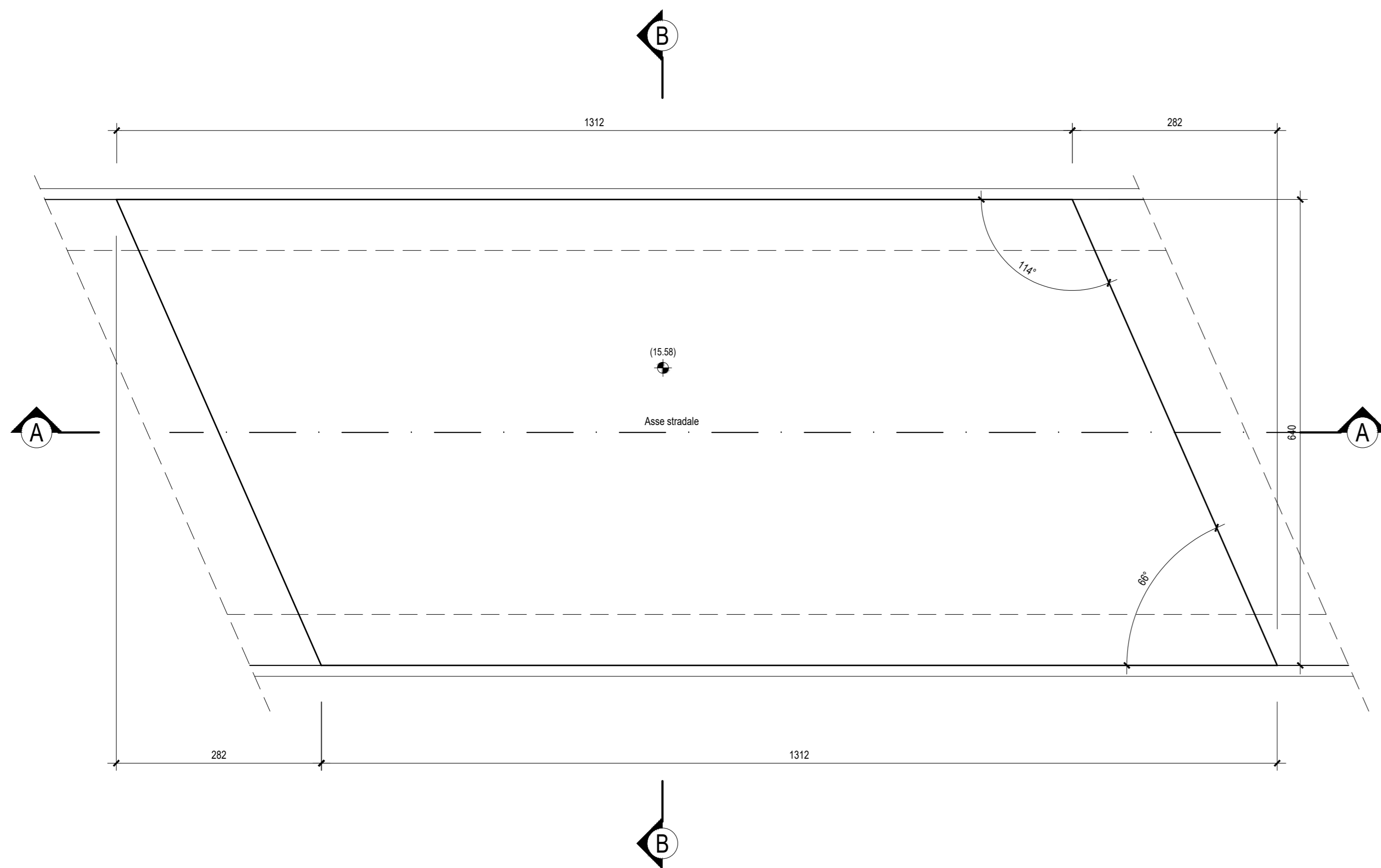

SEZIONE LONGITUDINALE A-A - Scala 1:50

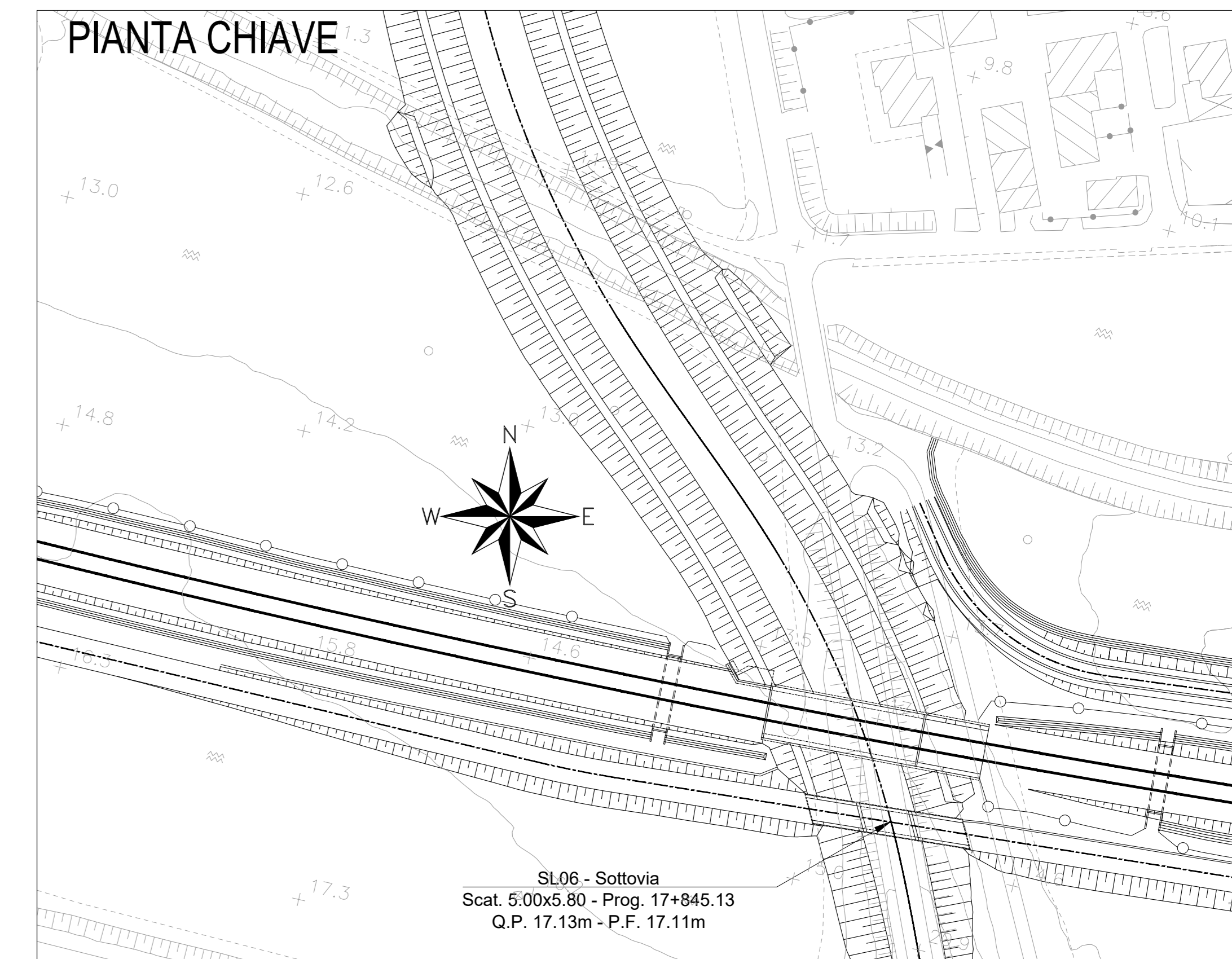
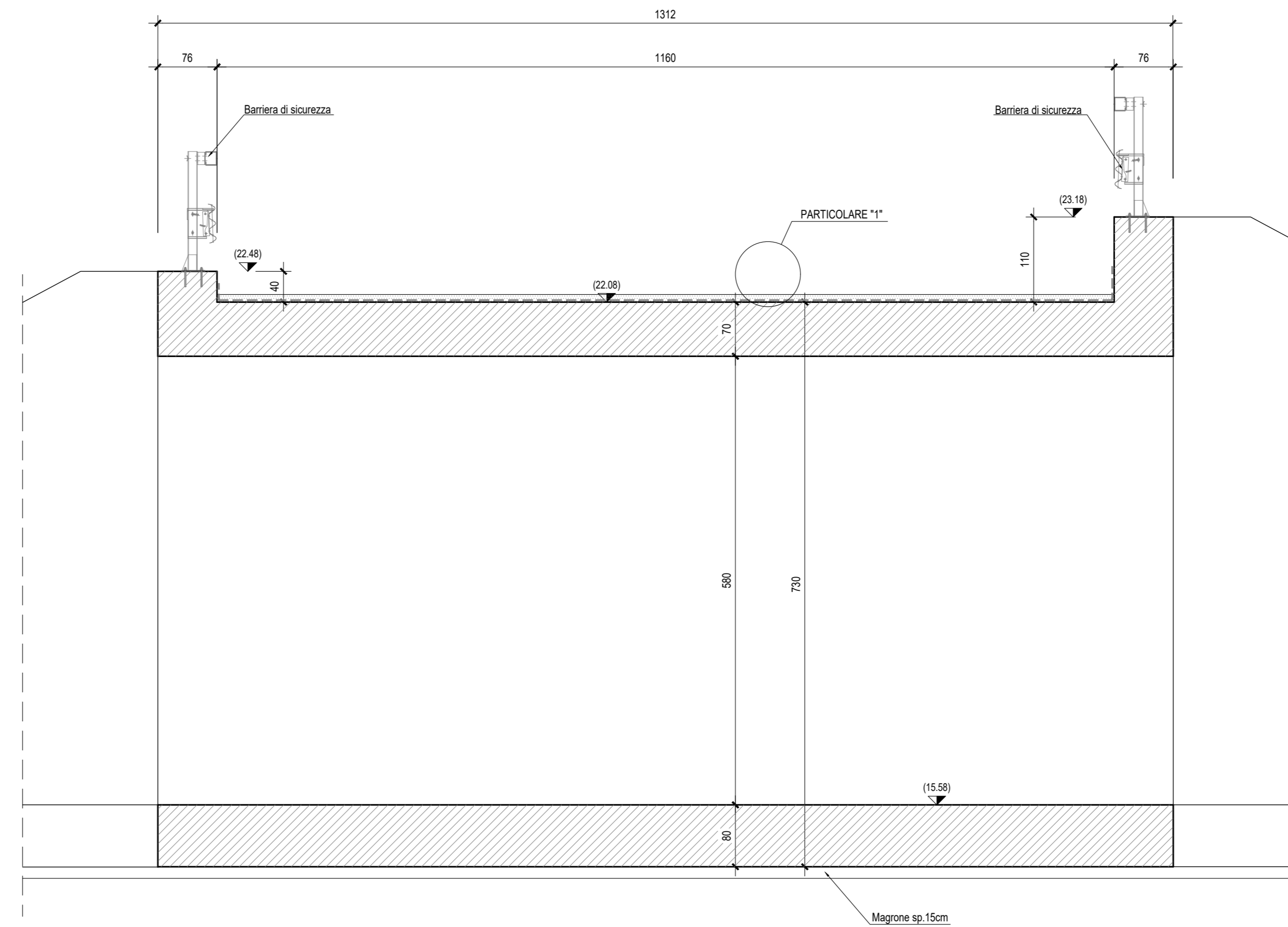

SCHEMA DI POSA IMPERMEABILIZZAZIONE-Scala 1:20
(Doppia guaina bituminosa)

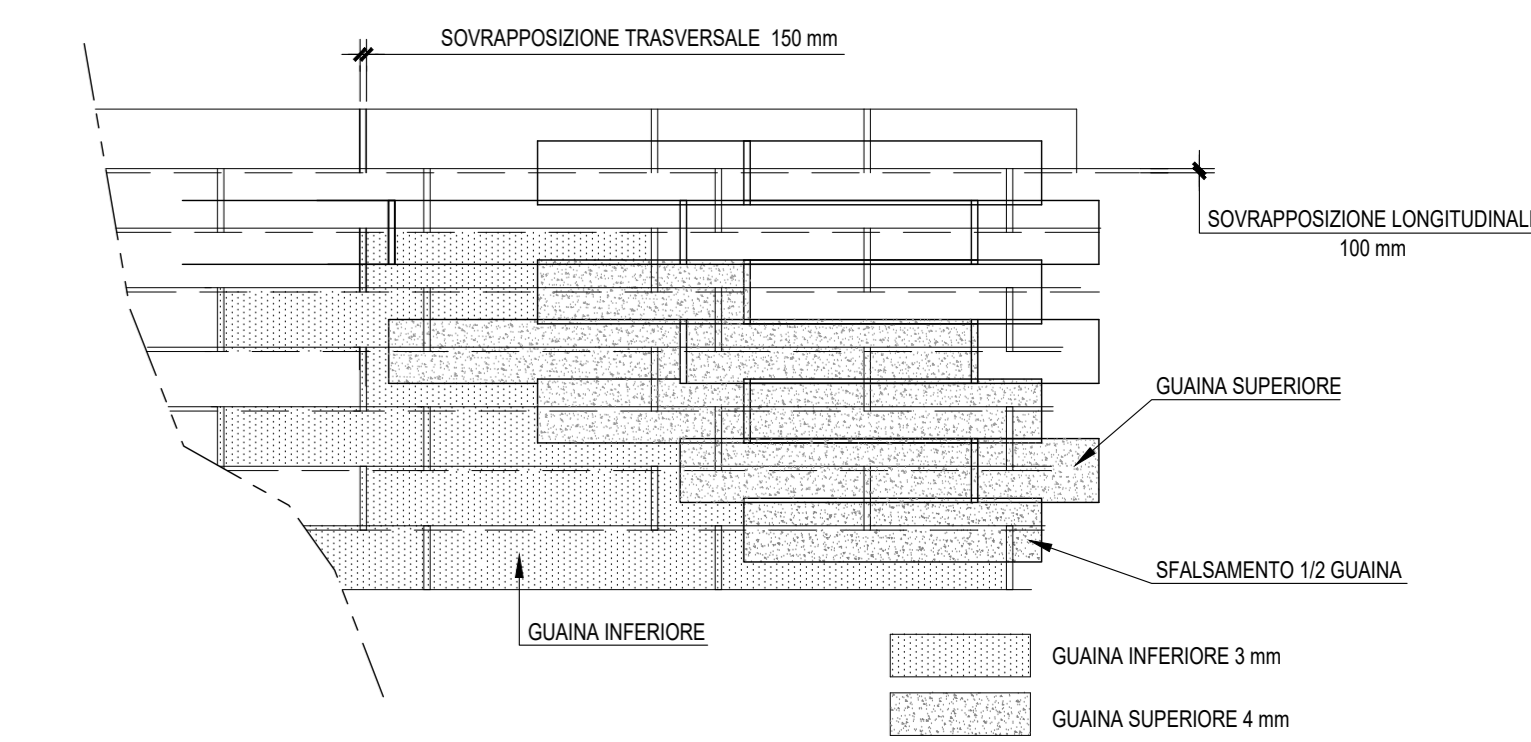

PIANTA SPICCATO - Scala 1:50

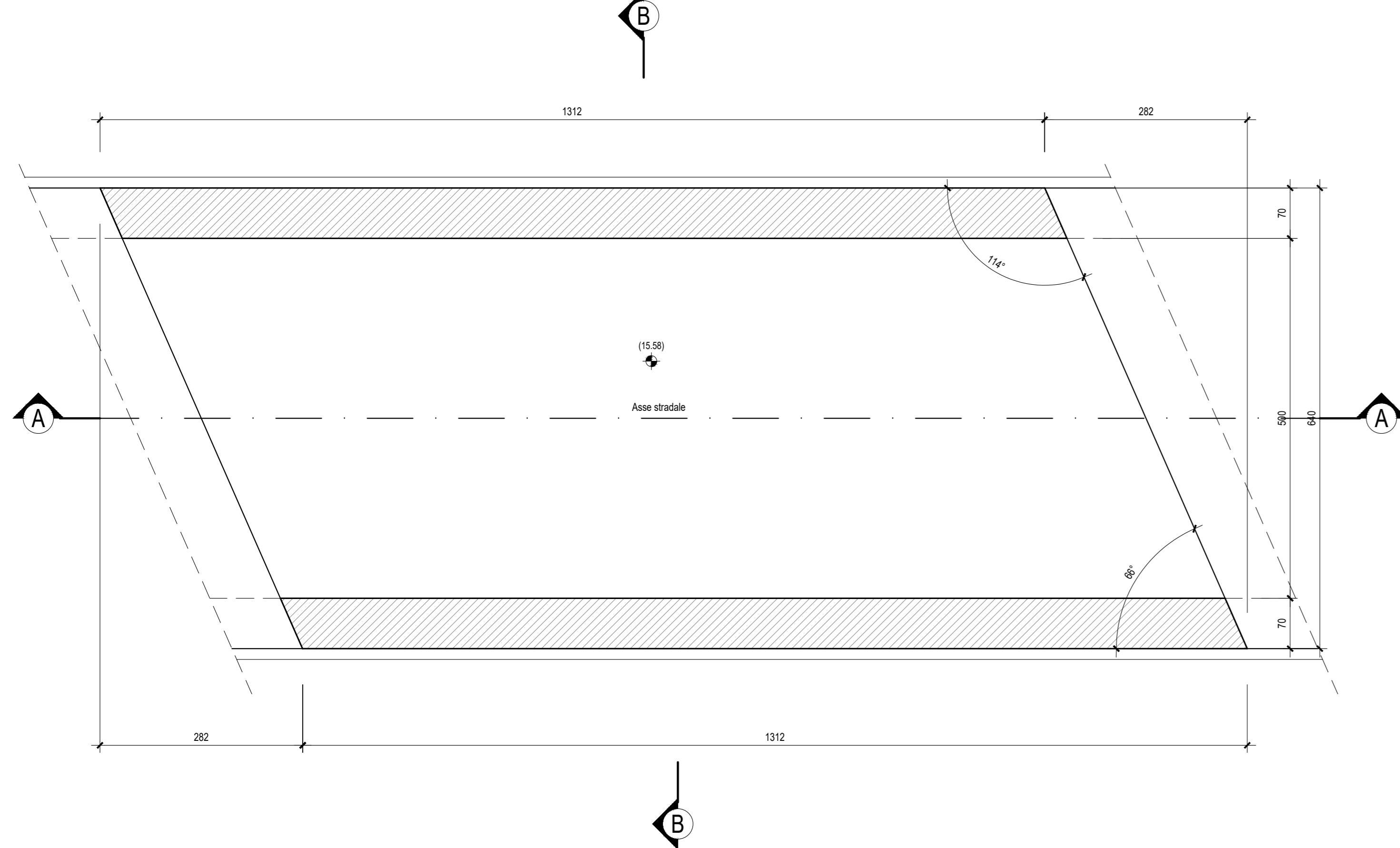

SEZIONE TRASVERSALE B-B - Scala 1:50

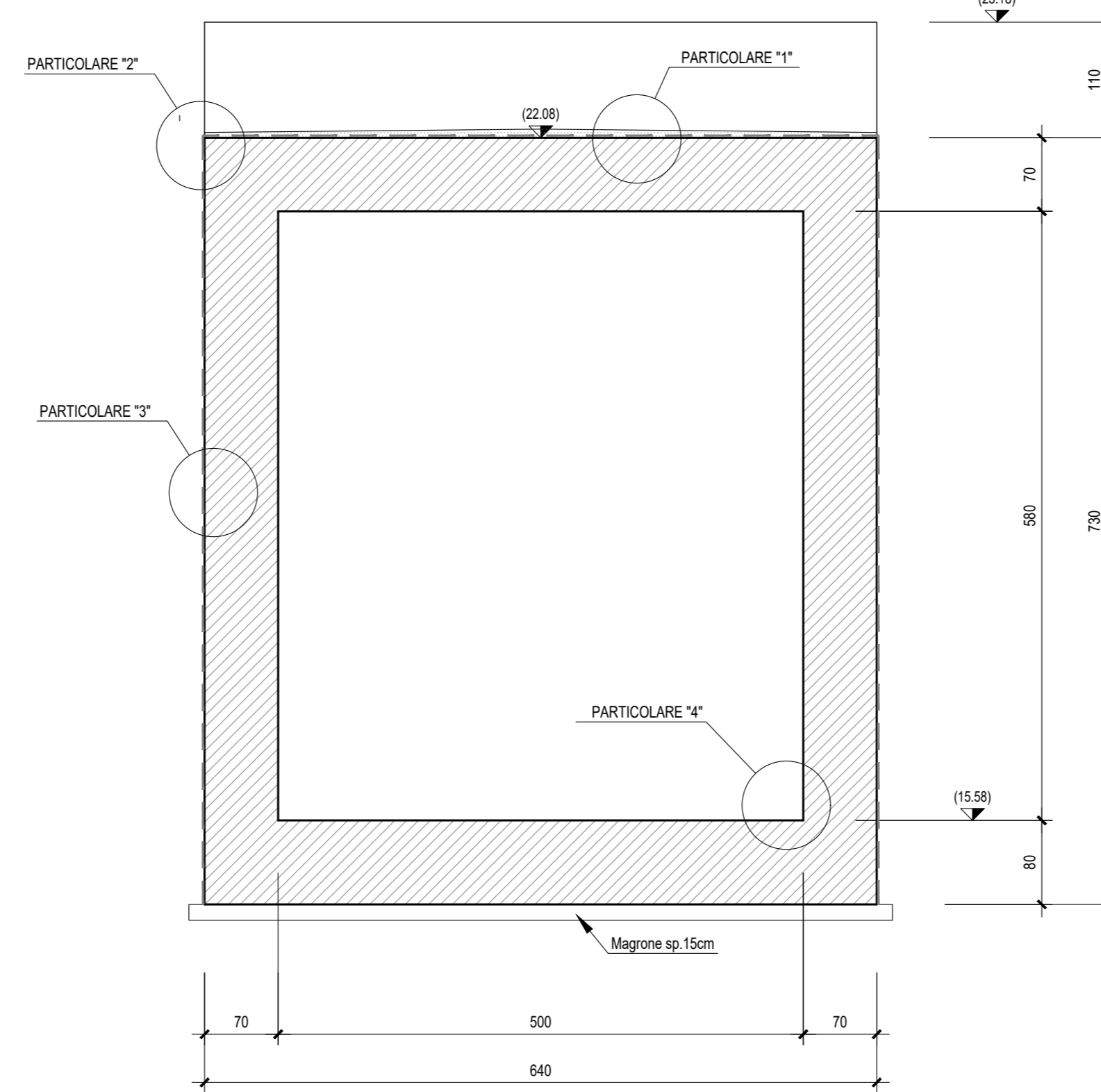

PARTICOLARE "2"-Scala 1:10

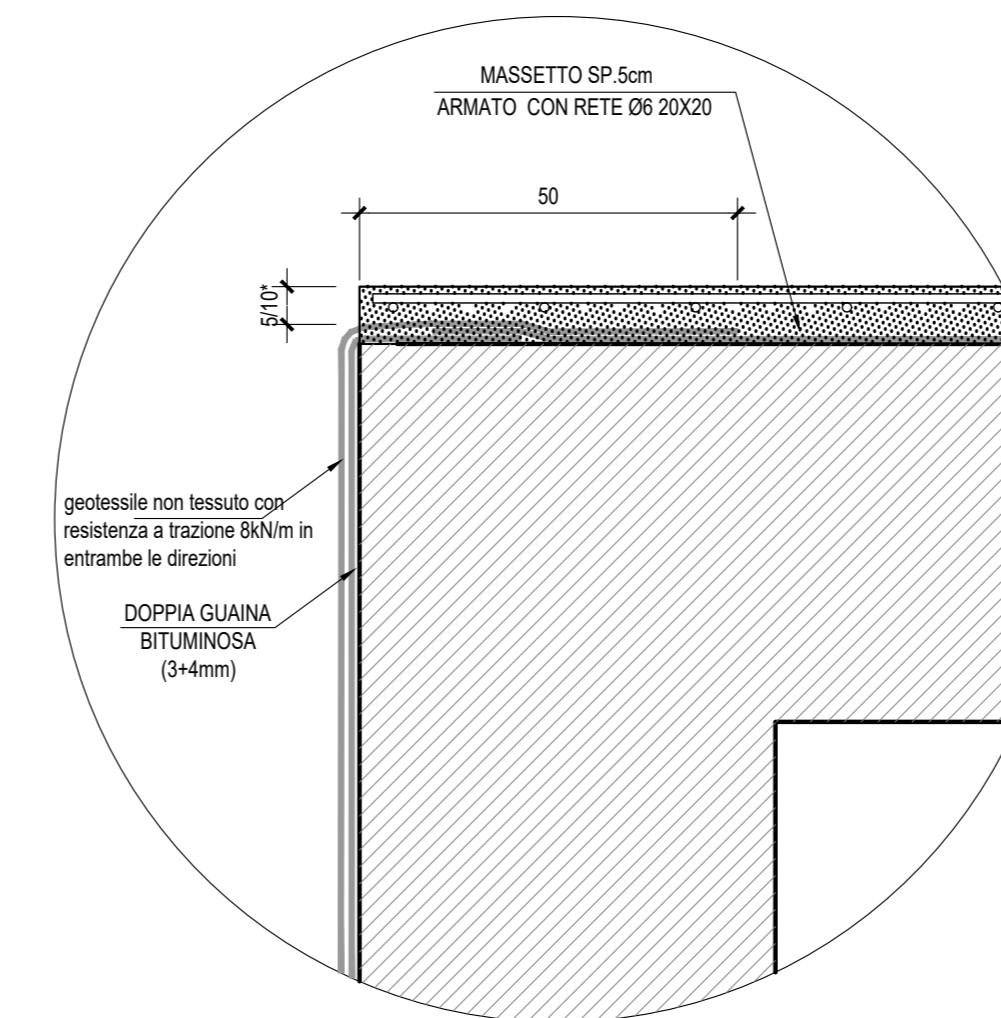

PARTICOLARE "1"-Scala 1:10

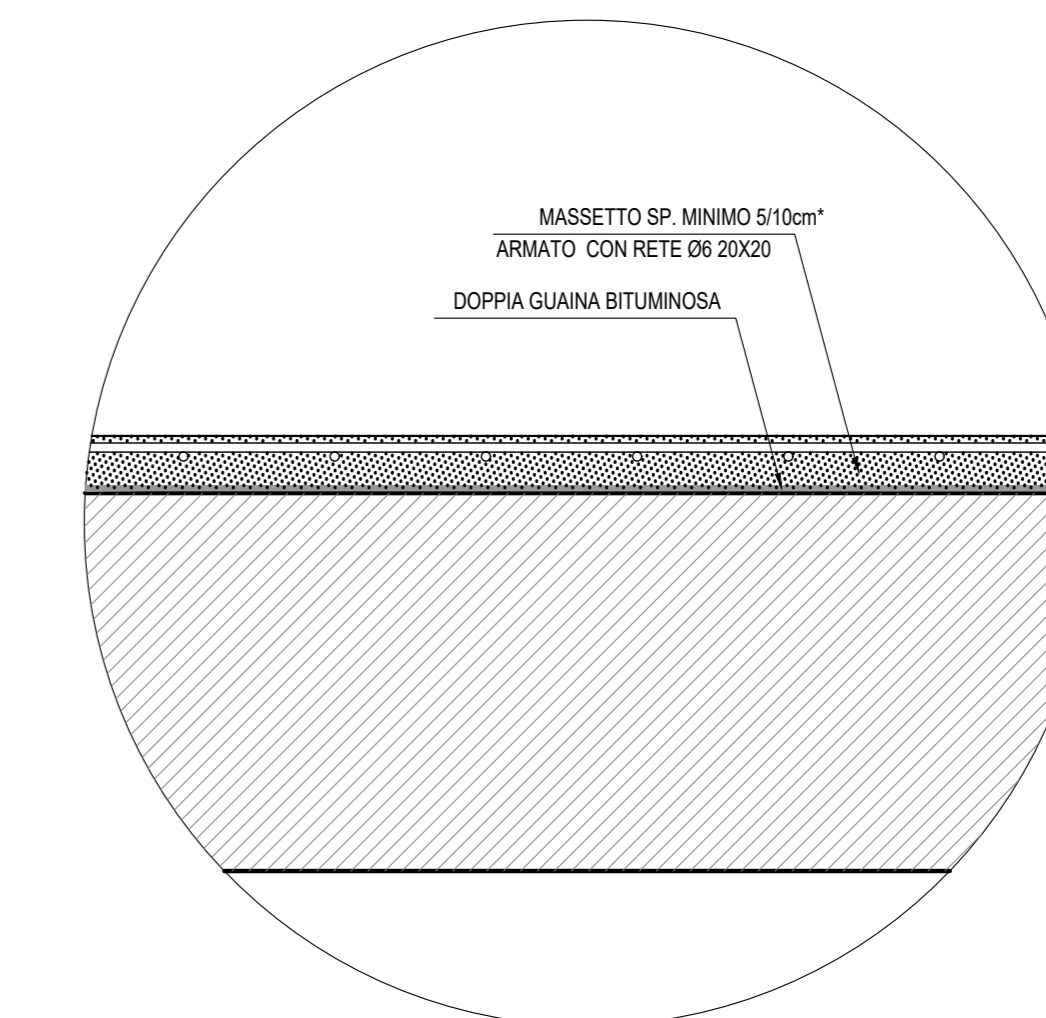

* Per sottovia e tombini scatoriali lo spessore minimo del massetto di protezione è pari a 5 cm per la farfalla ferroviaria (SL01) lo spessore minimo del massetto di protezione è pari a 10 cm

PARTICOLARE "3"-Scala 1:10

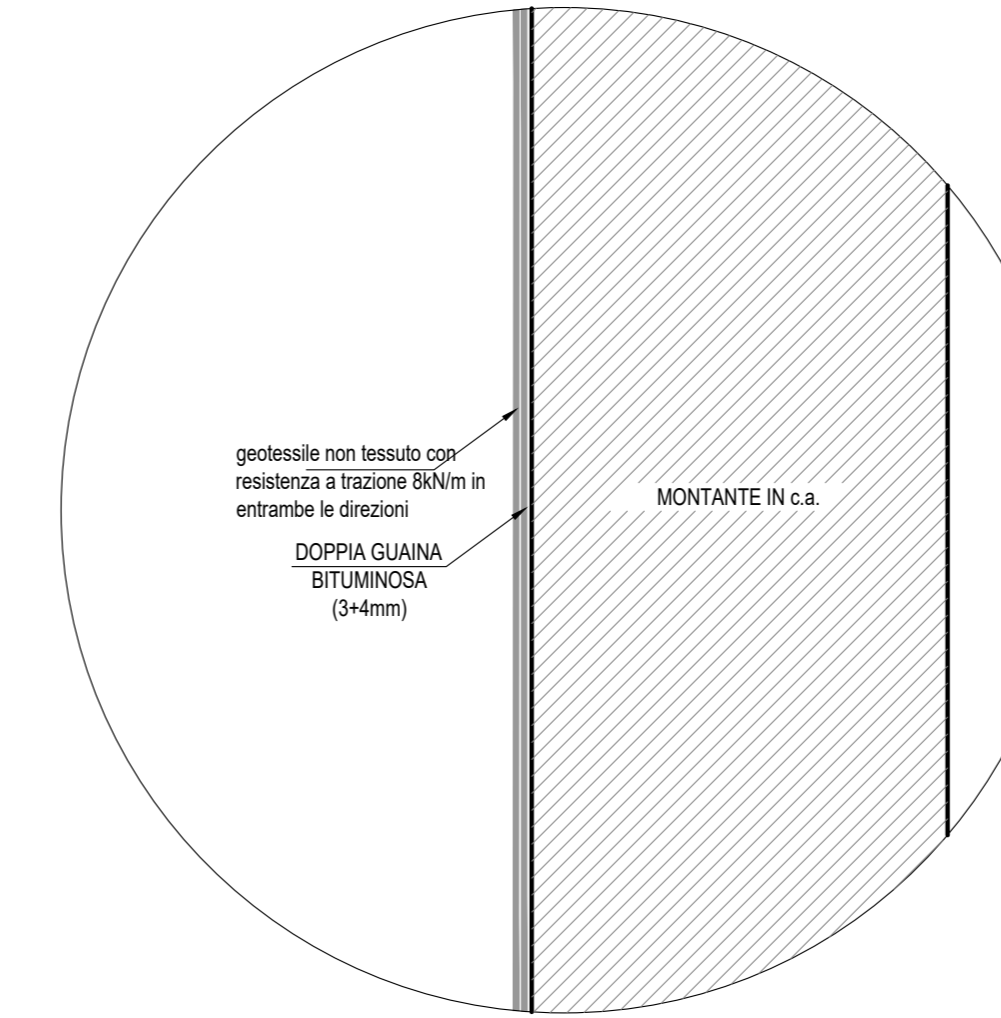

PARTICOLARE "4"-Scala 1:10

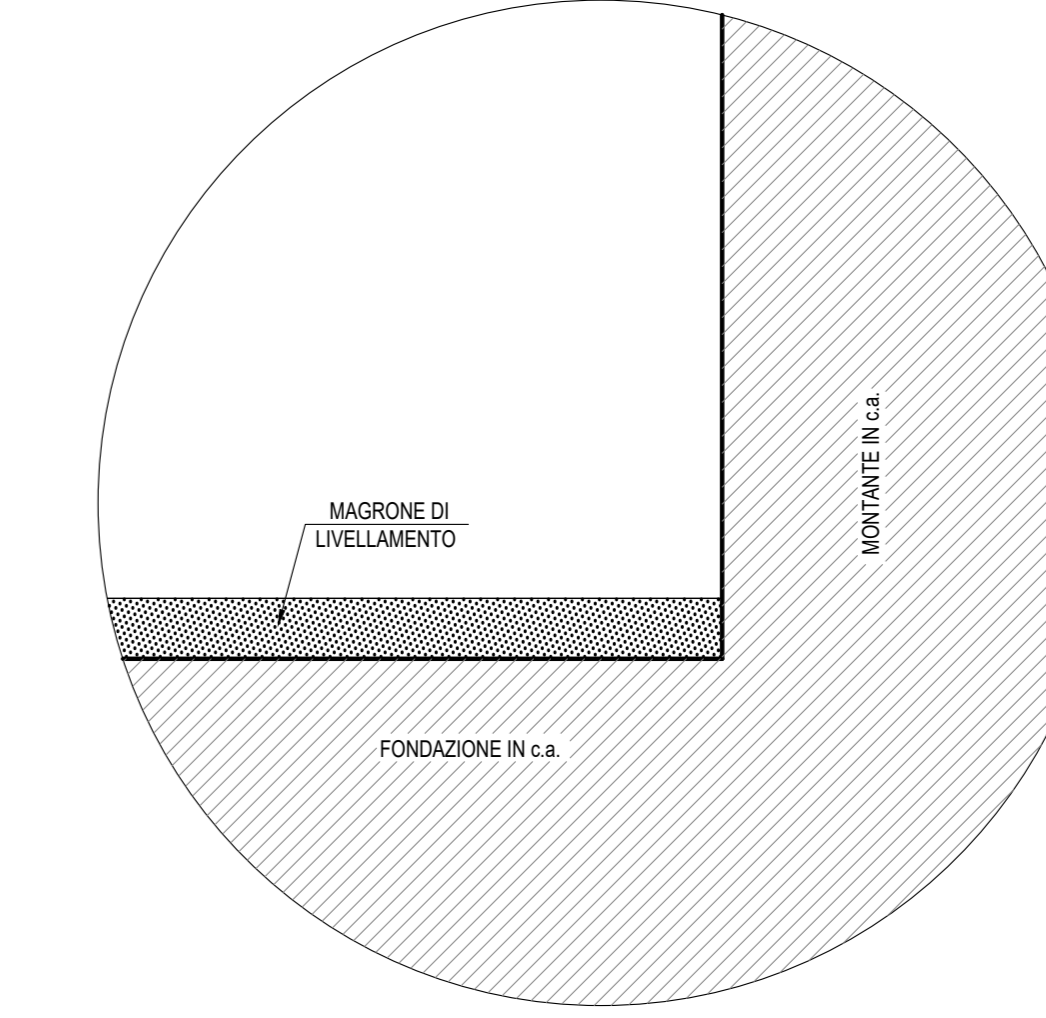

- GETTI IN OPERA
CALCESTRUZZO MAGRO E GETTO DI LIVELLAMENTO
CALCESTRUZZO SOTTOVIA
CALCESTRUZZO MURI D'IMBOCO
ACCIAIO ORDINARIO PER CALCESTRUZZO ARMATO

VISTA DALL'ALTO - Scala 1:50

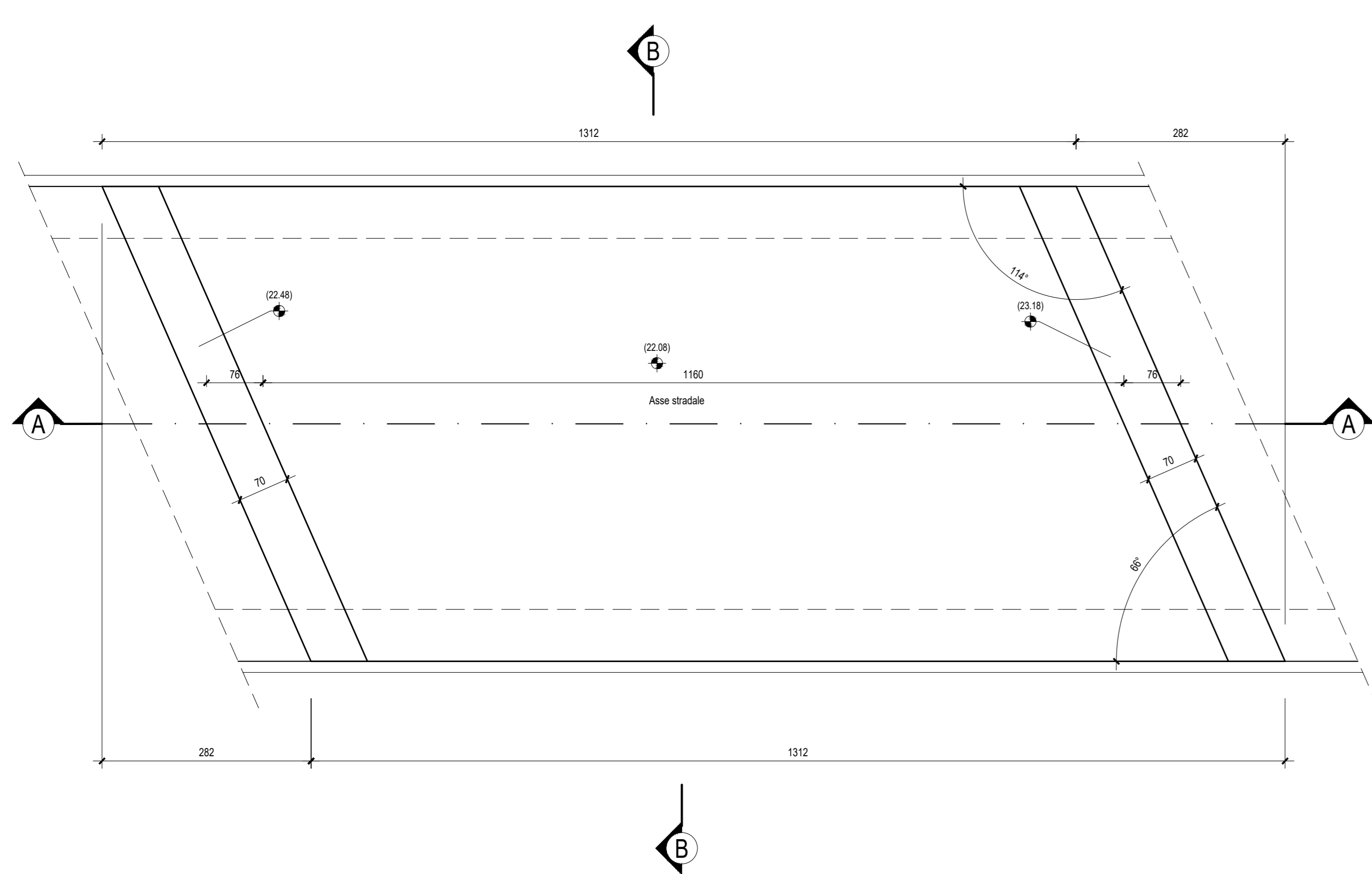

PARTICOLARE "A"-Scala 1:5

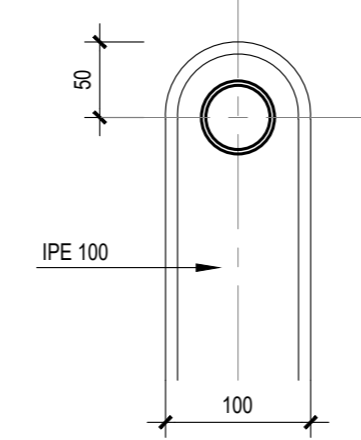

PARTICOLARE "B"-Scala 1:5

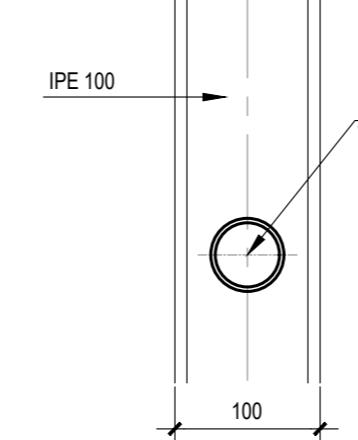

SEZIONE TRASVERSALE-Scala 1:20

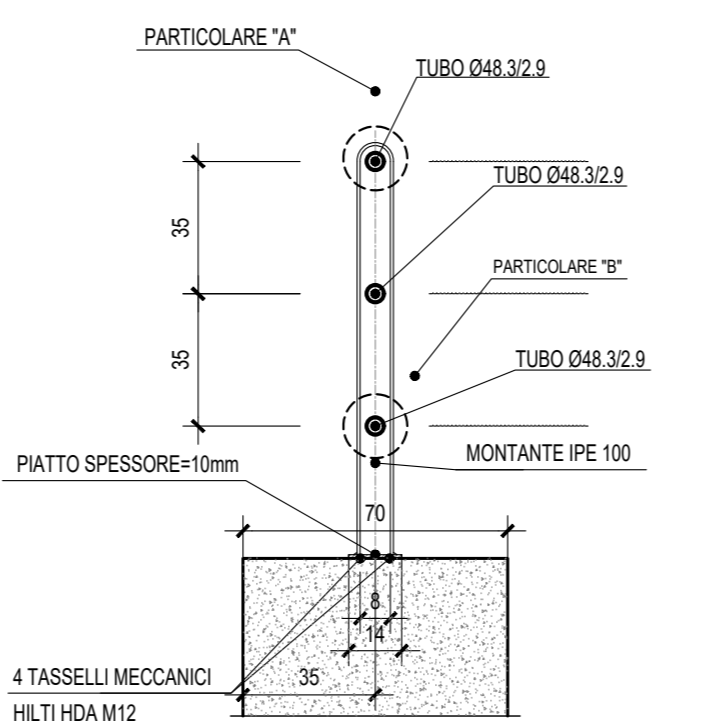

PROSPETTO PARAPETTO CORRENTE-Scala 1:20

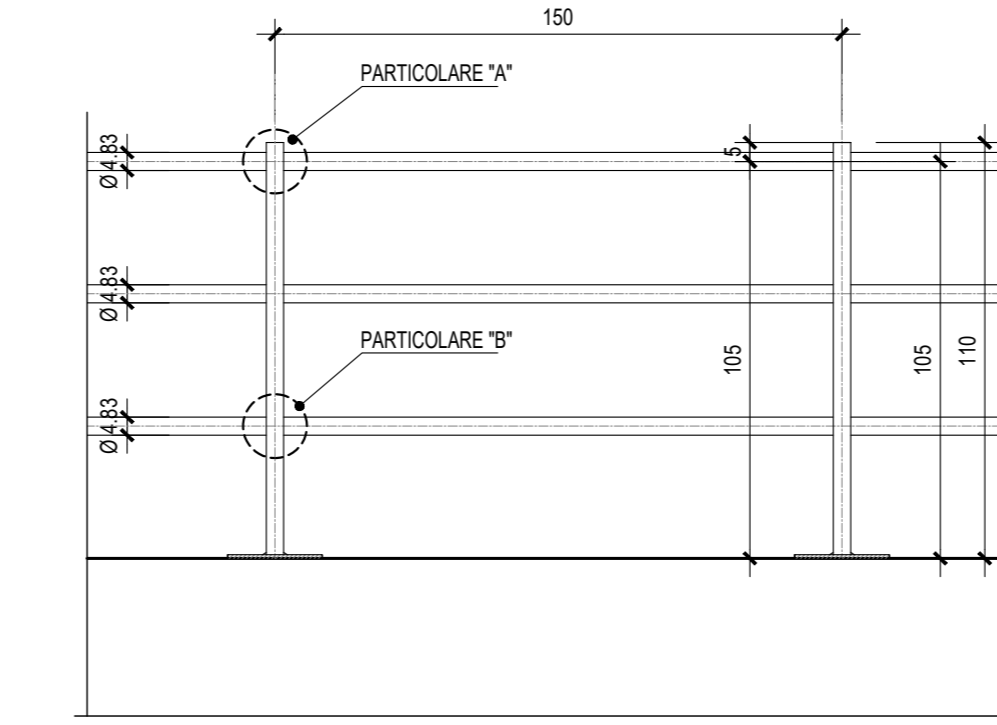

PROSPETTO TERMINALE PARAPETTO-Scala 1:20

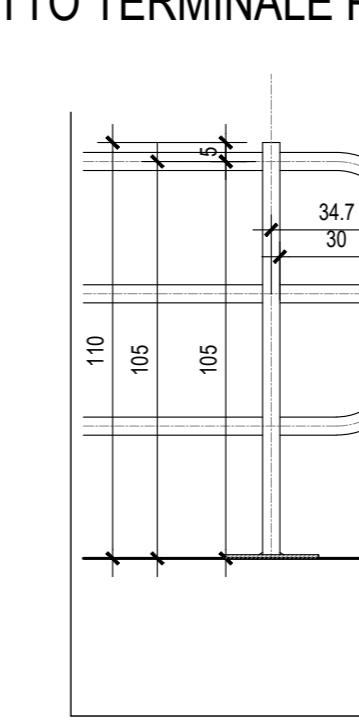

N.B.: Per la tipologia e la disposizione delle barriere di sicurezza si vedano gli elaborati da LI0B02EZZP7NV1400014 a LI0B02EZZP7NV1400018

Table with material specifications for concrete and reinforcement, including sections ad U and Scatolare.

Project information block containing logos (RFI, ATLANTE), project name (LINEA PESCARA - BARI), lot number (LOTTO 2 e 3), and a construction schedule table.