

| NUMERO SEZIONE       | 01  | 02       | 03               | 04       | 05                 | 06       | 07               | 08       | 09       | 10       | 11                 | 12       | 13                 | 14       | 15                 | 16       | 17        | 18       | 19       | 20       | 21       | 22       | 23       | 24       | 25       | 26       | 27       | 28       | 29       | 30       | 31       | 32       | 33       |
|----------------------|---|----------|------------------|----------|--------------------|----------|------------------|----------|----------|----------|--------------------|----------|--------------------|----------|--------------------|----------|-----------|----------|----------|----------|----------|----------|----------|----------|----------|----------|----------|----------|----------|----------|----------|----------|----------|
| DISTANZE PARZIALI    | 20.00   | 20.00    | 20.00            | 20.00    | 20.00              | 20.00    | 20.00            | 20.00    | 20.00    | 20.00    | 20.00              | 20.00    | 20.00              | 20.00    | 20.00              | 20.00    | 20.00     | 20.00    | 20.00    | 20.00    | 20.00    | 20.00    | 20.00    | 20.00    | 20.00    | 20.00    | 20.00    | 20.00    | 20.00    | 20.00    | 20.00    | 20.00    | 20.00    |
| DISTANZE PROGRESSIVE | 0+000.00  | 0+020.00 | 0+040.00         | 0+060.00 | 0+080.00           | 0+100.00 | 0+120.00         | 0+140.00 | 0+160.00 | 0+180.00 | 0+200.00           | 0+220.00 | 0+240.00           | 0+260.00 | 0+280.00           | 0+300.00 | 0+320.00  | 0+340.00 | 0+360.00 | 0+380.00 | 0+400.00 | 0+420.00 | 0+440.00 | 0+460.00 | 0+480.00 | 0+500.00 | 0+520.00 | 0+540.00 | 0+560.00 | 0+580.00 | 0+600.00 | 0+620.00 | 0+640.00 |
| QUOTE PROGETTO       | 54.48   | 54.48    | 54.48            | 54.48    | 54.58              | 55.15    | 56.13            | 57.28    | 58.43    | 59.58    | 60.62              | 61.34    | 61.75              | 61.87    | 61.85              | 61.69    | 61.39     | 60.99    | 60.59    | 60.19    | 59.79    | 59.38    | 58.98    | 58.58    | 58.18    | 57.79    | 57.47    | 57.06    | 56.66    | 56.26    | 55.86    | 55.46    | 55.06    |
| QUOTE TERRENO        | 54.48   | 54.48    | 54.48            | 54.30    | 54.58              | 55.15    | 56.13            | 57.28    | 58.43    | 59.58    | 60.62              | 61.34    | 61.75              | 61.87    | 61.85              | 61.69    | 61.39     | 60.99    | 60.59    | 60.19    | 59.79    | 59.38    | 58.98    | 58.58    | 58.18    | 57.79    | 57.47    | 57.06    | 56.66    | 56.26    | 55.86    | 55.46    | 55.06    |
| DIFFERENZA QUOTE     | 0.00  | 0.00     | 0.00             | 0.18     | 0.00               | 0.00     | 0.00             | 0.00     | 0.00     | 0.00     | 0.00               | 0.00     | 0.00               | 0.00     | 0.00               | 0.00     | 0.00      | 0.00     | 0.00     | 0.00     | 0.00     | 0.00     | 0.00     | 0.00     | 0.00     | 0.00     | 0.00     | 0.00     | 0.00     | 0.00     | 0.00     | 0.00     | 0.00     |
| ANDAM. PLANIMETRICO  | L=19.60m R=727.50m  |          | L=35.46m A=39.00 |          | L=154.22m R=40.50m |          | L=40.50m A=40.50 |          | L=69.93m |          | L=25.06m A=105.00m |          | L=12.81m A=105.00m |          | L=25.06m A=105.00m |          | L=352.57m |          |          |          |          |          |          |          |          |          |          |          |          |          |          |          |          |
| ANDAMENTO CIGLI      | [Schematic representation of road edge profiles with various slopes and curves] |          |                  |          |                    |          |                  |          |          |          |                    |          |                    |          |                    |          |           |          |          |          |          |          |          |          |          |          |          |          |          |          |          |          |          |
| ETTOMETRICHE         | [Blank area for volume calculations]  |          |                  |          |                    |          |                  |          |          |          |                    |          |                    |          |                    |          |           |          |          |          |          |          |          |          |          |          |          |          |          |          |          |          |          |

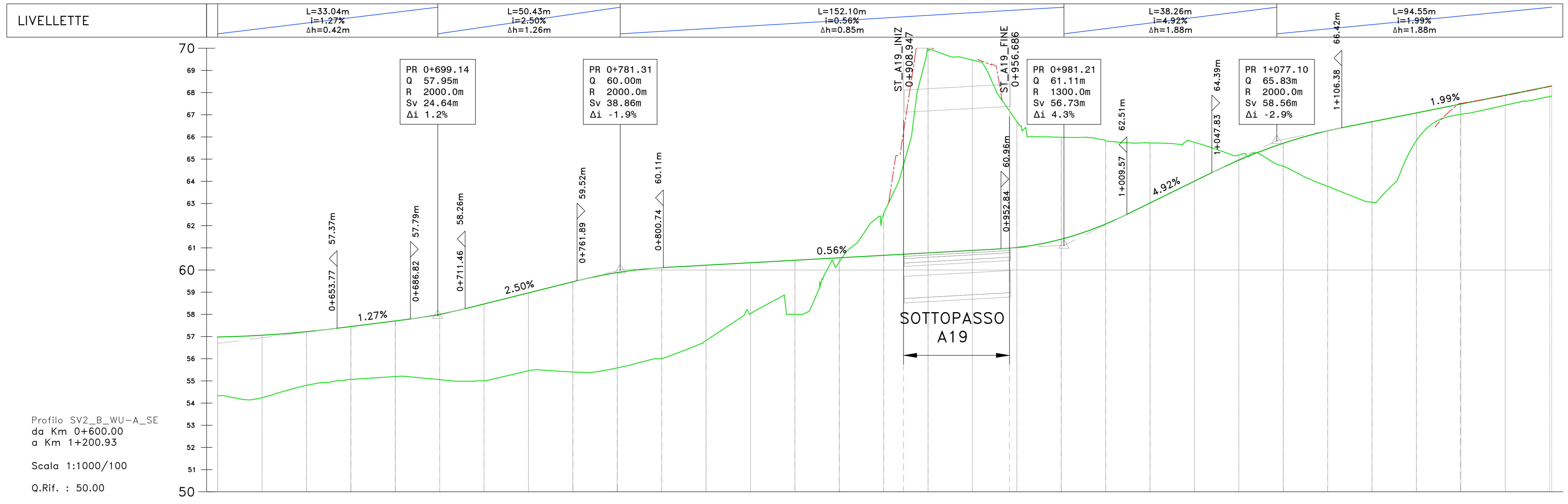

| NUMERO SEZIONE       | 31  | 32       | 33       | 34       | 35       | 36       | 37       | 38       | 39       | 40       | 41       | 42       | 43       | 44       | 45       | 46       | 47       | 48       | 49       | 50       | 51       | 52       | 53       | 54       | 55       | 56       | 57       | 58       | 59       |       |       |       |       |
|----------------------|---|----------|----------|----------|----------|----------|----------|----------|----------|----------|----------|----------|----------|----------|----------|----------|----------|----------|----------|----------|----------|----------|----------|----------|----------|----------|----------|----------|----------|-------|-------|-------|-------|
| DISTANZE PARZIALI    | 20.00   | 20.00    | 20.00    | 20.00    | 20.00    | 20.00    | 20.00    | 20.00    | 20.00    | 20.00    | 20.00    | 20.00    | 20.00    | 20.00    | 20.00    | 20.00    | 20.00    | 20.00    | 20.00    | 20.00    | 20.00    | 20.00    | 20.00    | 20.00    | 20.00    | 20.00    | 20.00    | 20.00    | 20.00    | 19.77 |       |       |       |
| DISTANZE PROGRESSIVE | 0+600.00  | 0+620.00 | 0+640.00 | 0+660.00 | 0+680.00 | 0+700.00 | 0+720.00 | 0+740.00 | 0+760.00 | 0+780.00 | 0+800.00 | 0+820.00 | 0+840.00 | 0+860.00 | 0+880.00 | 0+900.00 | 0+920.00 | 0+940.00 | 0+960.00 | 0+980.00 | 1+000.00 | 1+020.00 | 1+040.00 | 1+060.00 | 1+080.00 | 1+100.00 | 1+120.00 | 1+140.00 | 1+159.77 |       |       |       |       |
| QUOTE PROGETTO       | 56.98   | 57.06    | 57.22    | 57.45    | 57.71    | 58.00    | 58.47    | 58.97    | 59.47    | 59.89    | 60.11    | 60.22    | 60.33    | 60.44    | 60.55    | 60.66    | 60.77    | 60.88    | 60.99    | 61.10    | 61.21    | 61.32    | 61.43    | 61.54    | 61.65    | 61.76    | 61.87    | 61.98    | 62.09    | 62.20 | 62.31 | 62.42 | 62.53 |
| QUOTE TERRENO        | 54.33   | 54.25    | 54.07    | 53.80    | 53.52    | 53.24    | 52.96    | 52.68    | 52.40    | 52.12    | 51.84    | 51.56    | 51.28    | 51.00    | 50.72    | 50.44    | 50.16    | 49.88    | 49.60    | 49.32    | 49.04    | 48.76    | 48.48    | 48.20    | 47.92    | 47.64    | 47.36    | 47.08    | 46.80    | 46.52 | 46.24 | 45.96 | 45.68 |
| DIFFERENZA QUOTE     | 2.65  | 2.81     | 3.15     | 3.65     | 4.19     | 4.76     | 5.51     | 6.29     | 7.07     | 7.77     | 8.27     | 8.78     | 9.29     | 9.80     | 10.31    | 10.82    | 11.33    | 11.84    | 12.35    | 12.86    | 13.37    | 13.88    | 14.39    | 14.90    | 15.41    | 15.92    | 16.43    | 16.94    | 17.45    | 17.96 | 18.47 | 18.98 |       |
| ANDAM. PLANIMETRICO  | [Schematic representation of road alignment with curves and slopes] |          |          |          |          |          |          |          |          |          |          |          |          |          |          |          |          |          |          |          |          |          |          |          |          |          |          |          |          |       |       |       |       |
| ANDAMENTO CIGLI      | [Schematic representation of road edge profiles]                    |          |          |          |          |          |          |          |          |          |          |          |          |          |          |          |          |          |          |          |          |          |          |          |          |          |          |          |          |       |       |       |       |
| ETTOMETRICHE         | [Blank area for volume calculations]                                |          |          |          |          |          |          |          |          |          |          |          |          |          |          |          |          |          |          |          |          |          |          |          |          |          |          |          |          |       |       |       |       |

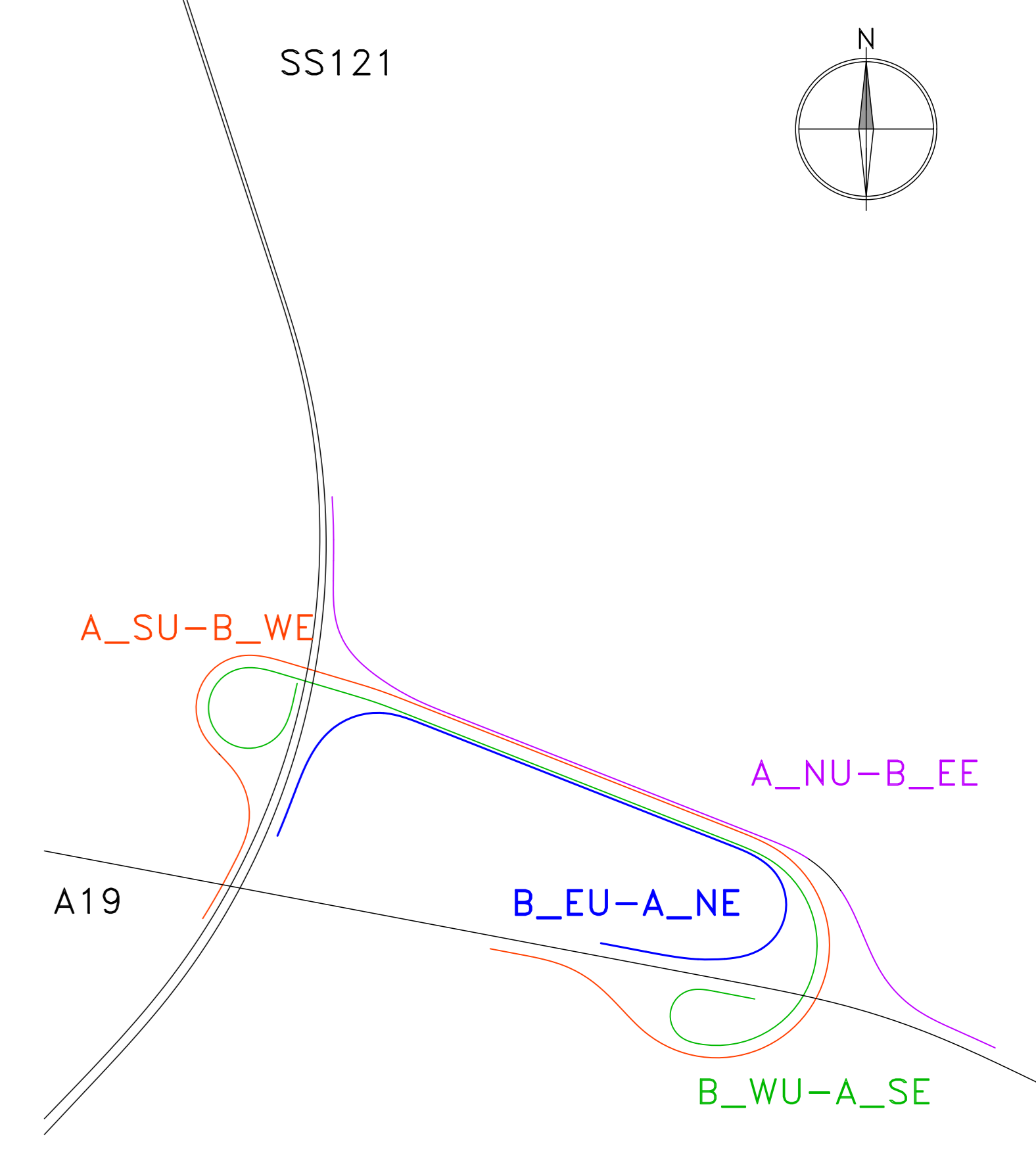

**Sanas**  
GRUPPO FS ITALIANE

*Direzione Tecnica*

**S.S.121 "Catanesa"**  
Intervento S.S.121 - Tratto Palermo (A19) - rotonda Bolognetta

**PROGETTO DEFINITIVO** cod. UP62

PROGETTAZIONE: **ATI VIA - SERING - VDP - BRENG**

|   |   |
|---|---|
| RESPONSABILE DELL'INTEGRAZIONE DELLE PRESTAZIONI SPECIALISTICHE:<br>Dir. Ing. Giovanni Piazza (Dir. Ing. Prov. Roma A1234)  | GRUPPO DI PROGETTAZIONE<br>MANAGER:<br>INGEGNERIA   |
| PROGETTISTA:<br>Responsabile Tecnico Strada: Dir. Ing. Massimo Capasso (Dir. Ing. Prov. Roma 20012)<br>Responsabile Strada: Dir. Ing. Giovanni Piazza (Dir. Ing. Prov. Roma 22001)<br>Responsabile Strada, Geotecnica e Impanti: Dir. Ing. Sergio Di Majo (Dir. Ing. Prov. Roma 20012)<br>Responsabile Impianti: Dir. Ing. Francesco Venturoli (Dir. Ing. Prov. Roma 14860) |   |
| GEOLOGO:<br>Dir. Ing. Enrico Ciampini (Dir. Ing. Prov. Roma 20012)  | COORDINATORE SICUREZZA IN FASE DI PROGETTAZIONE:<br>Dir. Ing. Matteo Di Giovanni (Dir. Ing. Prov. Roma 15138) |
| RESPONSABILE SIA:<br>Dir. Ing. Francesco Venturoli (Dir. Ing. Prov. Roma 14860)   | VISTO: IL RESPONSABILE DEL PROCEDIMENTO:<br>Dir. Ing. Luigi Maja  |

**PROGETTO STRADALE**  
SV02 SVINCOLO AUTOSTRADA  
Profilo di progetto  
TAV 05

|                 |                          |           |             |
|-----------------|--------------------------|-----------|-------------|
| CODICE PROGETTO | NOME FILE                | REVISIONE | SCALA:      |
| DPUP0062        | UP62_V02PS00TRAFLO1-05_A | A         | 1:1000/1100 |
| PROGETTO        | UV, PROG, ANNO           | ELAB.     |             |
|                 |                          |           |             |

|      |             |           |                              |
|------|-------------|-----------|------------------------------|
| D    |             |           |                              |
| C    |             |           |                              |
| B    |             |           |                              |
| A    | EMISSIONE   | FEBR 2023 | M/TOB                        |
| REV. | DESCRIZIONE | DATA      | REDDATO VERIFICATO APPROVATO |