

1- Dettaglio planimetrico cancello metallico carrabile

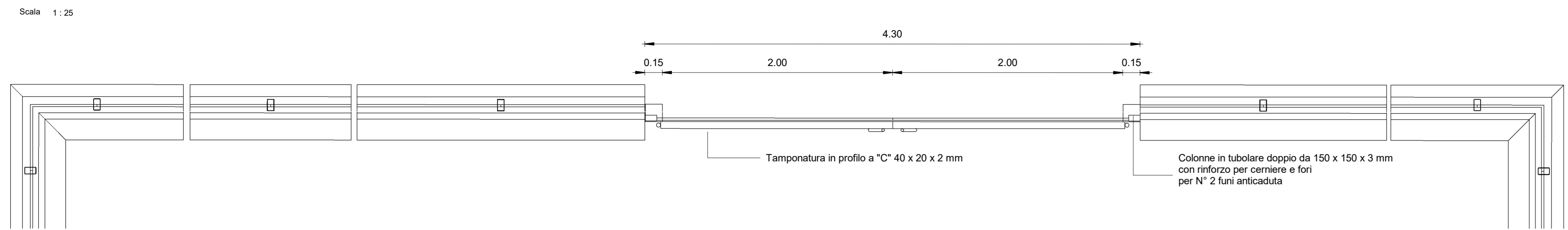

2- Dettaglio planimetrico cancello metallico carrabile

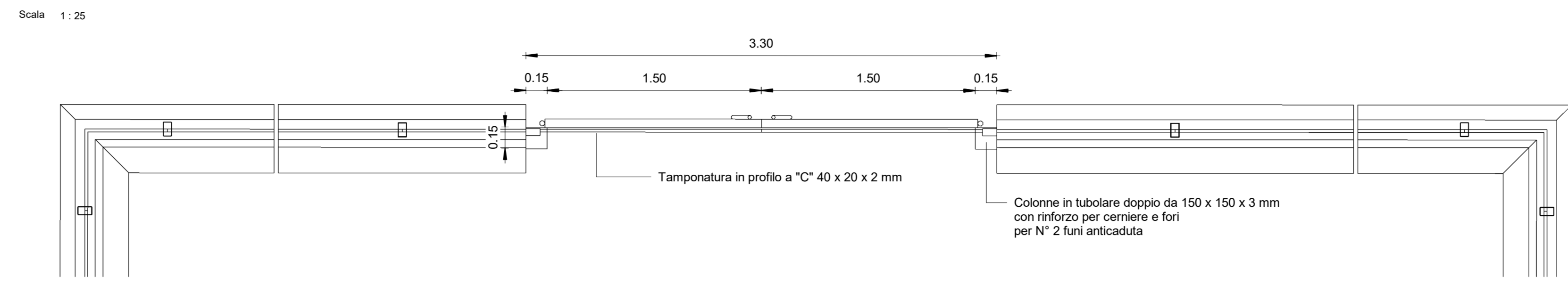

Pianta chiave estradosso banchina - dettaglio del cancello

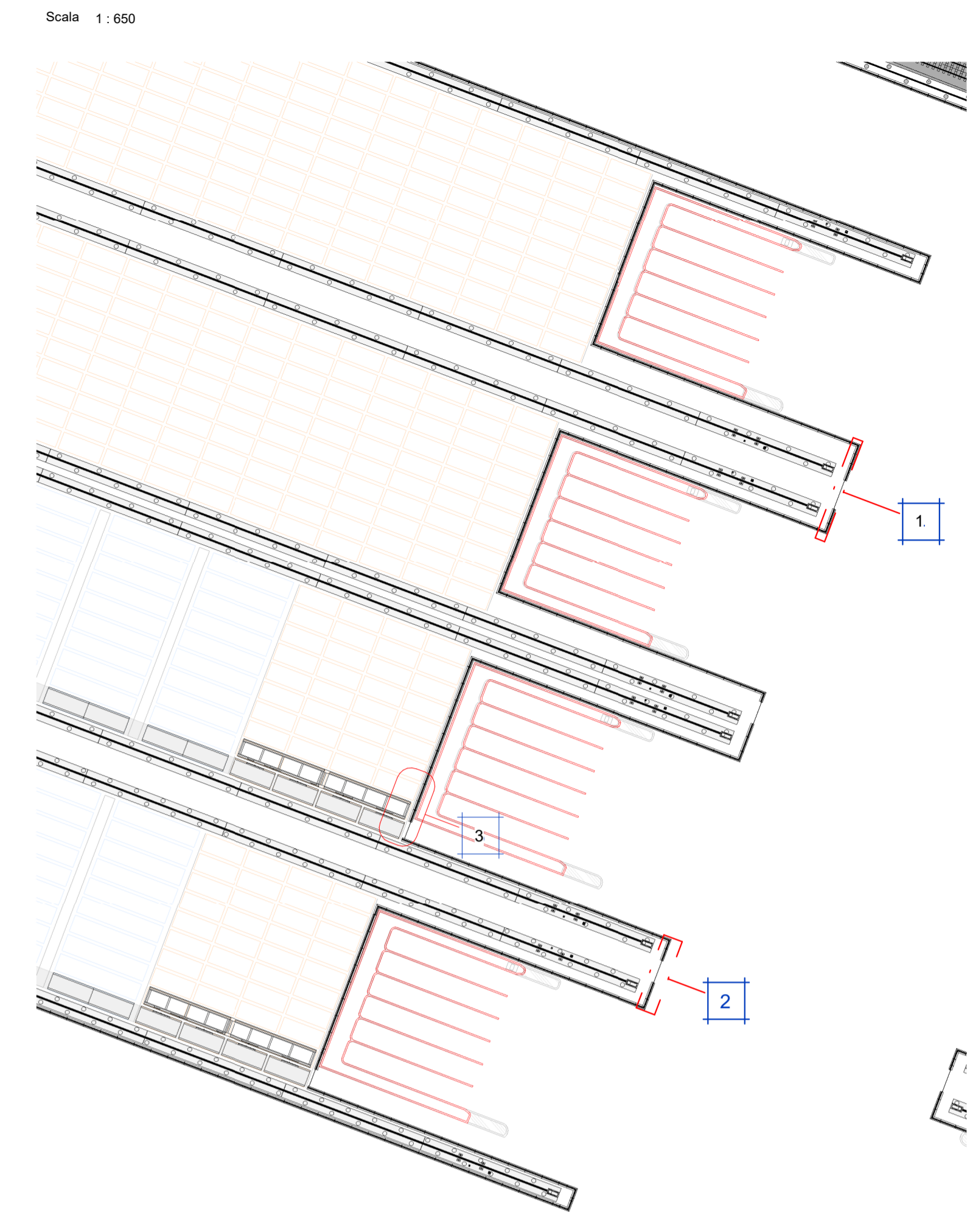

1- Dettaglio cancello metallico carrabile

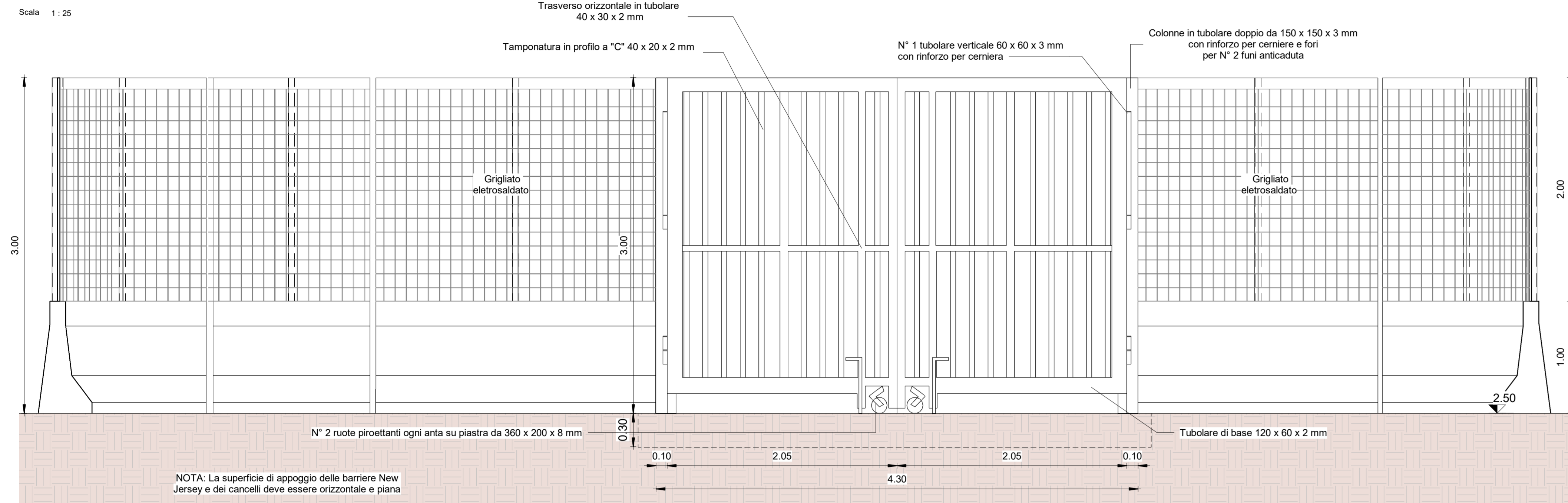

Dettaglio - Cancelli

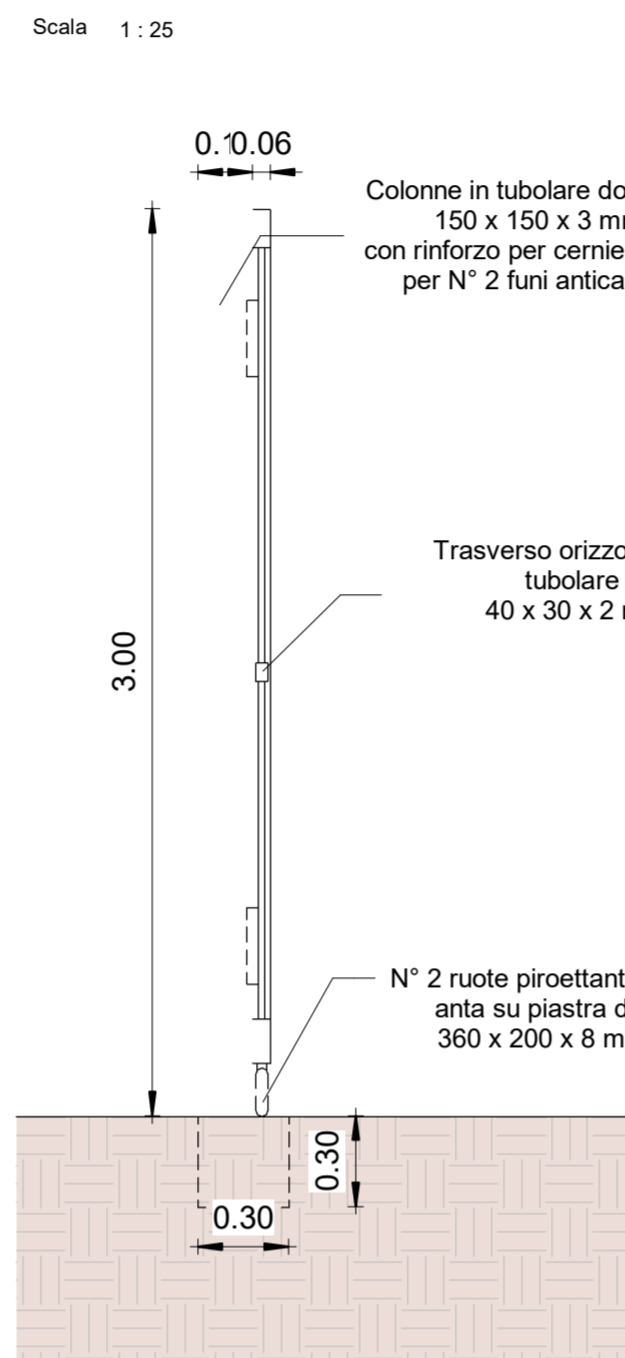

2- Dettaglio cancello metallico carrabile

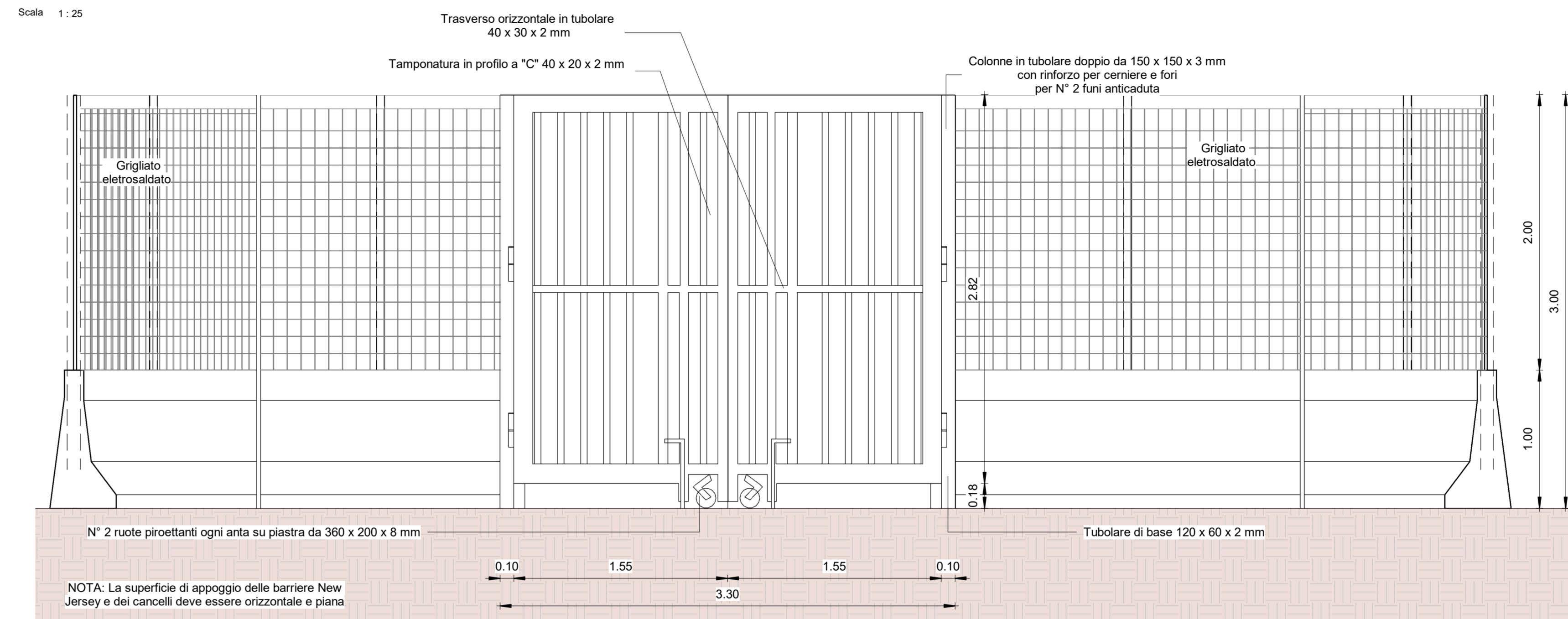

Dettaglio - Cancelli - Piccolo

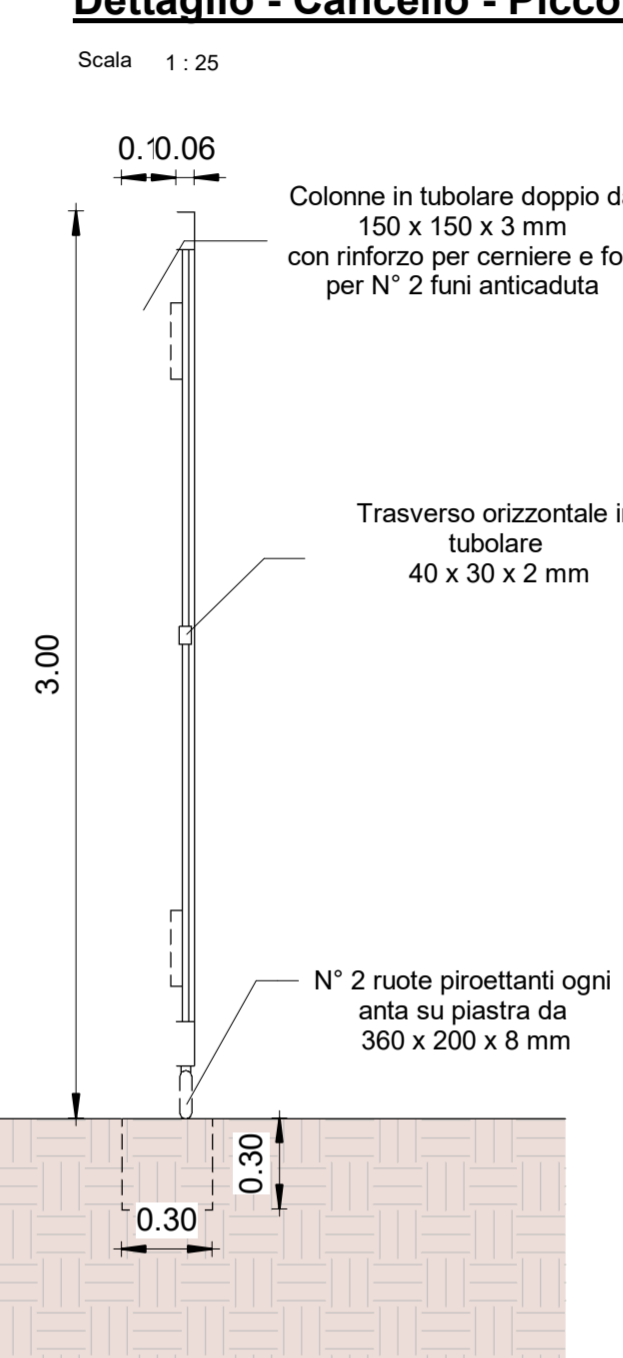

3- Dettaglio planimetrico cancello metallico area container pedonale

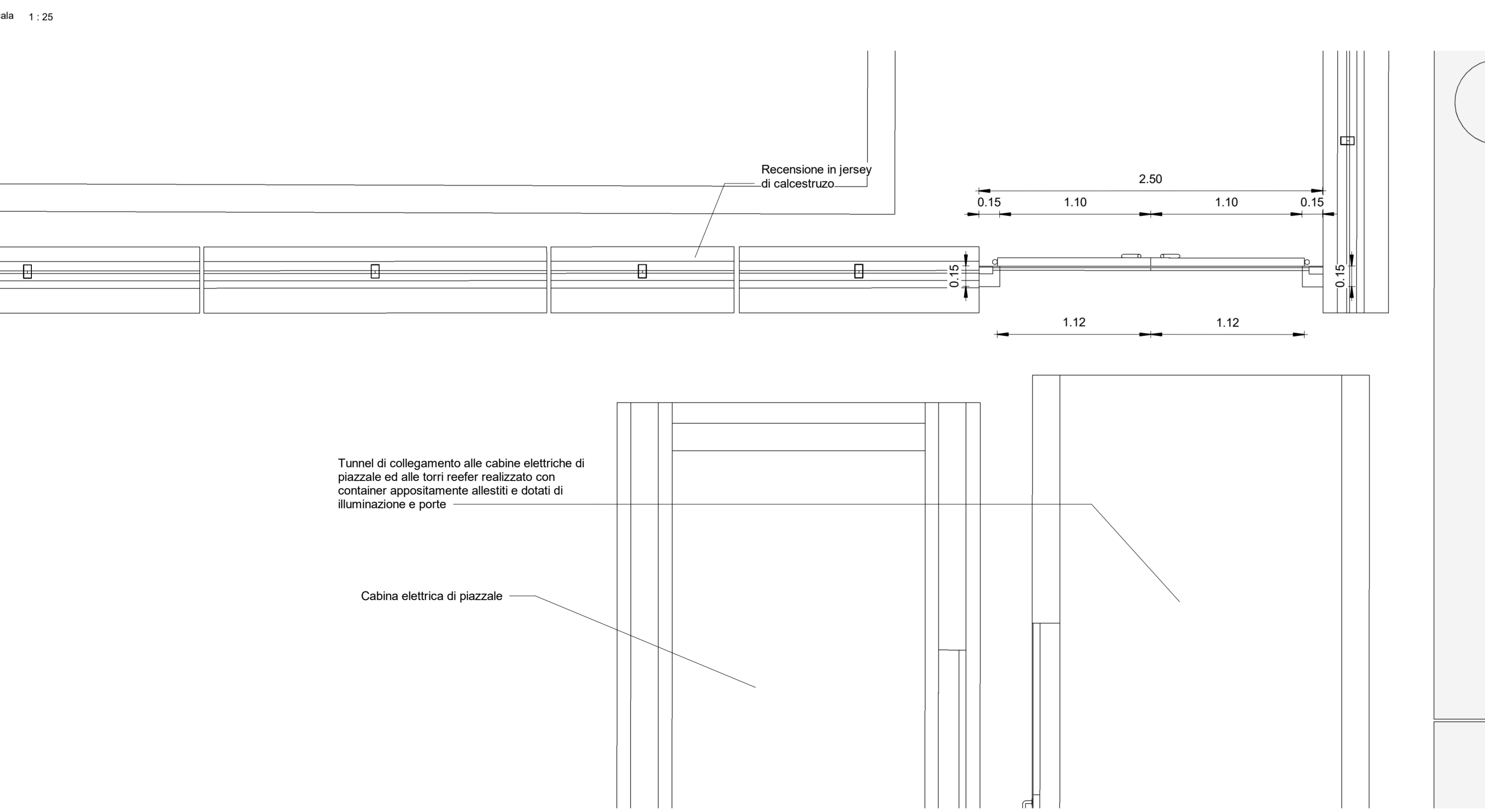

3- Dettaglio cancello metallico area container pedonale

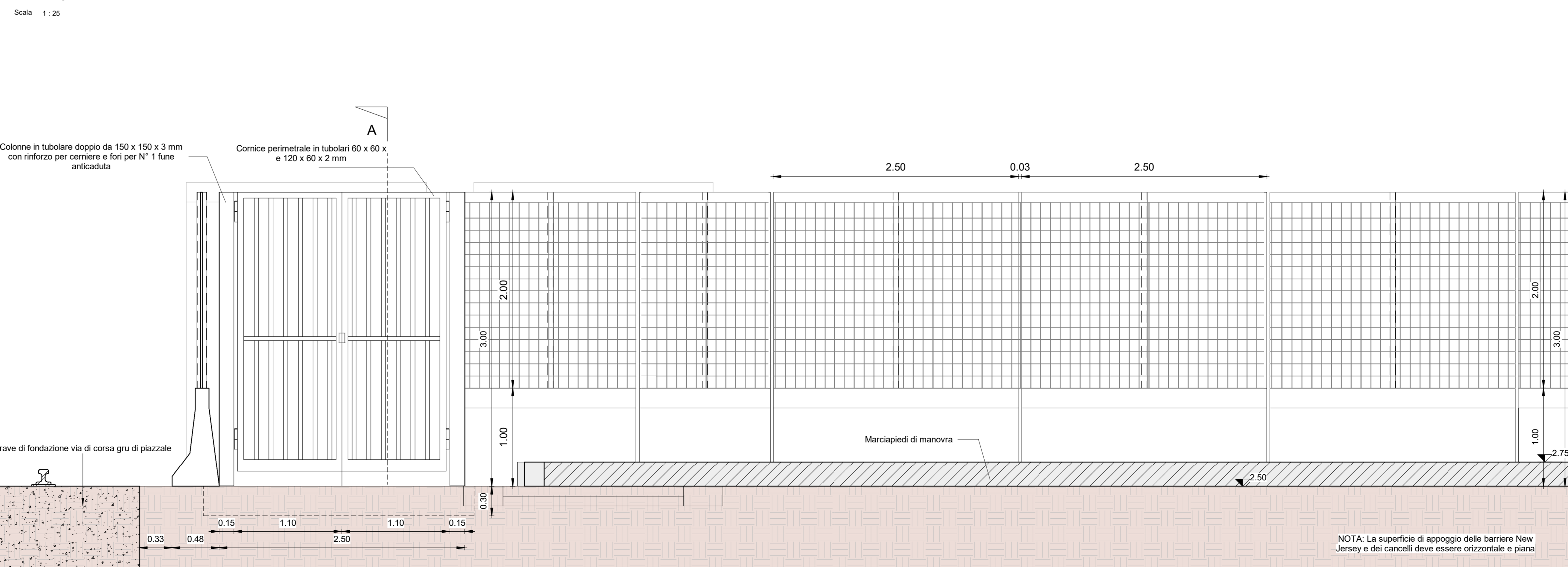

Dettaglio - Sezione A-A Cancelli Pedonale

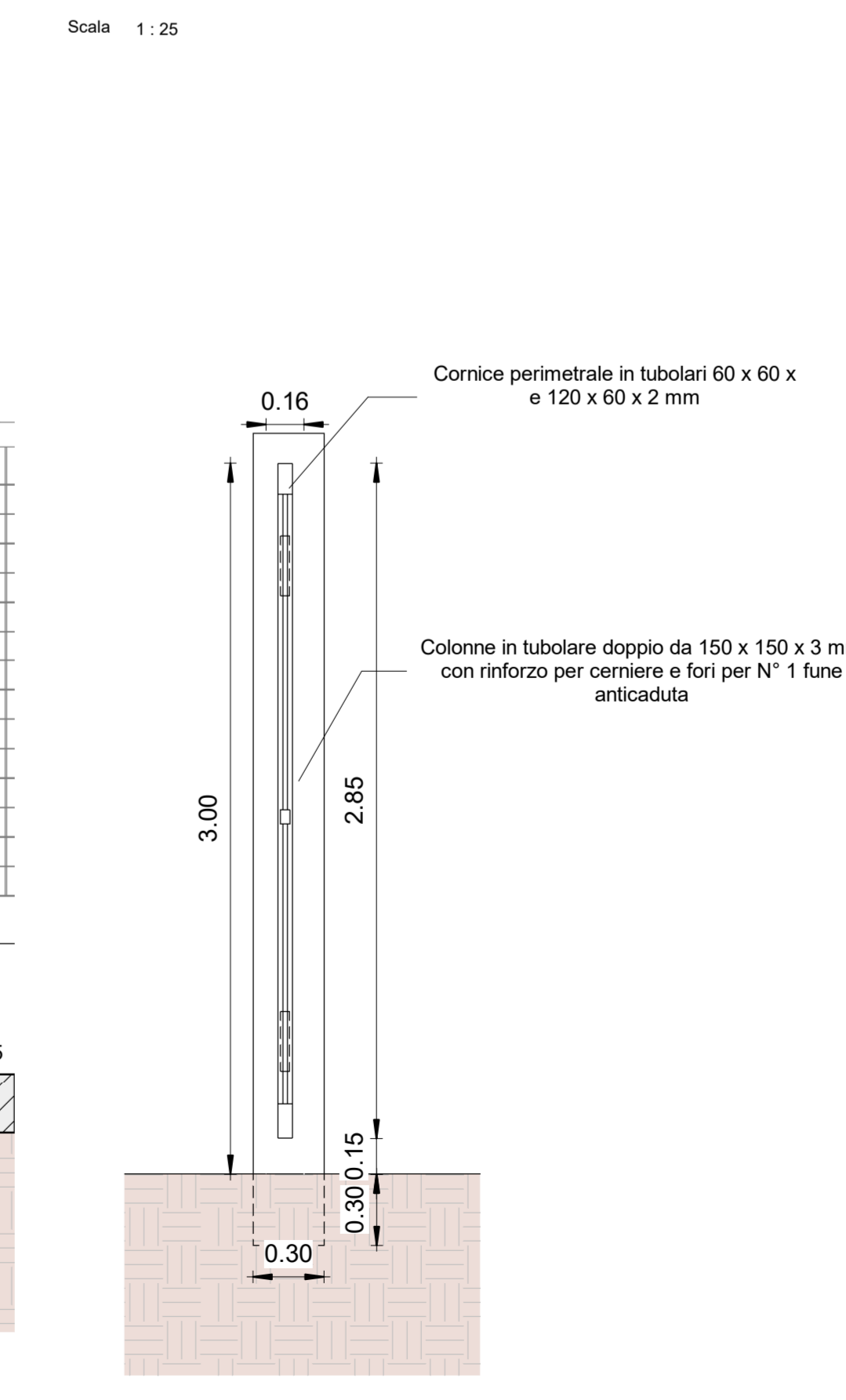

LA SPEZIA CONTAINER TERMINAL

PORTO DI LA SPEZIA
AMPLIAMENTO TERMINAL RAVANO

PROGETTO ESECUTIVO

TITOLO ELABORATO
Piazzale di ponente - cancelli area container - Stato di Progetto

CODICE ELABORATO
21 08 PE TE22 0

SCALA
Come indicato

Rev. 0
Data 05/05/2023
Emissione finale per verificare

IL COMMITTENTE
LSCT S.p.A.
Viale San Bartolomeo, 20
19128 - La Spezia (SP)
C.F. 007280115 - P.IVA 0169481014

IL PROGETTISTA
LSCT S.p.A.
Via Salaria, 75
00198 - Roma (RM)
C.F. - P.IVA 0845653100

Disegnato: Corradini
Controllato: Sanzone
Approvato: Tartaglino

DIMENSIONI FOGLIO
A1

NOTE