

**Stralcio planimetrico- Parabordi**

Scala 1:700



**PARABORDO TIPO TRELLEBORG SCN 1600 F2.3 O EQUIVALENTE**

**Dettaglio piastra distanziatrice in acciaio S355**

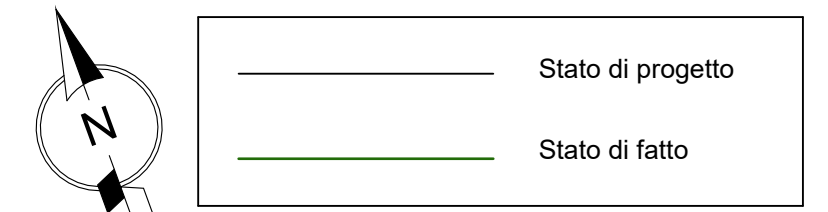

**Dettaglio 1 - Pianta**

Scala 1:25

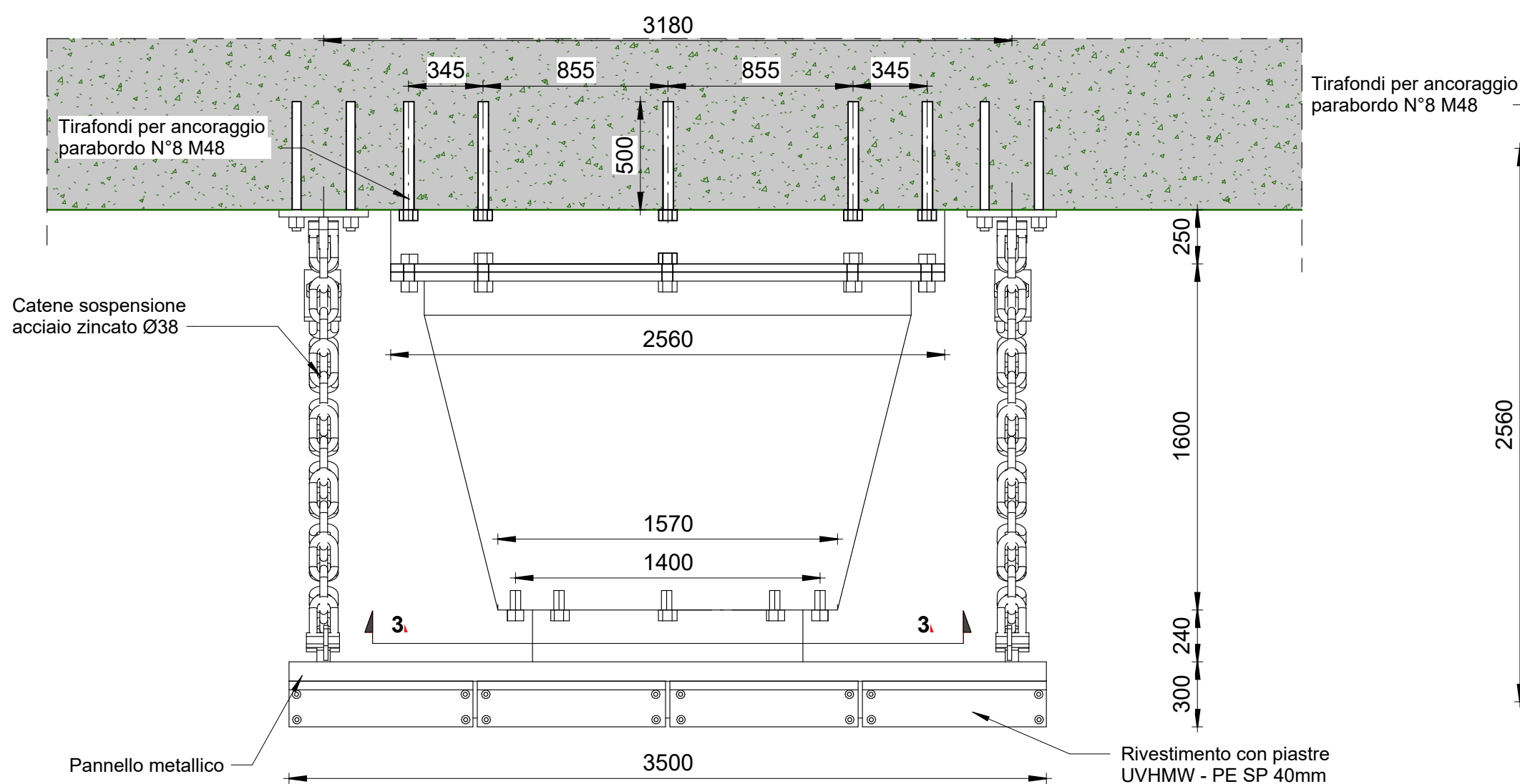

**Sezione A-A**

Scala 1:25

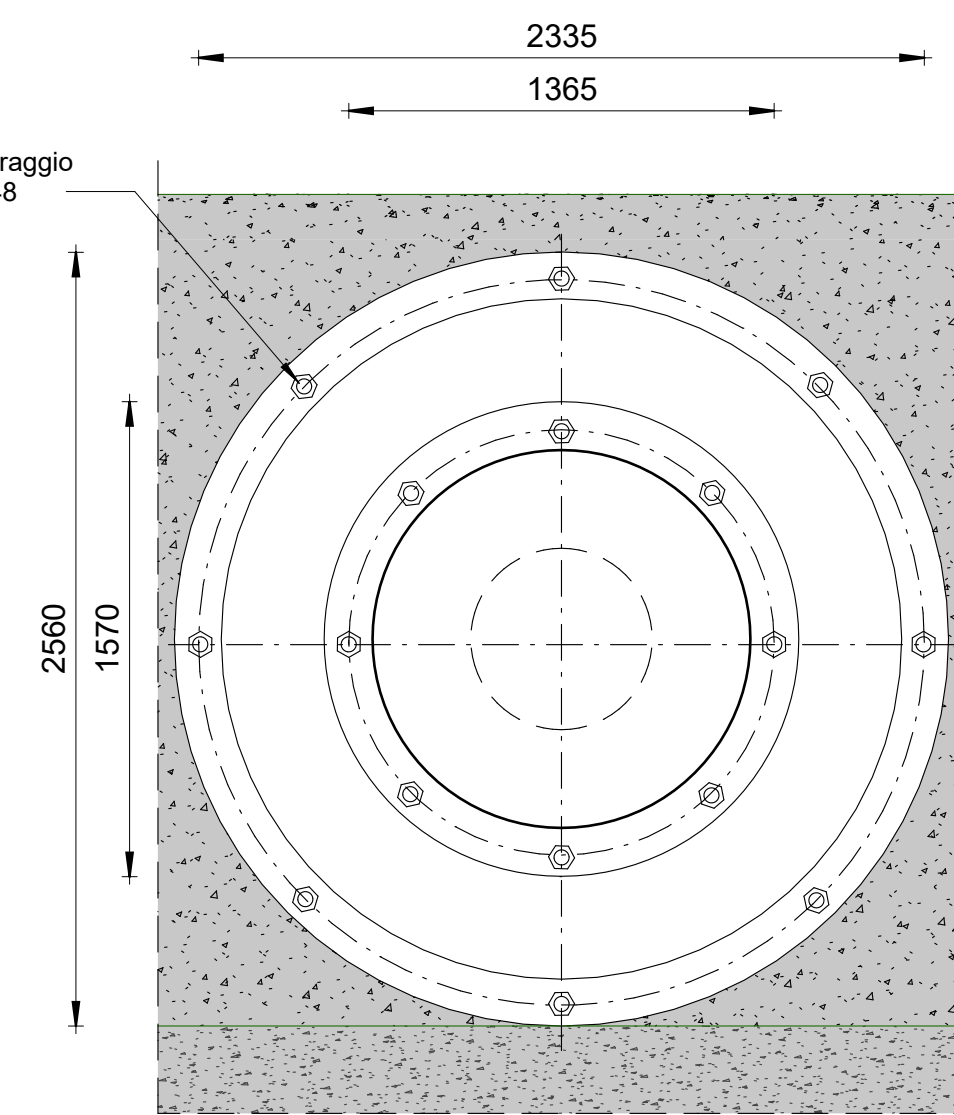

**Vista di pianta**

Scala 1:25

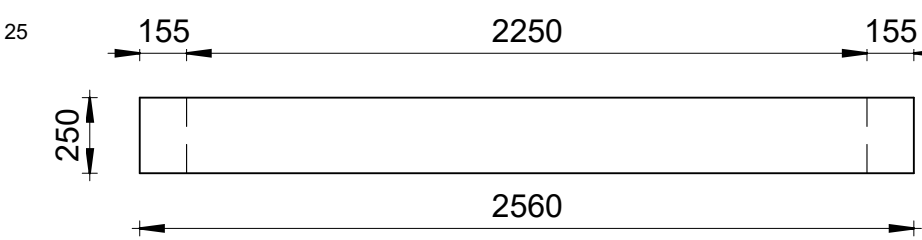

**Vista frontale**

Scala 1:25

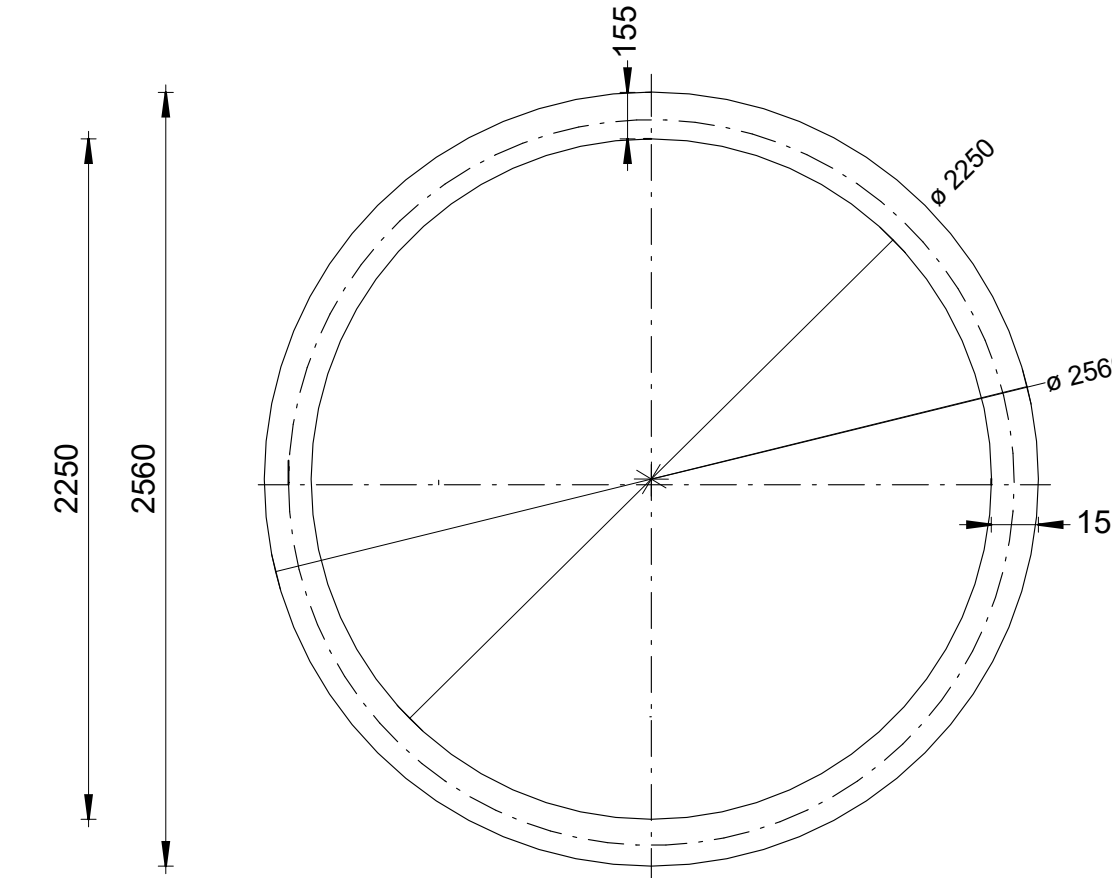

**LEGENDA**

- Fender system type SCN1600 F2.3 painted with a 2K epoxy paint system that meets the high durability class as per EN ISO 12944 C5
- Closed box fender panel 3.5(W) x 4.5 (H) m. Steelgrade S355 , painted with a 2K epoxy paint system that meets the high durability class as per EN ISO 12944 C5
- UHMW PE 1000 Virgin, 40 mm thck. low friction facing pads, UV stable prefitted with SS136 studs
- weight chains, grade SL3, including tensioner and shackles, HDG as per EN ISO 1461
- tension chains,including shackles, Grade SL3, HDG as per EN ISO 1461
- Bolt M48x120mmL , grade 8.8, hdg. Fender to closed box
- circular washer M48 , hdg. - Fender to closed box
- Anchors type NC3 M48, 42CrMO+Q235B, hdg. Fender to quay.
- Bolt M48x305mmL , grade 8.8, hdg. Fender to quay
- Lip washer , hdg. Fender to quay.
- Chain Bracket , S355J2, hdg min.85 microns.
- Chain Bracket NC3 Anchor M48, 42CrMO+Q235B, hdg.
- pcs Chain Bracket NC3 Anchor Bolt M48x120mmL, grade 8.8, hdg
- pcs Chain Bracket NC3 Anchor circular Washer M48,hdg.

**Prospetto frontale**

Scala 1:25

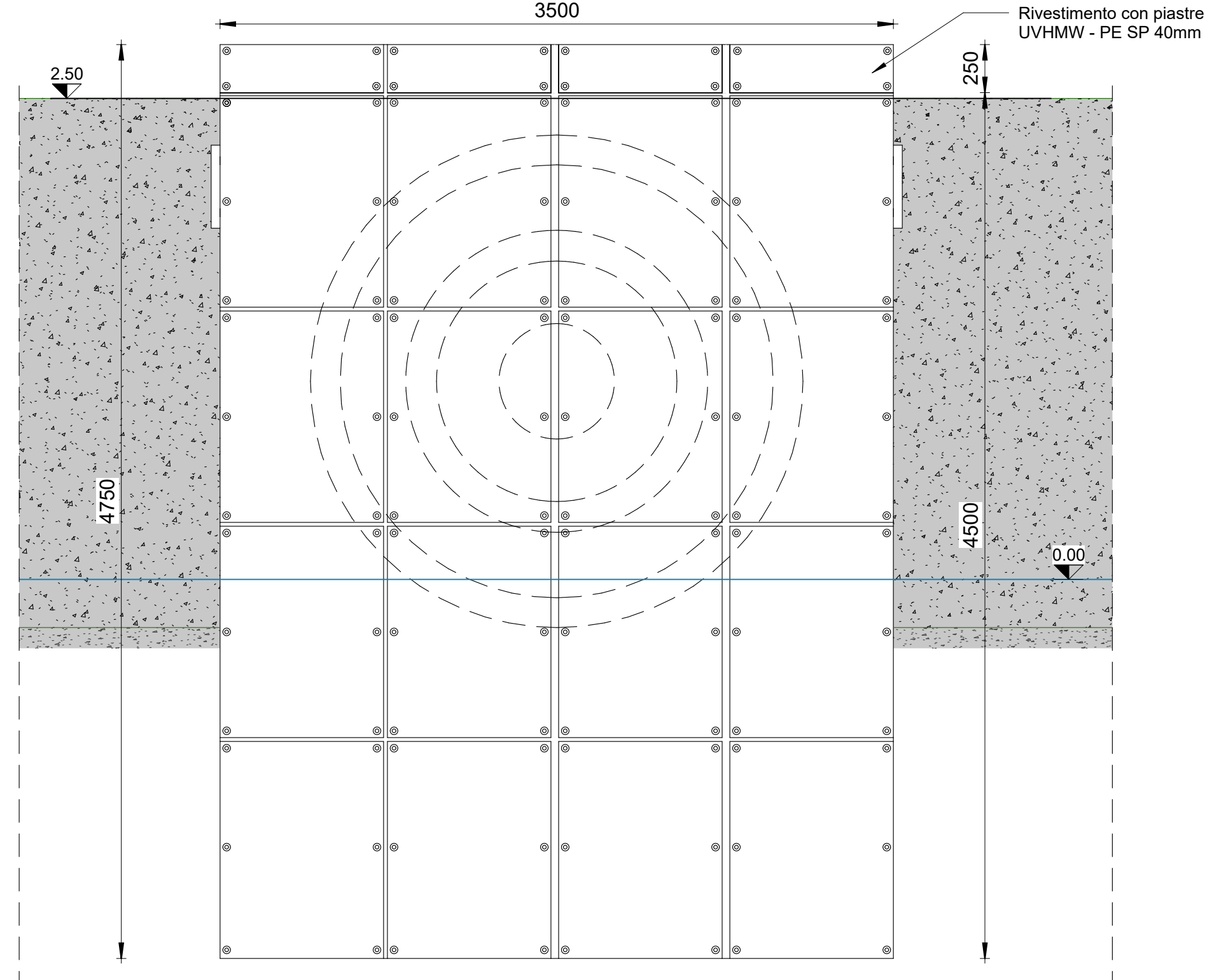

**Prospetto laterale**

Scala 1:25

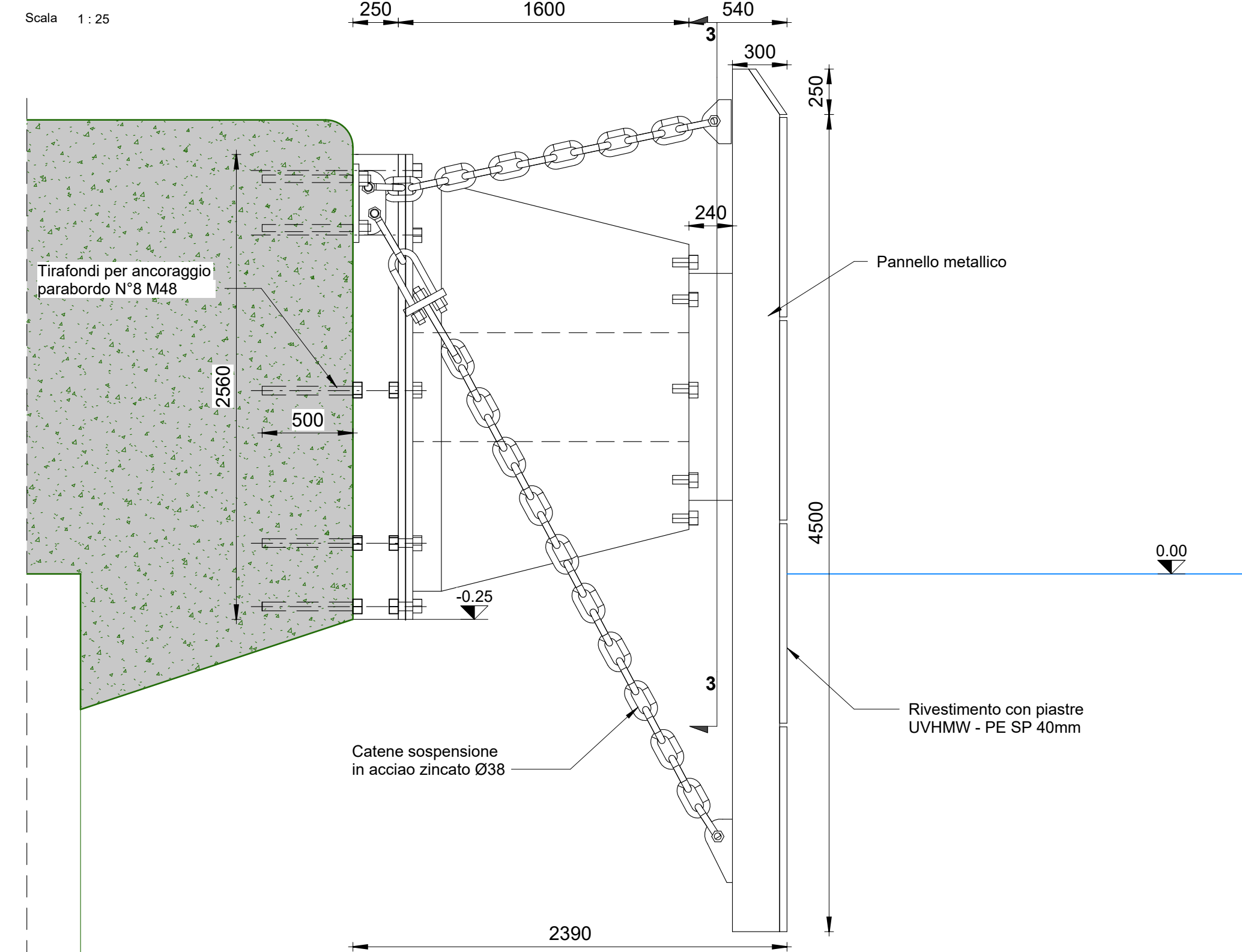

LA SPEZIA CONTAINER TERMINAL

PORTO DI LA SPEZIA  
AMPLIAMENTO TERMINAL RAVANO

**PROGETTO ESECUTIVO**

TITOLO ELABORATO

**Arredi di banchina - Parabordi**

CODICE ELABORATO

21 | 08 | PE | TS04 | 0

SCALA

Come indicato

Rev.	Data	Causale
0	05/05/2023	Emissione finale per verificatore

**IL COMMITTENTE**

LSCT S.p.a  
Viale San Bartolomeo, 20  
19126 - La Spezia (SP)  
C.F. 00072960115 - P.IVA 00839620114

**IL PROGETTISTA**

Modimor Project S.r.l.  
Motimor Project S.r.l.  
Via Sennara, 72  
00100 - Roma (RM)  
C.F. - P.IVA 16016110009

Geotechnical Engineering Services S.r.l.  
GES - Geotechnical Engineering Service S.r.l.  
Via Sandro Tatti, 7/A - 60131 Ancona (AN)  
C.F. - P.IVA 0529109420

LSA Progetti - Studio Tecnico Associato  
Via Sandro Perini, 55 - 62023 Tolentino (MC)  
C.F. - P.IVA 0081750432

DIMENSIONI FOGLIO

A1

Disegnato:	Controllato:	Validato:
Corinaldesi	Sanzone	Tartaglino

Note: