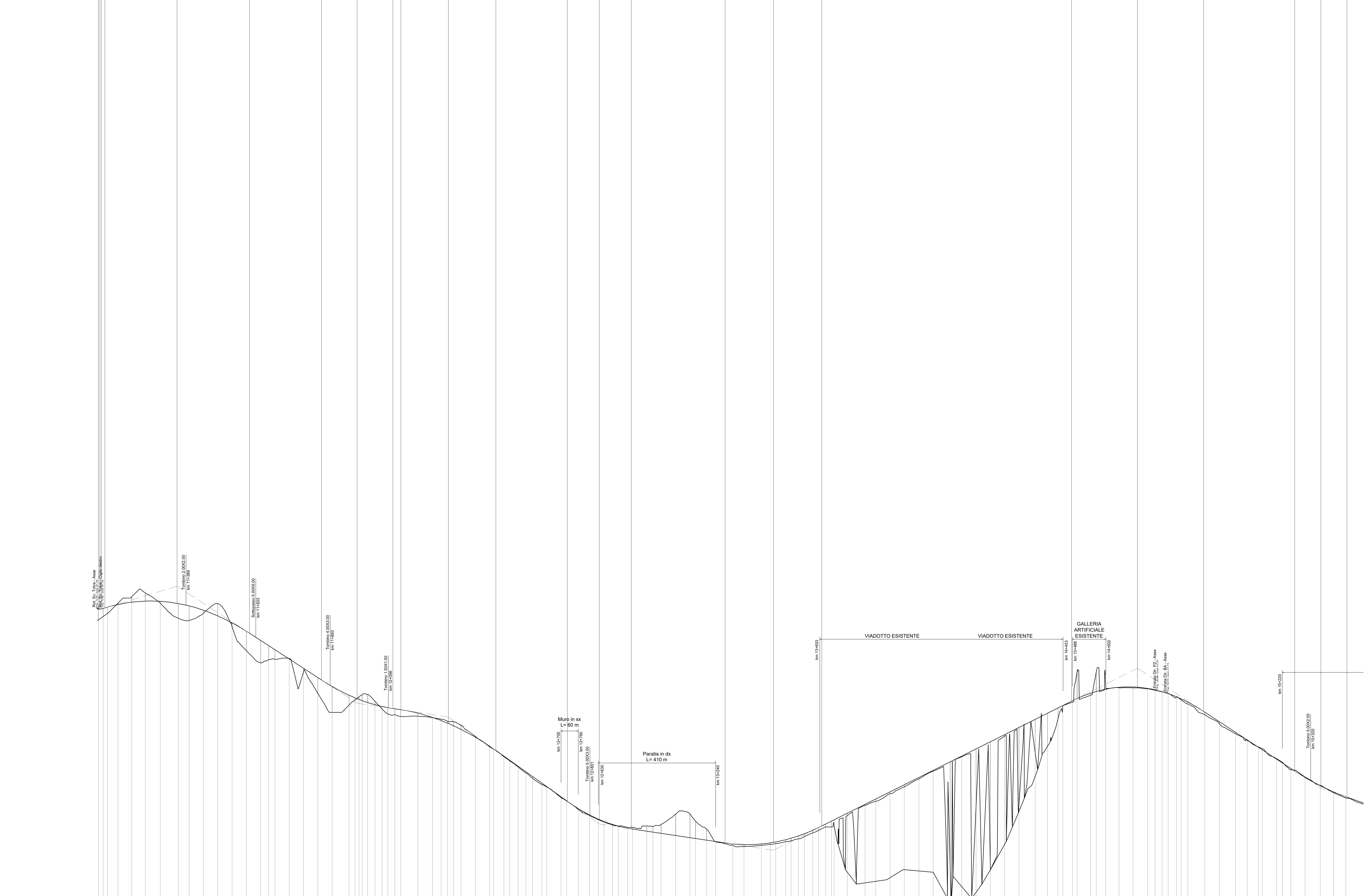

Table with 8 columns containing leveling data: N, Pi, Qi, R, T, Fr, Sv. Includes vertical curve data with height (h), length (L), and grade (i) for each section.



Technical drawing data table with columns: NUMERO SEZIONI, DISTANZE PARZIALI, DISTANZE PROGRESSIVE, QUOTE TERRENO, QUOTE PROGETTO, ETTOMETRICHE, and SCOPRELEVAZIONI. Includes vertical curve data at the bottom with L, h, and i values.

Project title: ITINERARIO "SALERNO - POTENZA - BARI" Adeguamento delle sedi esistenti e tratti di nuova realizzazione IV tratta da zona industriale Vaglio a svincolo S.P. Oppido S.S. 96. Includes logos for Sanas, GPI Ingegneria, and HYpro. Project code: TO01A35TRAFPO4.

Revision table with columns: C, B, A, and REV. Includes revision dates (Feb. '22, Sett. '19), revisioners (Parente, De Sanctis, Guiducci), and descriptions of revisions.