

**ARMATURA SMORZA**  
FERRI ESTRADOSSO

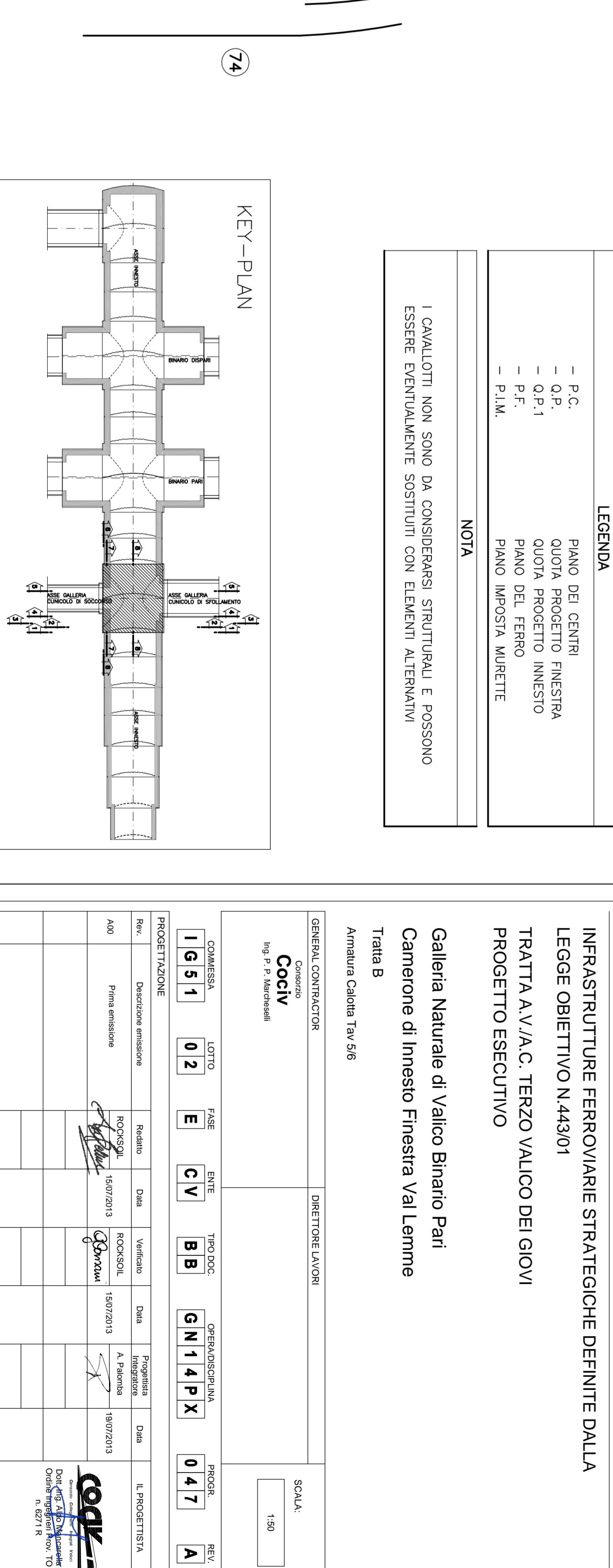

**PARTICOLARE COPRIFERRO**  
SCALA 1:10

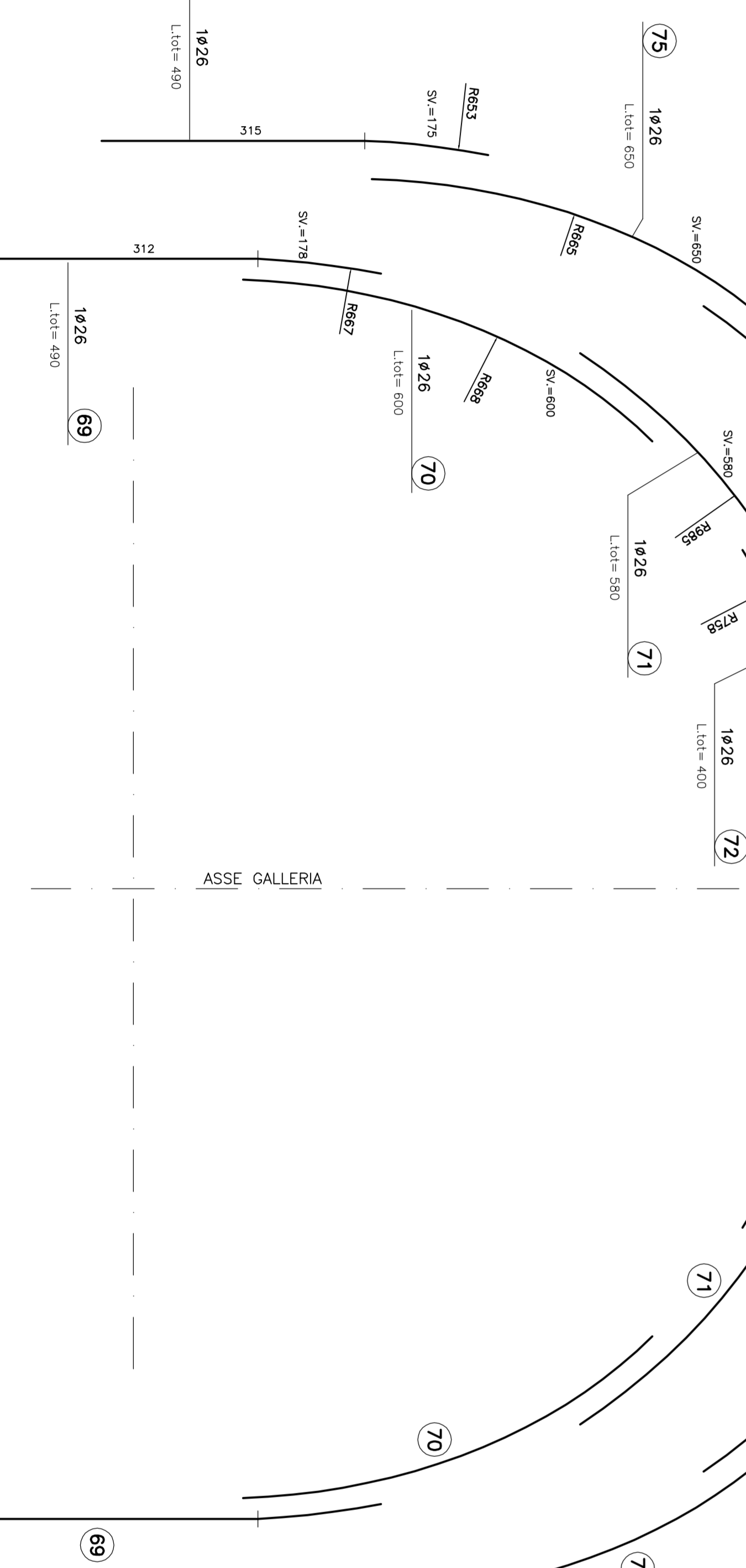
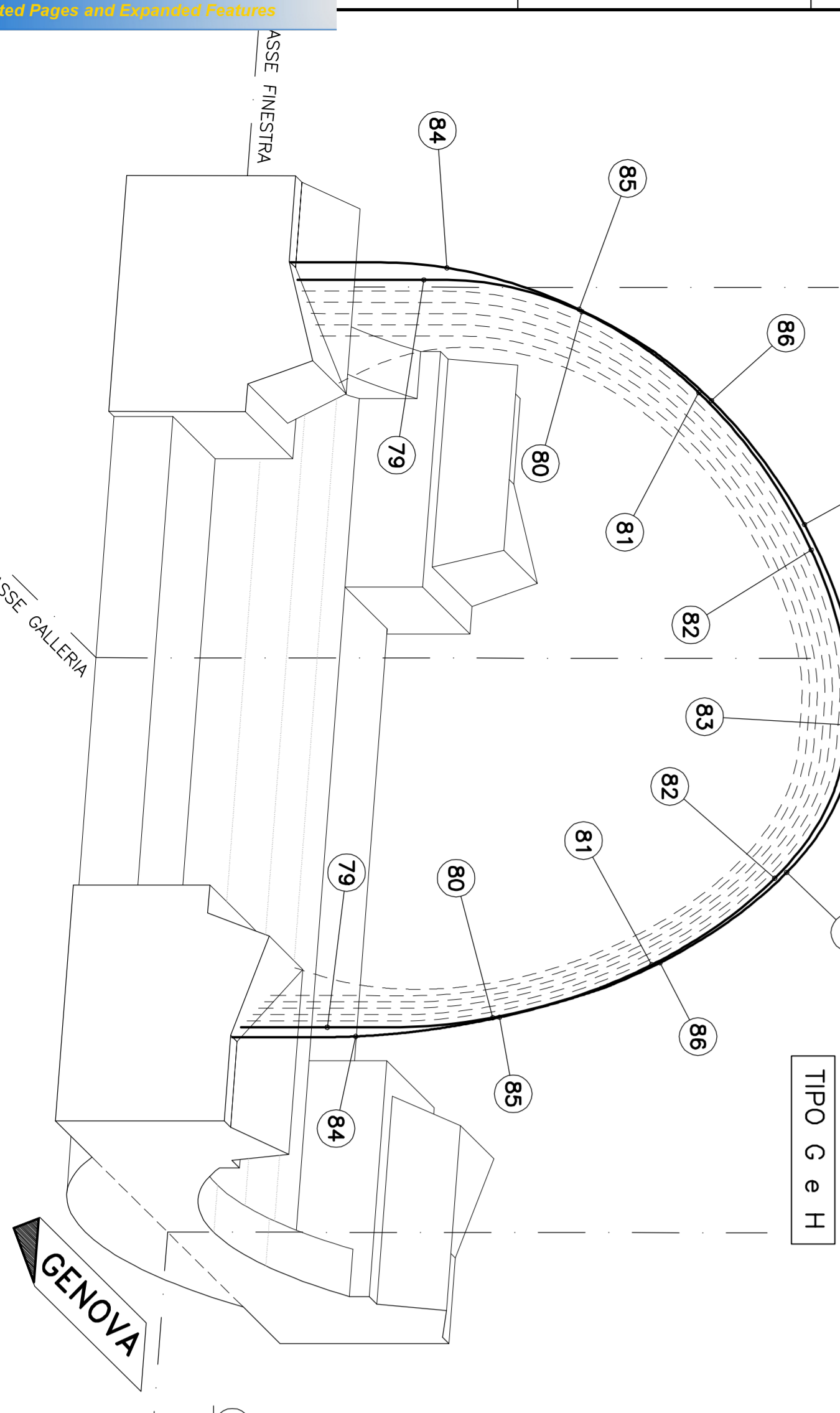
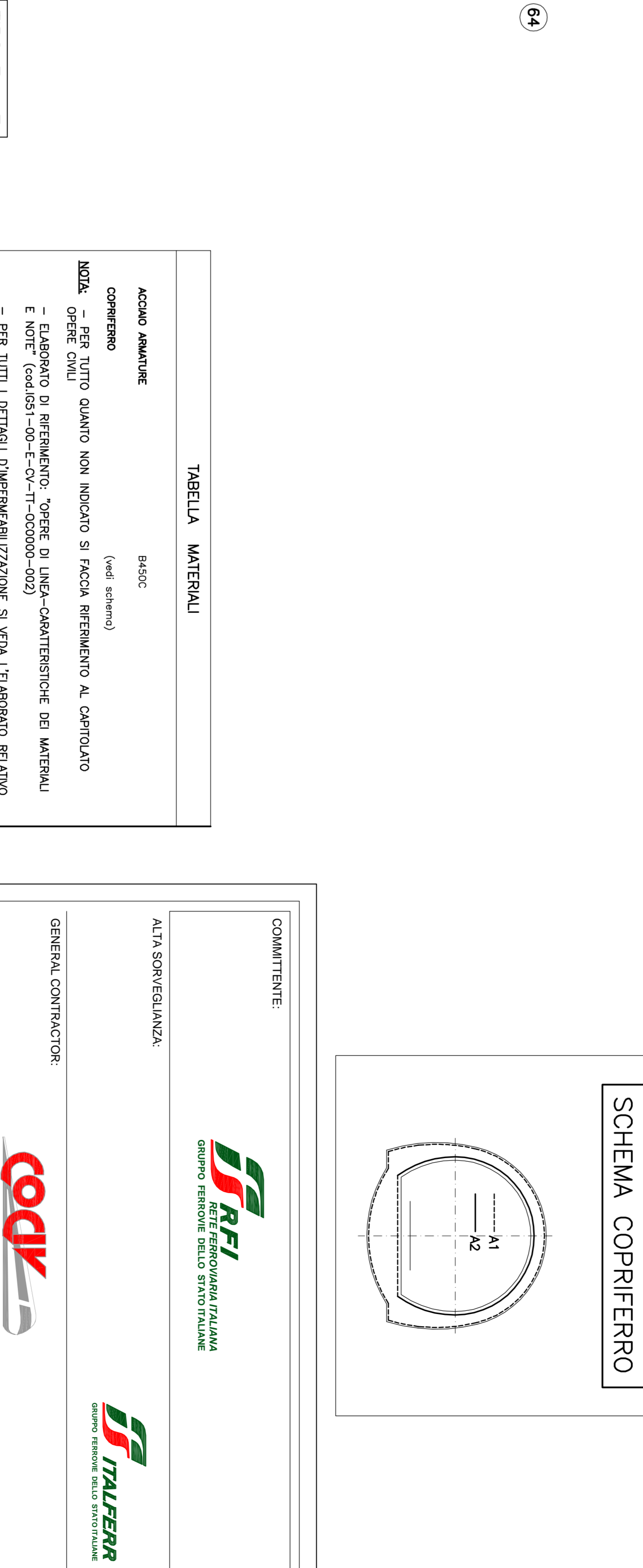
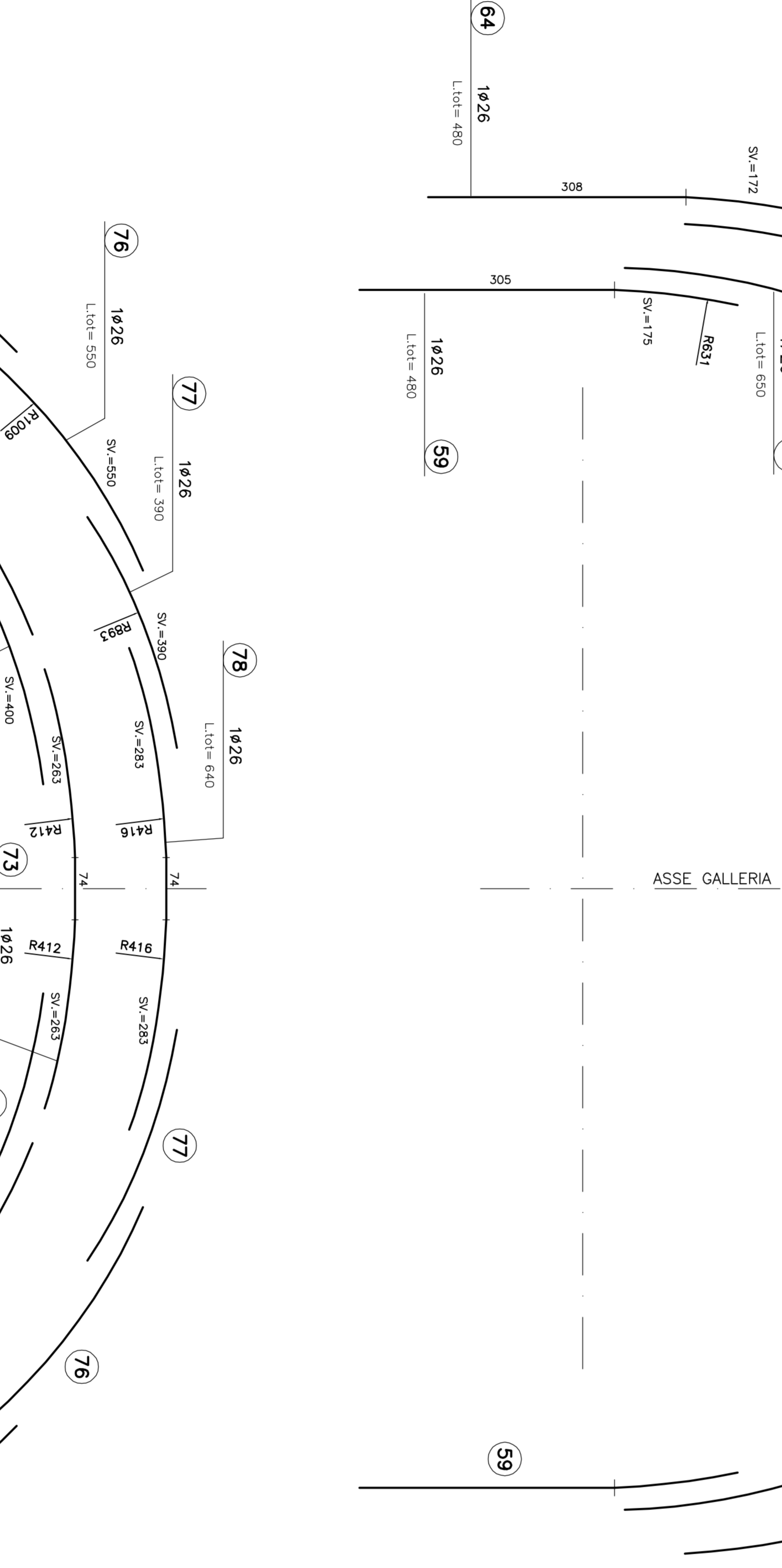
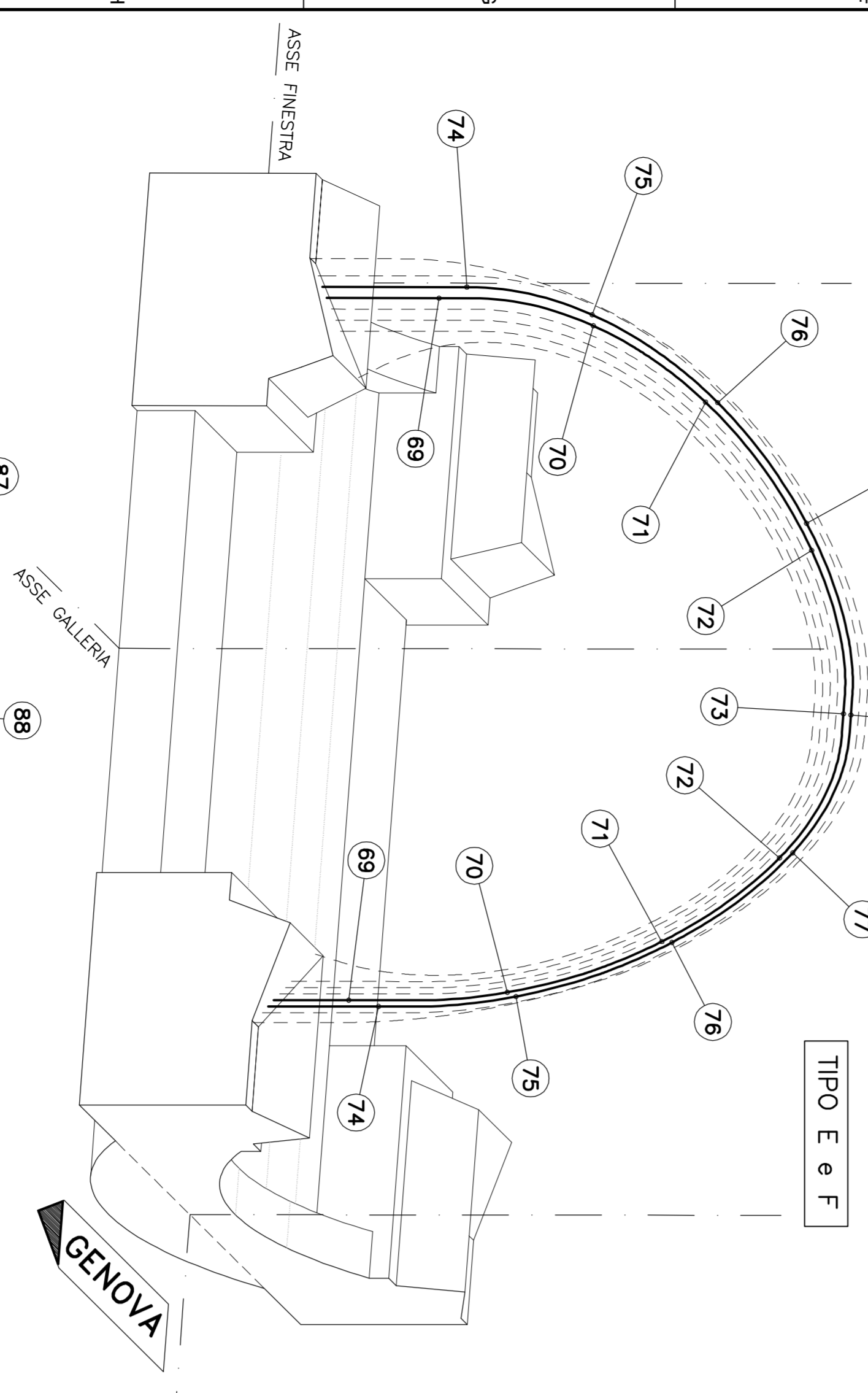
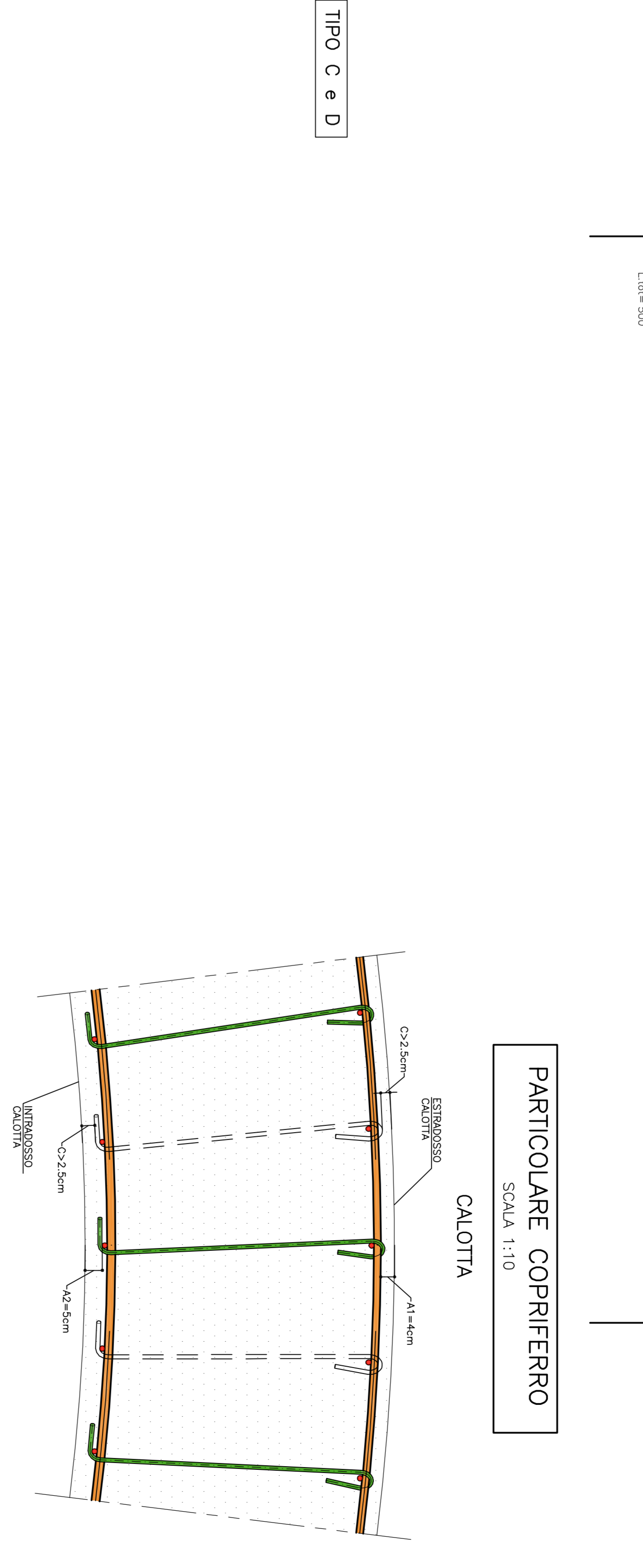
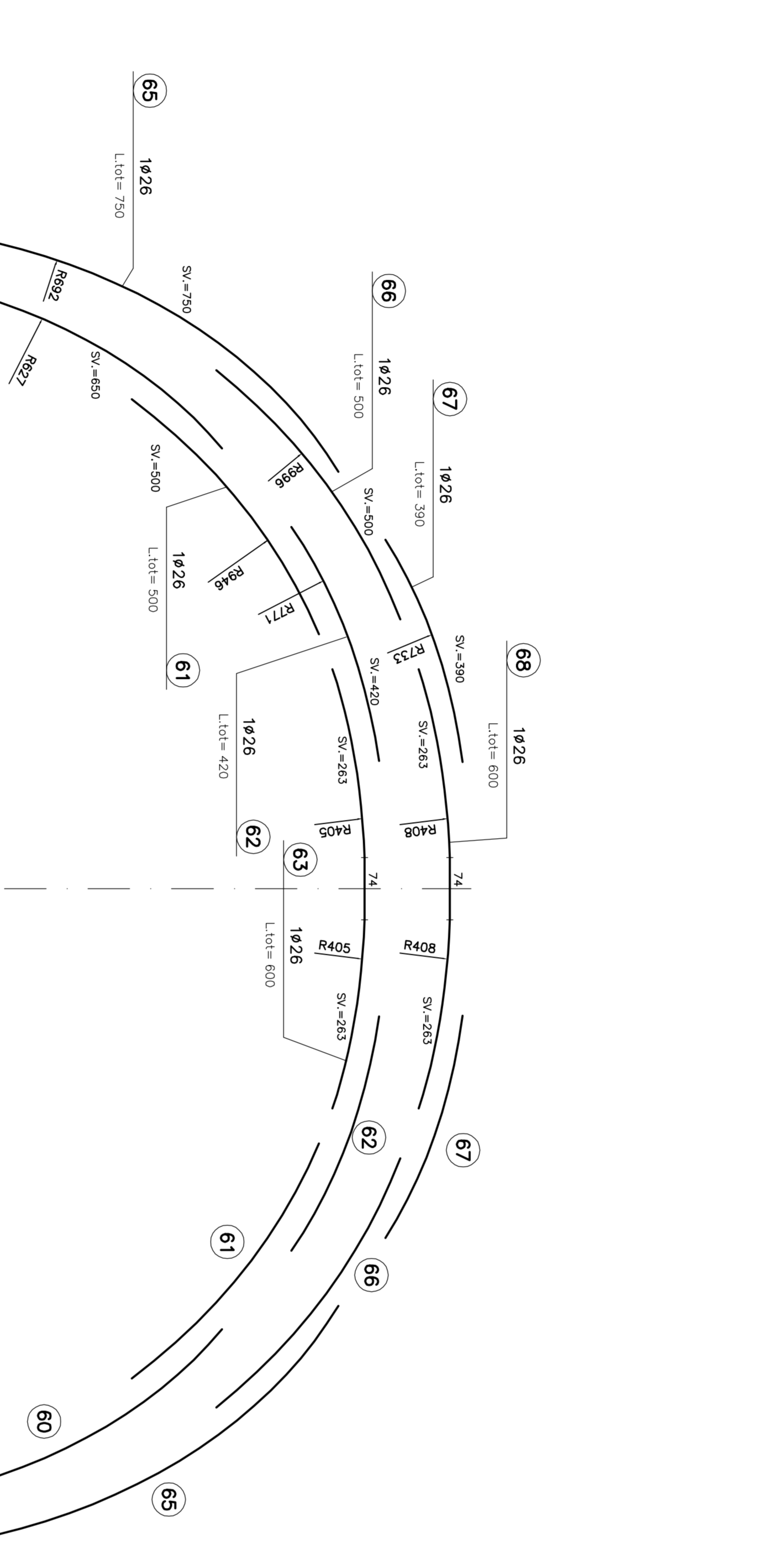
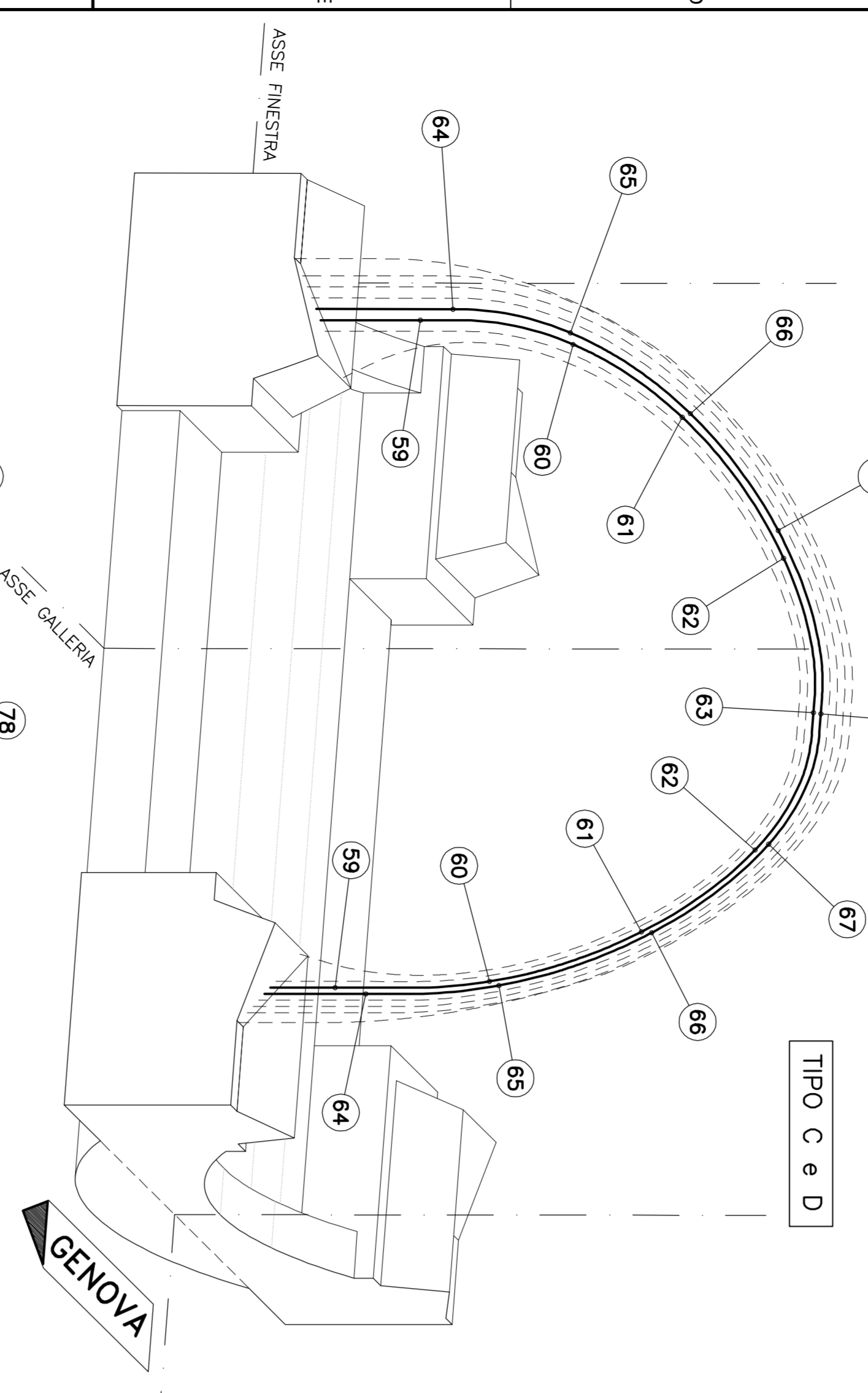
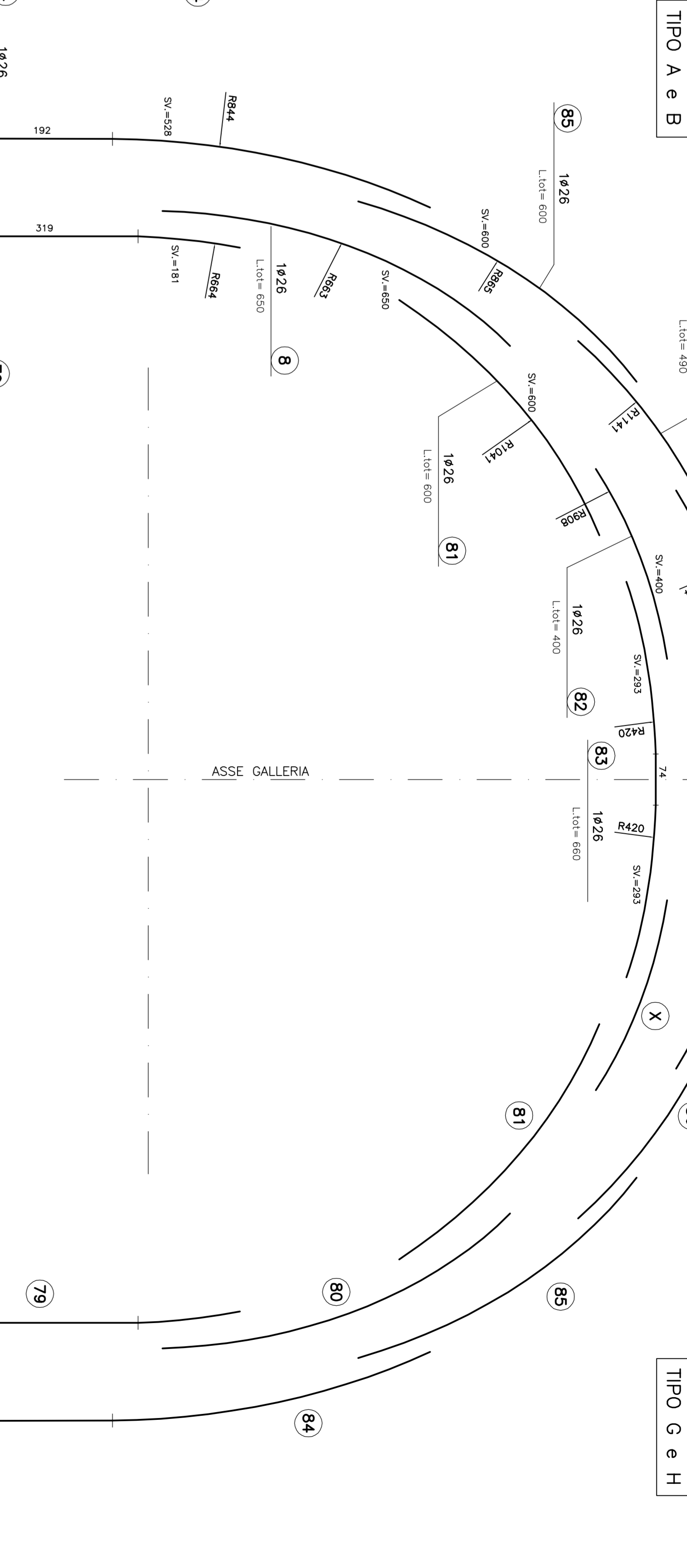
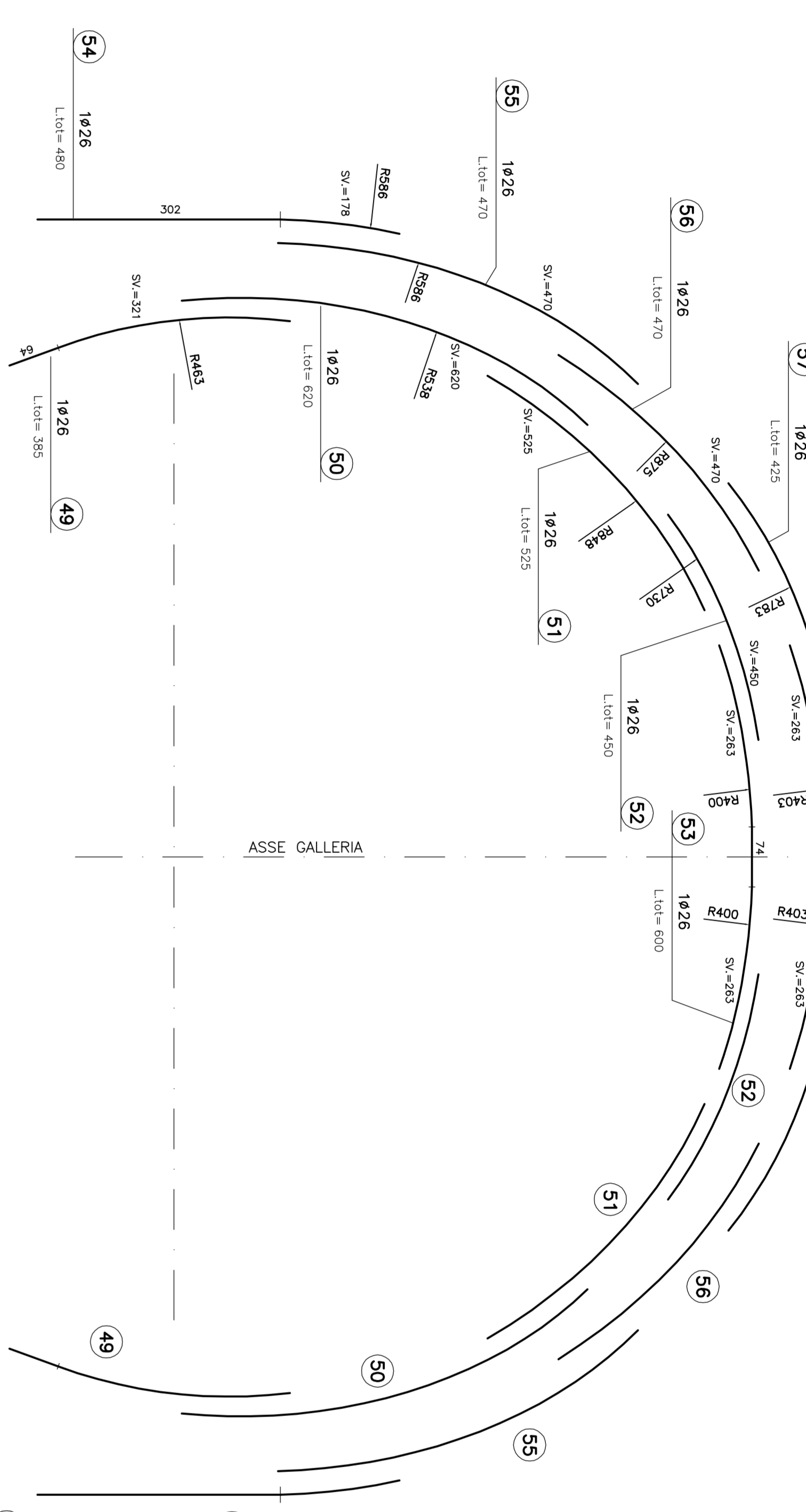
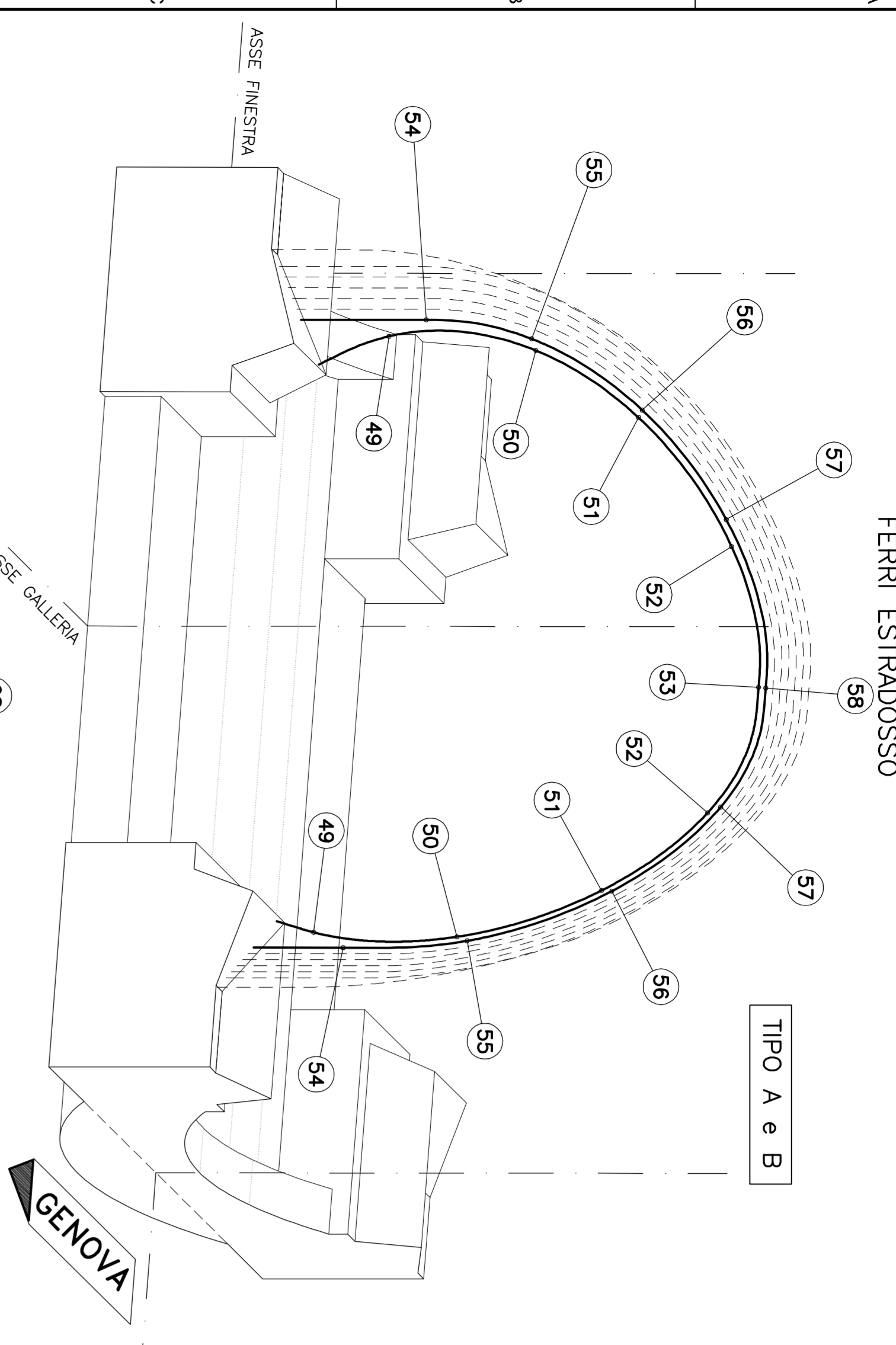
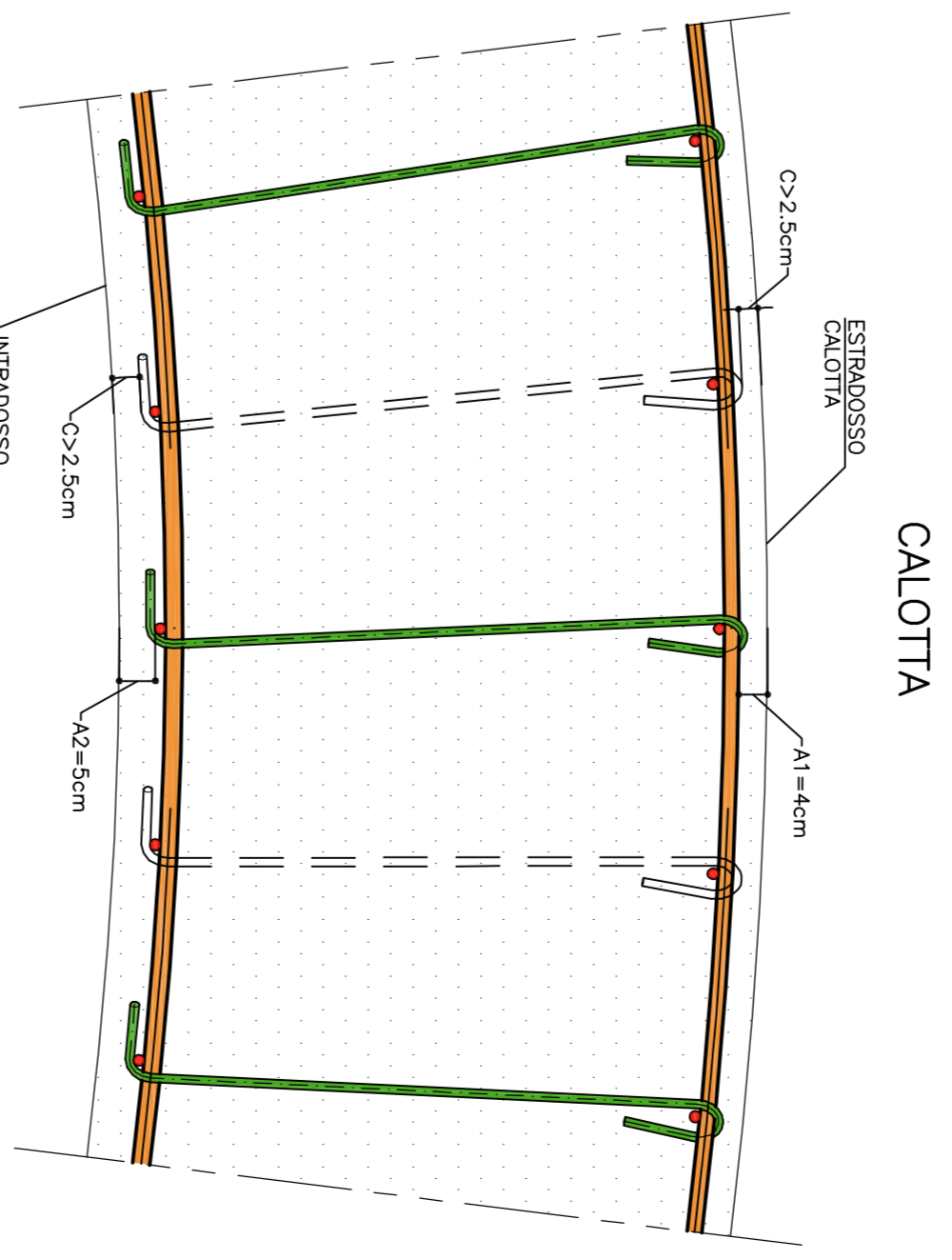

**SCHEMA COPRIFERRO**



TABELLA MATERIALI	
ACCIAIO ARMATIFERRO	R40C (vedi schema)
COPRIFERRO	
NOTE: - PER TUTTO QUANTO NON INDICATO SI FACCA RIFERIMENTO AL CAPITOLO ORDRE CALVI	
- ELABORANDO IL PROGETTO, TORRE DI INGEG. CARATTERISTICO DEI MATERIALI E VEDI IL CAPITOLO ORDRE CALVI	
- PER TUTTI I DETTAGLI DI PERMEABILIZZAZIONE SI VEDA L'ELABORAZIONE RELATIVA	
LEGENDA	
- P.C.	PIANO DEI CENTRI
- O.P.F.1	QUOTA PROGETTO INTERNO
- P.F.	PIANO DEL FERRO
- P.I.M.	PIANO IMPEDIZIA MURHETTE
NOTA	
I CAVALLOTTI NON SONO DA CONSIDERARSI STRUTTURALI E POSSONO ESSERE EVENTUALMENTE SOSTITUITI CON ELEMENTI ALTERNATIVI	



**COMMITTENTE:** ALTA SORVEGLIANZA

**GENERAL CONTRACTOR:** **COOPV** (Gruppo: Sordani, Ing. Mario)

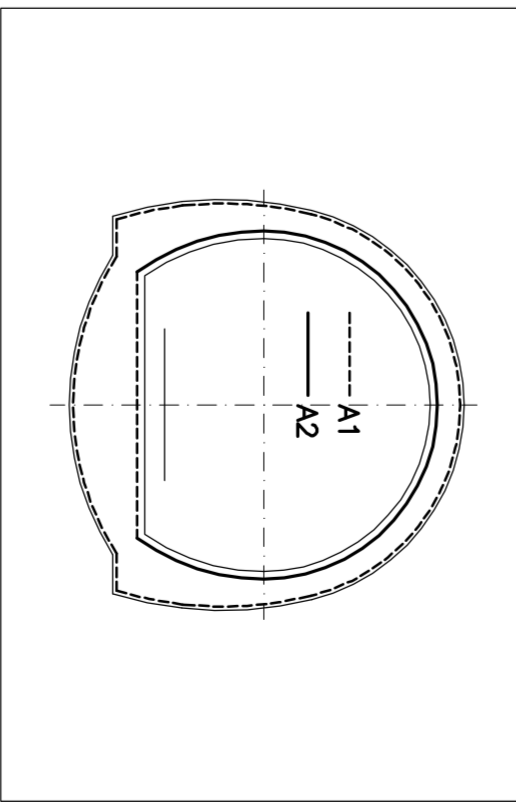
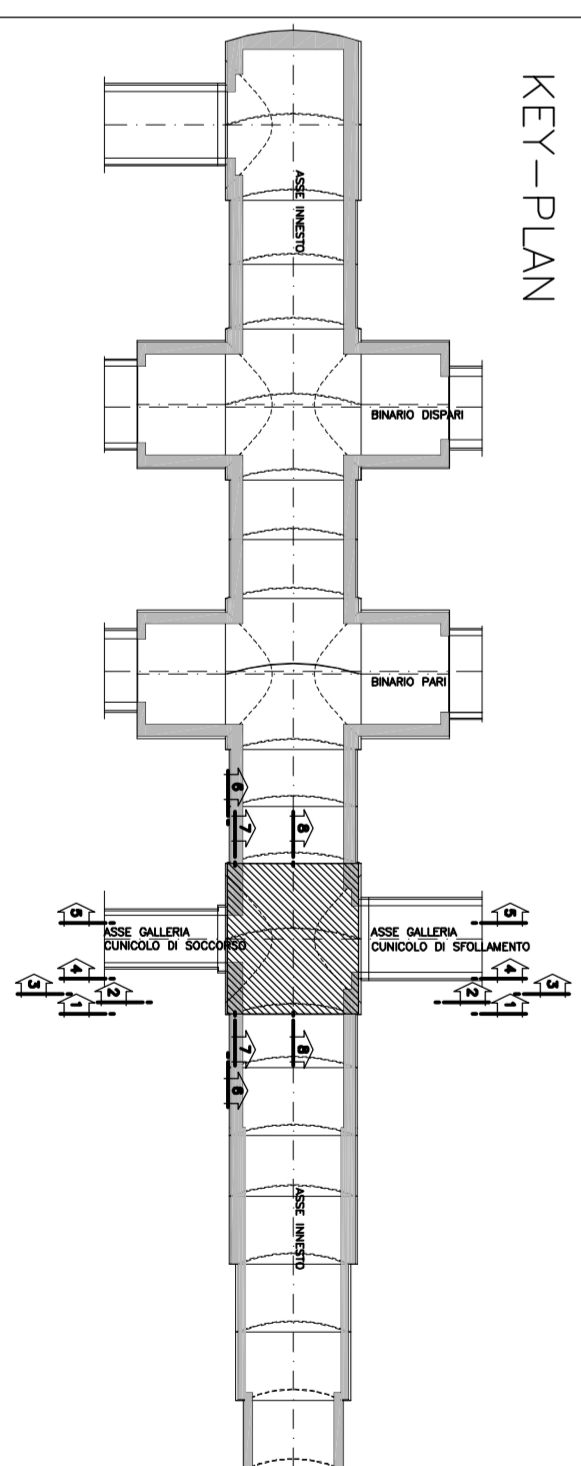
**INFRASTRUTTURE FERROVIARIE STRATEGICHE DEFINITE DALLA LEGGE OBETTIVO N.443/01**

**TRATTA A/V.A.C. TERZO VALICO DEI GIOVI**

**PROGETTO ESECUTIVO**

Galleria Naturale di Valico Binario Pari  
Camerone di Inneso Finestra Val Lemme  
Tratto B  
Armatura Calotta Tav. 5/8

**GENERAL CONTRACTOR:** **COOPV** (Gruppo: Sordani, Ing. Mario)

**GENERAL CONTRACTOR:** **ITALFERR** (Gruppo: Sordani, Ing. Mario)

CONFERMA	LETTO	FASE	DATE	TIPOLOGIA	OPERAZIONE	PROG.	REV.
1	5	1	02	E	C.V.I.	B.B.	G.N.I.P.X
PROGETTISTA	PROVA	VERIFICA	VERIFICA	VERIFICA	VERIFICA	VERIFICA	VERIFICA
Ing. Sordani	Ing. Sordani	Ing. Sordani	Ing. Sordani	Ing. Sordani	Ing. Sordani	Ing. Sordani	Ing. Sordani

SCALA: 1:50