

SEZIONE TRASVERSALE F-F scala 1:50

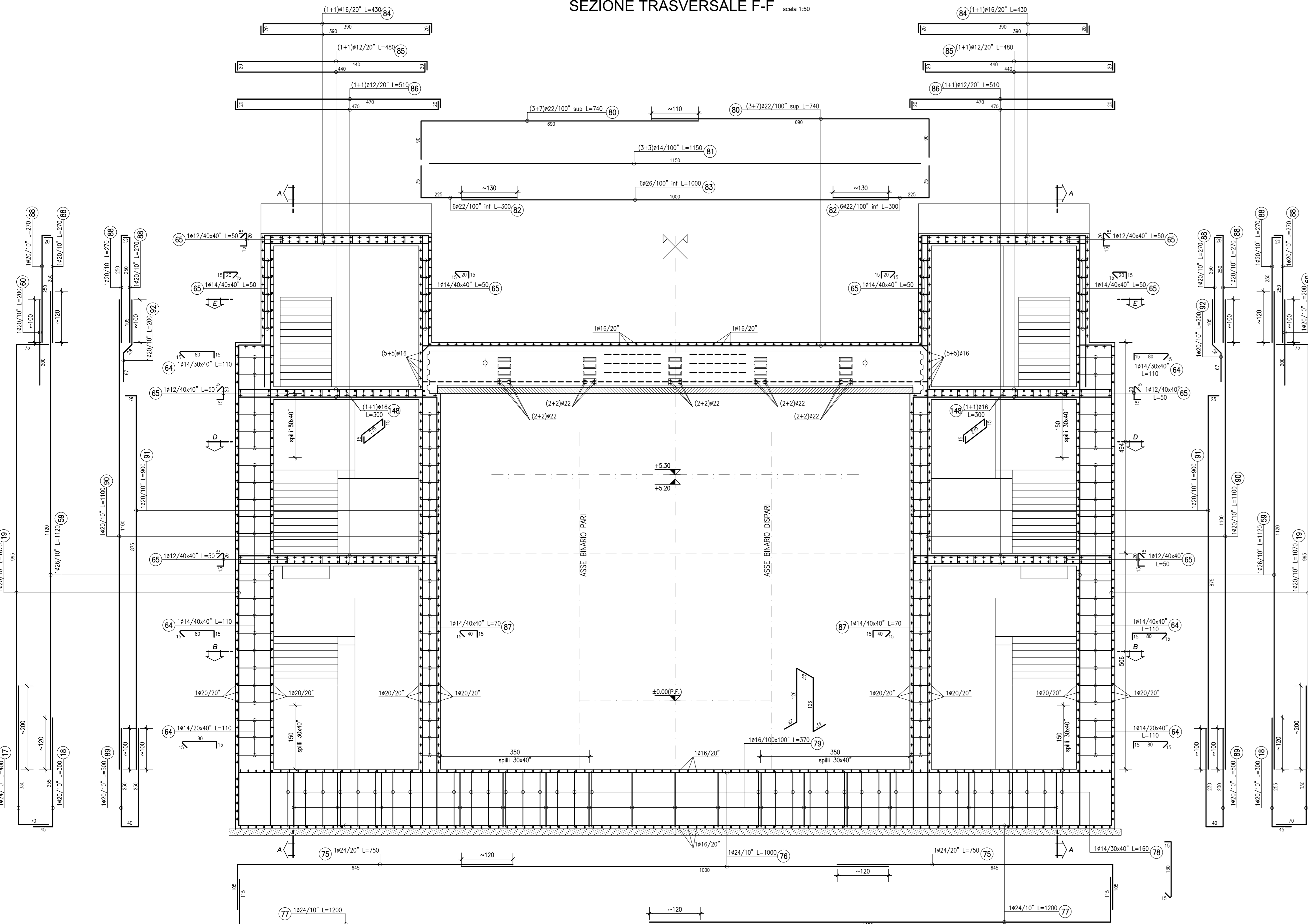

SEZIONE TRASVERSALE G-G scala 1:50

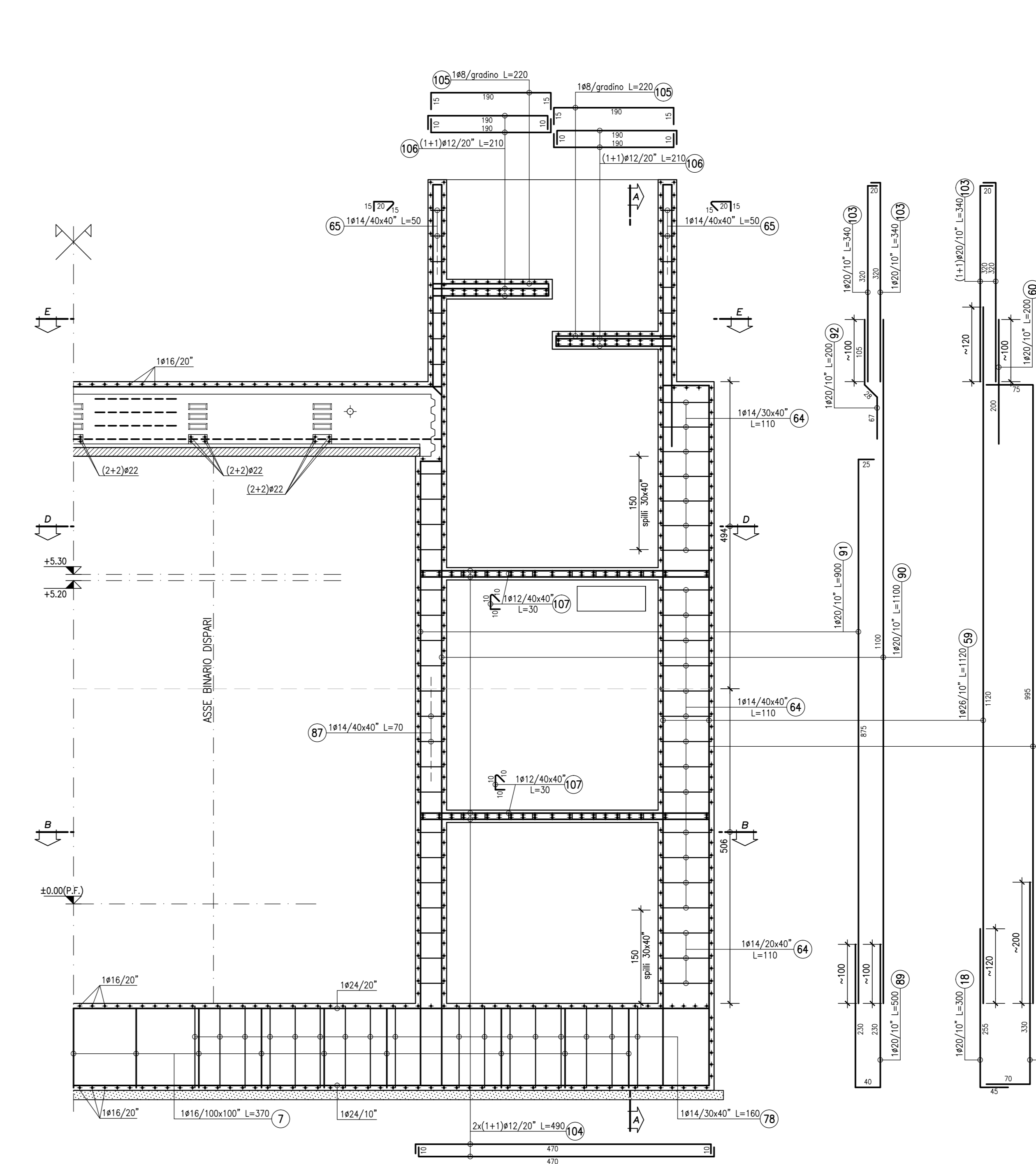

SEZIONE TRASVERSALE H-H scala 1:50

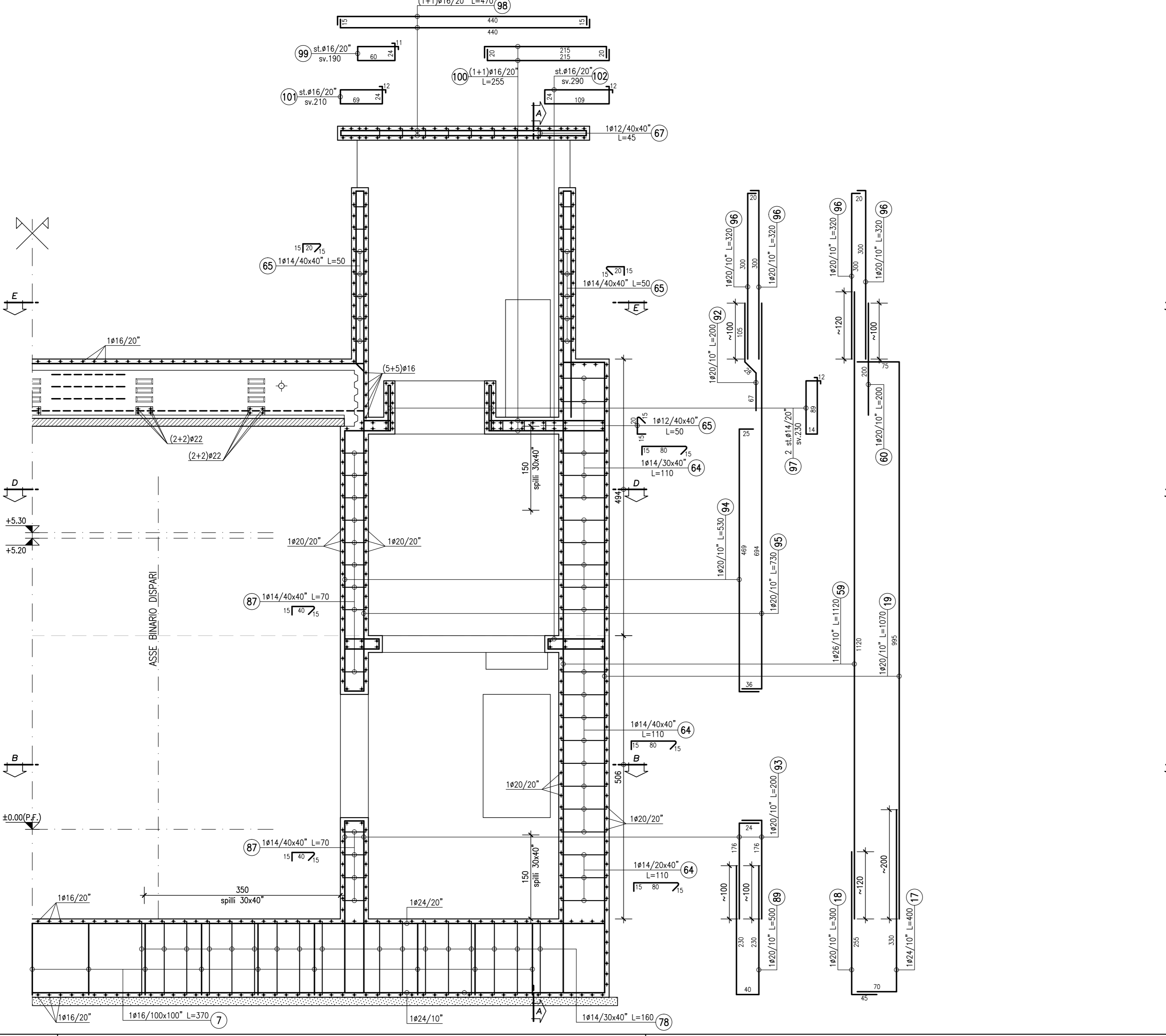

SEZIONE TRASVERSALE I-I scala 1:50

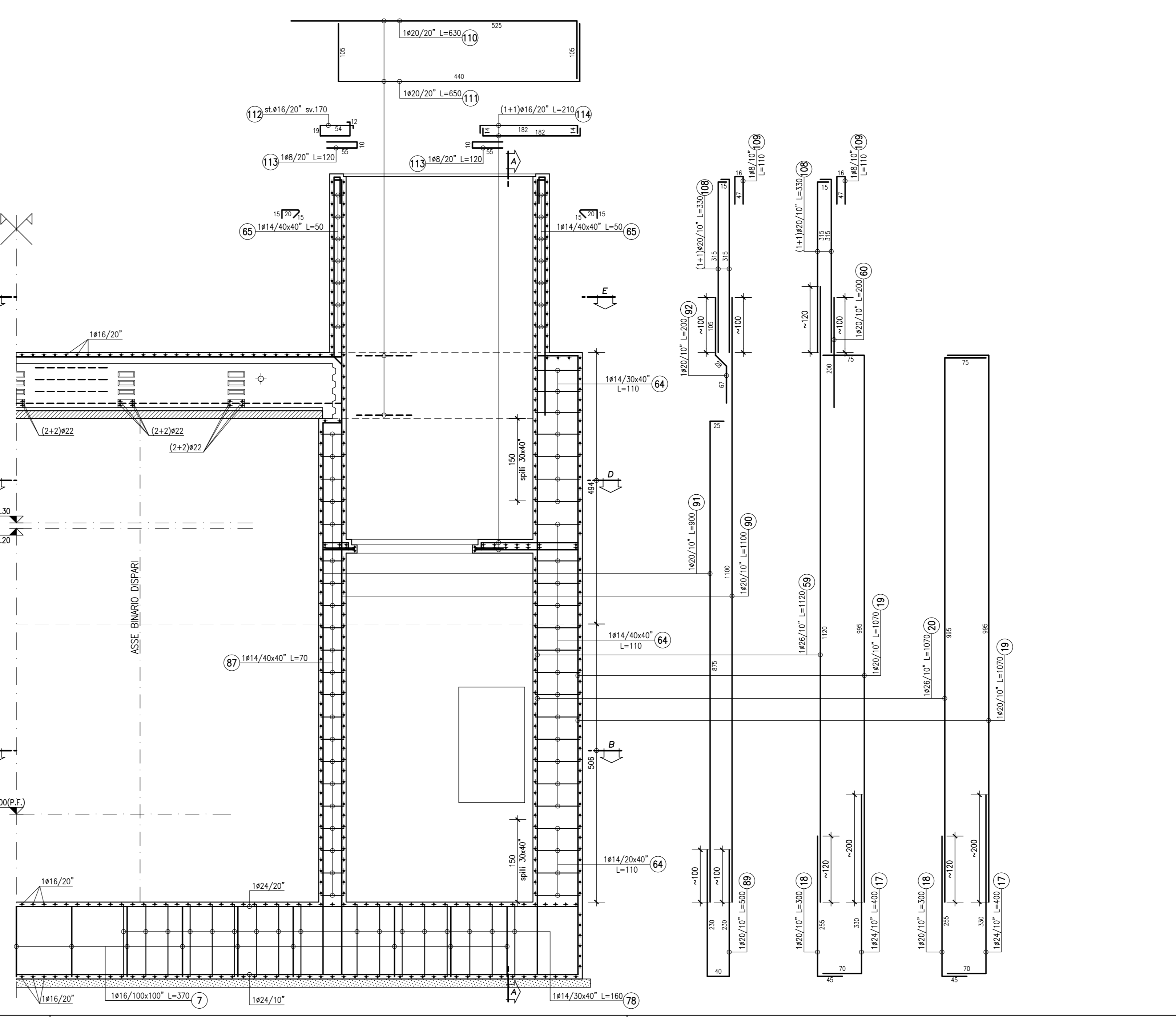

KEY PLAN scala 1:500

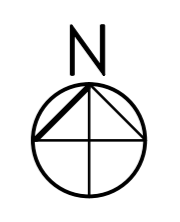
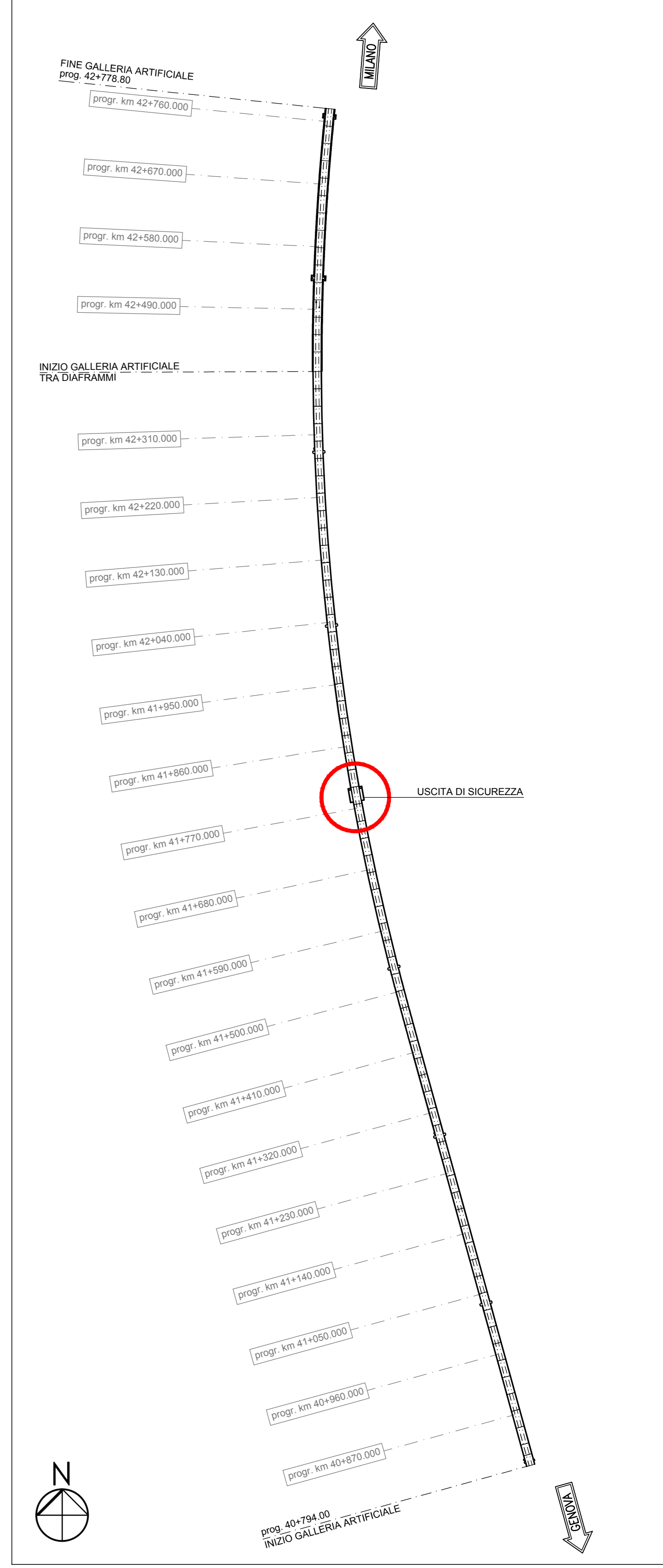

NOTA

Per la tabella materiali si fa riferimento all'elaborato IG51-00-E-CV-TT-0C00-00-002

COMMITTENTE:
RFI
 Rete Ferroviaria Italiana
 Gruppo Ferrovie dello Stato Italiane

ALTA SORVEGLIANZA:
ITALFERR
 Gruppo Ferrovie dello Stato Italiane

GENERAL CONTRACTOR:
COCIV
 Consorzio Costruttori Integrati Valchi

INFRASTRUTTURE FERROVIARIE STRATEGICHE DEFINITE DALLA LEGGE OBIETTIVO N.443/01
 TRATTA A.V./A.C. TERZO VALICO DEI GIOVI
 PROGETTO ESECUTIVO

GALLERIA ARTIFICIALE POZZOLO DAL KM 40+794.00 AL KM 42+778.00
 Uscite di sicurezza: armatura tav. 3

GENERAL CONTRACTOR Consorzio Cociv ing. P.P. Marchetti	DIRETTORE LAVORI	SCALA: 1:50
COMMESSA IG51	LOTTO 02	FASE E
ENTE CV	TIPO DOC. BZ	OPERAZIONE GA1M0X
PROGETTAZIONE	PROG. REV.	
Rev. 001	01	01
Rev. 002	02	02
Rev. 003	03	03
Rev. 004	04	04
Rev. 005	05	05
Rev. 006	06	06
Rev. 007	07	07
Rev. 008	08	08
Rev. 009	09	09
Rev. 010	10	10
Rev. 011	11	11
Rev. 012	12	12
Rev. 013	13	13
Rev. 014	14	14
Rev. 015	15	15
Rev. 016	16	16
Rev. 017	17	17
Rev. 018	18	18
Rev. 019	19	19
Rev. 020	20	20
Rev. 021	21	21
Rev. 022	22	22
Rev. 023	23	23
Rev. 024	24	24
Rev. 025	25	25
Rev. 026	26	26
Rev. 027	27	27
Rev. 028	28	28
Rev. 029	29	29
Rev. 030	30	30
Rev. 031	31	31
Rev. 032	32	32
Rev. 033	33	33
Rev. 034	34	34
Rev. 035	35	35
Rev. 036	36	36
Rev. 037	37	37
Rev. 038	38	38
Rev. 039	39	39
Rev. 040	40	40
Rev. 041	41	41
Rev. 042	42	42
Rev. 043	43	43
Rev. 044	44	44
Rev. 045	45	45
Rev. 046	46	46
Rev. 047	47	47
Rev. 048	48	48
Rev. 049	49	49
Rev. 050	50	50
Rev. 051	51	51
Rev. 052	52	52
Rev. 053	53	53
Rev. 054	54	54
Rev. 055	55	55
Rev. 056	56	56
Rev. 057	57	57
Rev. 058	58	58
Rev. 059	59	59
Rev. 060	60	60
Rev. 061	61	61
Rev. 062	62	62
Rev. 063	63	63
Rev. 064	64	64
Rev. 065	65	65
Rev. 066	66	66
Rev. 067	67	67
Rev. 068	68	68
Rev. 069	69	69
Rev. 070	70	70
Rev. 071	71	71
Rev. 072	72	72
Rev. 073	73	73
Rev. 074	74	74
Rev. 075	75	75
Rev. 076	76	76
Rev. 077	77	77
Rev. 078	78	78
Rev. 079	79	79
Rev. 080	80	80
Rev. 081	81	81
Rev. 082	82	82
Rev. 083	83	83
Rev. 084	84	84
Rev. 085	85	85
Rev. 086	86	86
Rev. 087	87	87
Rev. 088	88	88
Rev. 089	89	89
Rev. 090	90	90
Rev. 091	91	91
Rev. 092	92	92
Rev. 093	93	93
Rev. 094	94	94
Rev. 095	95	95
Rev. 096	96	96
Rev. 097	97	97
Rev. 098	98	98
Rev. 099	99	99
Rev. 100	100	100

PROGETTAZIONE
 Rev. Descrizione emissione Redatto Data Verificato Data Progettista
 A00 Prima emissione [Signature] 24/07/2013 S. Fucini 26/07/2013 A. Palomba 31/07/2013
 [Signature] [Signature] [Signature] [Signature] [Signature]

in. Elab. Nome File: IG51-00-E-CV-TT-0C00-00-002-001
 CUP: F81H0000000000