





Planimetria generale scala 1:4000









Planimetria di dettaglio area NORD-OVEST scala 1:200

Legenda

-  Tracker
-  Viabilità interna
-  Recinzione e sentiero esterno
-  Cavidotto
-  Area destinata ad intervento di mitigazione

Modulo AA: Fascia arboreo-arbustiva

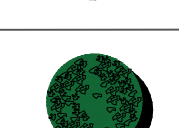
Specie arboree			
Nome latino	Nome volgare		h (m)
<i>Quercus ilex L.</i>	Leccio		15
<i>Quercus suber L.</i>	Sughera		15
Specie arbustive			
Nome latino	Nome volgare		h (m)
<i>Pistacia lentiscus L.</i>	Lentisco		3.5
<i>Myrtus communis L.</i>	Mirto		2
<i>Boxus sempervirens L.</i>	Bosso comune		3

Modulo sesto d'impianto a maglia rettangolare scala 1:50

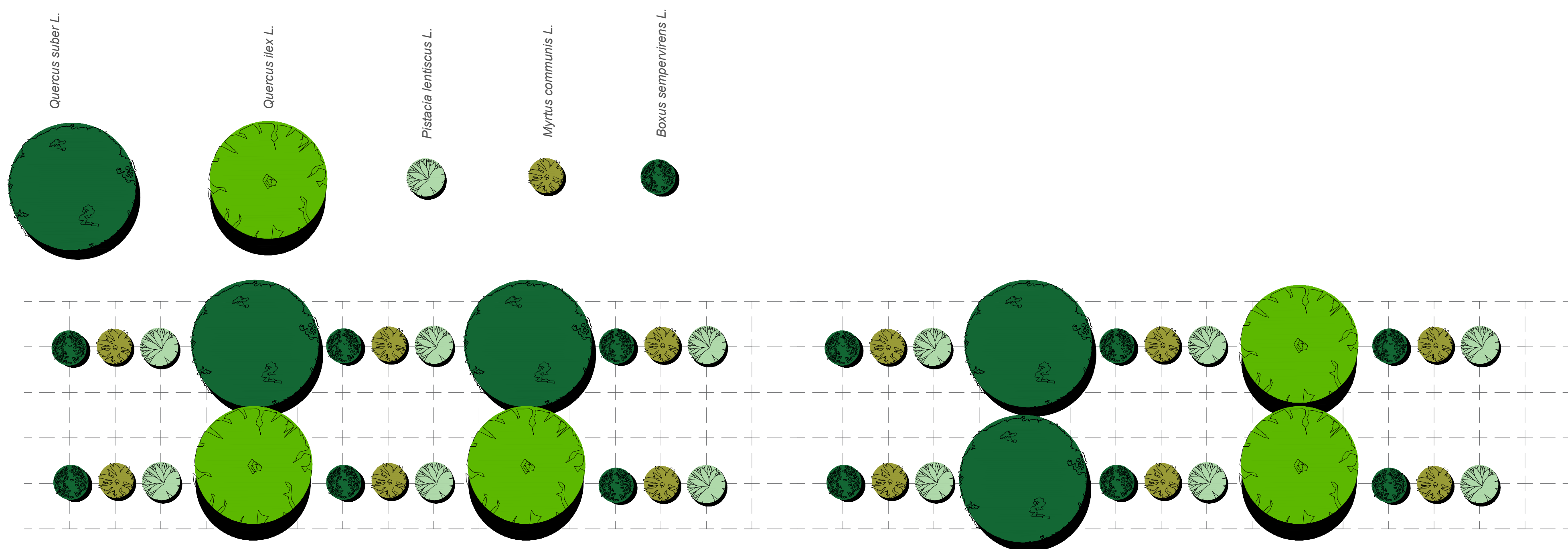

Modulo sesto d'impianto scala 1:100

Esempio della disposizione del sesto di impianto con messa a dimora di doppio filare perimetrale con interdistanza delle piante uguale lungo la fila. I due filari saranno costituiti da varie specie arboree ed arbustive coerenti con la vegetazione autoctona.

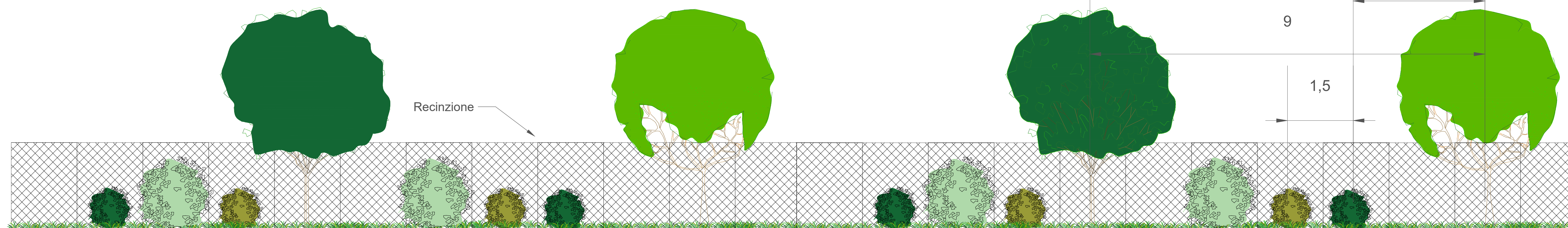

Prospetto BB' vista verso l'esterno del campo agrivoltaico scala 1:50

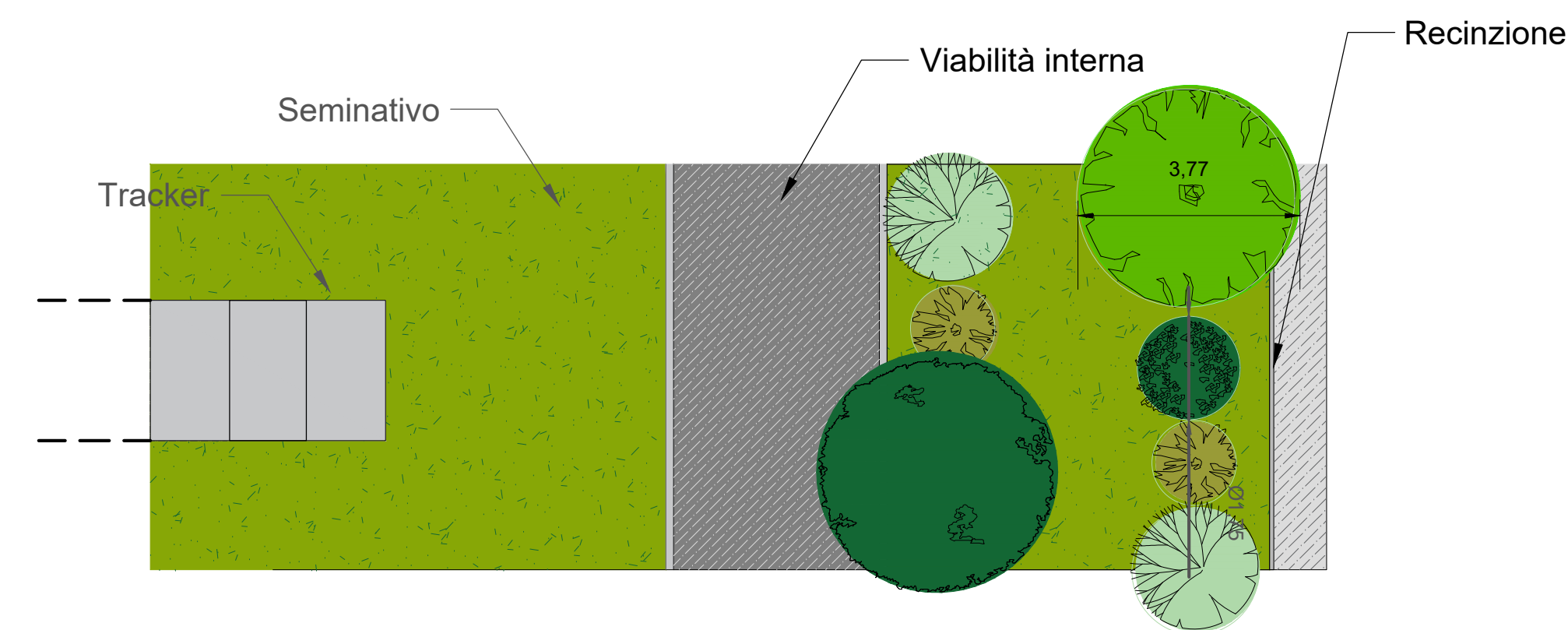

Planimetria di dettaglio scala 1:100

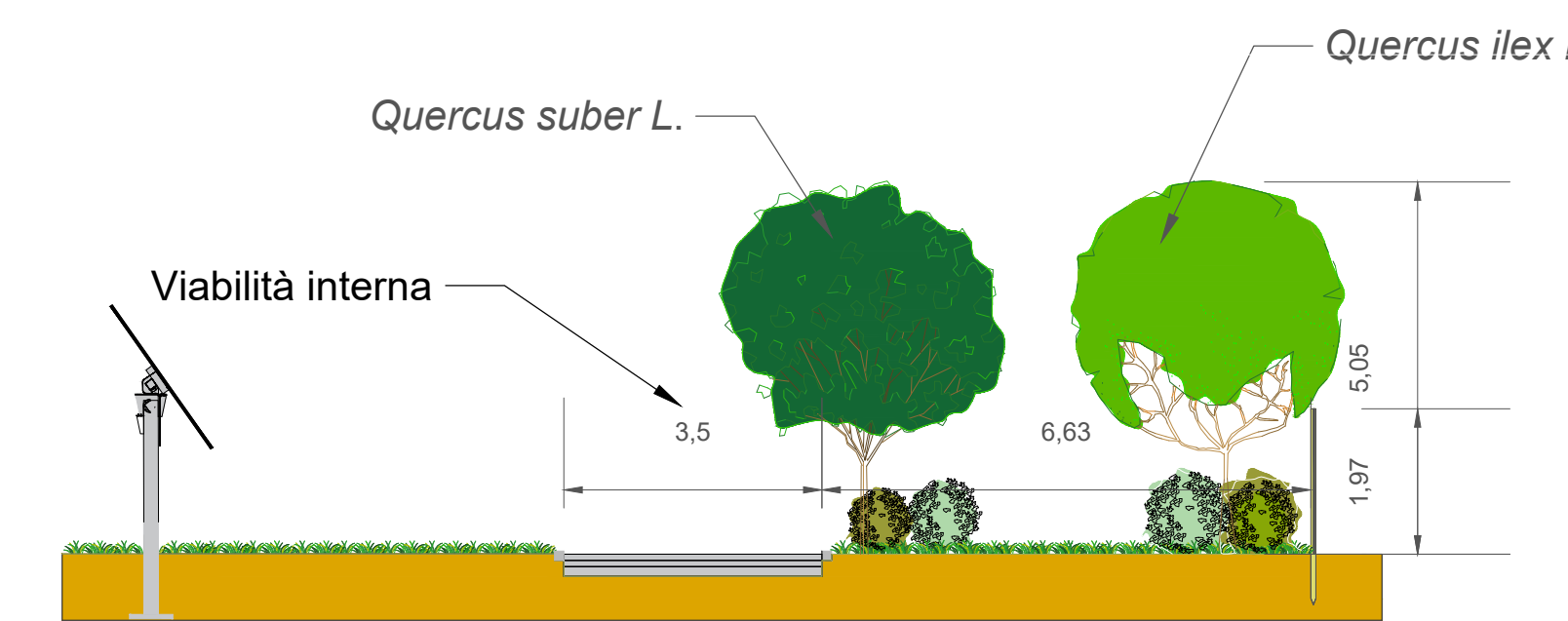

Sezione AA' scala 1:100

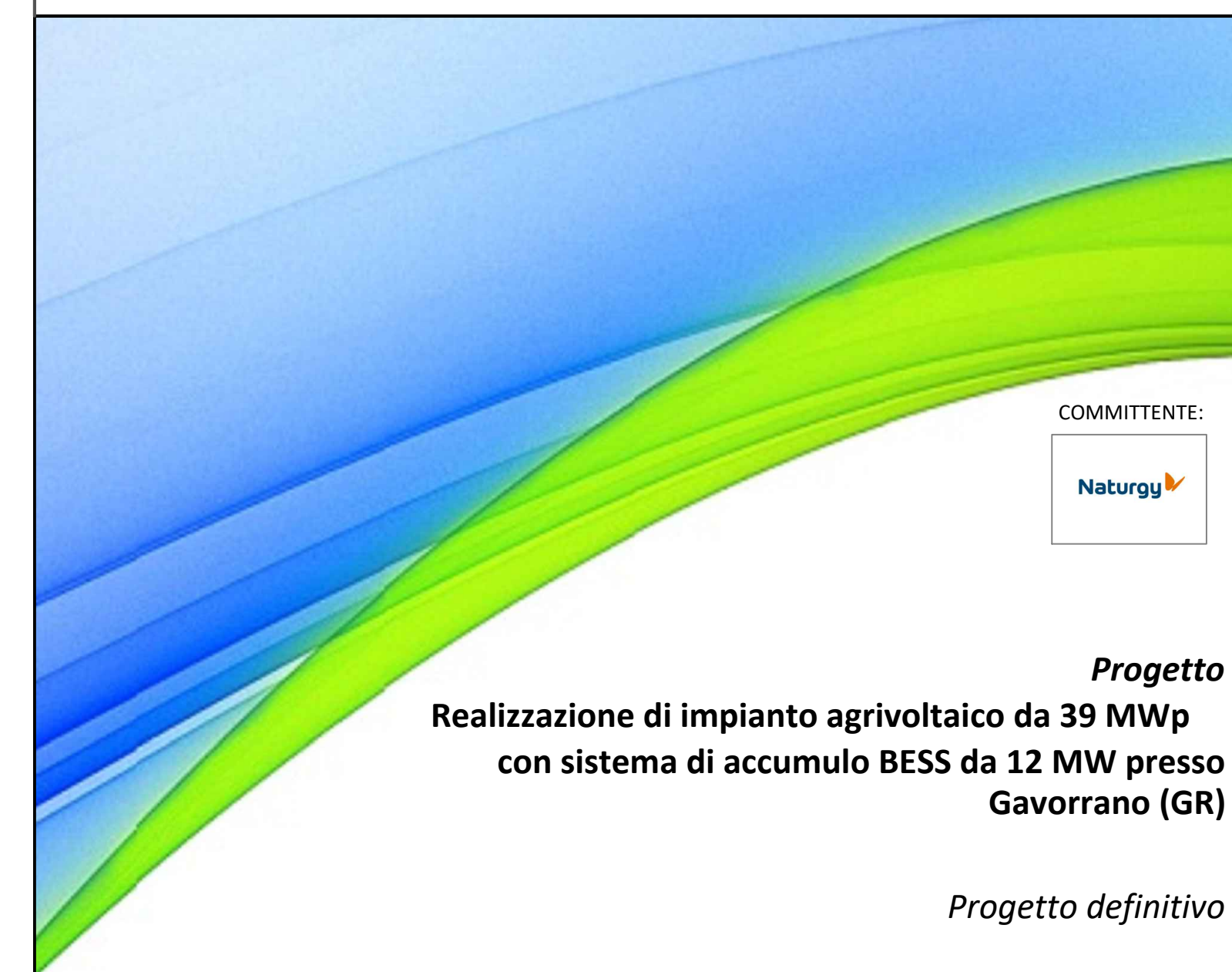

NAT02_PD_AMB_TAV14

Planimetria degli interventi di inserimento paesaggistico e ambientale e sezioni tipo: impianto agrivoltaico

COMMESSA	LIVELLO	AMB.	ELAB.	N.	NUMERO FILE	FORMATO	SCALA
NAT02	PD	PEC	TAV	14	NAT02_PD_AMB_TAV14	A0	VARIE
REV.	DATA	REDAZIONE	VERIFICA	APPROVAZIONE	VERIFICATO	DESCRIZIONE	
0	Giugno 2024	F. Marsili	F. Marsili	M. Alterra		Consegna Progetto Definitivo	
1							
2							
3							