

SOLUTIONE DI ESTENSIONE DELLA SEZIONE 220KV

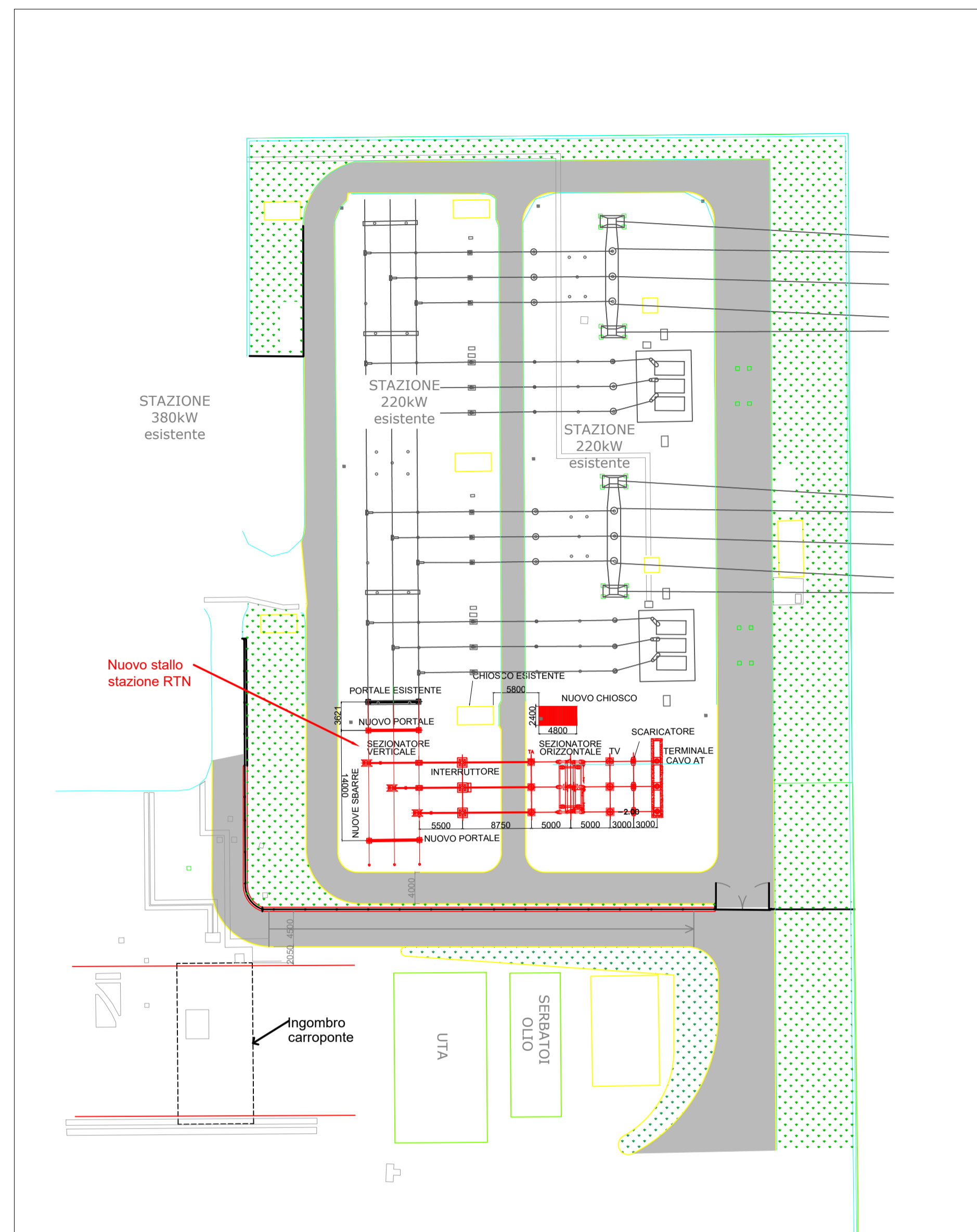

LAYOUT POST-INTERVENTO DELLA SEZIONE 220KV

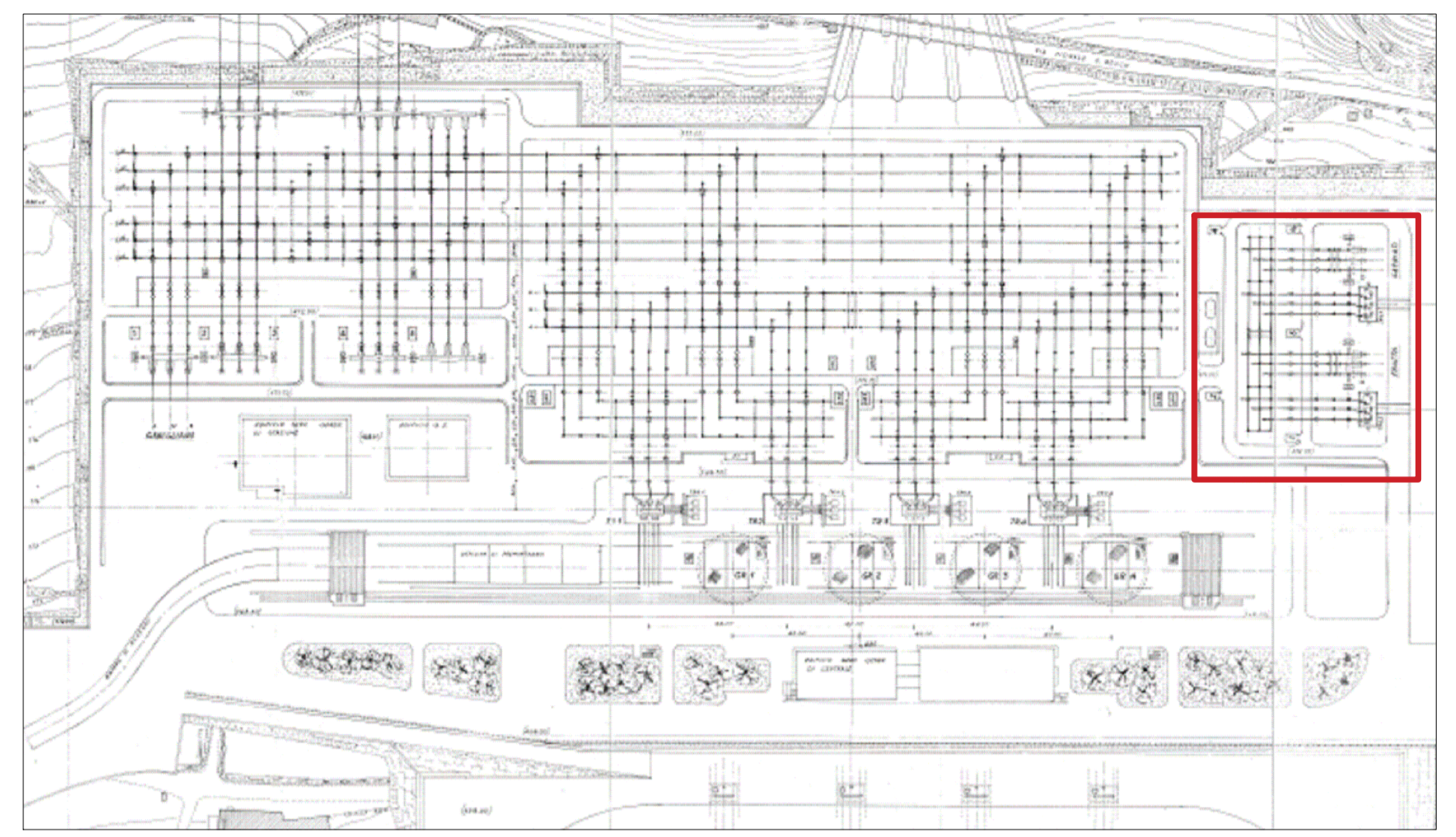

KEY PLAN

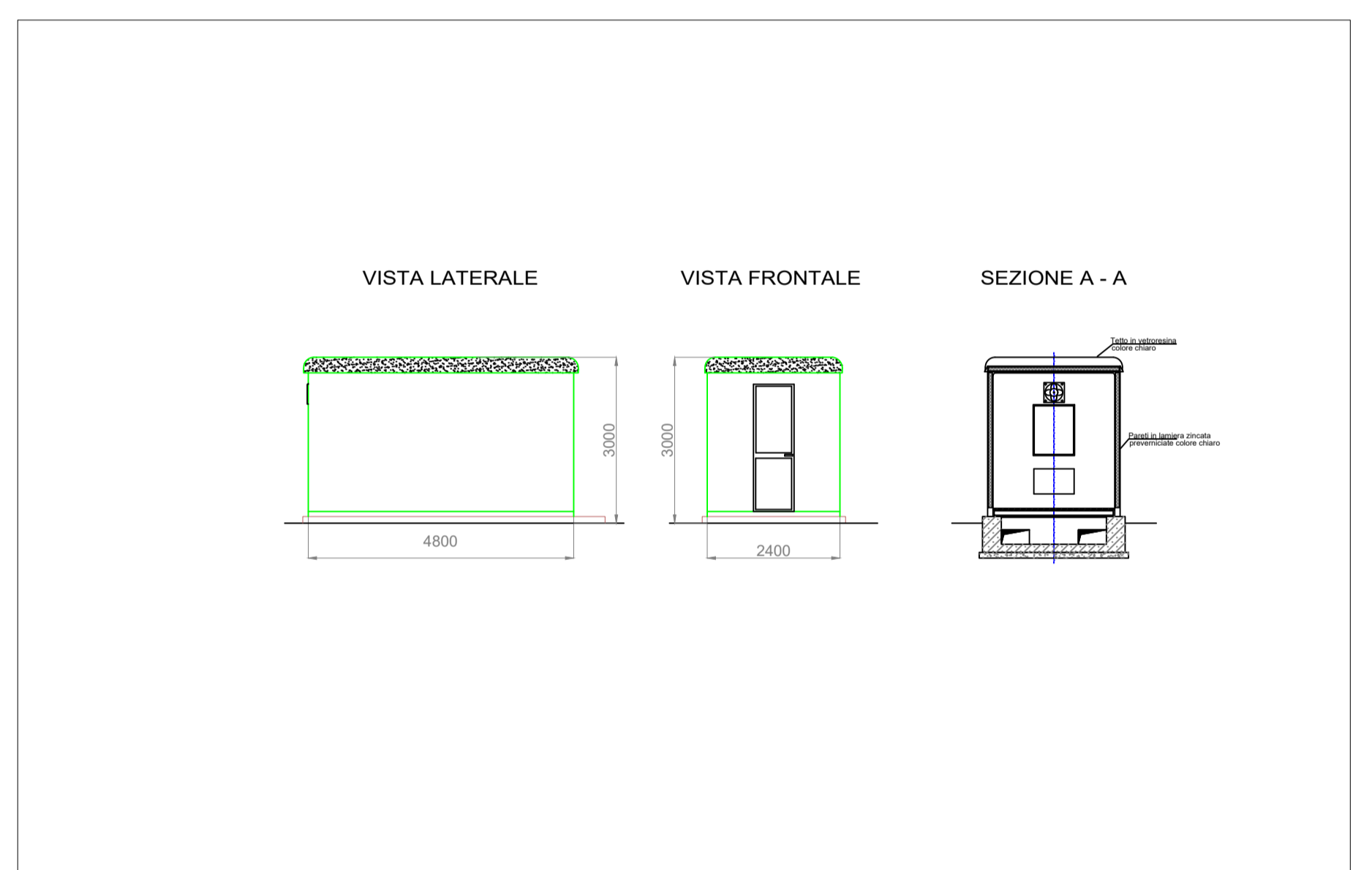

CHIOSCO - SCALA 1:100

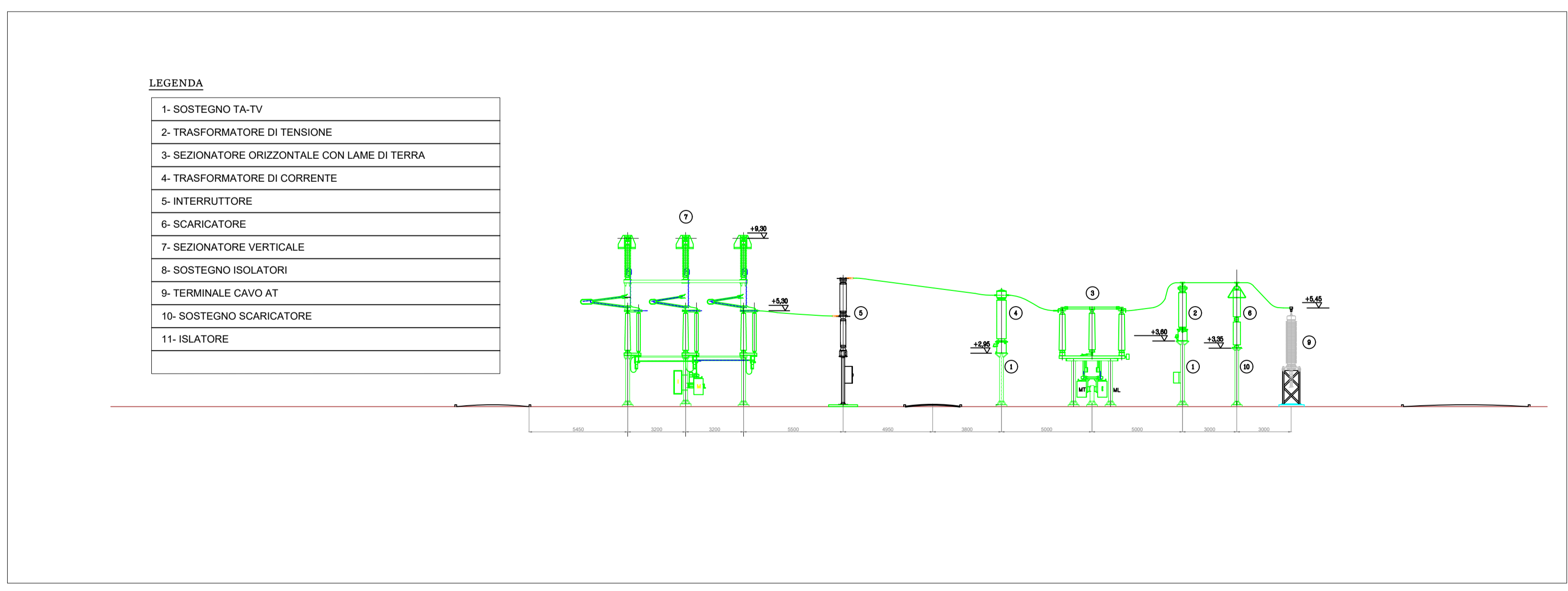

SEZIONE SCALA 1:200

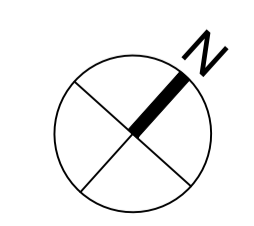

00		09/10/2023	Revisione per variazione layout d'impianto	D.STANGALINO	M.IAQUINTA	D.STANGALINO					
REV.	DATE	DESCRIPTION	PREPARED	CHECKED	APPROVED						
			IMPIANTO FOTOVOLTAICO FLOTTANTE 35,640 MW AC Comune di Presenzano (CE)								
			FILE NAME: GRE.EEC.D.27.IT.P.14456.00.056.00								
CLASSIFICATION:		FORMAT: A1	SCALE: 1:500	PLOT SCALE:	SHEET: 1 di 1						
UTILIZATION SCOPE:			TITLE:								
Engineering & Construction EGP VALIDATION			AUTORIZZAZIONE Planimetria e sezione elettromeccanica Nuovo stallo Stazione RTN 220KV esistente								
VALIDATED BY:			EGP CODE:								
VERIFIED BY:	COLLABORATORS:	GROUP: GRE	FUNCTION: EEC	TYPE: D	ISSUER: 27	COUNTRY: IT	TEC: P	PLANT: 14456	SYSTEM: 00	PROGRESSIVE: 056	REVISION: 00
This document is property of Enel Green Power SpA. It is strictly forbidden to reproduce this document, in whole or in part, and to provide to others any related information without the previous written consent by Enel Green Power SpA.											