

Provincia		BRESCIA
Comune		LOGRATO
Livellette	DISCESA L= 1461,78 m	DH= -10,99 m
Progressive livellette		p= -0,00752

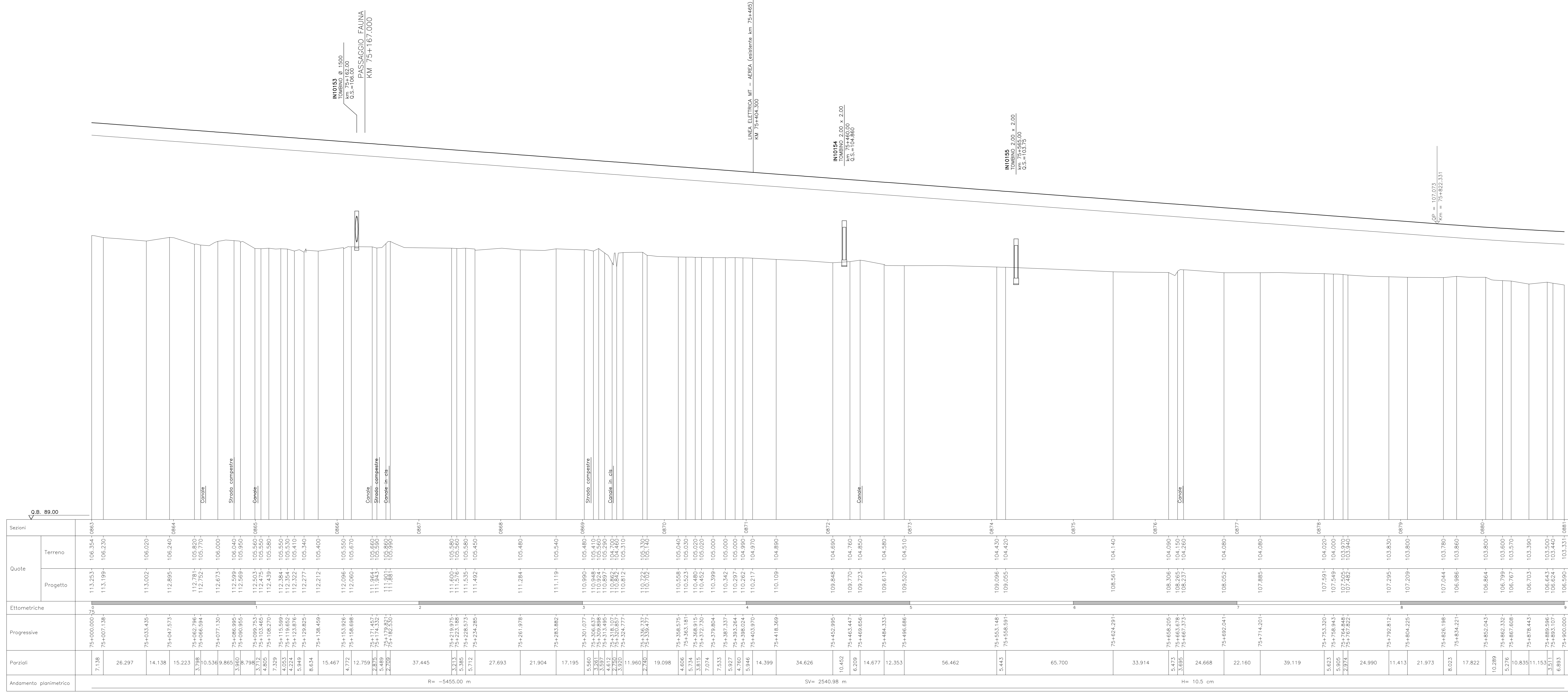

Sezioni	Quote	Elettometriche	Progressive	Particolari	Andamento planimetrico
0864	113,553 113,199	75+000,000 75+007,136	75+000,000 75+007,136	7,138 26,297	
0865	112,895 112,781 112,752	75+014,325 75+047,573 75+062,796 75+066,994	75+014,325 75+047,573 75+062,796 75+066,994	14,138 15,223 3,710	
0866	112,673 112,589 112,569	75+071,136 75+086,995 75+090,995	75+071,136 75+086,995 75+090,995	9,860 3,960 3,960	
0867	112,503 112,499 112,499	75+099,793 75+106,995 75+106,995	75+099,793 75+106,995 75+106,995	7,329 6,453 5,849	
0868	112,384 112,322 112,277	75+116,509 75+119,652 75+123,876	75+116,509 75+119,652 75+123,876	8,634 15,467	
0869	112,212 112,096 112,060	75+138,499 75+151,016 75+158,098	75+138,499 75+151,016 75+158,098	4,772 12,759	
0870	111,864 111,864 111,864	75+171,457 75+174,332 75+174,332	75+171,457 75+174,332 75+174,332	5,489 2,702	
0871	111,881 111,881 111,881	75+182,553 75+182,553 75+182,553	75+182,553 75+182,553 75+182,553	2,702	
0872	111,722 110,722 110,722	75+206,737 75+236,737 75+236,737	75+206,737 75+236,737 75+236,737	37,445 19,098	
0873	110,566 110,566 110,566	75+246,576 75+246,576 75+246,576	75+246,576 75+246,576 75+246,576	4,606	
0874	110,523 110,523 110,523	75+263,181 75+263,181 75+263,181	75+263,181 75+263,181 75+263,181	5,714 3,774	
0875	110,480 110,480 110,480	75+268,915 75+268,915 75+268,915	75+268,915 75+268,915 75+268,915	5,385 7,074	
0876	110,452 110,452 110,452	75+272,700 75+272,700 75+272,700	75+272,700 75+272,700 75+272,700	7,074 7,833	
0877	110,399 110,399 110,399	75+279,694 75+279,694 75+279,694	75+279,694 75+279,694 75+279,694	7,833 4,937	
0878	110,399 110,399 110,399	75+283,264 75+283,264 75+283,264	75+283,264 75+283,264 75+283,264	4,937 4,760	
0879	110,397 110,397 110,397	75+287,337 75+287,337 75+287,337	75+287,337 75+287,337 75+287,337	4,937 5,846	
0880	110,297 110,297 110,297	75+293,264 75+293,264 75+293,264	75+293,264 75+293,264 75+293,264	4,760 14,399	
0881	110,277 110,277 110,277	75+303,970 75+303,970 75+303,970	75+303,970 75+303,970 75+303,970	5,846 34,626	
0882	110,109 110,109 110,109	75+418,369 75+418,369 75+418,369	75+418,369 75+418,369 75+418,369	14,399 10,452	
0883	109,696 109,696 109,696	75+452,995 75+452,995 75+452,995	75+452,995 75+452,995 75+452,995	10,452 6,209	
0884	109,770 109,770 109,770	75+463,447 75+463,447 75+463,447	75+463,447 75+463,447 75+463,447	6,209 14,677	
0885	109,723 109,723 109,723	75+469,696 75+469,696 75+469,696	75+469,696 75+469,696 75+469,696	14,677 12,353	
0886	109,613 109,613 109,613	75+484,333 75+484,333 75+484,333	75+484,333 75+484,333 75+484,333	12,353 56,462	
0887	109,520 109,520 109,520	75+496,696 75+496,696 75+496,696	75+496,696 75+496,696 75+496,696	12,353 5,943	
0888	108,561 108,561 108,561	75+624,291 75+624,291 75+624,291	75+624,291 75+624,291 75+624,291	5,943 65,700	
0889	108,506 108,506 108,506	75+658,205 75+658,205 75+658,205	75+658,205 75+658,205 75+658,205	33,914 24,668	
0890	108,285 108,285 108,285	75+665,678 75+665,678 75+665,678	75+665,678 75+665,678 75+665,678	24,668 22,160	
0891	108,237 108,237 108,237	75+667,373 75+667,373 75+667,373	75+667,373 75+667,373 75+667,373	24,668 39,119	
0892	108,052 108,052 108,052	75+692,041 75+692,041 75+692,041	75+692,041 75+692,041 75+692,041	22,160 5,623	
0893	107,895 107,895 107,895	75+714,201 75+714,201 75+714,201	75+714,201 75+714,201 75+714,201	39,119 2,974	
0894	107,591 107,591 107,591	75+723,320 75+723,320 75+723,320	75+723,320 75+723,320 75+723,320	5,623 2,974	
0895	107,549 107,549 107,549	75+728,943 75+728,943 75+728,943	75+728,943 75+728,943 75+728,943	2,974 24,990	
0896	107,505 107,505 107,505	75+735,888 75+735,888 75+735,888	75+735,888 75+735,888 75+735,888	24,990 11,413	
0897	107,462 107,462 107,462	75+740,822 75+740,822 75+740,822	75+740,822 75+740,822 75+740,822	11,413 21,973	
0898	107,295 107,295 107,295	75+752,812 75+752,812 75+752,812	75+752,812 75+752,812 75+752,812	21,973 8,023	
0899	107,209 107,209 107,209	75+804,225 75+804,225 75+804,225	75+804,225 75+804,225 75+804,225	8,023 17,822	
0900	107,044 107,044 107,044	75+826,198 75+826,198 75+826,198	75+826,198 75+826,198 75+826,198	17,822 10,289	
0901	106,986 106,986 106,986	75+834,221 75+834,221 75+834,221	75+834,221 75+834,221 75+834,221	10,289 5,276	
0902	106,864 106,864 106,864	75+852,043 75+852,043 75+852,043	75+852,043 75+852,043 75+852,043	5,276 10,836	
0903	106,799 106,799 106,799	75+862,332 75+862,332 75+862,332	75+862,332 75+862,332 75+862,332	10,836 11,153	
0904	106,767 106,767 106,767	75+867,698 75+867,698 75+867,698	75+867,698 75+867,698 75+867,698	11,153 3,511	
0905	106,703 106,703 106,703	75+878,443 75+878,443 75+878,443	75+878,443 75+878,443 75+878,443	3,511 6,893	
0906	106,615 106,615 106,615	75+889,696 75+889,696 75+889,696	75+889,696 75+889,696 75+889,696	6,893 106,590	
0907	106,624 106,624 106,624	75+893,107 75+893,107 75+893,107	75+893,107 75+893,107 75+893,107	106,590 103,331	
0908	106,590 106,590 106,590	75+900,000 75+900,000 75+900,000	75+900,000 75+900,000 75+900,000	103,331 0881	

COMMITENTE:

ALTA SOVRIGLIANZA:

GENERAL CONTRACTOR:

INFRASTRUTTURE FERROVIARIE STRATEGICHE DEFINITE DALLA LEGGE OBIETTIVO N. 443/01
 LINEA A.V. /A.C. TORINO - VENEZIA Tratta MILANO - VERONA
 Lotto funzionale Brescia-Verona
 PROGETTO DEFINITIVO

PROFILO LONGITUDINALE LINEA A.C.
 DA KM 75+000.000 A KM 75+900.000
 TAVOLA N° 53

ALTA SOVRIGLIANZA:

COMMESSA	LOTTO	FASE	ENTE	TIPO DOC.	OPERAZIONE	PROGR.	REV.	SCALA
IN05	00	D	E2	F7	IF0001	053	1	1:1000/1:100

PROGETTAZIONE GENERAL CONTRACTOR

Rev.	Data	Descrizione	Redatto	Data	Verificato	Data	Approvato	Data	Aut. / Data
0	31/03/14	EMISSIONE PER CDS	M.T.	31/03/14	GHELFRI	31/03/14	LAZZARI	31/03/14	Cepav due
1	01/07/14	REVISIONE PER CDS	M.T.	01/07/14	M.T.	01/07/14	LAZZARI	01/07/14	Project director
2									
3									

Salpem S.p.a. COMM. 032121 | Data: 01/07/14 | Doc. N. IN0500DE2F7IF00010531

Progetto cofinanziato dalla Unione Europea | CLP: FER1HF100000003