

Provincia	BRESCIA		
Comune	MONTIRONE		
Livelle	SALITA L= 1060.00 m	DH= 2.13 m	p= 0.00201
Progressive livelle			DISCESA L= 325.00 m DH= -4.08 m p= -0.01255
			86+660.000

Op	119.330
Ap	-50.0456
Ry	-18000.000
f	131.07
f	-5.477

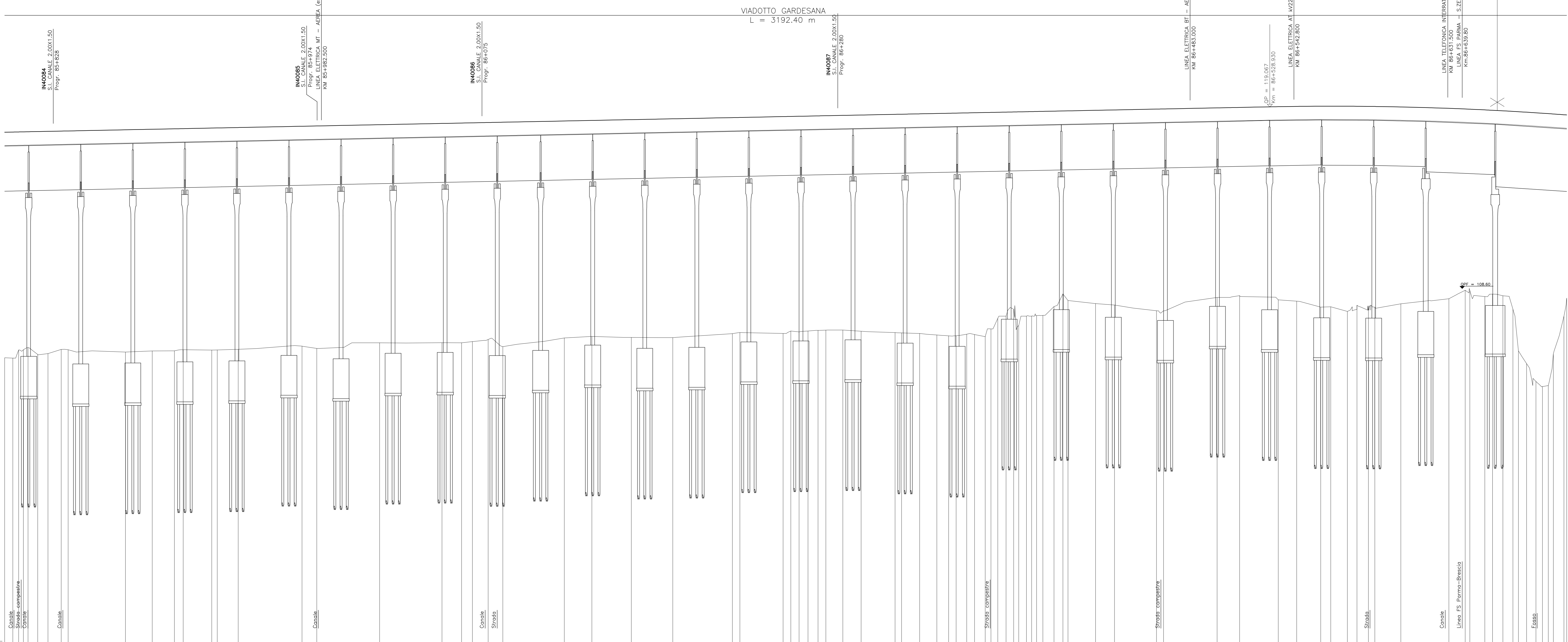

Sezioni	Quote	Progetto	Terreno
85+000.000	117.602	117.602	104.598
85+005.000	117.611	117.611	104.590
85+010.000	117.620	117.620	104.582
85+015.000	117.629	117.629	104.574
85+020.000	117.638	117.638	104.566
85+025.000	117.647	117.647	104.558
85+030.000	117.656	117.656	104.550
85+035.000	117.665	117.665	104.542
85+040.000	117.674	117.674	104.534
85+045.000	117.683	117.683	104.526
85+050.000	117.692	117.692	104.518
85+055.000	117.701	117.701	104.510
85+060.000	117.710	117.710	104.502
85+065.000	117.719	117.719	104.494
85+070.000	117.728	117.728	104.486
85+075.000	117.737	117.737	104.478
85+080.000	117.746	117.746	104.470
85+085.000	117.755	117.755	104.462
85+090.000	117.764	117.764	104.454
85+095.000	117.773	117.773	104.446
85+100.000	117.782	117.782	104.438
85+105.000	117.791	117.791	104.430
85+110.000	117.800	117.800	104.422
85+115.000	117.809	117.809	104.414
85+120.000	117.818	117.818	104.406
85+125.000	117.827	117.827	104.398
85+130.000	117.836	117.836	104.390
85+135.000	117.845	117.845	104.382
85+140.000	117.854	117.854	104.374
85+145.000	117.863	117.863	104.366
85+150.000	117.872	117.872	104.358
85+155.000	117.881	117.881	104.350
85+160.000	117.890	117.890	104.342
85+165.000	117.899	117.899	104.334
85+170.000	117.908	117.908	104.326
85+175.000	117.917	117.917	104.318
85+180.000	117.926	117.926	104.310
85+185.000	117.935	117.935	104.302
85+190.000	117.944	117.944	104.294
85+195.000	117.953	117.953	104.286
85+200.000	117.962	117.962	104.278
85+205.000	117.971	117.971	104.270
85+210.000	117.980	117.980	104.262
85+215.000	117.989	117.989	104.254
85+220.000	117.998	117.998	104.246
85+225.000	118.007	118.007	104.238
85+230.000	118.016	118.016	104.230
85+235.000	118.025	118.025	104.222
85+240.000	118.034	118.034	104.214
85+245.000	118.043	118.043	104.206
85+250.000	118.052	118.052	104.198
85+255.000	118.061	118.061	104.190
85+260.000	118.070	118.070	104.182
85+265.000	118.079	118.079	104.174
85+270.000	118.088	118.088	104.166
85+275.000	118.097	118.097	104.158
85+280.000	118.106	118.106	104.150
85+285.000	118.115	118.115	104.142
85+290.000	118.124	118.124	104.134
85+295.000	118.133	118.133	104.126
85+300.000	118.142	118.142	104.118
85+305.000	118.151	118.151	104.110
85+310.000	118.160	118.160	104.102
85+315.000	118.169	118.169	104.094
85+320.000	118.178	118.178	104.086
85+325.000	118.187	118.187	104.078
85+330.000	118.196	118.196	104.070
85+335.000	118.205	118.205	104.062
85+340.000	118.214	118.214	104.054
85+345.000	118.223	118.223	104.046
85+350.000	118.232	118.232	104.038
85+355.000	118.241	118.241	104.030
85+360.000	118.250	118.250	104.022
85+365.000	118.259	118.259	104.014
85+370.000	118.268	118.268	104.006
85+375.000	118.277	118.277	104.000
85+380.000	118.286	118.286	103.992
85+385.000	118.295	118.295	103.984
85+390.000	118.304	118.304	103.976
85+395.000	118.313	118.313	103.968
85+400.000	118.322	118.322	103.960
85+405.000	118.331	118.331	103.952
85+410.000	118.340	118.340	103.944
85+415.000	118.349	118.349	103.936
85+420.000	118.358	118.358	103.928
85+425.000	118.367	118.367	103.920
85+430.000	118.376	118.376	103.912
85+435.000	118.385	118.385	103.904
85+440.000	118.394	118.394	103.896
85+445.000	118.403	118.403	103.888
85+450.000	118.412	118.412	103.880
85+455.000	118.421	118.421	103.872
85+460.000	118.430	118.430	103.864
85+465.000	118.439	118.439	103.856
85+470.000	118.448	118.448	103.848
85+475.000	118.457	118.457	103.840
85+480.000	118.466	118.466	103.832
85+485.000	118.475	118.475	103.824
85+490.000	118.484	118.484	103.816
85+495.000	118.493	118.493	103.808
85+500.000	118.502	118.502	103.800
85+505.000	118.511	118.511	103.792
85+510.000	118.520	118.520	103.784
85+515.000	118.529	118.529	103.776
85+520.000	118.538	118.538	103.768
85+525.000	118.547	118.547	103.760
85+530.000	118.556	118.556	103.752
85+535.000	118.565	118.565	103.744
85+540.000	118.574	118.574	103.736
85+545.000	118.583	118.583	103.728
85+550.000	118.592	118.592	103.720
85+555.000	118.601	118.601	103.712
85+560.000	118.610	118.610	103.704
85+565.000	118.619	118.619	103.696
85+570.000	118.628	118.628	103.688
85+575.000	118.637	118.637	103.680
85+580.000	118.646	118.646	103.672
85+585.000	118.655	118.655	103.664
85+590.000	118.664	118.664	103.656
85+595.000	118.673	118.673	103.648
85+600.000	118.682	118.682	103.640
85+605.000	118.691	118.691	103.632
85+610.000	118.700	118.700	103.624
85+615.000	118.709	118.709	103.616
85+620.000	118.718	118.718	103.608
85+625.000	118.727	118.727	103.600
85+630.000	118.736	118.736	103.592
85+635.000	118.745	118.745	103.584
85+640.000	118.754	118.754	103.576
85+645.000	118.763	118.763	103.568
85+650.000	118.772	118.772	103.560
85+655.000	118.781	118.781	103.552
85+660.000	118.790	118.790	103.544
85+665.000	118.799	118.799	103.536
85+670.000	118.808	118.808	103.528
85+675.000	118.817	118.817	103.520
85+680.000	118.826	118.826	103.512
85+685.000	118.835	118.835	103.504
85+690.000	118.844	118.844	103.496
85+695.000	118.853	118.853	103.488
85+700.000	118.862	118.862	103.480

COMMITTENTE:

ALTA SOVRIGLIANZA:

GENERAL CONTRACTOR:

INFRASTRUTTURE FERROVIARIE STRATEGICHE DEFINITE DALLA LEGGE OBIETTIVO N. 443/01
 LINEA A.V. /A.C. TORINO - VENEZIA Tratta MILANO - VERONA
 Lotto funzionale Brescia-Verona
 PROGETTO DEFINITIVO

PROFILO LONGITUDINALE LINEA A.C.
 DA KM 85+800.000 A KM 86+700.000
 TAVOLA N° 65

ALTA SOVRIGLIANZA:

COMMESSA	LOTTO	FASE	ENTE	TIPO DOC.	OPERAZIONE	PROGR.	REV.	SCALA
IN05	00	D	E2	F7	IF0001	065	1	1:1000/1:100

PROGETTAZIONE GENERAL CONTRACTOR

Rev.	Data	Descrizione	Redatto	Data	Verificato	Data	Approvato	Data	Aut. / Data
0	31/03/14	EMMISSIONE PER CDS	M.T.	31/03/14	GHELFI	31/03/14	LAZZARI	31/03/14	Cepav due
1	01/07/14	REVISIONE PER CDS		01/07/14	TORTO	01/07/14		01/07/14	Project director
2									
3									

Saipem S.p.a. COMM. 032121 | Data: 01/07/14 | Doc. N. IN0500DE2F7IF00010651

Progetto cofinanziato dalla Unione Europea | CUP: F81H9100000008