

Provincia	BRESCIA									
Comune	CALCINATO									
Livelle	DISCESA L= 790.80 m	DH= -7.04 m	p= -0.00890	DISCESA L= 562.61 m	DH= -8.42 m	p= -0.01497	SALITA L= 1149.56 m	DH= 13.68 m	p= 0.01190	
Progressive livelle	98+550.000						99+112.614			

Sp	130.380
Op	-20.0506
Rv	-24000.000
T	22.36
I	-0.110

Sp	132.180
Op	0.02687
Rv	20000.000
T	24.66
I	1.904

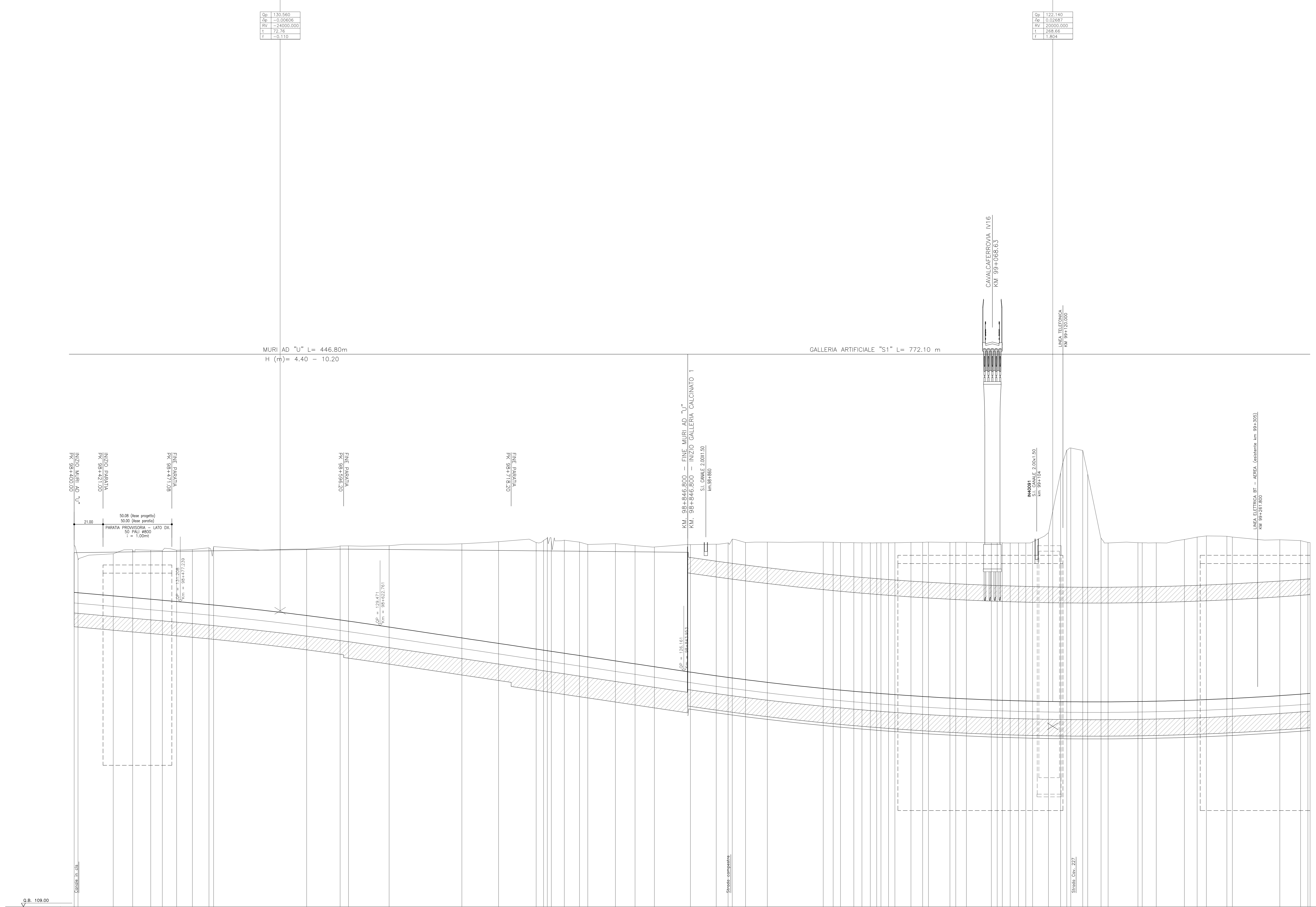

Sezioni	Quote Terreno	Quote Progetto	Elettriche	Progressive	Partici	Andamento planimetrico
1-1216	131.880	131.880	131.880	98+400.000	27.233	
134.710	131.642	131.642	131.642	98+438.436	25.663	
135.010	131.516	131.516	131.516	98+442.581	14.125	
134.940	131.399	131.399	131.399	98+456.748	8.820	
134.940	131.324	131.324	131.324	98+464.188	10.450	
134.970	131.231	131.231	131.231	98+474.618	11.446	
135.020	131.128	131.128	131.128	98+486.684	12.070	
135.150	131.013	131.013	131.013	98+498.134	3.399	
135.240	130.979	130.979	130.979	98+501.533	48.467	
135.022	130.845	130.845	130.845	98+500.000	19.248	
135.060	130.712	130.712	130.712	98+509.246	24.434	
135.280	129.889	129.889	129.889	98+503.692	6.091	
135.290	129.804	129.804	129.804	98+509.715	22.988	
135.286	129.471	129.471	129.471	98+622.761	6.268	
135.300	129.372	129.372	129.372	98+629.349	52.968	
135.440	128.980	128.980	128.980	98+682.317	26.699	
135.590	128.180	128.180	128.180	98+709.016	27.376	
135.500	127.770	127.770	127.770	98+736.392	5.834	
135.510	127.639	127.639	127.639	98+742.916	8.424	
135.520	127.539	127.539	127.539	98+749.604	5.339	
135.530	127.465	127.465	127.465	98+756.635	9.740	
135.700	127.464	127.464	127.464	98+756.801	6.019	
135.960	127.288	127.288	127.288	98+767.977	6.019	
135.990	127.258	127.258	127.258	98+773.996	20.140	
135.450	126.900	126.900	126.900	98+784.136	14.276	
135.310	126.693	126.693	126.693	98+808.412	14.099	
135.200	126.482	126.482	126.482	98+822.511	21.442	
135.410	126.161	126.161	126.161	98+843.955	4.776	
135.780	126.090	126.090	126.090	98+848.729	18.805	
135.410	125.822	125.822	125.822	98+867.534	8.658	
135.510	125.764	125.764	125.764	98+876.135	3.324	
135.780	125.684	125.684	125.684	98+879.236	14.672	
135.530	125.538	125.538	125.538	98+888.808	15.858	
135.560	125.453	125.453	125.453	98+904.786	40.707	
135.560	124.899	124.899	124.899	98+946.473	7.211	
135.560	124.829	124.829	124.829	98+952.604	5.339	
135.530	124.779	124.779	124.779	98+956.035	9.740	
135.520	124.691	124.691	124.691	98+967.772	6.019	
135.510	124.640	124.640	124.640	98+973.670	6.027	
135.510	124.589	124.589	124.589	98+979.777	4.856	
135.510	124.537	124.537	124.537	98+982.511	3.324	
135.510	124.485	124.485	124.485	98+989.038	4.656	
135.520	124.451	124.451	124.451	98+997.694	11.661	
135.540	124.369	124.369	124.369	98+1009.305	8.446	
135.550	124.314	124.314	124.314	98+1017.841	4.253	
135.550	124.259	124.259	124.259	98+1022.694	15.610	
135.540	124.200	124.200	124.200	98+1032.784	4.255	
135.550	124.178	124.178	124.178	98+1041.959	7.775	
135.550	124.140	124.140	124.140	98+1049.734	18.156	
135.510	124.065	124.065	124.065	98+1052.805	4.244	
135.510	124.037	124.037	124.037	98+1072.334	5.339	
135.510	124.034	124.034	124.034	98+1075.984	5.707	
135.500	124.016	124.016	124.016	98+1081.611	6.071	
135.500	123.988	123.988	123.988	98+1087.682	5.300	
135.500	123.972	123.972	123.972	98+1097.917	4.915	
135.250	123.949	123.949	123.949	98+1109.500	11.506	
135.250	123.923	123.923	123.923	98+1116.114	3.312	
135.250	123.897	123.897	123.897	98+1126.14	5.300	
135.250	123.871	123.871	123.871	98+1134.827	4.493	
135.250	123.845	123.845	123.845	98+1142.837	8.668	
135.250	123.819	123.819	123.819	98+1151.763	3.360	
135.250	123.793	123.793	123.793	98+1161.086	9.718	
135.250	123.767	123.767	123.767	98+1170.984	5.149	
135.250	123.741	123.741	123.741	98+1181.444	21.727	
135.250	123.715	123.715	123.715	98+1192.474	3.088	
135.250	123.689	123.689	123.689	98+1204.066	10.195	
135.250	123.663	123.663	123.663	98+1216.320	20.514	
135.250	123.637	123.637	123.637	98+1229.244	9.263	
135.250	123.611	123.611	123.611	98+1242.838	6.742	
135.250	123.585	123.585	123.585	98+1257.092	14.918	
135.250	123.559	123.559	123.559	98+1271.906	4.653	
135.250	123.533	123.533	123.533	98+1287.280	34.570	
135.250	123.507	123.507	123.507	98+1303.324	15.066	
135.250	123.481	123.481	123.481	98+1320.038	5.382	

DISEGNI DI RIFERIMENTO	
DESCRIZIONE	CODICE
NOTE GENERALI	
CARATTERISTICHE DEI MATERIALI	

COMMITENTE:

ALTA SOVRIGLIANZA:

GENERAL CONTRACTOR:

INFRASTRUTTURE FERROVIARIE STRATEGICHE DEFINITE DALLA LEGGE OBIETTIVO N. 443/01
LINEA A.V. /A.C. TORINO - VENEZIA Tratta MILANO - VERONA
 Progetto funzionale Brescia-Verona
PROGETTO DEFINITIVO

PROFILO LONGITUDINALE LINEA A.C.
 DA KM 98+400.000 A KM 99+300.000
 TAVOLA N° 79

ALTA SOVRIGLIANZA:

COMMESSA	LOTTO	FASE	ENTE	TIPO DOC.	OPERAZIONE	PROGR.	REV.	SCALA
IN05	00	D	E2	F7	IF0001	079	1	1:1000/1:100

PROGETTAZIONE GENERAL CONTRACTOR

Rev.	Data	Descrizione	Redatto	Data	Verificato	Data	Approvato	Data	Aut. / Data
0	31/03/14	EMMISSIONE PER CDS	M.T.	31/03/14	GHELFI	31/03/14	LAZZARI	31/03/14	Cepav due
1	01/07/14	REVISIONE PER CDS		01/07/14		01/07/14		01/07/14	Project director
2									
3									

Salpem S.p.a. COMM. 032121 Data: 01/07/14 Doc. N. IN0500DE2F7IF00010791

Progetto cofinanziato dalla Unione Europea CLP: FE11P100000008