

Provincia	BRESCIA		
Comune	DESENZANO DEL GARDA		
Livellette	DISCESA L= 680,00 m DH= -0,68 m p= -0,00100	DISCESA L= 1214,73 m	DH= -8,62 m p= -0,00710
Progressive livellette	111+481,236		

Q ₀	102,730
Z ₀	-0,00610
R _v	30000,000
L	91,44
f	-0,139

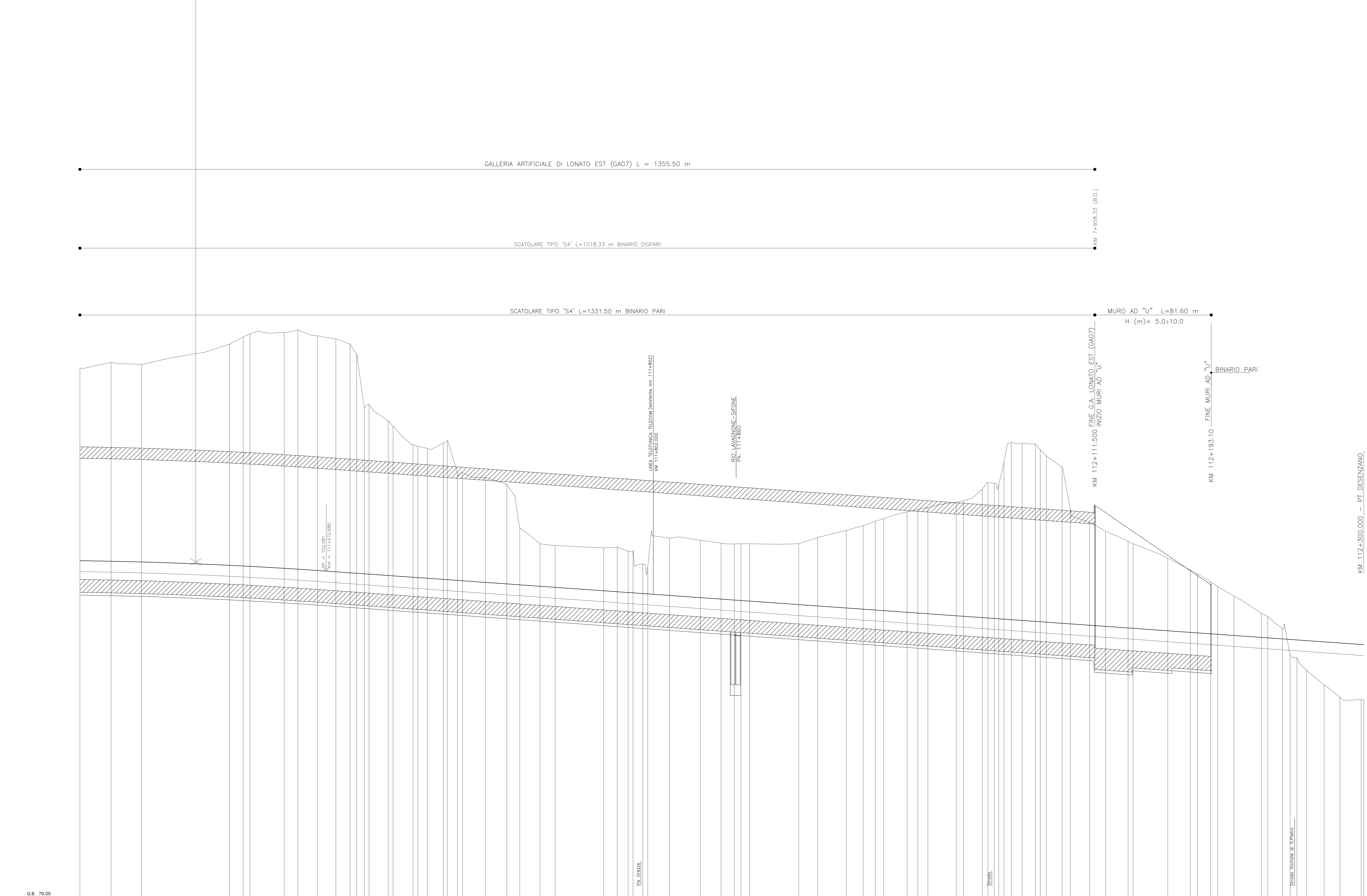

Sezioni	Quote		Ettometriche		Progressive	Pariali	Andamento planimetrico
	Terreno	Progetto					
	116,309	102,809	116,720	102,772	111+400,000	21,842	R= -18000,0 m
	116,580	102,721	116,580	102,721	111+453,336	21,284	SV= 317,27 m
	117,336	102,591	117,336	102,591	111+481,236	38,100	H= 3,5 cm
	118,000	102,485	118,000	102,485	111+504,948	23,712	RP= 110,00 m
	118,500	102,438	118,500	102,438	111+514,447	9,499	RETIFILLO
	118,720	102,413	118,720	102,413	111+519,274	23,962	L= 221,27 m
	118,990	102,316	118,990	102,316	111+520,790	9,554	R= 18000,0 m
	118,500	102,304	118,500	102,304	111+526,451	13,751	SV= 317,27 m
	118,469	102,081	118,469	102,081	111+527,680	6,139	H= 3,5 cm
	118,370	102,054	118,370	102,054	111+529,379	6,699	RP= 110,00 m
	118,000	101,962	118,000	101,962	111+530,399	4,504	
	117,280	101,930	117,280	101,930	111+533,993	5,331	
	113,370	101,888	113,370	101,888	111+532,705	3,381	
	112,610	101,773	112,610	101,773	111+543,236	13,432	
	112,240	101,748	112,240	101,748	111+545,946	3,300	
	110,840	101,649	110,840	101,649	111+548,261	3,905	
	110,650	101,629	110,650	101,629	111+549,999	3,015	
	110,690	101,628	110,690	101,628	111+550,399	6,759	
	111,200	101,549	111,200	101,549	111+552,400	11,099	
	108,930	101,479	108,930	101,479	111+554,723	7,603	
	108,897	101,450	108,897	101,450	111+557,012	3,435	
	108,650	101,389	108,650	101,389	111+559,892	14,256	
	108,170	101,183	108,170	101,183	111+564,298	14,953	
	105,090	101,118	105,090	101,118	111+569,271	9,138	
	104,000	101,018	104,000	101,018	111+570,309	14,157	
	103,680	100,942	103,680	100,942	111+572,516	10,638	
	103,710	100,701	103,710	100,701	111+573,154	34,044	
	103,720	100,633	103,720	100,633	111+575,198	9,300	
	103,639	100,610	103,639	100,610	111+576,701	11,767	
	103,410	100,555	103,410	100,555	111+578,012	4,232	
	102,580	100,506	102,580	100,506	111+580,712	3,383	
	104,440	100,000	104,440	100,000	111+582,787	6,149	
	104,390	99,974	104,390	99,974	111+584,310	6,492	
	104,250	99,731	104,250	99,731	111+586,250	34,322	
	105,270	99,494	105,270	99,494	111+588,872	13,335	
	105,760	99,250	105,760	99,250	111+591,207	20,015	
	106,420	99,011	106,420	99,011	111+593,222	11,922	
	106,510	98,871	106,510	98,871	111+595,144	8,419	
	106,510	98,871	106,510	98,871	111+597,563	5,929	
	106,510	98,871	106,510	98,871	111+600,896	16,391	
	106,510	98,871	106,510	98,871	111+604,301	7,549	
	106,510	98,871	106,510	98,871	111+607,792	7,901	
	106,510	98,871	106,510	98,871	111+611,284	6,853	
	106,510	98,871	106,510	98,871	111+615,775	13,059	
	106,510	98,871	106,510	98,871	111+620,266	5,058	
	106,510	98,871	106,510	98,871	111+624,757	13,226	
	106,510	98,871	106,510	98,871	111+629,248	4,312	
	106,510	98,871	106,510	98,871	111+633,739	3,392	
	106,510	98,871	106,510	98,871	111+638,230	5,139	
	106,510	98,871	106,510	98,871	111+642,721	8,656	
	106,510	98,871	106,510	98,871	111+647,212	9,222	
	106,510	98,871	106,510	98,871	111+651,703	4,265	
	106,510	98,871	106,510	98,871	111+656,194	10,991	
	106,510	98,871	106,510	98,871	111+660,685	8,618	
	106,510	98,871	106,510	98,871	111+665,176	13,470	
	106,510	98,871	106,510	98,871	111+669,667	3,835	
	106,510	98,871	106,510	98,871	111+674,158	7,331	
	106,510	98,871	106,510	98,871	111+678,649	15,764	
	106,510	98,871	106,510	98,871	111+683,139	24,304	
	106,510	98,871	106,510	98,871	111+687,630	15,860	
	106,510	98,871	106,510	98,871	111+692,121	5,020	
	106,510	98,871	106,510	98,871	111+696,612	12,237	
	106,510	98,871	106,510	98,871	111+701,103	4,949	
	106,510	98,871	106,510	98,871	111+705,594	11,444	
	106,510	98,871	106,510	98,871	111+710,085	19,179	
	106,510	98,871	106,510	98,871	111+714,576	4,827	
	106,510	98,871	106,510	98,871	111+719,067	10,198	
	106,510	98,871	106,510	98,871	111+723,558	5,474	
	106,510	98,871	106,510	98,871	111+728,049	16,383	
	106,510	98,871	106,510	98,871	111+732,540	12,328	
	106,510	98,871	106,510	98,871	111+737,031	97,117	
	106,510	98,871	106,510	98,871	111+741,522	97,038	
	106,510	98,871	106,510	98,871	111+746,013	93,220	
	106,510	98,871	106,510	98,871	111+750,504	93,202	
	106,510	98,871	106,510	98,871	111+755,000	93,202	
	106,510	98,871	106,510	98,871	111+759,500	93,202	

DISEGNI DI RIFERIMENTO	
DESCRIZIONE	CODICE
NOTE GENERALI	
CARATTERISTICHE DEI MATERIALI	

COMMITTENTE:																																																										
ALTA SOVRIGLIANZA:																																																										
GENERAL CONTRACTOR:																																																										
INFRASTRUTTURE FERROVIARIE STRATEGICHE DEFINITE DALLA LEGGE OBIETTIVO N. 443/01 LINEA A.V. /A.C. TORINO - VENEZIA Tratta MILANO - VERONA Lotto funzionale Brescia-Verona PROGETTO DEFINITIVO																																																										
PROFILO LONGITUDINALE LINEA A.C. DA KM 111+400,000 A KM 112+300,000 TAVOLA N° 95																																																										
ALTA SOVRIGLIANZA		<table border="1"> <tr> <th>Verificato</th> <th>Data</th> <th>Approvato</th> <th>Data</th> </tr> <tr> <td></td> <td></td> <td></td> <td></td> </tr> </table>		Verificato	Data	Approvato	Data																																																			
Verificato	Data	Approvato	Data																																																							
COMMESSA	LOTTO	FASE	ENTE	TIPO DOC.	OPERAZIONE	PROGR.	REV.	SCALA																																																		
IN05	00	D	E2	F7	IF0001	095	1	1:1000/1:100																																																		
PROGETTAZIONE GENERAL CONTRACTOR								<table border="1"> <tr> <th>Rev.</th> <th>Data</th> <th>Descrizione</th> <th>Redatto</th> <th>Data</th> <th>Verificato</th> <th>Data</th> <th>Approvato</th> <th>Data</th> <th>Aut. / Data</th> </tr> <tr> <td>0</td> <td>31/03/14</td> <td>EMMISSIONE PER CDS</td> <td>M.T.</td> <td>31/03/14</td> <td>GHELFI</td> <td>31/03/14</td> <td>LAZZARI</td> <td>31/03/14</td> <td>Cepav due Consorzio Project director New Cepav due</td> </tr> <tr> <td>1</td> <td>01/07/14</td> <td>REVISIONE PER CDS</td> <td></td> <td>01/07/14</td> <td></td> <td>01/07/14</td> <td></td> <td>01/07/14</td> <td></td> </tr> <tr> <td>2</td> <td></td> <td></td> <td></td> <td></td> <td></td> <td></td> <td></td> <td></td> <td></td> </tr> <tr> <td>3</td> <td></td> <td></td> <td></td> <td></td> <td></td> <td></td> <td></td> <td></td> <td></td> </tr> </table>	Rev.	Data	Descrizione	Redatto	Data	Verificato	Data	Approvato	Data	Aut. / Data	0	31/03/14	EMMISSIONE PER CDS	M.T.	31/03/14	GHELFI	31/03/14	LAZZARI	31/03/14	Cepav due Consorzio Project director New Cepav due	1	01/07/14	REVISIONE PER CDS		01/07/14		01/07/14		01/07/14		2										3									
Rev.	Data	Descrizione	Redatto	Data	Verificato	Data	Approvato	Data	Aut. / Data																																																	
0	31/03/14	EMMISSIONE PER CDS	M.T.	31/03/14	GHELFI	31/03/14	LAZZARI	31/03/14	Cepav due Consorzio Project director New Cepav due																																																	
1	01/07/14	REVISIONE PER CDS		01/07/14		01/07/14		01/07/14																																																		
2																																																										
3																																																										
Salpem S.p.a. COMM. 032121								Data: 01/07/14 Doc.N. IN0500DE2F7F00010951																																																		
Progetto cofinanziato dalla Unione Europea								CLP: FB1HF1000000008																																																		

Scale di piani: 1:1