

Provincia	BRESCIA					
Comune	PESCHIERA DEL GARDA					
Livelllette	SALITA L= 1374,91 m	DH= 8,07 m	p= 0,00587	SALITA L= 2220,15 m	DH= 26,19 m	p= 0,01180
Progressive livelllette	124+337,426					

Qc	80,090
Zc	0,00593
Rv	30000,000
f	85,83
T	0,132

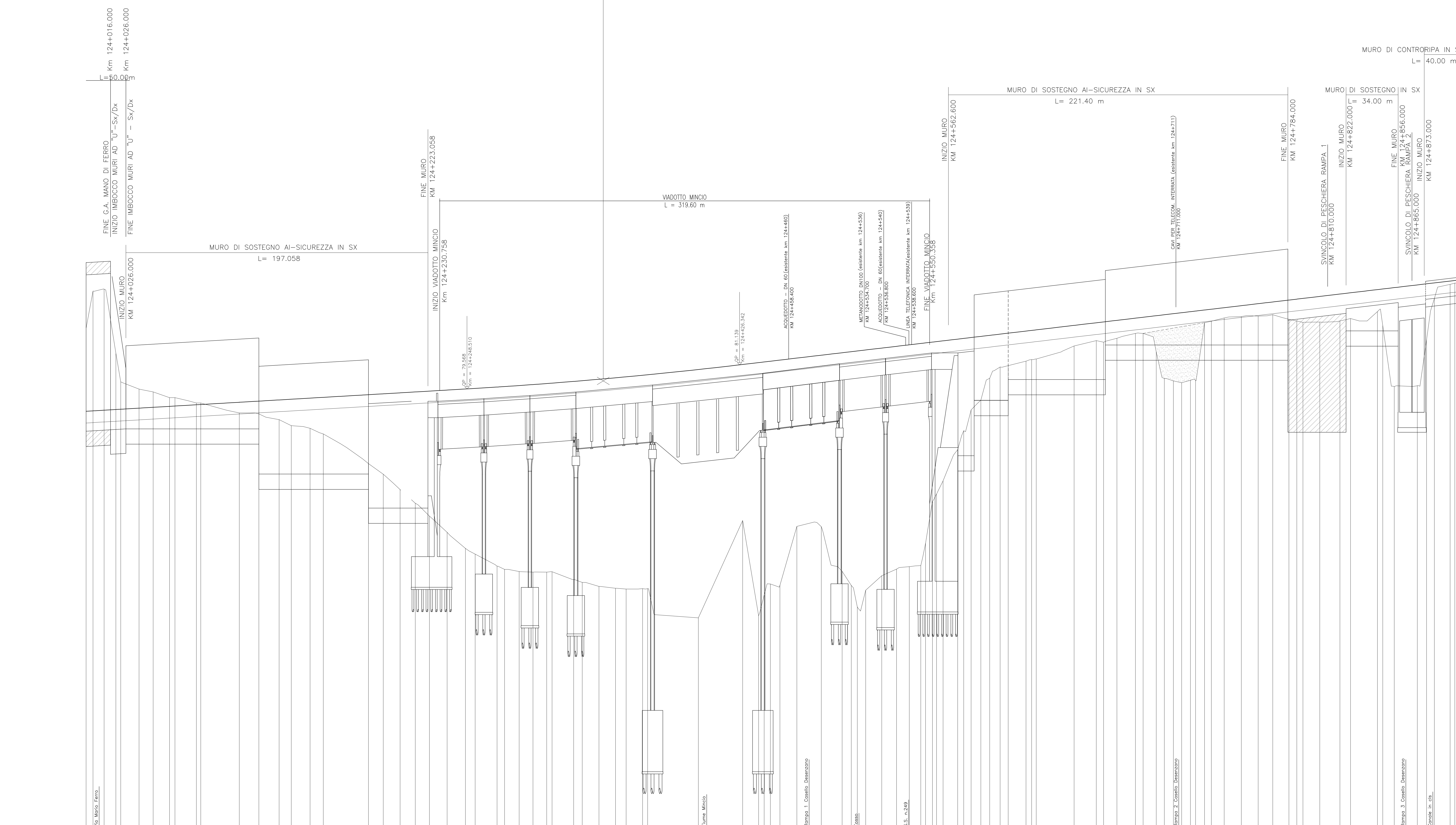

Sezioni	Quote	Terreno	Progetto	Elettometriche	Progressive	Parziali	Andamento planimetrico
1	78.110	83.525	78.110	24+000,000	4,531	29,410	
2	78.136	85.950	78.136	24+004,331	7,244	33,096	
3	78.179	86.080	78.179	24+011,785	4,085	37,181	
4	81.900	80.030	78.224	24+019,465	7,889	45,070	
5	78.243	80.030	78.243	24+022,625	3,386	48,456	
6	78.313	79.560	78.313	24+024,275	1,287	49,743	
7	78.367	79.370	78.367	24+043,811	17,454	67,197	
8	78.452	78.000	78.452	24+058,623	16,171	83,368	
9	78.555	78.650	78.555	24+074,536	15,877	99,245	
10	78.600	78.000	78.600	24+099,373	25,137	124,382	
11	77.940	77.940	77.940	24+112,752	13,190	137,572	
12	77.560	77.560	77.560	24+125,942	7,869	145,441	
13	77.170	77.170	77.170	24+133,907	7,969	153,410	
14	77.000	77.000	77.000	24+146,141	12,234	165,644	
15	77.000	77.000	77.000	24+154,809	8,668	174,312	
16	76.630	76.630	76.630	24+169,373	29,410	203,722	
17	74.690	74.690	74.690	24+184,219	9,713	213,435	
18	74.000	74.000	74.000	24+193,502	9,246	222,681	
19	73.000	73.000	73.000	24+204,896	79,312	302,000	
20	72.110	72.110	72.110	24+214,813	79,370	381,370	
21	71.270	71.270	71.270	24+223,977	79,424	460,794	
22	70.210	70.210	70.210	24+235,580	79,492	540,286	
23	68.160	68.160	68.160	24+247,479	79,562	619,848	
24	68.790	68.790	68.790	24+253,875	79,600	699,448	
25	68.000	68.000	68.000	24+268,128	14,253	713,701	
26	67.790	67.790	67.790	24+273,009	4,300	718,001	
27	67.650	67.650	67.650	24+282,267	9,558	727,559	
28	67.610	67.610	67.610	24+291,552	79,852	807,411	
29	67.610	67.610	67.610	24+300,531	79,919	887,330	
30	67.640	67.640	67.640	24+304,017	79,945	967,275	
31	67.130	67.130	67.130	24+318,113	80,057	1,047,322	
32	66.940	66.940	66.940	24+323,692	80,104	1,127,426	
33	66.680	66.680	66.680	24+334,594	80,197	1,207,623	
34	66.500	66.500	66.500	24+345,392	80,293	1,287,916	
35	66.510	66.510	66.510	24+352,342	80,357	1,368,273	
36	66.530	66.530	66.530	24+363,937	80,459	1,448,732	
37	66.530	66.530	66.530	24+366,362	80,491	1,529,223	
38	64.630	64.630	64.630	24+399,458	33,096	1,562,319	
39	70.980	70.980	70.980	24+428,332	28,874	1,591,193	
40	64.770	64.770	64.770	24+438,244	10,422	1,601,615	
41	66.840	66.840	66.840	24+446,440	3,001	1,604,616	
42	66.750	66.750	66.750	24+452,442	4,085	1,608,701	
43	70.600	70.600	70.600	24+463,717	11,075	1,619,776	
44	70.590	70.590	70.590	24+479,683	15,966	1,635,742	
45	67.660	67.660	67.660	24+493,279	13,596	1,649,338	
46	67.740	67.740	67.740	24+499,222	5,843	1,655,181	
47	65.340	65.340	65.340	24+503,161	3,528	1,658,709	
48	66.430	66.430	66.430	24+508,589	10,469	1,669,178	
49	67.380	67.380	67.380	24+519,088	9,641	1,678,819	
50	67.810	67.810	67.810	24+528,729	8,219	1,687,038	
51	67.970	67.970	67.970	24+537,048	6,219	1,693,257	
52	68.040	68.040	68.040	24+544,573	7,825	1,701,082	
53	68.690	68.690	68.690	24+547,999	4,477	1,705,559	
54	73.570	73.570	73.570	24+554,336	2,858	1,708,417	
55	67.000	67.000	67.000	24+559,124	9,550	1,717,967	
56	67.600	67.600	67.600	24+568,627	3,552	1,721,519	
57	68.200	68.200	68.200	24+572,545	4,895	1,726,414	
58	68.200	68.200	68.200	24+577,410	6,307	1,732,721	
59	68.200	68.200	68.200	24+582,275	5,788	1,738,509	
60	68.200	68.200	68.200	24+589,025	6,789	1,745,298	
61	81.000	81.000	81.000	24+601,565	5,271	1,750,569	
62	81.000	81.000	81.000	24+613,201	11,636	1,762,205	
63	81.450	81.450	81.450	24+619,872	3,015	1,765,220	
64	82.370	82.370	82.370	24+644,577	24,705	1,789,925	
65	82.720	82.720	82.720	24+659,985	14,488	1,804,413	
66	82.620	82.620	82.620	24+663,804	4,239	1,808,652	
67	82.870	82.870	82.870	24+672,516	8,712	1,817,364	
68	83.190	83.190	83.190	24+684,505	12,039	1,830,403	
69	83.190	83.190	83.190	24+689,569	5,014	1,835,417	
70	83.190	83.190	83.190	24+698,667	8,998	1,844,415	
71	83.190	83.190	83.190	24+703,400	5,253	1,849,668	
72	83.190	83.190	83.190	24+709,370	3,950	1,853,618	
73	83.190	83.190	83.190	24+714,751	3,931	1,857,549	
74	83.190	83.190	83.190	24+720,462	3,380	1,860,929	
75	83.190	83.190	83.190	24+729,274	5,882	1,866,811	
76	83.190	83.190	83.190	24+734,107	4,433	1,871,244	
77	84.200	84.200	84.200	24+742,465	8,358	1,879,602	
78	84.200	84.200	84.200	24+753,667	11,202	1,890,804	
79	84.320	84.320	84.320	24+764,461	10,994	1,901,798	
80	84.410	84.410	84.410	24+774,169	8,524	1,910,322	
81	84.110	84.110	84.110	24+784,753	5,339	1,915,661	
82	84.000	84.000	84.000	24+789,892	8,429	1,924,090	
83	83.930	83.930	83.930	24+793,629	3,987	1,928,077	
84	83.930	83.930	83.930	24+804,842	10,983	1,939,060	
85	84.000	84.000	84.000	24+817,885	13,143	1,952,203	
86	84.160	84.160	84.160	24+824,912	6,827	1,959,030	
87	84.160	84.160	84.160	24+842,480	3,653	1,962,683	
88	84.160	84.160	84.160	24+845,035	7,508	1,970,191	
89	84.160	84.160	84.160	24+853,441	15,011	1,985,202	
90	84.160	84.160	84.160	24+868,456	5,540	1,990,742	
91	84.160	84.160	84.160	24+874,504	5,394	1,996,136	
92	84.160	84.160	84.160	24+879,598	6,486	2,002,622	
93	84.160	84.160	84.160	24+889,887	10,289	2,012,911	
94	84.160	84.160	84.160	24+892,951	3,054	2,015,965	
95	84.160	84.160	84.160	24+900,000	7,249	2,023,214	

DISEGNI DI RIFERIMENTO	
DESCRIZIONE	CODICE
NOTE GENERALI	
CARATTERISTICHE DEI MATERIALI	



COMMITENTE:

ALTA SOVRIGLIANZA:

GENERAL CONTRACTOR:

INFRASTRUTTURE FERROVIARIE STRATEGICHE DEFINITE DALLA LEGGE OBIETTIVO N. 443/01

LINEA A.V. /A.C. TORINO - VENEZIA Tratta MILANO - VERONA

Lotto funzionale Brescia-Verona

PROGETTO DEFINITIVO

PROFILO LONGITUDINALE LINEA A.C. DA KM 124+000,000 A KM 124+900,000

TAVOLA N° 109

ALTA SOVRIGLIANZA:

COMMESSA: **IN05** LOTTO: **00** FASE: **D** ENTE: **E2** TIPO DOC: **F7** OPERA/CD/CP/PA: **IF0001** PROGR.: **109** REV.: **1** SCALA: **1:1000/1:100**

PROGETTAZIONE GENERAL CONTRACTOR:

Rev.	Data	Descrizione	Redatto	Data	Verificato	Data	Approvato	Data	Autorizzato/Data
0	31/03/14	EMMISSIONE PER CDS	M.T.	31/03/14	GHELFI	31/03/14	LAZZARI	31/03/14	Cepav due
1	01/07/14	REVISIONE PER CDS		01/07/14		01/07/14		01/07/14	Project Director
2									
3									

Salpem S.p.a. COMM. 032121 Data: 01/07/14 Doc. N. IN05002E2F7F00011091

Progetto cofinanziato dalla Unione Europea

CLP: F81HF1000000008