

Provincia	VERONA
Comune	SOMMACAMPAGNA
Livellette	
Progressive livellette	

DISEGNI DI RIFERIMENTO	
DESCRIZIONE	CODICE
NOTE GENERALI	
CARATTERISTICHE DEI MATERIALI	

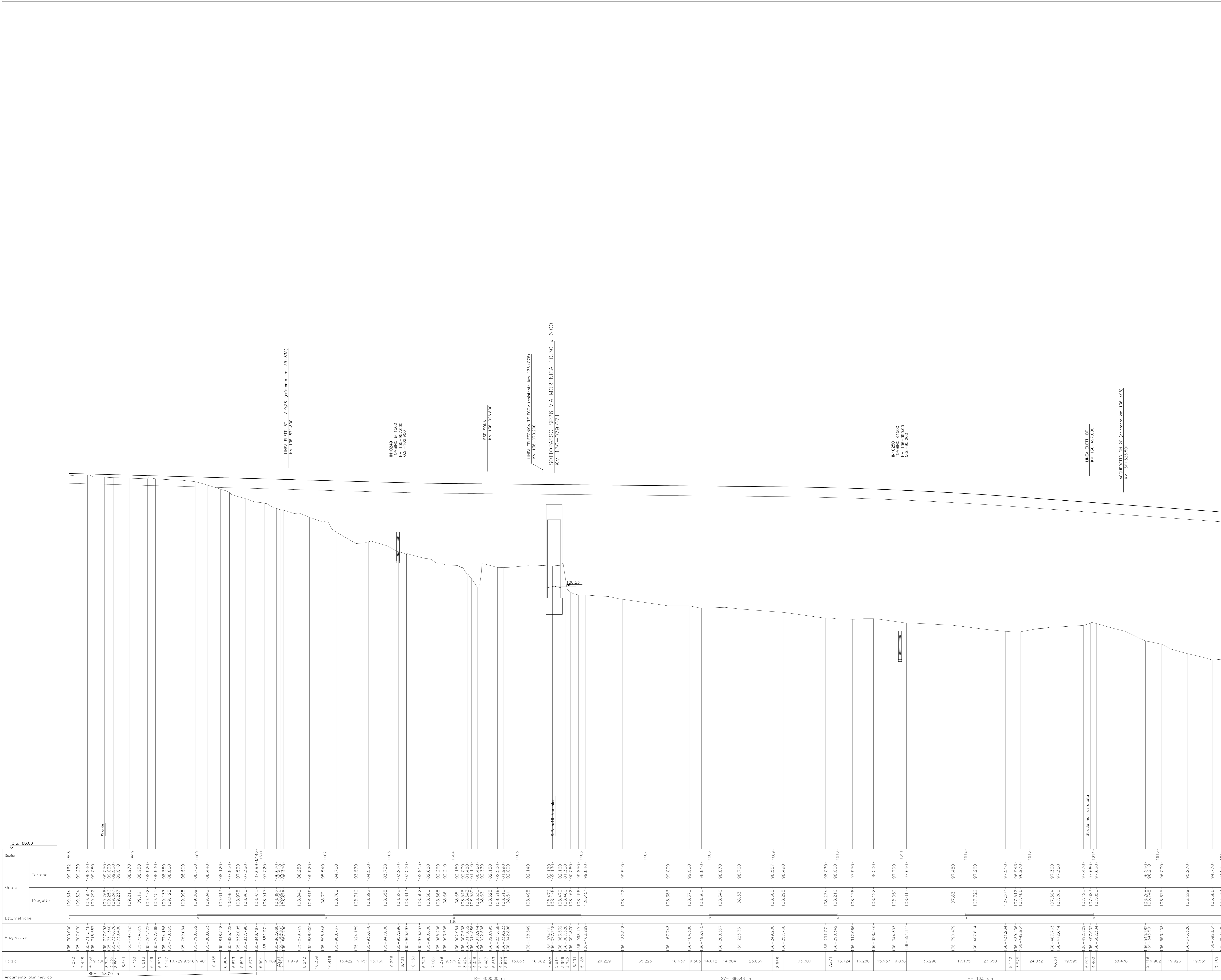

Sezioni	Quote	Elettometriche	Progressive	Parziali	Andamento planimetrico
1	109.344	109.344	35+700.000	7.070	
2	109.324	109.324	35+700.000	7.448	
3	109.304	109.304	35+700.000	4.169	
4	109.284	109.284	35+700.000	3.306	
5	109.264	109.264	35+700.000	3.071	
6	109.244	109.244	35+700.000	3.384	
7	109.224	109.224	35+700.000	3.306	
8	109.204	109.204	35+700.000	3.384	
9	109.184	109.184	35+700.000	3.306	
10	109.164	109.164	35+700.000	3.384	
11	109.144	109.144	35+700.000	3.306	
12	109.124	109.124	35+700.000	3.384	
13	109.104	109.104	35+700.000	3.306	
14	109.084	109.084	35+700.000	3.384	
15	109.064	109.064	35+700.000	3.306	
16	109.044	109.044	35+700.000	3.384	
17	109.024	109.024	35+700.000	3.306	
18	109.004	109.004	35+700.000	3.384	
19	108.984	108.984	35+700.000	3.306	
20	108.964	108.964	35+700.000	3.384	
21	108.944	108.944	35+700.000	3.306	
22	108.924	108.924	35+700.000	3.384	
23	108.904	108.904	35+700.000	3.306	
24	108.884	108.884	35+700.000	3.384	
25	108.864	108.864	35+700.000	3.306	
26	108.844	108.844	35+700.000	3.384	
27	108.824	108.824	35+700.000	3.306	
28	108.804	108.804	35+700.000	3.384	
29	108.784	108.784	35+700.000	3.306	
30	108.764	108.764	35+700.000	3.384	
31	108.744	108.744	35+700.000	3.306	
32	108.724	108.724	35+700.000	3.384	
33	108.704	108.704	35+700.000	3.306	
34	108.684	108.684	35+700.000	3.384	
35	108.664	108.664	35+700.000	3.306	
36	108.644	108.644	35+700.000	3.384	
37	108.624	108.624	35+700.000	3.306	
38	108.604	108.604	35+700.000	3.384	
39	108.584	108.584	35+700.000	3.306	
40	108.564	108.564	35+700.000	3.384	
41	108.544	108.544	35+700.000	3.306	
42	108.524	108.524	35+700.000	3.384	
43	108.504	108.504	35+700.000	3.306	
44	108.484	108.484	35+700.000	3.384	
45	108.464	108.464	35+700.000	3.306	
46	108.444	108.444	35+700.000	3.384	
47	108.424	108.424	35+700.000	3.306	
48	108.404	108.404	35+700.000	3.384	
49	108.384	108.384	35+700.000	3.306	
50	108.364	108.364	35+700.000	3.384	
51	108.344	108.344	35+700.000	3.306	
52	108.324	108.324	35+700.000	3.384	
53	108.304	108.304	35+700.000	3.306	
54	108.284	108.284	35+700.000	3.384	
55	108.264	108.264	35+700.000	3.306	
56	108.244	108.244	35+700.000	3.384	
57	108.224	108.224	35+700.000	3.306	
58	108.204	108.204	35+700.000	3.384	
59	108.184	108.184	35+700.000	3.306	
60	108.164	108.164	35+700.000	3.384	
61	108.144	108.144	35+700.000	3.306	
62	108.124	108.124	35+700.000	3.384	
63	108.104	108.104	35+700.000	3.306	
64	108.084	108.084	35+700.000	3.384	
65	108.064	108.064	35+700.000	3.306	
66	108.044	108.044	35+700.000	3.384	
67	108.024	108.024	35+700.000	3.306	
68	108.004	108.004	35+700.000	3.384	
69	107.984	107.984	35+700.000	3.306	
70	107.964	107.964	35+700.000	3.384	
71	107.944	107.944	35+700.000	3.306	
72	107.924	107.924	35+700.000	3.384	
73	107.904	107.904	35+700.000	3.306	
74	107.884	107.884	35+700.000	3.384	
75	107.864	107.864	35+700.000	3.306	
76	107.844	107.844	35+700.000	3.384	
77	107.824	107.824	35+700.000	3.306	
78	107.804	107.804	35+700.000	3.384	
79	107.784	107.784	35+700.000	3.306	
80	107.764	107.764	35+700.000	3.384	
81	107.744	107.744	35+700.000	3.306	
82	107.724	107.724	35+700.000	3.384	
83	107.704	107.704	35+700.000	3.306	
84	107.684	107.684	35+700.000	3.384	
85	107.664	107.664	35+700.000	3.306	
86	107.644	107.644	35+700.000	3.384	
87	107.624	107.624	35+700.000	3.306	
88	107.604	107.604	35+700.000	3.384	
89	107.584	107.584	35+700.000	3.306	
90	107.564	107.564	35+700.000	3.384	
91	107.544	107.544	35+700.000	3.306	
92	107.524	107.524	35+700.000	3.384	
93	107.504	107.504	35+700.000	3.306	
94	107.484	107.484	35+700.000	3.384	
95	107.464	107.464	35+700.000	3.306	
96	107.444	107.444	35+700.000	3.384	
97	107.424	107.424	35+700.000	3.306	
98	107.404	107.404	35+700.000	3.384	
99	107.384	107.384	35+700.000	3.306	
100	107.364	107.364	35+700.000	3.384	
101	107.344	107.344	35+700.000	3.306	
102	107.324	107.324	35+700.000	3.384	
103	107.304	107.304	35+700.000	3.306	
104	107.284	107.284	35+700.000	3.384	
105	107.264	107.264	35+700.000	3.306	
106	107.244	107.244	35+700.000	3.384	
107	107.224	107.224	35+700.000	3.306	
108	107.204	107.204	35+700.000	3.384	
109	107.184	107.184	35+700.000	3.306	
110	107.164	107.164	35+700.000	3.384	
111	107.144	107.144	35+700.000	3.306	
112	107.124	107.124	35+700.000	3.384	
113	107.104	107.104	35+700.000	3.306	
114	107.084	107.084	35+700.000	3.384	
115	107.064	107.064	35+700.000	3.306	
116	107.044	107.044	35+700.000	3.384	
117	107.024	107.024	35+700.000	3.306	
118	107.004	107.004	35+700.000	3.384	
119	106.984	106.984	35+700.000	3.306	
120	106.964	106.964	35+700.000	3.384	
121	106.944	106.944	35+700.000	3.306	
122	106.924	106.924	35+700.000	3.384	
123	106.904	106.904	35+700.000	3.306	
124	106.884	106.884	35+700.000	3.384	
125	106.864	106.864	35+700.000	3.306	
126	106.844	106.844	35+700.000	3.384	
127	106.824	106.824	35+700.000	3.306	
128	106.804	106.804	35+700.000	3.384	
129	106.784	106.784	35+700.000	3.306	
130	106.764	106.764	35+700.000	3.384	
131	106.744	106.744	35+700.000	3.306	
132	106.724	106.724	35+700.000	3.384	
133	106.704	106.704	35+700.000	3.306	
134	106.684	106.684	35+700.000	3.384	
135	106.664	106.664	35+700.000	3.306	
136	106.644	106.644	35+700.000	3.384	
137	106.624	106.624	35+700.000	3.306	
138	106.604	106.604	35+700.000	3.384	
139	106.584	106.584	35+700.000	3.306	
140	106.564	106.564	35+700.000	3.384	
141	106.544	106.544	35+700.000	3.306	
142	106.524	106.524	35+700.000	3.384	
143	106.504	106.504	35+700.000	3.306	
144	106.484	106.484	35+700.000	3.384	
145	106.464	106.464	35+700.000	3.306	
146	106.444	106.444	35+700.000	3.384	
147	106.424	106.424	35+700.000	3.306	
148	106.404	106.404	35+700.000	3.384	
149	106.384	106.384	35+700.000	3.306	
150	106.364	106.364	35+700.000	3.384	
151	106.344	106.344	35+700.000	3.306	
152	106.324	106.324	35+700.000	3.384	
153	106.304	106.304	35+700.000	3.306	
154	106.284	106.284	35+700.000	3.384	
155	106.264	106.264	35+700.000	3.306	
156	106.244	106.244	35+700.000	3.384	
157	106.224	106.224	35+700.000	3.306	
158	106.204	106.204	35+700.000	3.384	
159	106.184	106.184	35+700.000	3.306	
160	106.164	106.164	35+700.000	3.384	
161	106.144	106.144	35+700.000	3.306	
162	106.124	106.124	35+700.000	3.384	