

DESEIINI DI RIFERIMENTO

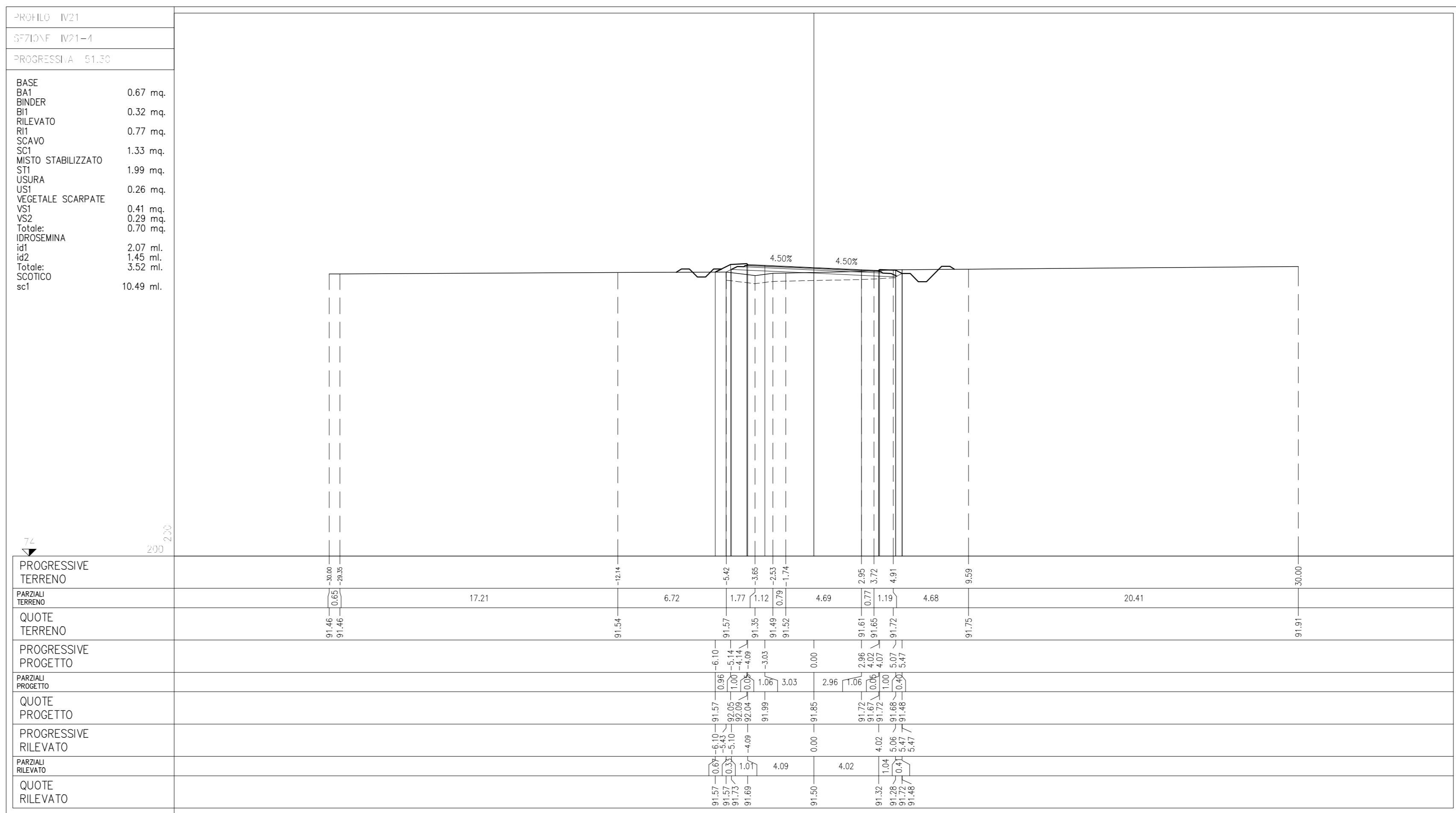
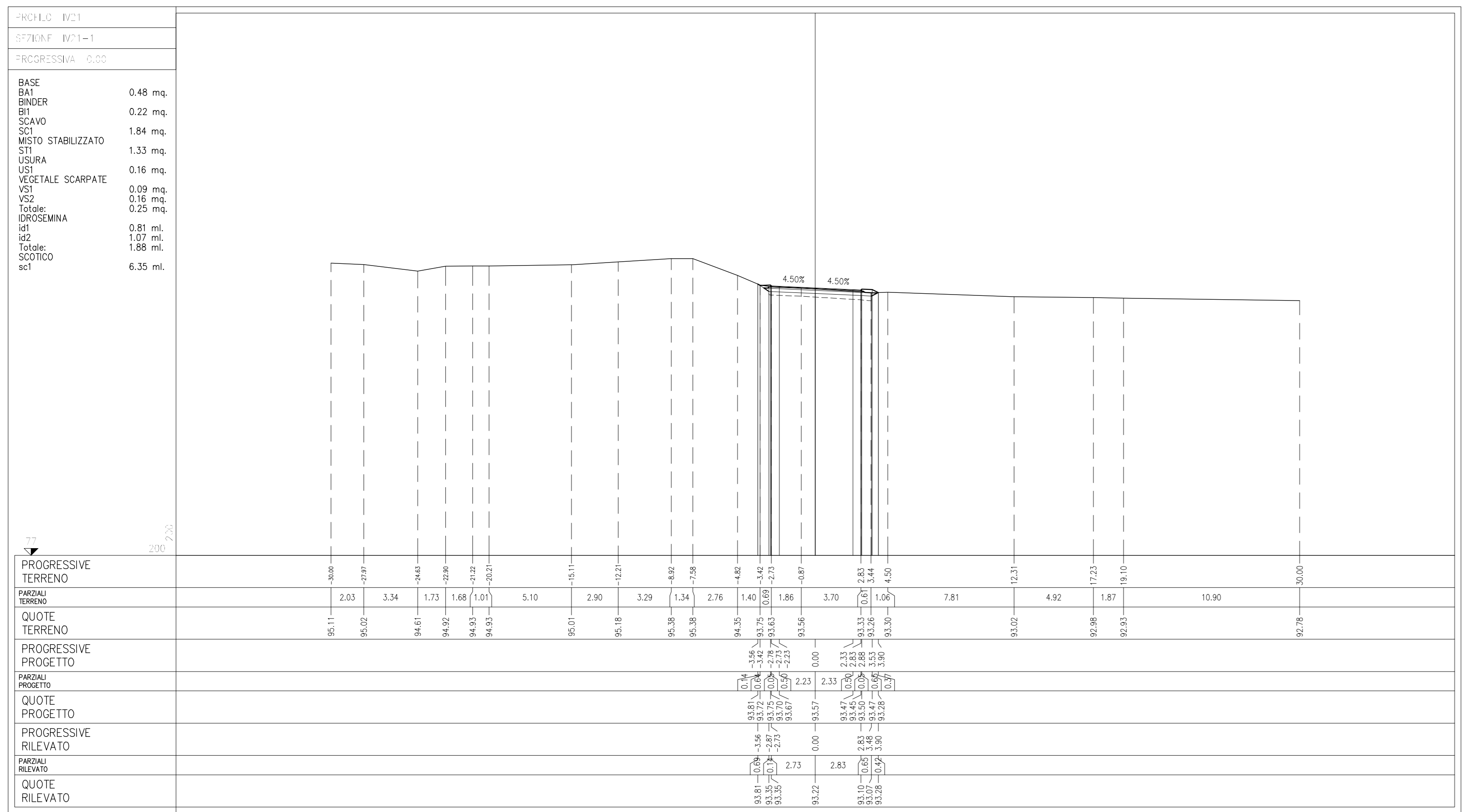
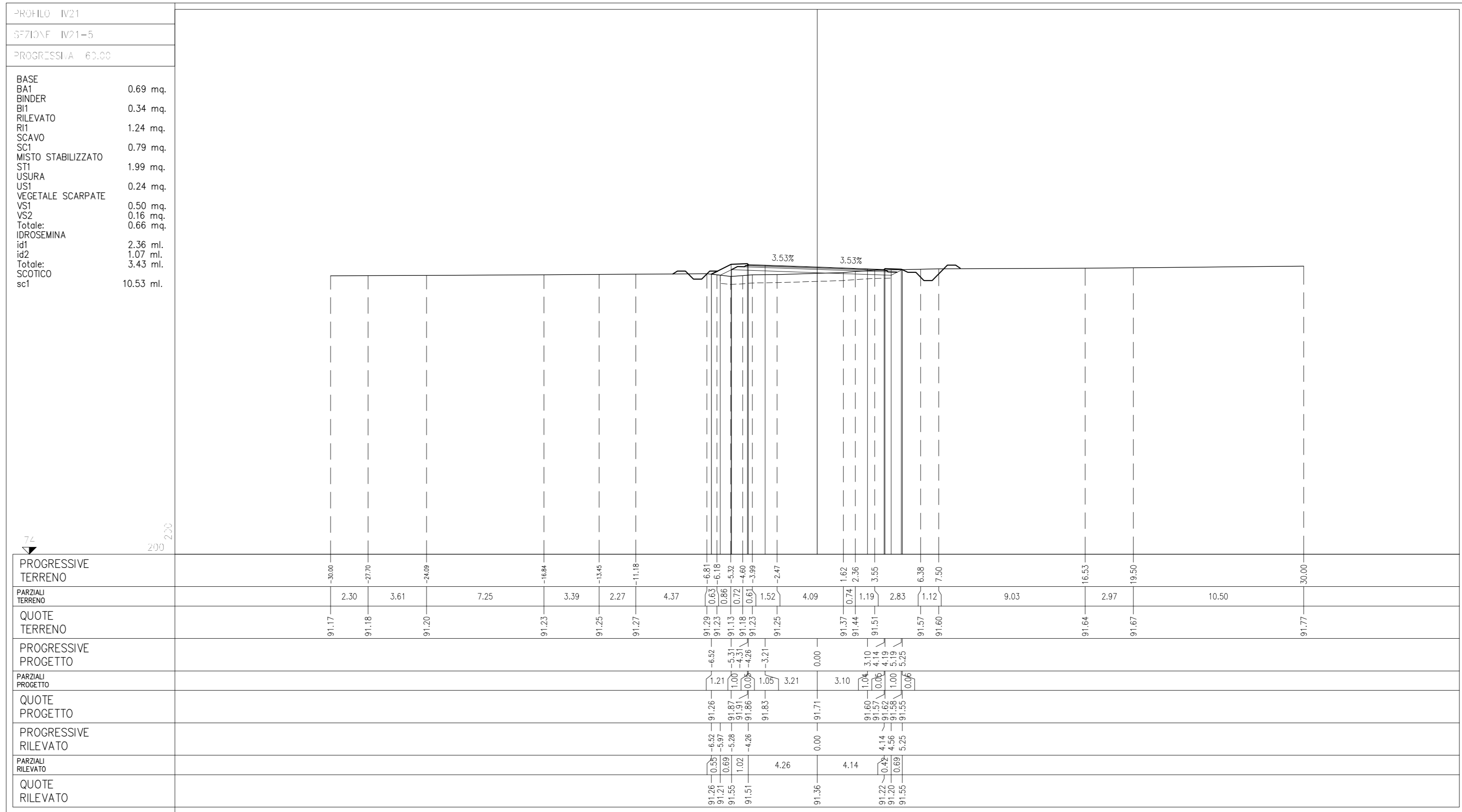
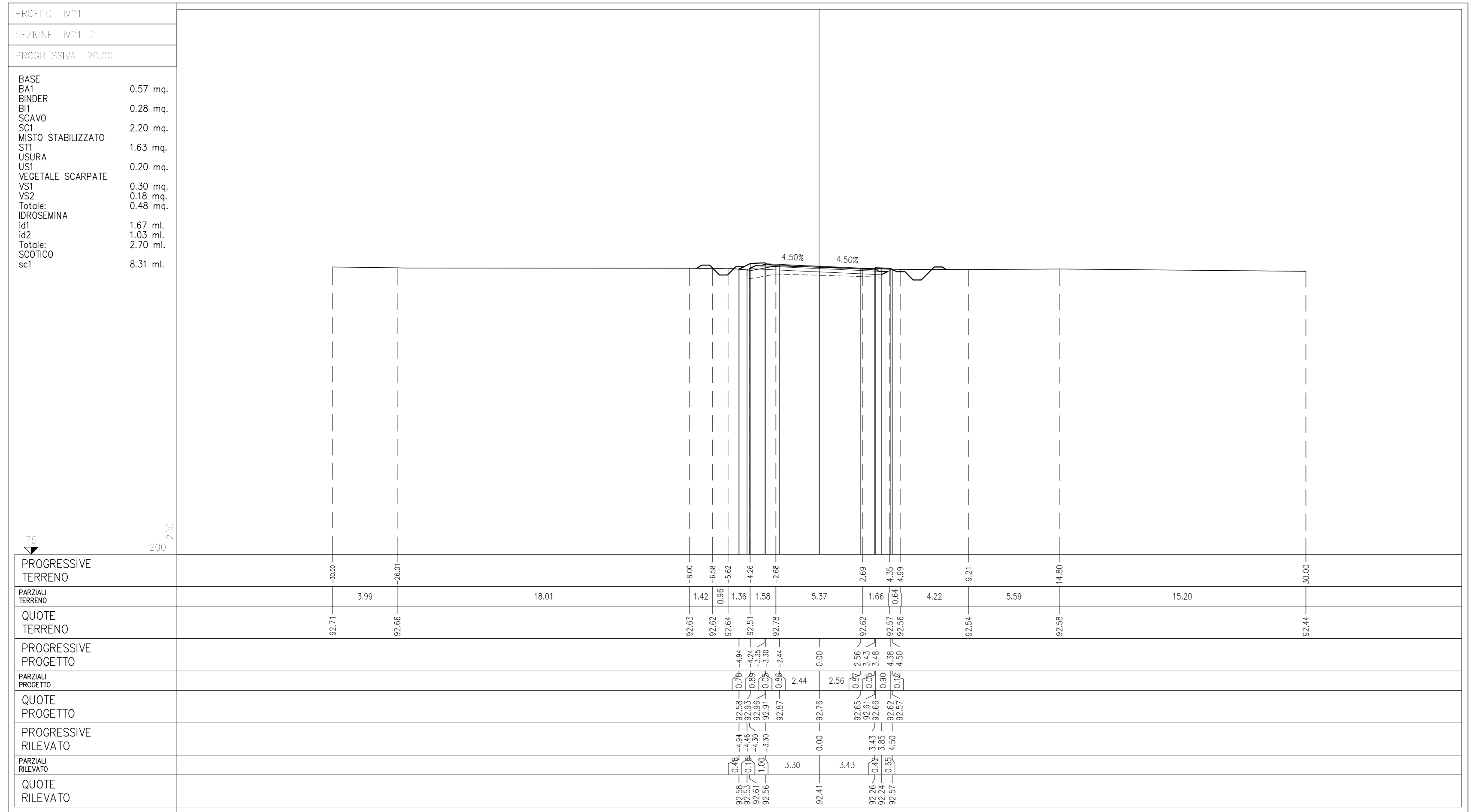

Table with 3 columns: DESCRIZIONE (Detailed description of materials and construction phases), CODICE (Reference codes for materials and phases).



NOTE GENERALI

CARATTERISTICHE DEI MATERIALI

LEGENDA

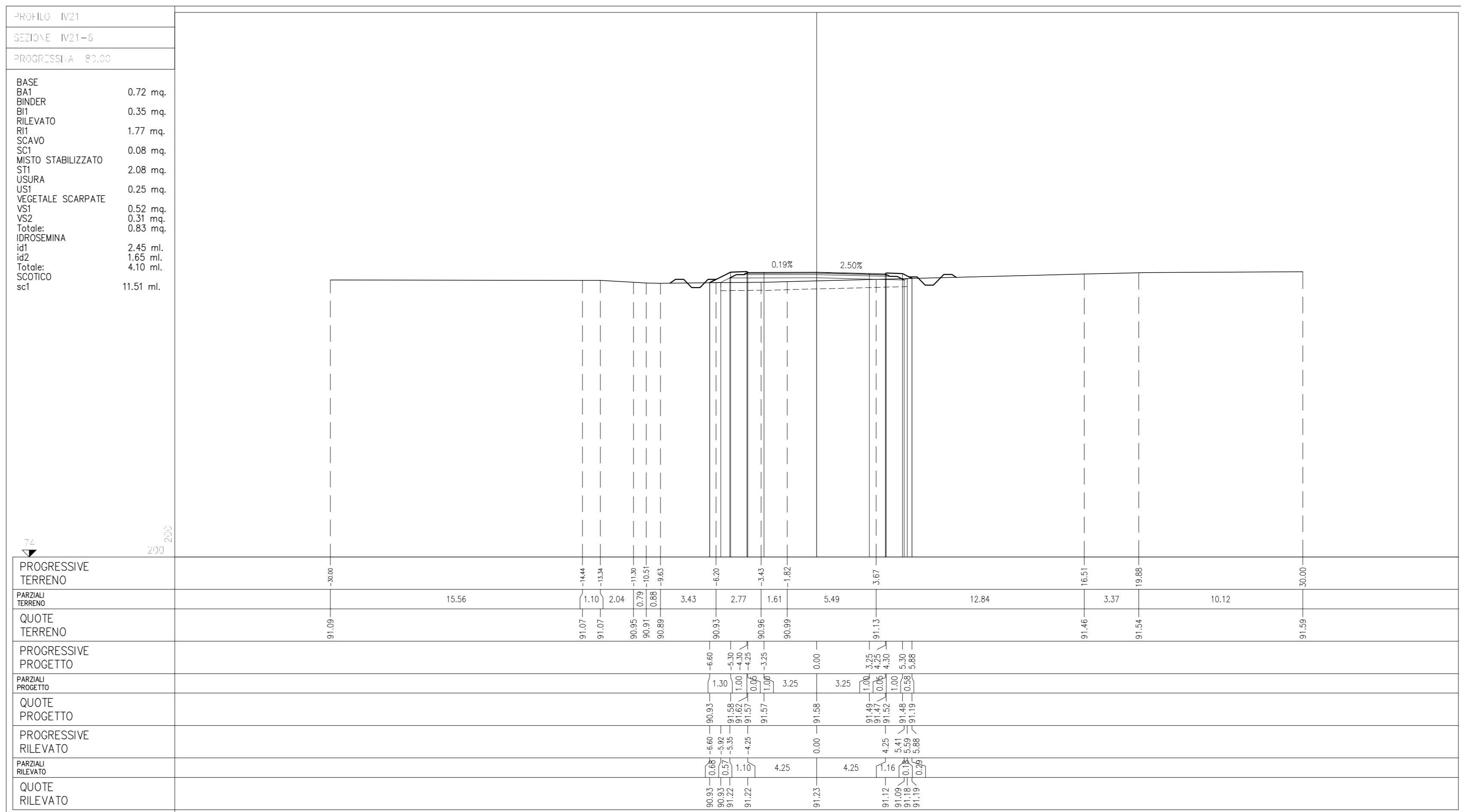
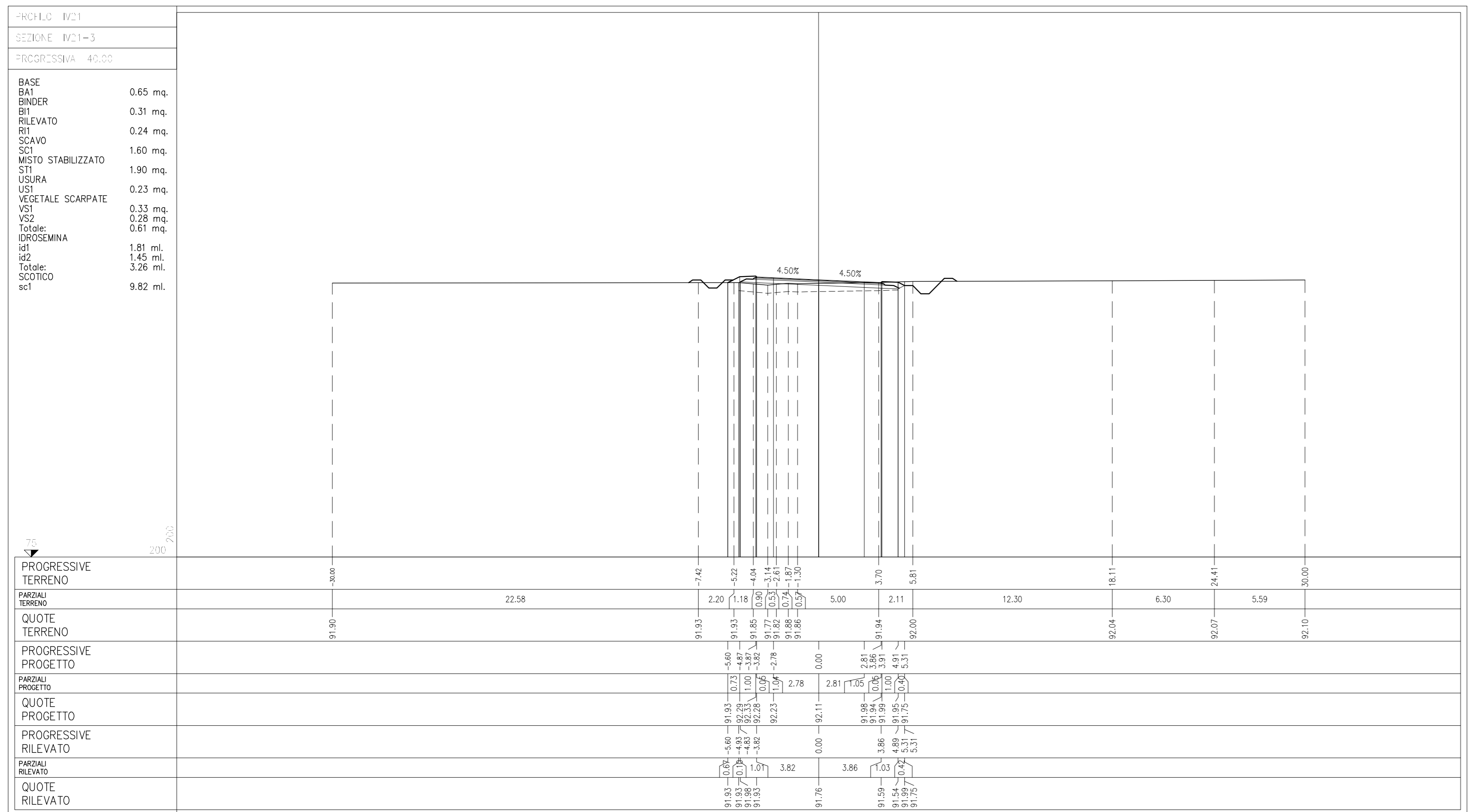

Administrative section containing: COMMITTENTE (RFI), ALTA SORVEGLIANZA (Cepav due), GENERAL CONTRACTOR (Cepav due), INFRASTRUTTURE FERROVIARIE STRATEGICHE DEFINITE DALLA LEGGE OBIETTIVO N. 443/01, LINEA A.V. /A.C. TORINO - VENEZIA, Lotto funzionale Brescia-Verona, PROGETTO DEFINITIVO, OPERE DI ATTRAVERSAMENTO STRADALE, CAVALCAFERROVIA VIA MONTANALE BASSO - Km 113+452.619, ASSE PRINCIPALE. SEZIONI TRASVERSALI (TAV 1/4), and a table for project approvals and dates.