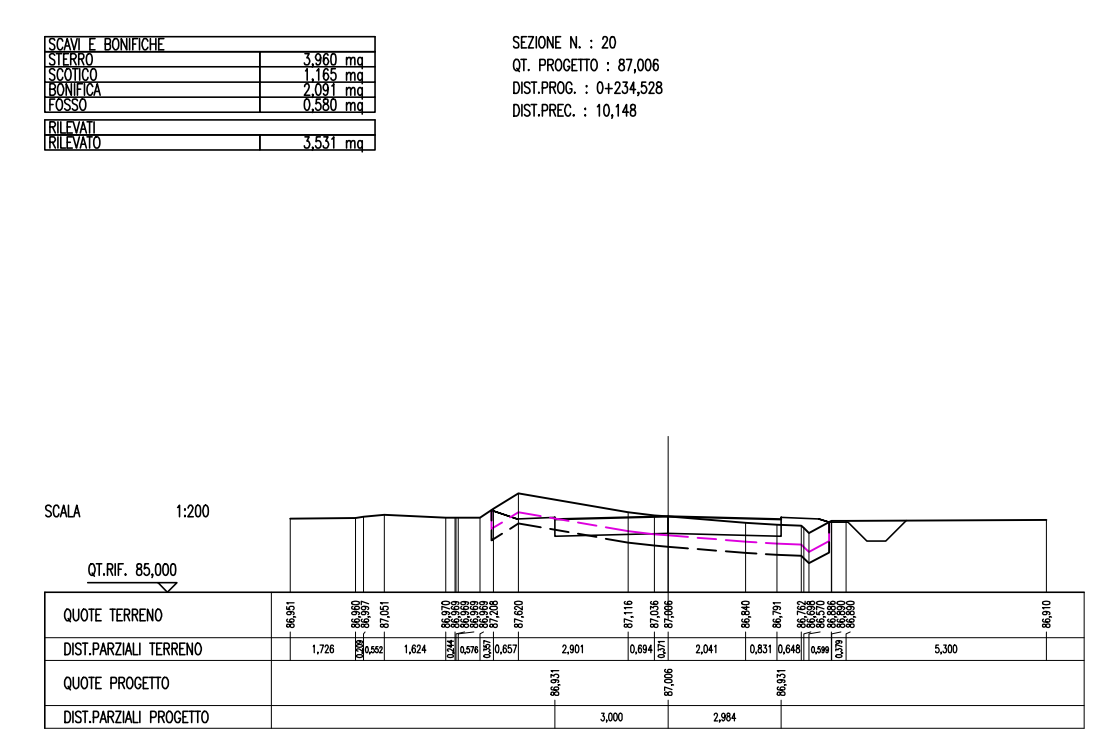
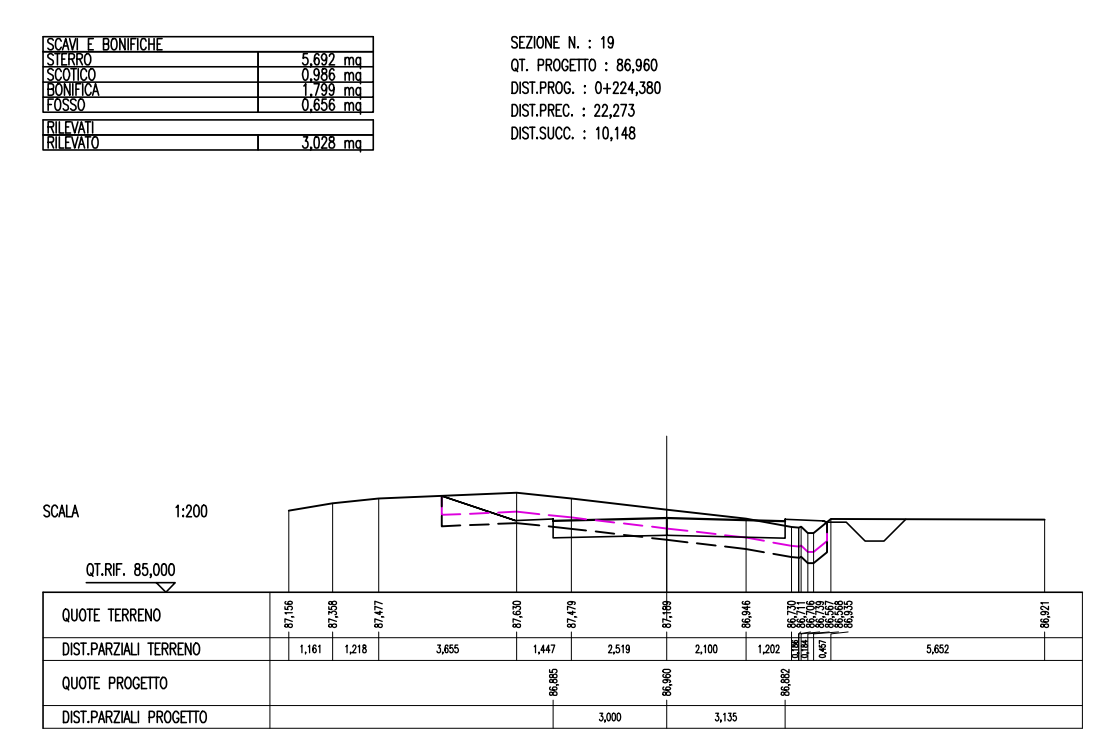
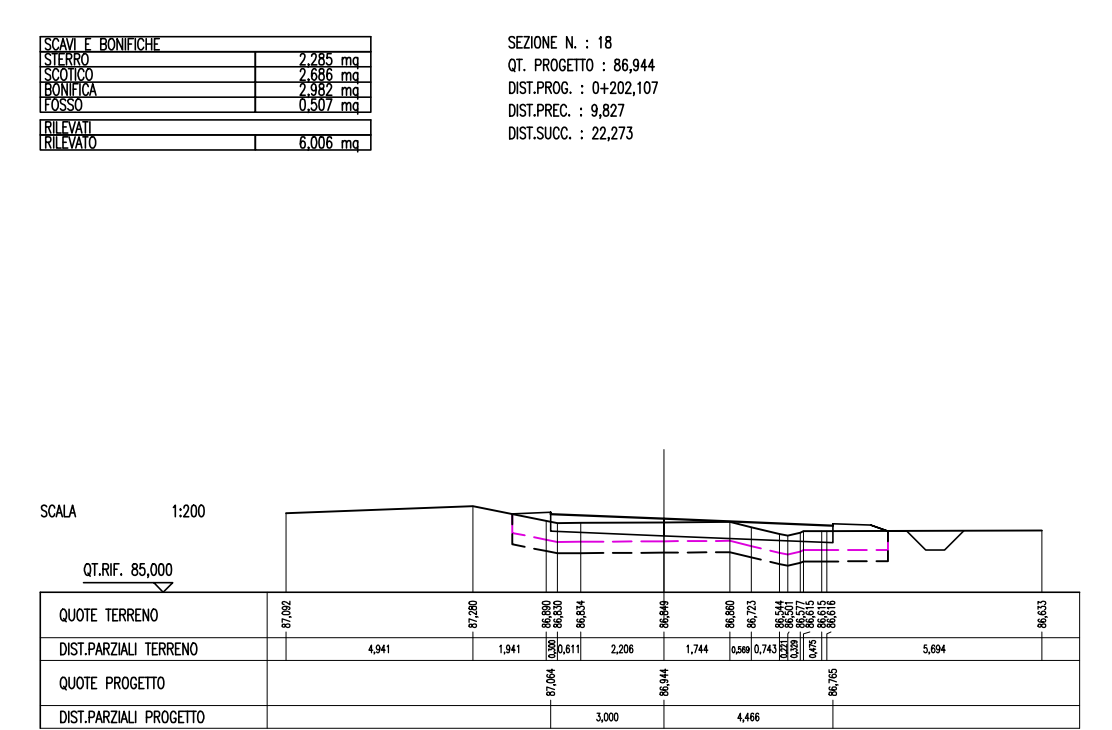
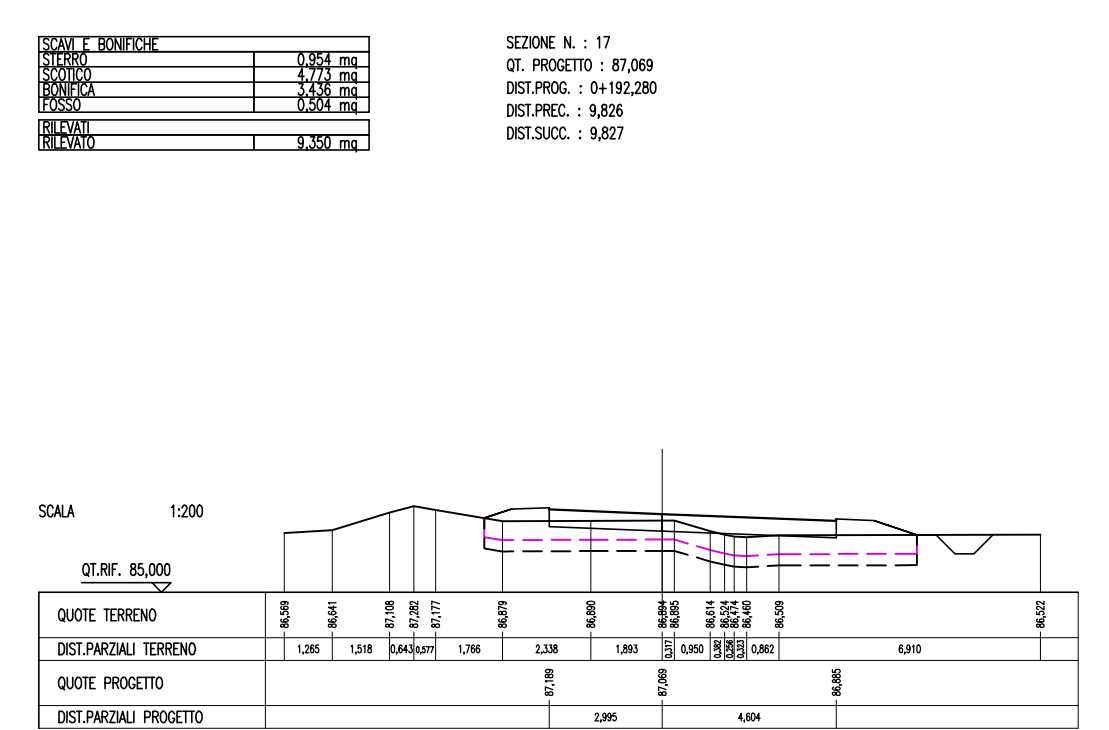
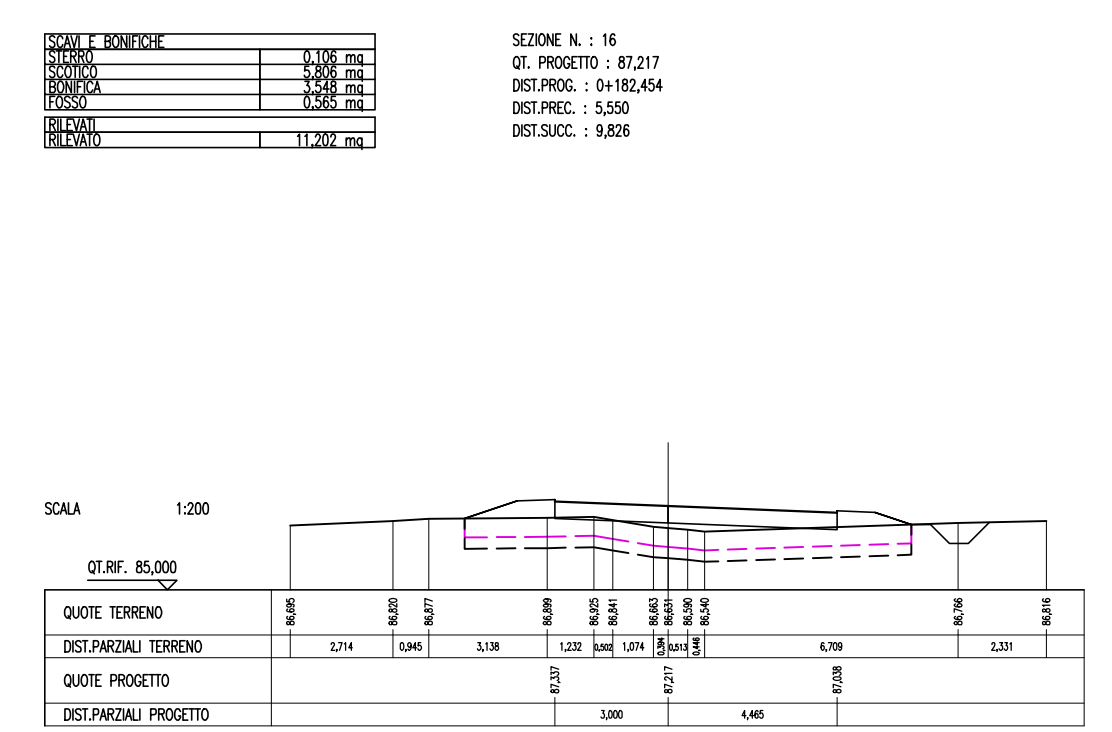
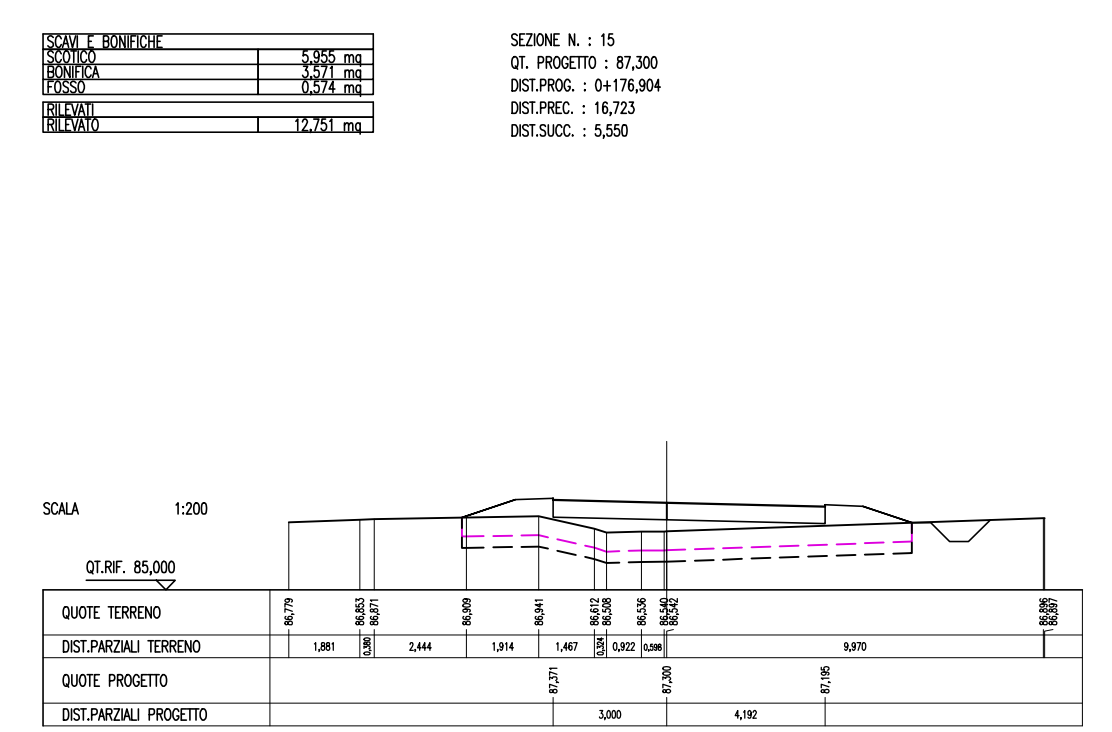
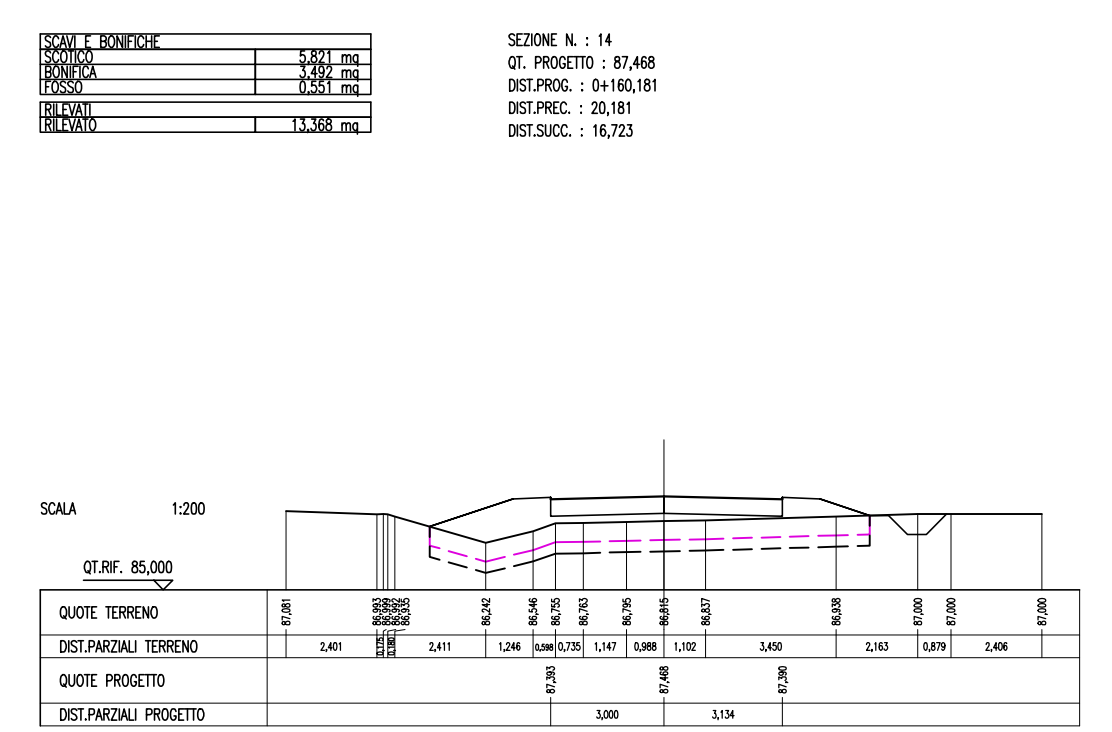
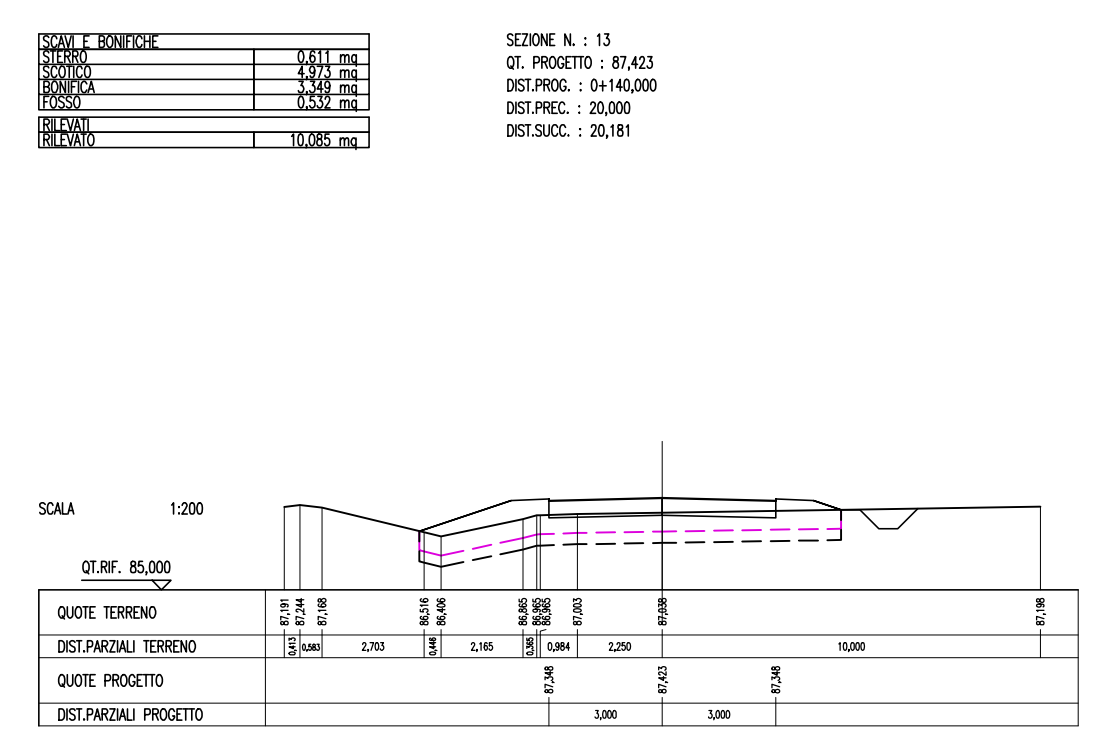
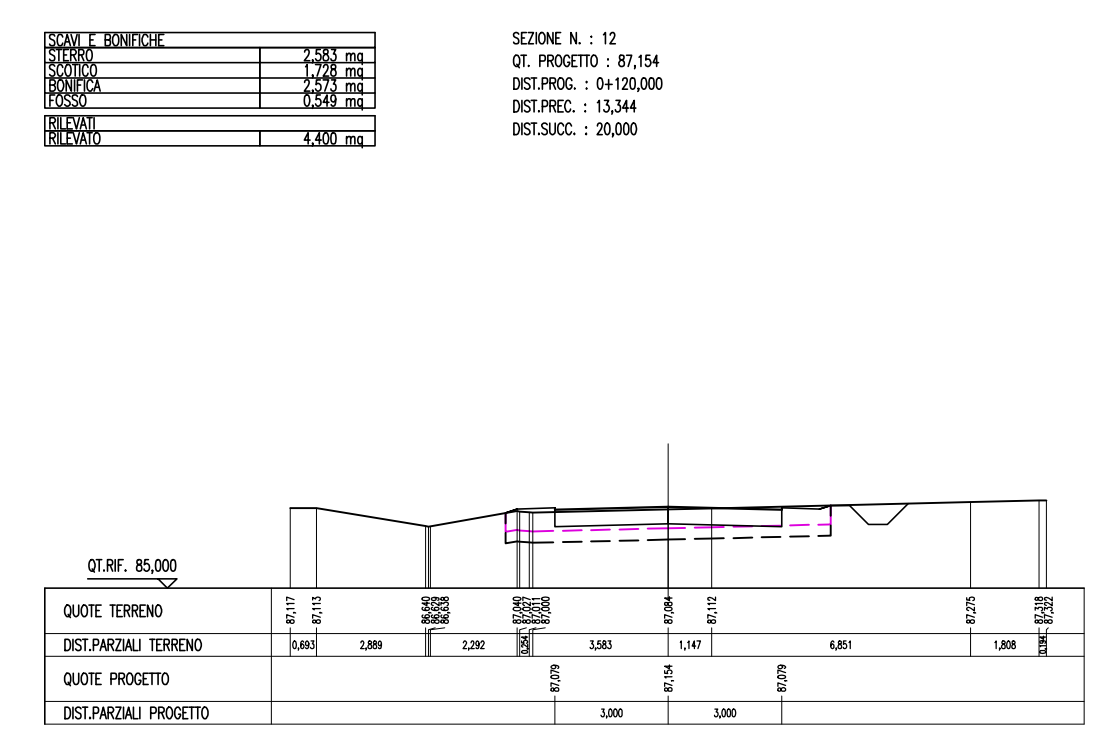
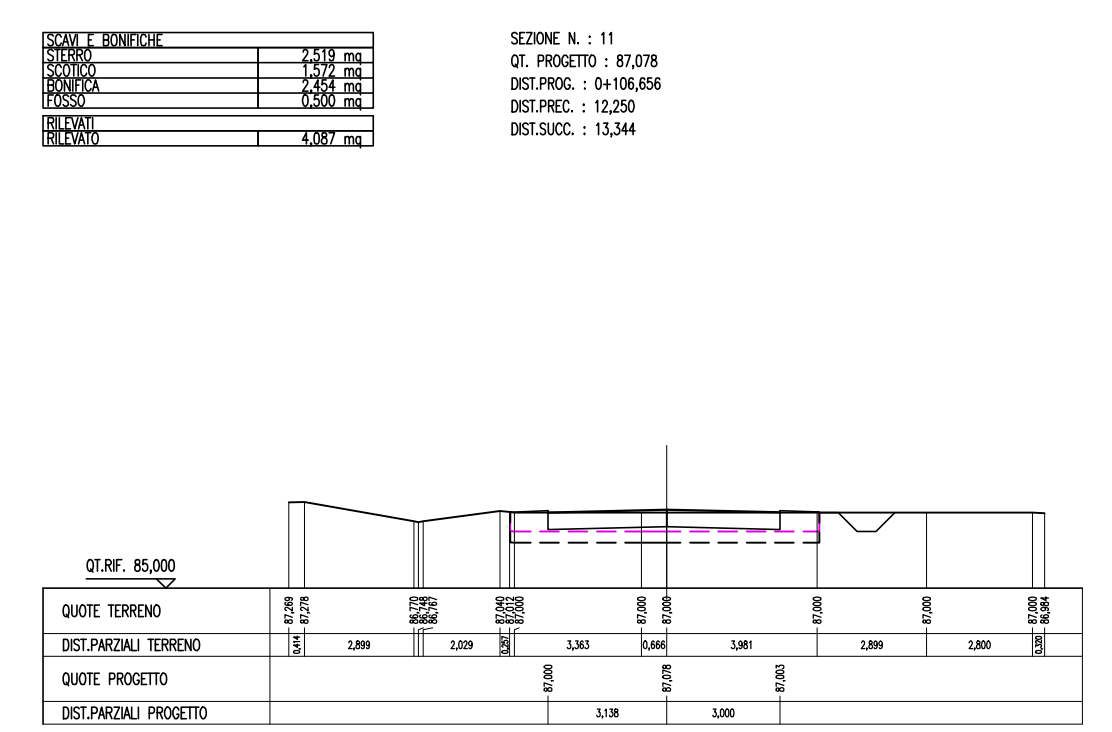
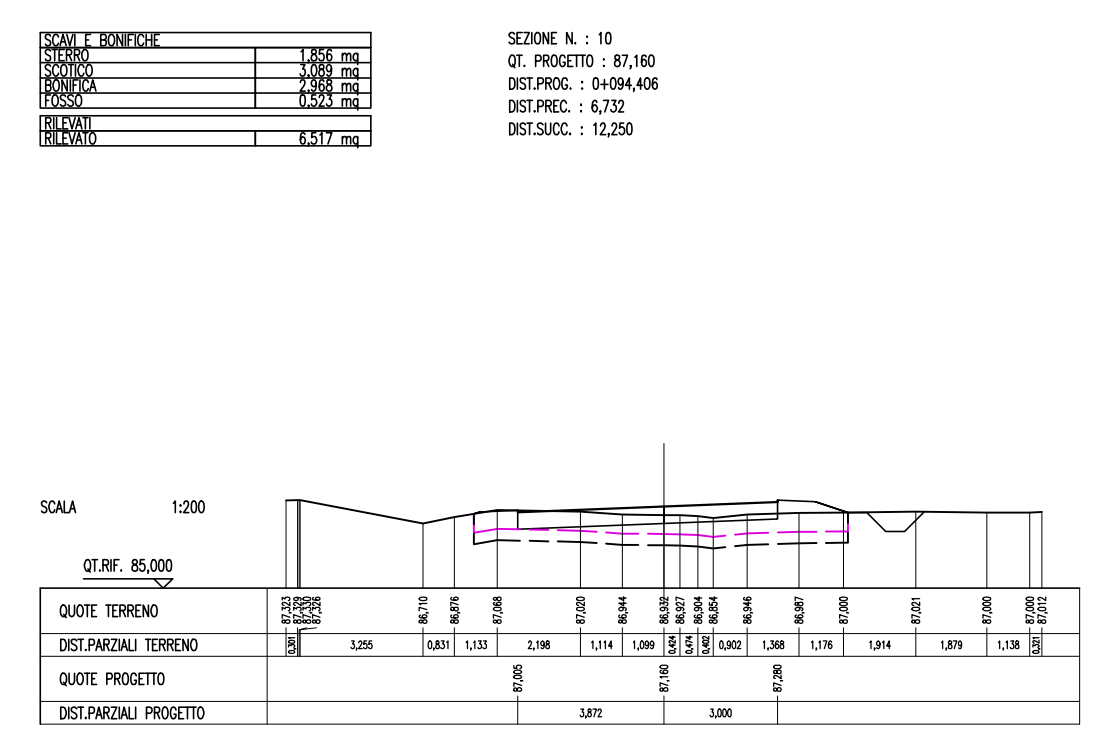
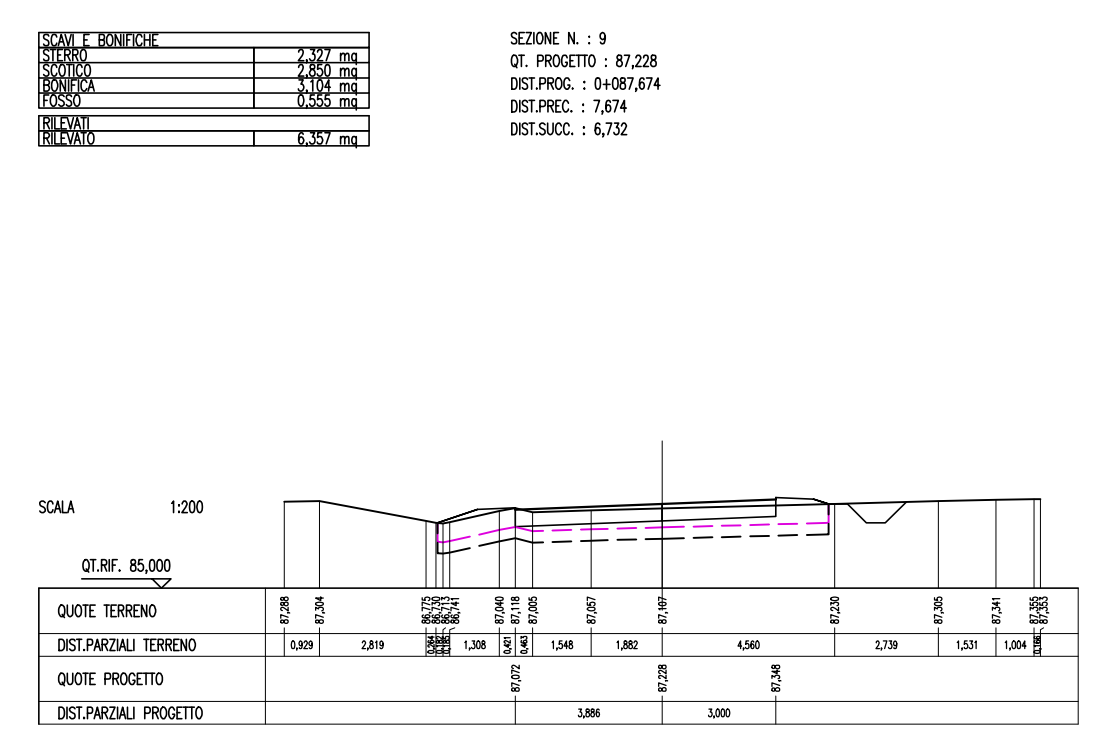
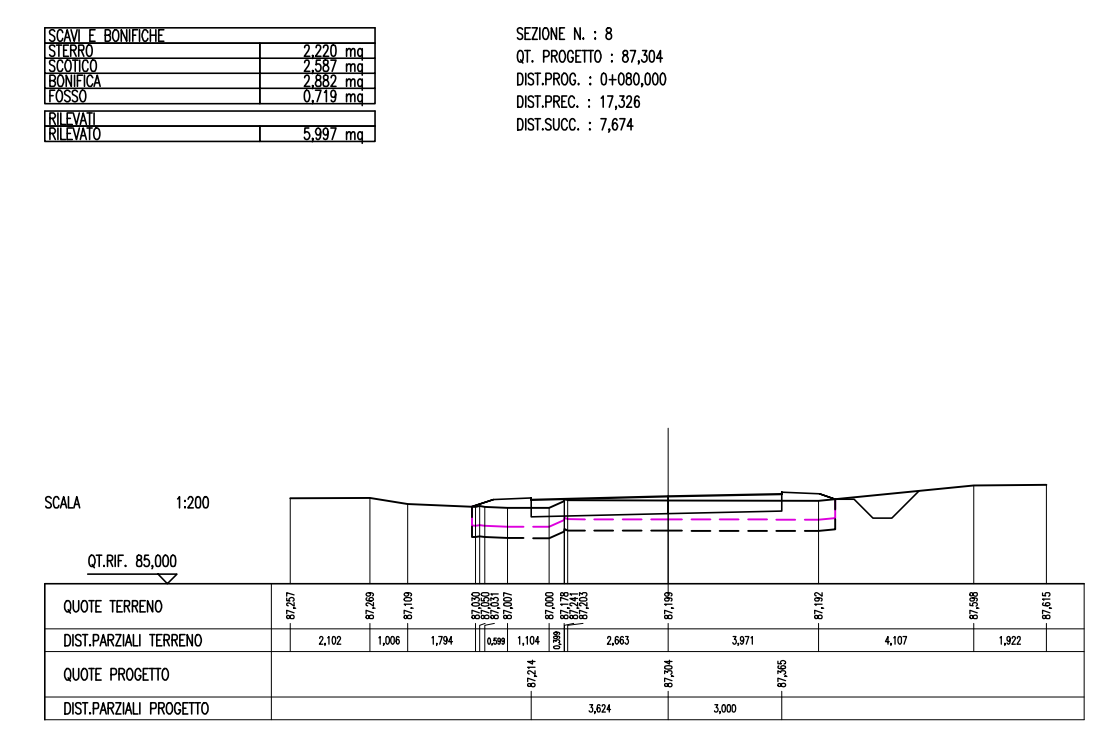
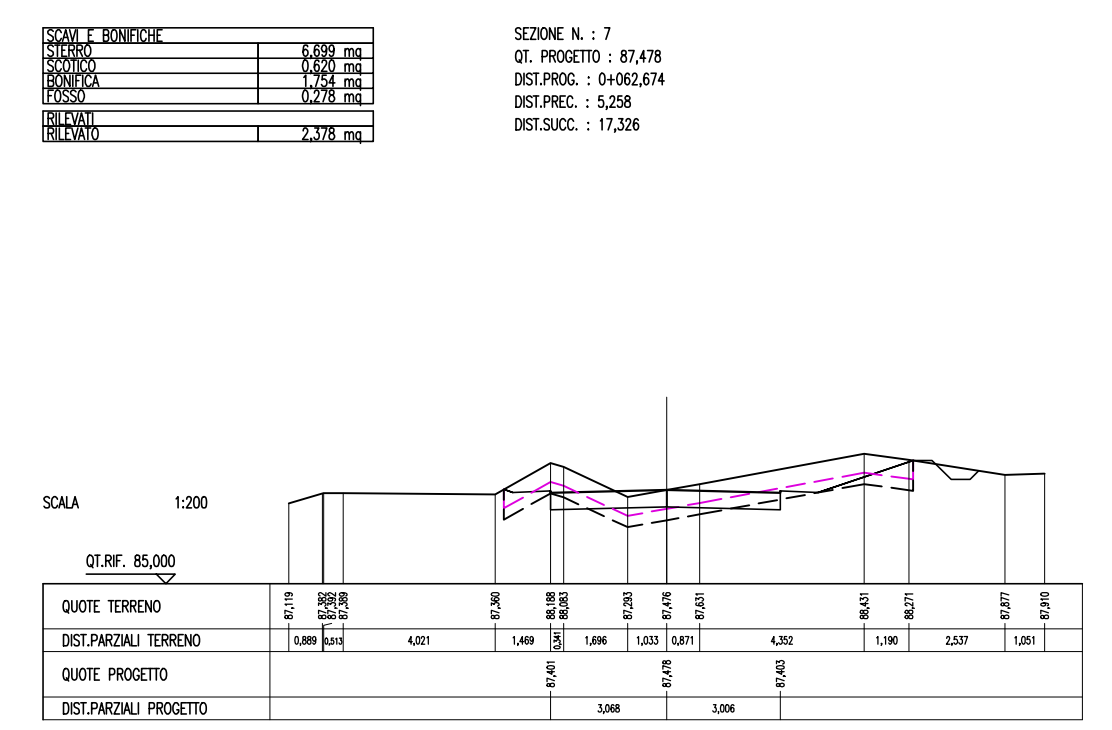
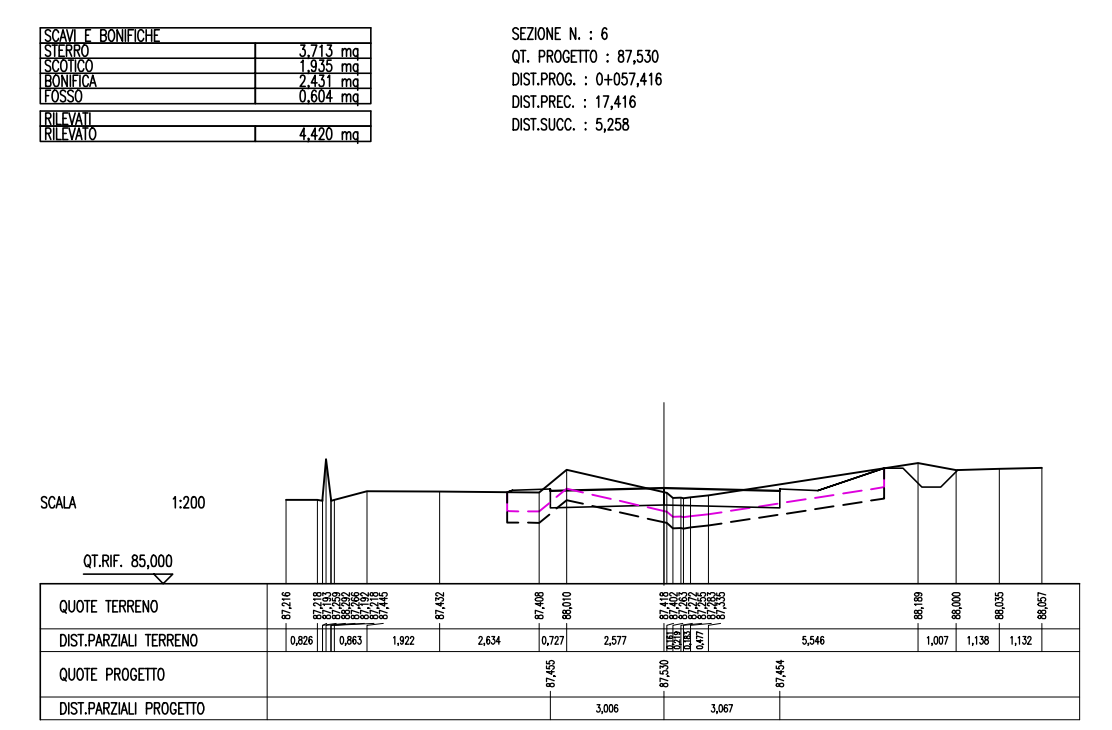
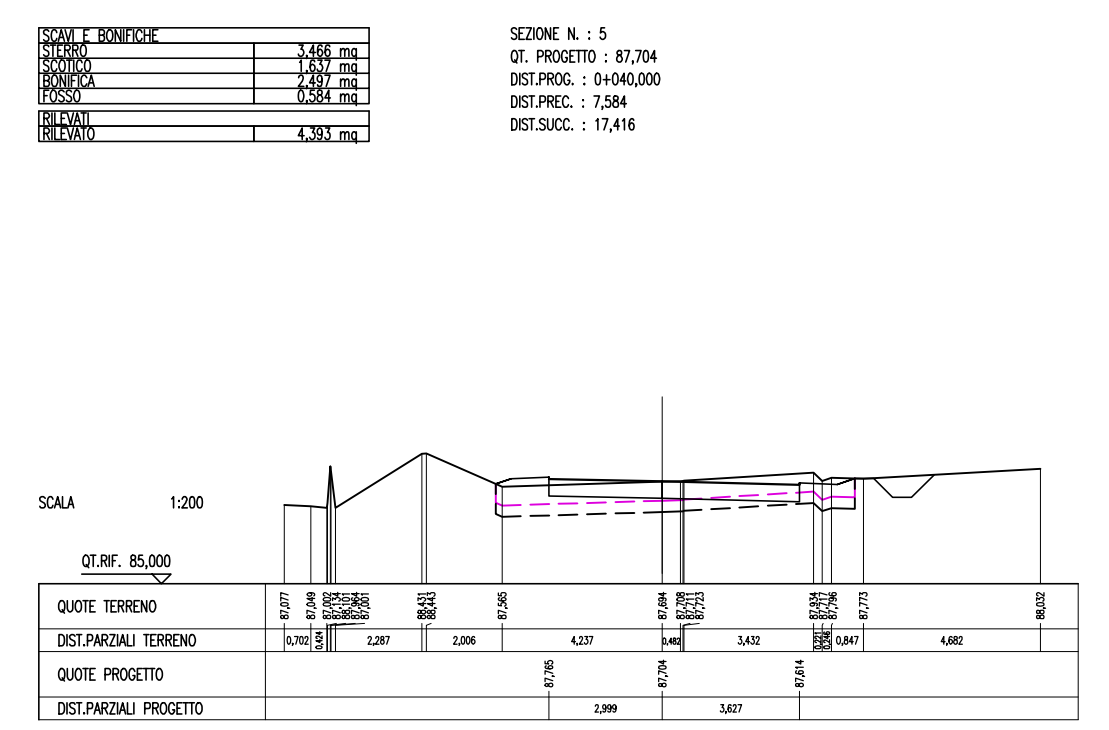
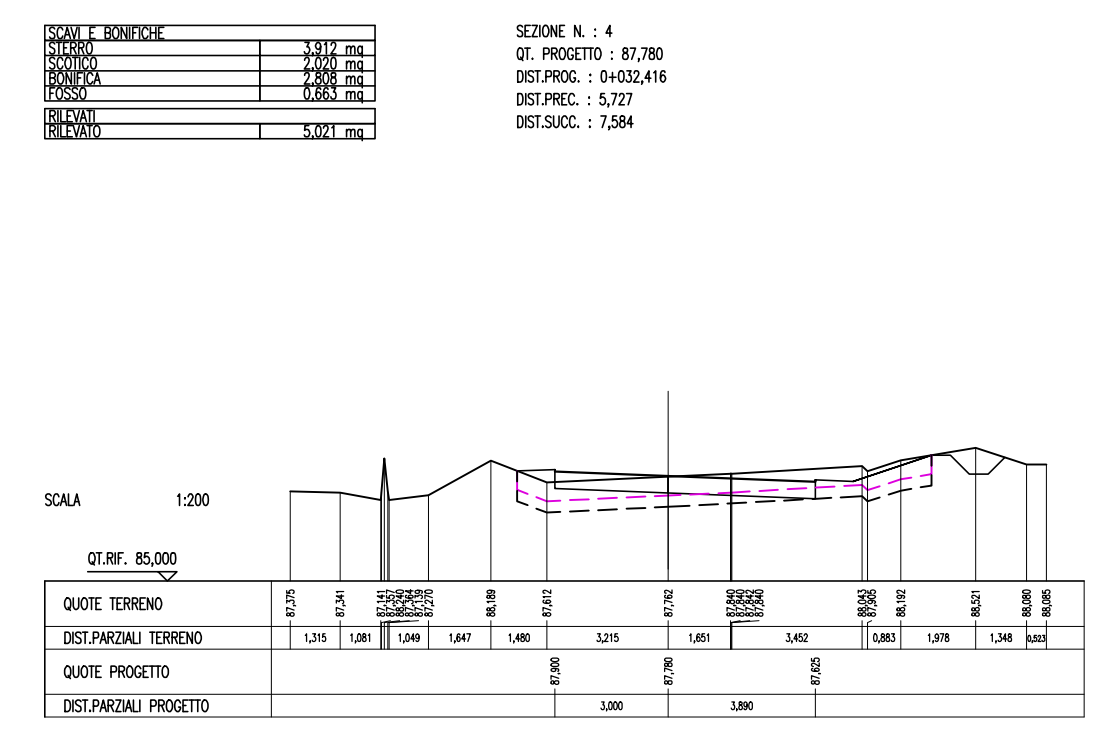
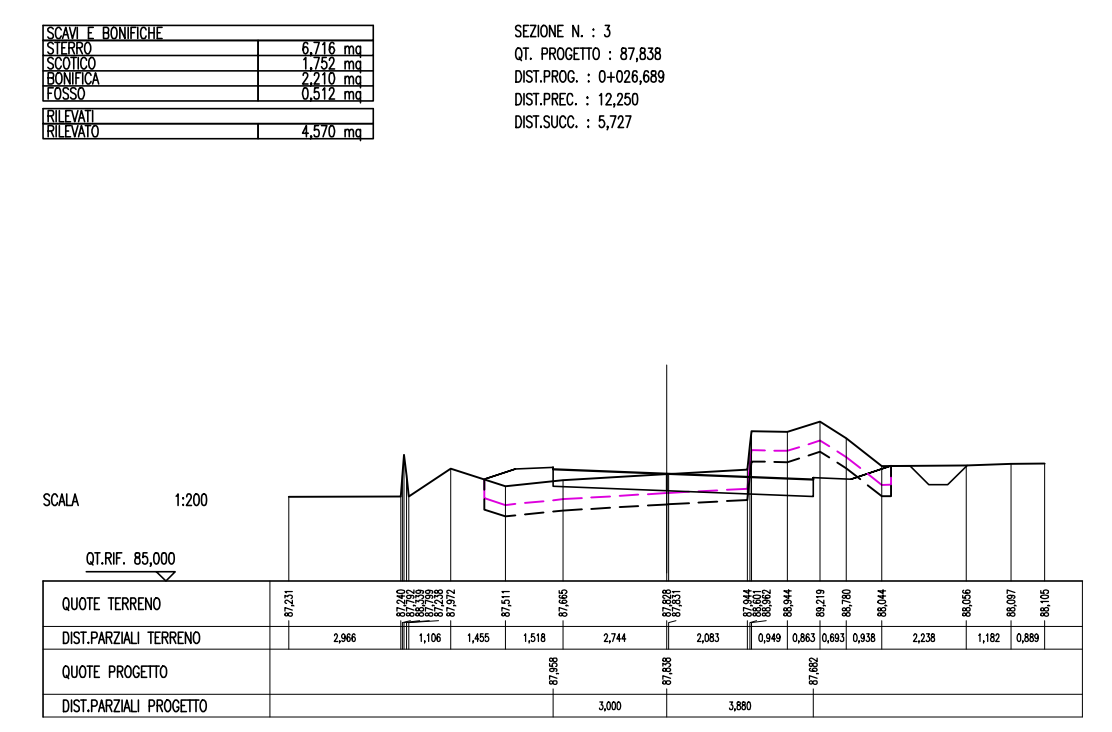
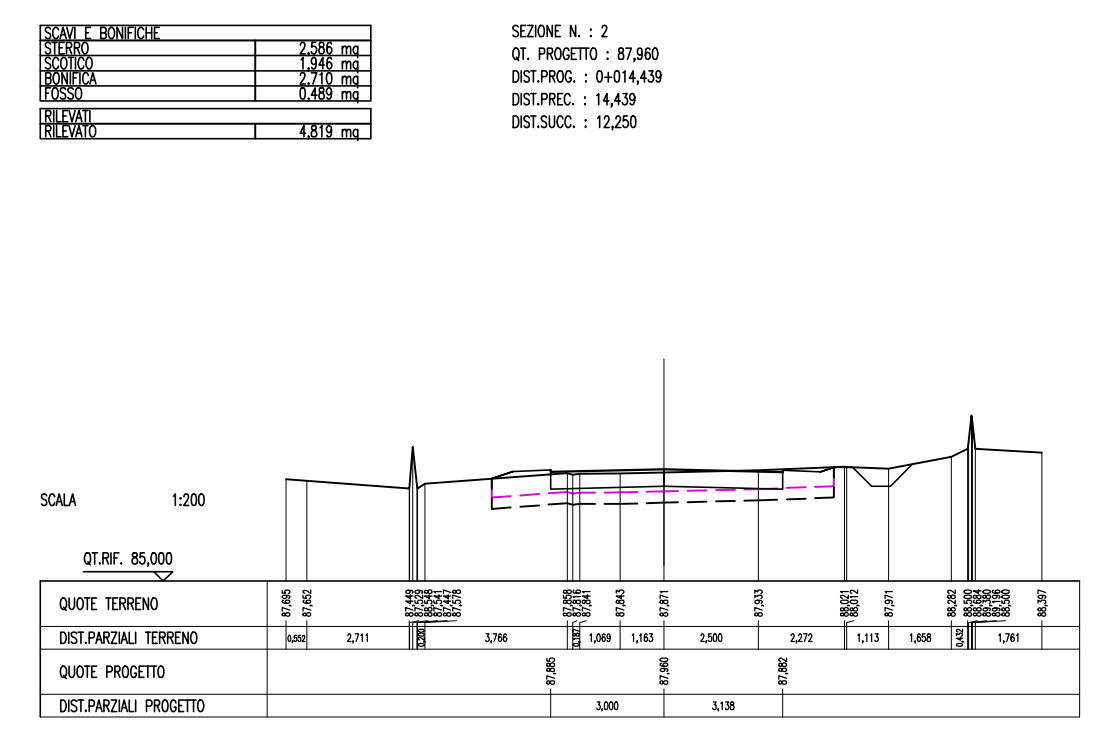
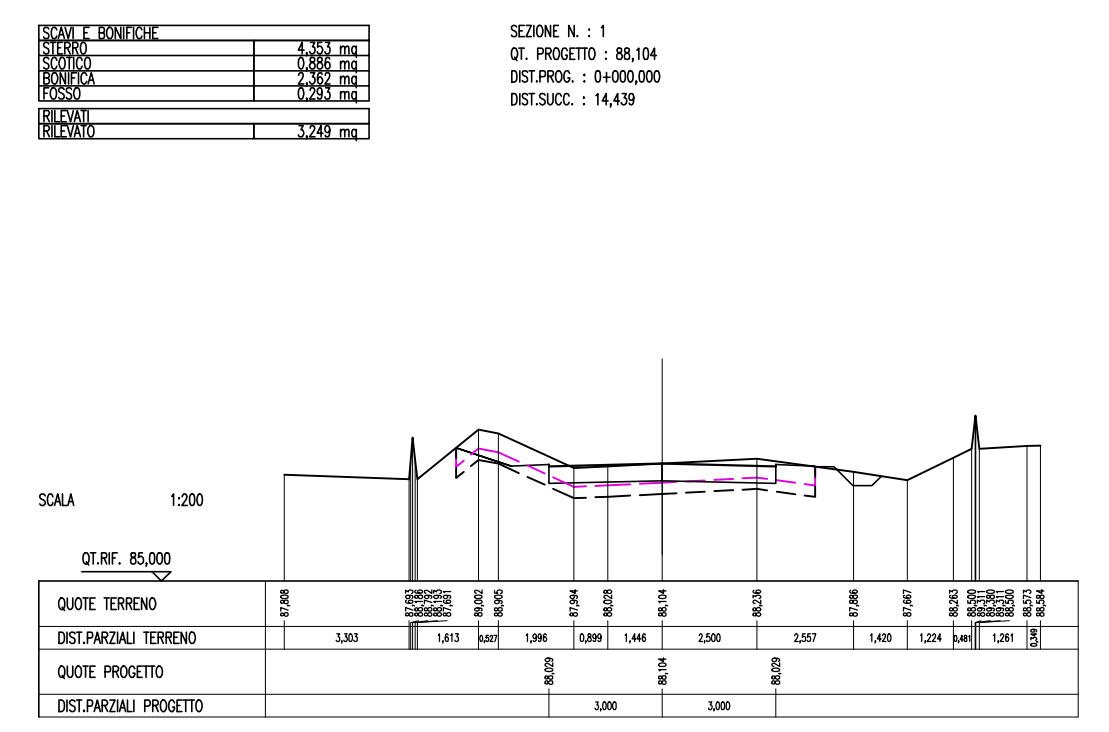

Table with 2 columns: DESCRIZIONE and CODICE. It lists various technical specifications and their corresponding codes, such as 'SVIN SIRMIONE - COGNOGRAFIA' and 'SVIN SIRMIONE - PLANIMETRIA GENERALE'.

- IL CODICE COMMESSA "A202" E' STATO SOSTITUITO CON "IN05"

NOTE GENERALI

CARATTERISTICHE DEI MATERIALI



COMMITTENTE: RFI Rete Ferroviaria Italiana Gruppo Ferrovie dello Stato Italiane

ALTA Sorveglianza: ITALFERR

GENERAL CONTRACTOR: Cepam due

INFRASTRUTTURE FERROVIARIE STRATEGICHE DEFINITE DALLA LEGGE OBBIETTIVO N. 443/01 LINEA A.V./A.C. TORINO - VENEZIA Tratta MILANO - VERONA Lotto funzionale Brescia-Verona PROGETTO DEFINITIVO

LINEA A.C. MILANO-VERONA Progetto Definitivo Svincolo Sirmione - Strada podereale: Sezioni trasversali

Table with columns: Verificato, Data, Approvato, Data. It contains approval signatures and dates.

Table with columns: COMM. LOTTO FASE ENTE TIPO DOC. OPERA/DISCIPLINA. It lists project details like 'IN05', '00', 'D', 'E2', 'M9', 'N19/00', '006', '0'.

Table with columns: PROGETTISTA GENERAL CONTRACTOR, PROGETTISTA INTEGRATORE. It lists project management roles and names.