

PIANTA COPERTURA

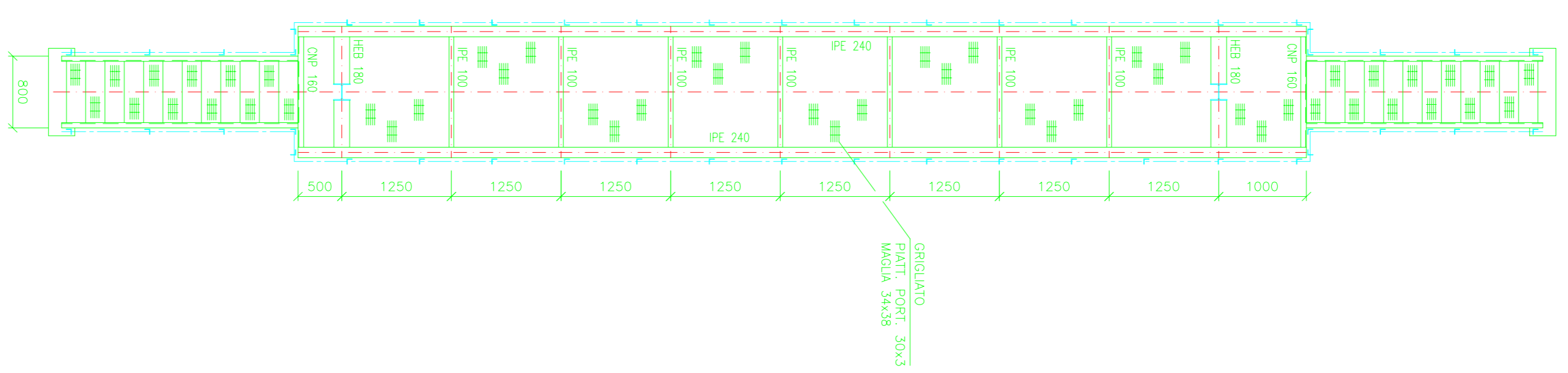

PIANTA QUOTA 2770

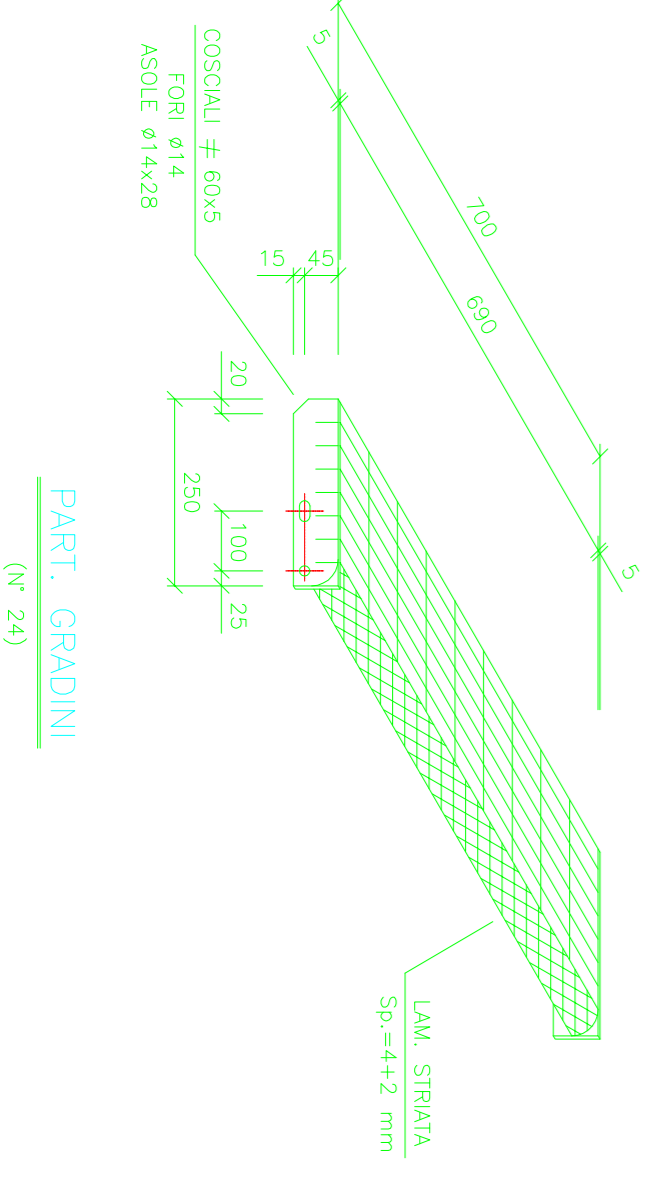

PARTI GRADINI
(N° 24)

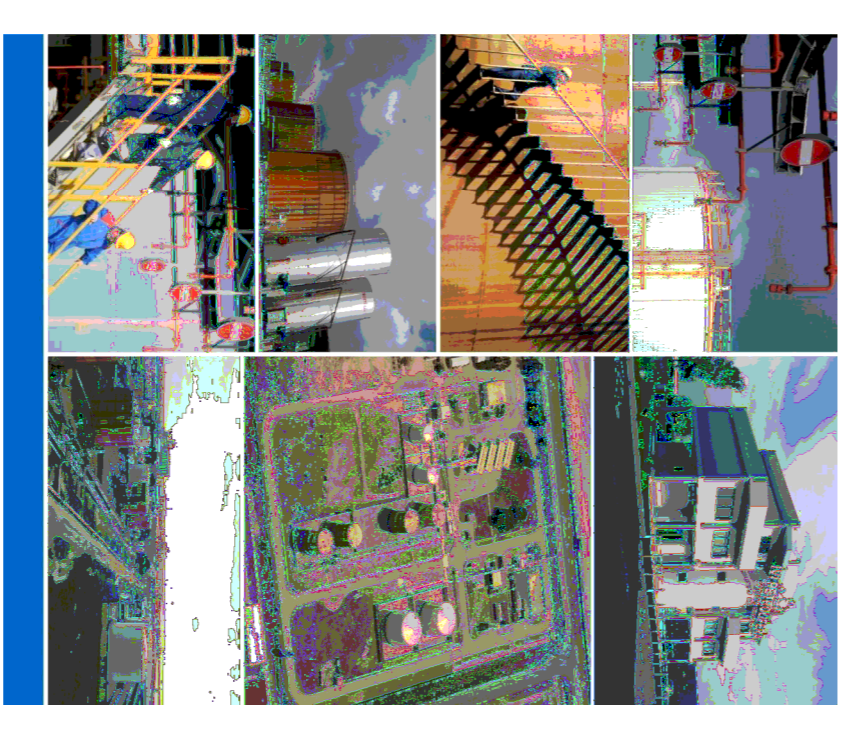
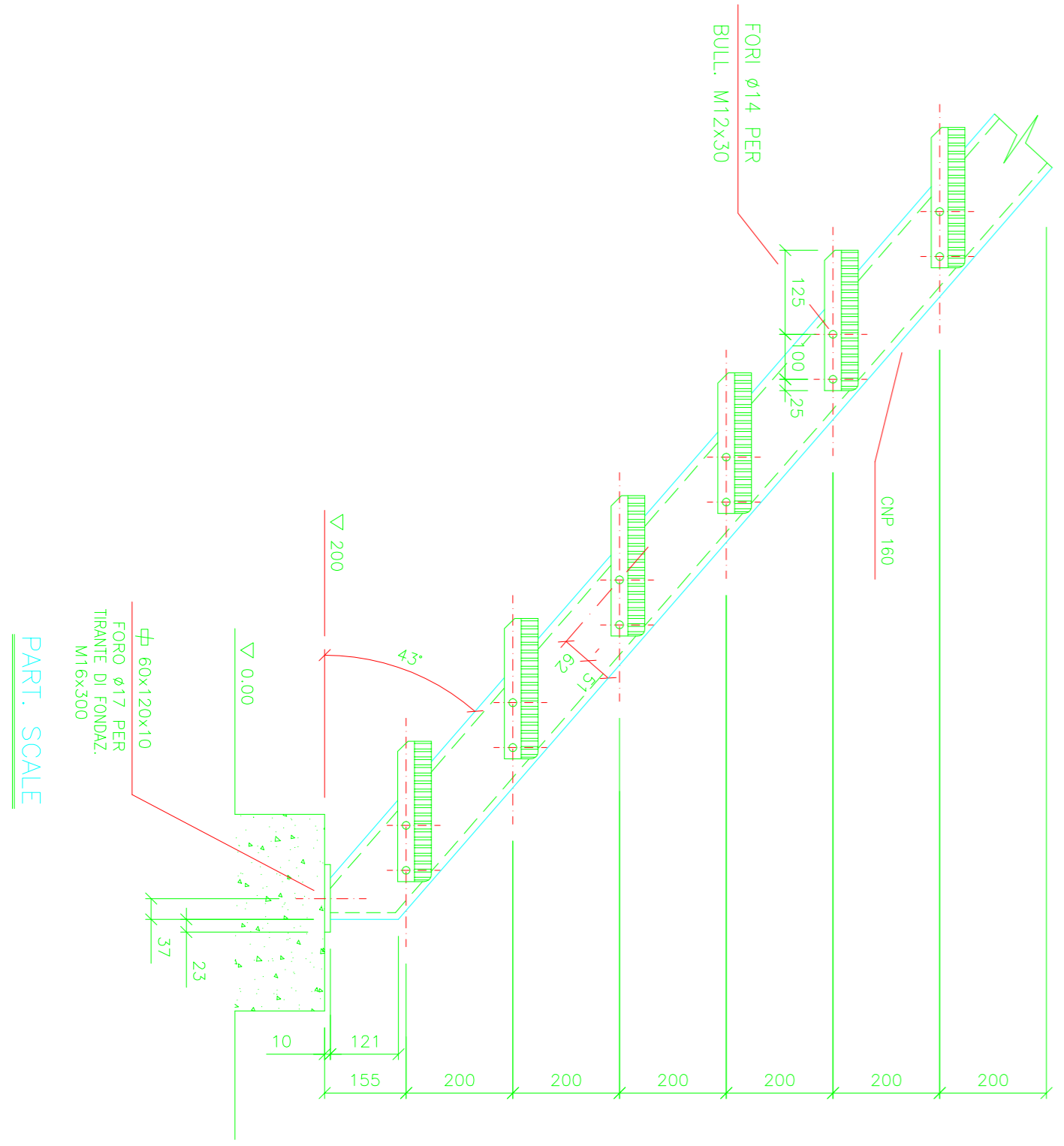
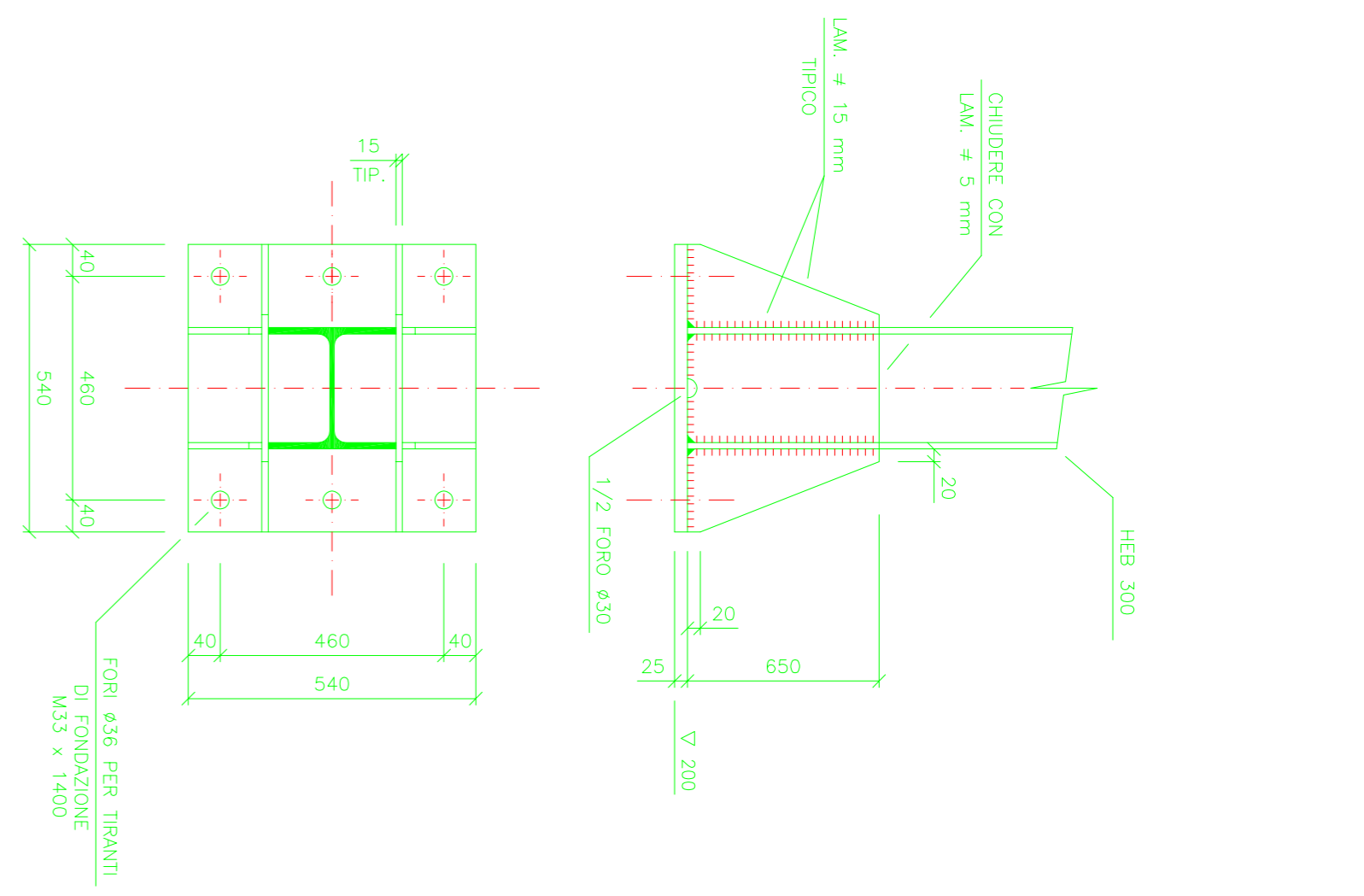
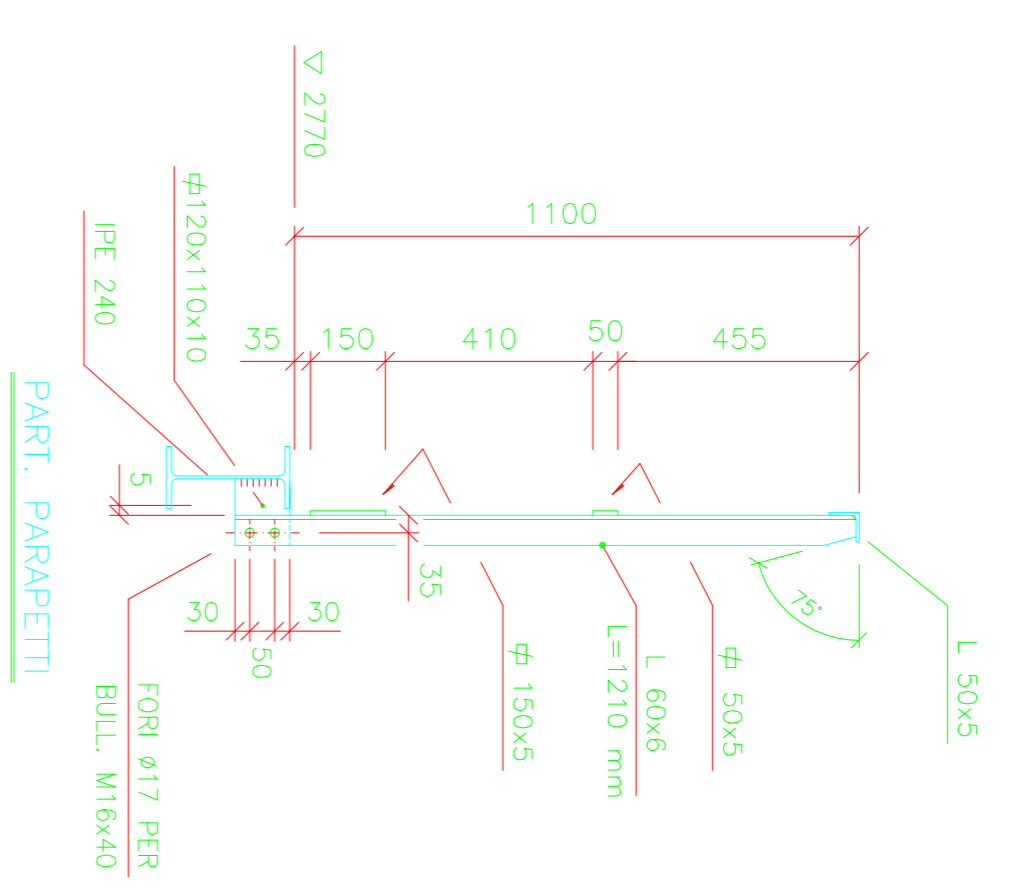
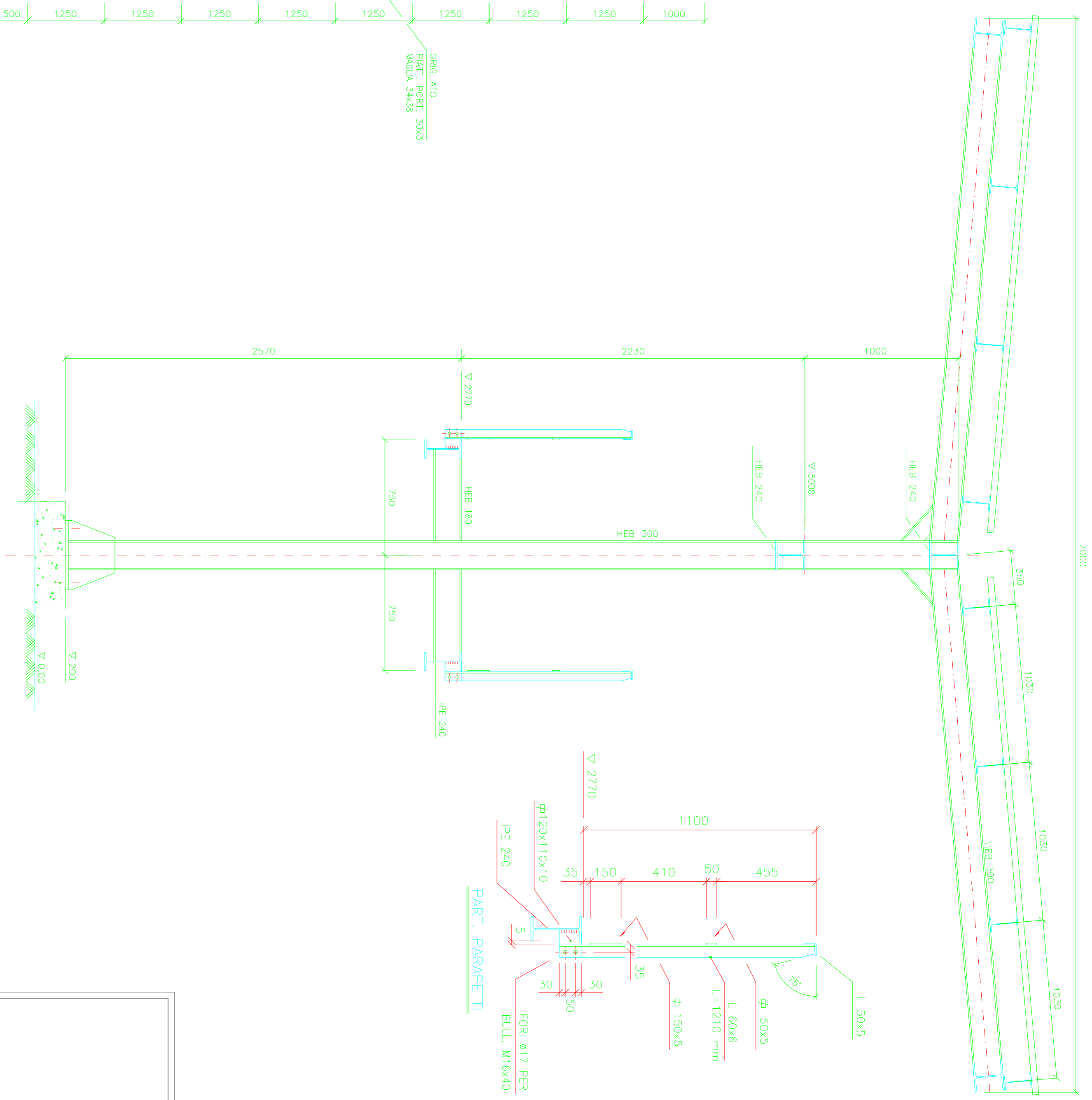

PROGETTO DI AMPLIAMENTO DEPOSITO COSTIERO DI SANTA GIUSTA
PER LA MOVIMENTAZIONE DI PRODOTTI PETROLIFERI

PROGETTO DEFINITIVO

IL COMMITTENTE
SIMV
PETROLIFERI
DEPOSITO COSTIERO

PROGETTAZIONE
Ing. Andrea Fiori

ELABORATO
PARTICOLARI COSTRUTTIVI
PENSILINE DI CARICO

TAVOLA
15
(CC-015-2014)

ORDINE INGEGNERI
PROF. ING. ANDREA FIORI
N° 548 DOPI
Ingegneri Ordine Amministrativa, Incentivabile e
dell'Interprofessione Superiore a.s.c. - Sezione a.b.c.

SCALA: /
DATA: 07/11/2014