

ELEMENTI STRUTTURALI COMPONENTI I SOSTEGNI

SOSTEGNI		Mensola	Parte comune	Elemento ausiliario	TRONCHI						Base	Piedi
Tipo	Riferimento				I	II	III	IV	V	VI		
ELEMENTI STRUTTURALI												
MV 15	1083/1	2726	2725	2850	2851	—	—	—	—	—	2857	2867
MV 18	1083/2	2726	2725	2850	2851	2852	—	—	—	—	2858	2867
MV 21	1083/3	2726	2725	2850	2851	2852	—	—	—	—	2859	2867
MV 24	1083/4	2726	2725	2850	2851	2852	2853	—	—	—	2860	2867
MV 27	1083/5	2726	2725	2850	2851	2852	2853	—	—	—	2861	2868
MV 30	1083/6	2726	2725	2850	2851	2852	2853	—	—	—	2862	2868
MV 33	1083/7	2726	2725	2850	2851	2852	2853	2854	—	—	2863	2868
MV 36	1083/8	2726	2725	2850	2851	2852	2853	2854	—	—	2864	2868
MV 39	1083/9	2726	2725	2850	2851	2852	2853	2854	2855	—	2865	2868
MV 42	1083/10	2726	2725	2850	2851	2852	2853	2854	2855	2856	2866	2868

ELEMENTI STRUTTURALI COMPONENTI I SOSTEGNI

TRONCHI		Mensola	Parte comune	Elemento ausiliario	SOSTEGNI								Base	Piedi
Tipo	Riferimento				I	II	III	IV	V	VI	VII	VIII		
ELEMENTI STRUTTURALI														
MV 45	1083/11	2726	2725	2850	2851	2852	2853	2854	2855	2856	—	—	2963	2967
MV 48	1083/12	2726	2725	2850	2851	2852	2853	2854	2855	2856	2961	—	2964	2967
MV 51	1083/13	2726	2725	2850	2851	2852	2853	2854	2855	2856	2961	—	2965	2967
MV 54	1083/14	2726	2725	2850	2851	2852	2853	2854	2855	2856	2961	2962	2966	2967

ELEMENTI STRUTTURALI COMPONENTI I SOSTEGNI

SOSTEGNI		Mensola	Parte comune	ELEMENTO AUSILIARIO		TRONCHI						Base	Piedi
Tipo	Riferimento			I	II	I	II	III	IV	V	VI		
						ELEMENTI STRUTTURALI							
ML 15	1083/21	2727	2725	2850	2869	2851	—	—	—	—	—	2857	2867
ML 18	1083/22	2727	2725	2850	2869	2851	2852	—	—	—	—	2858	2867
ML 21	1083/23	2727	2725	2850	2869	2851	2852	—	—	—	—	2859	2867
ML 24	1083/24	2727	2725	2850	2869	2851	2852	2853	—	—	—	2860	2867
ML 27	1083/25	2727	2725	2850	2869	2851	2852	2853	—	—	—	2861	2868
ML 30	1083/26	2727	2725	2850	2869	2851	2852	2853	—	—	—	2862	2868
ML 33	1083/27	2727	2725	2850	2869	2851	2852	2853	2854	—	—	2863	2868
ML 36	1083/28	2727	2725	2850	2869	2851	2852	2853	2854	—	—	2864	2868
ML 39	1083/29	2727	2725	2850	2869	2851	2852	2853	2854	2855	—	2865	2868
ML 42	1083/30	2727	2725	2850	2869	2851	2852	2853	2854	2855	2856	2866	2868

ELEMENTI STRUTTURALI COMPONENTI I SOSTEGNI

SOSTEGNI		Mensola	Parte comune	ELEMENTO AUSILIARIO		TRONCHI								Base	Piedi
Tipo	Riferimento			I	II	I	II	III	IV	V	VI	VII	VIII		
ELEMENTI STRUTTURALI															
ML 45	1083/31	2727	2725	2850	2869	2851	2852	2853	2854	2855	2856	—	—	2963	2967
ML 48	1083/32	2727	2725	2850	2869	2851	2852	2853	2854	2855	2856	2961	—	2964	2967
ML 51	1083/33	2727	2725	2850	2869	2851	2852	2853	2854	2855	2856	2961	—	2965	2967
ML 54	1083/34	2727	2725	2850	2869	2851	2852	2853	2854	2855	2856	2961	2962	2966	2967

UNIFICAZIONE

ENEL

LS 1083

Gennaio 1993
Ed. 1 - 5/12

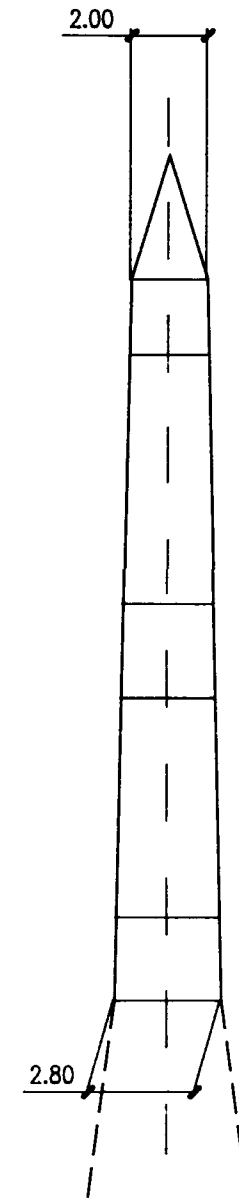
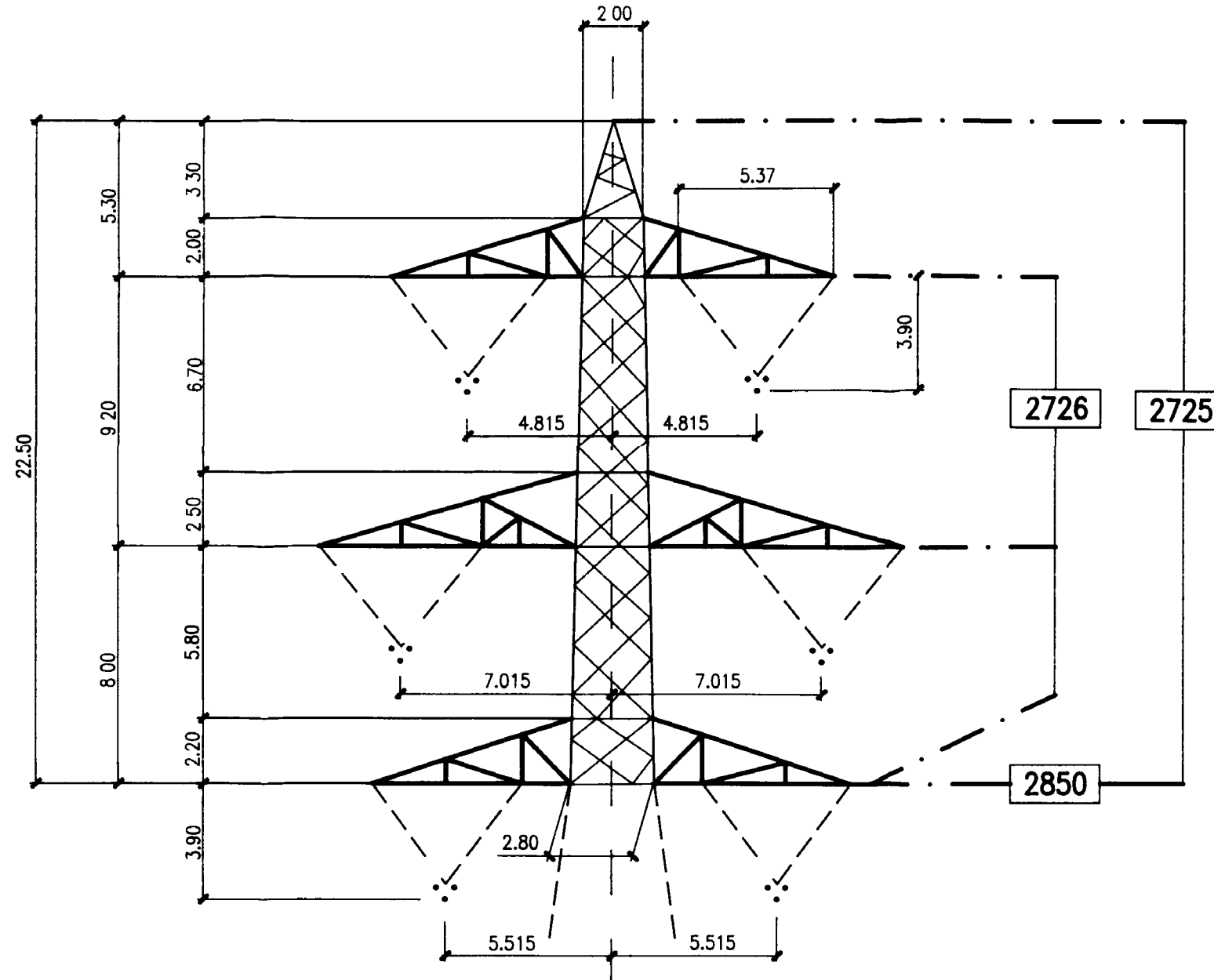

VISTA TRASVERSALE

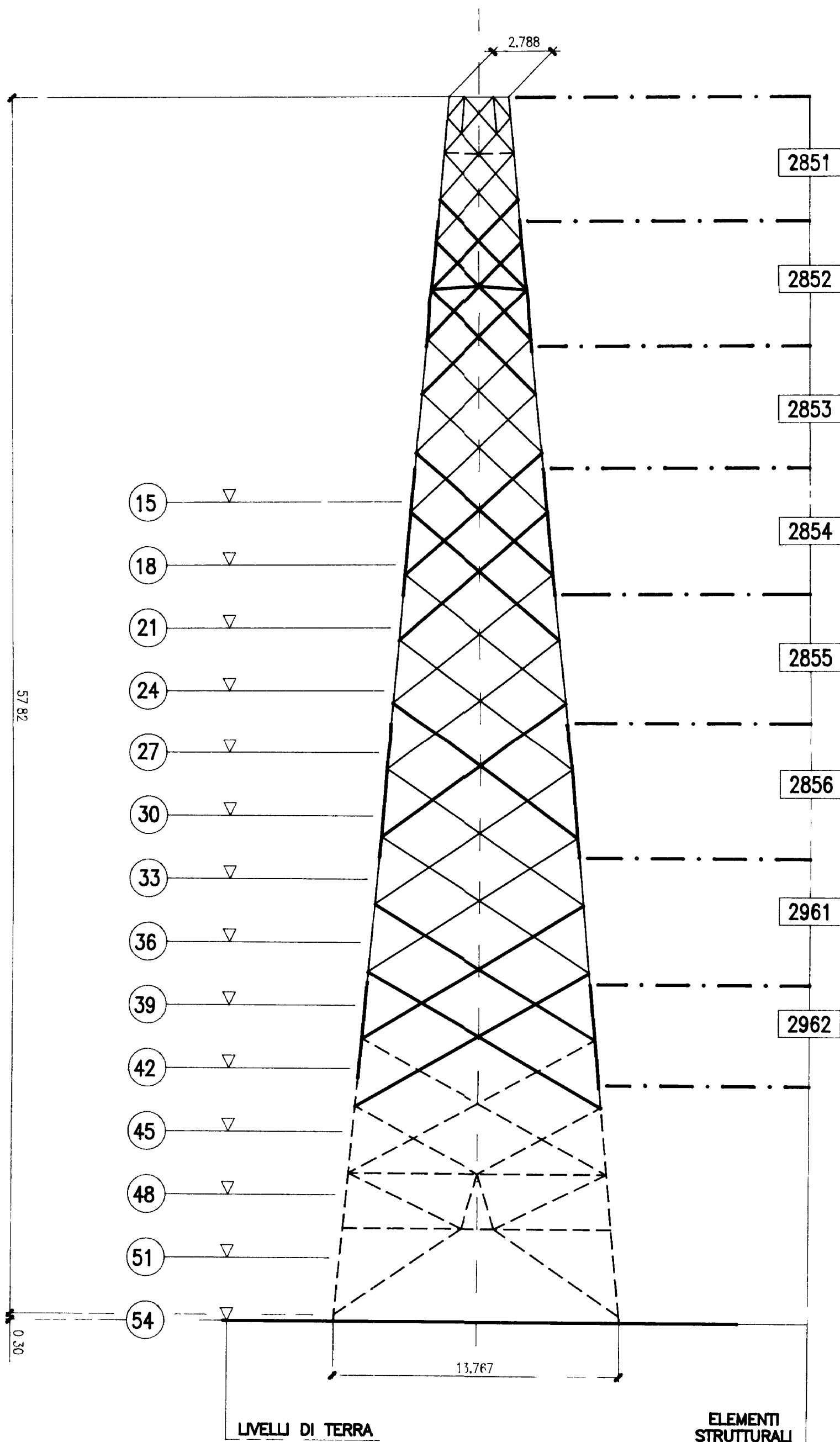

LIVELLI DI TERRA

ELEMENTI STRUTTURALI

UNIFICAZIONE
ENEL

LS 1083
Gennaio 1993
Ed. 1 - 6/12

VISTA LONGITUDINALE

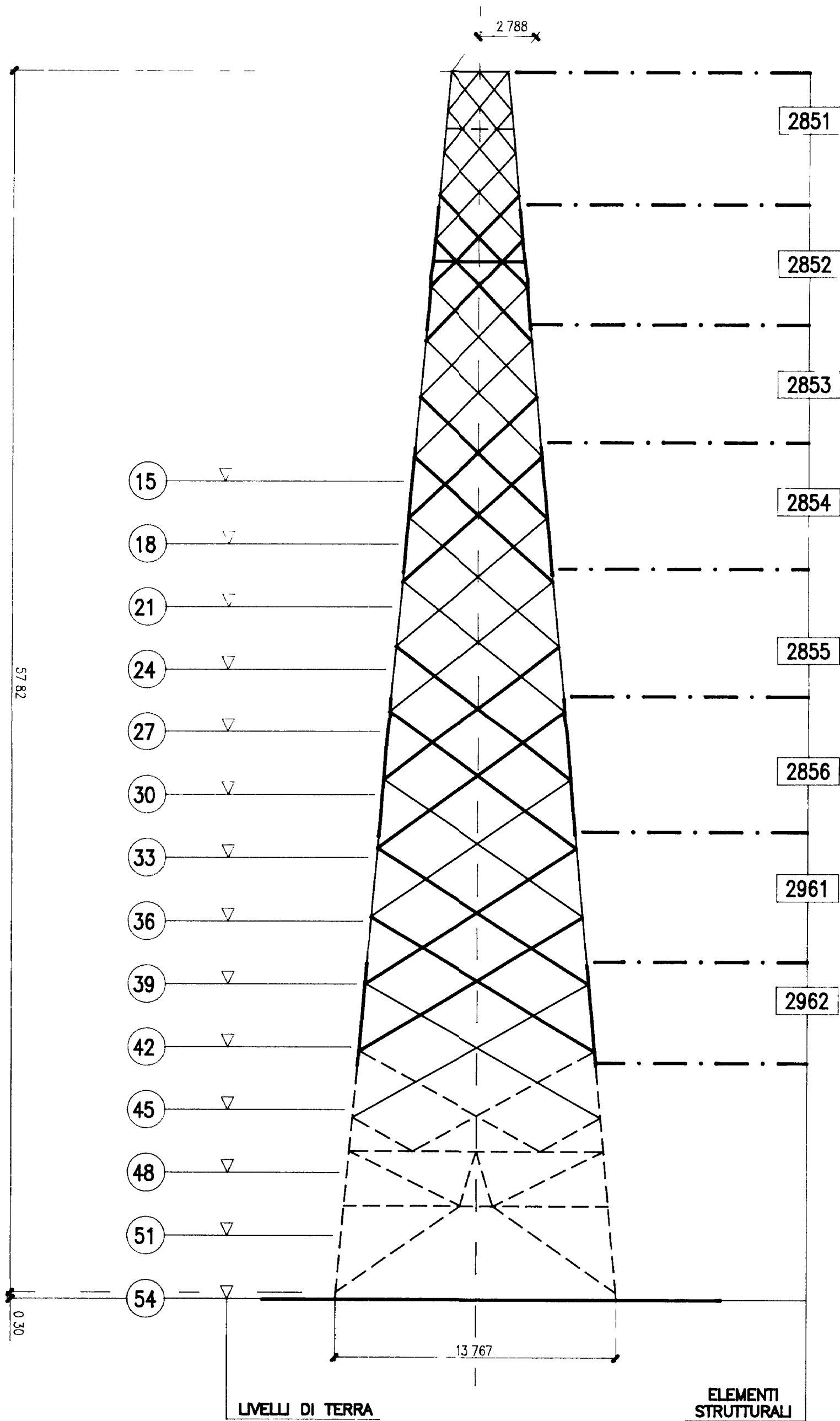

UNIFICAZIONE
ENEL

LS 1083
Gennaio 1993
Ed. 1 - 7/12

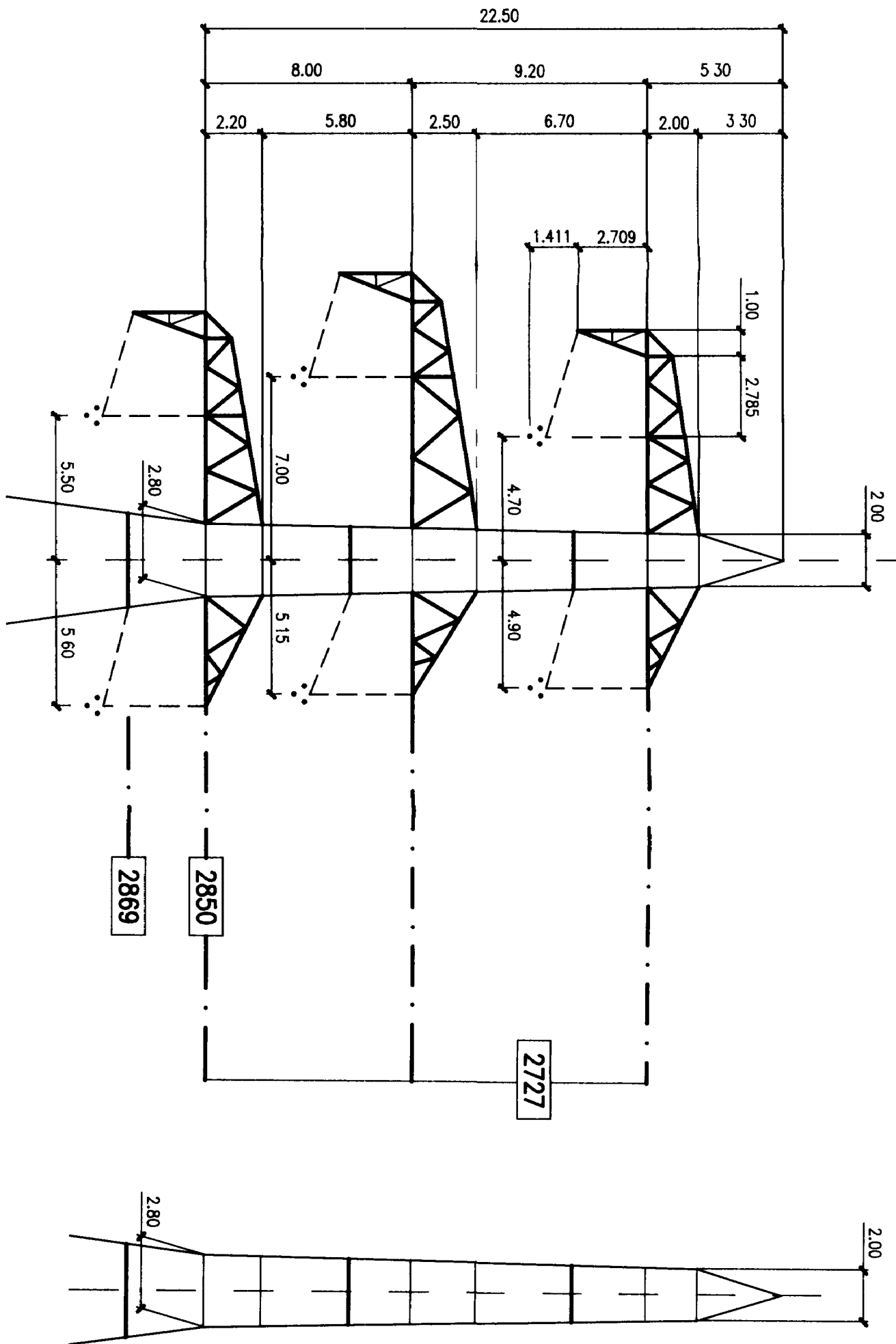

UNIFICAZIONE
ENEL

LS 1083

Geniale 1983
Ed. 1 - 8/12

BASI

VISTE TRASVERSALI

VISTE LONGITUDINALI

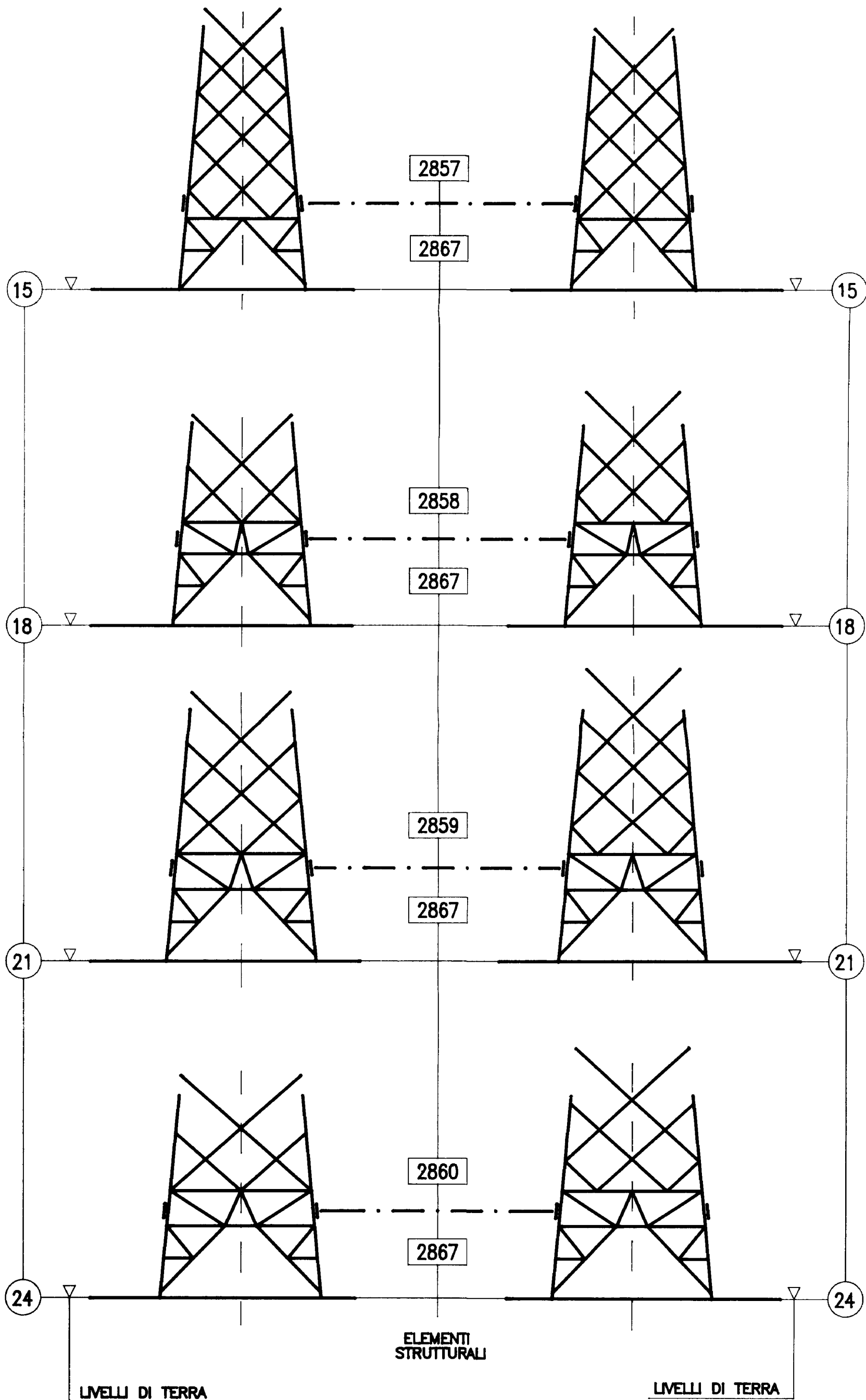

UNIFICAZIONE
ENEL

LS 1083

Genio 1993
Ed. 1 - 9/12

BASI

VISTE TRASVERSALI

VISTE LONGITUDINALI

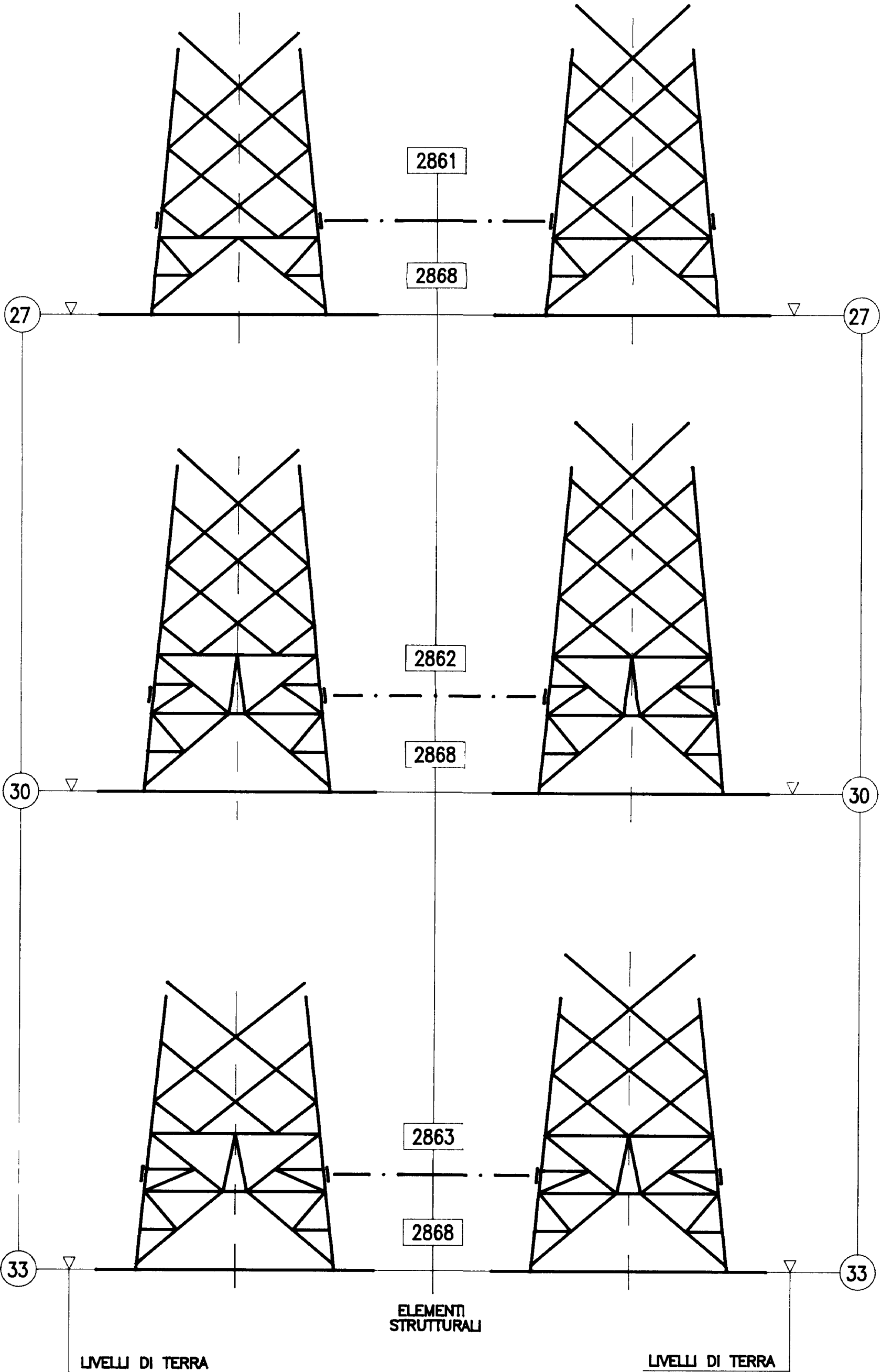

UNIFICAZIONE
ENEL

LS 1083

Gennaio 1993
Ed. 1 - 10/12

BASI

VISTE TRASVERSALI

VISTE LONGITUDINALI

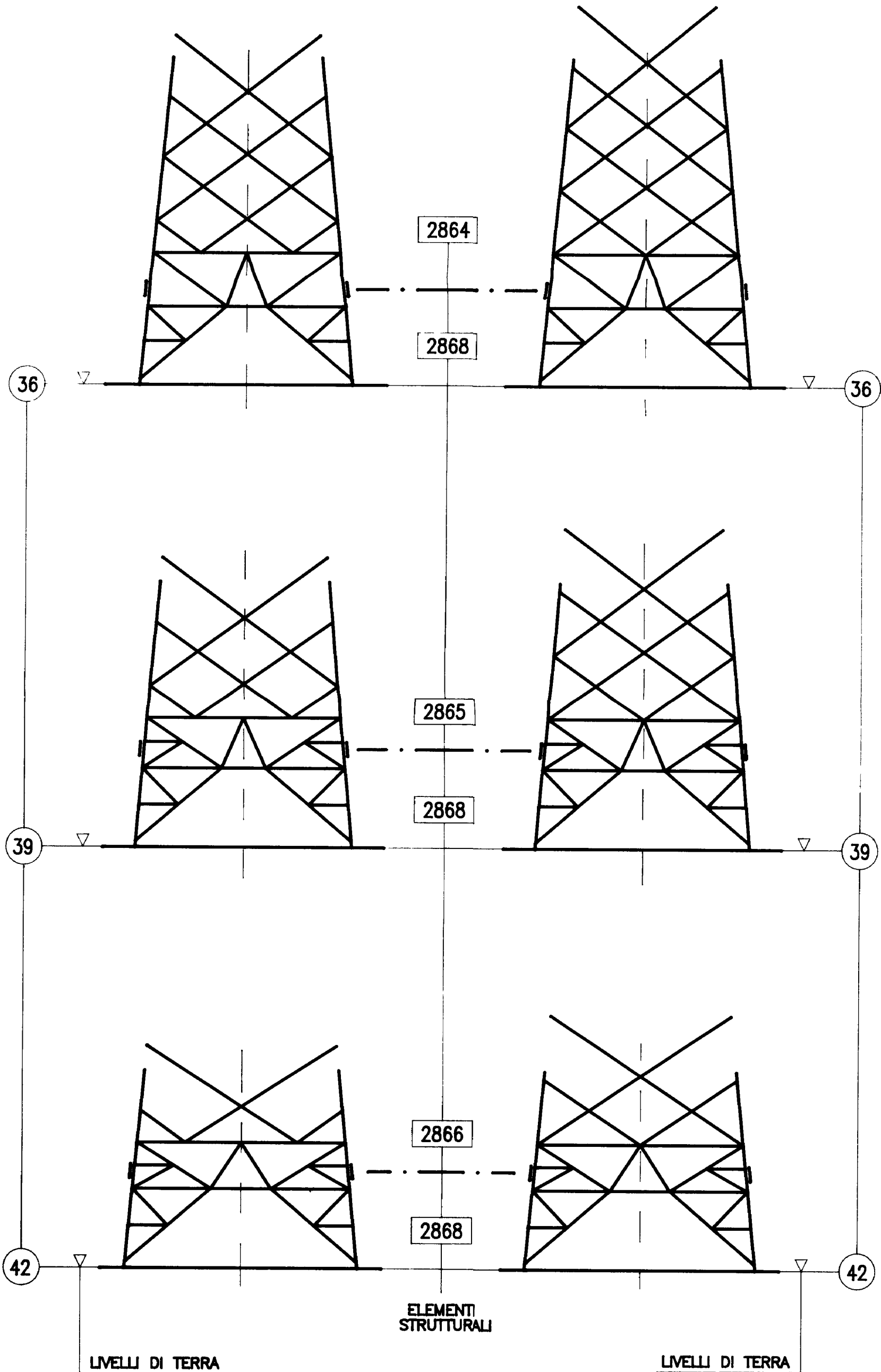

UNIFICAZIONE
ENEL

LS 1083

Genadio 1993
Ed. 1 - 11/12

VISTE TRASVERSALI

BASI

VISTE LONGITUDINALI

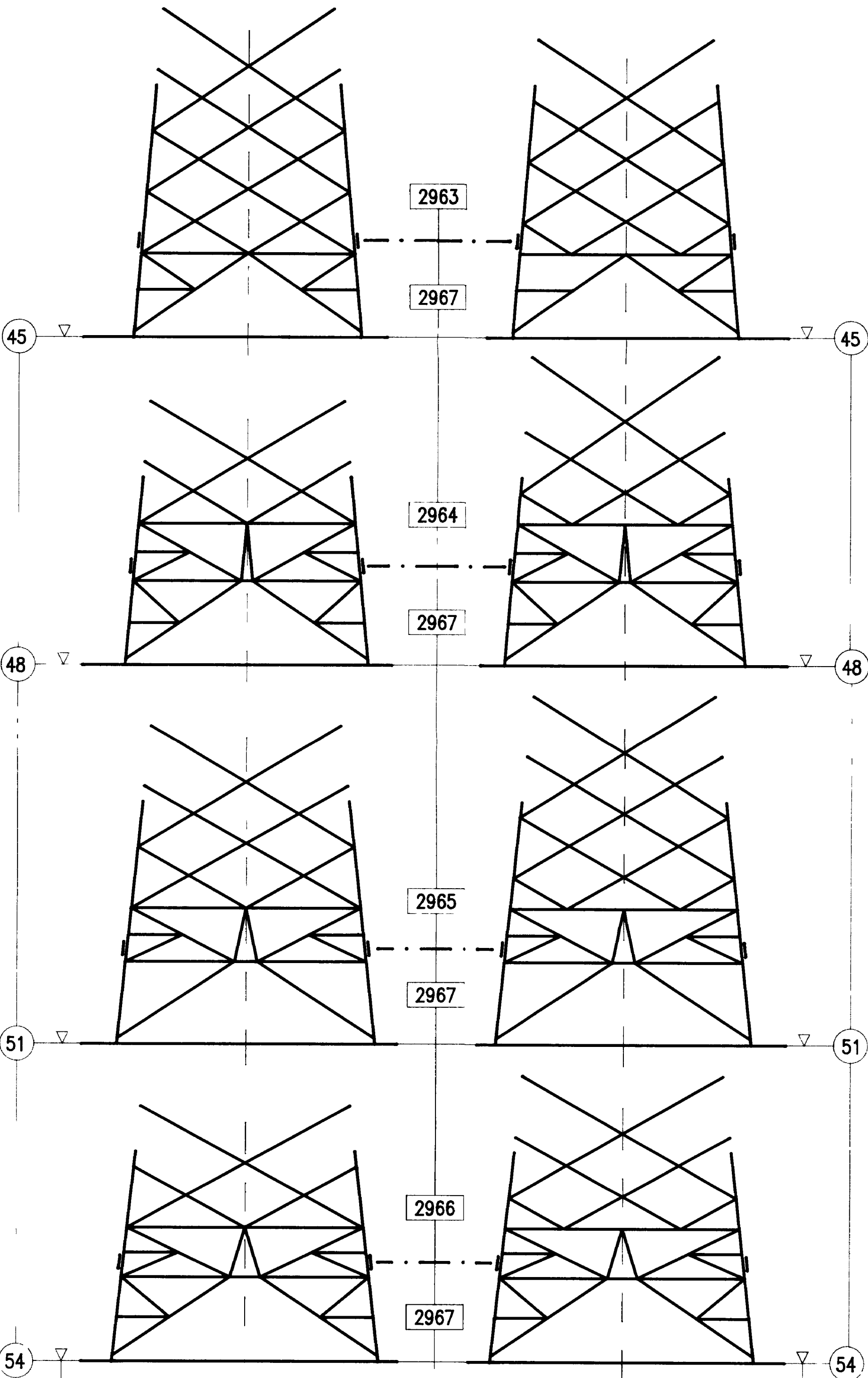

LIVELLI DI TERRA

ELEMENTI STRUTTURALI

LIVELLI DI TERRA

UNIFICAZIONE
ENEL

LS 1083
Gennaio 1993
Ed. 1 - 12/12