

**PLANIMETRIA**  
SCALA 1:500

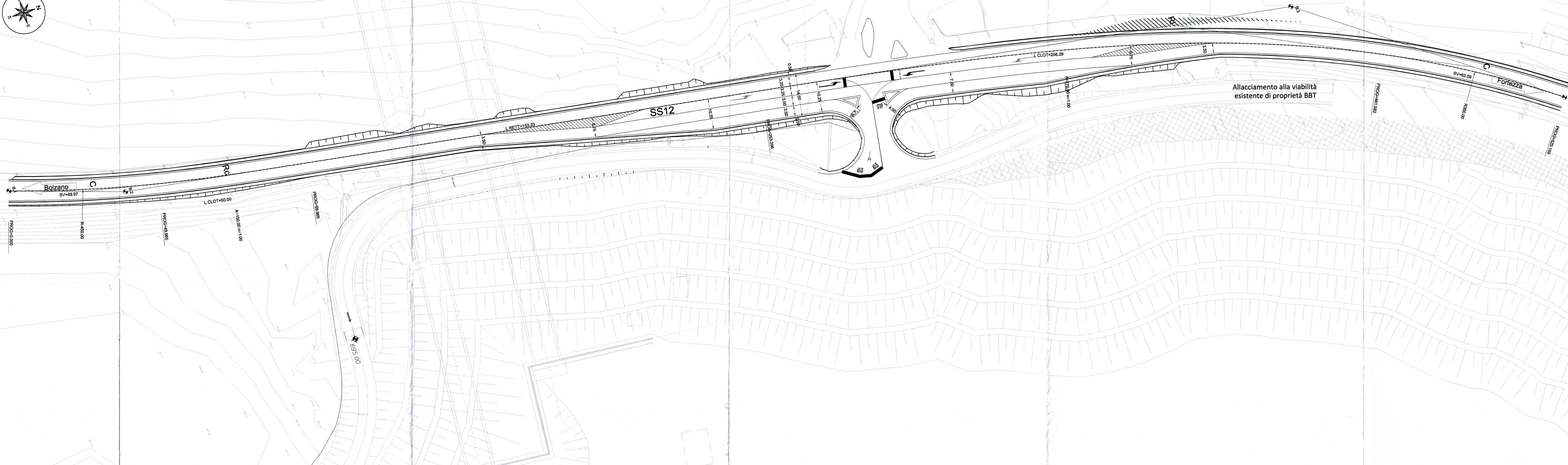

STRA B VERTICE B.2				STRA B VERTICE B.3							
X	1701441.500	R	X	0.000	X	1701488.884	R	X	1701488.884		
Y	5181449.184	Y	0.000	Y	5181857.896	Y	5181857.896	Y	5181857.896		
T	38.965	T <sub>v</sub>	0.000	T	179.437	T <sub>v</sub>	130.507	T	179.437		
Alfa	15.850387	Alfa	0.000	Alfa	30.690703	Alfa	30.690703	Alfa	30.690703		
Az	21.006481	Az	0.000	Az	10.401093	Az	270.000	Az	10.401093		
DeMtr	15.601093	DeMtr	0.000	DeMtr	0.000	DeMtr	0.165	DeMtr	0.165		
C	X	1701438.777	R	X	1701445.830	C	X	1701444.207	R	X	0.000
Y	5181445.960	Y	5181445.960	Y	5181445.960	Y	5181445.960	Y	5181445.960	Y	0.000
R	-450.000	T <sub>v</sub>	33.339	R	350.000	T <sub>v</sub>	0.000	R	350.000	T <sub>v</sub>	0.000
Alfa	7.098012	Alfa	16.672	Alfa	11.988017	Alfa	0.000	Alfa	11.988017	Alfa	0.000
T <sub>v</sub>	23.008	T <sub>v</sub>	30.600	T <sub>v</sub>	31.881	T <sub>v</sub>	0.000	T <sub>v</sub>	31.881	T <sub>v</sub>	0.000
Sv	49.965	A	150.000	Sv	63.588	A	150.000	Sv	63.588	A	150.000
DeMtr	0.231	DeMtr	0.000	DeMtr	0.000	DeMtr	0.000	DeMtr	0.000	DeMtr	0.000
Tau	3.538774	Tau	0.000000	Tau	3.538774	Tau	0.000000	Tau	3.538774	Tau	0.000000

STRA B VERTICE B.4				STRA B VERTICE B.1					
X	1701583.314	R	X	1701428.674	X	1701428.674	R	X	1701428.674
Y	5181935.286	Y	0.000	Y	5181432.321	Y	5181432.321	Y	5181432.321
Alfa	40.500707	Alfa	0.000	Alfa	21.006481	Alfa	0.000	Alfa	21.006481

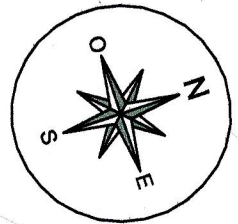
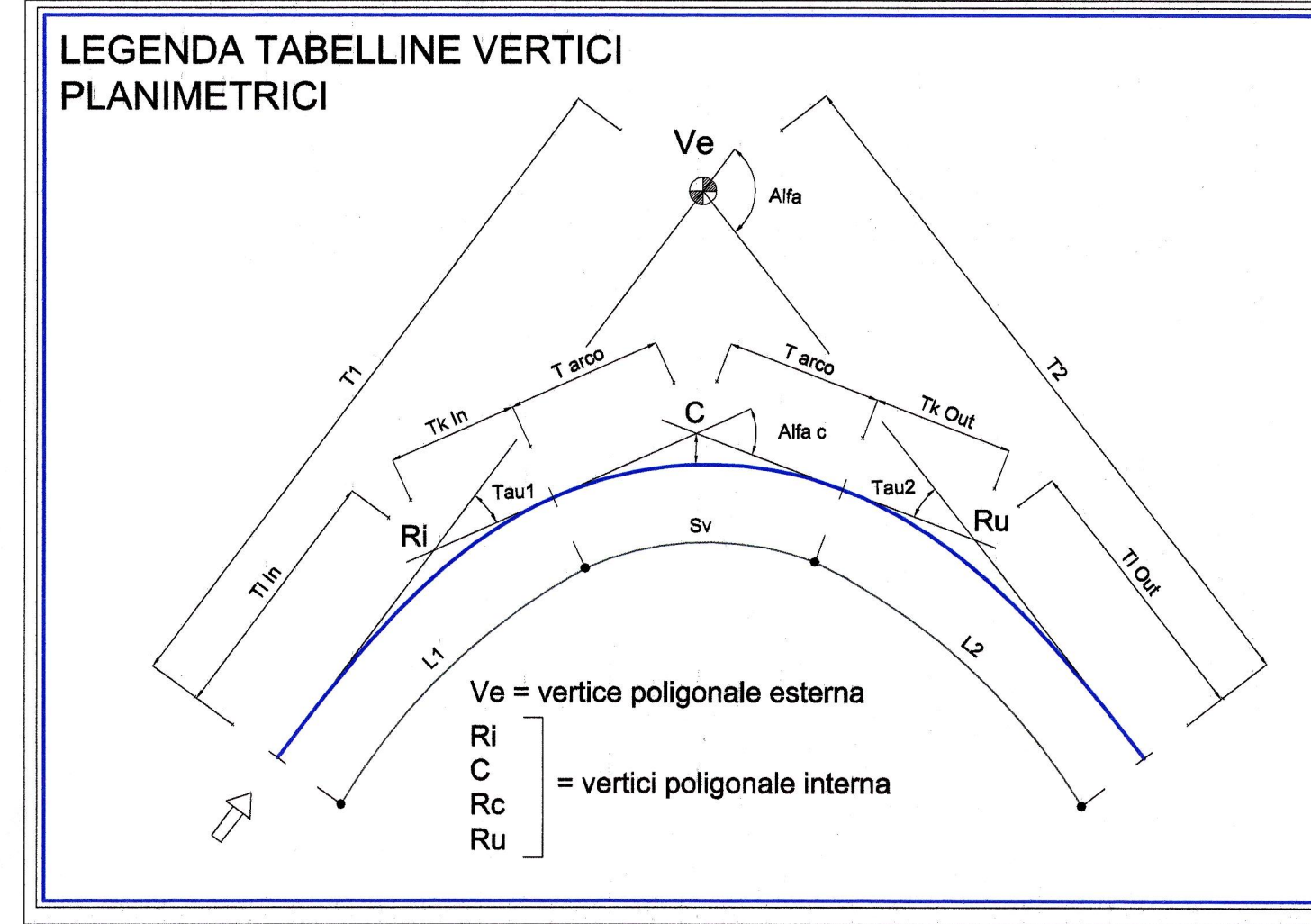

LIVELLETTA	L	DGL	R	L	DGL	R	L	DGL	R	L	DGL	R	L	DGL	R	L	DGL	R
PROG. LIVELLETTA	60.54	0.0015009	60.538	41.26	0.011593	41.25	17.48	0.011593	17.48	39.86	0.011593	39.86	109.74	0.022667	109.74	72.32	0.022667	72.32
	60.54	0.0015009	60.538	101.791	0.021851	101.781	119.271	0.021851	119.271	199.125	0.021851	199.125	268.864	0.022667	268.864	341.180	0.022667	341.180
	60.54	0.0015009	60.538	341.180	0.022667	341.180	377.548	0.022667	377.548	447.349	0.022667	447.349	525.169	0.022667	525.169	598.80	0.022667	598.80

PR = 0.00	PR = 60.54	PR = 95.84	PR = 152.07	PR = 188.65	PR = 274.32	PR = 341.18	PR = 377.55	PR = 447.35	PR = 525.17
QV = 697.54	QV = 697.54	QV = 697.54	QV = 697.54	QV = 697.54	QV = 697.54	QV = 697.54	QV = 697.54	QV = 697.54	QV = 697.54
CP = 0.004	CP = 0.004	CP = 0.004	CP = 0.004	CP = 0.004	CP = 0.004	CP = 0.004	CP = 0.004	CP = 0.004	CP = 0.004
PS = 4000.00	PS = 4000.00	PS = 4000.00	PS = 4000.00	PS = 4000.00	PS = 4000.00	PS = 4000.00	PS = 4000.00	PS = 4000.00	PS = 4000.00
T = 15.67	T = 4.28	T = 16.63	T = 16.67	T = 16.67	T = 3.08	T = 11.92	T = 19.17	T = 14.22	T = 7.08
F = 0.04	F = 0.01	F = 0.01	F = 0.01	F = 0.01	F = 0.01	F = 0.01	F = 0.01	F = 0.01	F = 0.01

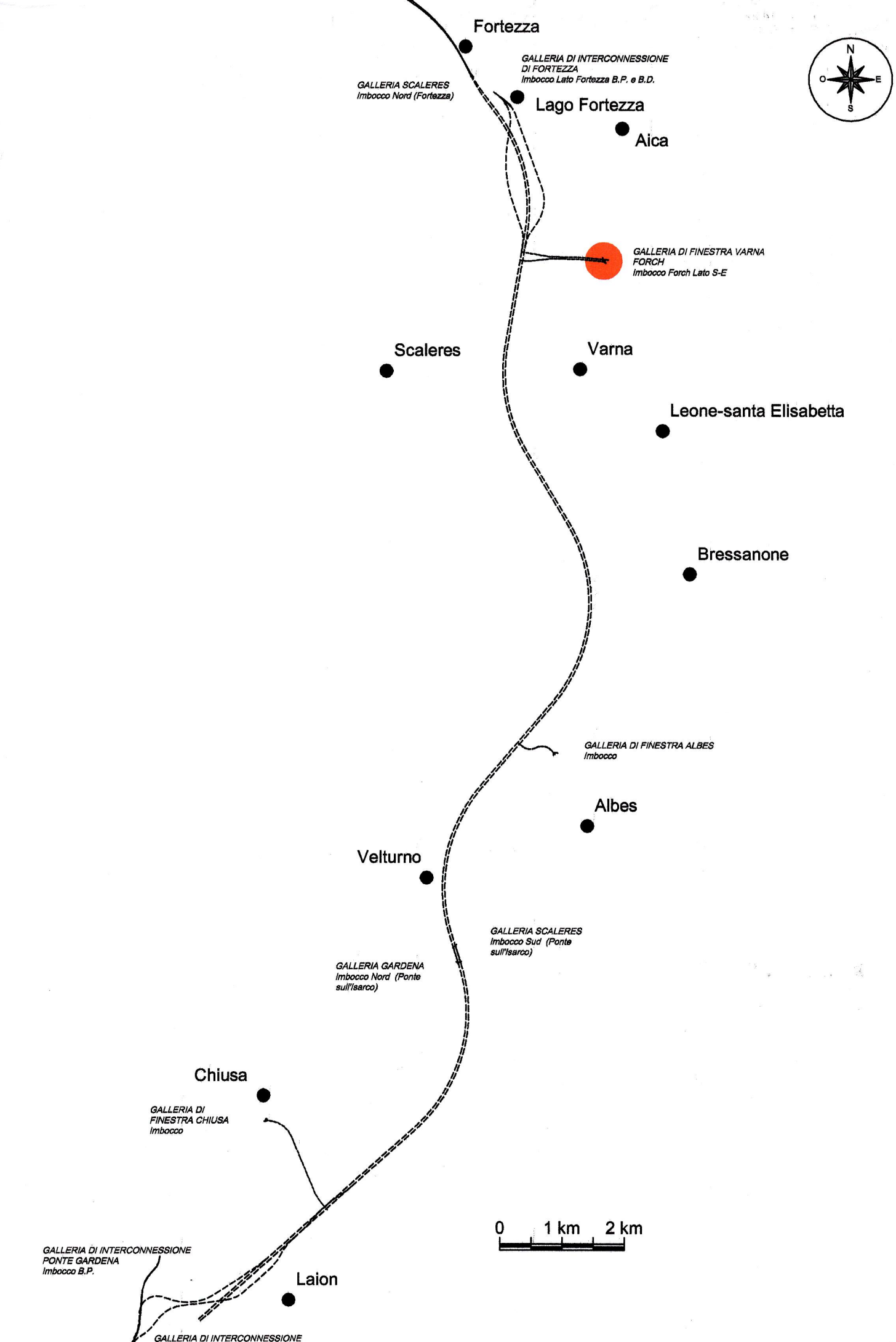
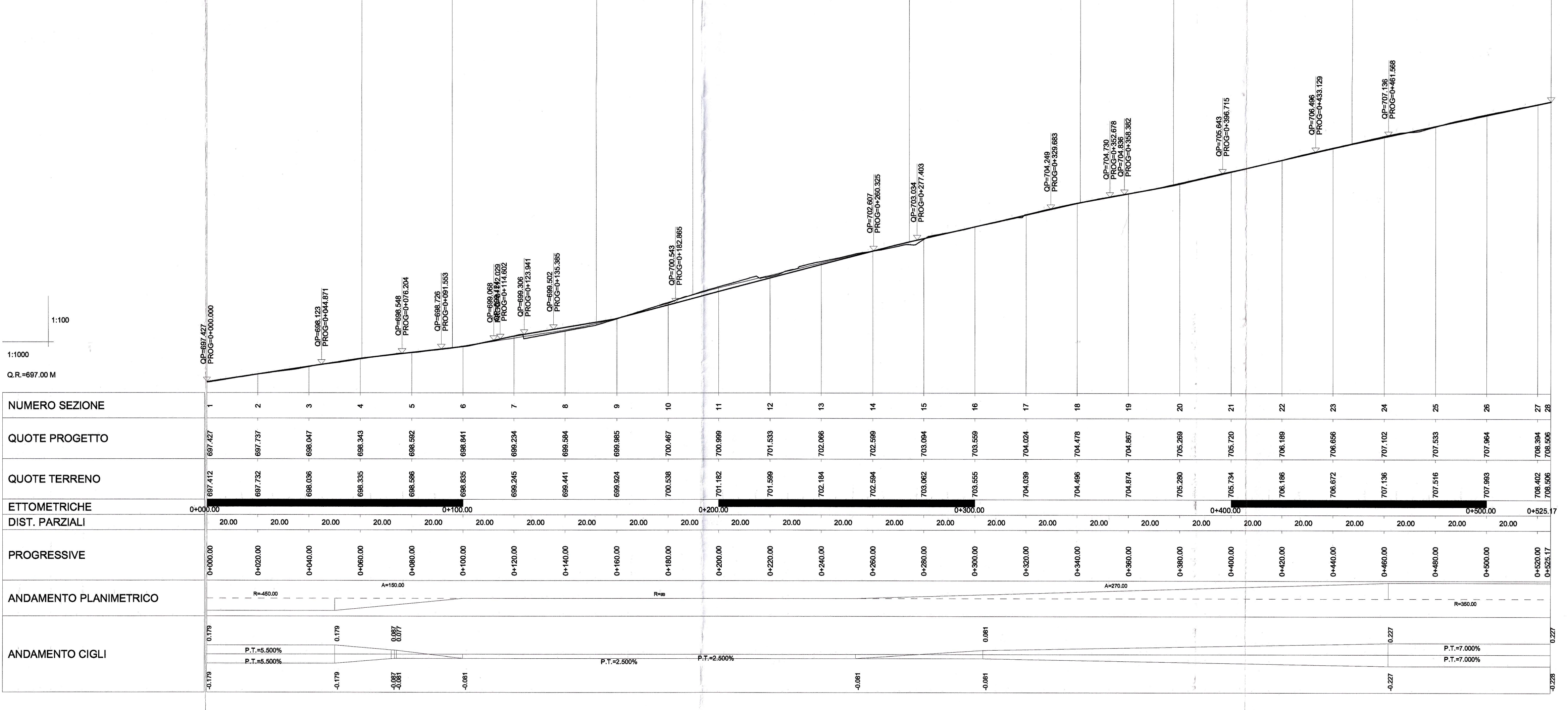

COMMITENTE: **RFI** GRUPPO FERROVIARIO ITALIANO

PROGETTAZIONE: **ITALFERR** GRUPPO FERROVIE DELLO STATO ITALIANO

**INFRASTRUTTURE FERROVIARIE STRATEGICHE DEFINITE DALLA LEGGE OBIETTIVO N. 443/01 e s.m.i**

Progetto cofinanziato dalla Unione Europea

CLP: J94F0400020001

**PRODUZIONE CENTRO - NORD**

**PROGETTO DEFINITIVO**

**ASSE FERROVIARIO MONACO - VERONA**

**ACCESSO SUD ALLA GALLERIA DI BASE DEL BRENNERO QUADRUPPLICAMENTO DELLA LINEA FORTEZZA - VERONA**

**LOTTO 1: FORTEZZA - PONTE GARDENA**

Viabilità di accesso area Forch da SS12 - Viabilità di accesso - Planimetria/profilo di tracciamento

SCALA: **VARIE**

COMMESSA	LOTTO	FASE	ENTE	TIPO DOC.	OPERA/DISCIPLINA	PROGR.	REV.
IBL1	10	D	26	PZ	NV0320	001	A

Rev.	Descrizione	Redatto	Data	Verificato	Data	Approvato	Data
A	EMMISSIONE		MAR.2013		MAR.2013		MAR.2013

File: ILL10003PZV032001A.DWG