

RETE DI EVACUAZIONE ACQUE DI PIATTAFORMA

SCHEMA IDRAULICO FOSSI DI GUARDIA

SCALA 1:3000

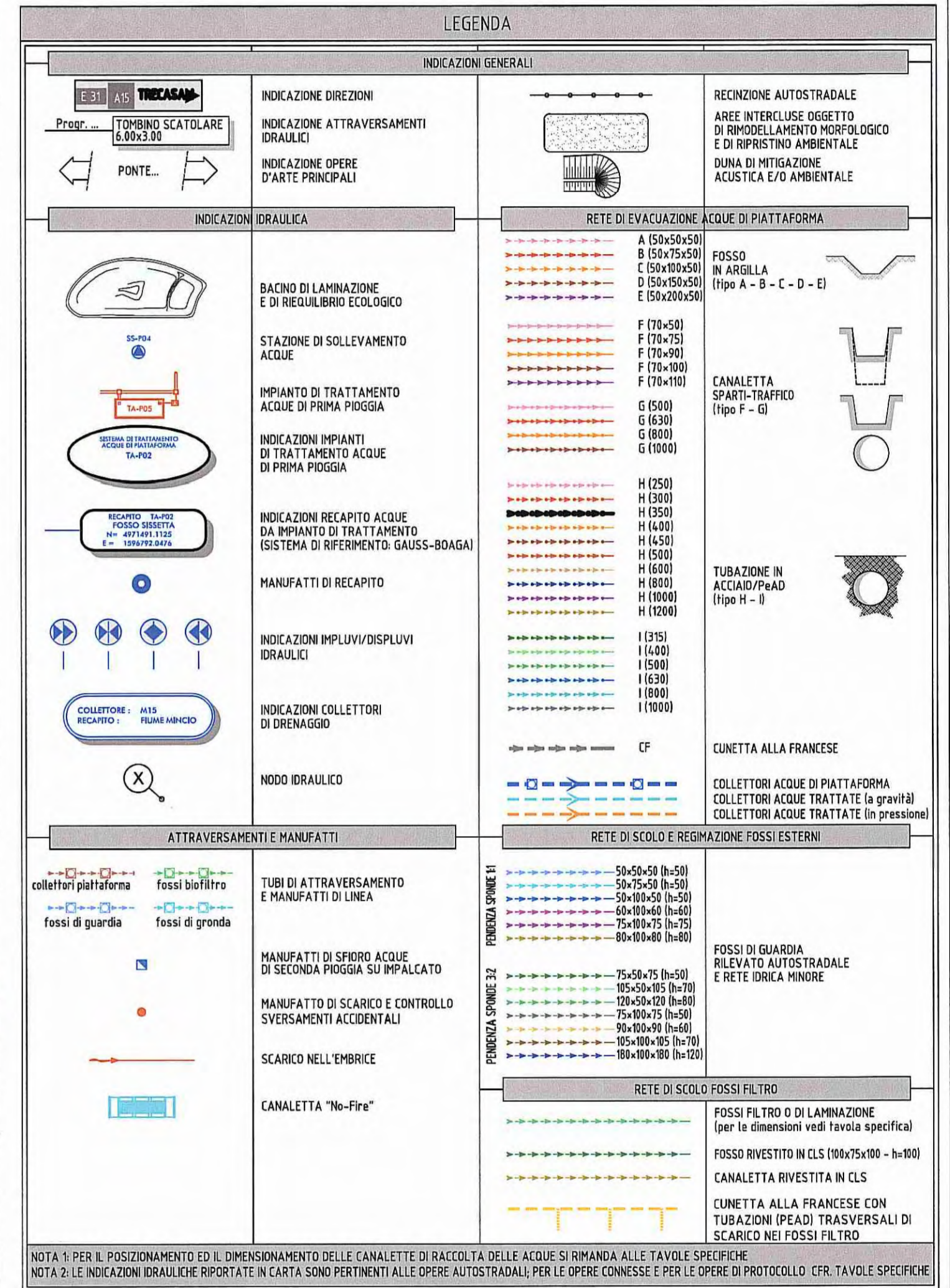
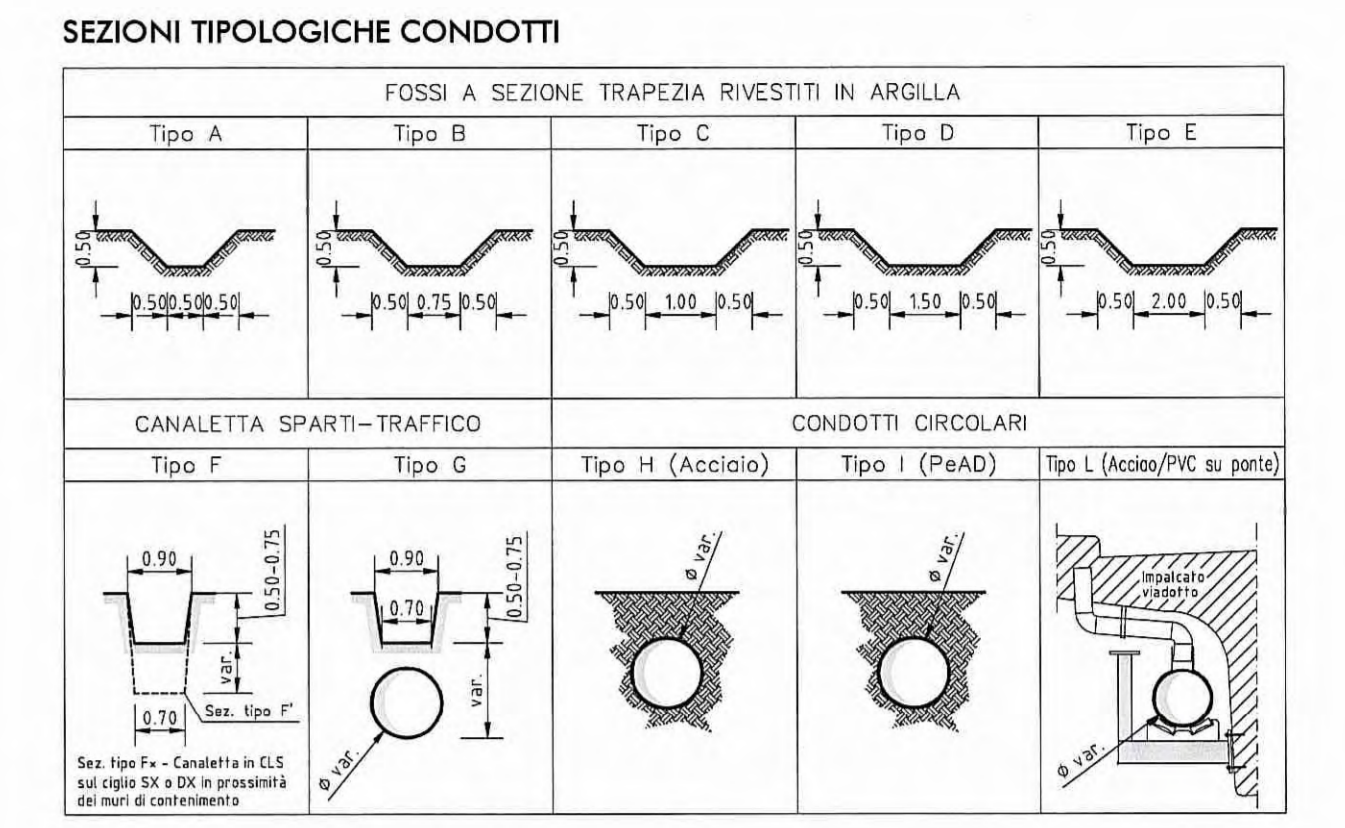
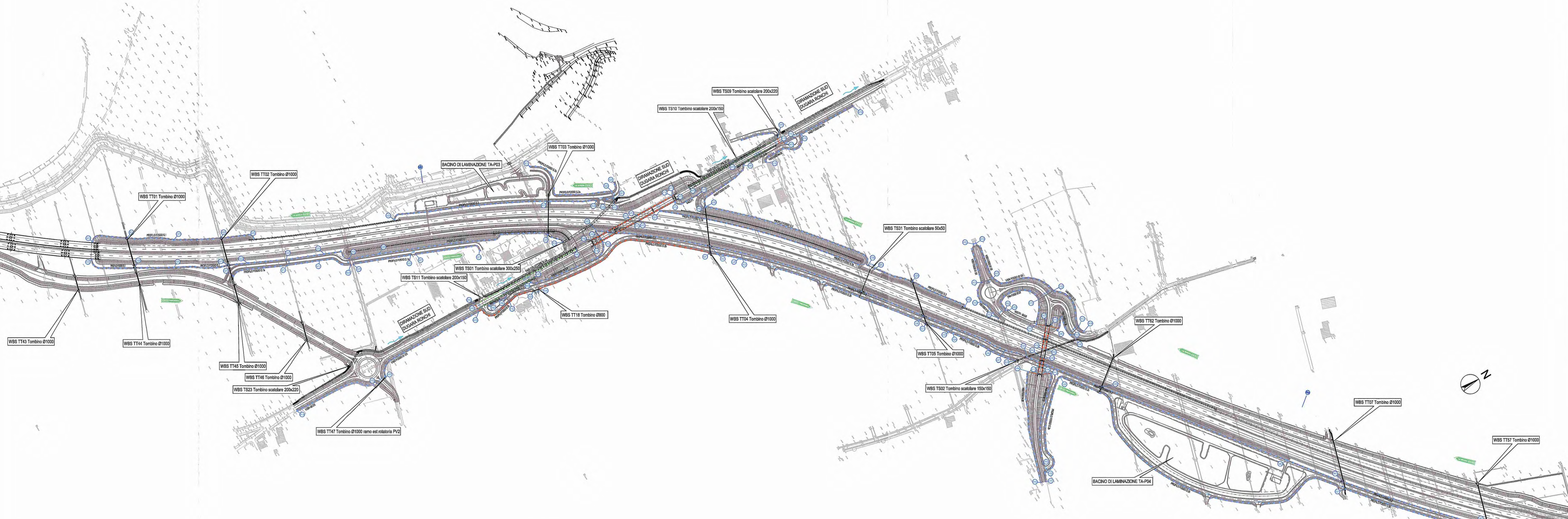

FOSSI-7

Tronco	nodo monte	nodo valle	L tronco (m)	Pendenza media (%)	A strada (m²)	A scarpata e fascia est. (m²)	A totale (m²)	tc (minuti)	Q ₅₀ (l/s)	U (l/s/ha)	Dimensioni opera (Strockler)	Ks (%)	i (%)	hu (m)	riemp (%)	v (m/s)
S2a	A219	A220	166.8	0.48	0	1,605	1,605	16	25	158	50x50x50	30	0.48	0.11	21	0.39
A221	A220	18.9	0.10	0	163	163	11	3	212	50x50x50	30	0.10	0.05	10	0.12	
A220	A222	12.6	0.10	0	1,767	1,767	16	28	158	50x50x50	30	0.10	0.19	32	0.36	
S1	A223	A224	72.8	0.10	0	946	946	12	18	190	50x50x50	30	0.10	0.14	28	0.21
A227	A224	86.3	0.10	0	906	906	13	17	185	50x50x50	30	0.10	0.14	28	0.21	
A227	A226	88.4	0.10	0	839	839	13	16	185	50x50x50	30	0.10	0.13	26	0.20	
A225	A228	81.4	0.10	0	583	583	12	11	194	50x50x50	30	0.10	0.11	22	0.18	

FOSSI-5

Tronco	nodo monte	nodo valle	L tronco (m)	Pendenza media (%)	A strada (m²)	A scarpata e fascia est. (m²)	A totale (m²)	tc (minuti)	Q ₅₀ (l/s)	U (l/s/ha)	Dimensioni opera (Strockler)	Ks (%)	i (%)	hu (m)	riemp (%)	v (m/s)
S2	A206	A207	289.5	0.10	1,158	5,066	6,224	20	106	171	50x50x50	30	0.10	0.37	74	0.33
A207	A208	87.8	0.20	351	1,537	1,888	13	43	228	50x50x50	30	0.20	0.19	38	0.34	
A208	A209	18.5	0.39	351	1,537	1,888	13	43	228	50x50x50	30	0.39	0.14	14	0.62	
A209	A210	17.5	1.03	422	1,844	2,266	11	59	282	50x50x50	30	1.03	0.14	28	0.68	

FOSSI-9

Tronco	nodo monte	nodo valle	L tronco (m)	Pendenza media (%)	A strada (m²)	A scarpata e fascia est. (m²)	A totale (m²)	tc (minuti)	Q ₅₀ (l/s)	U (l/s/ha)	Dimensioni opera (Strockler)	Ks (%)	i (%)	hu (m)	riemp (%)	v (m/s)
D2c	A158	A239	119.7	0.15	4,129	4,793	8,881	27	157	177	50x75x50	30	0.15	0.38	75	0.40
A239	A240	10.5	0.10	4,129	4,793	8,881	27	157	177	50x75x50	30	0.10	0.48	58	0.56	
A240	A241	341.5	0.12	5,495	7,485	12,959	38	174	134	50x75x50	30	0.12	0.39	79	0.40	
A242	A241	54.2	0.48	217	434	651	12	18	279	50x50x50	30	0.48	0.09	18	0.38	
A242	A243	363.6	0.44	1,454	2,909	4,363	22	79	181	50x50x50	30	0.44	0.21	42	0.53	
A244	A245	52.2	0.57	209	417	626	12	18	280	50x50x50	30	0.57	0.08	17	0.37	
A244	A245	127.1	0.46	508	1,017	1,525	14	37	245	50x50x50	30	0.46	0.14	27	0.43	

FOSSI-10

Tronco	nodo monte	nodo valle	L tronco (m)	Pendenza media (%)	A strada (m²)	A scarpata e fascia est. (m²)	A totale (m²)	tc (minuti)	Q ₅₀ (l/s)	U (l/s/ha)	Dimensioni opera (Strockler)	Ks (%)	i (%)	hu (m)	riemp (%)	v (m/s)
D2c	A246	A247	871.9	0.12	2,888	5,375	8,083	32	112	139	50x50x50	30	0.12	0.36	72	0.36
A247	A248	277.3	0.15	1,109	2,219	3,329	19	66	199	50x50x50	30	0.15	0.26	52	0.34	
A248	A249	178.2	0.16	713	1,426	2,139	16	48	227	50x50x50	30	0.16	0.21	43	0.32	
A249	A250	171.8	0.10	687	1,374	2,062	16	47	229	50x50x50	30	0.10	0.24	48	0.27	
A251	A250	28.1	0.60	112	225	337	11	10	294	50x50x50	30	0.60	0.06	12	0.31	
A251	A252	296.4	0.10	1,194	2,387	3,581	20	70	194	50x50x50	30	0.10	0.29	59	0.30	
D2c	A248	A150	200.0	0.10	800	1,600	2,400	17	53	220	50x50x50	30	0.10	0.25	51	0.28

FOSSI-3

Tronco	nodo monte	nodo valle	L tronco (m)	Pendenza media (%)	A strada (m²)	A scarpata e fascia est. (m²)	A totale (m²)	tc (minuti)	Q ₅₀ (l/s)	U (l/s/ha)	Dimensioni opera (Strockler)	Ks (%)	i (%)	hu (m)	riemp (%)	v (m/s)
D2	A31	A32	214.1	0.60	1,550	6,055	7,555	17	145	191	50x50x50	30	0.60	0.27	55	0.70
A32	A33	53.5	0.54	0	535	535	12	11	197	50x50x50	30	0.54	0.07	13	0.32	
A33	A34	61.0	0.42	0	810	810	12	12	194	50x50x50	30	0.42	0.07	15	0.30	
A34	A36	88.4	1.12	0	884	884	13	16	185	50x50x50	30	1.12	0.08	16	0.33	
A36	A37	14.9	0.10	0	1,033	1,033	13	19	180	50x50x50	30	0.10	0.17	27	0.33	
A37	A38	34.8	0.10	0	1,381	1,381	15	23	170	50x50x50	30	0.10	0.16	33	0.22	
A38	A39	156.3	0.34	0	1,583	1,583	18	28	165	50x50x50	30	0.34	0.18	33	0.24	
A39	A40	383.1	0.10	0	3,631	3,631	22	46	128	50x50x50	30	0.10	0.24	48	0.27	
A40	A41	110.4	1.08	0	1,988	1,988	14	35	178	50x50x50	30	1.08	0.10	21	0.57	
A41	A42	276.4	0.24	0	4,145	4,145	19	58	141	50x50x50	30	0.24	0.21	42	0.39	
A42	A43	178.2	0.15	0	2,673	2,673	16	43	160	50x50x50	30	0.15	0.20	40	0.30	
A43	A44	173.1	0.11	0	2,596	2,596	16	42	161	50x50x50	30	0.11	0.22	44	0.27	
A44	A45	326.9	0.10	0	4,904	4,904	21	65	133	50x50x50	30	0.10	0.28	55	0.30	
A45	A46	69.6	0.10	0	1,044	1,044	12	20	191	50x50x50	30	0.10	0.14	29	0.22	
A46	A47	248.1	0.10	0	4,342	4,342	18	63	146	50x50x50	30	0.10	0.28	55	0.30	
A47	A47	32.2	0.19	0	564	564	11	12	206	50x50x50	30	0.19	0.09	18	0.23	
A48	A49	32.9	0.31	0	5,776	5,776	21	77	134	50x50x50	30	0.17	0.27	54	0.37	
A49	A50	236.8	0.10	0	3,789	3,789	18	56	148	50x50x50	30	0.10	0.28	52	0.28	

FOSSI-11

Tronco	nodo monte	nodo valle	L tronco (m)	Pendenza media (%)	A strada (m²)	A scarpata e fascia est. (m²)	A totale (m²)	tc (minuti)	Q ₅₀ (l/s)	U (l/s/ha)	Dimensioni opera (Strockler)	Ks (%)	i (%)	hu (m)	riemp (%)	v (m/s)
S3a	A253	A254	393.1	0.16	0	5,440	5,440	30	57	105	50x50x50	30	0.16	0.23	46	0.33
S3	A255	A254	323.0	0.21	0	6,138	6,138	24	75	122	50x50x50	30	0.21	0.25	50	0.40
A254	A254a	13.7	0.97	0	11,576	11,576	30	120	104	50x50x50	50	0.97	0.25	50	1.23	
A254a	A256	73.2	0.97	0	12,966	12,966	31	130	101	50x50x50	30	0.97	0.22	45	0.81	
A256	A123	132.7	0.10	0	1,327	1,327	21	18	133	50x50x50	30	0.10	0.14	27	0.20	

FOSSI-8

Tronco	nodo monte	nodo valle	L tronco (m)	Pendenza media (%)	A strada (m²)	A scarpata e fascia est. (m²)	A totale (m²)	tc (minuti)	Q ₅₀ (l/s)	U (l/s/ha)	Dimensioni opera (Strockler)	Ks (%)	i (%)	hu (m)	riemp (%)	v (m/s)
D1	A228	A229	87.0	0.10	0	1,783	1,783	13	33	185	50x50x50	30	0.10	0.10	28	0.21
A229	A229	71.7	0.10	0	932	932	12	18	190	50x50x50	30	0.10	0.14	28	0.21	
A230	A231	101.7	0.24	0	1,678	1,678	13	30	160	50x50x50	30	0.24	0.15	30	0.33	
A231	A231	35.4	0.83	0	586	586	11	12	204	50x50x50	30	0.83	0.06	12	0.38	
A232	A233	69.0	0.54	0	1,132	1,132	12	22	191	50x50x50	30	0.54	0.10	20	0.39	
A234	A233	72.2	0.31	0	1,177	1,177	12	22	190	50x50x50	30	0.31	0.11	22	0.32	
A233	A212	11.5	0.10	0	2,309	2,309	12	44	190	50x50x50	30	0.10	0.24	40	0.40	
A234	A235	53.0	0.45	0	922	922	12	18	197	50x50x50	30	0.45	0.09	18	0.34	
A236	A235	56.2	0.26	0	1,050	1,050	12	21	196	50x50x50	30	0.26	0.12	23	0.30	
A235	A214	13.1	0.10	0	1,972	1,972	12	39	196	50x50x50	30	0.10	0.23	38	0.40	
A236	A237	317.5	0.26	0	4,763	4,763	21	64	134	50x50x50	30	0.26	0.21	42	0.42	
A237	A238	35.1	0.25	0	1,156	10,471	11,629	22	189	145	50x50x50	30	0.25	0.37	74	0.53

FOSSI-6

Tronco	nodo monte	nodo valle	L tronco (m)	Pendenza media (%)	A strada (m²)	A scarpata e fascia est. (m²)	A totale (m²)	tc (minuti)	Q ₅₀ (l/s)	U (l/s/ha)	Dimensioni opera (Strockler)	Ks (%)	i (%)	hu (m)	riemp (%)	v (m/s)
D1a	A211	A212	105.6	0.10	0	1,330	1,330	14	33	250	50x50x50	30	0.10	0.20	40	0.25
A213</																