

Km. = Chilotometric principale
 ● 100.00 = Etlometrica
 ● 756.228 = Progressiva elementi planimetrici

DATI CLOTODI		DATI VERTICI		DATI RACCORDI	
Parametro A	Ve	Vertice esterno	C3	Centro della curva	
Sv(m)	Vi	Vertice interno	Ve	Vertice esterno	
Td(d)	Angolo di deviazione	Coordinate rettilinea/cercle	Vertice esterno-interno	Eln(-Nln)	Coordinate centro curva-vertice esterno
Dr(m)	Scostamento	Eln(-Nln)	Vertice esterno-interno	Eln(-Nln)	Coordinate centro curva-vertice esterno
Tl(m)	Tangente lunga	Hln(-F2ln)	Vertice esterno-interno	Rln	Raggio
TK(m)	Tangente corta	Coordinate relative punto finale	Tangenti	Alc	Deviazione
Xf(m)-Yf(m)	Coordinate relative punto finale	Tangenti	Tl(m)	Alc	Deviazione
R(m)	Raggio	Raggio	Sv(m)	Frl(m)	Frazione

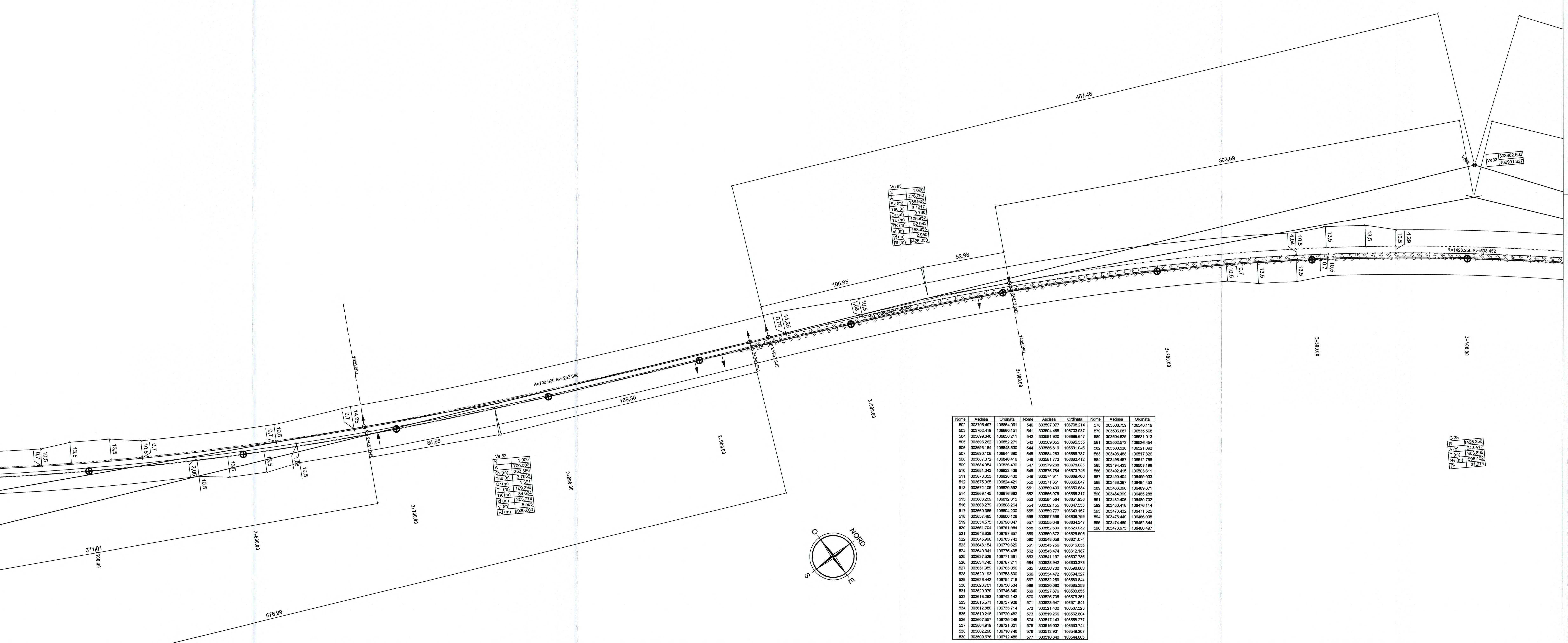

Ve 83

N	1.000
A	478.062
Sv (m)	1.58.000
Tau (g)	3.1917
Dr (m)	0.738
Tl (m)	1105.963
TK (m)	82.983
Xf (m)	158.853
Yf (m)	2.950
Rf (m)	428.250

Ve 82

N	1.000
A	1700.000
Sv (m)	2.53.886
Tau (g)	3.7695
Dr (m)	1.391
Tl (m)	169.286
TK (m)	84.894
Xf (m)	253.775
Yf (m)	8.565
Rf (m)	890.000

Nome	Assees	Ordinate	Nome	Assees	Ordinate	Nome	Assees	Ordinate
502	303705.487	109864.291	540	303587.077	109708.214	576	303508.798	109640.118
503	303702.419	109861.151	541	303584.488	109703.837	578	303506.897	109638.588
504	303699.340	109858.211	542	303581.820	109699.847	580	303504.822	109637.013
505	303696.262	109855.271	543	303579.355	109696.355	581	303502.572	109635.454
506	303693.184	109852.330	544	303576.819	109692.846	582	303500.326	109633.892
507	303690.106	109849.390	545	303574.283	109689.337	583	303498.080	109632.326
508	303687.027	109846.449	546	303571.773	109685.812	584	303495.827	109630.758
509	303683.948	109843.508	547	303569.288	109682.288	585	303493.433	109629.186
510	303680.869	109840.567	548	303566.819	109678.746	586	303491.039	109627.614
511	303677.790	109837.626	549	303564.354	109675.204	587	303488.645	109626.042
512	303674.711	109834.685	550	303561.889	109671.662	588	303486.251	109624.470
513	303671.632	109831.744	551	303559.424	109668.120	589	303483.857	109622.898
514	303668.553	109828.803	552	303556.959	109664.578	590	303481.463	109621.326
515	303665.474	109825.862	553	303554.494	109661.036	591	303479.069	109619.754
516	303662.395	109822.921	554	303552.029	109657.494	592	303476.675	109618.182
517	303659.316	109820.000	555	303549.564	109653.952	593	303474.281	109616.610
518	303656.237	109817.059	556	303547.099	109650.410	594	303471.887	109615.038
519	303653.158	109814.118	557	303544.634	109646.868	595	303469.493	109613.466
520	303650.079	109811.177	558	303542.169	109643.326	596	303467.099	109611.894
521	303647.000	109808.236	559	303539.704	109639.784	597	303464.705	109610.322
522	303643.921	109805.295	560	303537.239	109636.242	598	303462.311	109608.750
523	303640.842	109802.354	561	303534.774	109632.700	599	303459.917	109607.178
524	303637.763	109799.413	562	303532.309	109629.158	600	303457.523	109605.606
525	303634.684	109796.472	563	303529.844	109625.616	601	303455.129	109604.034
526	303631.605	109793.531	564	303527.379	109622.074	602	303452.735	109602.462
527	303628.526	109790.590	565	303524.914	109618.532	603	303450.341	109600.890
528	303625.447	109787.649	566	303522.449	109614.990	604	303447.947	109599.318
529	303622.368	109784.708	567	303520.000	109611.448	605	303445.553	109597.746
530	303619.289	109781.767	568	303517.535	109607.906	606	303443.159	109596.174
531	303616.210	109778.826	569	303515.070	109604.364	607	303440.765	109594.602
532	303613.131	109775.885	570	303512.605	109600.822	608	303438.371	109593.030
533	303610.052	109772.944	571	303510.140	109597.280	609	303435.977	109591.458
534	303606.973	109770.003	572	303507.675	109593.738	610	303433.583	109589.886
535	303603.894	109767.062	573	303505.210	109590.196	611	303431.189	109588.314
536	303600.815	109764.121	574	303502.745	109586.654	612	303428.795	109586.742
537	303597.736	109761.180	575	303500.280	109583.112	613	303426.401	109585.170
538	303594.657	109758.239	576	303497.815	109579.570	614	303424.007	109583.598
539	303591.578	109755.298	577	303495.350	109576.028	615	303421.613	109582.026
540	303588.499	109752.357	578	303492.885	109572.486	616	303419.219	109580.454
541	303585.420	109749.416	579	303490.420	109568.944	617	303416.825	109578.882
542	303582.341	109746.475	580	303487.955	109565.402	618	303414.431	109577.310
543	303579.262	109743.534	581	303485.490	109561.860	619	303412.037	109575.738
544	303576.183	109740.593	582	303483.025	109558.318	620	303409.643	109574.166
545	303573.104	109737.652	583	303480.560	109554.776	621	303407.249	109572.594
546	303570.025	109734.711	584	303478.095	109551.234	622	303404.855	109571.022
547	303566.946	109731.770	585	303475.630	109547.692	623	303402.461	109569.450
548	303563.867	109728.829	586	303473.165	109544.150	624	303400.067	109567.878
549	303560.788	109725.888	587	303470.700	109540.608	625	303397.673	109566.306
550	303557.709	109722.947	588	303468.235	109537.066	626	303395.279	109564.734
551	303554.630	109720.006	589	303465.770	109533.524	627	303392.885	109563.162
552	303551.551	109717.065	590	303463.305	109529.982	628	303390.491	109561.590
553	303548.472	109714.124	591	303460.840	109526.440	629	303388.097	109560.018
554	303545.393	109711.183	592	303458.375	109522.898	630	303385.703	109558.446
555	303542.314	109708.242	593	303455.910	109519.356	631	303383.309	109556.874
556	303539.235	109705.301	594	303453.445	109515.814	632	303380.915	109555.302
557	303536.156	109702.360	595	303450.980	109512.272	633	303378.521	109553.730
558	303533.077	109699.419	596	303448.515	109508.730	634	303376.127	109552.158
559	303530.000	109696.478	597	303446.050	109505.188	635	303373.733	109550.586
560	303526.921	109693.537	598	303443.585	109501.646	636	303371.339	109549.014
561	303523.842	109690.596	599	303441.120	109498.104	637	303368.945	109547.442
562	303520.763	109687.655	600	303438.655	109494.562	638	303366.551	109545.870
563	303517.684	109684.714	601	303436.190	109491.020	639	303364.157	109544.298
564	303514.605	109681.773	602	303433.725	109487.478	640	303361.763	109542.726
565	303511.526	109678.832	603	303431.260	109483.936	641	303359.369	109541.154
566	303508.447	109675.891	604	303428.795	109480.394	642	303356.975	109539.582
567	303505.368	109672.950	605	303426.330	109476.852	643	303354.581	109538.010
568	303502.289	109670.009	606	303423.865	109473.310	644	303352.187	109536.438
569	303499.210	109667.068	607	303421.400	109469.768	645	303349.793	109534.866
570	303496.131	109664.127	608	303418.935	109466.226	646	303347.399	109533.294
571	303493.052	109661.186	609	303416.470	109462.684	647	303345.005	109531.722
572	303490.000	109658.245	610	303414.005	109459.142	648	303342.611	109530.150
573	303486.919	109655.304	611	303411.540	109455.600	649	303340.217	109528.578
574	303483.838	109652.363	612	303409.075	109452.058	650	303337.823	109527.006
575	303480.757	109649.422	613	303406.610	109448.516	651	303335.429	109525.434
576	303477.676	109646.481	614	303404.145	109444.974	652	303333.035	109523.862
577	303474.595	109643.540	615	303401.680	109441.432	653	303330.641	109522.290
578	303471.514	109640.599	616	303399.215	109437.890	654	303328.247	109520.718
579	303468.433	109637.658	617	303396.750	109434.348	655	303325.853	109519.146
580	303465.352	109634.717	618	303394.285	109430.806	656	303323.459	109517.574
581	303462.271	109631.776	619	303391.820	109427.264	657	303321.065	109516.002
582	303459.190	109628.835	620	303389.355	109423.722	658	303318.671	109514.430
583	303456.109	109625.894	621	303386.890	109420.180	659	303316.277	109512.858
584	303453.028	109622.953	622	303384.425	109416.638	660	303313.883	109511.286
585	303450.000	109620.012	623	303381.960	109413.096	661	303311.489	109509.714
586	303446.921	109617.071	624	303379.495	109409.554	662	303309.095	109508.142
587	303443.840	109614.130	625	303377.030	109406.012	663	303306.701	109506.570
588	303440.759	109611.189	626	303374.565	109402.470	664	303304.307	109505.000
589	303437.678	109608.248	627	303372.100	109398.928	665	303301.913	109503.428
590	303434.597	109605.307	628	303369.635	109395.386	666	303299.519	109501.856
591	303431.516	109602.366	629	303367.170	109391.844	667	303297.125	10950