

SCHNITT 1-1 / SEZIONE 1-1

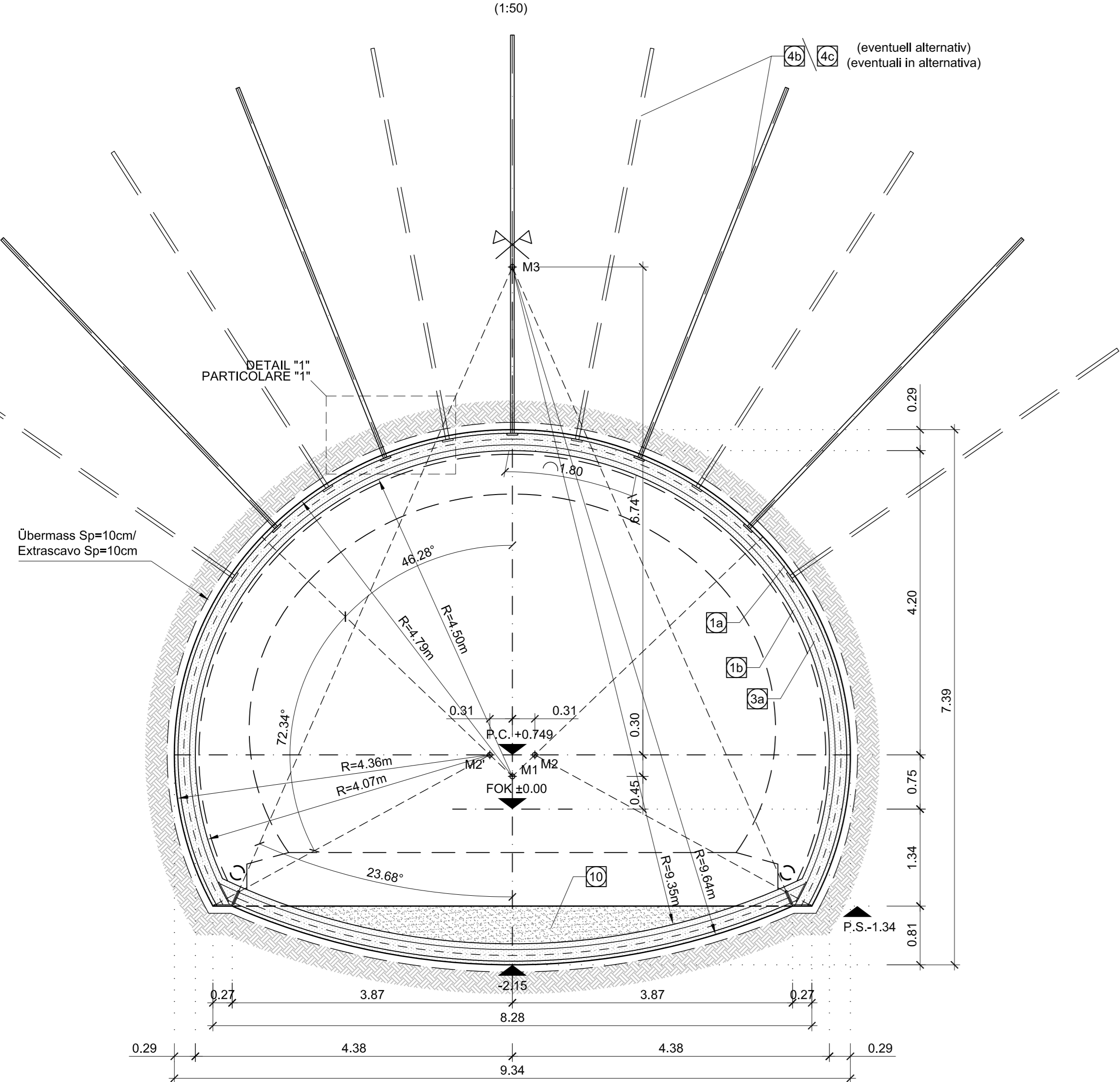

KOORDINATEN / COORDINATE	
PTN	X
M1	0,000
M2	0,311
M3	0,000

SCHNITT MIT SCHEMA DER EVENTUELLEN FESIGUNGSEINGRIFFE AN DER ORTSBRUST
SEZIONE CON SCHEMA TRACCIAMENTO INTERVENTI DI CONSOLIDAMENTO AL FRONTE EVENTUALI

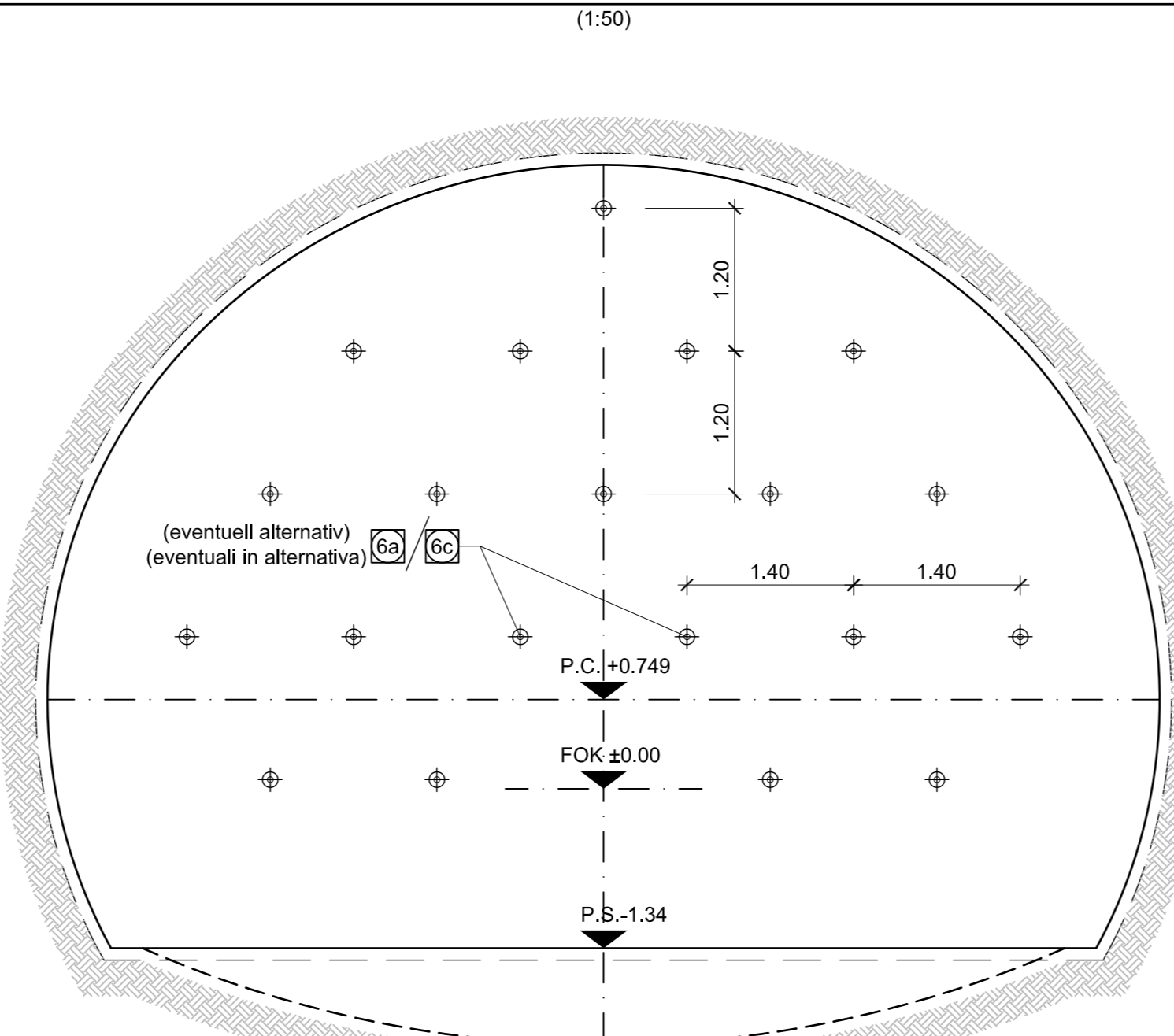

LÄNGSABLAUF / SVILUPPO LONGITUDINALE
GESTALTUNG MIT EINSEITIGE NEIGUNG/
CONFIGURAZIONE MONOPENDENZA

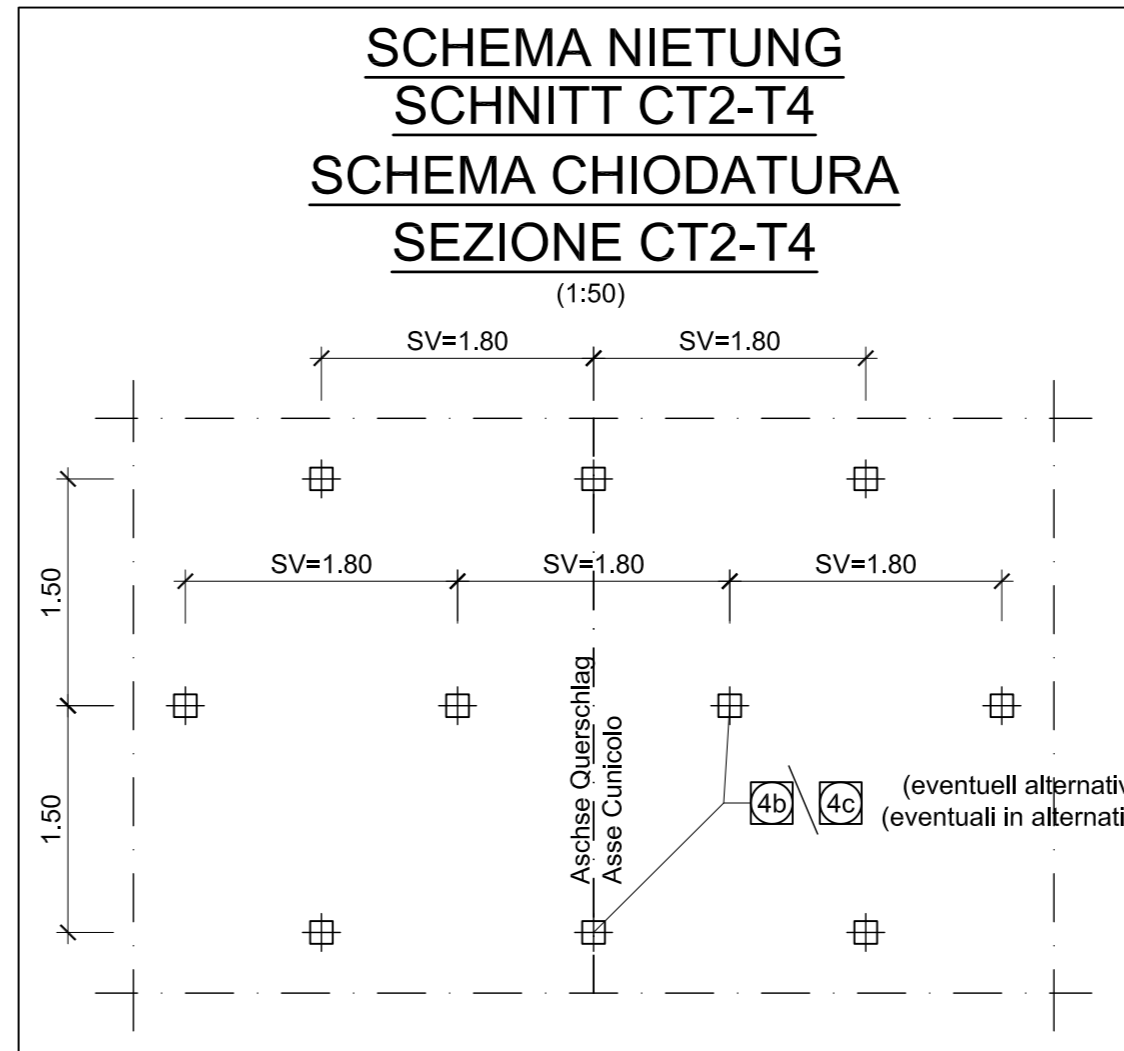
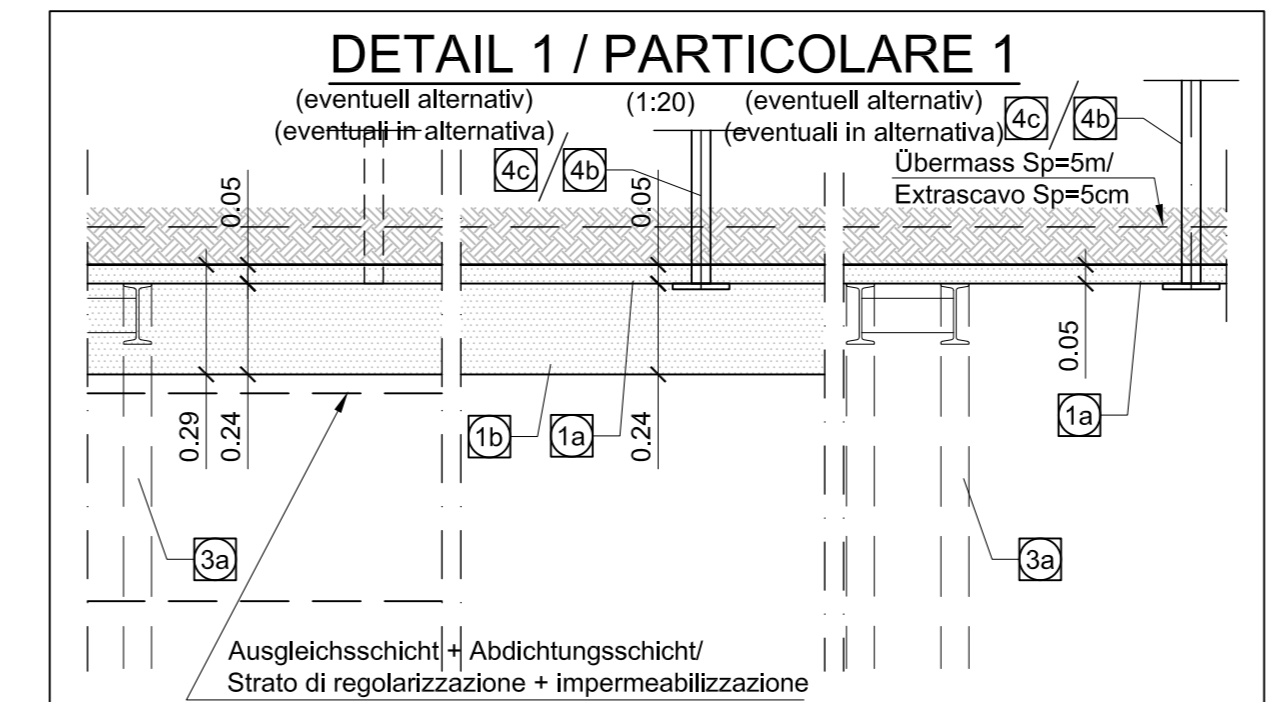
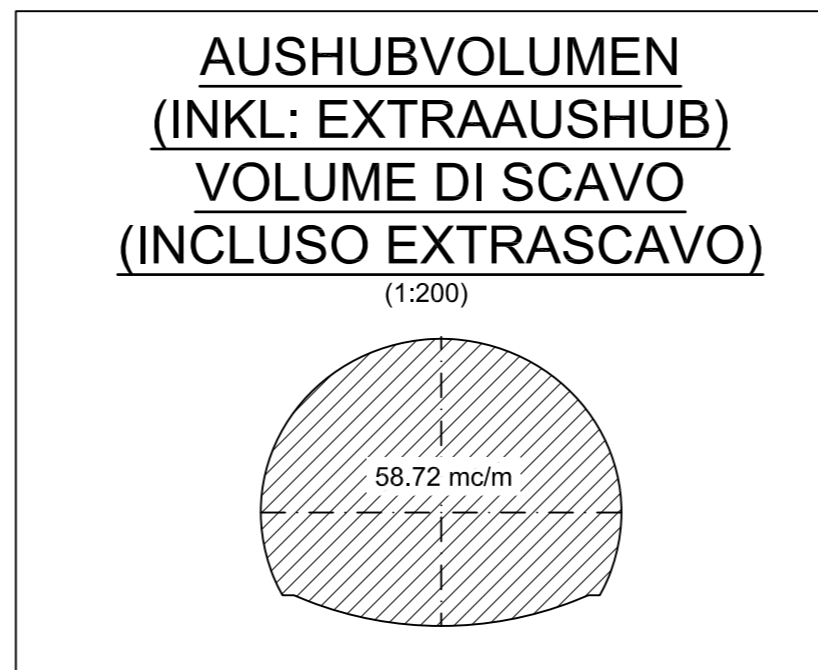
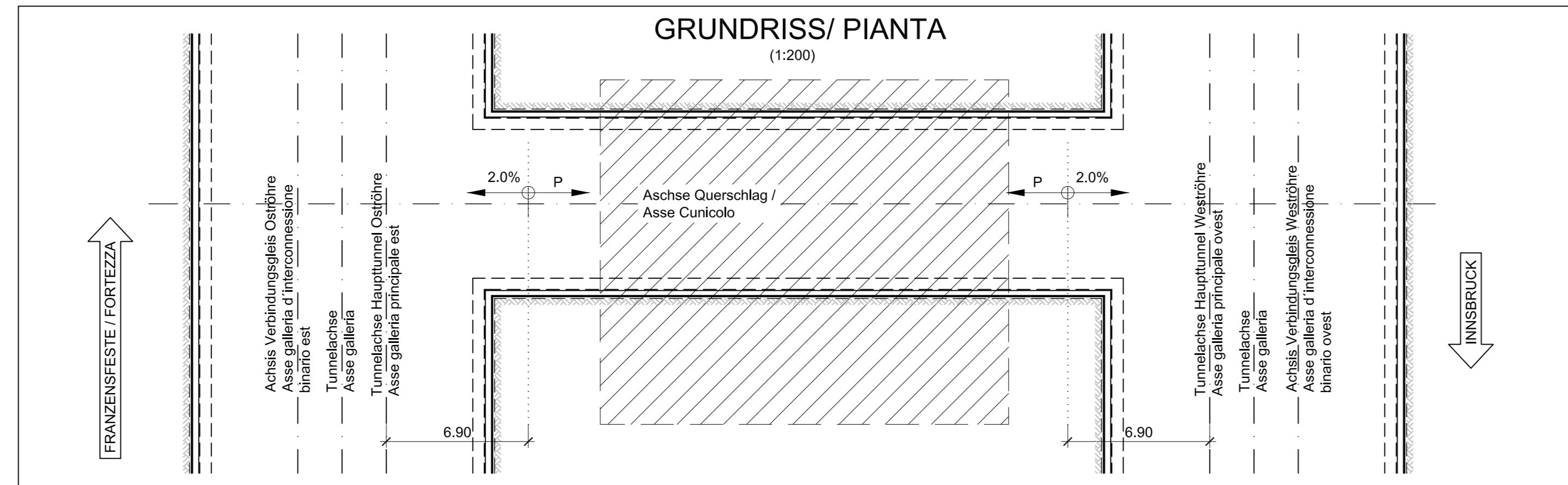
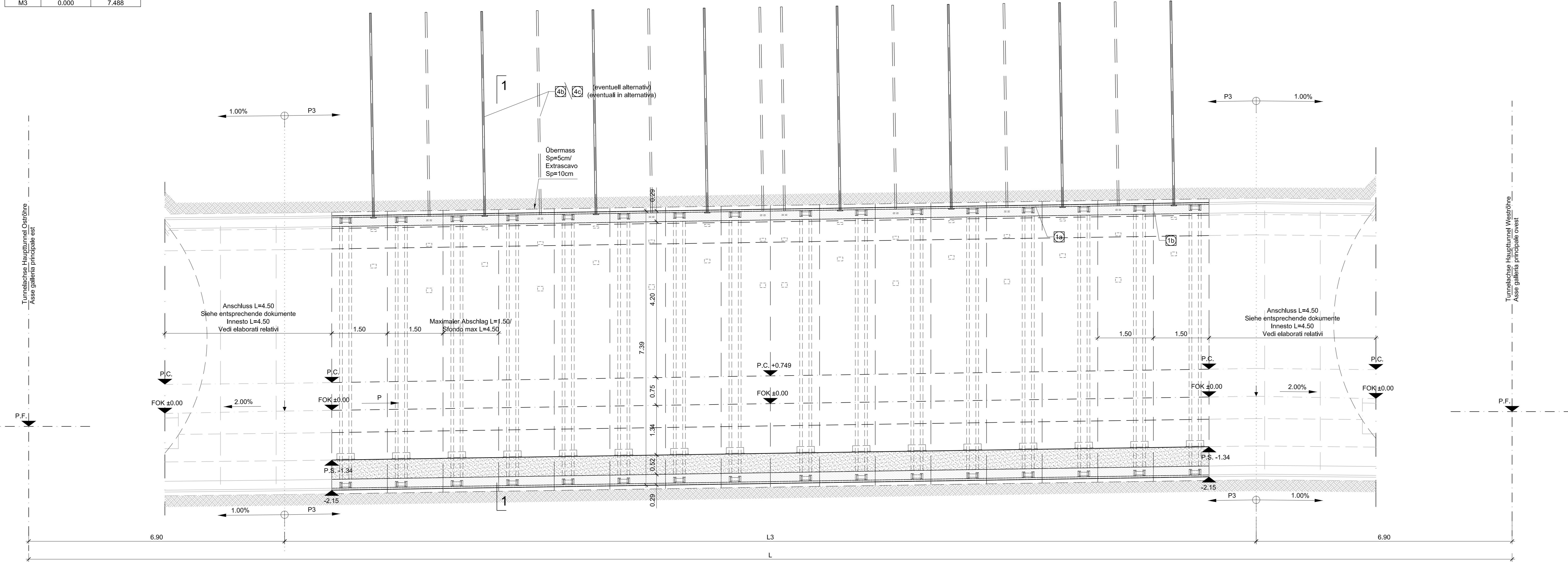

Bereich Campo	Spezifikation Specificazione	Einheit Unità	Querschnitt CT2-T4 / Sezione tipo CT2-T4	
			Beschreibung Descrizione	Menge / m Tunnel Quantità per m di galleria
Aushub Scavo	Abschlaglänge Lunghezza di abbattimento	-	-	1,5m
	Übermass / Estrascavo Volume di sovrappiombatura	m³	-	55,96
Bekleidung Pavimentazione	Faserbeton Beton con fibre	m²	Faserbeton Typ R200 Beton con fibre	26,30-25,29
	Ausbauarbeiten / Scaffalung Anelli di ancoraggio	m	2 Profile IPN 160 aus Stahl S235JR 2 profile IPN 160 in acciaio S235JR	25,45
Ordnungsbauwerk Struttura di sostegno	Faserbeton Beton con fibre	m²	Faserbeton Typ R200 Beton con fibre	37,31
	Stahlbeton Beton armato	m³	Beton armato Beton con ferro	27,58
Ordnungsbauwerk Struttura di sostegno	Faserbeton Beton con fibre	m²	Faserbeton Typ R200 Beton con fibre	3,33
	Stahlbeton Beton armato	m³	Beton armato Beton con ferro	6,67

	P3	L (m)	L3 (m)
Querschnitt / Caricatura trasversale di collegamento S4/1	2,814%	40,000	26,200
Querschnitt / Caricatura trasversale di collegamento S4/1a	2,796%	40,000	26,200

BEMERKUNGEN

- DAS REGELPROFIL "CT2-T4" WIRD INENKATIV MIT RHM-WERT "41" ANGEBOHRHT.
- DIE ANORDNUNG DER ANKER KANN ANHAND DER VOR ORT ANGETROFFENEN GEOMECHANISCHEN BEDINGUNGEN VARIEREN.
- BEI EINER LANG ANHALTENDE VORBEREITUNG MÜSSEN AN DER ORTSBRUST EINE STAHLFASERBEWEHRTE SPRITZBETONSCHICHT VON MINDESTENS 10CM DICKE AUFGETRAGEN WERDEN.
- HINZU FÜR JEDE ANKERSTELLE MÜSSEN AN DER ORTSBRUST EINE STAHLFASERBEWEHRTE SPRITZBETONSCHICHT VON MINDESTENS 10CM DICKE AUFGETRAGEN WERDEN.
- DIE AUSFÜHRUNG VON VERANKERUNGEN BEZUGNEHMEND AUF DIE INSTABILE FLÄCHE.
- DIE VERANKERUNGSDÄRMUNG DER ORTSBRUST MÜSSEN DIE VERANKERUNGSDÄRMUNG GROSSESTENS 1% DES AUSBRUCHRADIUS (R) SEIN.
- DIE GEOMETRIE DER AUSBRUCHSCHNITTE WERDEN UNTER BERÜCKSICHTIGUNG EINES SCHNITTENDECKUNGSPAKETES (DCH AUSGLEICHSCHICHT + 2CM ABDICHTUNG) DEFINIERT.
- ALTERNATIV ZU DEN STAHLFASERBEWEHRTE NETZBEWEHRUNGEN MIT WIDERSTANDSMOMENT 2 ALS DIE DER LEISTUNGSGREISE ANGEWENDET WERDEN.
- DIE VERANKERUNGSDÄRMUNG MÜSSEN MINDESTENS 1 FELD VOR DER AUSBRUCHFRONT, WELCHE VON DER BEWEHRUNGSDÄRMUNG RECHNUNG ABGEBEN, ÜBERBRÜCKEN WERDEN.

BAUPHASEN

1- AUSFÜHRUNG DER EVENTUELLEN VORBEREITUNGSARBEITEN AN DER ORTSBRUST (ALLE 24 ABSCHLAG) NACH VORBEREITUNG ABBRUCH VON FASERBEWEHRTE SPRITZBETON AN DER ORTSBRUST (10cm).
2- AUSFÜHRUNG DER ANKERSTELLE MIT ZUSÄTZLICHE MECHANISCHES MITTEL, UNTER DER ORTSBRUST UND AM ANKER.
3- LEISTUNGSGREISE AN DER ORTSBRUST UND AN DER ORTSBRUST UND AM ANKER.
4- AUSFÜHRUNG DER FASERBEWEHRTE SPRITZBETONSCHICHT (24cm).
5- AUFFÜLLUNG DER TRITTLÄCHE.
6- AUSFÜHRUNG ABDICHTUNG UND INNENSCHALE.

LEGENDE

- P.C. = EBENE DER KRÖNENZENTREN
- F.F. = EBENE DER FASERBEWEHRTE
- FOK = KOTE BOCKENNIVEAU QUERVERBINDUNG
- P.S. = AUSBRUCHSCHEITEL

MATERIALEIGENSCHAFTEN UND TECHNISCHE SPEZIFIKATIONEN

1- SPRITZBETON MIT STAHLFASERBEWEHRTE
Schriftzeichen: CFSpC 3037, Dicke: S(1a) + 24(1a) cm.
Eigenschaften: K23, K33, K43, K53, K63, K73, K83, K93, K103, K113, K123, K133, K143, K153, K163, K173, K183, K193, K203, K213, K223, K233, K243, K253, K263, K273, K283, K293, K303, K313, K323, K333, K343, K353, K363, K373, K383, K393, K403, K413, K423, K433, K443, K453, K463, K473, K483, K493, K503, K513, K523, K533, K543, K553, K563, K573, K583, K593, K603, K613, K623, K633, K643, K653, K663, K673, K683, K693, K703, K713, K723, K733, K743, K753, K763, K773, K783, K793, K803, K813, K823, K833, K843, K853, K863, K873, K883, K893, K903, K913, K923, K933, K943, K953, K963, K973, K983, K993, K1003, K1013, K1023, K1033, K1043, K1053, K1063, K1073, K1083, K1093, K1103, K1113, K1123, K1133, K1143, K1153, K1163, K1173, K1183, K1193, K1203, K1213, K1223, K1233, K1243, K1253, K1263, K1273, K1283, K1293, K1303, K1313, K1323, K1333, K1343, K1353, K1363, K1373, K1383, K1393, K1403, K1413, K1423, K1433, K1443, K1453, K1463, K1473, K1483, K1493, K1503, K1513, K1523, K1533, K1543, K1553, K1563, K1573, K1583, K1593, K1603, K1613, K1623, K1633, K1643, K1653, K1663, K1673, K1683, K1693, K1703, K1713, K1723, K1733, K1743, K1753, K1763, K1773, K1783, K1793, K1803, K1813, K1823, K1833, K1843, K1853, K1863, K1873, K1883, K1893, K1903, K1913, K1923, K1933, K1943, K1953, K1963, K1973, K1983, K1993, K2003, K2013, K2023, K2033, K2043, K2053, K2063, K2073, K2083, K2093, K2103, K2113, K2123, K2133, K2143, K2153, K2163, K2173, K2183, K2193, K2203, K2213, K2223, K2233, K2243, K2253, K2263, K2273, K2283, K2293, K2303, K2313, K2323, K2333, K2343, K2353, K2363, K2373, K2383, K2393, K2403, K2413, K2423, K2433, K2443, K2453, K2463, K2473, K2483, K2493, K2503, K2513, K2523, K2533, K2543, K2553, K2563, K2573, K2583, K2593, K2603, K2613, K2623, K2633, K2643, K2653, K2663, K2673, K2683, K2693, K2703, K2713, K2723, K2733, K2743, K2753, K2763, K2773, K2783, K2793, K2803, K2813, K2823, K2833, K2843, K2853, K2863, K2873, K2883, K2893, K2903, K2913, K2923, K2933, K2943, K2953, K2963, K2973, K2983, K2993, K3003, K3013, K3023, K3033, K3043, K3053, K3063, K3073, K3083, K3093, K3103, K3113, K3123, K3133, K3143, K3153, K3163, K3173, K3183, K3193, K3203, K3213, K3223, K3233, K3243, K3253, K3263, K3273, K3283, K3293, K3303, K3313, K3323, K3333, K3343, K3353, K3363, K3373, K3383, K3393, K3403, K3413, K3423, K3433, K3443, K3453, K3463, K3473, K3483, K3493, K3503, K3513, K3523, K3533, K3543, K3553, K3563, K3573, K3583, K3593, K3603, K3613, K3623, K3633, K3643, K3653, K3663, K3673, K3683, K3693, K3703, K3713, K3723, K3733, K3743, K3753, K3763, K3773, K3783, K3793, K3803, K3813, K3823, K3833, K3843, K3853, K3863, K3873, K3883, K3893, K3903, K3913, K3923, K3933, K3943, K3953, K3963, K3973, K3983, K3993, K4003, K4013, K4023, K4033, K4043, K4053, K4063, K4073, K4083, K4093, K4103, K4113, K4123, K4133, K4143, K4153, K4163, K4173, K4183, K4193, K4203, K4213, K4223, K4233, K4243, K4253, K4263, K4273, K4283, K4293, K4303, K4313, K4323, K4333, K4343, K4353, K4363, K4373, K4383, K4393, K4403, K4413, K4423, K4433, K4443, K4453, K4463, K4473, K4483, K4493, K4503, K4513, K4523, K4533, K4543, K4553, K4563, K4573, K4583, K4593, K4603, K4613, K4623, K4633, K4643, K4653, K4663, K4673, K4683, K4693, K4703, K4713, K4723, K4733, K4743, K4753, K4763, K4773, K4783, K4793, K4803, K4813, K4823, K4833, K4843, K4853, K4863, K4873, K4883, K4893, K4903, K4913, K4923, K4933, K4943, K4953, K4963, K4973, K4983, K4993, K5003, K5013, K5023, K5033, K5043, K5053, K5063, K5073, K5083, K5093, K5103, K5113, K5123, K5133, K5143, K5153, K5163, K5173, K5183, K5193, K5203, K5213, K5223, K5233, K5243, K5253, K5263, K5273, K5283, K5293, K5303, K5313, K5323, K5333, K5343, K5353, K5363, K5373, K5383, K5393, K5403, K5413, K5423, K5433, K5443, K5453, K5463, K5473, K5483, K5493, K5503, K5513, K5523, K5533, K5543, K5553, K5563, K5573, K5583, K5593, K5603, K5613, K5623, K5633, K5643, K5653, K5663, K5673, K5683, K5693, K5703, K5713, K5723, K5733, K5743, K5753, K5763, K5773, K5783, K5793, K5803, K5813, K5823, K5833, K5843, K5853, K5863, K5873, K5883, K5893, K5903, K5913, K5923, K5933, K5943, K5953, K5963, K5973, K5983, K5993, K6003, K6013, K6023, K6033, K6043, K6053, K6063, K6073, K6083, K6093, K6103, K6113, K6123, K6133, K6143, K6153, K6163, K6173, K6183, K6193, K6203, K6213, K6223, K6233, K6243, K6253, K6263, K6273, K6283, K6293, K6303, K6313, K6323, K6333, K6343, K6353, K6363, K6373, K6383, K6393, K6403, K6413, K6423, K6433, K6443, K6453, K6463, K6473, K6483, K6493, K6503, K6513, K6523, K6533, K6543, K6553, K6563, K6573, K6583, K6593, K6603, K6613, K6623, K6633, K6643, K6653, K6663, K6673, K6683, K6693, K6703, K6713, K6723, K6733, K6743, K6753, K6763, K6773, K6783, K6793, K6803, K6813, K6823, K6833, K6843, K6853, K6863, K6873, K6883, K6893, K6903, K6913, K6923, K6933, K6943, K6953, K6963, K6973, K6983, K6993, K7003, K7013, K7023, K7033, K7043, K7053, K7063, K7073, K7083, K7093, K7103, K7113, K7123, K7133, K7143, K7153, K7163, K7173, K7183, K7193, K7203, K7213, K7223, K7233, K7243, K7253, K7263, K7273, K7283, K7293, K7303, K7313, K7323, K7333, K7343, K7353, K7363, K7373, K7383, K7393, K7403, K7413, K7423, K7433, K7443, K7453, K7463, K7473, K7483, K7493, K7503, K7513, K7523, K7533, K7543, K7553, K7563, K7573, K7583, K7593, K7603, K7613, K7623, K7633, K7643, K7653, K7663, K7673, K7683, K7693, K7703, K7713, K7723, K7733, K7743, K7753, K7763, K7773, K7783, K7793, K7803, K7813, K7823, K7833, K7843, K7853, K7863, K7873, K7883, K7893, K7903, K7913, K7923, K7933, K7943, K7953, K7963, K7973, K7983, K7993, K8003, K8013, K8023, K8033, K8043, K8053, K8063, K8073, K8083, K8093, K8103, K8113, K8123, K8133, K8143, K8153, K8163, K8173, K8183, K8193, K8203, K8213, K8223, K8233, K8243, K8253, K8263, K8273, K8283, K8293, K8303, K8313, K8323, K8333, K8343, K8353, K8363, K8373, K8383, K8393, K8403, K8413, K8423, K8433, K8443, K8453, K8463, K8473, K8483, K8493, K8503, K8513, K8523, K8533, K8543, K8553, K8563, K8573, K8583, K8593, K8603, K8613, K8623, K8633, K8643, K8653, K8663, K8673, K8683, K8693, K8703, K8713, K8723, K8733, K8743, K8753, K8763, K8773, K8783, K8793, K8803, K8813, K8823, K8833, K8843, K8853, K8863, K8873, K8883, K8893, K8903, K8913, K8923, K8933, K8943, K8953, K8963, K8973, K8983, K8993, K9003, K9013, K9023, K9033, K9043, K9053, K9063, K9073, K9083, K9093, K9103, K9113, K9123, K9133, K9143, K9153, K9163, K9173, K9183, K9193, K9203, K9213, K9223, K9233, K9243, K9253, K9263, K9273, K9283, K9293, K9303, K9313, K9323, K9333, K9343, K9353, K9363, K9373, K9383, K9393, K9403, K9413, K9423, K9433, K9443, K9453, K9463, K9473, K9483, K9493, K9503, K9513, K9523, K9533, K9543, K9553, K9563, K9573, K9583, K9593, K9603, K9613, K9623, K9633, K9643, K9653, K9663, K9673, K9683, K9693, K9703, K9713, K9723, K9733, K9743, K9753, K9763, K9773, K9783, K9793, K9803, K9813, K9823, K9833, K9843, K9853, K9863, K9873, K9883, K9893, K9903, K9913, K9923, K9933, K9943, K9953, K9963, K9973, K9983, K9993, K10003, K10013, K10023, K10033, K10043, K10053, K10063, K10073, K10083, K10093, K10103, K10113, K10123, K10133, K10143, K10153, K10163, K10173, K10183, K10193, K10203, K10213, K10223, K10233, K10243, K10253, K10263, K10273, K10283, K10293, K10303, K10313, K10323, K10333, K10343, K10353, K10363, K10373, K10383, K10393, K10403, K10413, K10423, K10433, K10443, K10453, K10463, K10473, K10483, K10493, K10503, K10513, K10523, K10533, K10543, K10553, K10563, K10573, K10583, K10593, K10603, K10613, K10623, K10633, K10643, K10653, K10663, K10673, K10683, K10693, K10703, K10713, K10723, K10733, K10743, K10753, K10763, K10773, K10783, K10793, K10803, K10813, K10823, K10833, K10843, K10853, K10863, K10873, K10883, K10893, K10903, K10913, K10923, K10933, K10943, K10953, K10963, K10973, K10983, K10993, K11003, K11013, K11023, K11033, K11043, K11053, K11063, K11073, K11083, K11093, K11103, K11113, K11123, K11133, K11143, K11153, K11163, K11173, K11183, K11193, K11203, K11213, K11223, K11233, K11243, K11253, K11263, K11273, K11283, K11293, K11303, K11313, K11323, K11333, K11343, K11353, K11363, K11373, K11383, K11393, K11403, K11413, K11423, K11433, K11443, K11453, K11463, K11473, K11483, K11493, K11503, K11513, K11523, K11533, K11543, K11553, K11563, K11573, K11583, K11593, K11603, K11613, K11623, K11633, K11643, K11653, K11663, K11673, K11683, K11693, K11703, K11713, K11723, K11733, K11743, K11753, K11763, K11773, K11783, K11793, K11803, K11813, K11823, K11833, K11843, K11853, K11863, K11873, K11883, K11893, K11903, K11913, K11923, K11933, K11943, K11953, K11963, K11973, K11983, K11993, K12003, K12013, K12023, K12033, K12043, K12053, K12063, K12073, K12083, K12093, K12103, K12113, K12123, K12133, K12143, K12153, K12163, K12173, K12183, K12193, K12203, K12213, K12223, K12233, K12243, K12253, K12263, K12273, K12283, K12293, K12303, K12313, K12323, K12333, K12343, K12353, K12363, K12373, K12383, K12393, K12403, K12413, K12423, K12433, K12443, K12453, K12463, K12473, K12483, K12493, K12503, K12513, K12523, K12533, K12543, K12553, K12563, K12573, K12583, K12593, K12603, K12613, K12623, K12633, K12643, K12653, K12663, K12673, K12683, K12693, K12703, K12713, K12723, K12733, K12743, K12753, K12763, K12773, K12783, K12793, K12803, K12813, K12823, K12833, K12843, K12853, K12863, K12873, K12883, K12893, K12903, K12913, K12923, K12933, K12943, K12953, K12963, K12973, K12983, K12993, K13003, K13013, K13023, K13033, K13043, K13053, K13063, K13073, K13083, K13093, K13103, K13113, K13123, K13133, K13143, K13153, K13163, K13173, K13183, K13193, K13203, K13213, K13223, K13233, K13243, K13253, K13263, K13273, K13283, K13293, K13303, K13313, K13323, K13333, K13343, K13353, K13363, K13373, K13383, K13393, K13403, K13413, K13423, K13433, K13443, K13453, K13463, K13473, K13483, K13493, K13503, K13513, K13523, K13533, K13543, K13553, K13563, K13573, K13583, K13593, K13603, K13613, K13623, K13633, K13643, K13653, K13663, K13673, K13683, K13693, K13703, K13713, K13723, K13733, K13743, K13753, K13763, K13773, K13783, K13793, K13803, K13813, K13823, K13833, K13843, K13853, K13863, K13873, K13883, K13893, K13903, K13913, K13923, K13933, K13943, K13953, K13963, K13973, K13983, K13993, K14003, K14013, K14023, K14033, K14043, K14053, K14063, K14073, K14083, K14093, K14103, K14113, K14123, K14133, K14143, K14153, K14163, K14173, K14183, K14193, K14203, K14213, K14223, K14233, K14243, K14253, K14263, K14273, K14283, K14293, K14303, K14313, K14323, K14333, K14343, K14353, K14363, K14373, K14383, K14393, K14403, K14413, K14423, K14433, K14443, K14453, K14463, K14473, K14483, K14493, K14503, K14513, K14523, K14533, K14543, K14553, K14563, K14573, K14583, K14593, K14603, K14613, K14623, K14633, K14643, K14653, K14663, K14673, K14683, K14693, K14703, K14713, K14723, K14733, K14743, K14753, K14763, K14773, K14783, K14793, K14803, K14813, K14823, K14833, K14843, K14853, K14863, K14873, K14883, K14893, K14903, K14913, K14923, K14933, K14943, K14953, K14963, K14973, K14983, K14993, K15003, K15013, K15023, K15033, K15043, K15053, K15063, K15073, K15083, K15093, K15103, K15113, K15123, K15133, K15143, K15153, K15163, K15173, K15183, K15193, K15203, K15213, K15223, K15233, K15243, K15253, K15263, K15273, K15283, K15293, K15303, K15313, K15323, K15333, K15343, K15353, K15363