

GRUNDRISS ANSCHLUSS / PIANTA INNESTO

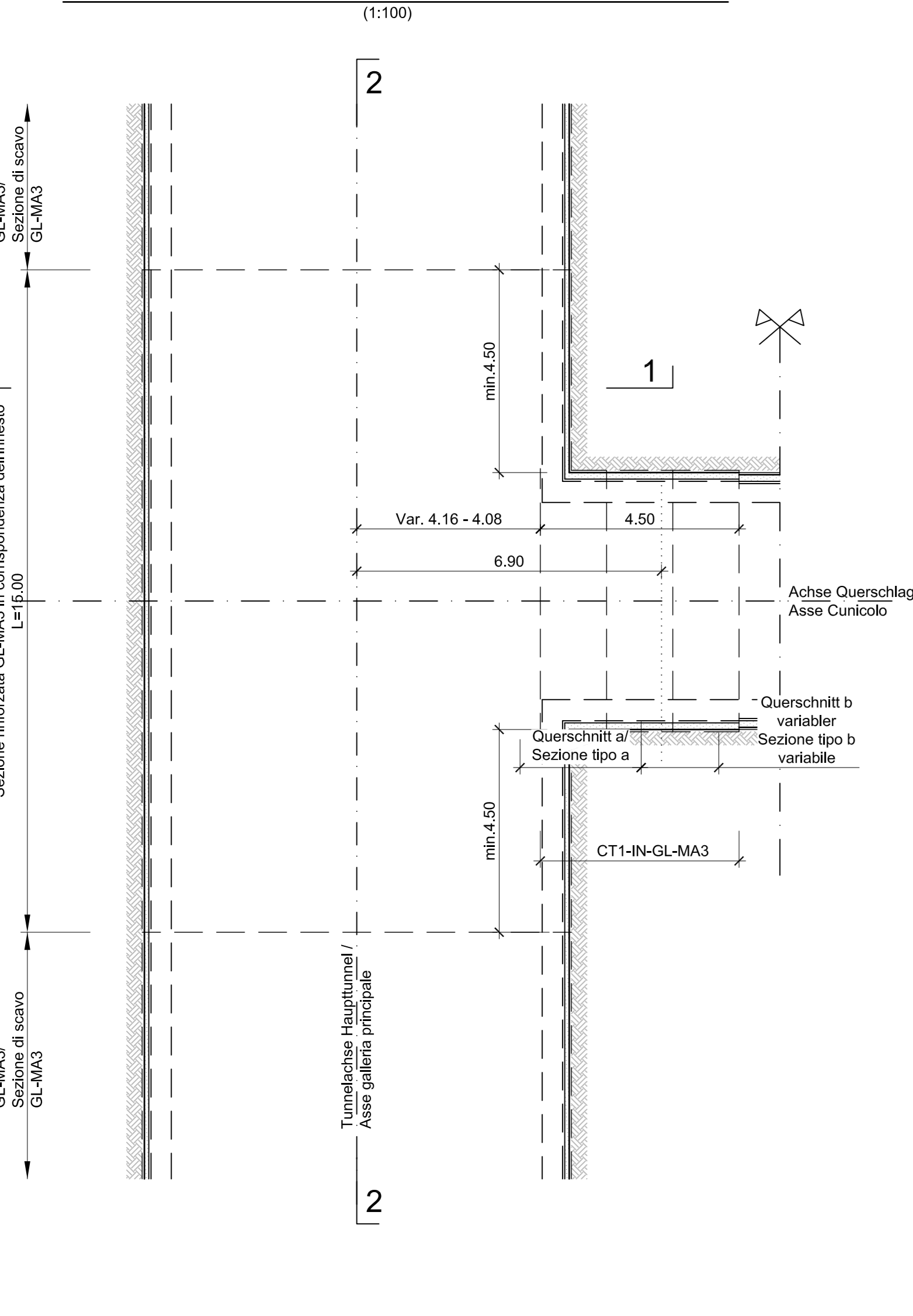

SCHNITT a / SEZIONE TIPO a

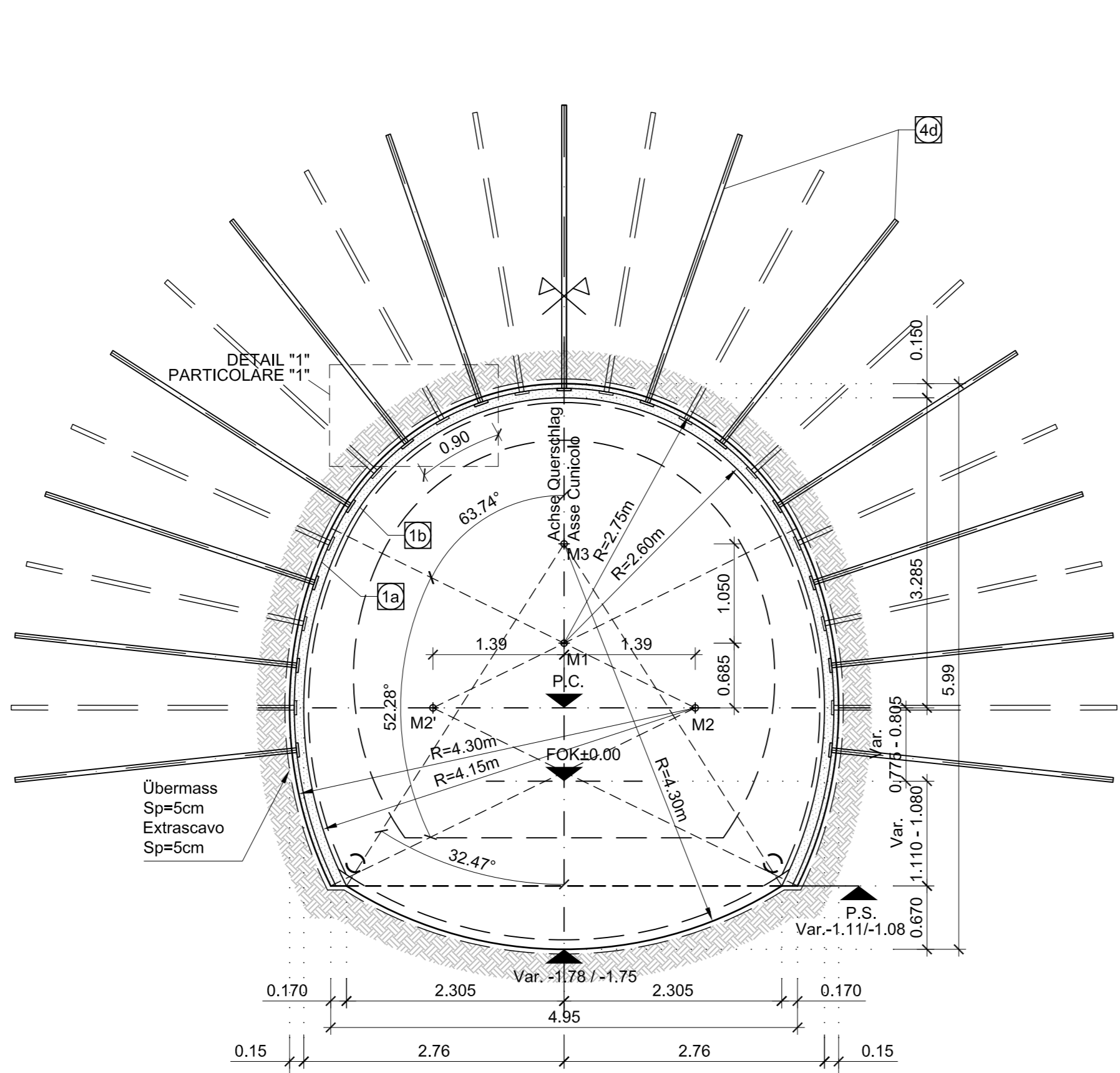

FASI ESECUTIVE: 1. SCALO DELLA GALLERIA CORRENTE CON APPLICAZIONE DEGLI INTERVENTI DI RINFORZO...

BAUPHASEN: 1. AUSBAU DESSES TUNNELS MIT ANWENDUNG DER VERSTÄRKUNGSPHASE AN DER STREBE...

SCHNITT b / SEZIONE TIPO b

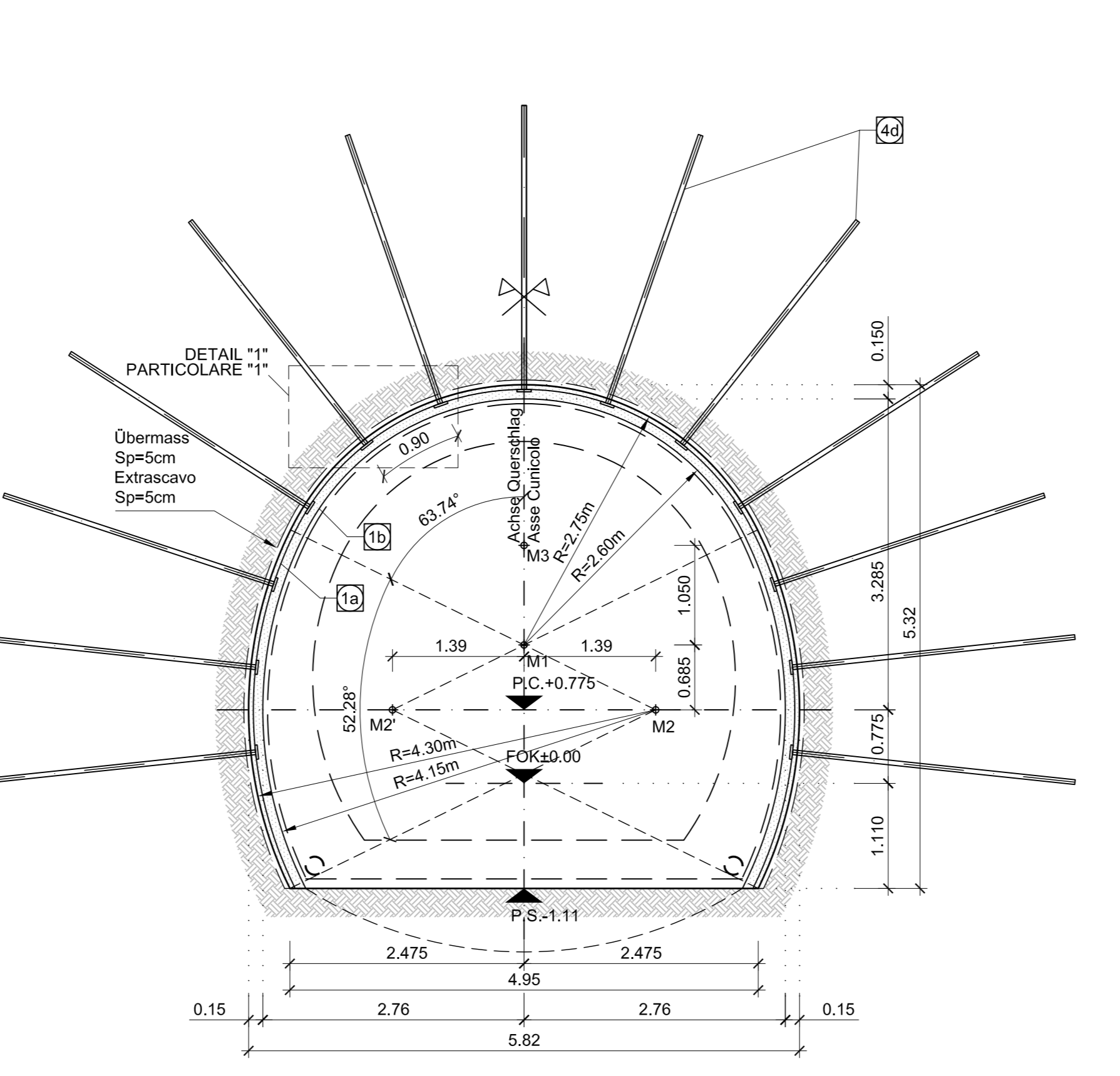

SCHEMA NIETUNG SCHNITT CT1-IN-GL-MA3

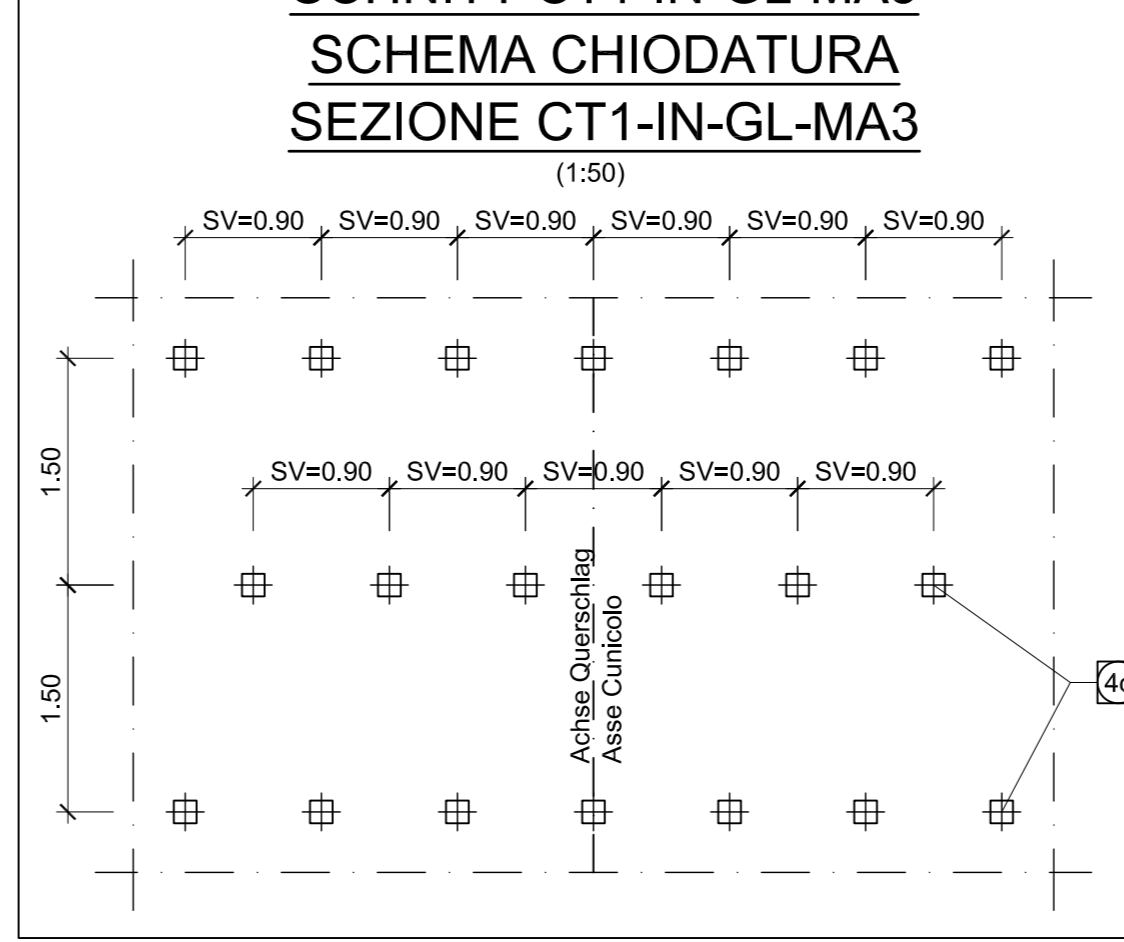

SCHEMA NIETUNG GL-MA3 ANSCHLUSS

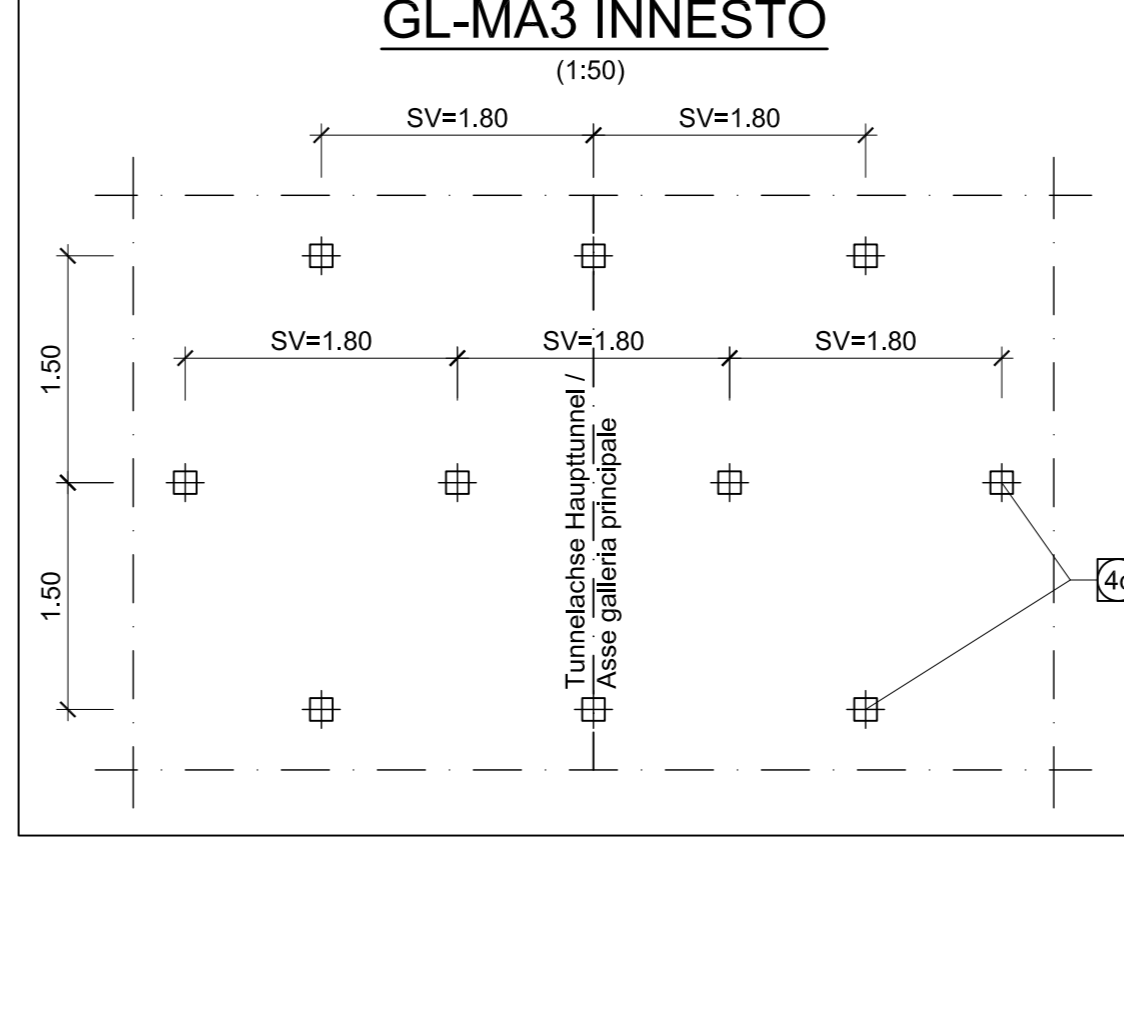

BEMERKUNGEN

- DAß BEI DER PROFIL 'CT1-IN-GL-MA3' WIRD NUR MIT EINEM WERT +1400 ANGERECHNET...
LEGENDE: -P.C.= EBENE DER KREISMITTEN...
MATERIALEIGENSCHAFTEN UND TECHNISCHE SPEZIFIKATIONEN

LEGENDA

Table with 4 columns: Distanz Galleria Est, Distanz Galleria Ovest, L1 (m), L2 (m), L3 (m), P.

NOTE

- LA SEZIONE TIPO 'CT1-IN-GL-MA3' VIENE APPLICATA INDICATAIEMENTE CON R=400...
LEGENDA: -P.C.= PIANO DEI CENTRI...
CARATTERISTICHE DEI MATERIALI E SPECIFICHE TECNICHE

Table with 5 columns: Bereich, Campo, Spezifikation, Einheit, Menge/m Tunnel.

GRUNDRISS / PIANTA

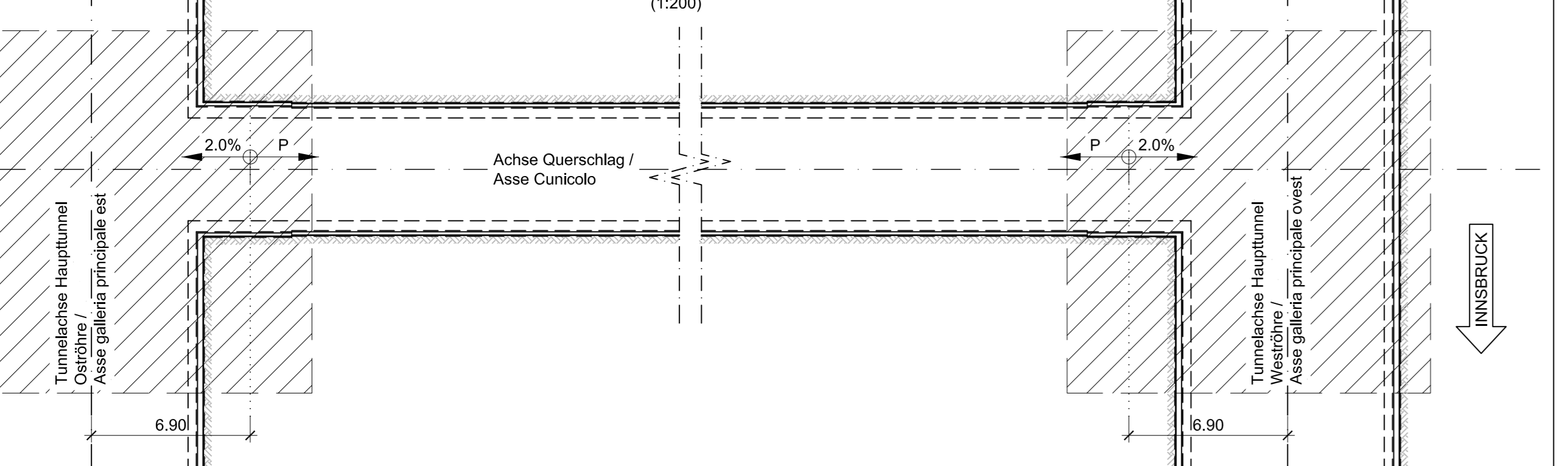

DETAIL 1 / PARTICOLARE 1

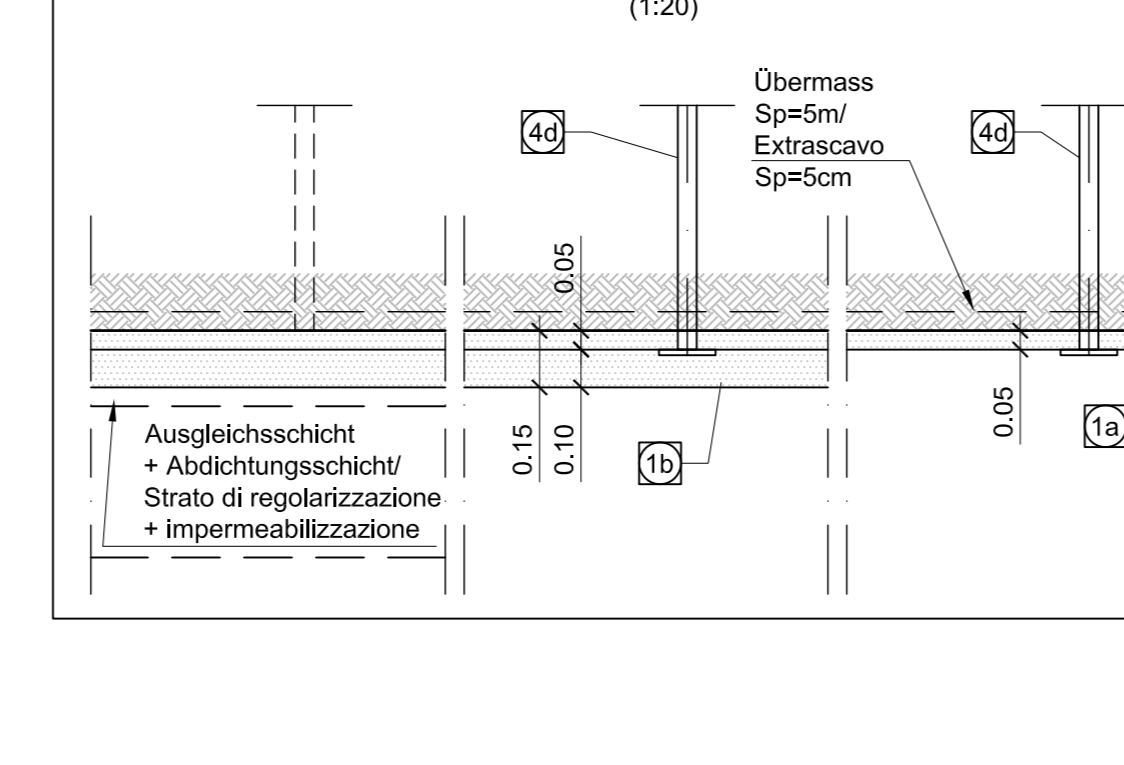

DETAIL 2 / PARTICOLARE 2

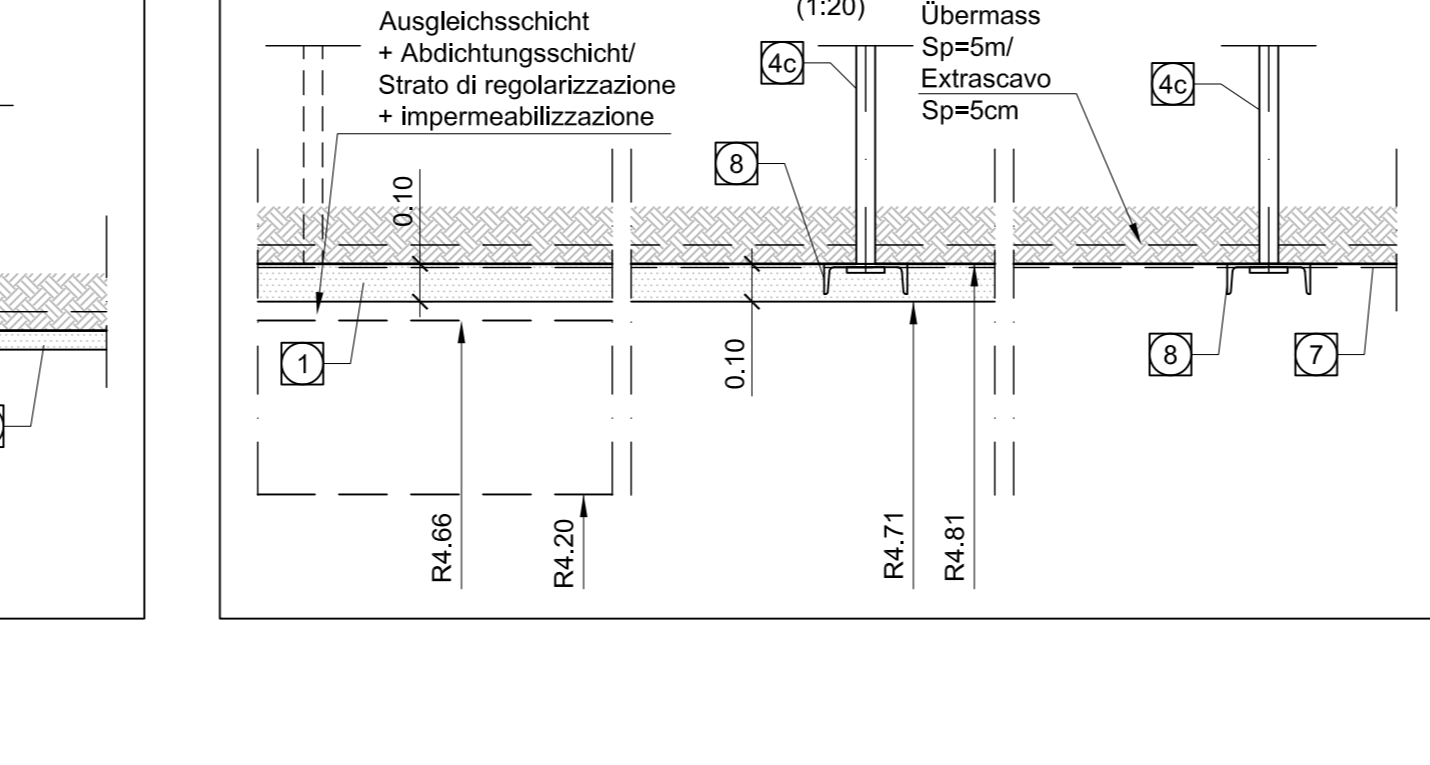

DETAIL ANKERPLATTE / PARTICOLARE PIASTRA DI ANCORAGGIO

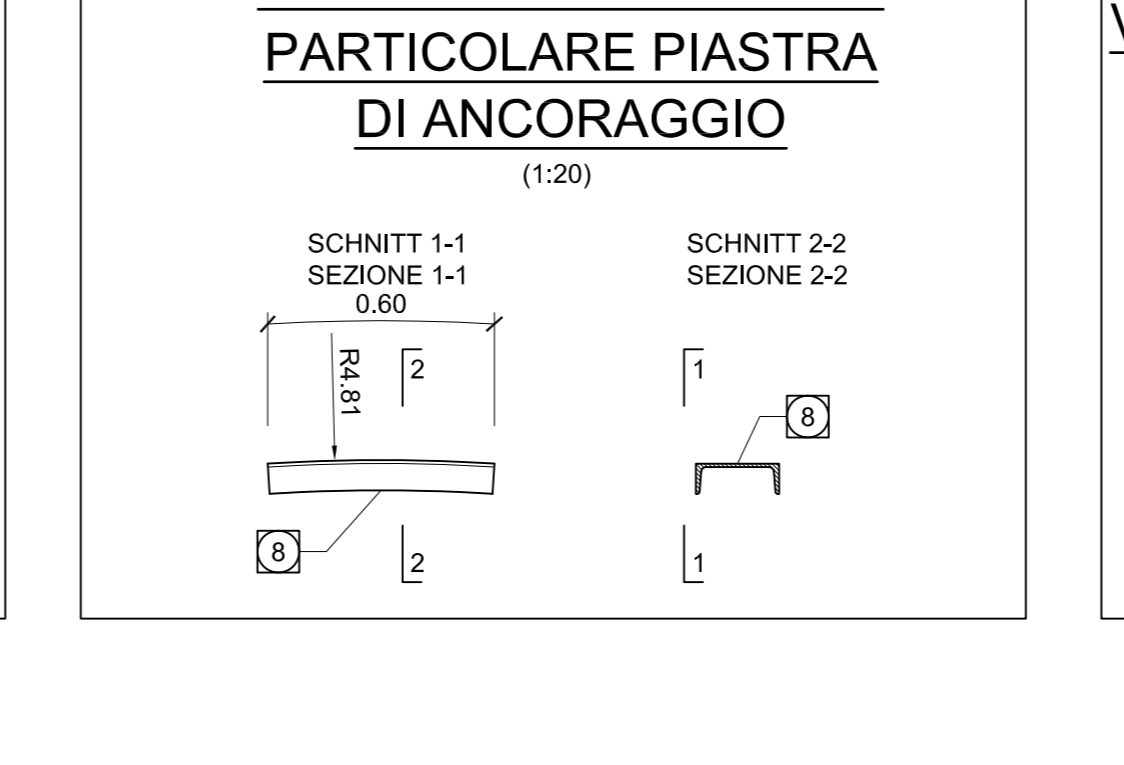

AUSHUBVOLUMEN (INKL. EXTRAUSHUB) / VOLUME DI SCAVO (INCLUSO EXTRASCALO)

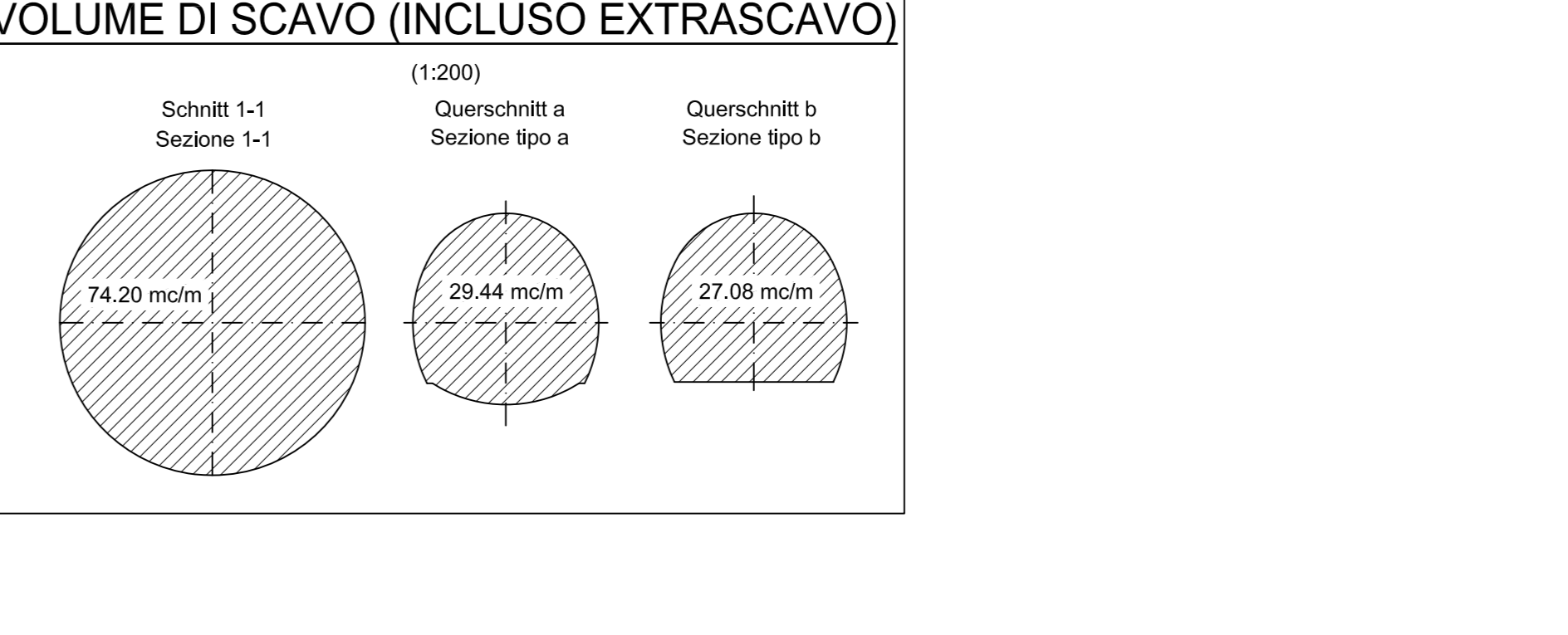

SCHNITT 2-2 / SEZIONE 2-2

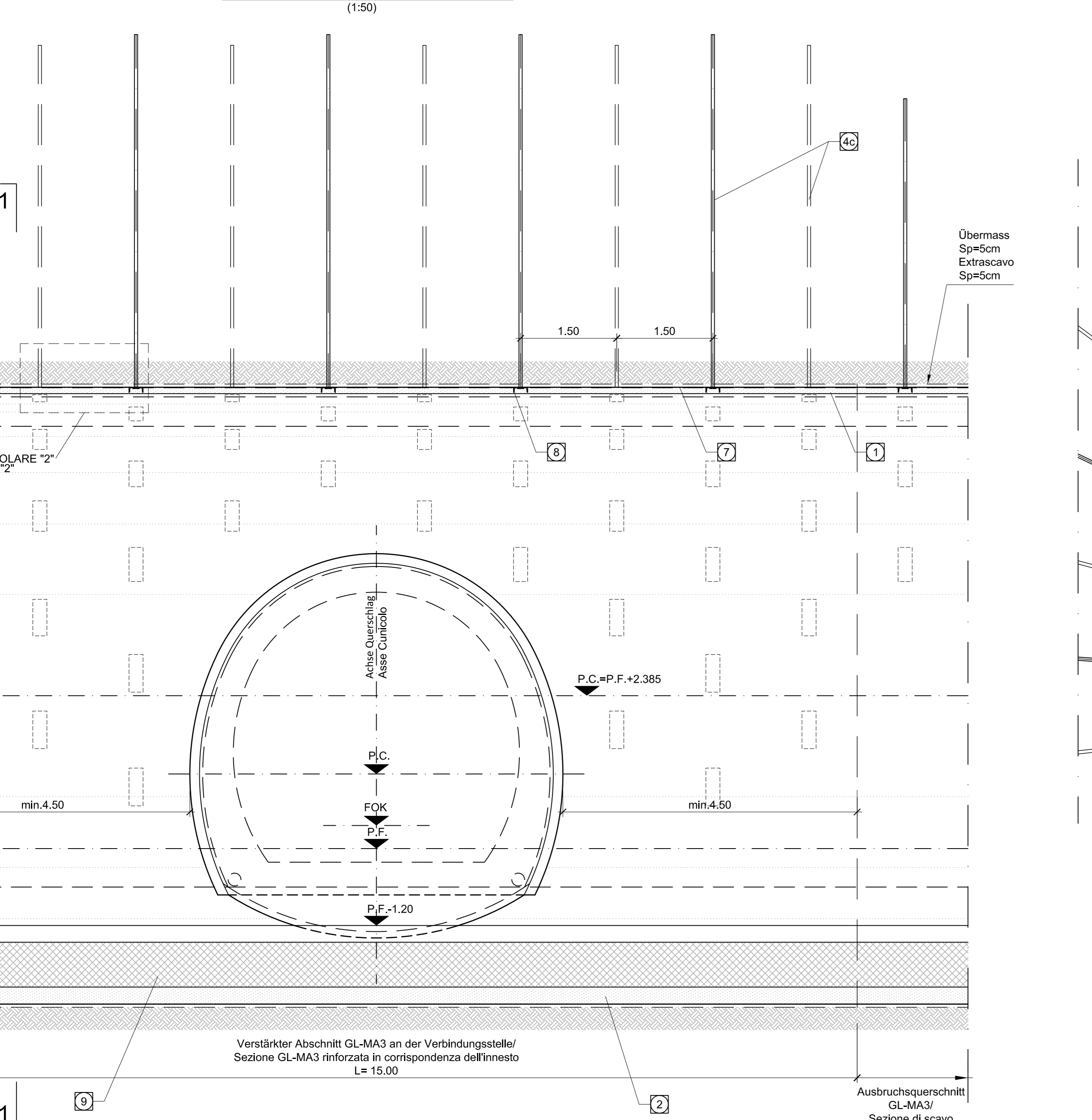

LÄNGSABLAUF / SVILUPPO LONGITUDINALE

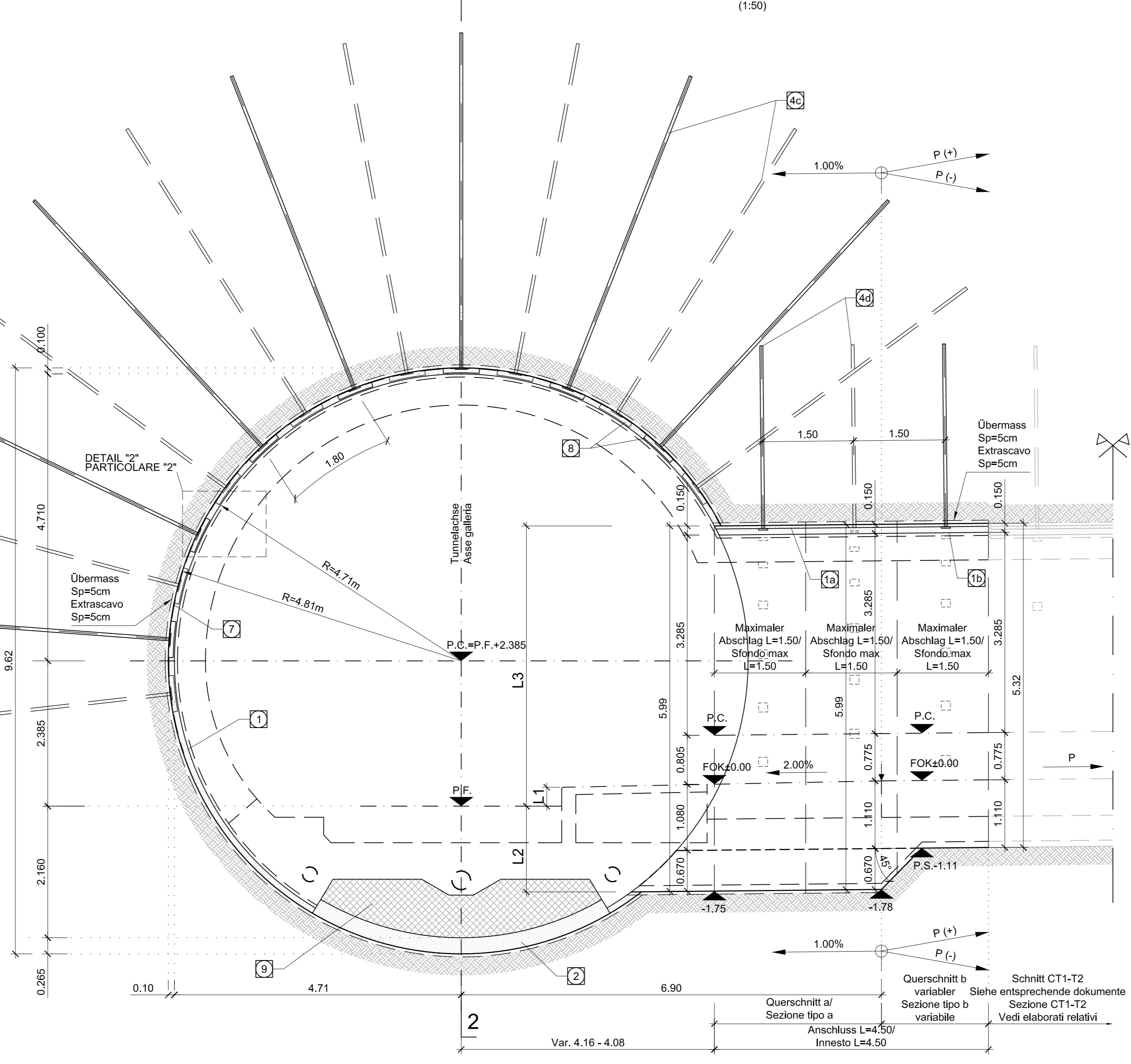

SCHNITT 1-1 / SEZIONE 1-1

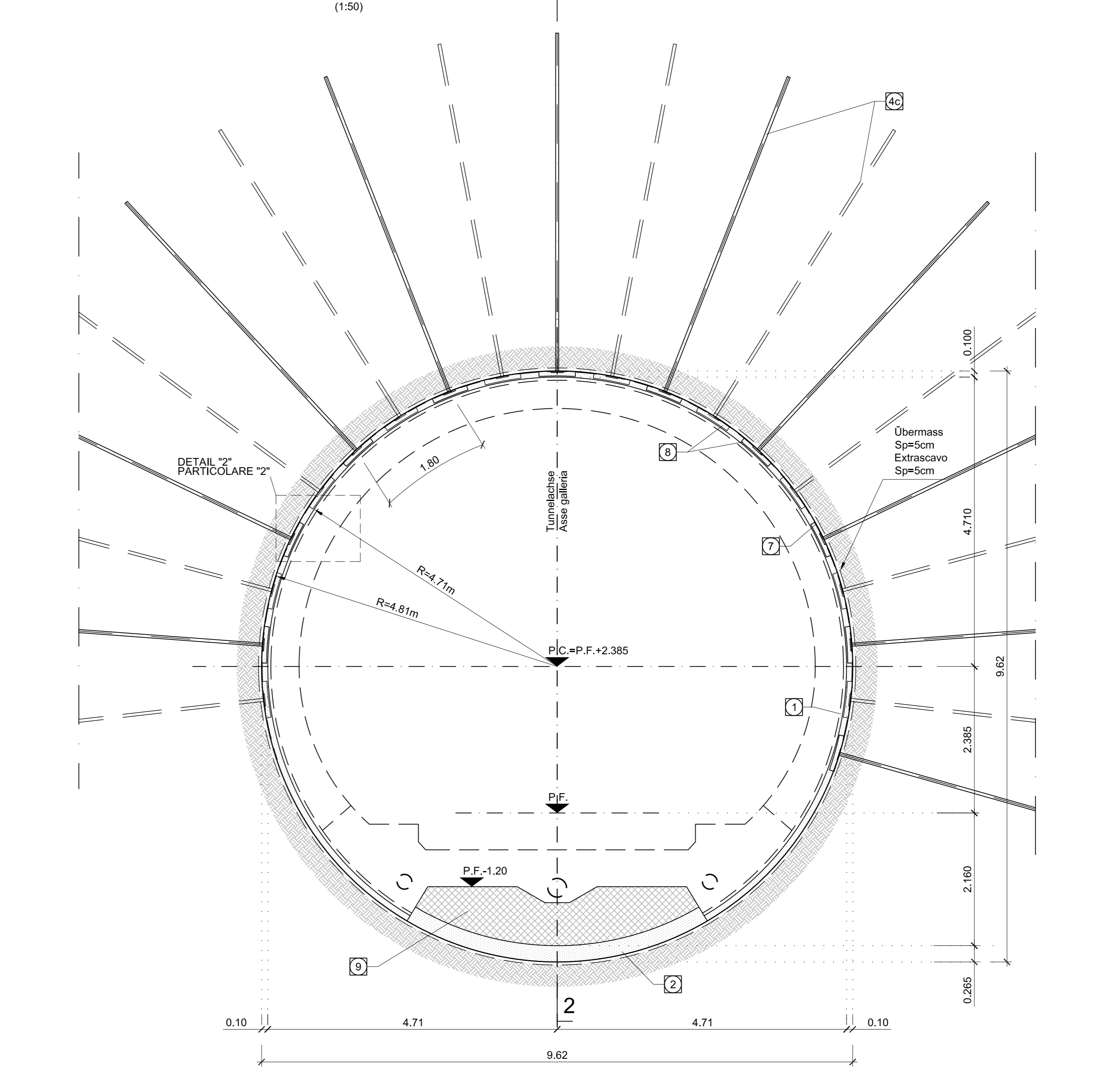

Referenzdokumente: Documenti di riferimento including codes and descriptions.

Table with 5 columns: Revision, Datum, Verändertes, Verantwortlich, Datum.

Logo of the European Union and BBT logo.

Project information including title 'BRENNER BASISTUNNEL', location, and participating organizations like Pöyry and pini swiss.