

SCHNITT 1-1 / SEZIONE 1-1

QUERSCHNITT a / SEZIONE TIPO a

QUERSCHNITT b / SEZIONE TIPO b

SCHEMA NIETUN SCHNITT CT1-IN-GL-D2

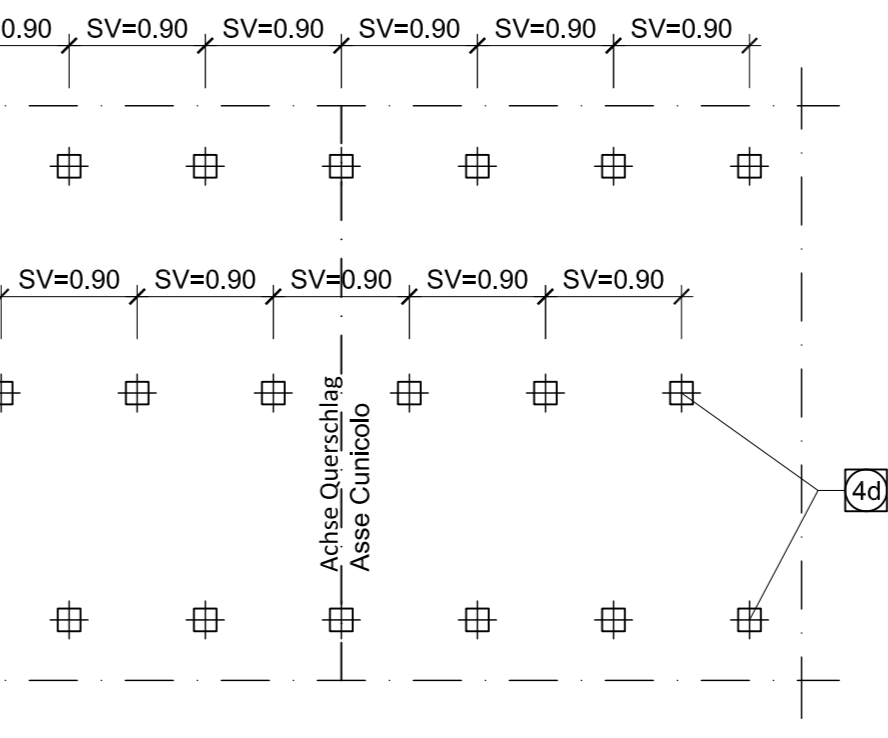

SCHEMA NIETUN GL-D2 ANSCHLUSS SCHEMA CHIODATURA GL-D2 INNESTO

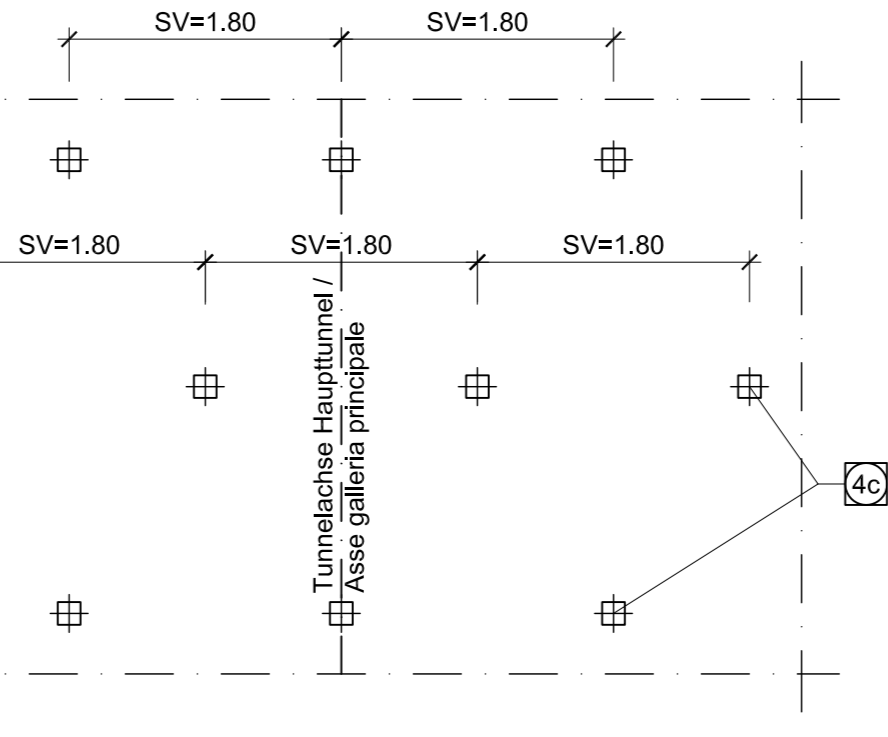

BEWERTUNGEN, LEGENDE, MATERIALEIGENSCHAFTEN UND TECHNISCHE SPEZIFIKATIONEN

NOTE, LEGENDA, CARATTERISTICHE DEI MATERIALI E SPECIFICHE TECNICHE

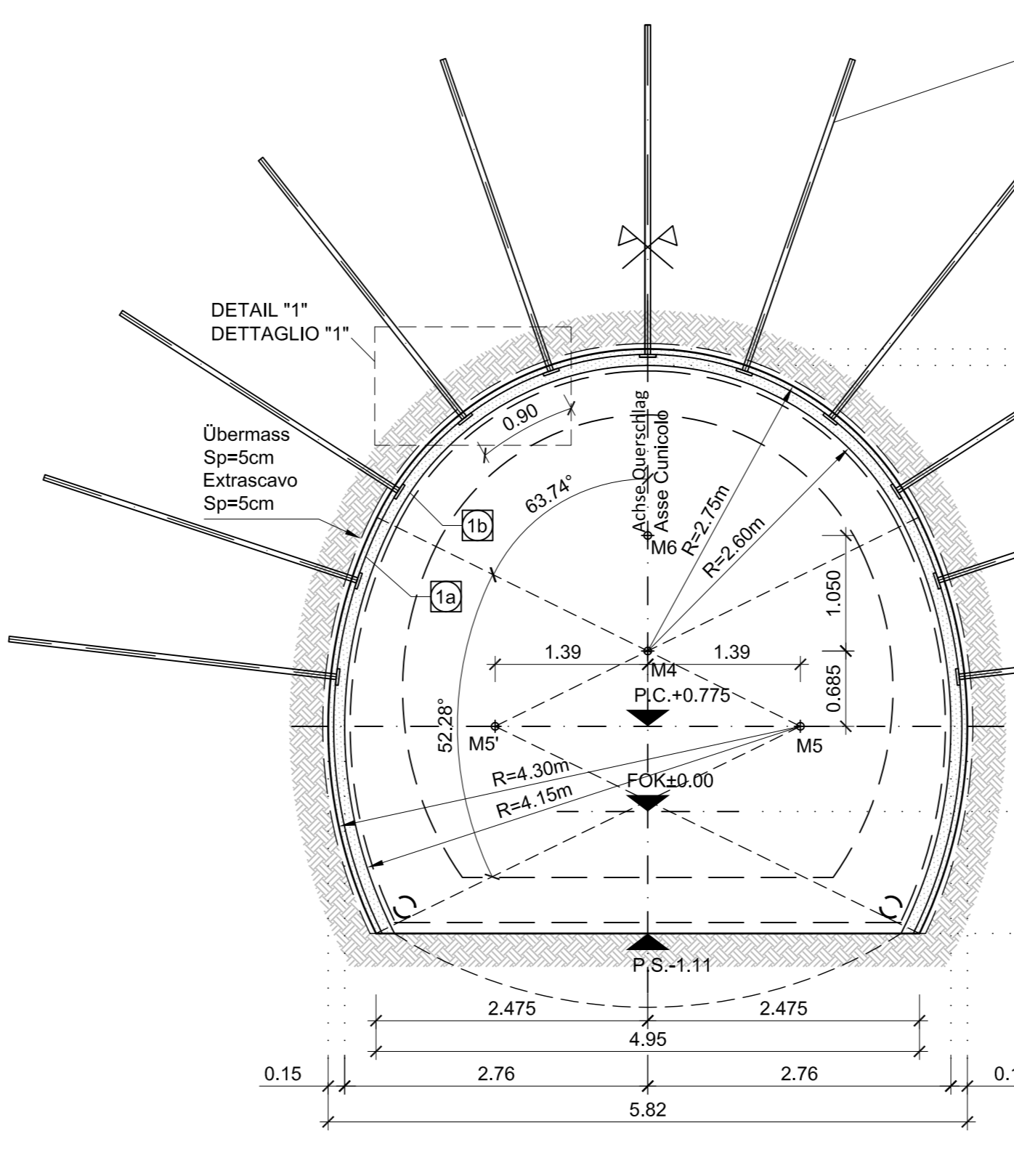
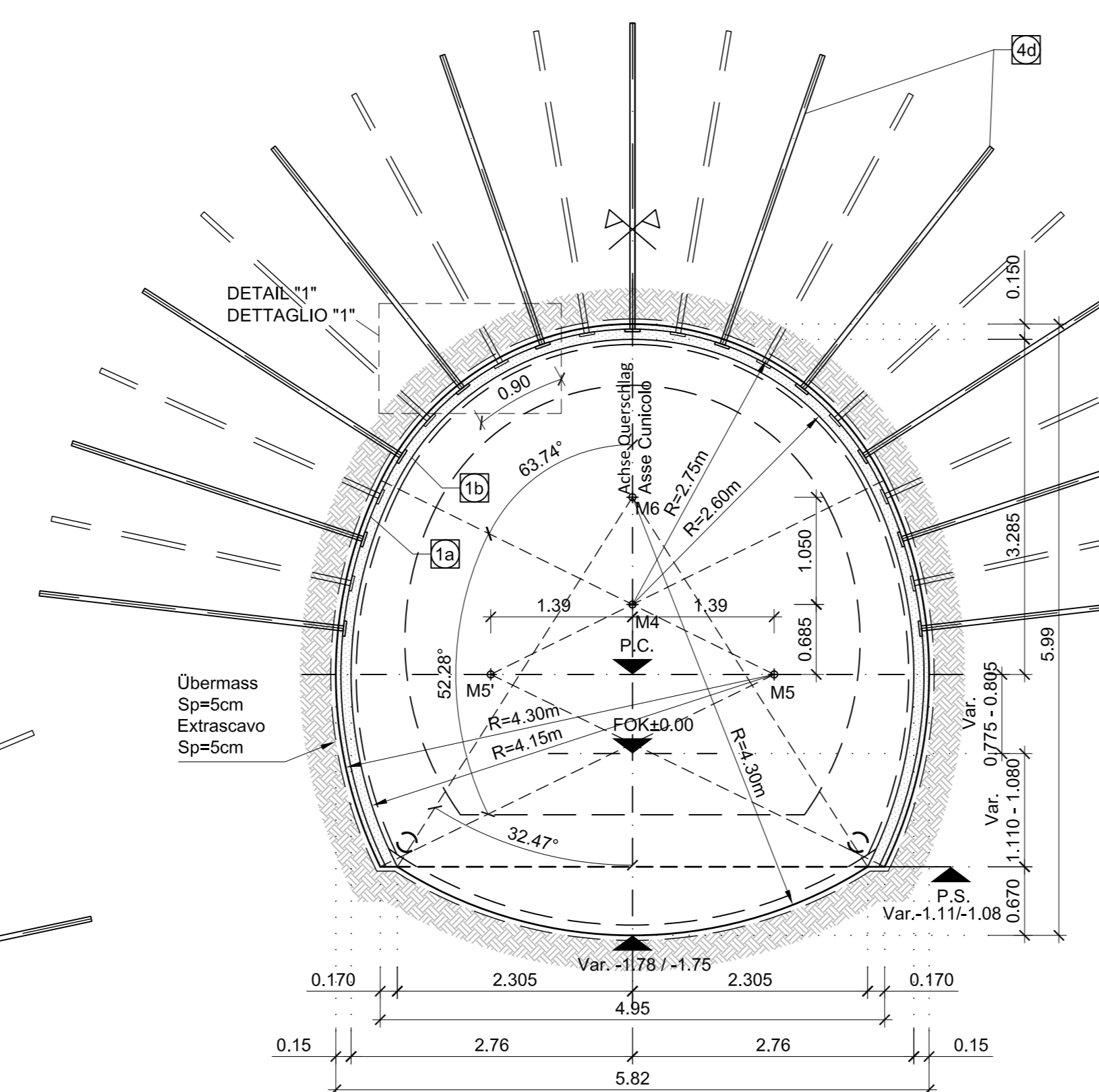
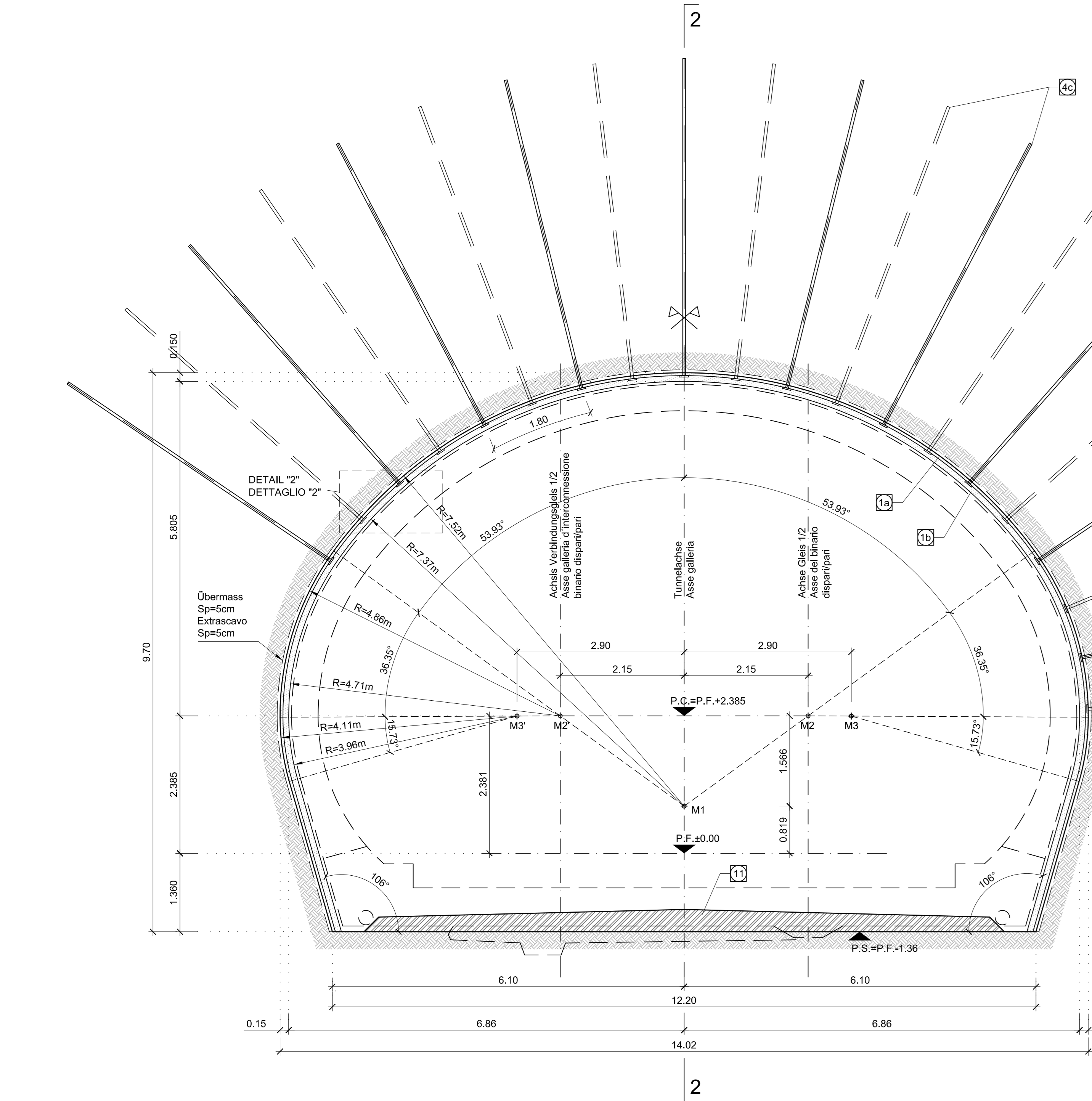

- BAUPHASEN (Construction Phases) - 5 numbered steps describing the construction process from excavation to final lining.

Table with 2 columns: Querschnitt / Cross-section and 7 columns of numerical data.

- FASI ESECUTIVE (Execution Phases) - 4 numbered steps detailing the execution of the tunnel lining and connection.

Table with 2 columns: KOORDINATEN / COORDINATE and 2 columns of numerical data for points M1, M2, M3, M2, M3.

LÄNGSABLAUF / SVILUPPO LONGITUDINALE

SCHNITT 2-2 / SEZIONE 2-2

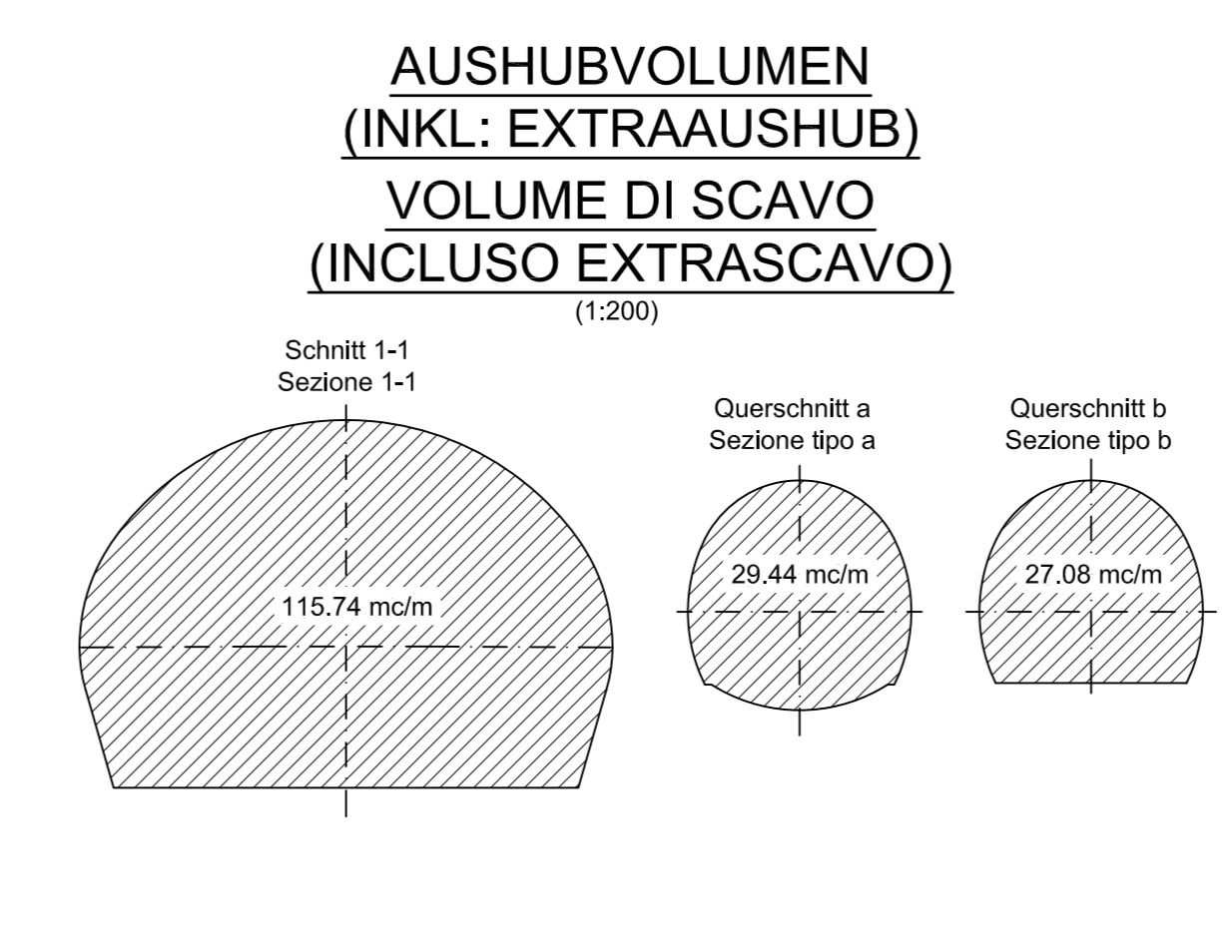
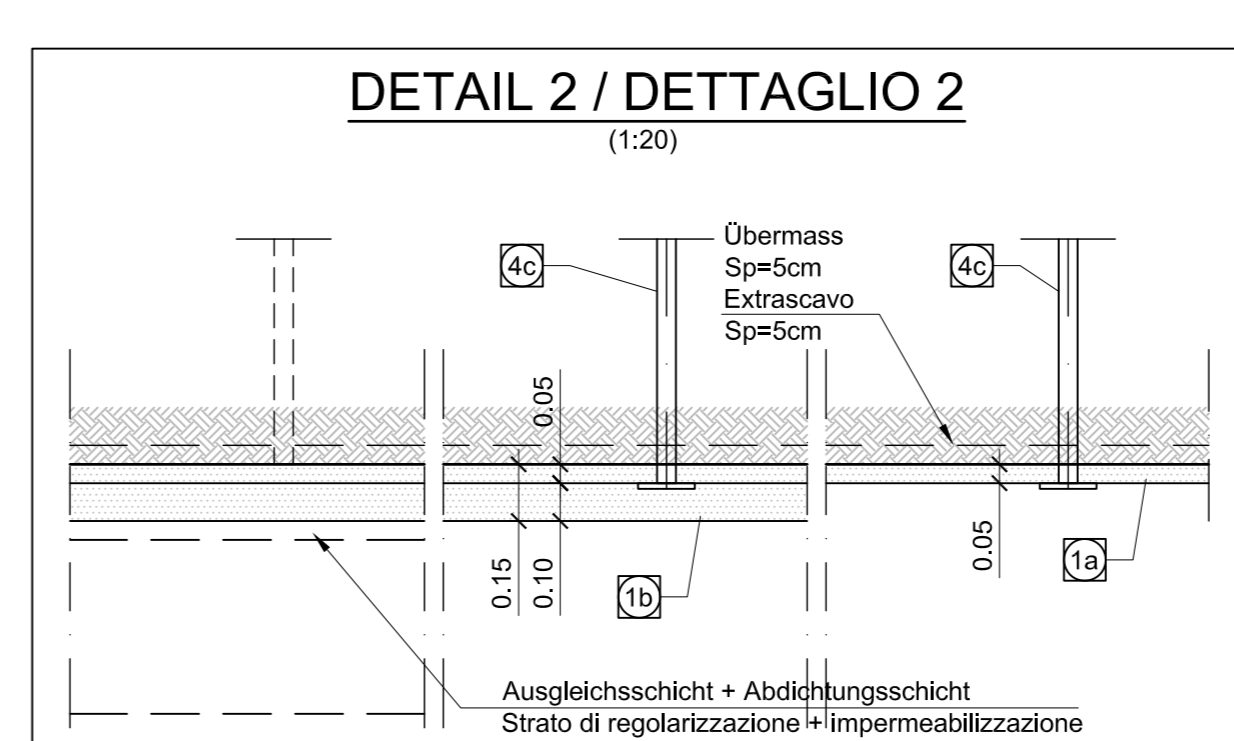
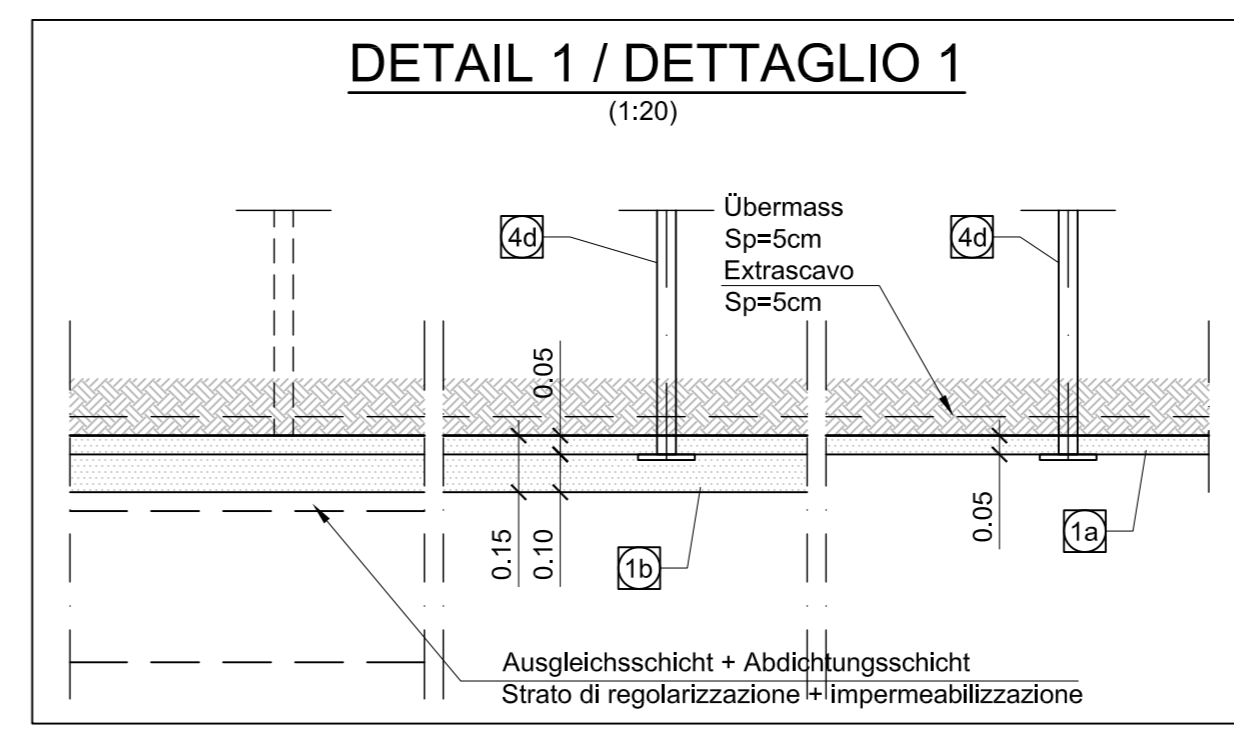
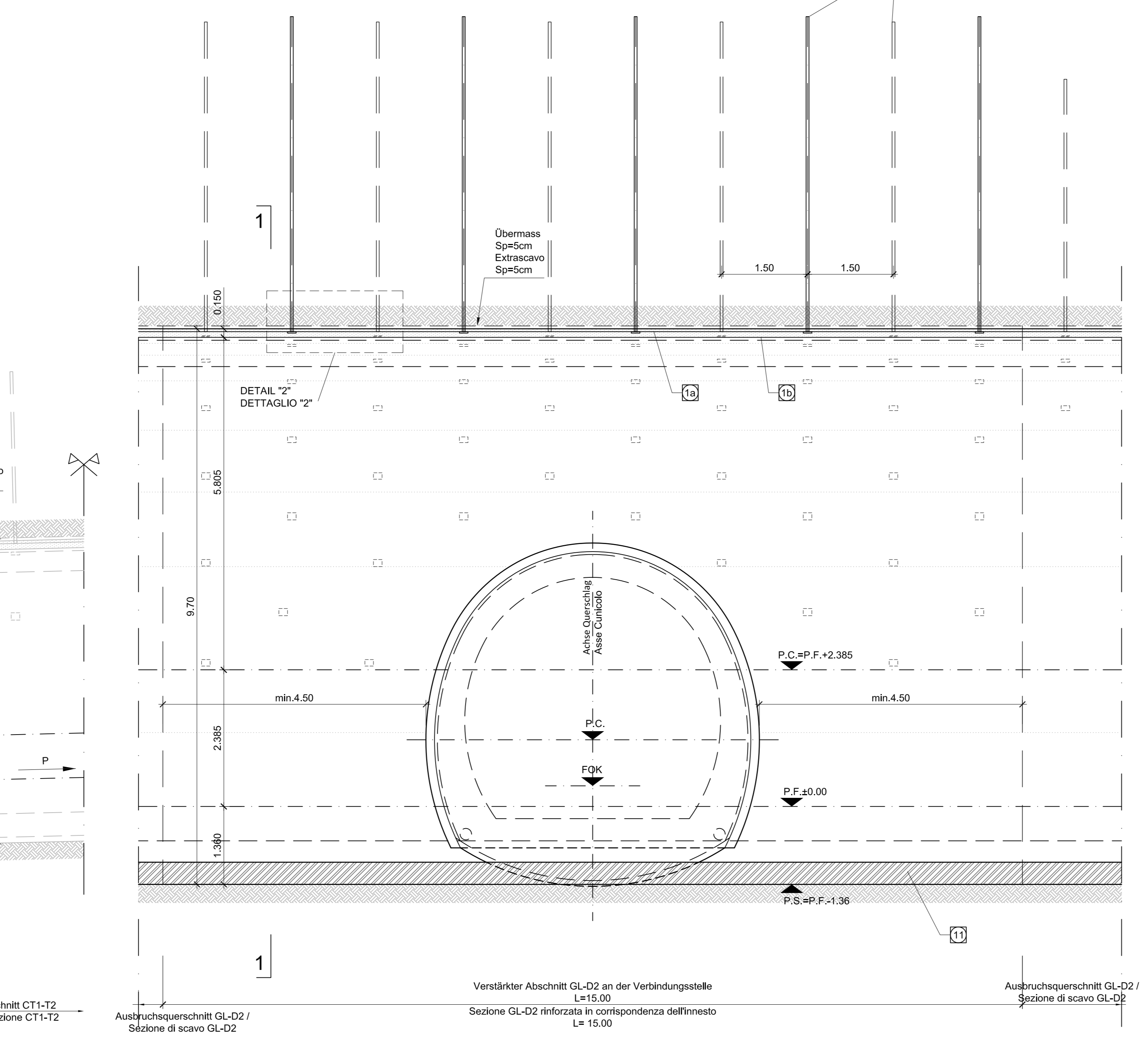
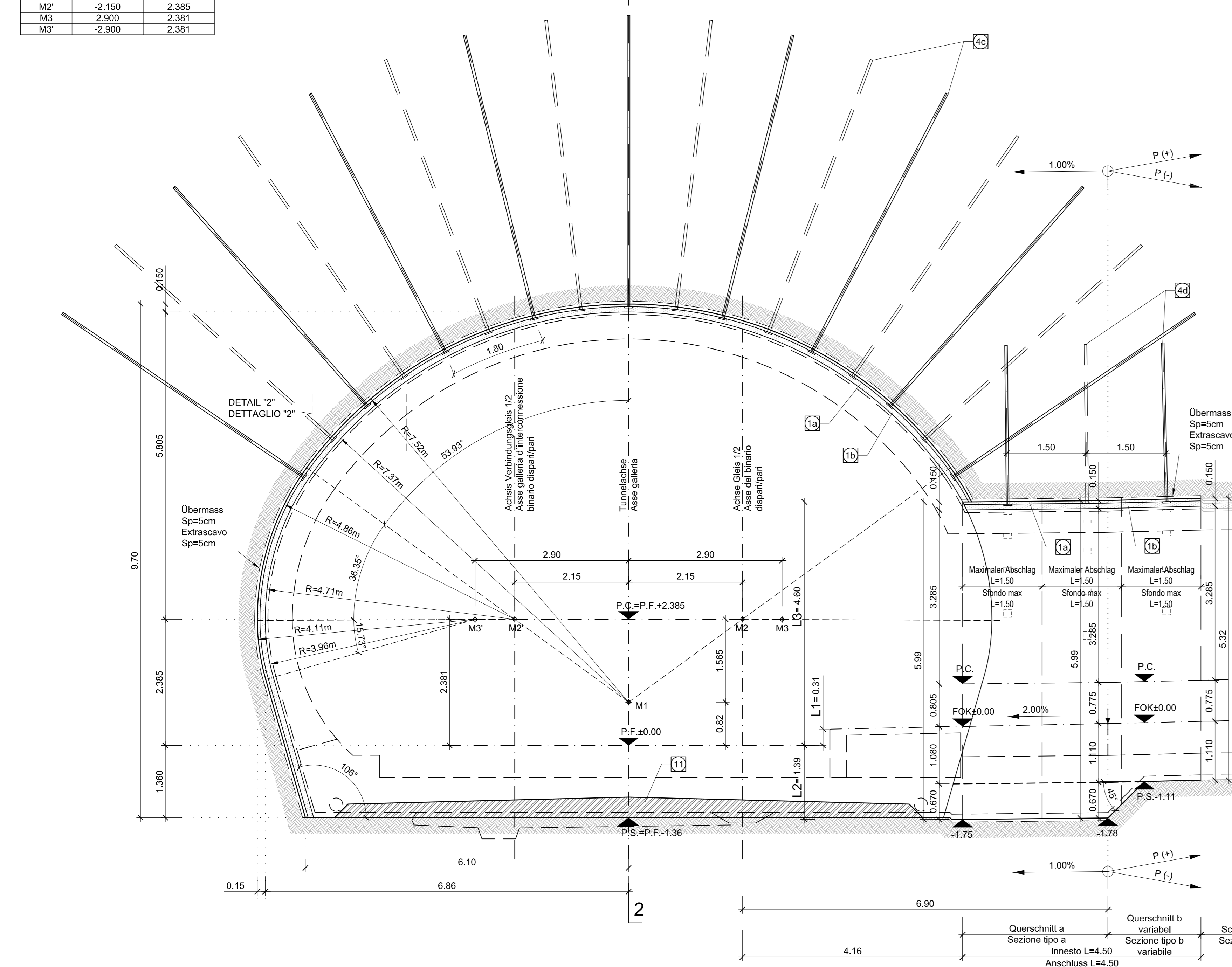

GRUNDRIS ANSCHLUSS / PIANA INNESTO

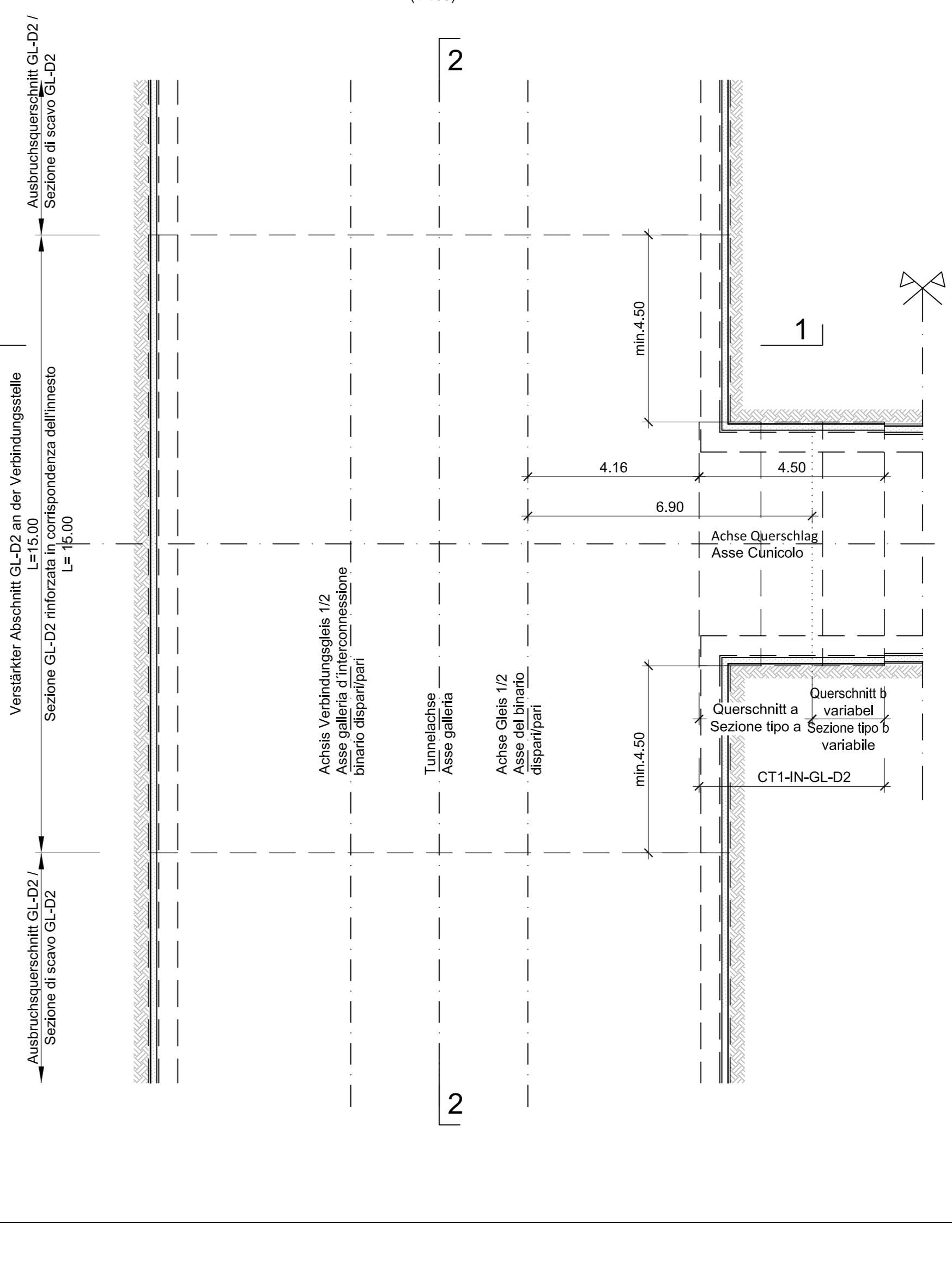

Referenzdokumente (Reference Documents) table listing various documents and their descriptions.

Project information block including logos, company names (BBT, Pini Swiss), and project details for the Brennero Basistunnel.