

SCHNITT A-A / SEZIONE A-A

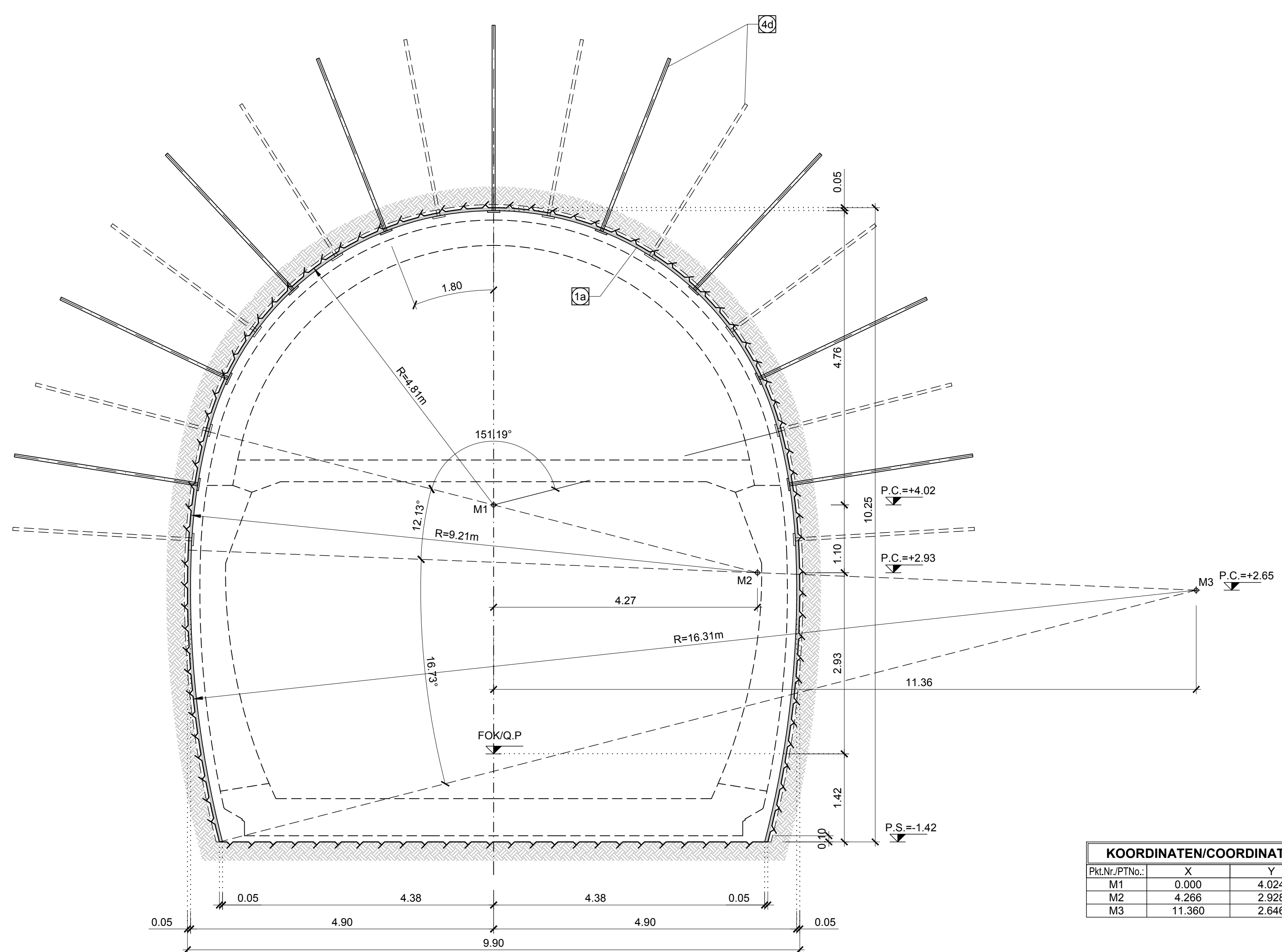

SCHNITT B-B / SEZIONE B-B

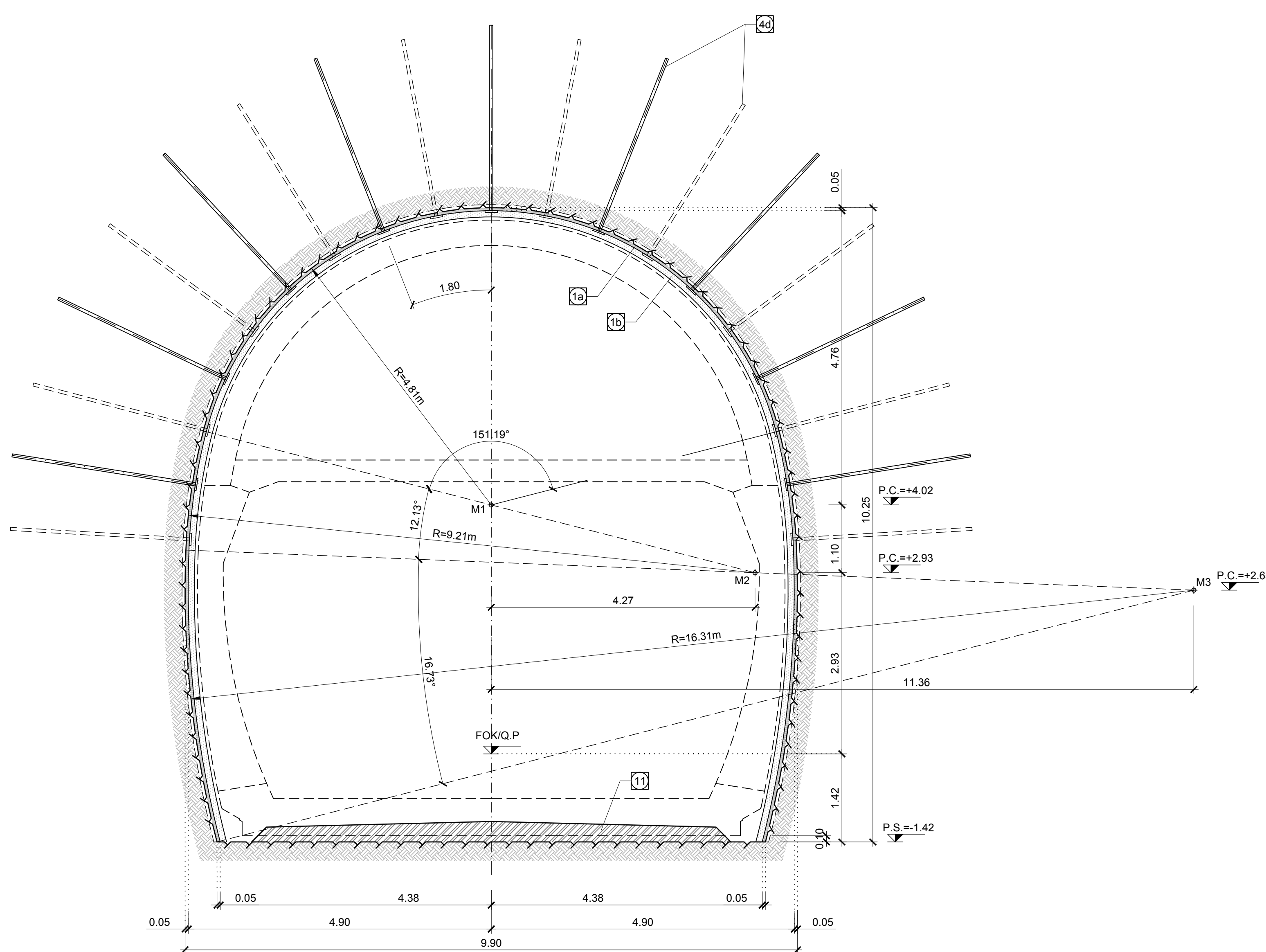

AUSBRUCHVOLUMEN (mit Übermaß) / VOLUME DI SCAVO (incluso sovrascavo)

(1:200)

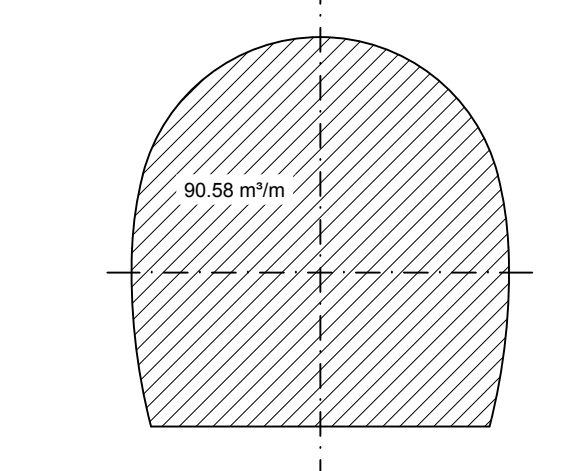
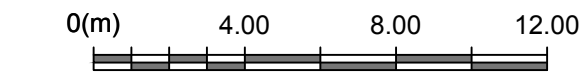

DETAIL / PARTICOLARE

(1:20)

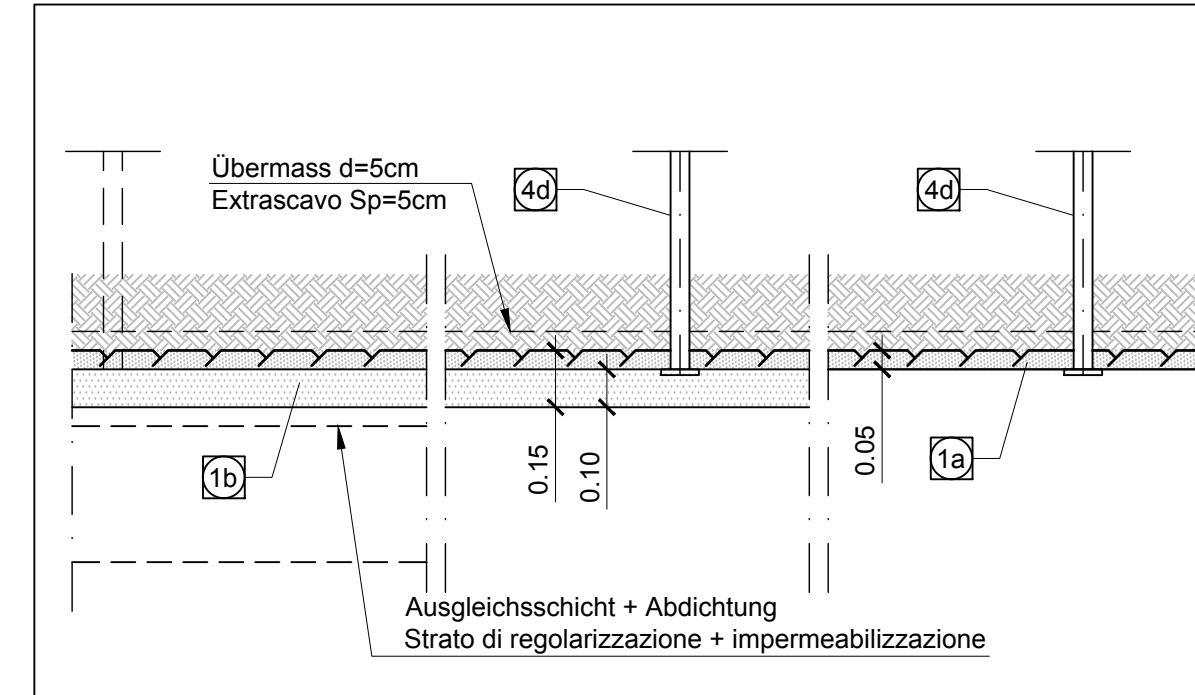
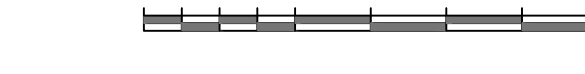

ANKERPLAN / PIANTA ANCORAGGI

(1:100)

Raster / Maglia: 1.80x3.00m, L = 3.00m

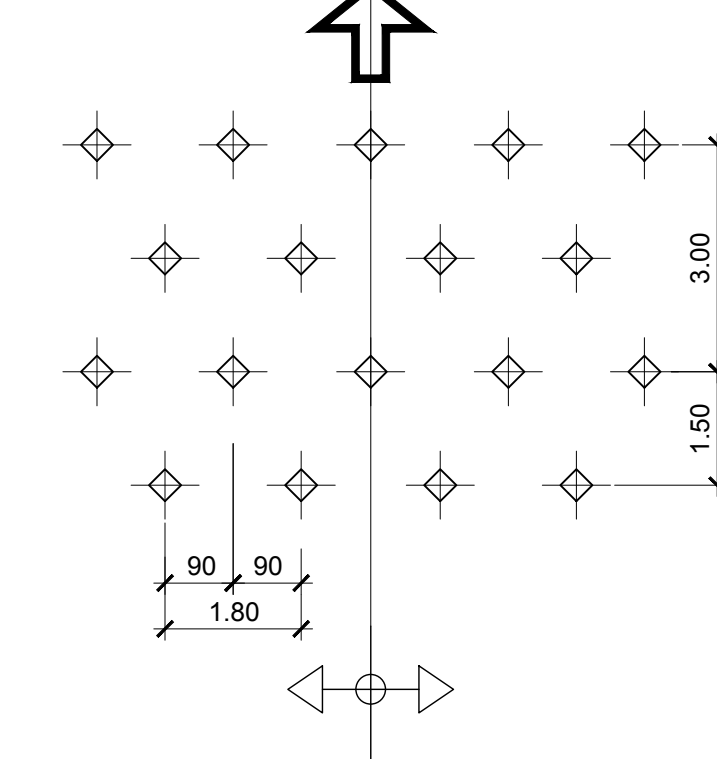

LÄNGSBLAUF / SVILUPPO LONGITUDINALE

(1:50)

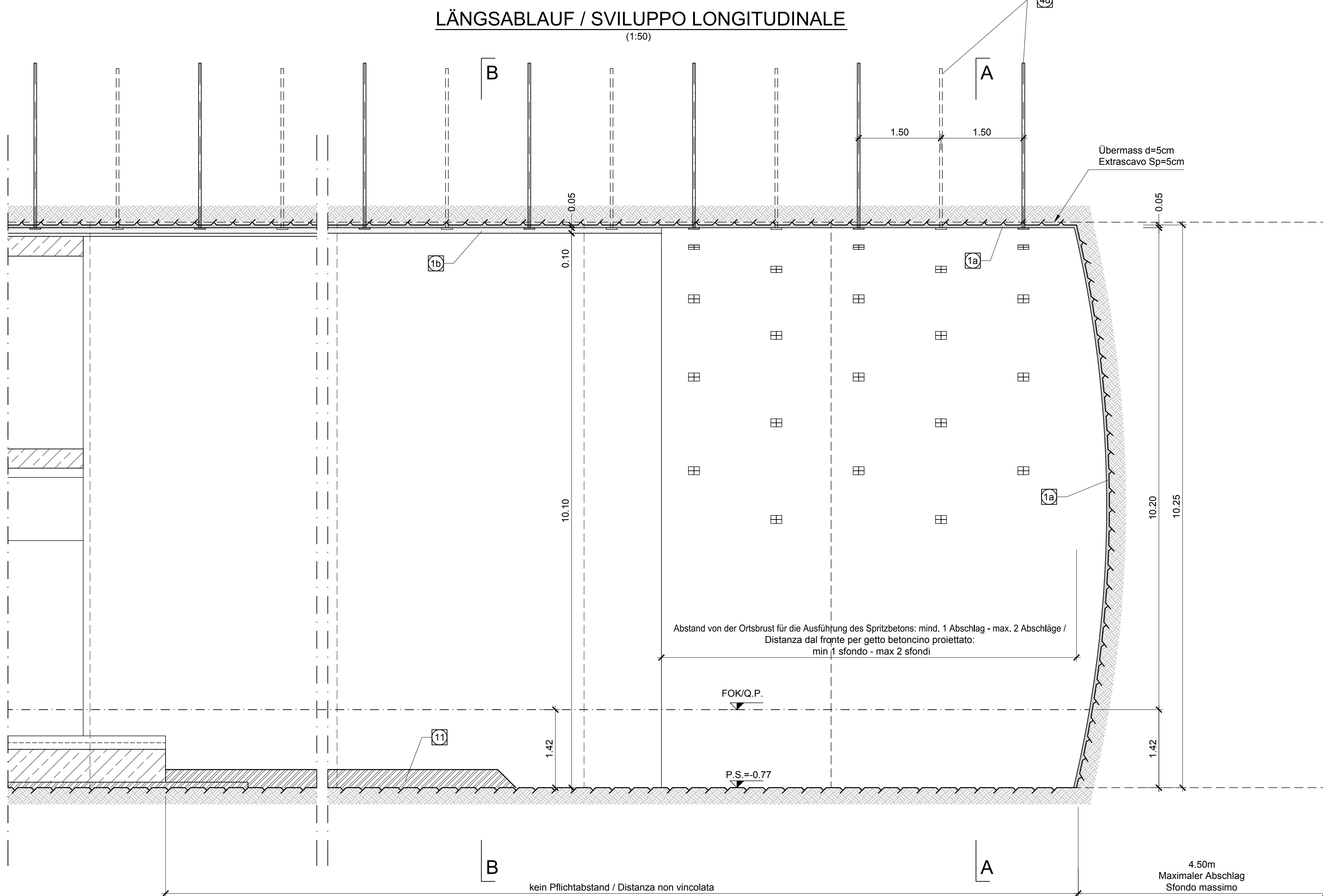

Table with 4 columns: BEMERKUNGEN (Remarks), BAUPHASEN (Construction Phases), MATERIALEIGENSCHAFTEN UND TECHNISCHE SPEZIFIKATIONEN (Material Properties and Technical Specifications), and LEGENDE / LEGENDA (Legend).

Table with 2 columns: NOTE (Notes) and FASI ESECUTIVE (Execution Phases). It details the construction steps from excavation to final lining.

Table with 1 column: ANMERKUNGEN / ANNOTAZIONI (Remarks / Annotations), detailing the SOK/P.F. and FOK/Q.P. levels.

Summary table for the project, showing dimensions, quantities, and material specifications.

M / SCALA 1 : 50

Referenzdokumente / Documenti di riferimento

Table listing reference documents, including technical specifications, design drawings, and construction methods.

Bearbeitungsstand / Stato di elaborazione

Table showing the revision history of the document, including dates and responsible parties.

Project information page for 'BRENNER BASISTUNNEL' and 'GALLERIA DI BASE DEL BRENNERO'. It includes logos for BBT, RTI 4P, and various partners like Pöyry and Pini Swiss.