

## TRASSIERUNG FAHRRADWEG UND KANAL - 1/4 TRACCIAMENTO NUOVA PISTA CICLABILE E CANALE - 1/4

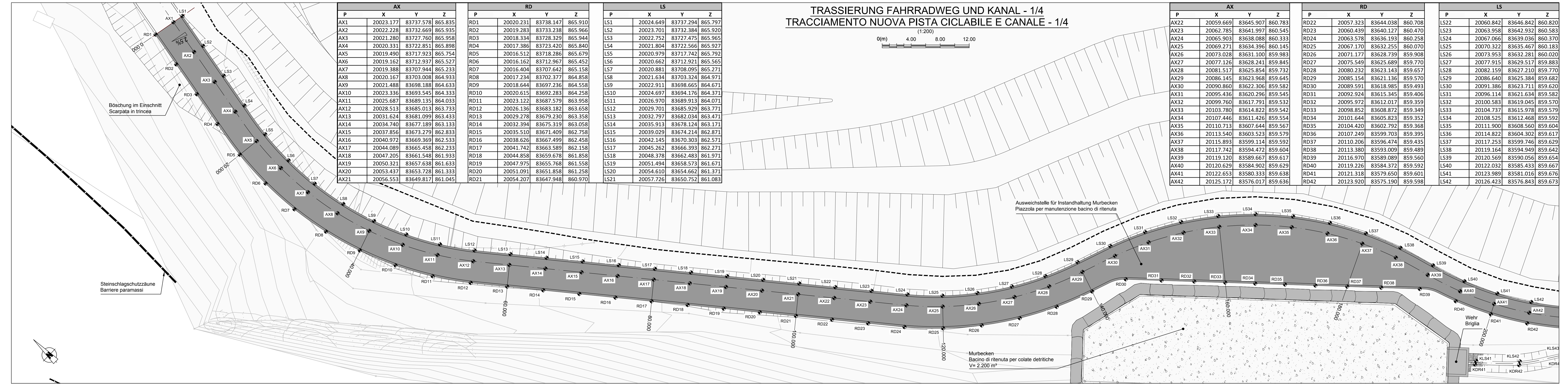

AX				RD				LS			
P	X	Y	Z	P	X	Y	Z	P	X	Y	Z
AX1	20023.177	83737.578	865.835	RD1	20020.231	83738.147	865.910	LS1	20024.649	83645.907	865.797
AX2	20022.228	83732.669	865.935	RD2	20019.283	83733.238	865.966	LS2	20022.701	83733.384	865.920
AX3	20021.280	83727.669	865.958	RD3	20018.334	83728.329	865.944	LS3	20022.574	83638.088	860.333
AX4	20020.331	83722.851	865.988	RD4	20017.386	83723.420	865.840	LS4	20021.804	83722.566	865.927
AX5	20019.490	83717.923	865.754	RD5	20016.512	83718.286	865.679	LS5	20020.979	83717.742	865.792
AX6	20019.162	83712.937	865.527	RD6	20016.162	83712.967	865.452	LS6	20020.662	83712.921	865.656
AX7	20019.388	83707.944	865.233	RD7	20016.404	83707.642	865.158	LS7	20020.881	83708.955	865.271
AX8	20020.167	83703.008	864.933	RD8	20017.234	83702.377	864.858	LS8	20021.634	83703.324	864.971
AX9	20021.488	83698.188	864.633	RD9	20018.644	83697.236	864.558	LS9	20022.911	83698.665	864.671
AX10	20023.336	83693.545	864.333	RD10	20020.615	83692.283	864.258	LS10	20024.697	83694.176	864.371
AX11	20025.687	83689.135	864.033	RD11	20023.127	83687.579	863.958	LS11	20026.970	83689.929	863.771
AX12	20028.513	83685.013	863.733	RD12	20026.136	83683.182	863.658	LS12	20029.701	83685.929	863.771
AX13	20031.624	83681.099	863.433	RD13	20029.278	83679.230	863.359	LS13	20032.797	83682.034	863.471
AX14	20034.740	83677.189	863.133	RD14	20032.394	83675.319	863.059	LS14	20035.913	83678.124	863.171
AX15	20037.856	83673.279	862.833	RD15	20035.510	83671.409	862.759	LS15	20039.029	83674.214	862.871
AX16	20040.972	83669.369	862.533	RD16	20038.626	83667.499	862.459	LS16	20042.145	83670.303	862.571
AX17	20044.089	83665.458	862.233	RD17	20041.742	83663.589	862.159	LS17	20045.262	83666.393	862.271
AX18	20047.205	83661.548	861.933	RD18	20044.858	83659.678	861.858	LS18	20048.378	83662.483	861.971
AX19	20050.321	83657.638	861.633	RD19	20047.975	83655.768	861.558	LS19	20051.494	83658.573	861.671
AX20	20053.437	83653.728	861.333	RD20	20051.091	83651.858	861.258	LS20	20054.610	83654.662	861.371
AX21	20056.553	83649.817	861.045	RD21	20054.207	83647.948	860.970	LS21	20057.726	83650.752	861.083

## TRASSIERUNG FAHRRADWEG UND KANAL - 2/4 TRACCIAMENTO NUOVA PISTA CICLABILE E CANALE - 2/4

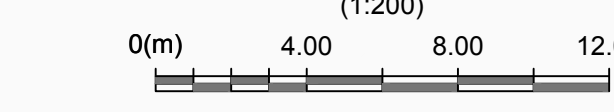
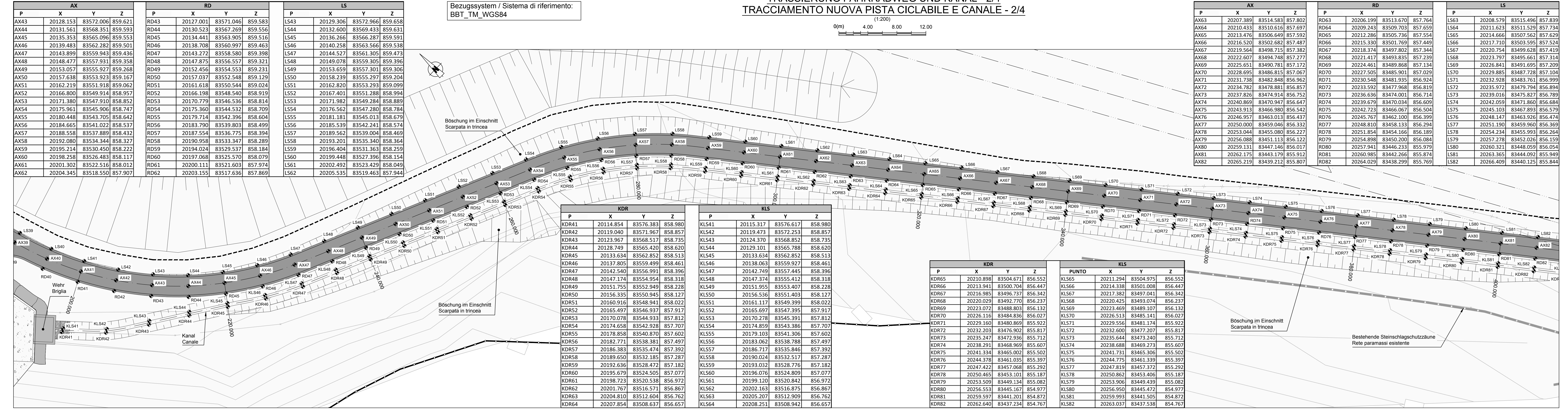
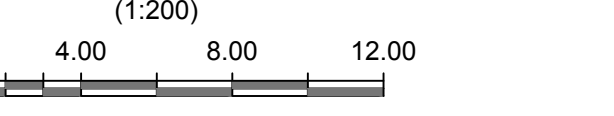

AX				RD				LS			
P	X	Y	Z	P	X	Y	Z	P	X	Y	Z
AX63	20207.389	83514.583	857.802	RD63	20206.199	83513.670	857.764	LS63	20208.579	83515.496	857.839
AX64	20210.433	83510.616	857.697	RD64	20209.243	83509.703	857.659	LS64	20211.623	83511.529	857.734
AX65	20213.476	83506.649	857.592	RD65	20212.286	83505.736	857.554	LS65	20214.666	83507.562	857.629
AX66	20216.520	83502.682	857.487	RD66	20215.330	83501.769	857.449	LS66	20217.710	83503.595	857.524
AX67	20219.564	83498.715	857.382	RD67	20218.374	83497.802	857.344	LS67	20220.754	83499.628	857.419
AX68	20222.607	83494.748	857.277	RD68	20221.417	83493.835	857.239	LS68	20223.797	83495.661	857.314
AX69	20225.651	83490.781	857.172	RD69	20224.461	83489.868	857.134	LS69	20226.841	83491.695	857.209
AX70	20228.695	83486.815	857.067	RD70	20227.505	83485.901	857.029	LS70	20229.885	83487.728	857.104
AX71	20231.738	83482.848	856.962	RD71	20230.548	83481.935	856.924	LS71	20232.928	83483.761	856.999
AX72	20234.782	83478.881	856.857	RD72	20233.592	83477.968	856.819	LS72	20235.972	83479.794	856.894
AX73	20237.826	83474.914	856.752	RD73	20236.636	83474.001	856.714	LS73	20239.016	83475.827	856.789
AX74	20240.869	83470.947	856.647	RD74	20239.679	83470.034	856.609	LS74	20242.059	83471.860	856.684
AX75	20243.913	83466.980	856.542	RD75	20242.723	83466.067	856.504	LS75	20245.103	83467.893	856.579
AX76	20246.957	83463.013	856.437	RD76	20245.767	83462.100	856.399	LS76	20248.147	83463.926	856.474
AX77	20250.000	83459.046	856.332	RD77	20248.810	83458.133	856.294	LS77	20251.190	83459.960	856.369
AX78	20253.044	83455.080	856.227	RD78	20251.854	83454.166	856.189	LS78	20254.234	83455.993	856.264
AX79	20256.088	83451.113	856.122	RD79	20254.898	83450.200	856.084	LS79	20257.278	83452.026	856.159
AX80	20259.131	83447.146	856.017	RD80	20257.941	83446.233	855.979	LS80	20260.321	83448.059	856.054
AX81	20262.175	83443.179	855.912	RD81	20260.985	83442.266	855.874	LS81	20263.365	83444.092	855.949
AX82	20265.219	83439.212	855.807	RD82	20264.029	83438.299	855.769	LS82	20266.409	83440.125	855.844

### SCHLÜSSELPLAN / PIANTA CHIAVE

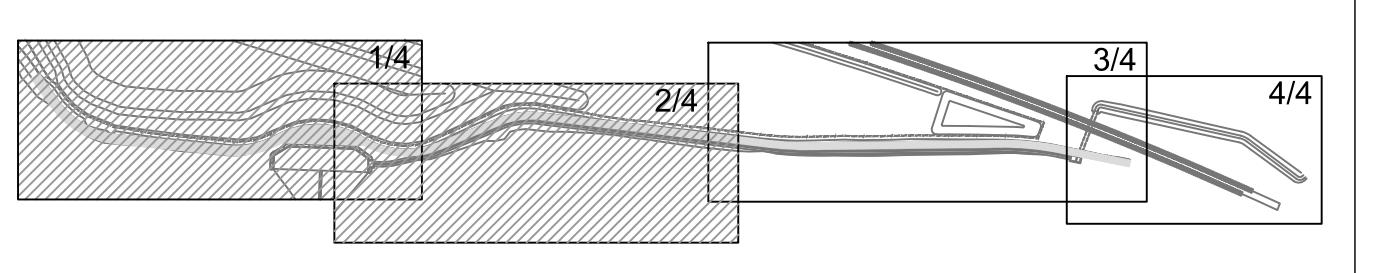

### Referenzdokumente Documenti di riferimento

Referenz / Documento	Contenuto	Descrizione
02_H61_DB_300_KLP_D0700_51100	Übersichtspatial Materialdeponie Genauen 2	Planimetria generale deposito Genauen 2 (Fase 2)
02_H61_ST_410_KDR_D0700_54321	Materialdeponie Genauen 2 Langsprofil neuer Fahrradweg	Deposito Genauen 2 Profilo longitudinale nuova pista ciclabile
02_H61_ST_410_KRP_D0700_54322	Materialdeponie Genauen 2 Regelprofil neuer Fahrradweg	Deposito Genauen 2 Sezioni tipo nuova pista ciclabile
02_H61_ST_410_KRQ_D0700_54323	Materialdeponie Genauen 2 Querschnitte Fahrradweg und Kanal	Deposito Genauen 2 Sezioni trasversali nuova pista ciclabile e canale
02_H61_DB_300_KTB_D0700_51015	Technischer Bericht Materialdeponien	Relazione sui depositi di materiale
02_H61_BS_410_KLP_D0700_54135	Lageplan Zufahrtsstrasse Baustelle Genauen 2	Planimetria strada di accesso cantiere Genauen 2

### Bearbeitungsstand Stato di elaborazione

Revision / Revisione	Änderungen / Modifiche	Verantwortlicher / Responsabile	Datum / Data
20	Überarbeitung infolge Dienstveränderung vom 17.10.2014 / Revisione a seguito ODS n°1 del 17.10.14	Merini	04.12.2014
21	Abgabe für Ausschreibung / Emission per Appalto	Merini	30.01.2015

**Ausbau Eisenbahnstrecke München-Vercelli**  
**BRENNER BASISTUNNEL**  
Ausführungsplanung

Potenziamento asse ferroviario Monaco - Verona  
**GALLERIA DI BASE DEL BRENNERO**  
Progettazione esecutiva

RT4P Engineering

D0700: Baufeld Maulf 2-3  
D0700: Lotta Molis 2-3

Projektleiter / Direttore dei lavori	WBS
Baustelleneinrichtung - Baustelle Genauen 2	Cantierizzazione - Cantiere Genauen 2
Dokumentation	Tipo documento
Lageplan	Planimetria
Titel	Titolo
Materialdeponie Genauen 2: Trassierung Fahrradweg und Kanal (Blatt 1/2)	Deposito Genauen 2: Tracciam. nuova pista ciclabile e canale (Tav. 1/2)

Generale / Responsabile integrazione prestazioni gestionale  
Ing. Enrico Maria Pizzarotti  
Cod. Imp. M61 N° 2014

Mandatario / Committente	Mandante / Progettista	Mandante / Progettista	Mandante / Progettista
PTERO	POYRY	pin swiss engineers	PRODIGIO/ROBBA
Facultante / progettista specialistico	Facultante / progettista specialistico	Facultante / progettista specialistico	Facultante / progettista specialistico

Bearbeitet / Elaborato	Datum / Data	Name / Nome	Gesellschaft / Società
Geprüft / Verificato	30.01.2015	Merini / Gianfranco	Pin Swiss
		Merini / Gianfranco	Pin Swiss

Projekt / Progetto  
Charakter / Carattere: ST  
Umfang / Estensione: H61

Rev.-Muster / Serie: ST  
Umfang / Estensione: H61

Status / Stato: P02

Dokumentation / Documentazione: KLP  
Titolo / Titolo: D0700

Blatt / Foglio: 54326  
Blattanzahl / Numero Fogli: 21

Name / Nome: R. Zurlo  
Name / Nome: K. Bergmeister