

TRIESTE

VENEZIA

PROVINCIA DI UDINE COMUNE DI S. CANZIAN D'ISONZO	PROVINCIA DI UDINE COMUNE DI TURRACO	PROVINCIA DI UDINE COMUNE DI FIUMICELLO	PROVINCIA DI UDINE COMUNE DI RUDA	PROVINCIA DI UDINE COMUNE DI S. CANZIAN D'ISONZO
835,56 -0,47 -0,00000	1147,00 -0,00 -0,00000	124,486 0,00000	60,17 0,00000	835,56 -0,47 -0,00000

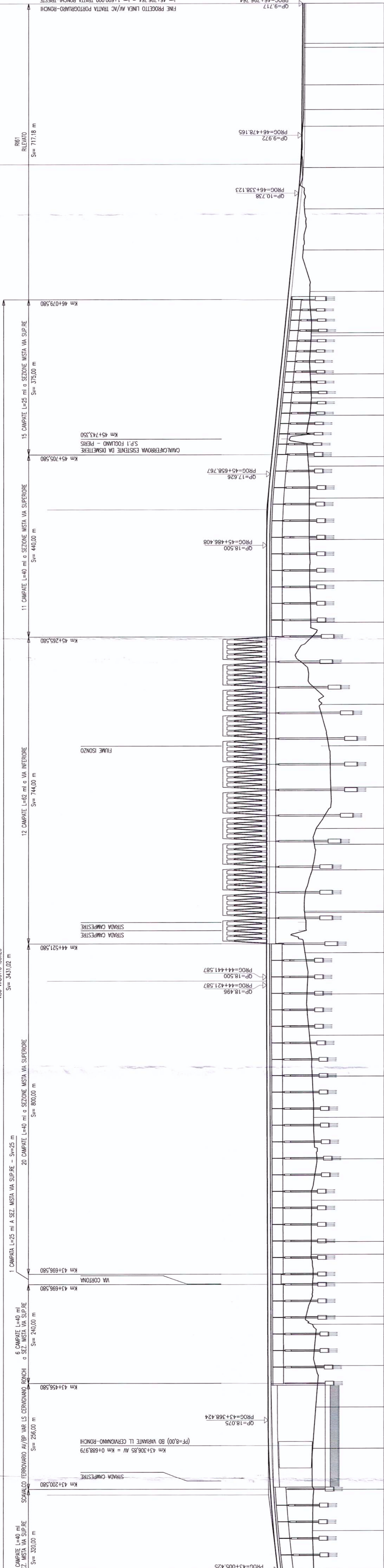

PROGRESSIVE	QUOTE TERRENO	ETOMETRICHE	DIST. PARZIALI	VELOCITA' DI PROGETTO
43+000,00	15,668	430	1,000	250
43+100,00	7,298	517	1,000	250
43+200,00	6,970	627	1,000	250
43+300,00	7,205	737	1,000	250
43+400,00	1,989	847	1,000	250
43+500,00	1,879	957	1,000	250
43+600,00	1,817	1,067	1,000	250
43+700,00	1,969	1,177	1,000	250
43+800,00	6,442	1,287	1,000	250
43+900,00	7,907	1,397	1,000	250
44+000,00	1,850	1,507	1,000	250
44+100,00	1,850	1,617	1,000	250
44+200,00	1,850	1,727	1,000	250
44+300,00	1,850	1,837	1,000	250
44+400,00	1,850	1,947	1,000	250
44+500,00	1,850	2,057	1,000	250
44+600,00	1,850	2,167	1,000	250
44+700,00	1,850	2,277	1,000	250
44+800,00	1,850	2,387	1,000	250
44+900,00	1,850	2,497	1,000	250
45+000,00	1,850	2,607	1,000	250
45+100,00	1,850	2,717	1,000	250
45+200,00	1,850	2,827	1,000	250
45+300,00	1,850	2,937	1,000	250
45+400,00	1,850	3,047	1,000	250
45+500,00	1,850	3,157	1,000	250
45+600,00	1,850	3,267	1,000	250
45+700,00	1,850	3,377	1,000	250
45+800,00	1,850	3,487	1,000	250
45+900,00	1,850	3,597	1,000	250
46+000,00	1,850	3,707	1,000	250
46+100,00	1,850	3,817	1,000	250
46+200,00	1,850	3,927	1,000	250
46+300,00	1,850	4,037	1,000	250
46+400,00	1,850	4,147	1,000	250
46+500,00	1,850	4,257	1,000	250
46+600,00	1,850	4,367	1,000	250
46+700,00	1,850	4,477	1,000	250
46+800,00	1,850	4,587	1,000	250
46+900,00	1,850	4,697	1,000	250
47+000,00	1,850	4,807	1,000	250
47+100,00	1,850	4,917	1,000	250
47+200,00	1,850	5,027	1,000	250
47+300,00	1,850	5,137	1,000	250
47+400,00	1,850	5,247	1,000	250
47+500,00	1,850	5,357	1,000	250
47+600,00	1,850	5,467	1,000	250
47+700,00	1,850	5,577	1,000	250
47+800,00	1,850	5,687	1,000	250
47+900,00	1,850	5,797	1,000	250
48+000,00	1,850	5,907	1,000	250
48+100,00	1,850	6,017	1,000	250
48+200,00	1,850	6,127	1,000	250
48+300,00	1,850	6,237	1,000	250
48+400,00	1,850	6,347	1,000	250
48+500,00	1,850	6,457	1,000	250
48+600,00	1,850	6,567	1,000	250
48+700,00	1,850	6,677	1,000	250
48+800,00	1,850	6,787	1,000	250
48+900,00	1,850	6,897	1,000	250
49+000,00	1,850	7,007	1,000	250
49+100,00	1,850	7,117	1,000	250
49+200,00	1,850	7,227	1,000	250
49+300,00	1,850	7,337	1,000	250
49+400,00	1,850	7,447	1,000	250
49+500,00	1,850	7,557	1,000	250
49+600,00	1,850	7,667	1,000	250
49+700,00	1,850	7,777	1,000	250
49+800,00	1,850	7,887	1,000	250
49+900,00	1,850	7,997	1,000	250
50+000,00	1,850	8,107	1,000	250
50+100,00	1,850	8,217	1,000	250
50+200,00	1,850	8,327	1,000	250
50+300,00	1,850	8,437	1,000	250
50+400,00	1,850	8,547	1,000	250
50+500,00	1,850	8,657	1,000	250
50+600,00	1,850	8,767	1,000	250
50+700,00	1,850	8,877	1,000	250
50+800,00	1,850	8,987	1,000	250
50+900,00	1,850	9,097	1,000	250
51+000,00	1,850	9,207	1,000	250
51+100,00	1,850	9,317	1,000	250
51+200,00	1,850	9,427	1,000	250
51+300,00	1,850	9,537	1,000	250
51+400,00	1,850	9,647	1,000	250
51+500,00	1,850	9,757	1,000	250
51+600,00	1,850	9,867	1,000	250
51+700,00	1,850	9,977	1,000	250
51+800,00	1,850	10,087	1,000	250
51+900,00	1,850	10,197	1,000	250
52+000,00	1,850	10,307	1,000	250
52+100,00	1,850	10,417	1,000	250
52+200,00	1,850	10,527	1,000	250
52+300,00	1,850	10,637	1,000	250
52+400,00	1,850	10,747	1,000	250
52+500,00	1,850	10,857	1,000	250
52+600,00	1,850	10,967	1,000	250
52+700,00	1,850	11,077	1,000	250
52+800,00	1,850	11,187	1,000	250
52+900,00	1,850	11,297	1,000	250
53+000,00	1,850	11,407	1,000	250
53+100,00	1,850	11,517	1,000	250
53+200,00	1,850	11,627	1,000	250
53+300,00	1,850	11,737	1,000	250
53+400,00	1,850	11,847	1,000	250
53+500,00	1,850	11,957	1,000	250
53+600,00	1,850	12,067	1,000	250
53+700,00	1,850	12,177	1,000	250
53+800,00	1,850	12,287	1,000	250
53+900,00	1,850	12,397	1,000	250
54+000,00	1,850	12,507	1,000	250
54+100,00	1,850	12,617	1,000	250
54+200,00	1,850	12,727	1,000	250
54+300,00	1,850	12,837	1,000	250
54+400,00	1,850	12,947	1,000	250
54+500,00	1,850	13,057	1,000	250
54+600,00	1,850	13,167	1,000	250
54+700,00	1,850	13,277	1,000	250
54+800,00	1,850	13,387	1,000	250
54+900,00	1,850	13,497	1,000	250
55+000,00	1,850	13,607	1,000	250
55+100,00	1,850	13,717	1,000	250
55+200,00	1,850	13,827	1,000	250
55+300,00	1,850	13,937	1,000	250
55+400,00	1,850	14,047	1,000	250
55+500,00	1,850	14,157	1,000	250
55+600,00	1,850	14,267	1,000	250
55+700,00	1,850	14,377	1,000	250
55+800,00	1,850	14,487	1,000	250
55+900,00	1,850	14,597	1,000	250
56+000,00	1,850	14,707	1,000	250
56+100,00	1,850	14,817	1,000	250
56+200,00	1,850	14,927	1,000	250
56+300,00	1,850	15,037	1,000	250
56+400,00	1,850	15,147	1,000	250
56+500,00	1,850	15,257	1,000	250
56+600,00	1,850	15,367	1,000	250
56+700,00	1,850	15,477	1,000	250
56+800,00	1,850	15,587	1,000	250
56+900,00	1,850	15,697	1,000	250
57+000,00	1,850	15,807	1,000	250
57+100,00	1,850	15,917	1,000	250
57+200,00	1,850	16,027	1,000	250
57+300,00	1,850	16,137	1,000	250
57+400,00	1,850	16,247	1,000	250
57+500,00	1,850	16,357	1,000	250
57+600,00	1,850	16,467	1,000	250
57+700,00	1,850	16,577	1,000	250
57+800,00	1,850	16,687	1,000	250
57+900,00	1,850	16,797	1,000	250
58+000,00	1,850	16,907	1,000	250
58+100,00	1,850	17,017	1,000	250
58+200,00	1,850	17,127	1,000	250
58+300,00	1,850	17,237	1,000	250
58+400,00	1,850	17,347	1,000	250
58+500,00	1,850	17,457	1,000	250
58+600,00	1,850	17,567	1,000	250
58+700,00	1,850	17,677	1,000	250
58+800,00	1,850	17,787	1,000	250
58+900,00	1,850	17,897	1,000	250
59+000,00	1,850	18,007	1,000	250
59+100,00	1,850	18,117	1,000	250
59+200,00	1,850	18,227	1,000	250
59+300,00	1,850	18,337	1,000	250
59+400,00	1,850	18,447	1,000	250
59+500,00	1,850	18,557	1,000	250
59+600,00	1,850	18,667	1,000	250
59+700,00	1,850	18,777	1,000	250
59+800,00	1,850	18,887	1,000	250
59+900,00	1,850	18,997	1,000	250
60+000,00	1,850	19,107	1,000	250
60+100,00	1,850	19,217	1,000	250
60+200,00	1,850	19,327	1,000	250
60+300,00	1,850	19,437	1,000	250
60+400,00	1,850	19,547	1,000	250
60+500,00	1,850	19,657	1,000	250
60+600,00	1,850	19,767	1,000	250
60+700,00	1,850	19,877	1,000	250
60+800,00	1,850	19,987	1,000	250
60+900,00	1,850	20,097	1,000	250
61+000,00	1,850	20,207	1,000	250
61+100,00	1,850	20,317	1,000	250
61+200,00	1,850	20,427	1,000	250
61+300,00	1,850	20,537	1,000	250
61+400,00	1,850	20,647	1,000	250
61+500,00	1,850	20,757	1,000	250
61+600,00	1,850	20,867	1,000	250
61+700,00	1,850	20,977	1,000	250
61+800,00	1,850	21,087	1,000	250
61+900,00	1,850	21,197	1,000	250
62+000,00	1,850	21,307	1,000	250
62+100,00	1,850	21,417	1,000	250
62+200,00	1,850	21,527	1,000	250
62+300,00	1,850	21,637	1,000	250
62+400,00	1,850	21,747	1,000	250
62+500,00	1,850	21,857	1,000	250
62+600,00	1,850	21,967	1,000	250
62+700,00	1,850	22,077	1,000	250
62+800,00	1,850	22,187	1,000	250
62+900,00	1,850	22,297	1,000	250
63+000,00	1,850	22,407	1,000	250
63+100,00	1,850	22,517	1,000	250
63+200,00	1,850	22,627	1,000	250
63+300,00	1,850	22,737	1,000	250
63+400,00	1,850	22,847	1,000	250
63+500,00	1,850	22,9		