

Stralcio planimetrico scala 1:1000

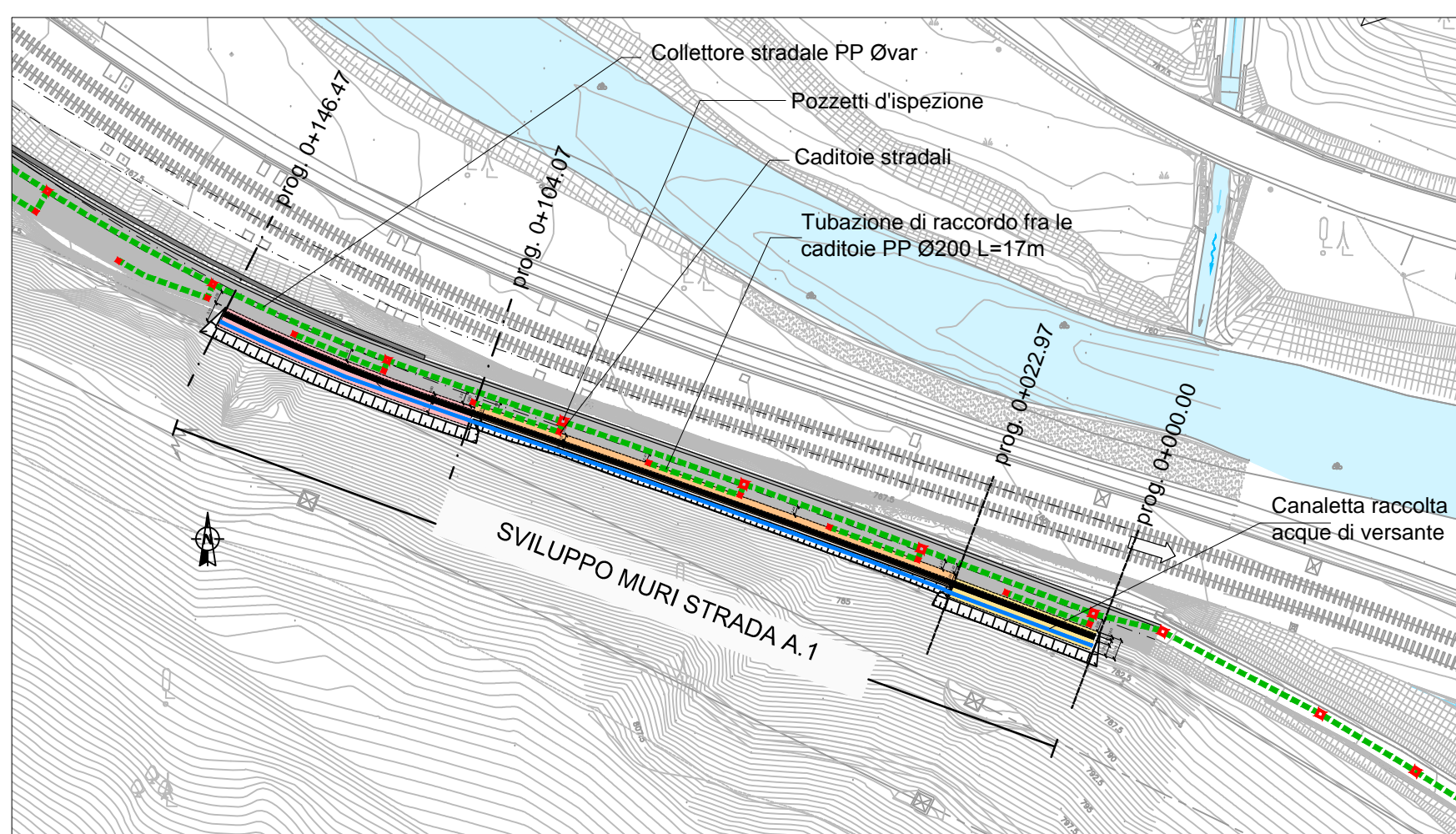

Da prog. 0+ 0.000 a prog. 0+022.97;
da 0+104.07 a prog. 0+146.47

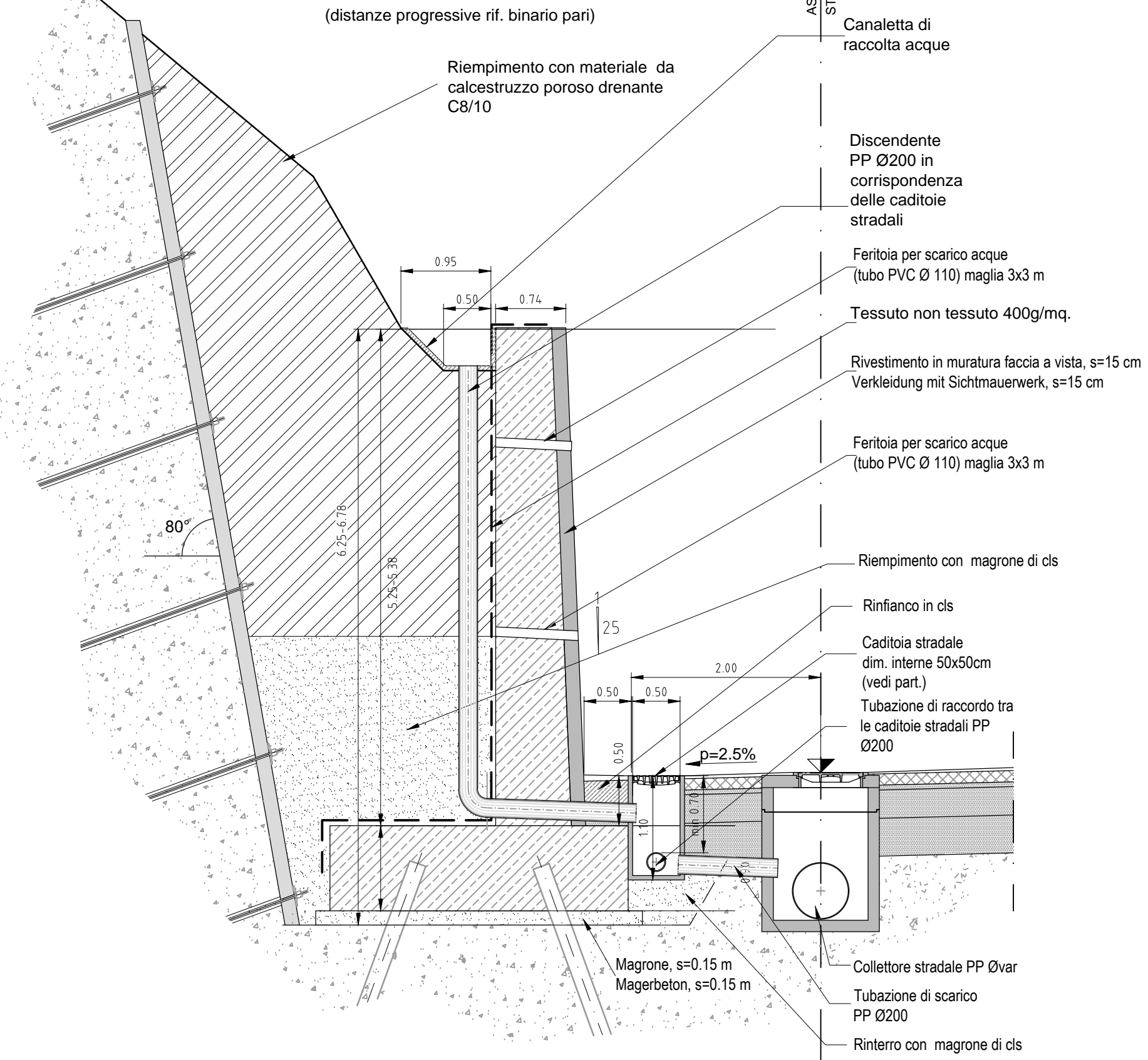

Da prog. 0+022.97 a prog. 0+104.07
(distanze progressive rif. binario pari)

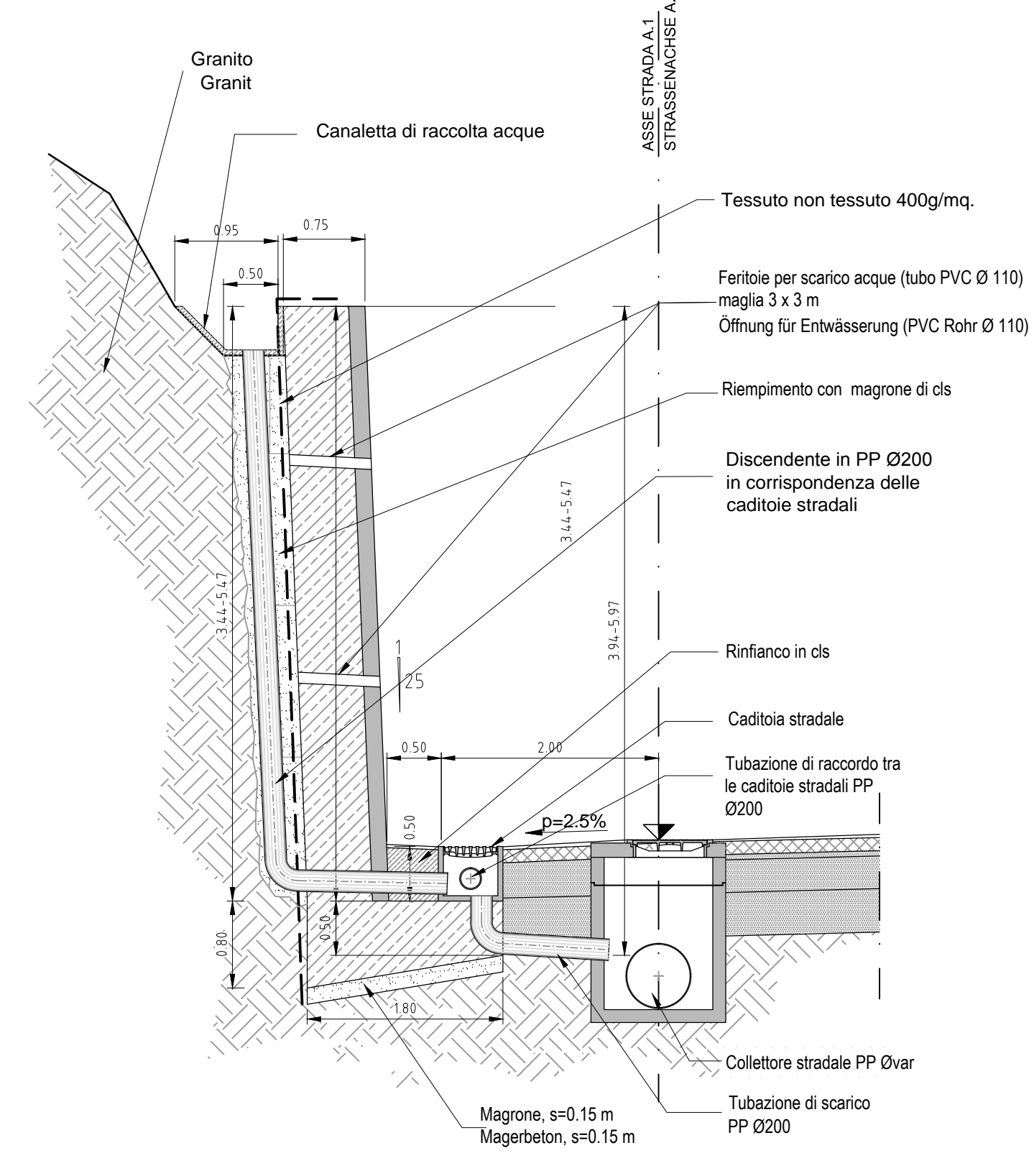

FOSSO DISPONENTE
VERSICKERUNGSMULDE

scala / Masstab 1:10

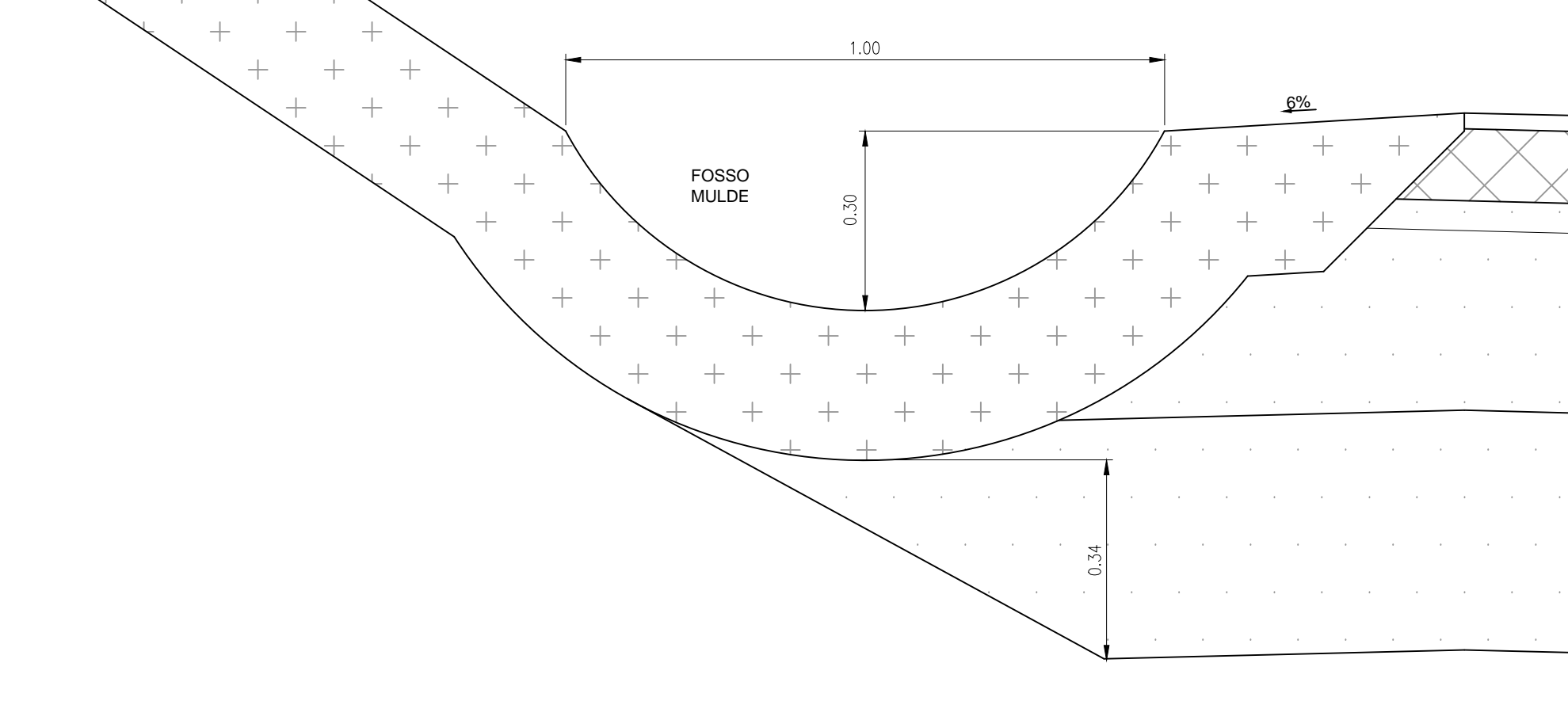

CADITOIA RAMPE E SOTTOPASSO FERROVIARIO (TIPO C2)
STRASSENEINLAUF RAMPEN UND EISENBHUNTERFÜHRUNG (TYP C2)

scala / Masstab 1:10

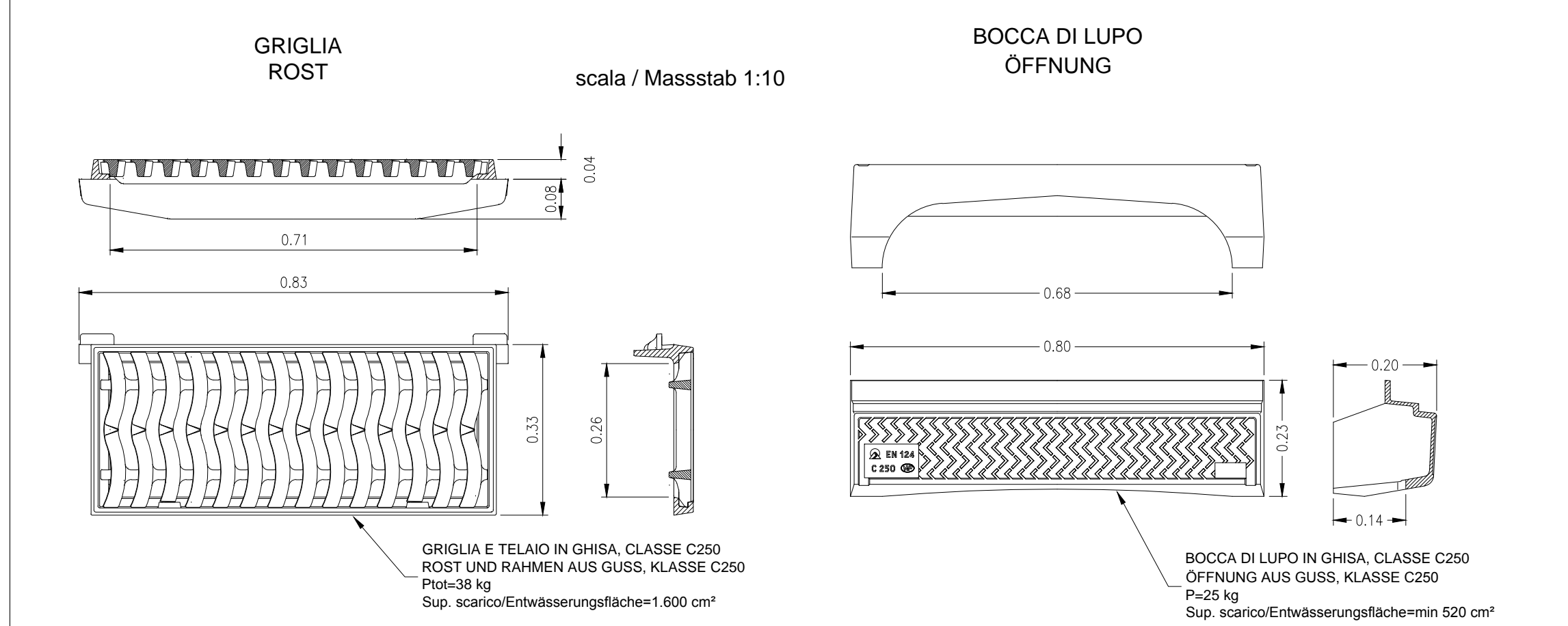
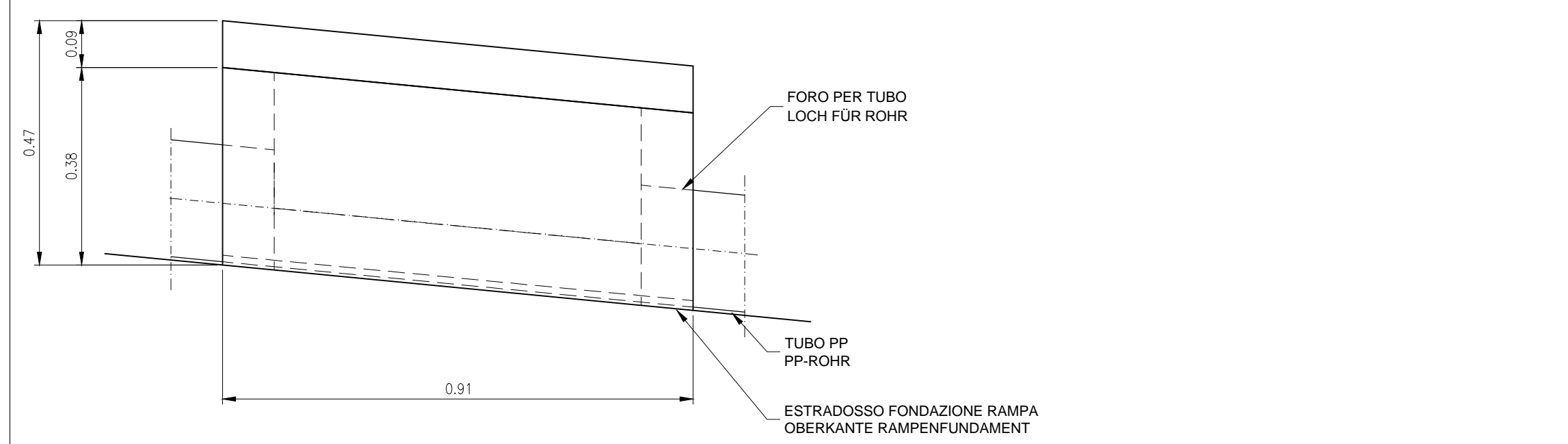
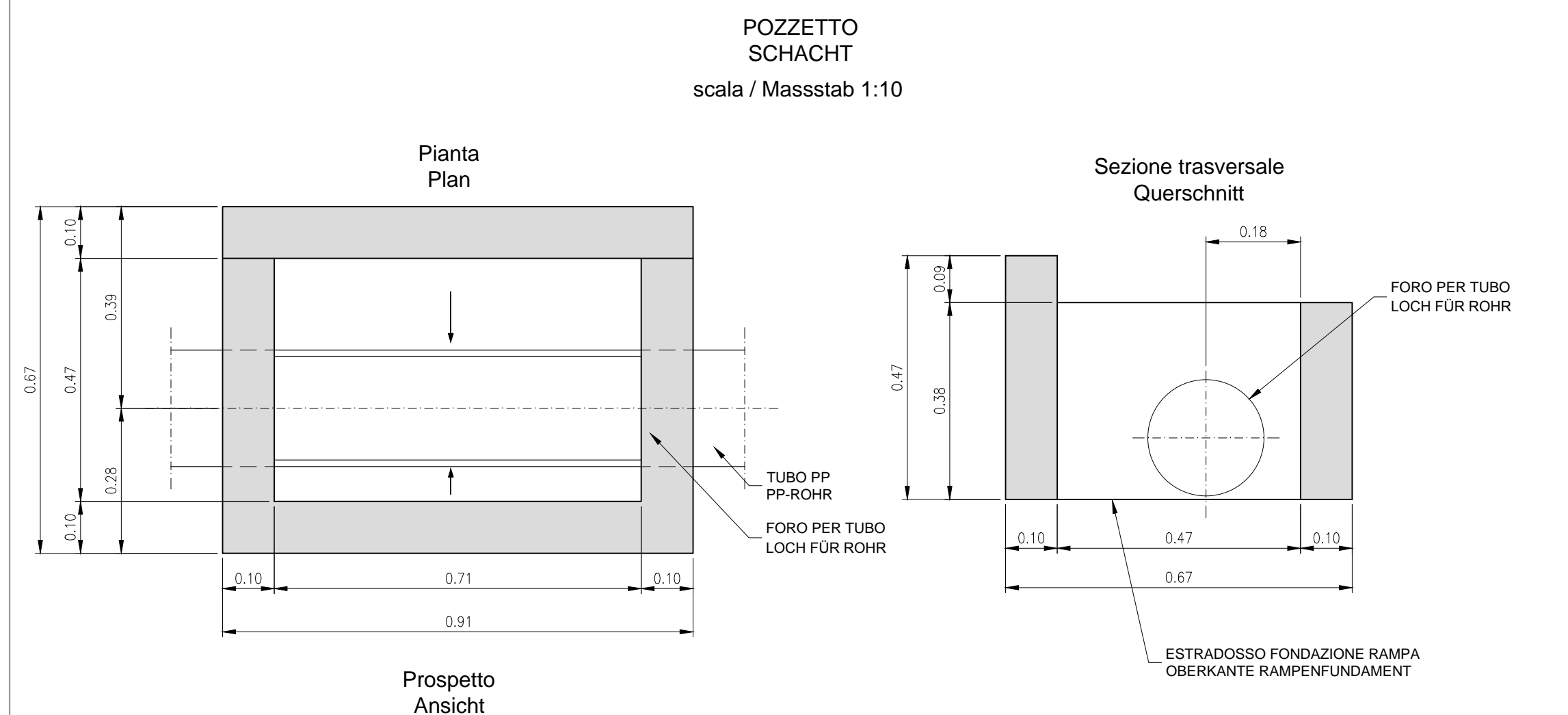
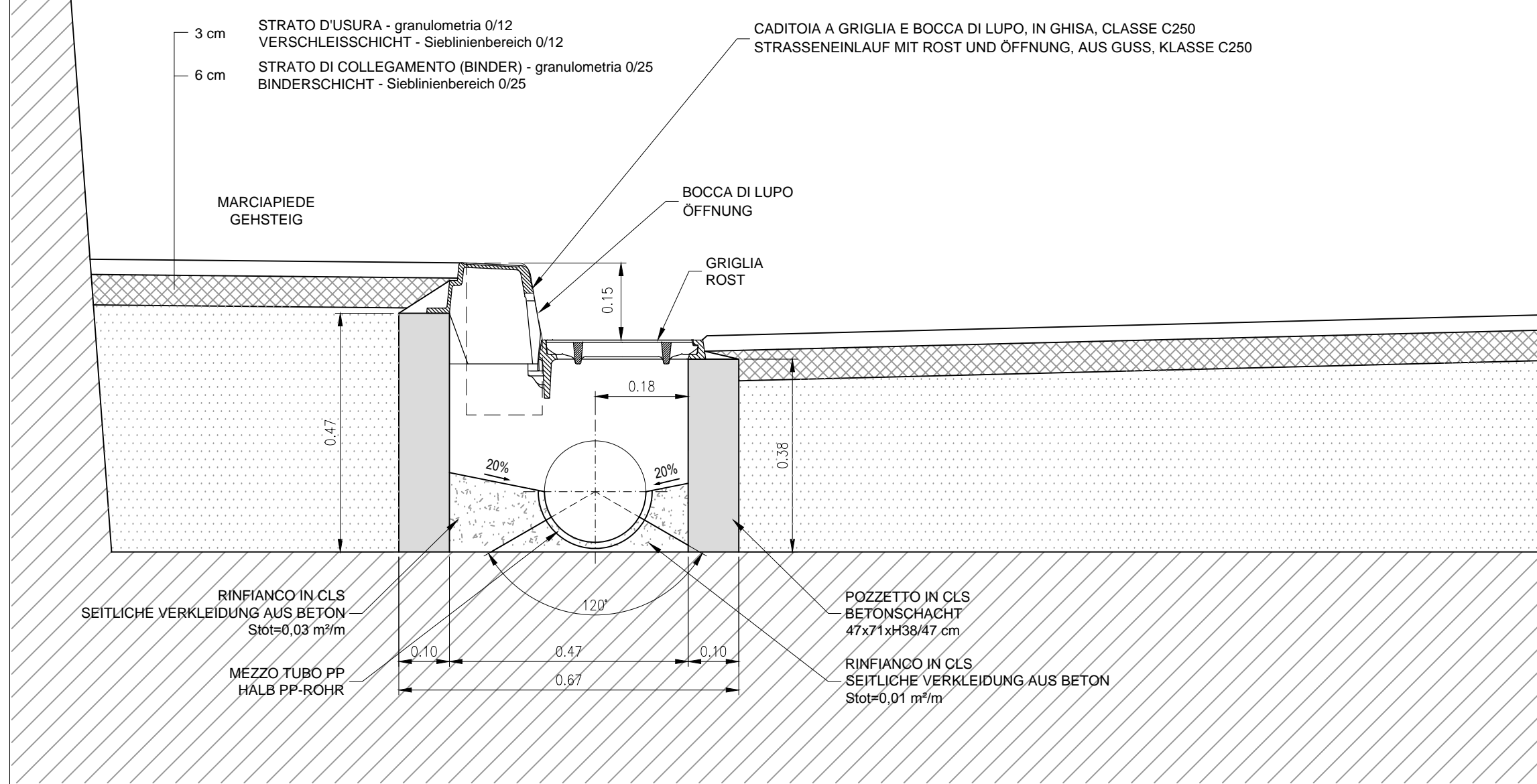

PARTICOLARE SCARICO DEL COLLETTORE R3 NEL FIUME ISARCO

Sezione A-A scala 1:100

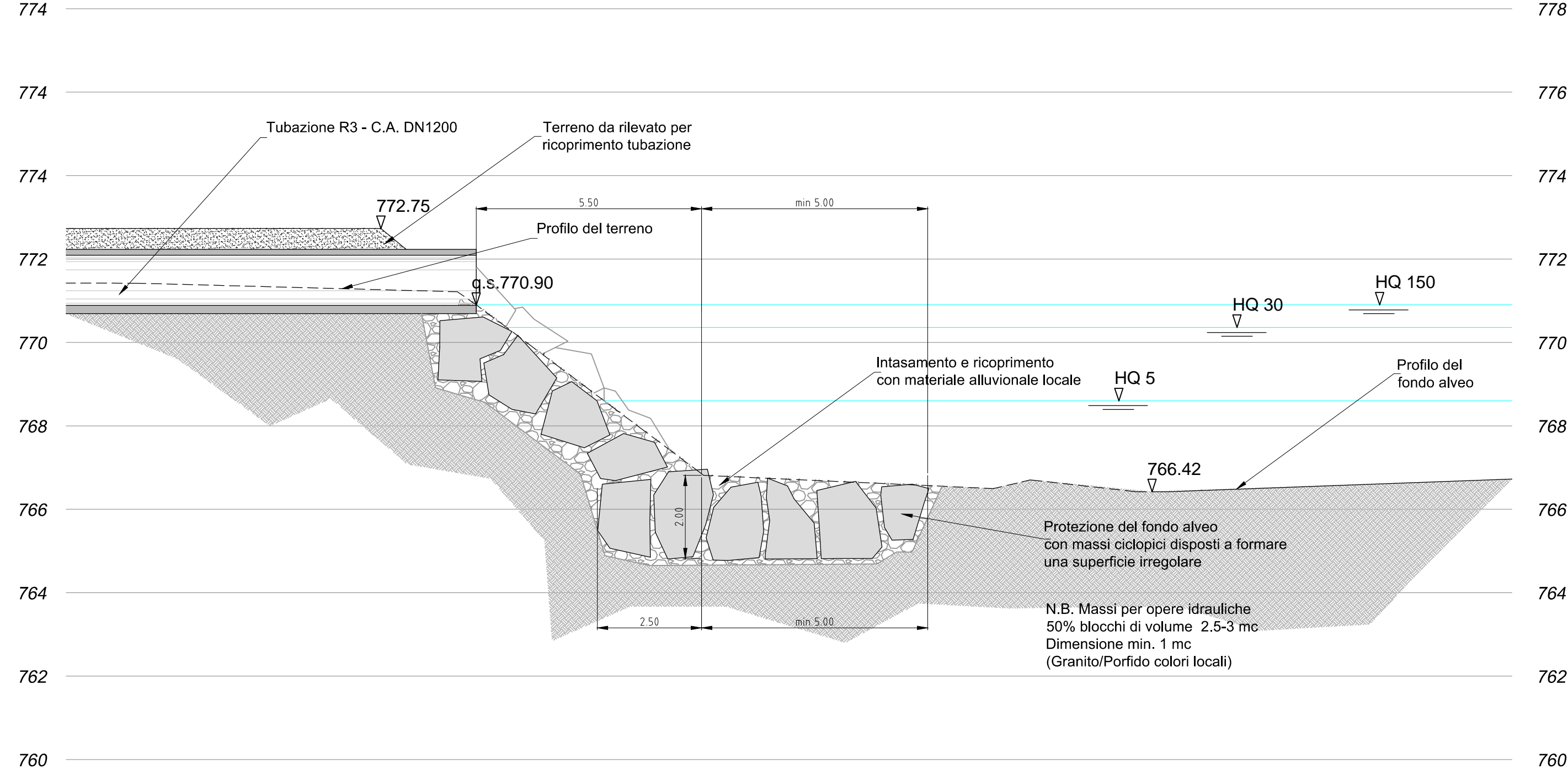

CUNETTE LUNGO FERROVIA
MULDEN ENTLANG BAHNSTRECKE

scala / Masstab 1:10

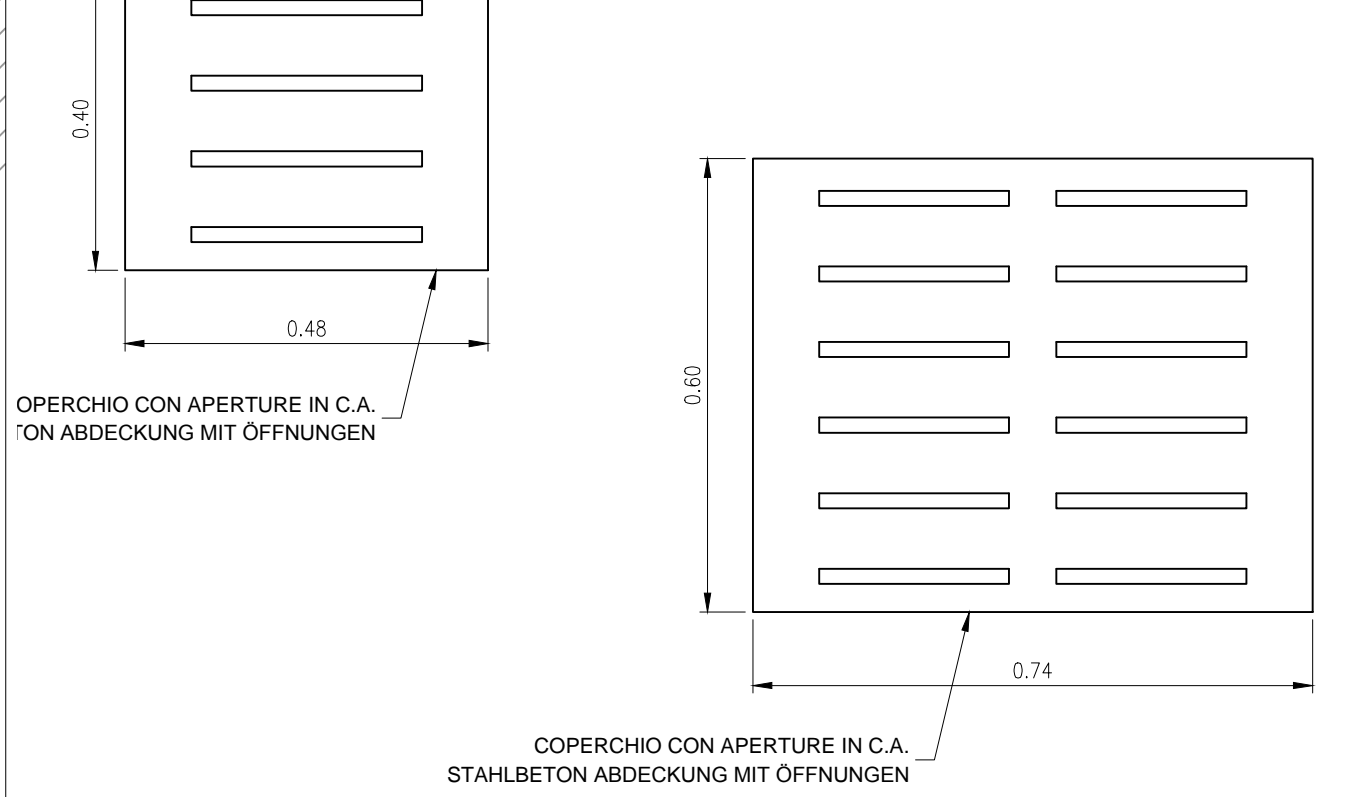
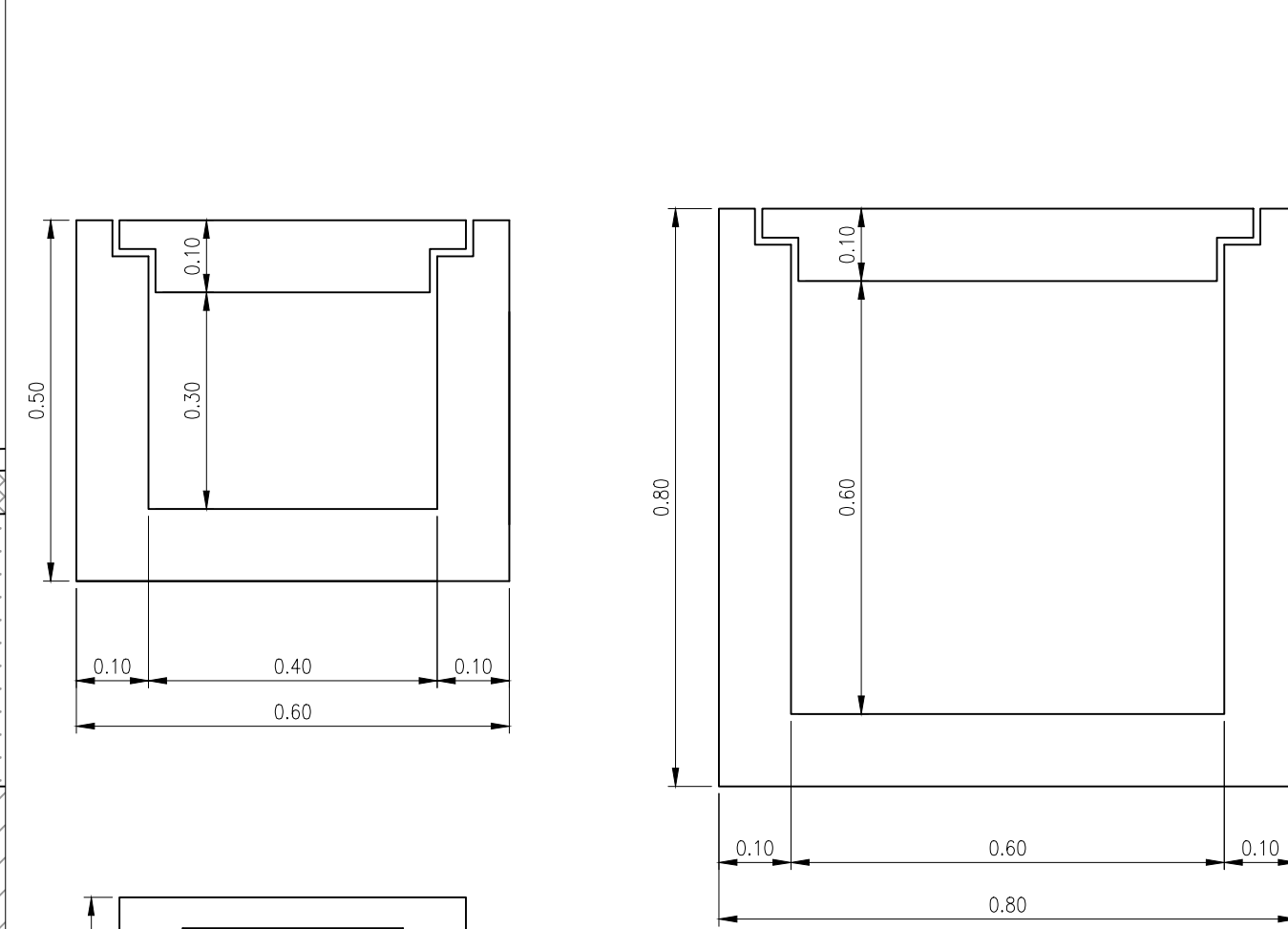

POZZETTO PREFABBRICATO IN C.A. 100x100cm,
120x150cm E 200x200cm (TIPO B, C, F)
VORGEFERTIGTER STAHLBETONSCHACHT
100x100cm, 120x150cm UND 200x200cm (TYP B, C, F)

Scala / Masstab 1:10

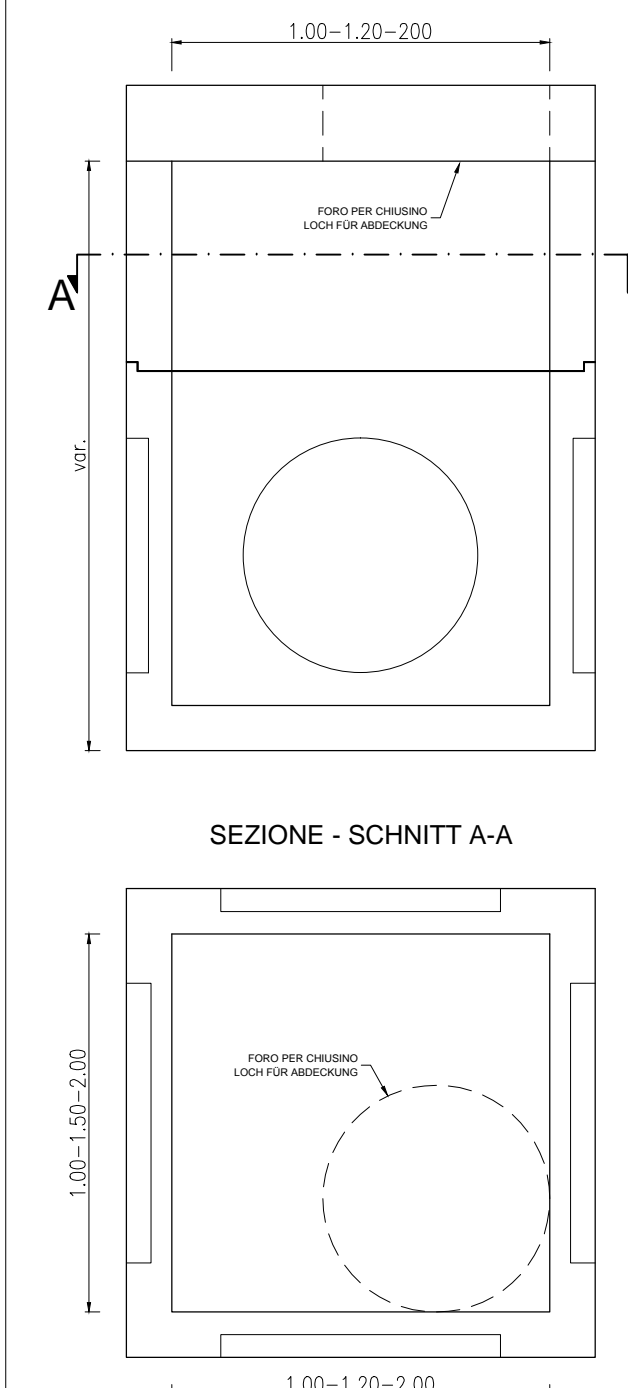

CHIUSINO IN GHISA Ø 600 mm CLASSE
D400 / SCHACHTABDECKUNG AUS
GUSS Ø 600 mm KLASSE D400

Scala / Masstab 1:10

SEZIONE - SCHNITT B-B

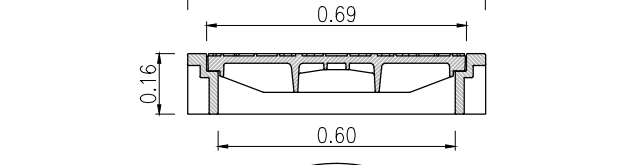

CHIUSINO Ø 80x80 cm
ABDECKUNG 80x80 cm

Scala / Masstab 1:10

SEZIONE - SCHNITT A-A



FOSSO DI GUARDIA TRAPEZOIDALE LUNGO FERROVIA
TRAPEZFÖRMIGER GRABEN ENTLANG BAHNSTRECKE

scala / Masstab 1:10

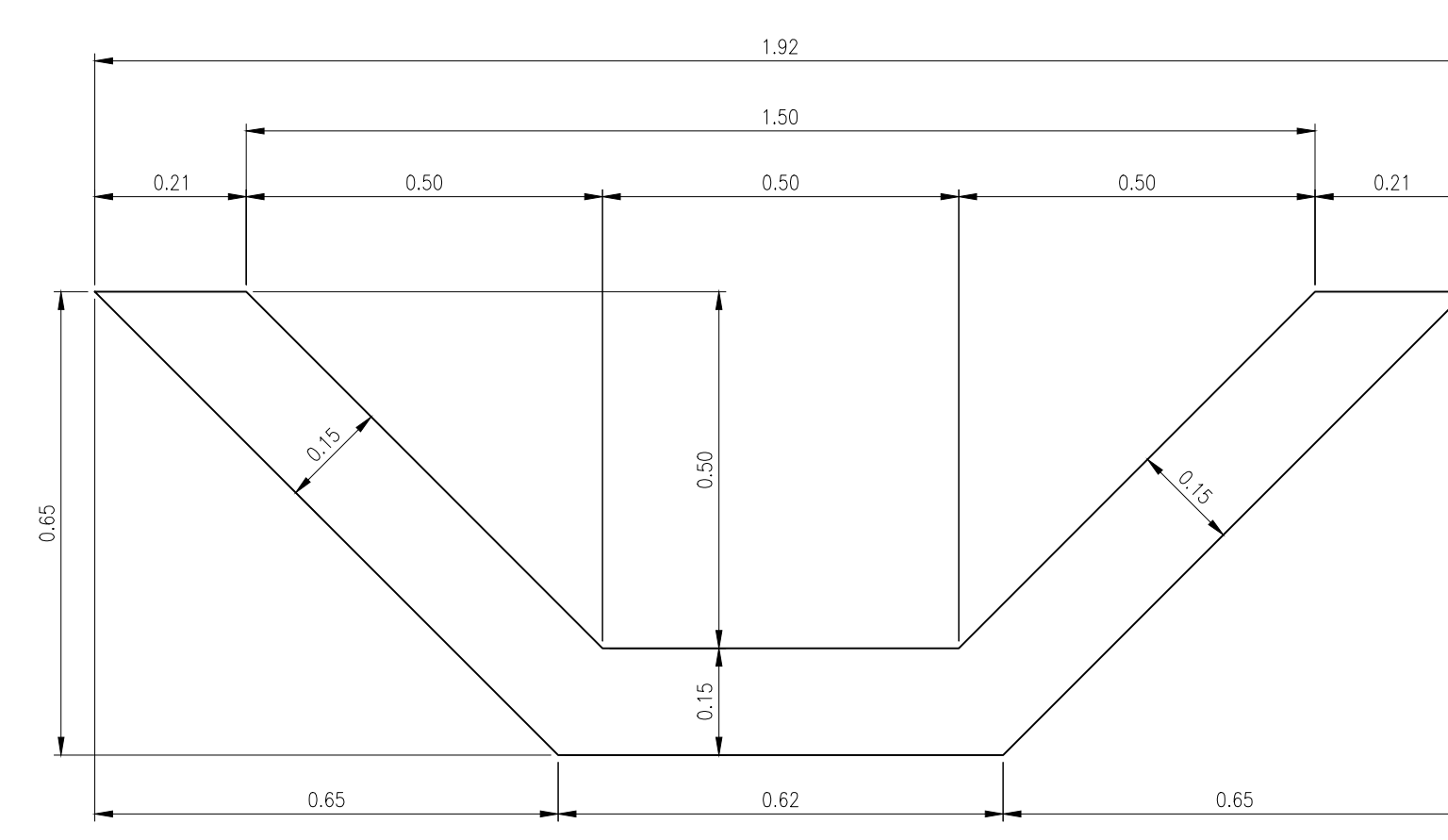

FOSSO RIVESTITO IN PIETREME
CEMENTATO

scala / Masstab 1:20

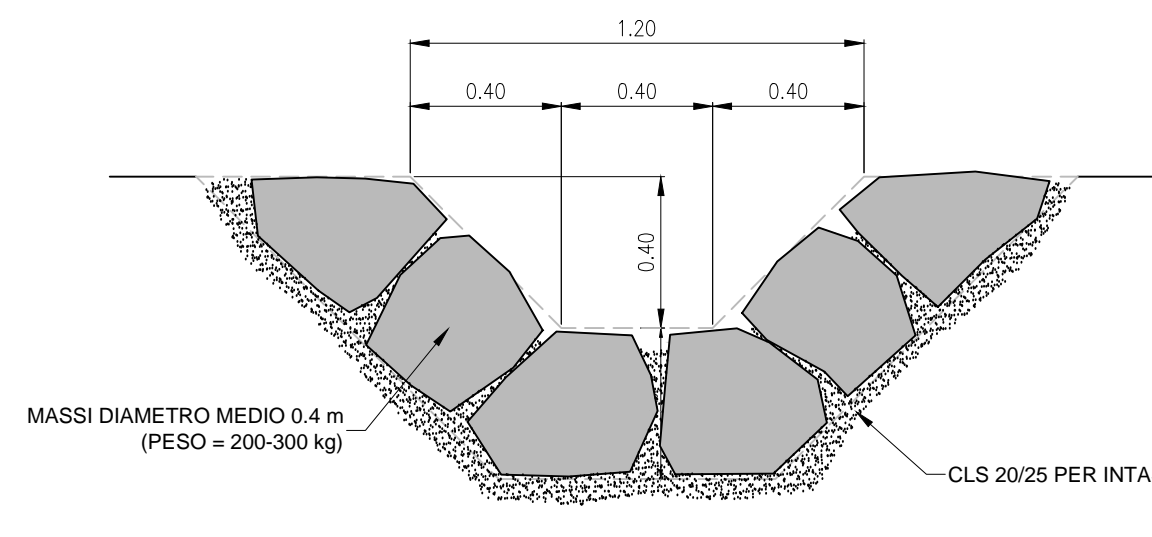

POZZETTO PREFABBRICATO IN C.A. 80x80 cm (TIPO E) /
VORGEFERTIGTER STAHLBETONSCHACHT 80x80 cm
(TYP E)

Scala / Masstab 1:20

CHIUSINO 80x80 cm
ABDECKUNG 80x80 cm

Scala / Masstab 1:20

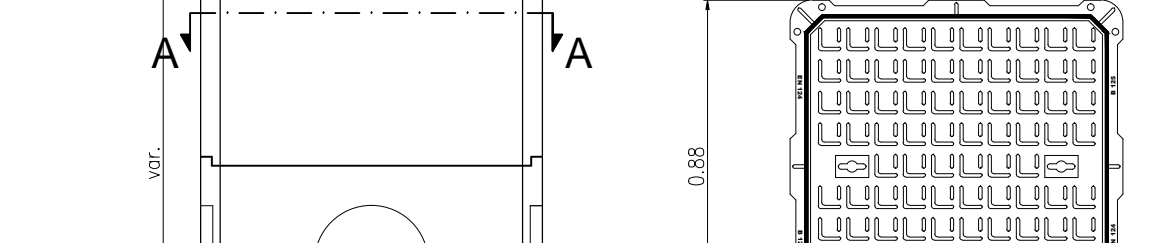

SEZIONE - SCHNITT A-A

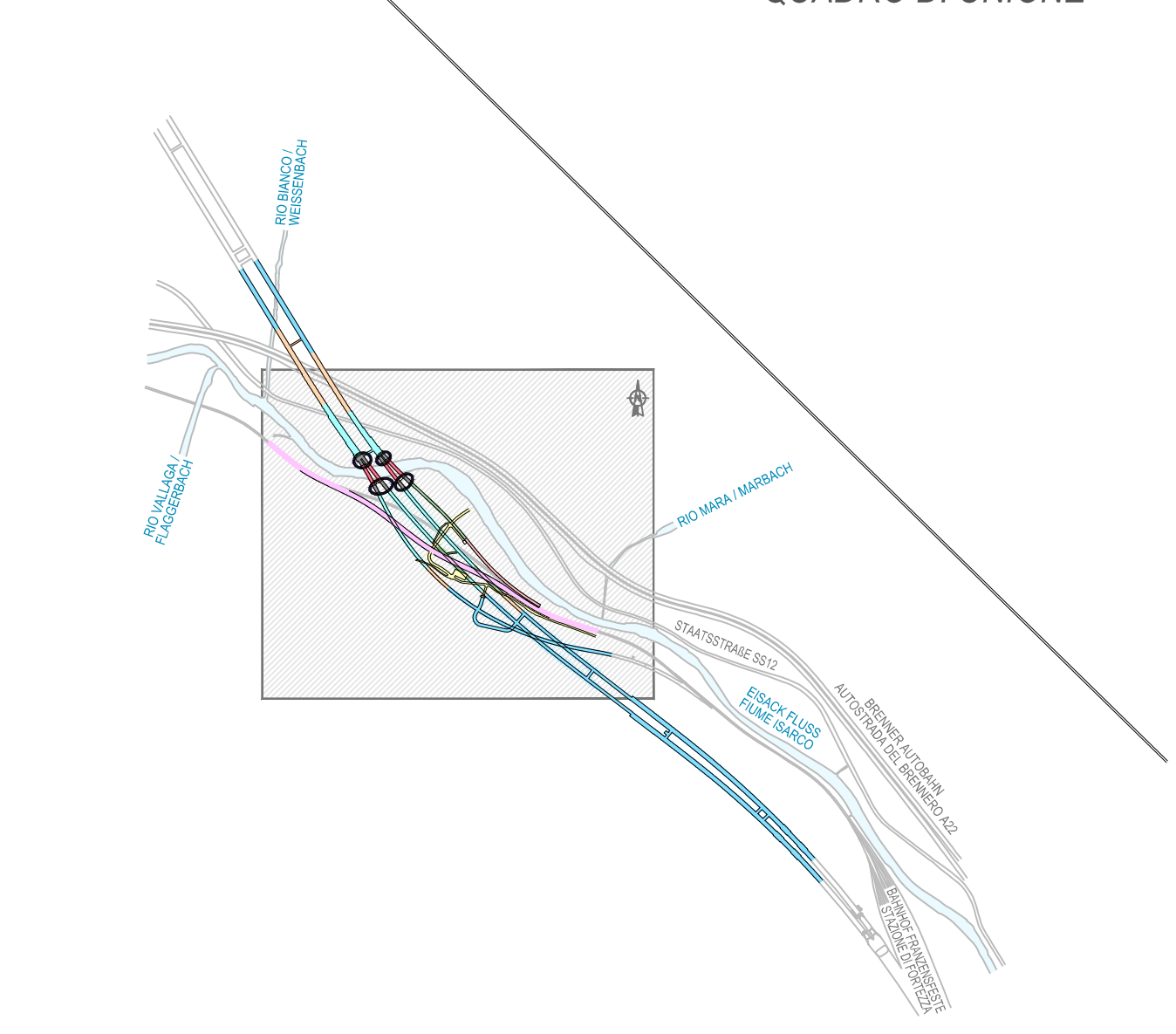
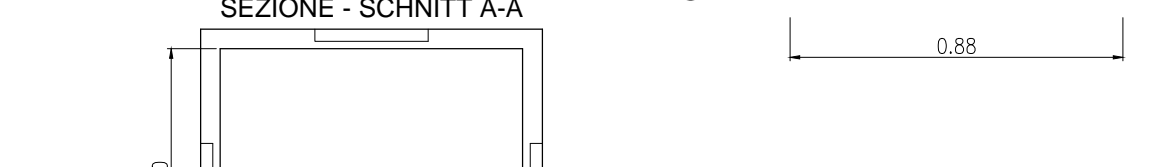

CADITOIA STRADALE (TIPO C1)
STRASSENEINLAUF (TYP C1)

scala / Masstab 1:10

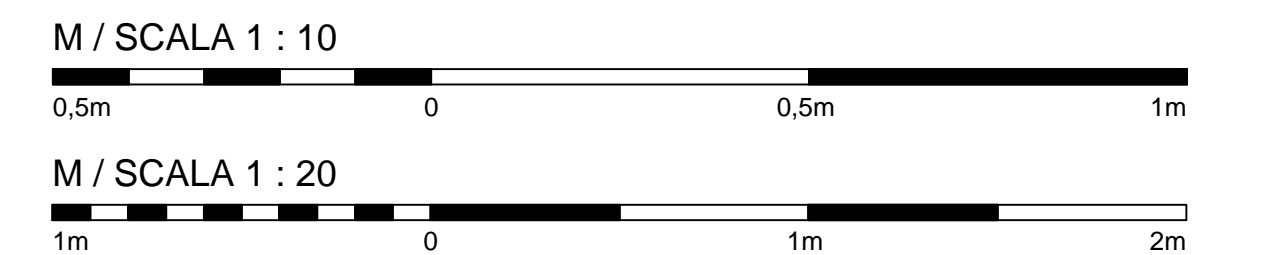
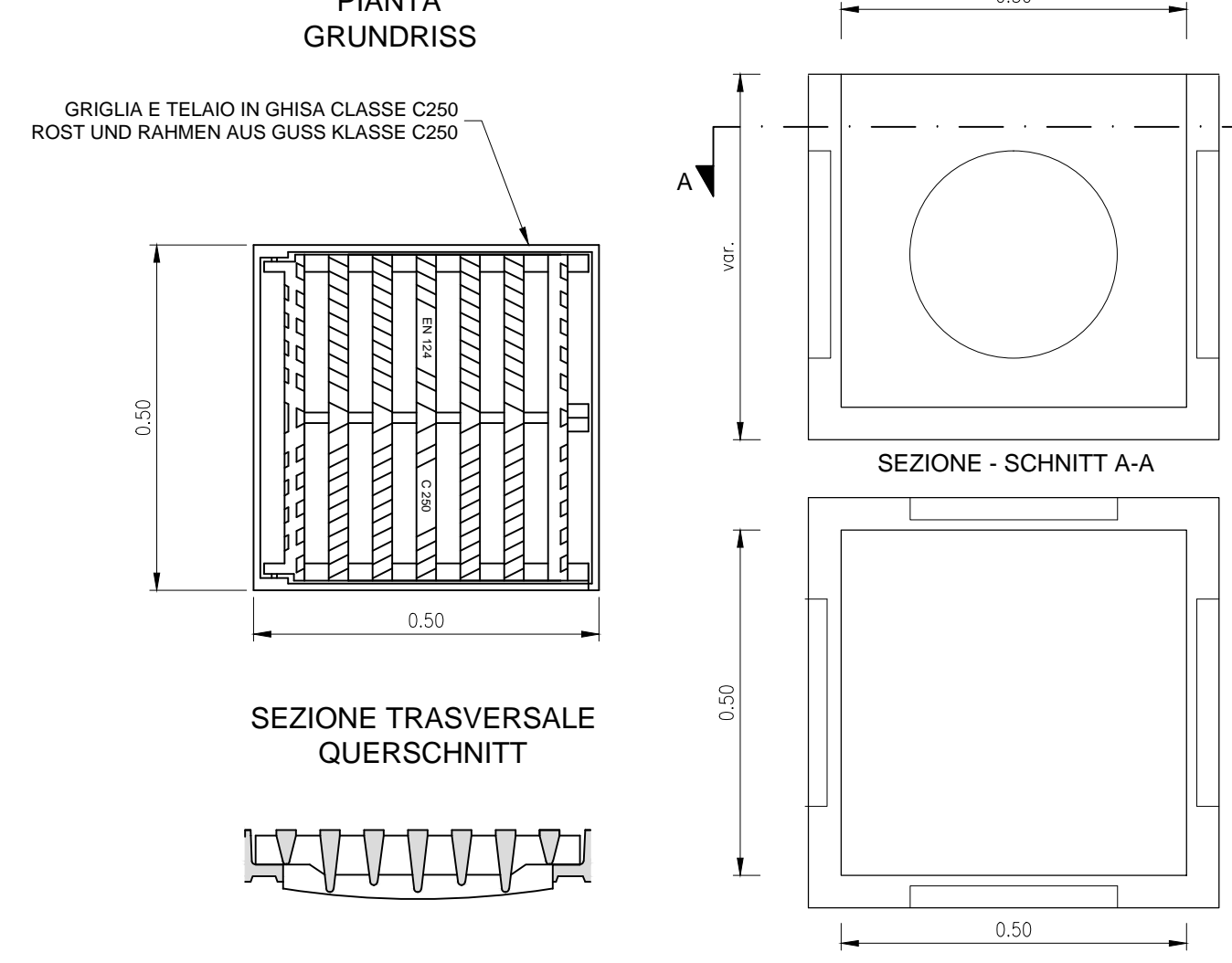

Bearbeitungsstand				
Stato di elaborazione				
Revision	Änderungen / Modifiche	Verantwortliche Änderung	Datum	
00	Entwurf / Prima Versione	M. Rasnelli	06.08.2015	
01	Armenungen BBT / Osservazioni BBT	M. Rasnelli	30.11.2015	
02	Armenungen BBT vom 15.12.2015 / Osservazioni BBT del 15.12.2015	M. Rasnelli	14.01.2016	
03				
04				
05				

Ausbau Eisenbahnhöhe München-Verona
BRENNER BASISTUNNEL
 Ausführungsprojekt
 Potenzierung asse ferroviario Monaco - Verona
GALLERIA DI BASE DEL BRENNERO
 Progetto esecutivo
 Sub-Bauleis Hauptbauwerke Eisackunterquerung
 Sublotto di costruzione Opere Principali Sottotraversamento Isarco
 Fachbereich: 08 - Verlegung Bestandsstrecke
 Thema: 08 - Spostamento linea storica
 Streckenplanung und Bauwerksplanung: Projektazione del tracciato e dell'opera
 Konstruktive Details: Dettagli costruttivi
 Details Entwässerung: Particolari costruttivi smaltimento acque
 Datum / Data: 14.01.2016
 Bearbeiter / Elaborato: M. Rasnelli
 Geprüft / Verificato: D. Bonadies
 Freigegeben / Autorizzato: M. Rasnelli
 Genehmigt / Visto BBT_RUP: A. Lombardi
 Projekt / Progetto: 02 H71 AF 002
 Blatt / Foglio: 08
 Datum / Data: 01
 Maßstab / Scala: 026.00
 Status / Stato: B0115 00237 520 02