

| | | | | |
|------------------|------------|------------|------------|------------|
| Provincia | | | | |
| Comune | | | | |
| L = | 25.867 | 73.432 | 227.661 | 480.000 |
| Skewette | 0.008 | 0.130 | -0.613 | -0.050 |
| p = | 0.315 | 1.770 | 2.955 | 0.104 |
| Progr. Livellate | 210328.237 | 210401.669 | 210629.330 | 211109.330 |

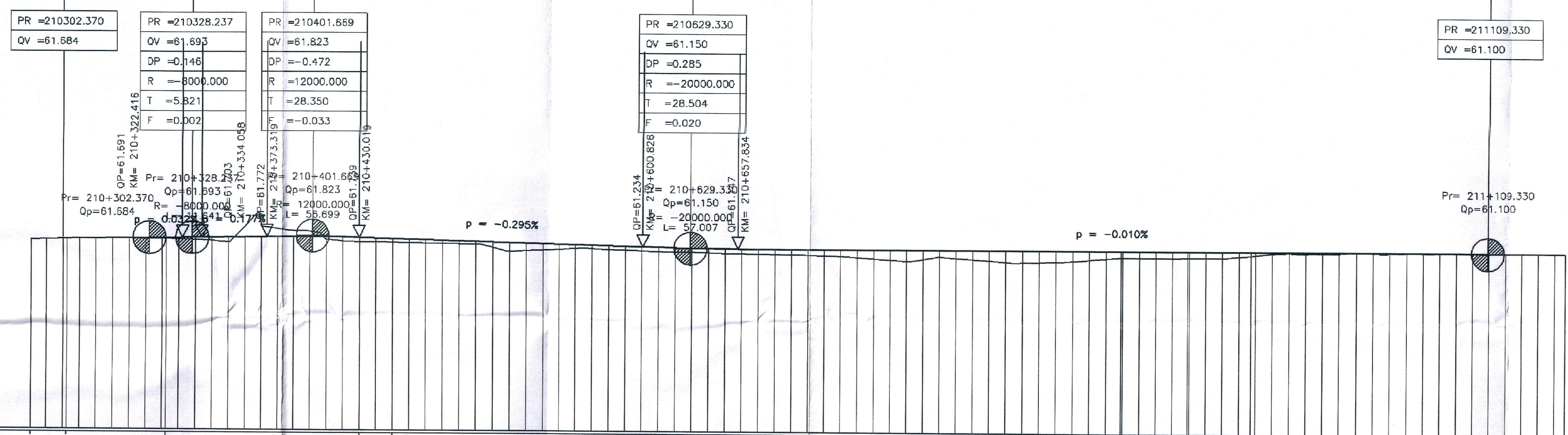

1:200
Q. R. = 50.00 m

| | | | | | | | | | | | | | | | | | | | | |
|------------------------|---------|---------|---------|---------|---------|---------|---------|---------|---------|---------|---------|---------|---------|---------|---------|---------|---------|---------|---------|-------|
| NUMERO SEZIONE | | | | | | | | | | | | | | | | | | | | |
| QUOTE PROGETTO | 61.571 | 61.571 | 61.584 | 61.588 | 61.700 | 61.728 | 61.699 | 61.582 | 61.287 | 61.155 | 61.132 | 61.123 | 61.122 | 61.115 | 61.111 | 61.108 | 61.104 | 61.122 | | |
| QUOTE TERRENO | 61.571 | 61.571 | 61.584 | 61.588 | 61.700 | 61.728 | 61.699 | 61.582 | 61.287 | 61.155 | 61.132 | 61.123 | 61.122 | 61.115 | 61.111 | 61.108 | 61.104 | 61.122 | | |
| ETTOMETRICHE | 210+200 | 210+250 | 210+300 | 210+350 | 210+400 | 210+450 | 210+500 | 210+550 | 210+600 | 210+650 | 210+700 | 210+750 | 210+800 | 210+850 | 210+900 | 210+950 | 211+000 | 211+050 | 211+100 | |
| DIST. PARZIALI | 0.00 | 30.86 | 21.51 | 47.83 | 27.83 | 30.18 | 20.00 | 48.82 | 100.00 | 100.00 | 100.00 | 100.00 | 68.18 | 28.10 | 38.04 | 37.85 | 30.00 | 70.00 | 56.07 | 43.83 |
| ANDAMENTO PLANIMETRICO | | | | | | | | | | | | | | | | | | | | |

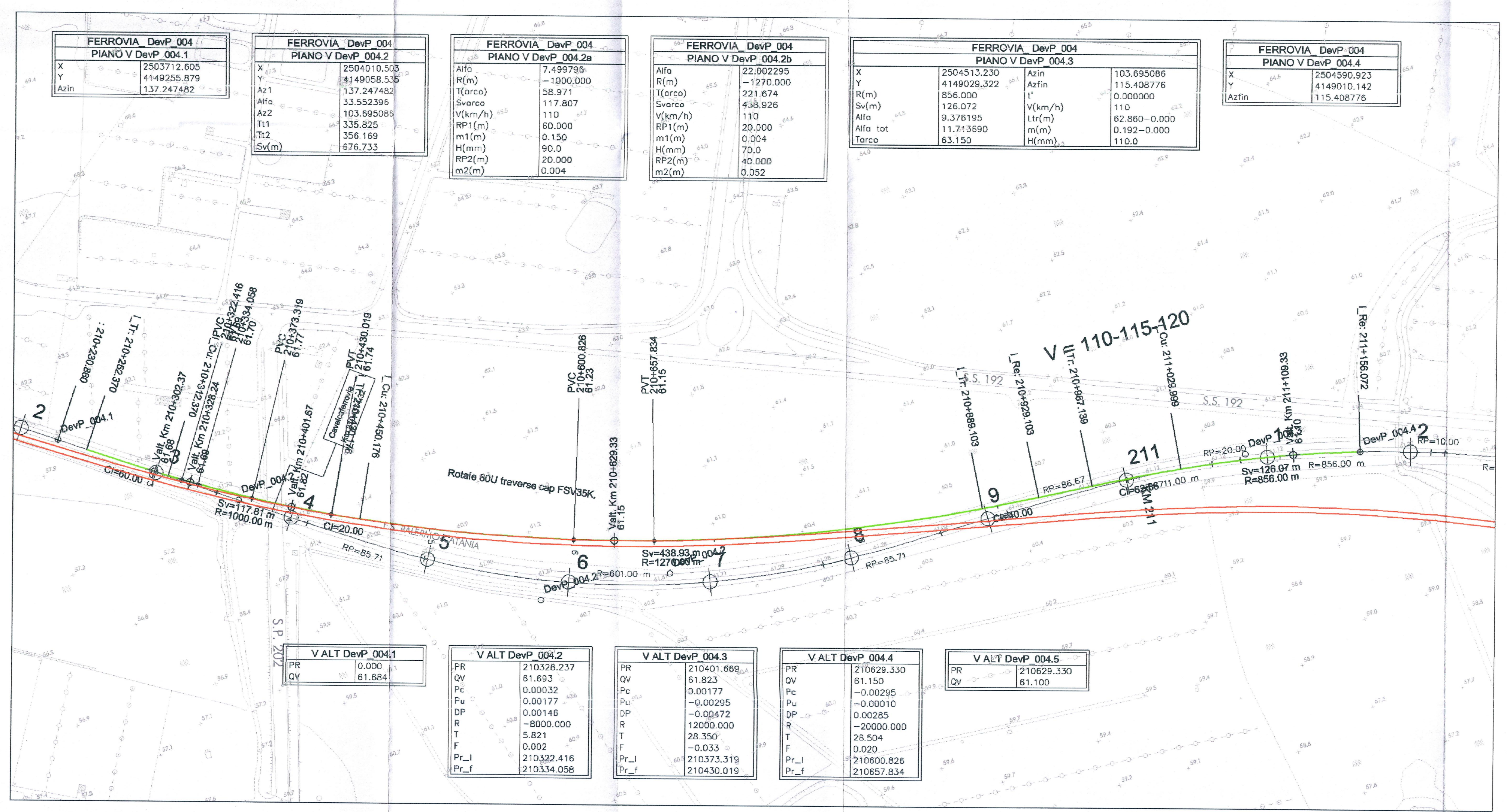

| | | | | | |
|--|--|--|---|---|--|
| FERROVIA DevP.004 PIANO V DevP.004.1 | FERROVIA DevP.004 PIANO V DevP.004.2 | FERROVIA DevP.004 PIANO V DevP.004.2a | FERROVIA DevP.004 PIANO V DevP.004.2b | FERROVIA DevP.004 PIANO V DevP.004.3 | FERROVIA DevP.004 PIANO V DevP.004.4 |
| X: 2503712.605 Y: 4149255.879 Azim: 137.247482 | X: 2504018.533 Y: 4149058.535 Az1: 137.247482 Az2: 103.990085 T11: 335.825 T12: 358.159 Sv(m): 676.733 | X: 2504018.533 Y: 4149058.535 Azim: 17.499768 R(m): -1000.000 I(pero): 38.971 Scurva: 117.807 v(km/h): 110 R1(m): 60.300 m1(m): 0.150 H(mm): 90.0 R1'(m): 70.300 m2(m): 0.004 | X: 2504018.533 Y: 4149058.535 Azim: 17.499768 R(m): -1000.000 I(pero): 221.674 Scurva: 438.526 v(km/h): 110 R1(m): 20.300 m1(m): 0.204 H(mm): 70.0 R1'(m): 40.300 m2(m): 0.352 | X: 2504513.230 Y: 4149028.322 Azim: 105.895086 R(m): 856.000 Sv(m): 115.430776 I: 0.000000 v(km/h): 110 Azim: 9.378195 Alfa tot: 62.850-0.000 Tg: 0.192-0.000 Tg: 110.0 | X: 2504590.923 Y: 4149010.142 Azim: 115.430776 |

| | | | | |
|-------------------------|---|--|---|------------------------------|
| V ALT DevP.004.1 | V ALT DevP.004.2 | V ALT DevP.004.3 | V ALT DevP.004.4 | V ALT DevP.004.5 |
| PR: 0.000 OV: 81.584 | PR: 210328.237 OV: 81.693 DP: 0.00177 R: -8900.000 T: 5.821 F: 0.002 Pv: 210332.416 Pv: 210334.058 | PR: 210401.669 OV: 81.823 DP: 0.00132 R: -12000.000 T: 28.350 F: -0.033 Pv: 210373.319 Pv: 210430.919 | PR: 210629.330 OV: 81.150 DP: -0.00035 R: -20000.000 T: 28.504 F: -0.033 Pv: 210800.826 Pv: 210857.834 | PR: 211109.330 OV: 81.100 |

COMMITENTE:

PROGETTAZIONE:

DIRETTRICE FERROVIARIA MESSINA - CATANIA - PALERMO
NUOVO COLLEGAMENTO PALERMO - CATANIA

U.O. PRODUZIONE CENTRO NORD
PROGETTO DEFINITIVO

RADDOPPIO DELLA TRATTA BICOCCA - CATENANUOVA
DEVIATA PROVVISORIA 004 - dal km. 210+252 al km 211+109
PIANO-PROFILO

SCALA: 1:2000

| | | | | | | | |
|----------|-------|------|------|-----------|------------------|--------|------|
| COMMESSA | LOTTO | FASE | ENTE | TIPO DOC. | OPERA/DISCIPLINA | PROGR. | REV. |
| RISOK | 10 | D | 26 | L6 | IF0501 | 001 | A |

| Rev. | Descrizione | Redatto | Data | Verificato | Data | Approvato | Data | Autore | Data |
|------|---------------------|-------------|------------|-------------|------------|-------------|------------|-------------|------------|
| A | Emissione Esecutiva | [Signature] | 08/03/2016 | [Signature] | 08/03/2016 | [Signature] | 08/03/2016 | [Signature] | 08/03/2016 |

File: R50K10028L6IF0501001A_DEV_PROV_V_004.DWG
 n. Foglio: 2/2