

SEZ. 23-23 PROGR. 47+225.00

SCOTICO: 28.94 mq.
STERRO: 96.04 mq.
RIPORTO: 96.04 mq.

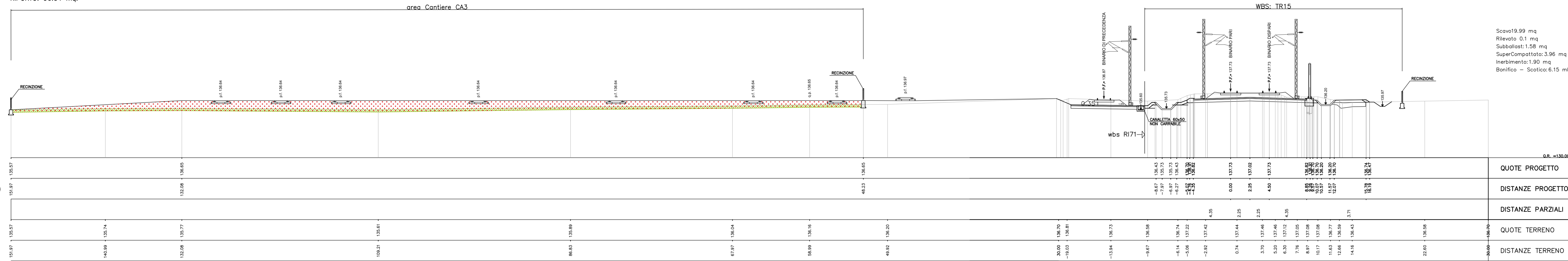

Scavo 19.99 mq
Rilevato 0.1 mq
Subballast: 1.58 mq
SuperCompattato: 3.96 mq
Inerimento: 1.90 mq
Bonifico - Scotica: 6.15 ml

Table with 5 rows: QUOTE PROGETTO, DISTANZE PROGETTO, DISTANZE PARZIALI, QUOTE TERRENO, DISTANZE TERRENO

- SCOTICO (green hatched)
- STERRO (orange hatched)
- RIPORTO (red hatched)

SEZ. 23-23 PROGR. 47+225.00

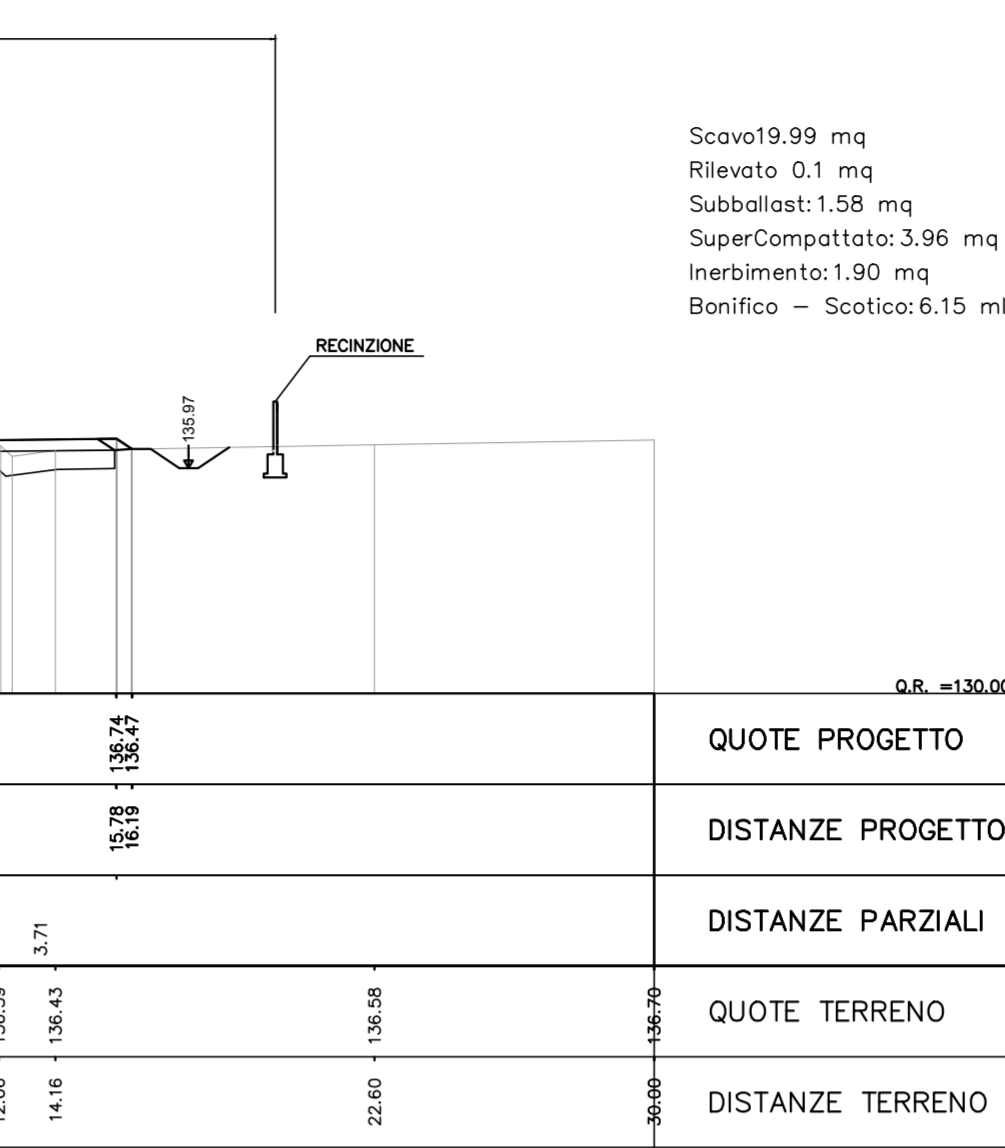

Scavo 19.99 mq
Rilevato 0.1 mq
Subballast: 1.58 mq
SuperCompattato: 3.96 mq
Inerimento: 1.90 mq
Bonifico - Scotica: 6.15 ml

Table with 5 rows: QUOTE PROGETTO, DISTANZE PROGETTO, DISTANZE PARZIALI, QUOTE TERRENO, DISTANZE TERRENO

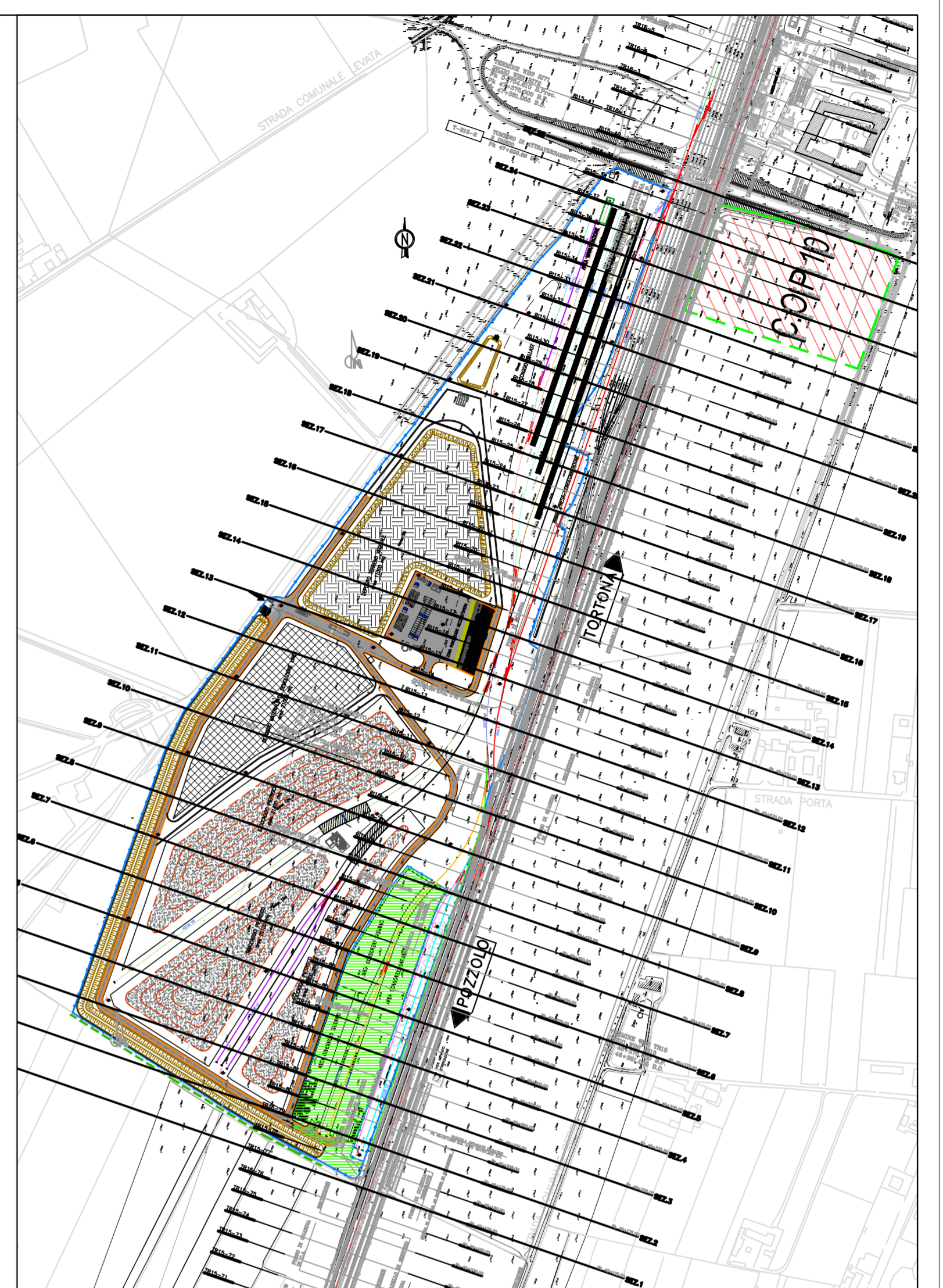
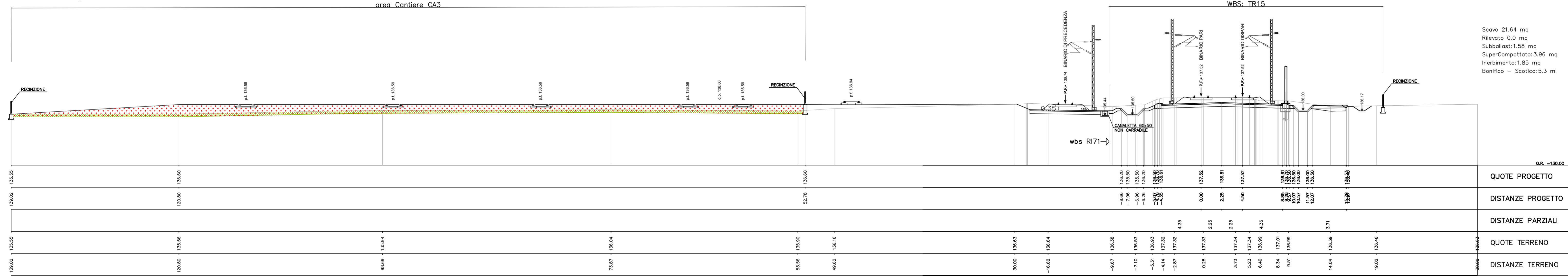

Table titled 'CA3 RIVALTA VOLUME DI SCOTICO' with columns: SEZ, Prog, Distanza, mq, media, distanza, STERRO.

SEZ. 24-24 PROGR. 47+275.00

SCOTICO: 25.75 mq.
STERRO: 78.95 mq.
RIPORTO: 78.95 mq.



Scavo 21.64 mq
Rilevato 0.0 mq
Subballast: 1.58 mq
SuperCompattato: 3.96 mq
Inerimento: 1.85 mq
Bonifico - Scotica: 5.3 ml

Table with 5 rows: QUOTE PROGETTO, DISTANZE PROGETTO, DISTANZE PARZIALI, QUOTE TERRENO, DISTANZE TERRENO

Table titled 'CA3 RIVALTA VOLUME DI STERRO' with columns: SEZ, Prog, Distanza, mq, media, distanza, STERRO.

SEZ. 25-25 PROGR. 47+325.00

SCOTICO: 20.28 mq.
STERRO: 40.27 mq.
RIPORTO: 40.27 mq.

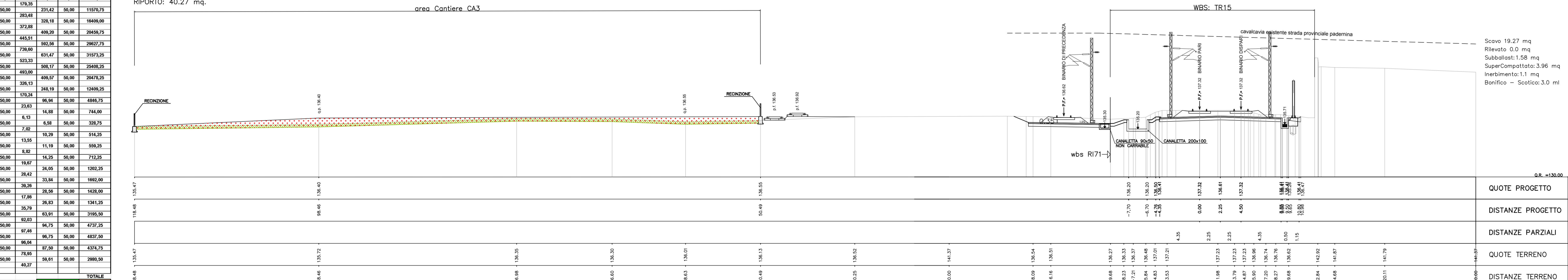

Scavo 19.27 mq
Rilevato 0.0 mq
Subballast: 1.58 mq
SuperCompattato: 3.96 mq
Inerimento: 1.17 mq
Bonifico - Scotica: 3.0 ml

Table with 5 rows: QUOTE PROGETTO, DISTANZE PROGETTO, DISTANZE PARZIALI, QUOTE TERRENO, DISTANZE TERRENO

Project information block including COMMITTENTE (RFI), ALTÀ SUPERVISORIALITÀ (ITALFERR), GENERAL CONTRACTOR (COCV), and project details like CA3 - CANTIERE ARMAMENTO RIVALTA, TRATTA A.V./A.C. TERZO VALICO DEI GIOVI, and scale 1:200.