

GENERAL NOTES

- ALL ELEVATION ARE REFERRED AT EL. $\nabla 0.00 = \nabla 8400$
- ALL DRAINAGE, IN THE LOWER POINT OF THE PIPE LINE, HAVE TO BE COLLECTED TO NEAREST EXISTING SEWER
- ALL DIMENSION ARE SHOWN IN mm
- ∇ SHOWN CENTER OF PIPE OR CENTER LINE EQUIPMENT
- ∇ SHOWN BOTTOM OF PIPE OR GENERIC ELEVATION
- PIPING SUPPORT HAVE TO BE DEFINING DURING DETAIL ENGINEERING
- ROUTING AND DIMENSION HAVE TO BE CHECKED OR CONFIRMED DURING DETAIL ENGINEERING

LEGEND

- X P.F. FIXED POINT
- G GUIDE
- A SUPPORT

Typical SUPPORT

Valid for pipe $10'' \leq \varnothing \leq 24''$

Typical GUIDE

Valid for pipe $10'' \leq \varnothing \leq 24''$

Typical FIXED POINT ON EXISTING PIPE RACK

Valid for pipe $10'' \leq \varnothing \leq 24''$

Typical For Drainage

① PIPE: 1/2\"/>

② PIPE: 1/2\"/>

Typical For Drainage Collecting

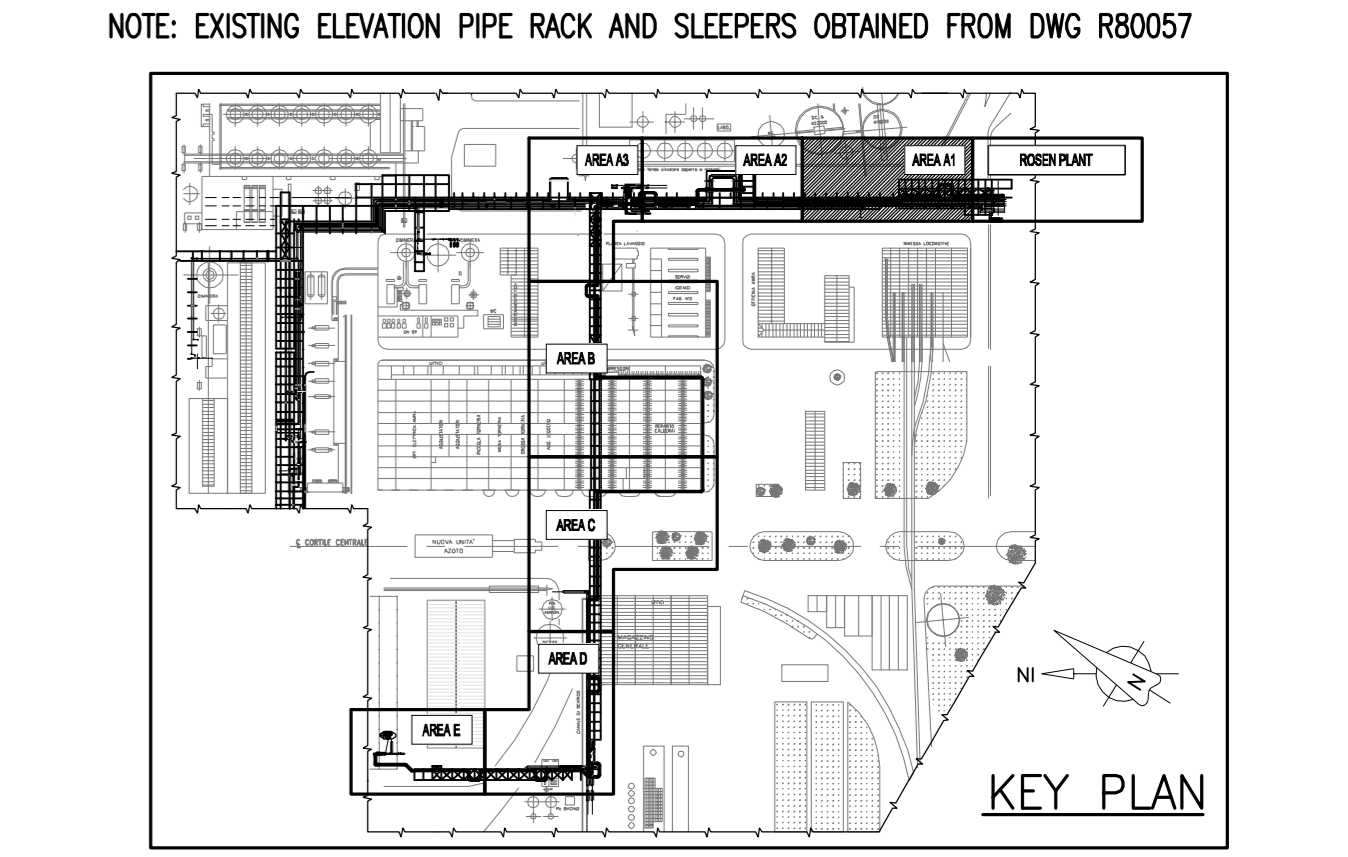

Documenti di Riferimento

| Doc. number | Titolo |
|-------------------------|----------------|
| ROS2017-560-1261375-001 | Key Plan |
| ROS2017-560-1261375-000 | General Layout |

| Rev. | Descr. | Aut. | Verif. | Stat. | Dr. | Ch. | Appr. | Validat. |
|------|--------|------|--------|-------|-----|-----|-------|----------|
| 01 | | | | | | | | |
| 02 | | | | | | | | |
| 03 | | | | | | | | |
| 04 | | | | | | | | |
| 05 | | | | | | | | |
| 06 | | | | | | | | |
| 07 | | | | | | | | |
| 08 | | | | | | | | |
| 09 | | | | | | | | |
| 10 | | | | | | | | |

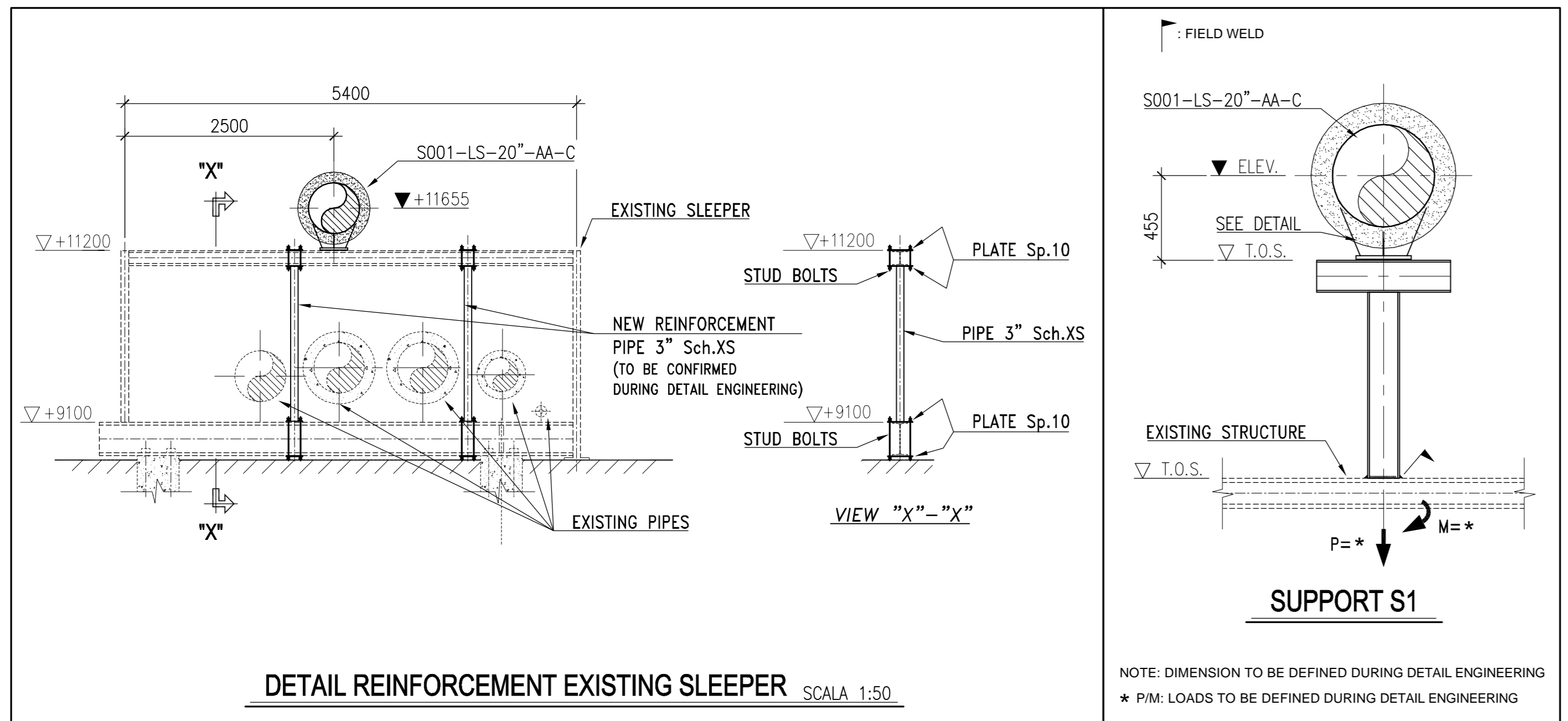

SOLVAY CHIMICA ITALIA S.P.A.

ROSEN 2017 CONVERSION

BASIC DESIGN
MAJOR PIPING LAYOUT
AREA "A1"

TRACTEBEL Engineering
GDF SVEZ

Project: ROS2017-560-1261375-000
Scale: 1:100
Sheet: 01 of 01
Date: 01/01/2017

Project Number: ROS2017-560-1261375-000
Sheet Number: 002 of 01