









-  Area di circolazione (fase 2)
-  Area di circolazione
-  Sale di imbarco
-  Area Commerciale, F&B, Intrattenimento
-  BHS/HBS
-  Toilets
-  Uffici
-  Locali tecnici
-  Magazzini e locali di supporto logistico
-  Opere relative al Processor, al GTC e all'Area di imbarco Sud



quota +5.00

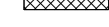
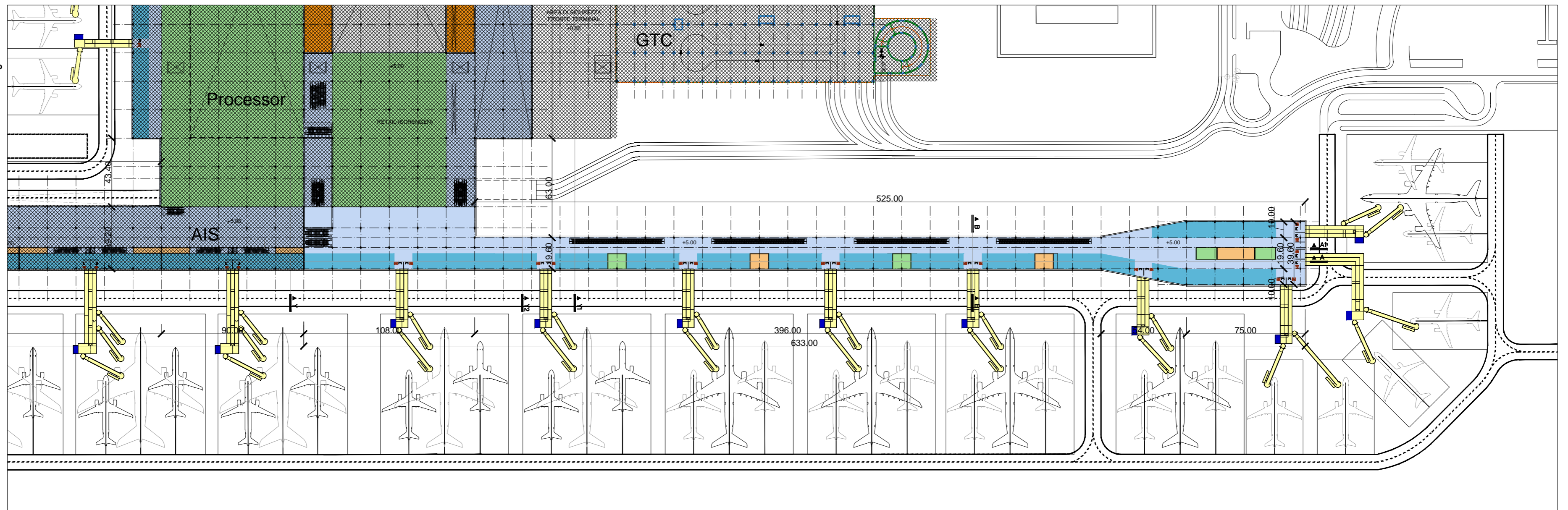
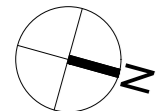
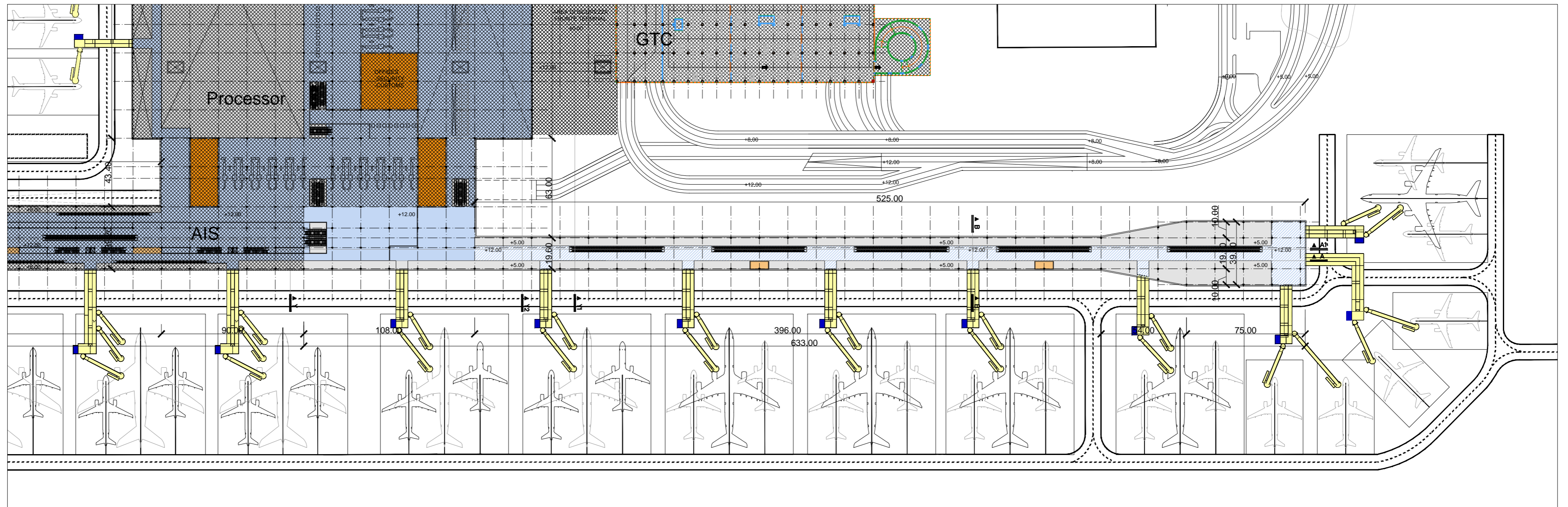

quota +12.00