

PROVINCIA :Alessandria  
 COMUNE :Tortona

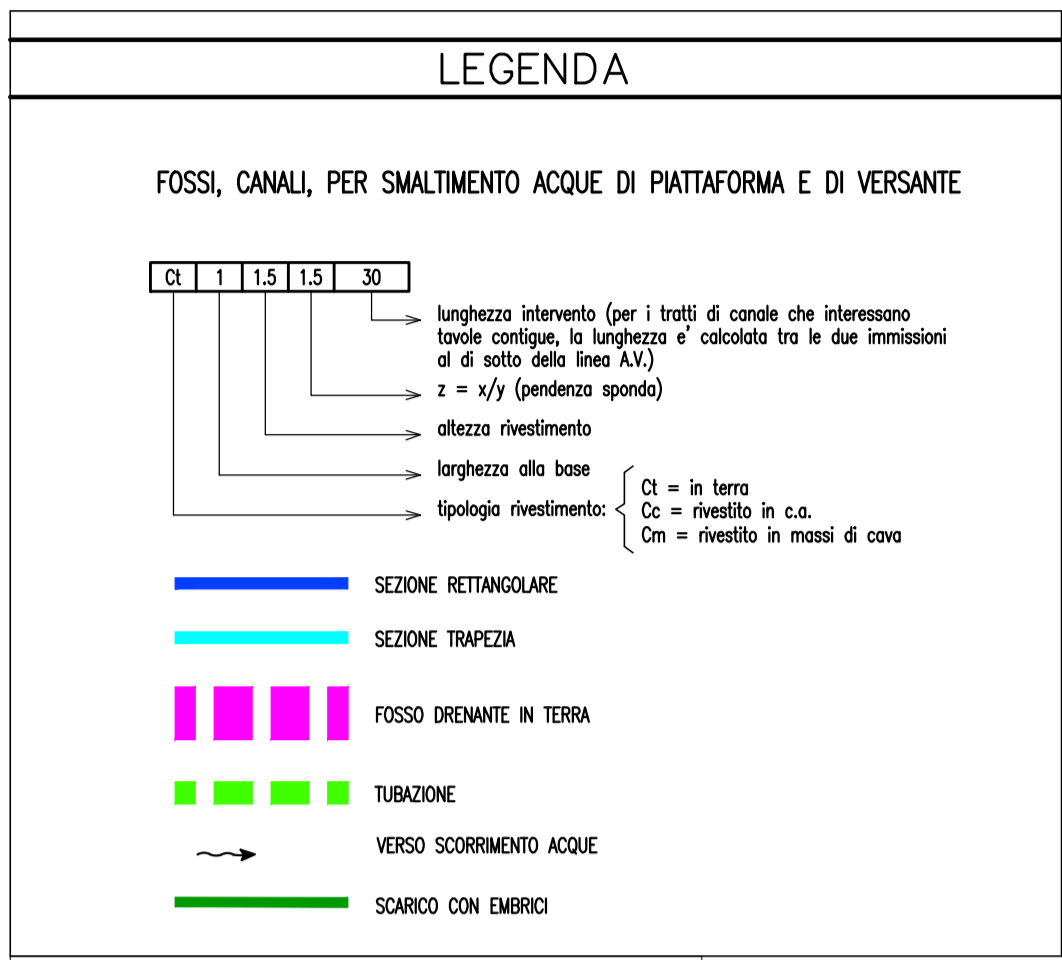
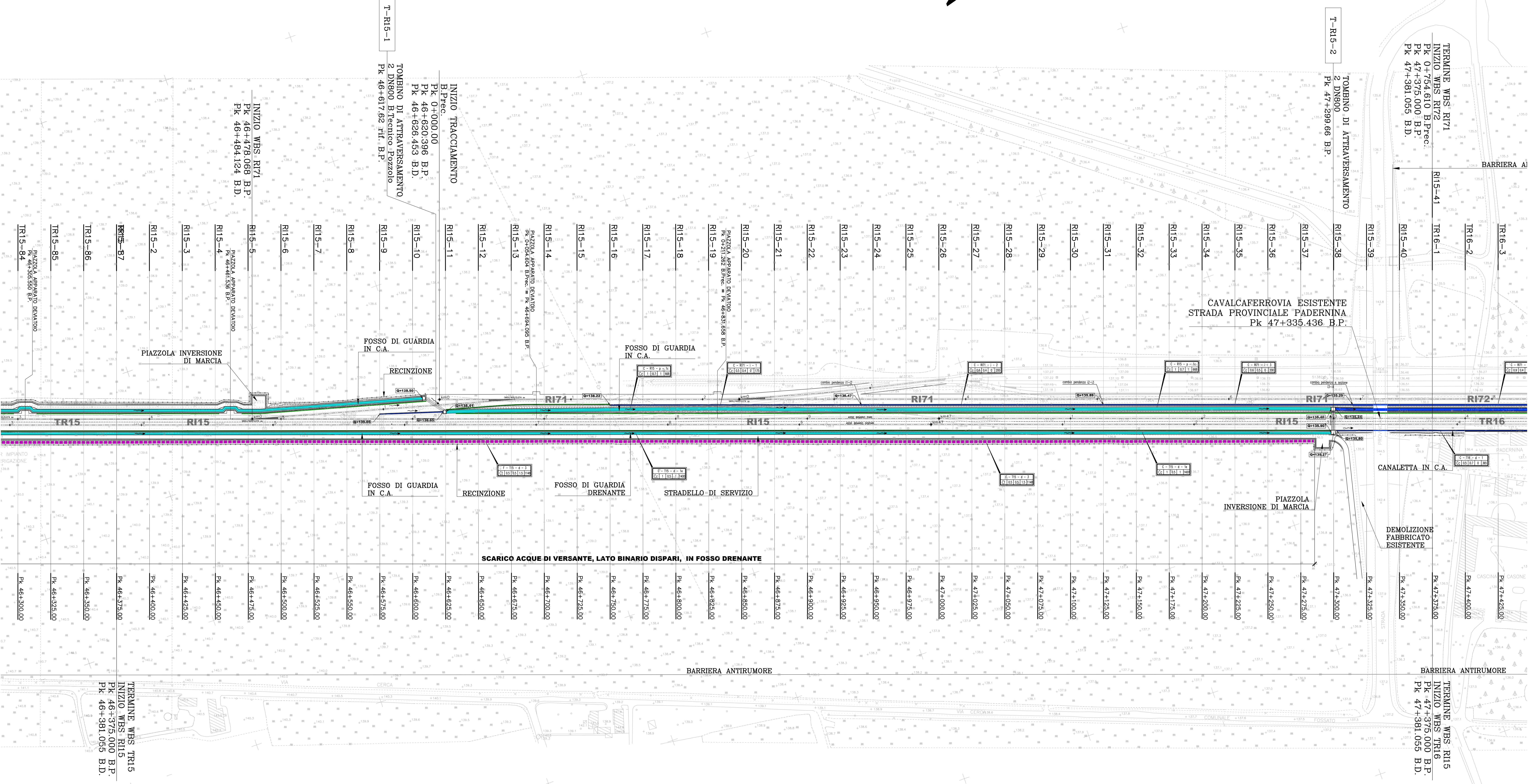
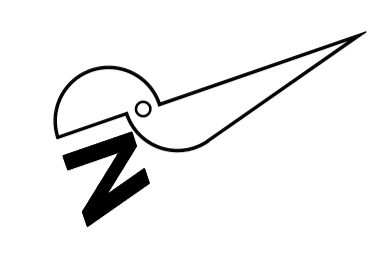

NOTA:  
 EMBRICI DI RILEVATO OGNI 15m

**CARATTERISTICHE DEI TRATTI E PORTATE SCARICATE**

Modulo	Modulo	h <sub>1</sub>	h <sub>2</sub>	h <sub>3</sub>	h <sub>4</sub>	h <sub>5</sub>	h <sub>6</sub>	h <sub>7</sub>	h <sub>8</sub>	h <sub>9</sub>	h <sub>10</sub>	h <sub>11</sub>	h <sub>12</sub>	h <sub>13</sub>	h <sub>14</sub>	h <sub>15</sub>	h <sub>16</sub>	h <sub>17</sub>	h <sub>18</sub>	h <sub>19</sub>	h <sub>20</sub>	h <sub>21</sub>	h <sub>22</sub>	h <sub>23</sub>	h <sub>24</sub>	h <sub>25</sub>	h <sub>26</sub>	h <sub>27</sub>	h <sub>28</sub>	h <sub>29</sub>	h <sub>30</sub>	h <sub>31</sub>	h <sub>32</sub>	h <sub>33</sub>	h <sub>34</sub>	h <sub>35</sub>	h <sub>36</sub>	h <sub>37</sub>	h <sub>38</sub>	h <sub>39</sub>	h <sub>40</sub>	h <sub>41</sub>	h <sub>42</sub>	h <sub>43</sub>	h <sub>44</sub>	h <sub>45</sub>	h <sub>46</sub>	h <sub>47</sub>	h <sub>48</sub>	h <sub>49</sub>	h <sub>50</sub>	h <sub>51</sub>	h <sub>52</sub>	h <sub>53</sub>	h <sub>54</sub>	h <sub>55</sub>	h <sub>56</sub>	h <sub>57</sub>	h <sub>58</sub>	h <sub>59</sub>	h <sub>60</sub>	h <sub>61</sub>	h <sub>62</sub>	h <sub>63</sub>	h <sub>64</sub>	h <sub>65</sub>	h <sub>66</sub>	h <sub>67</sub>	h <sub>68</sub>	h <sub>69</sub>	h <sub>70</sub>	h <sub>71</sub>	h <sub>72</sub>	h <sub>73</sub>	h <sub>74</sub>	h <sub>75</sub>	h <sub>76</sub>	h <sub>77</sub>	h <sub>78</sub>	h <sub>79</sub>	h <sub>80</sub>	h <sub>81</sub>	h <sub>82</sub>	h <sub>83</sub>	h <sub>84</sub>	h <sub>85</sub>	h <sub>86</sub>	h <sub>87</sub>	h <sub>88</sub>	h <sub>89</sub>	h <sub>90</sub>	h <sub>91</sub>	h <sub>92</sub>	h <sub>93</sub>	h <sub>94</sub>	h <sub>95</sub>	h <sub>96</sub>	h <sub>97</sub>	h <sub>98</sub>	h <sub>99</sub>	h <sub>100</sub>																																							
TR15-1	TR15-2	TR15-3	TR15-4	TR15-5	TR15-6	TR15-7	TR15-8	TR15-9	TR15-10	TR15-11	TR15-12	TR15-13	TR15-14	TR15-15	TR15-16	TR15-17	TR15-18	TR15-19	TR15-20	TR15-21	TR15-22	TR15-23	TR15-24	TR15-25	TR15-26	TR15-27	TR15-28	TR15-29	TR15-30	TR15-31	TR15-32	TR15-33	TR15-34	TR15-35	TR15-36	TR15-37	TR15-38	TR15-39	TR15-40	TR15-41	TR16-1	TR16-2	TR16-3	TR16-4	TR16-5	TR16-6	TR16-7	TR16-8	TR16-9	TR16-10	TR16-11	TR16-12	TR16-13	TR16-14	TR16-15	TR16-16	TR16-17	TR16-18	TR16-19	TR16-20	TR16-21	TR16-22	TR16-23	TR16-24	TR16-25	TR16-26	TR16-27	TR16-28	TR16-29	TR16-30	TR16-31	TR16-32	TR16-33	TR16-34	TR16-35	TR16-36	TR16-37	TR16-38	TR16-39	TR16-40	TR16-41	TR16-42	TR16-43	TR16-44	TR16-45	TR16-46	TR16-47	TR16-48	TR16-49	TR16-50	TR16-51	TR16-52	TR16-53	TR16-54	TR16-55	TR16-56	TR16-57	TR16-58	TR16-59	TR16-60	TR16-61	TR16-62	TR16-63	TR16-64	TR16-65	TR16-66	TR16-67	TR16-68	TR16-69	TR16-70	TR16-71	TR16-72	TR16-73	TR16-74	TR16-75	TR16-76	TR16-77	TR16-78	TR16-79	TR16-80	TR16-81	TR16-82	TR16-83	TR16-84	TR16-85	TR16-86	TR16-87	TR16-88	TR16-89	TR16-90	TR16-91	TR16-92	TR16-93	TR16-94	TR16-95	TR16-96	TR16-97	TR16-98	TR16-99	TR16-100

COMMITTENTE:  
**RFI**  
 ALTA Sorveglianza:  
**ITALFERR**

GENERAL CONTRACTOR:  
**Cociv**

INFRASTRUTTURE FERROVIARIE STRATEGICHE DEFINITE DALLA LEGGE OBIETTIVO N.443/01  
 TRATTA A.V.I.A.C. TERZO VALICO DEI GIOVI  
 PROGETTO ESECUTIVO

Rilevato di Linea III Valico  
 da pk 46+375,00 a pk 47+375,00  
 tratto 0  
 Planimetria idraulica

GENERAL CONTRACTOR <b>Cociv</b> Ing. N. Maitto	DIRETTORE LAVORI	SCALA 1:1000
--	------------------	-----------------

COMMESSA	LOTTO	FASE	ENTE	TIPO DOC.	OPERAZIONE/P.N.	PROG.	REV.
IG51	04	E	CV	P7	RI1503	001	A

PROGETTAZIONE	Redatto	Data	Verificato	Data	Progettista	Data	IL PROGETTISTA
000	Direzione emissione	E. Caruso	A. Nestor	15/05/2014	A. Palotta	15/05/2014	
A00	Prima emissione	E. Caruso	A. Nestor	15/05/2014	A. Palotta	15/05/2014	
A01	Appalto completo	M. Rinaldi	A. Nestor	25/11/2015	A. Palotta	25/11/2015	
A02	Revisione per cambio sito	M. Rinaldi	A. Nestor	22/03/2017	A. Palotta	22/03/2017	

Nome File: ...  
 CUP: ...