

PROVINCIA	BENEVENTO		BENEVENTO	BENEVENTO					
COMUNE	DUGENTA		DUGENTA	MELIZZANO					
LIVELLETTE	DIFF. DI QUOTA DISTANZA Pendenza	h = -0.70 L = 200.00 i = -0.35%	h = -3.56 L = 470.00 i = -0.75%	h = -1.90 L = 480.00 i = -0.40%	h = -4.15 L = 710.00 i = -0.58%				
Progr. Livellette									
WBS	TR01	RI01	TR02	RI02	VI01	RI03	RI04	SL02	RI05

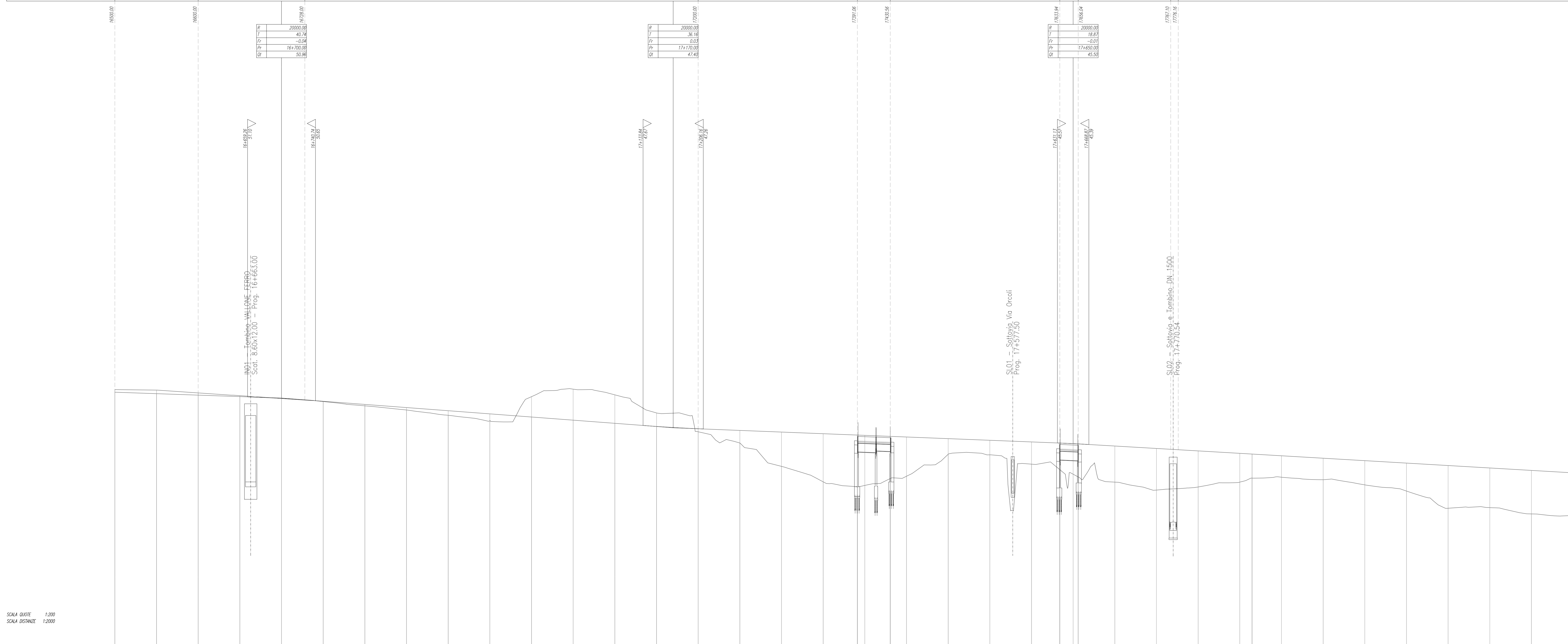

NUMERO SEZIONI	1	2	3	4	5	6	7	8	9	10	11	12	13	14	15	16	17	18	19	20	21	22	23	24	25	26	27	28	29	30	31	32	33	34	35	36
DISTANZE PARZIALI	50.00	50.00	50.00	50.00	50.00	50.00	49.99	49.99	50.01	50.00	50.00	50.00	50.00	49.99	41.07	8.84	30.56	19.44	50.00	50.00	50.00	33.90	16.00	41.90	49.99	50.00	50.00	35.24	50.00	50.00	50.00	50.00	49.99	50.00	50.00	
DISTANZE PROGRESSIVE	50.00	100.00	150.00	200.00	250.00	300.00	349.99	399.98	449.99	500.00	550.00	600.00	650.00	700.00	749.99	758.83	789.39	808.83	858.83	908.83	958.83	992.73	1008.73	1049.63	1099.62	1149.62	1184.86	1220.10	1255.34	1290.58	1325.82	1361.06	1396.30	1431.54	1466.78	1502.02
QUOTE TERRENO	-51.07	-51.07	-51.08	-51.14	-50.91	-50.54	-50.00	-49.51	-48.89	-48.07	-46.89	-45.07	-42.78	-41.07	-38.81	-36.57	-34.28	-31.94	-29.56	-27.14	-24.68	-22.19	-19.68	-17.14	-14.58	-11.99	-9.37	-6.73	-4.07	-1.39	1.30	3.92	6.45	8.89	11.24	
QUOTE PROGETTO	-51.06	-51.06	-51.11	-51.14	-50.92	-50.54	-50.00	-49.51	-48.89	-48.07	-46.89	-45.07	-42.78	-41.07	-38.81	-36.57	-34.28	-31.94	-29.56	-27.14	-24.68	-22.19	-19.68	-17.14	-14.58	-11.99	-9.37	-6.73	-4.07	-1.39	1.30	3.92	6.45	8.89	11.24	
ETOMETRICHE	165	166	167	168	169	170	171	172	173	174	175	176	177	178	179	180	181	182	183	184	185	186	187	188	189	190	191	192	193	194	195	196	197	198	199	200
ANDAMENTO PLANIMETRICO	L=288.83		L=140.97 Sv=150.00 Rv=1600.00		L=140.97 Sv=150.00 Rv=1600.00		L=140.97 Sv=150.00 Rv=1600.00		L=140.97 Sv=150.00 Rv=1600.00		L=140.97 Sv=150.00 Rv=1600.00		L=140.97 Sv=150.00 Rv=1600.00		L=140.97 Sv=150.00 Rv=1600.00		L=140.97 Sv=150.00 Rv=1600.00		L=140.97 Sv=150.00 Rv=1600.00		L=140.97 Sv=150.00 Rv=1600.00		L=140.97 Sv=150.00 Rv=1600.00		L=140.97 Sv=150.00 Rv=1600.00		L=140.97 Sv=150.00 Rv=1600.00		L=140.97 Sv=150.00 Rv=1600.00		L=140.97 Sv=150.00 Rv=1600.00		L=140.97 Sv=150.00 Rv=1600.00		L=140.97 Sv=150.00 Rv=1600.00	

SCALA QUOTE 1:200
SCALA DISTANZE 1:2000

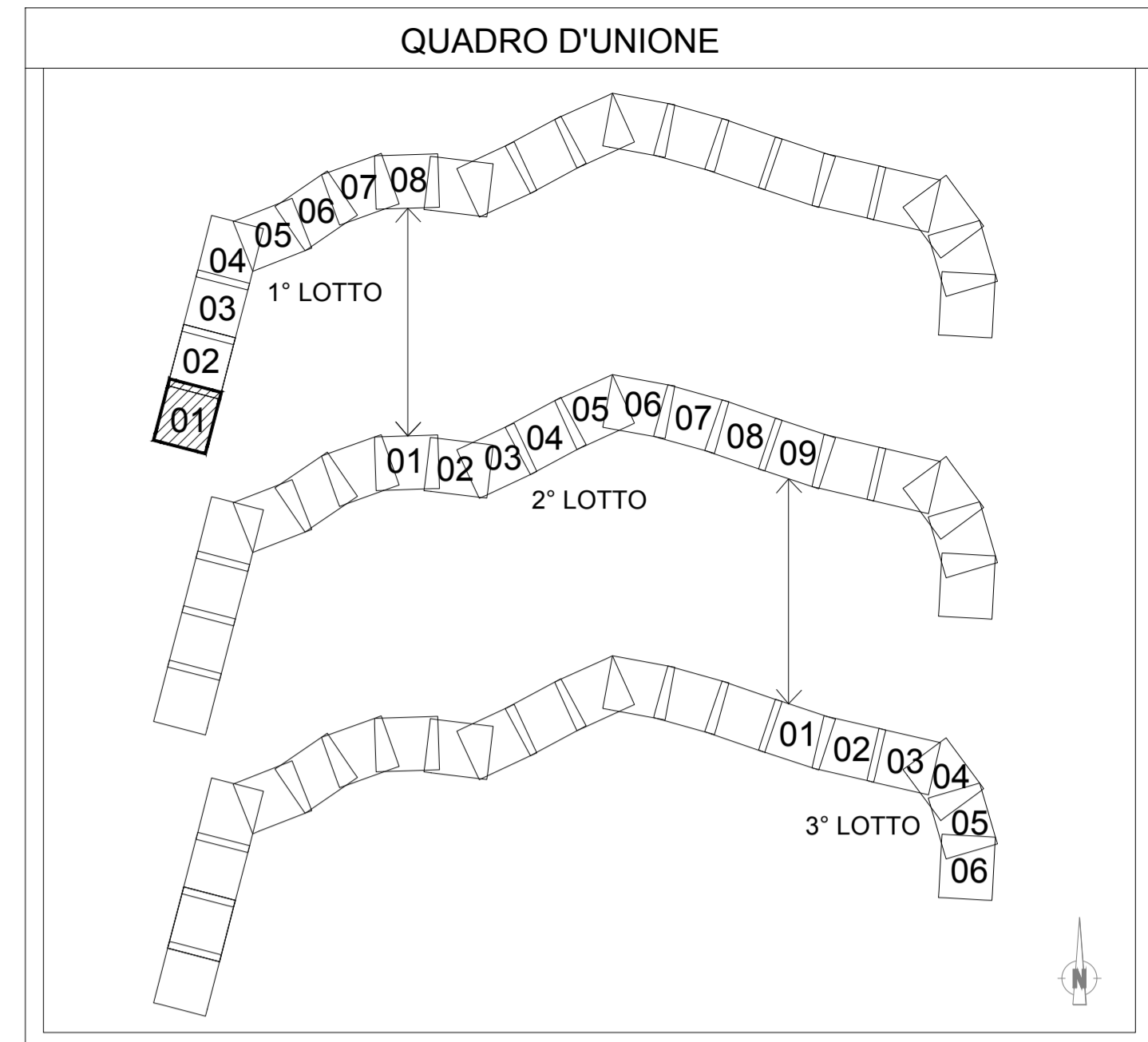

COMMITTENTE:

RETE FERROVIARIA ITALIANA
GRUPPO FERROVIE DELLO STATO ITALIANE

PROGETTAZIONE:

ITALFERR
GRUPPO FERROVIE DELLO STATO ITALIANE

**DIREZIONE TECNICA
UO INFRASTRUTTURE CENTRO**

PROGETTO DEFINITIVO

**ITINERARIO NAPOLI - BARI
RADDOPPIO TRATTA CANCELLO - BENEVENTO
II LOTTO FUNZIONALE FRASSO TELESINO - VITULANO
1° LOTTO FUNZIONALE FRASSO - TELESE**

ELABORATI GENERALI

Profilo longitudinale dal Km16+500 al Km 17+850

SCALA:
1:2000/200

COMMESSA LOTTO FASE ENTE TIPO DOC. OPERA/DISCIPLINA PROGR. REV.

IF0H 12 D 11 F6 IF0000 001 A

Revis.	Descrizione	Redatto	Data	Verificato	Data	Approvato	Data	Autorizzato	Data
A	Emissione Esecutiva	C. Di Serio	06/2017	F. C. Di Serio	06/2017	F. C. Di Serio	06/2017		