

NO. SEZIONE	DISTANZA PROGRESSIVA	QUOTE TERRENO	QUOTE PROGETTO
1	3,542	197,468	197,468
2	25,000	196,705	196,705
3	50,000	196,629	196,629
4	62,883	196,730	196,730
5	75,000	196,730	196,730
6	100,000	196,705	196,705
7	131,767	196,721	196,721
8	143,305	196,730	196,730
9	158,000	196,835	196,835
10	175,000	196,910	196,910
11	200,000	196,961	196,961
12	228,595	196,944	196,944
13	250,000	196,844	196,844
14	250,000	200,495	200,495
15	275,000	200,495	200,495
16	300,000	200,578	200,578
17	333,240	200,259	200,259
18	350,000	200,261	200,261
19	364,886	207,703	207,703
20	400,000	207,704	207,704
21	434,842	206,155	206,155
22	450,000	206,752	206,752
23	494,842	202,102	202,102
24	500,000	201,858	201,858
25	525,000	202,550	202,550
26	536,714	202,067	202,067
27	550,000	202,281	202,281
28	566,555	202,406	202,406
29	575,000	202,425	202,425
30	593,366	201,911	201,911
31	625,000	201,168	201,168
32	650,000	201,121	201,121
33	688,886	201,009	201,009
34	700,000	200,963	200,963
35	725,000	201,743	201,743
36	730,130	201,744	201,744
37	743,559	201,756	201,756
38	750,886	201,728	201,728
39	750,000	201,872	201,872
40	784,595	201,895	201,895

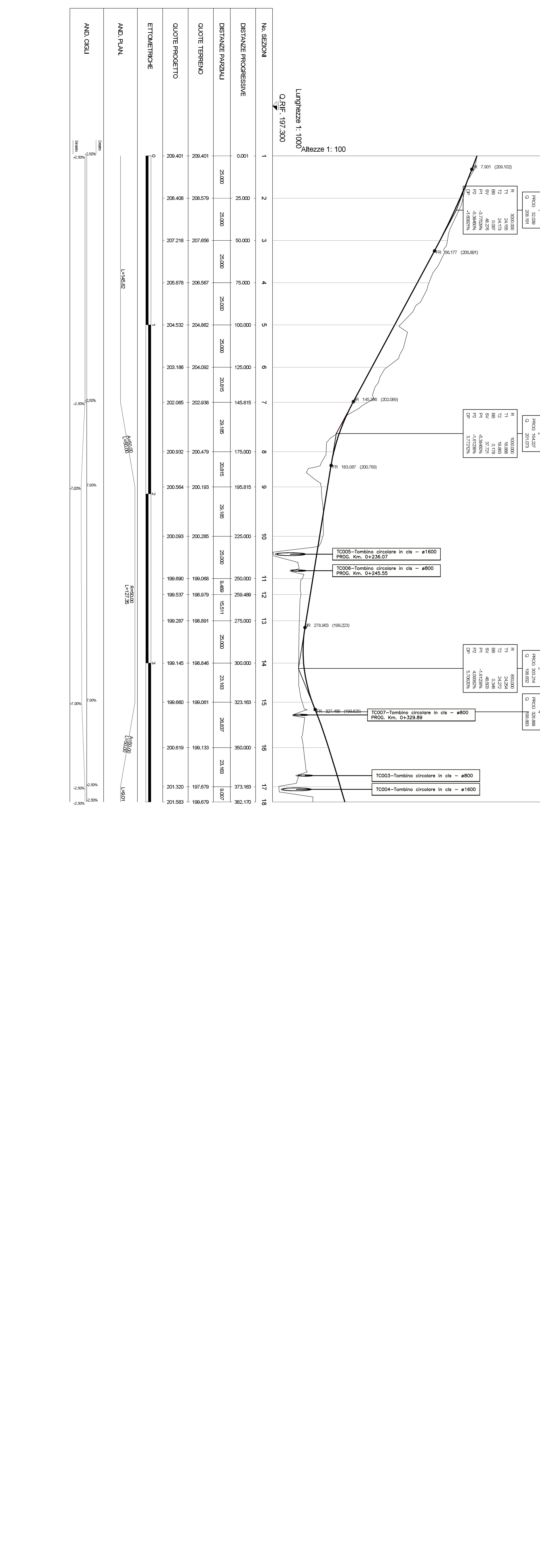
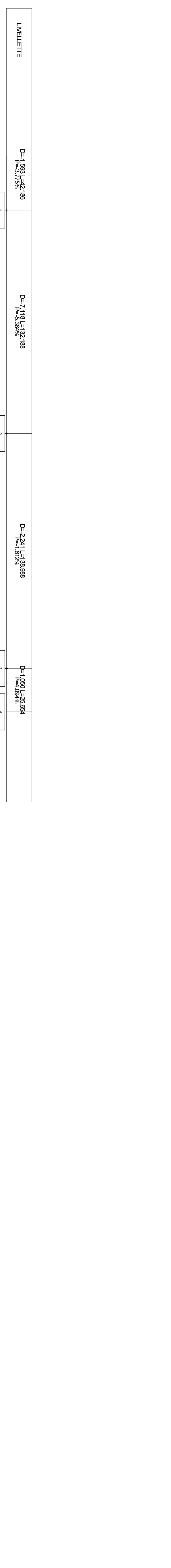

PROGETTO DI FATTIBILITA' TECNICA ED ECONOMICA
S1 - ADEGUAMENTO SINCOLO DI DALMINE
 PARTE STRADALE

PROFILI LONGITUDINALI
 RAMPE A2 - A3

autostrade // per l'Italia
AUTOSTRADA (A4) : TORINO - VENEZIA
ADEGUAMENTO DELLO SINCOLO DI DALMINE
TRATTO: MILANO BERGAMO

SPeA **INGEGNERIA**
 Via Fazio Saverio, 5
 10126 TORINO
 Tel. 011/2670111

VERO DIR. COORDINATORE
autostrade // per l'Italia
 Via Fazio Saverio, 5
 10126 TORINO
 Tel. 011/2670111

VERO DIR. COORDINATORE
INGEGNERIA
 Via Fazio Saverio, 5
 10126 TORINO
 Tel. 011/2670111