

Provincia		VERONA						
Comune		VERONA						
L =		363.588	860.012	191.011	223.452	270.354	628.193	
DISL =		-2.882	-1.032	-1.534	-0.455	-2.095	-0.755	
P =		8.20	1.20	8.03	1.99	7.75	1.20	
Progr. Livellate		0.000	363.588	1223.60	1414.611	1638.063	1908.417	2537.61

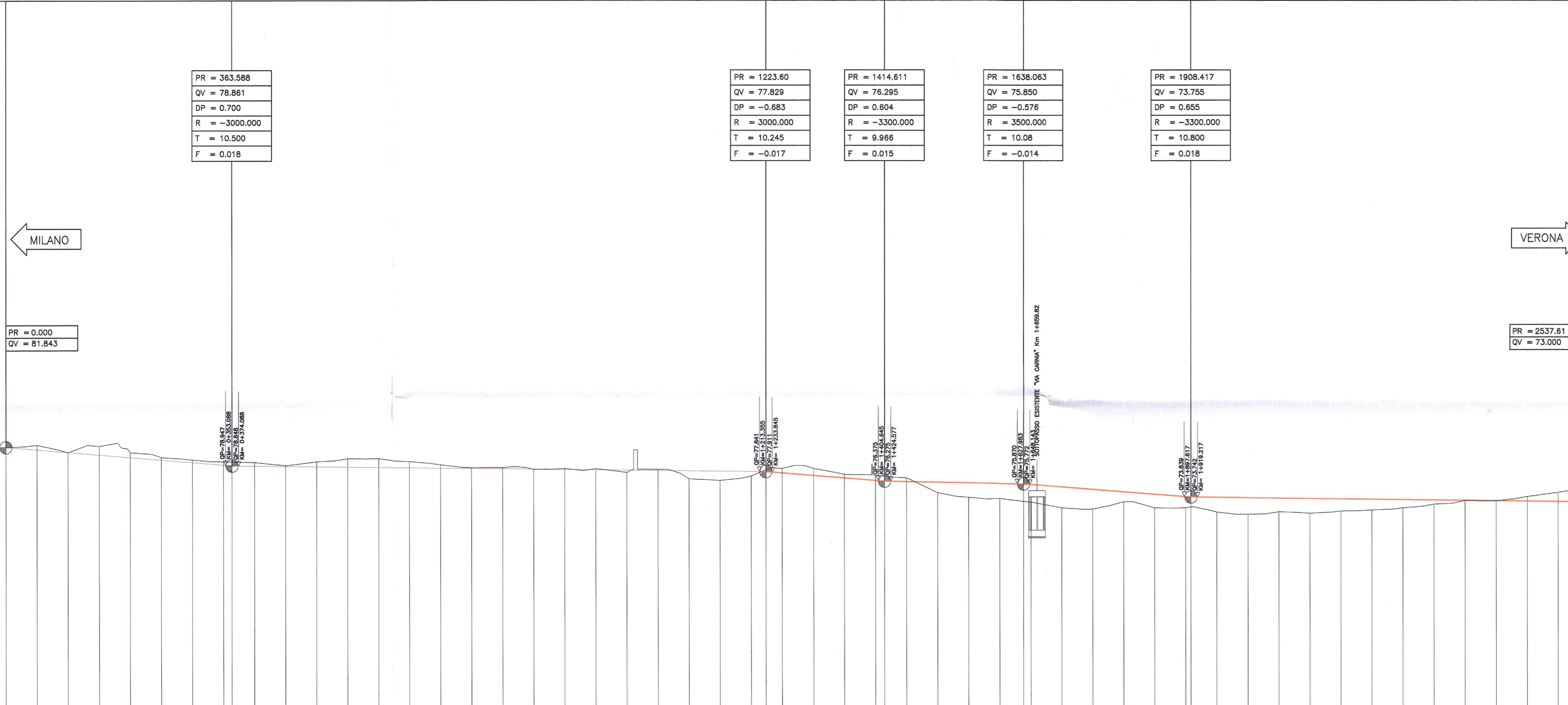

SEZIONI	000	100	200	300	400	500	600	700	800	900	000	100	200	300	400	500	600	700	800	900	000	100	200	300	400	500	37.81						
QUOTE PROGETTO	81.843	81.438	81.027	80.596	80.205	79.794	79.384	78.973	78.572	78.172	77.772	77.372	76.972	76.572	76.172	75.772	75.372	74.972	74.572	74.172	73.772	73.372	72.972	72.572	72.172	71.772	71.372	70.972	70.572	70.172	69.772	69.372	
QUOTE TERRENO	81.843	81.438	81.027	80.596	80.205	79.794	79.384	78.973	78.572	78.172	77.772	77.372	76.972	76.572	76.172	75.772	75.372	74.972	74.572	74.172	73.772	73.372	72.972	72.572	72.172	71.772	71.372	70.972	70.572	70.172	69.772	69.372	
ETOMETRICHE	000	50	100	150	200	250	300	350	400	450	500	550	600	650	700	750	800	850	900	950	000	50	100	150	200	250	300	350	400	450	500	550	600
DIST. PARZIALI	0+000.00	0+050.00	0+100.00	0+150.00	0+200.00	0+250.00	0+300.00	0+350.00	0+400.00	0+450.00	0+500.00	0+550.00	0+600.00	0+650.00	0+700.00	0+750.00	0+800.00	0+850.00	0+900.00	0+950.00	1+000.00	1+050.00	1+100.00	1+150.00	1+200.00	1+250.00	1+300.00	1+350.00	1+400.00	1+450.00	1+500.00	1+550.00	1+600.00
PROGRESSIVE	0+000.00	0+050.00	0+100.00	0+150.00	0+200.00	0+250.00	0+300.00	0+350.00	0+400.00	0+450.00	0+500.00	0+550.00	0+600.00	0+650.00	0+700.00	0+750.00	0+800.00	0+850.00	0+900.00	0+950.00	1+000.00	1+050.00	1+100.00	1+150.00	1+200.00	1+250.00	1+300.00	1+350.00	1+400.00	1+450.00	1+500.00	1+550.00	1+600.00
ANDAMENTO PLANIMETRICO	<p>Planimetric alignment showing curves with radii: R=148.85, R=550, L=47.98, L=156.25, R=800, L=55.18, L=801.83, R=150, L=36.32, L=18, R=30, R=30, L=70.20, R=105, L=30, R=250, L=22, L=28, R=500, L=60, L=50, R=1500, L=37.55, L=18, R=150, L=37.55, R=400, L=372.04, R=26.12.</p>																																
VELOCITA'	60 Km/h																30 Km/h																
WBS OPERE FERROVIARIE	TR13																R16																
WBS OPERE VARIE	1+483.45																																
PROGRESSIVE WBS	1+483.45																																

COMMITTENTE:

PROGETTAZIONE:

INFRASTRUTTURE FERROVIARIE STRATEGICHE DEFINITE DALLA LEGGE OBIETTIVO N. 443/01 e s.m.i

U.O. INFRASTRUTTURE NORD
PROGETTO PRELIMINARE
LINEA AV/AC MILANO - VENEZIA
LOTTO FUNZIONALE TRATTA AV/AC VERONA-PADOVA
NODO AV/AC DI VERONA: INGRESSO EST

TRACCIATO FERROVIARIO
 PPROFIO LONGITUDINALE SCALO CASON

SCALA:
 1:5000/500

Revis.	Descrizione	Redatto	Data	Verificato	Data	Approvato	Data	Autorizzato / Data
A	Emissione esecutiva	M. Brindisi	05.17	M. Brindisi	05.17	C. Mazzocchi	05.17	F. Sacchi 05.17