

Provincia	VERONA									
Comune	VERONA									
L =	70.850	88.910	82.330	219.390	436.420	395.780	435.530	121.883		
DISL =	0.000	0.960	1.110	0.000	-0.420	-0.843	0.753	-0.090		
P =	0.000	1.080	1.348	0.000	-0.096	-0.213	0.173	-0.074		
Progr. Livellette	70.850	159.760	242.090	461.480	899.900	1295.680	1731.210	1853.093		

PR = 70.850 QV = 66.450 DP = 1.080 R = -3000.000 T = 16.196 F = 0.044	PR = 242.090 QV = 68.520 DP = -1.348 R = 3000.000 T = 20.223 F = -0.068	PR = 461.480 QV = 68.520 DP = -0.096 R = 3000.000 T = 14.37 F = -0.003	PR = 899.900 QV = 68.100 DP = -0.117 R = 3000.000 T = 17.580 F = -0.005	PR = 1295.680 QV = 67.257 DP = 0.386 R = -10000.000 T = 19.294 F = 0.019	PR = 1731.210 QV = 68.010 DP = -0.247 R = 10000.000 T = 12.337 F = -0.008
--	--	---	--	---	--

PR = 1313.450 QV = 69.850 DP = -0.703 R = 3500.000 T = 12.302 F = -0.022	PR = 1853.093 QV = 67.920
---	------------------------------

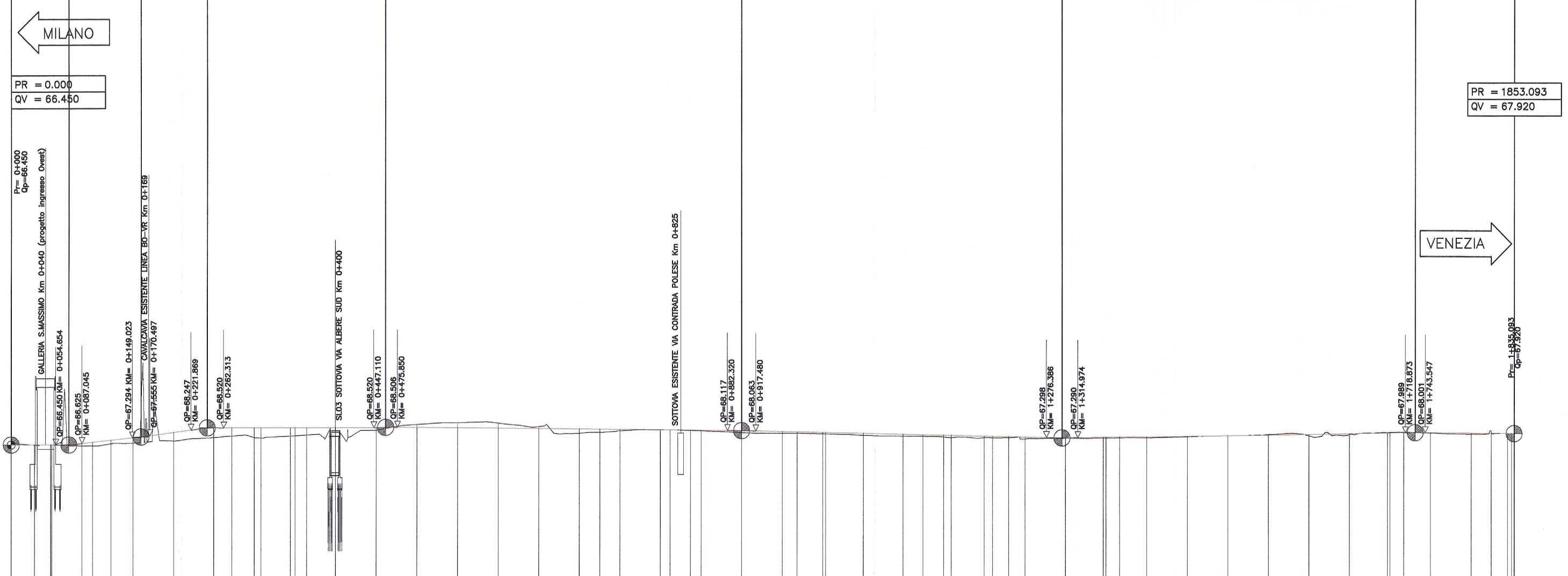

SEZIONI																																																																																																	
QUOTE PROGETTO	66.450	66.450	66.450	66.623	67.012	67.205	67.953	68.495	68.520	68.520	68.520	68.520	68.483	68.435	68.387	68.339	68.292	68.267	68.244	68.185	68.184	68.184	68.160	68.148	68.095	67.993	67.954	67.880	67.780	67.674	67.622	67.547	67.439	67.397	67.354	67.278	67.278	67.245	67.279	67.437	67.524	67.610	67.697	67.783	67.870	67.951	67.986	67.996	67.959	67.941	67.922																																														
QUOTE TERRENO	66.617	66.434	70.453	66.623	66.321	66.765	66.584	67.012	66.654	67.205	66.921	67.953	67.928	68.495	67.909	68.520	67.267	68.520	67.544	68.520	67.643	68.520	62.639	68.520	68.216	68.520	68.643	68.483	68.054	68.435	68.999	68.387	68.571	68.339	67.768	68.292	67.893	68.267	68.092	68.244	68.185	68.184	68.184	68.160	68.148	67.863	68.095	67.786	67.993	67.781	67.954	67.764	67.880	67.535	67.780	67.439	67.674	67.439	67.622	67.337	67.547	67.284	67.461	67.278	67.397	67.103	67.354	67.232	67.278	67.232	67.345	67.279	67.379	67.351	67.437	67.480	67.524	67.638	67.610	67.769	67.697	67.623	67.783	67.781	67.870	68.002	67.951	68.057	67.986	67.958	67.996	67.936	67.959	68.185	67.941	67.922	67.922
ETTOMETRICHE	000	100	200	300	400	500	600	700	800	900	000	100	200	300	400	500	600	700	800	900																																																																													
DIST. PARZIALI	29	20	38	13	23	27	50	28	28	8	36	614	36	50	50	50	50	25	25	50	12	25	13	50	50	18	32	3	47	50	1100.00	1124.42	26	9	41	10	20	15	1230.15	1250.00	50	46	20	34	50	50	50	50	50	50	47	20	33	50	25	20	8																																								
PROGRESSIVE	0.00	28.53	48.53	86.89	100.00	122.89	150.00	200.00	250.00	272.36	300.00	300.00	366.00	384.44	400.00	450.00	500.00	550.00	600.00	650.00	700.00	725.26	750.00	800.00	812.05	837.05	850.00	900.00	950.00	968.32	1000.00	1050.00	1100.00	1124.42	1150.00	1200.00	1210.15	1230.15	1250.00	1300.00	1346.44	1386.44	1400.00	1450.00	1500.00	1550.00	1600.00	1650.00	1697.15	1717.15	1750.00	1800.00	1824.82	1844.82	1844.82																																										
ANDAMENTO PLANIMETRICO	L=28.53 RP=20	R=10000 L=36.36	RP=36	R=397.14 L=149.47	RP=36	R=30000 L=36.08	L=335.82	RP=25	R=500.00 L=66.79	L=128.06	RP=35	R=400.00 L=125.99	RP=35	L=74.70	RP=25	R=510.00 L=82.71	RP=25	L=326.71	RP=20	R=700.00 L=102.85	RP=20	L=14.56																																																																											
VELOCITA'	60 Km/h																																																																																																
WBS OPERE FERROVIARIE	TR10										TR11																																																																																						
WBS OPERE VIARIE											SLO3																																																																																						
PROGRESSIVE WBS	40.00	169.00										400.00																																																																																					

COMMITTENTE:  
**RFI**  
RETE FERROVIARIA ITALIANA  
GRUPPO FERROVIE DELLO STATO ITALIANE

PROGETTAZIONE:  
**ITALFERR**  
GRUPPO FERROVIE DELLO STATO ITALIANE

**INFRASTRUTTURE FERROVIARIE STRATEGICHE DEFINITE DALLA LEGGE OBIETTIVO N. 443/01 e s.m.i**

U.O. INFRASTRUTTURE NORD  
CUP: J41E9100000009

PROGETTO PRELIMINARE

LINEA AV/AC MILANO - VENEZIA  
LOTTO FUNZIONALE TRATTA AV/AC VERONA-PADOVA

NODO AV/AC DI VERONA: INGRESSO EST

TRACCIATO FERROVIARIO

PROFILO LONGITUDINALE BINARIO DISPARI RACCORDO BIVIO S.MASSIMO-VERONA P.N.

SCALA :  
1:5000/500

COMMESSA	LOTTO	FASE	ENTE	TIPO DOC.	OPERA/DISCIPLINA	PROGR.	REV.
INOF	20	R	26	F5	CS0000	003	B

Revis.	Descrizione	Redatto	Data	Verificato	Data	Approvato	Data	Autorizz.
A	Emissione esecutiva	C.Caramazza	10.16	M.Brindisi	10.16	C.Mazzocchi	10.16	F. FRASSETTO
B	Emissione esecutiva			M.Brindisi	05.17	C.Mazzocchi	05.17	Ing. Francesco Sacchi