

CROSSING UNDER EXISTING UTILITY

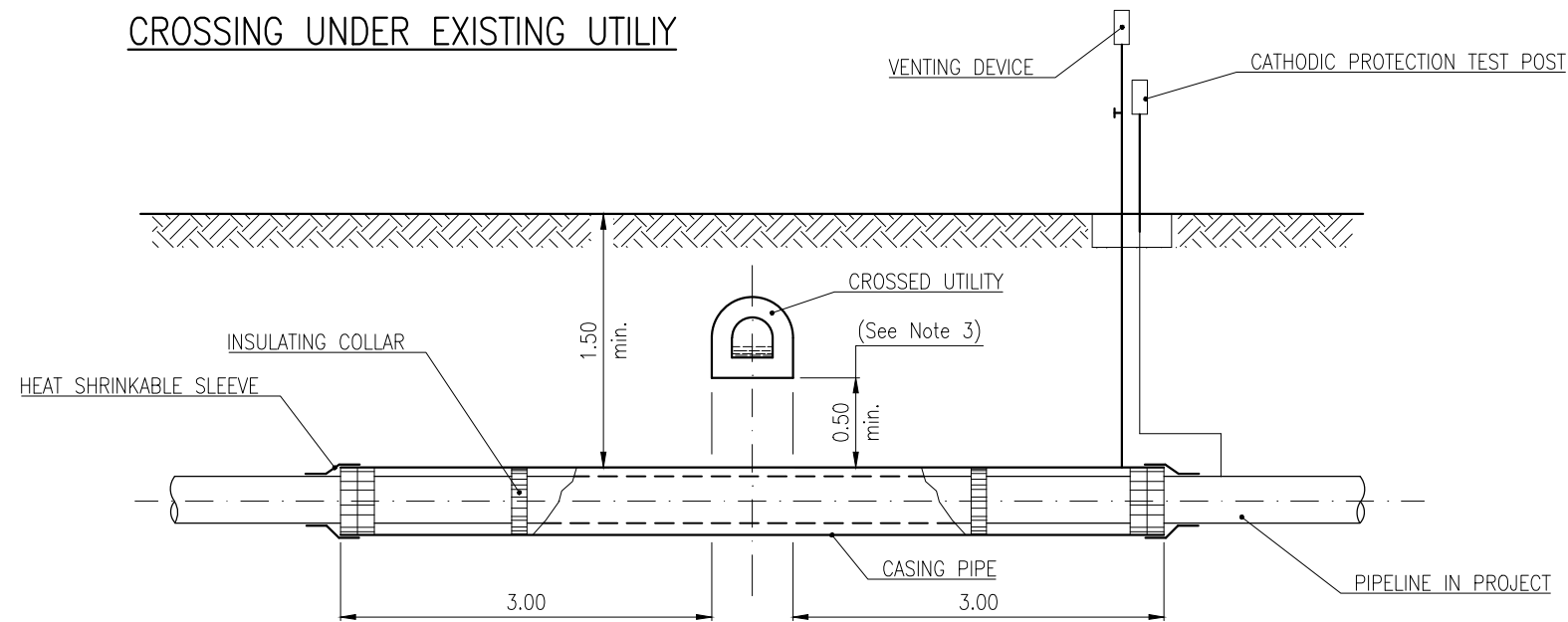

CROSSING OVER EXISTING UTILITY

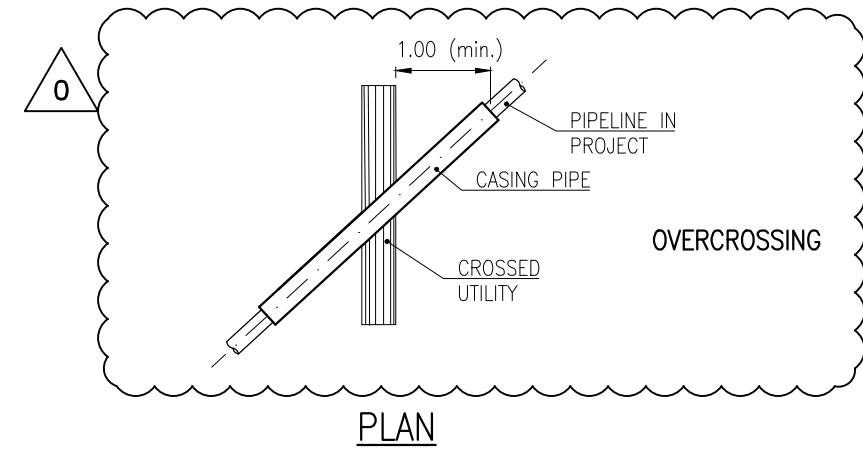
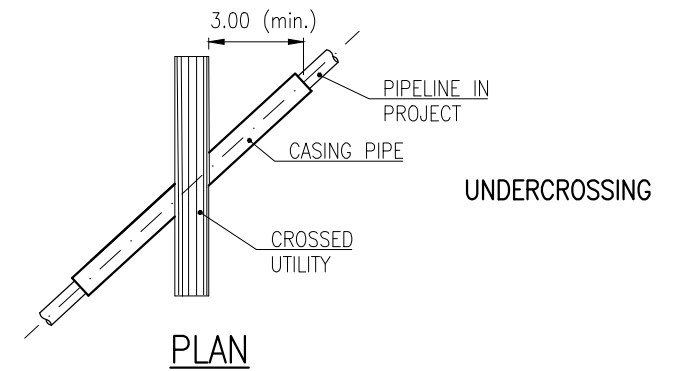
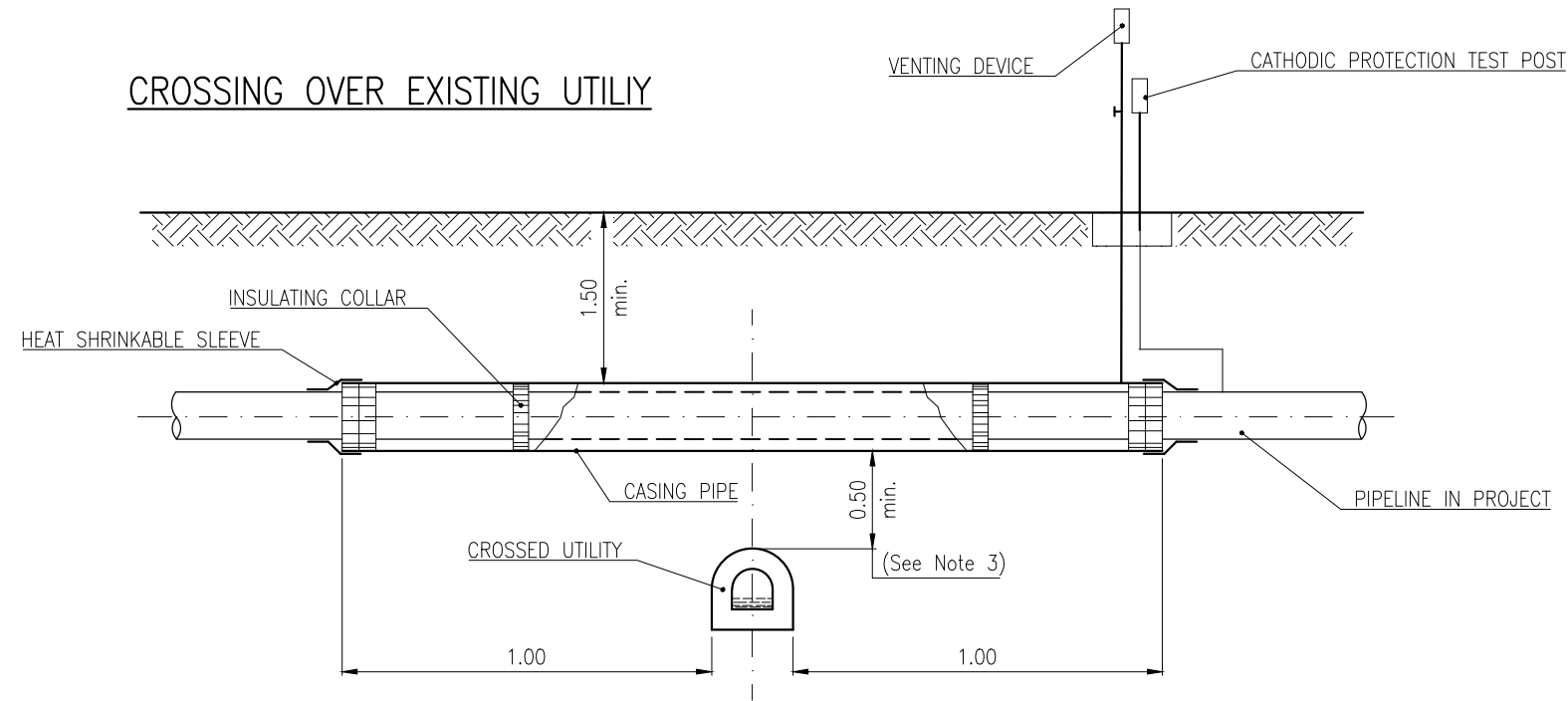

NOTE:

1. THIS DRAWING REPRESENTS A TYPICAL AND DEFINES THE MINIMUM REQUIREMENTS FOR THE SEWER AND COVERED CANAL CROSSINGS.
2. THE DESIGN OF THE CROSSING SHALL BE IN ACCORDANCE WITH D.M. 17/04/2008.
3. IF THE SEPARATION BETWEEN THE PIPELINE AND THE CROSSED SERVICE IS MORE THAN 1.50m, THE CASING IS NOT REQUIRED.
4. THE ANNULUS SHALL BE EMPTY OR FILLED WITH COMPANY APPROVED DRAINING MATERIAL AND CONNECTED TO A VENT.
5. THE EXACT LOCATION AND BURIAL OF THE SERVICE TO BE CROSSED SHALL BE DETERMINED WITH AN ON PURPOSE SURVEY. THE SERVICE OWNER SHALL BE MADE AWARE AND SHALL AGREE WITH THE PROPOSED CROSSING CONFIGURATION.
6. FOR DETAILS OF CASING PIPE INSTALLATION SEE DWG IPL00-C5522-100-F-DFT-0003 SH.2.
7. CROSSING SHALL BE MADE AS MUCH AS PERPENDICULAR.
8. ALL MEASUREMENTS ARE IN METRES UNLESS OTHERWISE SPECIFIED.



SUPPLIER DOCUMENT NUMBER
P15IT03157-PPL-DW-000-019

REV. NO.
0



PROJECT TITLE
Trans Adriatic Pipeline Project/Onshore Pipeline Italy (OPLI)

DRAWING TITLE
TYPICAL CROSSING OF SEWER AND COVERED CANALS

TAG NUMBERS

—
—
—

PAGE
1 of 2

FORMAT A3	SCALE N.T.S.	FACILITY CODE	SYSTEM NO. —	RD CODE	REVISION NO. 0
---------------------	------------------------	---------------	-----------------	---------	--------------------------

0	ISSUED FOR CONSTRUCTION	IFC	EMANUELE PEDINI	ALESSANDRO BENVENUTI	ALBERTO FARINA	10/10/16
B	RE-ISSUED FOR REVIEW	IFR	EP	AB	AF	06/09/16
A	ISSUED FOR REVIEW	IFR	EP	AB	AF	10/08/16
REV.	DESCRIPTION		PREP	VFY	APPR	DATE

DRAWING NO.
IPL00-C5522-100-F-DFT-0019-01

SOTTOPASSI

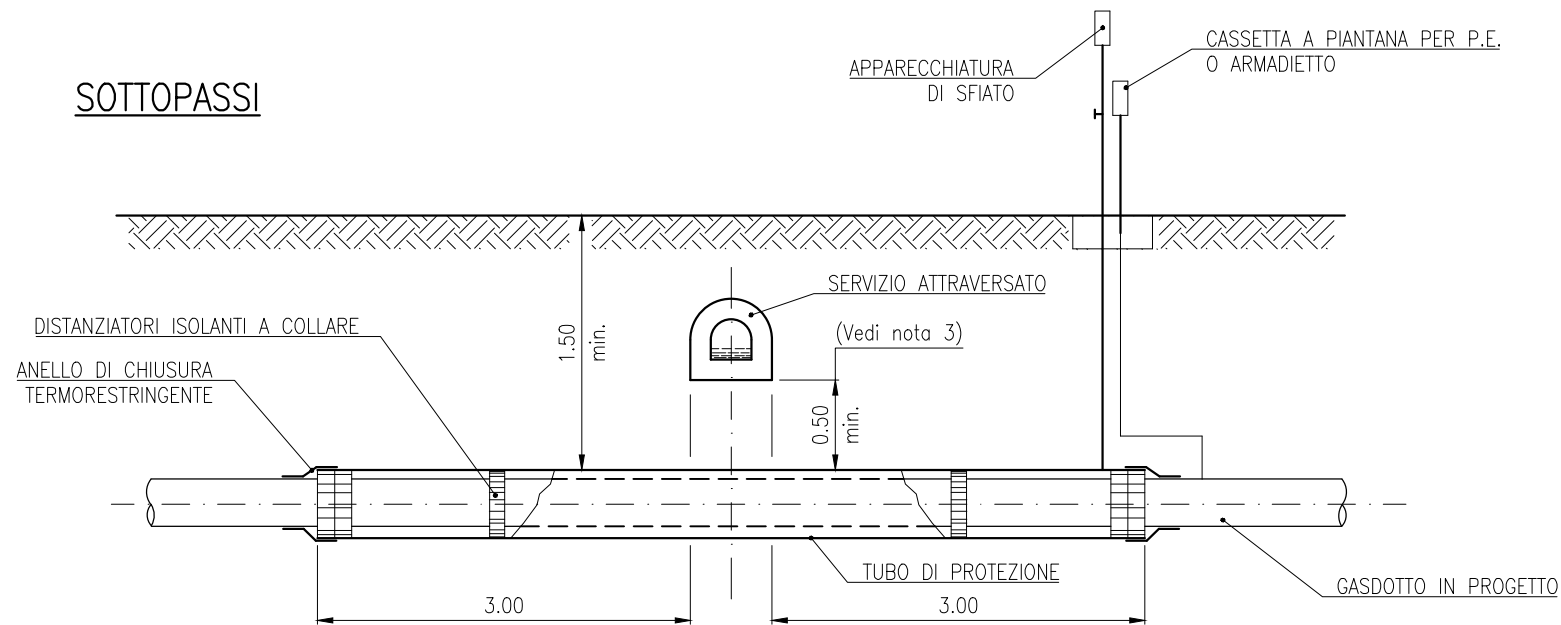

SOVRAPPASSI

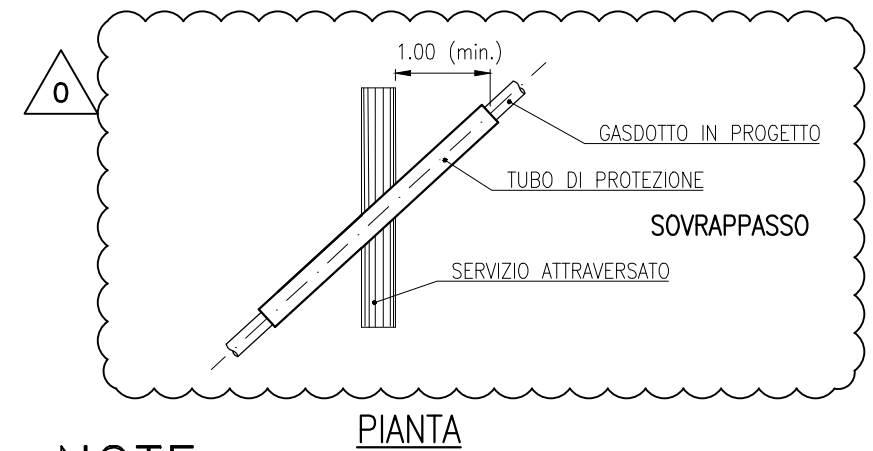
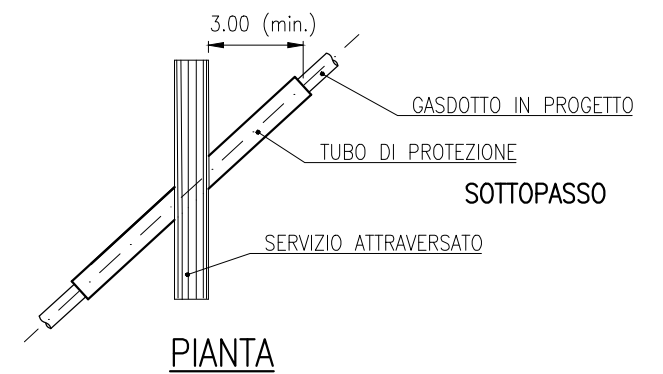
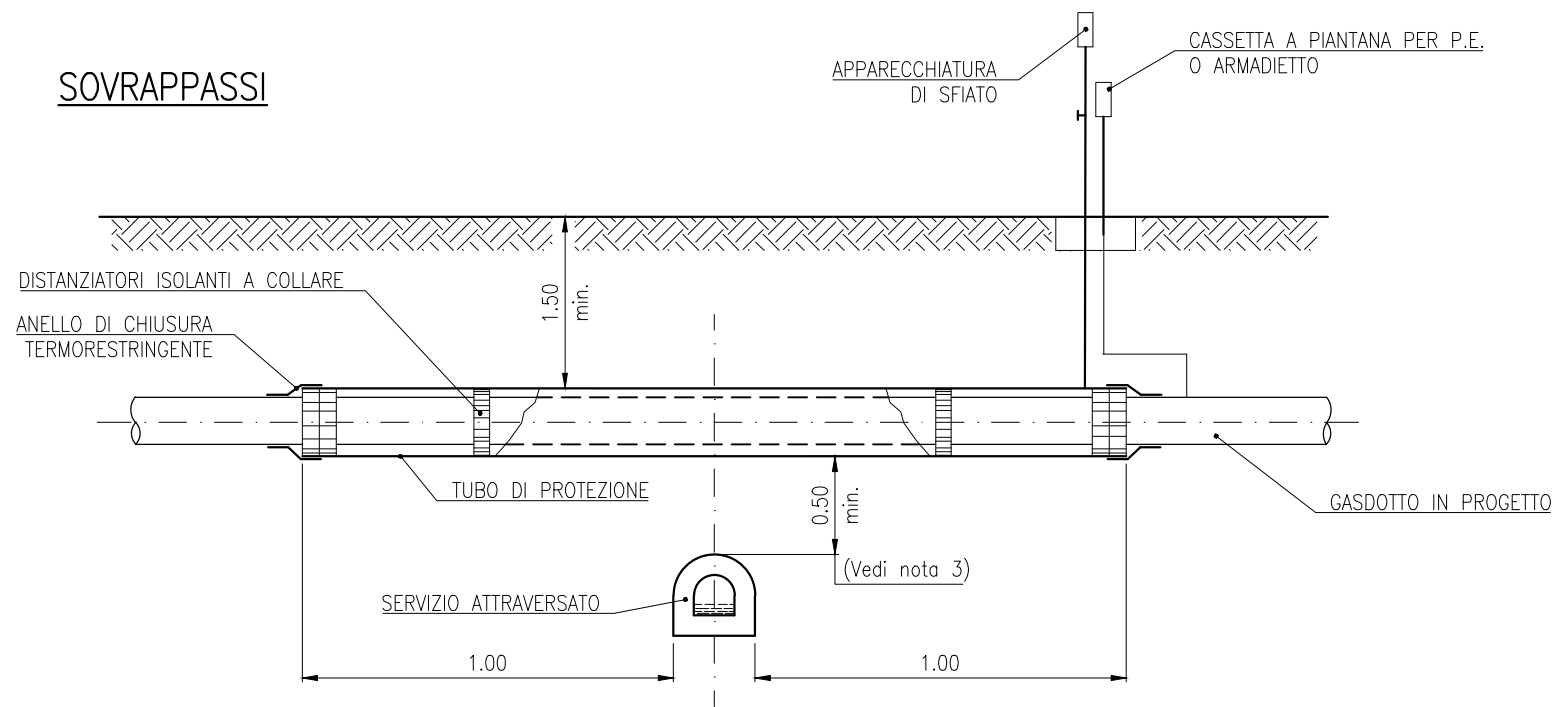

NOTE:

- QUESTO DISEGNO RAPPRESENTA UN TIPICO E DEFINISCE I MINIMI REQUISITI PER L'ATTRAVERSAMENTO DI FOGNATURE E CANALI.
- LA PROGETTAZIONE DELL'ATTRAVERSAMENTO SARA' IN ACCORDO AL D.M. 17/04/2008.
- SE LA SEPARAZIONE TRA LA CONDOTTA ED IL SERVIZIO ATTRAVERSATO E' MAGGIORE DI 1.50m, IL TUBO DI PROTEZIONE NON E' NECESSARIO.
- TRA LA CONDOTTA E IL TUBO DI PROTEZIONE DEVE ESSERE ASSICURATA UNA INTERCAPEDINE LIBERA O RIEMPIA CON MATERIALE DRENANTE CHE SARA' RESA COMUNICANTE CON L'ESTERNO MEDIANTE IL COLLEGAMENTO DI UNO O PIU' SFIATI.
- L'ESATTA UBICAZIONE E COPERTURA DEL SERVIZIO DA ATTRAVERSARE SARA' DETERMINATA CON UNA APPOSITA INDAGINE. LA CONFIGURAZIONE DELL'ATTRAVERSAMENTO DOVRA' ESSERE CONCORDATA CON IL PROPRIETARIO O IL GESTORE DEL SERVIZIO.
- PER I DETTAGLI DELL'INSATALLAZIONE DEL TUBO DI PROTEZIONE VEDI DWG N. IPL00-C5522-100-F-DFT-0003 SH.4
- L'ATTRAVERSAMENTO SARA' REALIZZATO PER QUANTO POSSIBILE PERPENDICOLARMENTE
- TUTTE LE MISURE SONO ESPRESSE IN METRI SE NON DIVERSAMENTE INDICATO.



SUPPLIER DOCUMENT NUMBER
P15IT03157-PPL-DW-000-019

REV. NO.
0



PROJECT TITLE

Trans Adriatic Pipeline Project/Onshore Pipeline Italy (OPLI)

DRAWING TITLE

ATTRAVERSAMENTO TIPO DI FOGNATURE E CANALI

TAG NUMBERS

—
—
—

PAGE

2 of 2

FORMAT

A3

SCALE

N.T.S.

FACILITY CODE

—

SYSTEM NO.

—

RD CODE

—

REVISION NO.

0

0	ISSUED FOR CONSTRUCTION	IFC	EMANUELE PEDINI	ALESSANDRO BENVENUTI	ALBERTO FARINA	10/10/16
B	RE-ISSUED FOR REVIEW	IFR	EP	AB	AF	06/09/16
A	ISSUED FOR REVIEW	IFR	EP	AB	AF	10/08/16
REV.	DESCRIPTION		PREP	VFY	APPR	DATE

DRAWING NO.

IPL00-C5522-100-F-DFT-0019-01