

CADASTRAL MAP	REFERENCE DRAWINGS	N°
TECHNICAL SPECIFICATION - BLOCK VALVE STATION ILV33 - CIVIL DESIGN SPECIFICATION		IPL00-C5522-000-F-DFK-0001-01
TECHNICAL SPECIFICATION - FENCING		IPL00-C5522-961-Q-TSD-0003
		IPL00-C5522-961-Q-TSD-0005

NOTES:
NOTE:

- ALL CO-ORDINATES AND ELEVATIONS ARE IN METRES, DIMENSIONS ARE IN MILLIMETERS.
- TUTTE LE COORDINATE E LE ELEVAZIONI SONO IN METRI, LE DIMENSIONI SONO IN MILLIMETRI.
- PLANT CO-ORDINATE (N 100.000, E 100.000) IS EQUIVALENT TO GEOGRAPHICAL CO-ORDINATE N=4465038.24 E=277684.59 WITH RESPECT TO TRUE NORTH.
- LE COORDINATE D'IMPIANTO (N 100.000, E 100.000) CORRISPONDENTI ALLE COORDINATE GEOGRAFICHE N=4465038.24 E=277684.59 CON RISPETTO AL NORD GEOGRAFICO.
- PLANT ELEVATION 0.00 CORRISPONDS TO TOPOGRAPHICAL ELEVATION 9.00 m A.S.L. REFERRED TO TOPOGRAPHICAL SURVEY REPORT IPL00-C5522-000-F-TRN-0001.
- LA QUOTA IMPIANTO 0,00 CORRISPONDE ALLA QUOTA 9,00 m S.L.M. RIPORTATO SULLA RELAZIONE DEL RILIEVO TOPOGRAFICO IPL00-C5522-000-F-TRN-0001.
- PRECAST "ENEL" PIT Dint 600x600 Hint 600mm WITH CAST IRON COVER TYPE UNI EN 124 - D400 WITH THE INSCRIPTION "ENEL - CAVI ELETTRICI".
- POZZETTO PREFABBRICATO USO "ENEL" Dint 600x600 Hint 600mm CON CHIUSINO IN GHISA TIPO UNI EN 124 - D400 RECANTE LA SCRITTA IN RILIEVO "ENEL - CAVI ELETTRICI".
- N° 3 PRECAST PITS Dint 1000x1000 Hint=1000 WITH CAST IRON COVER TYPE UNI EN 124 - D400. MATERIALS SHALL BE ACCORDING TO "TECHNICAL SPECIFICATION - CONCRETE WORKS - IPL00-C5522-961-Q-TSD-0004".
- N° 3 POZZETTI PREFABBRICATI Dint 1000x1000 Hint=1000 CON CHIUSINO IN GHISA TIPO UNI EN 124 - D400. I MATERIALI DEVONO ESSERE IN ACCORDO ALLA SPECIFICA "TECHNICAL SPECIFICATION - CONCRETE WORKS - IPL00-C5522-961-Q-TSD-0004".

THE COORDINATES ARE BASED ON THE SYSTEM:
LE COORDINATE GEOGRAFICHE SONO BASATE SUL SISTEMA:

GEODETIC REFERENCE SYSTEM	
Datum: WGS84	Spheroid: WGS84
Projection: UTM (Zone 34)	Central meridian: 21°E
Vertical Ref. Level: LAT	

LEGEND:
LEGENDA:

- E:100.000 N:100.000 REFERENCE PLANT CO-ORDINATE RIFERIMENTO COORDINATE D'IMPIANTO
- 0.00 FINISHING LEVEL ELEVATION QUOTA DI RIFERIMENTO IMPIANTO
- AREA WITH VEGETATIONAL LANDSCAPE MITIGATION (SURROUNDING VEGETATION) AREA DESTINATA AGLI INTERVENTI DI MASCHERAMENTO ED INSERIMENTO PAESAGISTICO(MASCHERAMENTO VEGETAZIONALE)
- QUARRY CRUSH GRANULAR MIX WITH COLOUR RANGE OF TUFFACEOUS LAND Thk. 50mm min. STRATO DI FRANTUMATO DI CAVA ASSORTITO CON CROMIE SULLA GAMMA DEI TERRENI TUFACEI Sp. 50mm min.
- FENCE RECINZIONE
- CIVIL WORKS OPERE CIVILI
- END-XX TAG CIVIL SUPPORT FOUNDATION
- XX-VIP-XXX TAG MECHANICAL PIPING SUPPORT

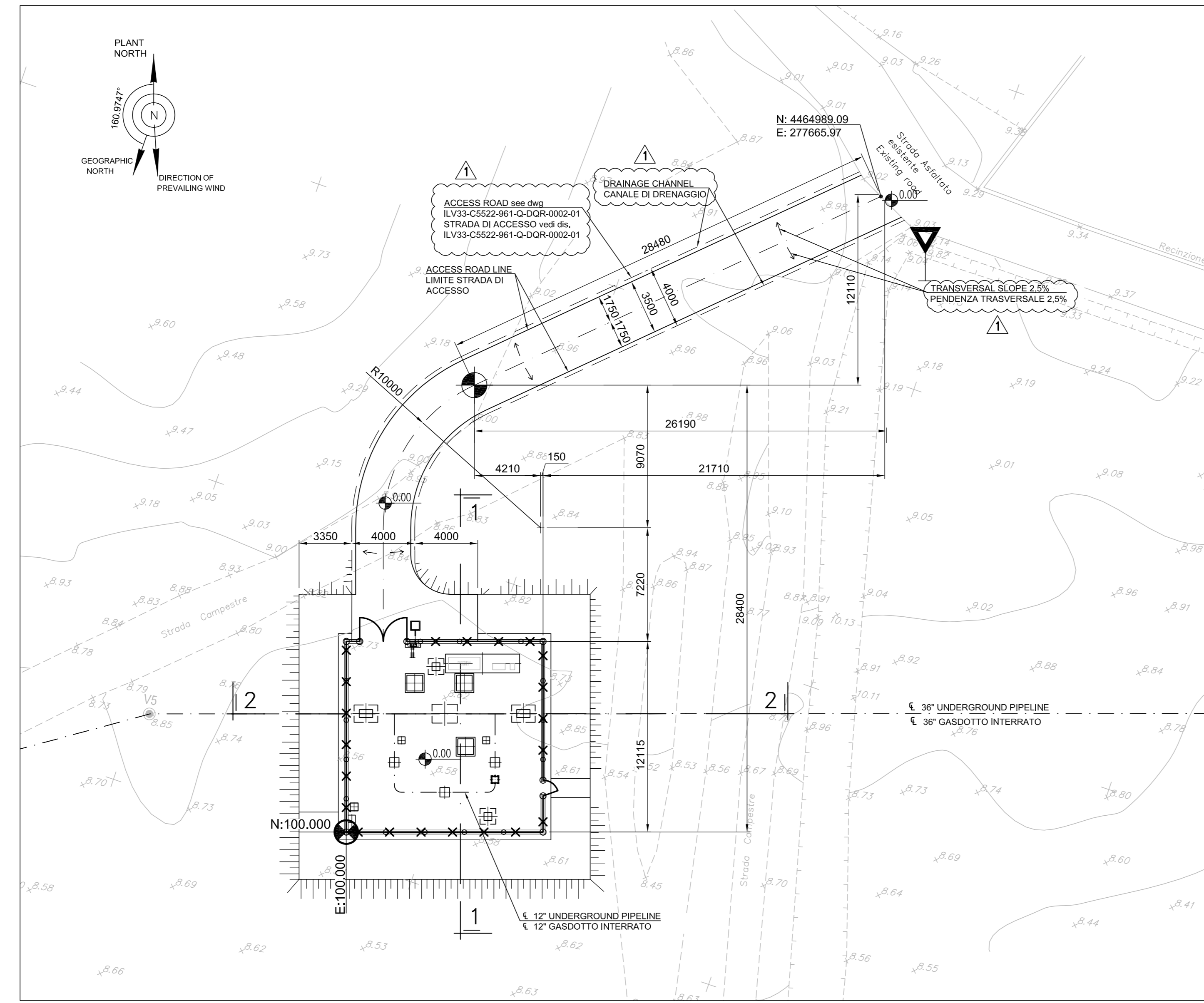

GRADING PLAN AND ACCESS ROAD LAYOUT
PIANO QUOTATO E PIANTA STRADA DI ACCESSO
SCALE 1:200
SCALA 1:200

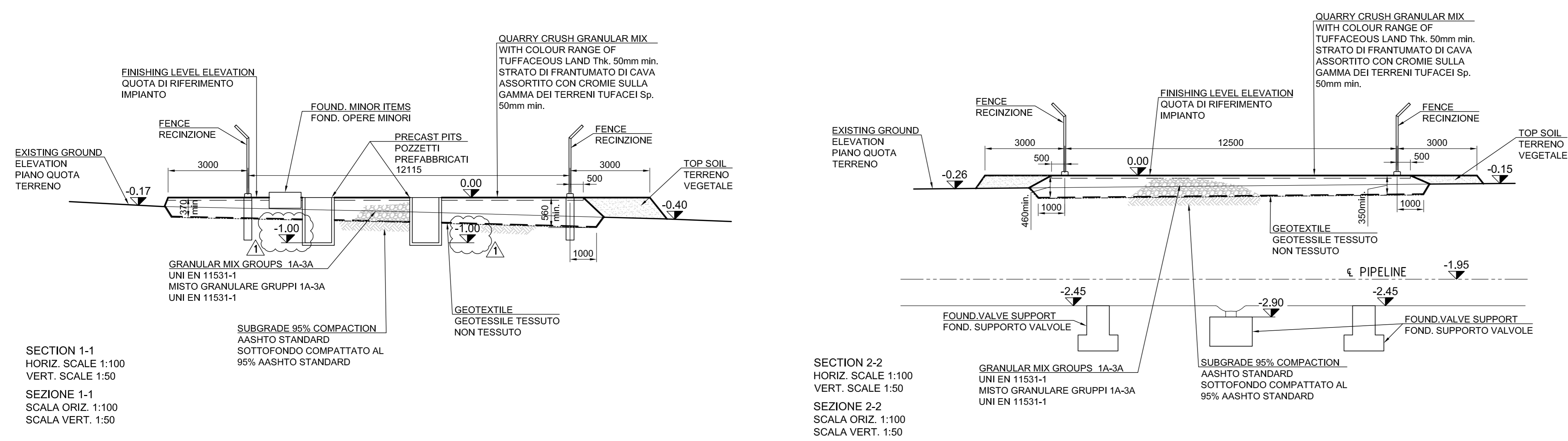

SECTION 1-1
HORIZ. SCALE 1:100
VERT. SCALE 1:50
SEZIONE 1-1
SCALA ORIZ. 1:100
SCALA VERT. 1:50

SECTION 2-2
HORIZ. SCALE 1:100
VERT. SCALE 1:50
SEZIONE 2-2
SCALA ORIZ. 1:100
SCALA VERT. 1:50



SUPPLIER DOCUMENT NUMBER	REV. NO.	MAX STREICHER S.p.A.	Enerco
P151T03157-CIV-DW-000-001	1		

1	RE-ISSUED FOR CONSTRUCTION / RIEMISSIONE PER COSTRUZIONE	IFC	GIACOMINI ALESSANDRO	ALBERTO FARINA	24/01/17
0	ISSUED FOR CONSTRUCTION / EMISSIONE PER COSTRUZIONE	IFC	GIACOMINI ALESSANDRO	ALBERTO FARINA	11/11/16
A	ISSUED FOR REVIEW / EMISSIONE PER REVISIONE	IFR	GIACOMINI ALESSANDRO	ALBERTO FARINA	25/10/16

REV.	DESCRIPTION	PREP	VFY	APPR	DATE
------	-------------	------	-----	------	------

PROJECT TITLE	Trans Adriatic Pipeline Project/Onshore Pipeline Italy (OPL)	TAG NUMBERS	
DRAWING TITLE	BLOCK VALVE STATION ILV-33 - CIVIL WORKS GENERAL LAYOUT	PAGE	1 of 2
FORMAT	A1	REVISION NO.	1

DRAWING NO. **ILV33-C5522-961-Q-DQA-0001-01**

REFERENCE DRAWINGS	N°
CADASTRAL MAP	IPL00-C5522-000-F-DFK-0001-01
TECHNICAL SPECIFICATION - BLOCK VALVE STATION ILV33 - CIVIL DESIGN SPECIFICATION	IPL00-C5522-961-Q-TSD-0003
TECHNICAL SPECIFICATION - FENCING	IPL00-C5522-961-Q-TSD-0005

- NOTES:**
NOTE:
- ALL CO-ORDINATES AND ELEVATIONS ARE IN METRES, DIMENSIONS ARE IN MILLIMETERS.
 - TUTTE LE COORDINATE E LE ELEVAZIONI SONO IN METRI, LE DIMENSIONI SONO IN MILLIMETRI.
 - PLANT CO-ORDINATE (N 100.000, E 100.000) IS EQUIVALENT TO GEOGRAPHICAL CO-ORDINATE N=4465038.24 E=277684.59 WITH RESPECT TO TRUE NORTH.
 - LE COORDINATE D'IMPIANTO (N 100.000, E 100.000) CORRISPONDONO ALLE COORDINATE GEOGRAFICHE N=4465038.24 E=277684.59 CON RISPETTO AL NORD GEOGRAFICO.
 - PLANT ELEVATION 0.00 CORRISPONDE TO TOPOGRAPHICAL ELEVATION 9.00 m A.S.L. REFERRED TO TOPOGRAPHICAL SURVEY REPORT IPL00-C5522-000-F-TRN-0001.
 - LA QUOTA IMPIANTO 0,00 CORRISPONDE ALLA QUOTA 9,00 m S.L.M. RIPORTATO SULLA RELAZIONE DEL RILIEVO TOPOGRAFICO IPL00-C5522-000-F-TRN-0001.
 - PRECAST "ENEL" PIT Dint 600x600 Hint 600mm WITH CAST IRON COVER TYPE UNI EN 124 - D400 WITH THE INSCRIPTION "ENEL - CAVI ELETTRICI".
 - POZZETTO PREFABBRICATO USO "ENEL" Dint 600x600 Hint 600mm CON CHIUSINO IN GHISA TIPO UNI EN 124 - D400 RECANTE LA SCRITTA IN RILIEVO "ENEL - CAVI ELETTRICI".
 - N° 3 PRECAST PITS Dint 1000x1000 Hint=1000 WITH CAST IRON COVER TYPE UNI EN 124 - D400. MATERIALS SHALL BE ACCORDING TO "TECHNICAL SPECIFICATION - CONCRETE WORKS - IPL00-C5522-961-Q-TSD-0004".
 - N° 3 POZZETTI PREFABBRICATI Dint 1000x1000 Hint=1000 CON CHIUSINO IN GHISA TIPO UNI EN 124 - D400. I MATERIALI DEVONO ESSERE IN ACCORDO ALLA SPECIFICA "TECHNICAL SPECIFICATION - CONCRETE WORKS - IPL00-C5522-961-Q-TSD-0004".

THE COORDINATES ARE BASED ON THE SYSTEM:
LE COORDINATE GEOGRAFICHE SONO BASATE SUL SISTEMA:

GEODETIC REFERENCE SYSTEM	
Datum: WGS84	Spheroid: WGS84
Projection: UTM (Zone 34)	Central meridian: 21°E
Vertical Ref. Level: LAT	

- LEGEND:**
LEGENDA:
- E:100.000
N:100.000 REFERENCE PLANT CO-ORDINATE
RIFERIMENTO COORDINATE D'IMPIANTO
 - 0.00 FINISHING LEVEL ELEVATION
QUOTA DI RIFERIMENTO IMPIANTO
 - AREA WITH VEGETATIONAL LANDSCAPE MITIGATION (SURROUNDING VEGETATION)
AREA DESTINATA AGLI INTERVENTI DI MASCHERAMENTO ED INSERIMENTO PAESAGGISTICO(MASCHERAMENTO VEGETAZIONALE)
 - QUARRY CRUSH GRANULAR MIX WITH COLOUR RANGE OF TUFFACEOUS LAND Thk. 50mm min.
STRATO DI FRANTUMATO DI CAVA ASSORTITO CON CROMIE SULLA GAMMA DEI TERRENI TUFACEI Sp. 50mm min.
 - FENCE
RECINZIONE
 - CIVIL WORKS
OPERE CIVILI
 - END-XX
XX-VIP-XXX TAG CIVIL SUPPORT FOUNDATION
 - TAG MECHANICAL PIPING SUPPORT



SUPPLIER DOCUMENT NUMBER	REV. NO.	MAX STREICHER S.p.A.	Enerco
P15IT03157-CIV-DW-000-001	1		

REV.	DESCRIPTION	PREP	VFY	APPR	DATE
1	RE-ISSUED FOR CONSTRUCTION / RIEMMISSIONE PER COSTRUZIONE	IFC	GIACOMO ALESSANDRO	ALBERTO FARINA	24/01/17
0	ISSUED FOR CONSTRUCTION / EMISSIONE PER COSTRUZIONE	IFC	GIACOMO ALESSANDRO	ALBERTO FARINA	11/11/16
A	ISSUED FOR REVIEW / EMISSIONE PER REVISIONE	IFR	GIACOMO ALESSANDRO	ALBERTO FARINA	25/10/16

PROJECT TITLE	TAG NUMBERS
Trans Adriatic Pipeline Project/Onshore Pipeline Italy (OPL)	---
DRAWING TITLE	---
Title	---
BLOCK VALVE STATION ILV-33 - CIVIL WORKS GENERAL LAYOUT	PAGE
BLOCK VALVE STATION ILV-33 - PLANIMETRIA OPERE CIVILI	2 of 2
FORMAT	REVISION NO.
A1	1

DRAWING NO. **ILV33-C5522-961-Q-DQA-0001-01**

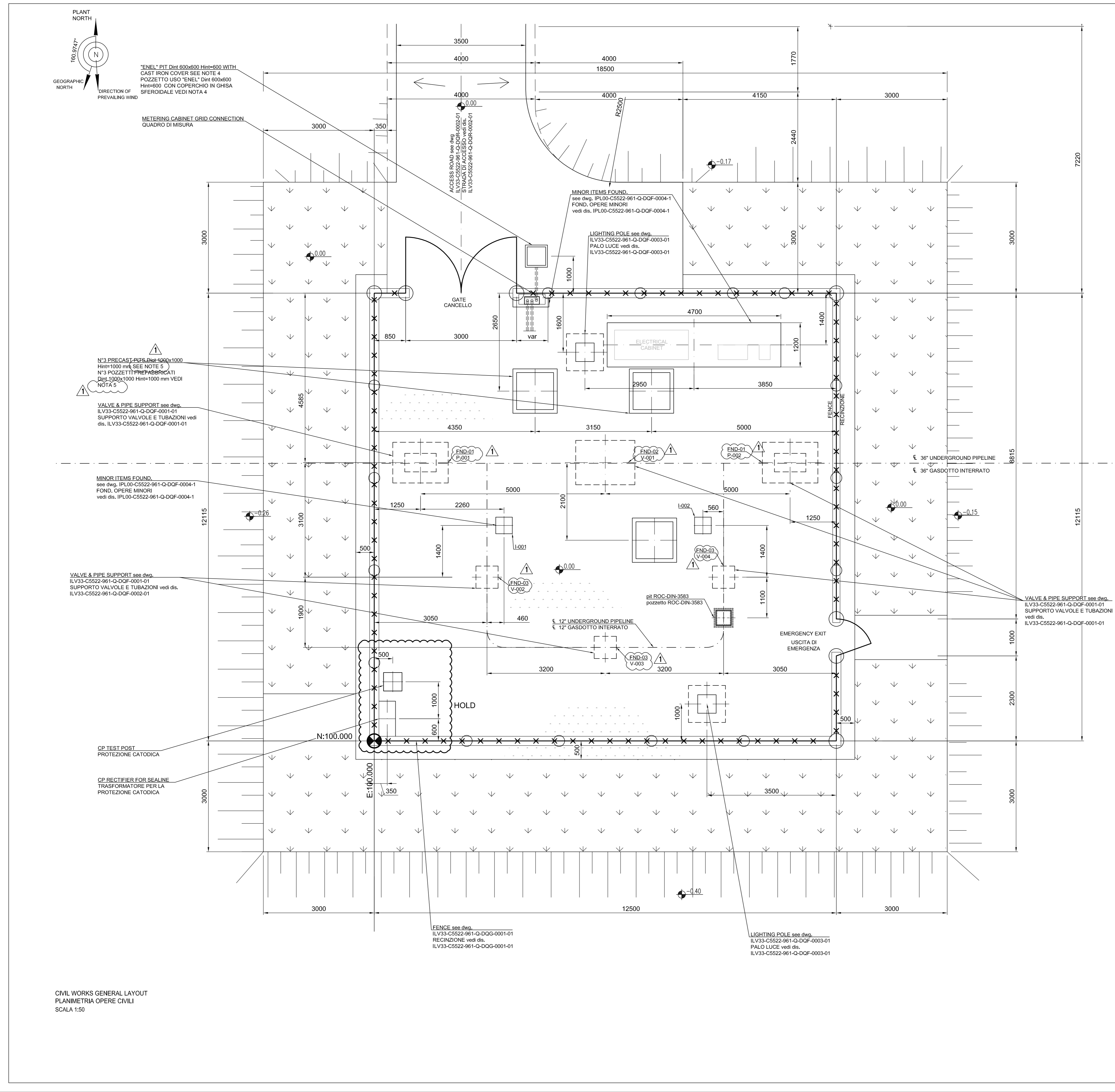

CIVIL WORKS GENERAL LAYOUT
PLANIMETRIA OPERE CIVILI
SCALA 1:50